

**TRACT 34657 - PORTION OF BLOCK 49, CHANDELEUR SOUND AREA, St. Bernard Parish, Louisiana**

All of the lands now or formerly constituting the beds and bottoms of all water bodies of every nature and description and all islands and other lands formed by accretion or reliction, except tax lands, belonging to the State of Louisiana and not under mineral lease on July 10, 2002, situated in St. Bernard Parish, Louisiana, and more particularly described as follows: Beginning at the Northeast corner of Block 49, Chandeleur Sound Area, having Coordinates of X = 2,635,350.00 and Y = 410,830.00; thence South 7,375.00 feet along the East boundary of said Block 49 to a point having Coordinates of X = 2,635,350.00 and Y = 403,455.00; thence West 2,800.00 feet to a point having Coordinates of X = 2,632,550.00 and Y = 403,455.00; thence North 7,375.00 feet to a point on the North boundary of said Block 49 having Coordinates of X = 2,632,550.00 and Y = 410,830.00; thence East 2,800.00 feet along the said North boundary of Block 49 to the point of beginning, containing approximately **450 acres**, as shown outlined on a plat on file in the Office of Mineral Resources, Department of Natural Resources, as provided by the applicant. All bearings, distances and coordinates are based on Louisiana Coordinate System of 1927 (South Zone).

NOTE: The above description of the tract nominated for lease has been provided exclusively by the party nominating the tract for lease.

Maps depicting the nominated tract, containing the bearings, distances and coordinates of the nominated tract based on the Louisiana Coordinate System of 1927, North or South Zone, as applicable, are available for public inspection and review at the offices of the Louisiana State Mineral Board from 10:00 a.m. to 3:00 p.m. Monday - Friday.

Any mineral lease selected from the nominated tract and awarded by the Louisiana State Mineral Board shall be without warranty of any kind, either express, implied, or statutory, including, but not limited to, the implied warranties or merchantability and fitness for a particular purpose. Should the mineral lease awarded by the Louisiana State Mineral Board be subsequently modified, cancelled or abrogated due to the existence of conflicting leases, operating agreements, private claims or other existing or future obligations or conditions which may affect all or any portion of the leased tract, it shall not relieve the Lessee of the obligation to pay any bonus due thereon to the Louisiana State Mineral Board, nor shall the Louisiana State Mineral Board be obligated to refund any consideration paid by the Lessee prior to such modification, cancellation, or abrogation, including, but not limited to, bonuses, rents and royalties.

NOTE: The Department of Wildlife and Fisheries has designated certain areas in the coastal waters of the State of Louisiana as Oyster Seed Bed

Areas. The exact location of those Seed Bed Areas must be obtained from Wildlife and Fisheries and any work done under an oil, gas and other liquid or gaseous mineral lease from the State of Louisiana must be conducted in conformity with the rules and regulations promulgated by the said Department of Wildlife and Fisheries for Oyster Seed Bed Areas.

NOTE: The State of Louisiana does hereby reserve, and this lease shall be subject to, the imprescriptible right of surface use in the nature of a servitude in favor of the Department of Natural Resources and/or the Louisiana Department of Wildlife and Fisheries, including its Offices and Commissions, for the sole purpose of implementing, constructing, servicing and maintaining approved coastal zone management and/or restoration projects. Utilization of any and all rights derived under this lease by the mineral lessee, its agents, successors or assigns, shall not interfere with nor hinder the reasonable surface use by the Department of Natural Resources and/or the Louisiana Department of Wildlife and Fisheries, its Offices or Commissions, as hereinabove reserved.

Applicant: Southern Oil & Gas Company, Inc.

36

BLK. 44

BLK. 43

P.O.B.

X= 2,635,350.00'  
Y= 410,830.00'

5

6

X<sup>2</sup>

WJL  
01  
02  
03  
04  
05  
06  
07  
08  
09  
10  
11  
12  
13  
14  
15  
16  
17  
18  
19  
20  
21  
22  
23  
24  
25  
26  
27  
28  
29  
30  
31  
32  
33  
34  
35  
36  
37  
38  
39  
40  
41  
42  
43  
44  
45  
46  
47  
48  
49  
50  
51  
52  
53  
54  
55  
56  
57  
58  
59  
60  
61  
62  
63  
64  
65  
66  
67  
68  
69  
70  
71  
72  
73  
74  
75  
76  
77  
78  
79  
80  
81  
82  
83  
84  
85  
86  
87  
88  
89  
90  
91  
92  
93  
94  
95  
96  
97  
98  
99  
100

CHANDELEUR SOUND AREA

ELIOT BAY OIL FIELD

TR 34657  
450 ± ACS.  
JULY, 2002

Platform

TREASURE BAY

7

8

rx

Codfish Point

Δ Codfish Point

BLK. 50

17

BLK. 49

S.L. 2221

ST BERNARD PARISH  
CHANDELEUR SOUND AREA

378

2000' 0' 2000'

**TRACT 34658 - PORTION OF BLOCK 49, CHANDELEUR SOUND AREA, St. Bernard Parish, Louisiana**

All of the lands now or formerly constituting the beds and bottoms of all water bodies of every nature and description and all islands and other lands formed by accretion or reliction, except tax lands, belonging to the State of Louisiana and not under mineral lease on July 10, 2002, situated in St. Bernard Parish, Louisiana, and more particularly described as follows: Beginning at the Southeast corner of Block 49, Chandeleur Sound Area, having Coordinates of X = 2,635,350.00 and Y = 396,080.00; thence West 2,500.00 feet along the South boundary of said Block 49 to the Southeast corner of State Lease 2221, as amended, having Coordinates of X = 2,632,850.00 and Y = 396,080.00; thence along the Eastern boundary of said State Lease 2221 the following courses: North 01 degrees 16 minutes 23 seconds West 4,501.11 feet to a point having Coordinates of X = 2,632,750.00 and Y = 400,580.00; North 08 degrees 44 minutes 46 seconds West 1,315.30 feet to a point having Coordinates of X = 2,632,550.00 and Y = 401,880.00; thence North 1,575.00 feet to a point having Coordinates of X = 2,632,550.00 and Y = 403,455.00; thence East 2,800.00 feet to a point on the East boundary of said Block 49 having Coordinates of X = 2,635,350.00 and Y = 403,455.00; thence South 7,375.00 feet along the said East boundary of Block 49 to the point of beginning, containing approximately **445.25 acres**, as shown outlined on a plat on file in the Office of Mineral Resources, Department of Natural Resources, as provided by the applicant. All bearings, distances and coordinates are based on Louisiana Coordinate System of 1927 (South Zone).

NOTE: The above description of the tract nominated for lease has been provided exclusively by the party nominating the tract for lease.

Maps depicting the nominated tract, containing the bearings, distances and coordinates of the nominated tract based on the Louisiana Coordinate System of 1927, North or South Zone, as applicable, are available for public inspection and review at the offices of the Louisiana State Mineral Board from 10:00 a.m. to 3:00 p.m. Monday - Friday.

Any mineral lease selected from the nominated tract and awarded by the Louisiana State Mineral Board shall be without warranty of any kind, either express, implied, or statutory, including, but not limited to, the implied warranties or merchantability and fitness for a particular purpose. Should the mineral lease awarded by the Louisiana State Mineral Board be subsequently modified, cancelled or abrogated due to the existence of conflicting leases, operating agreements, private claims or other existing or future obligations or conditions which may affect all or any portion of the leased tract, it shall not relieve the Lessee of the obligation to pay any bonus due thereon to the Louisiana State Mineral Board, nor shall the Louisiana State Mineral Board be obligated to refund any consideration paid by the Lessee prior to such modification,

cancellation, or abrogation, including, but not limited to, bonuses, rents and royalties.

NOTE: The Department of Wildlife and Fisheries has designated certain areas in the coastal waters of the State of Louisiana as Oyster Seed Bed Areas. The exact location of those Seed Bed Areas must be obtained from Wildlife and Fisheries and any work done under an oil, gas and other liquid or gaseous mineral lease from the State of Louisiana must be conducted in conformity with the rules and regulations promulgated by the said Department of Wildlife and Fisheries for Oyster Seed Bed Areas.

NOTE: The State of Louisiana does hereby reserve, and this lease shall be subject to, the imprescriptible right of surface use in the nature of a servitude in favor of the Department of Natural Resources and/or the Louisiana Department of Wildlife and Fisheries, including its Offices and Commissions, for the sole purpose of implementing, constructing, servicing and maintaining approved coastal zone management and/or restoration projects. Utilization of any and all rights derived under this lease by the mineral lessee, its agents, successors or assigns, shall not interfere with nor hinder the reasonable surface use by the Department of Natural Resources and/or the Louisiana Department of Wildlife and Fisheries, its Offices or Commissions, as hereinabove reserved.

Applicant: Southern Oil & Gas, Company, Inc.

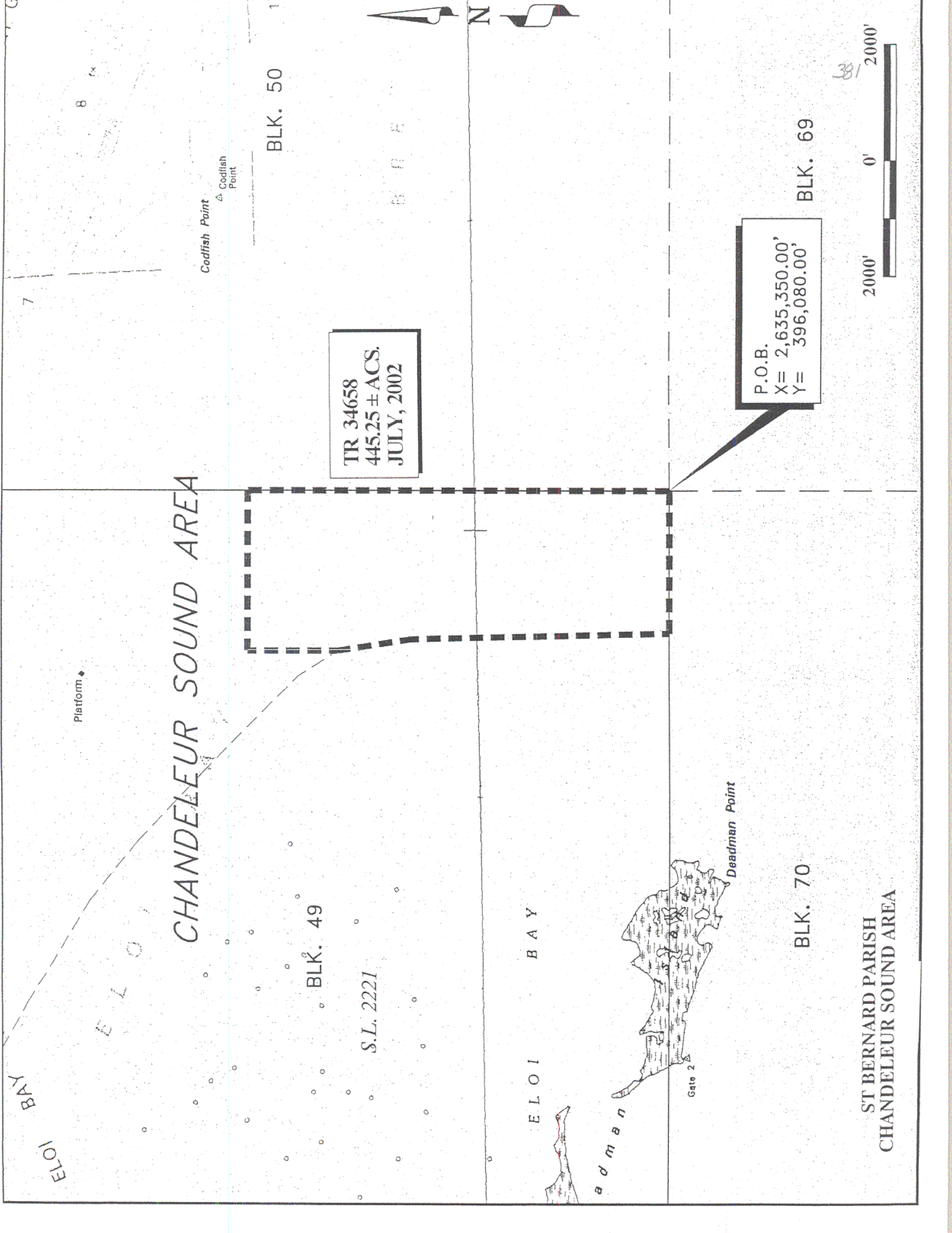

TR 34658  
445.25 ± ACS.  
JULY, 2002

P.O.B.  
X= 2,635,350.00'  
Y= 396,080.00'

ST BERNARD PARISH  
CHANDELEUR SOUND AREA

**TRACT 34659 - PORTION OF BLOCK 70, CHANDELEUR SOUND AREA, St. Bernard Parish, Louisiana**

All of the lands now or formerly constituting the beds and bottoms of all water bodies of every nature and description and all islands and other lands formed by accretion or reliction, except tax lands, belonging to the State of Louisiana and not under mineral lease on July 10, 2002, situated in St. Bernard Parish, Louisiana, and more particularly described as follows: Beginning at the Northeast corner of Block 70, Chandeleur Sound Area, having Coordinates of X = 2,635,350.00 and Y = 396,080.00; thence South 7,375.00 feet along the East line of said Block 70, Chandeleur Sound Area, to the Northeast corner of State Lease No. 16798 having Coordinates of X = 2,635,350.00 and Y = 388,705.00; thence West 4,332.00 feet along the North line of said State Lease No. 16798 to its Northwest corner having Coordinates of X = 2,631,018.00 and Y = 388,705.00; thence South 1,609.00 feet along the West line of said State Lease No. 16798 to its Southwest corner, said corner also being a point on the North line of State Lease No. 16866, having Coordinates of X = 2,631,018.00 and Y = 387,096.00; thence West 3,331.00 feet along the North line of said State Lease No. 16866 to its Northwest corner having Coordinates of X = 2,627,687.00 and Y = 387,096.00; thence North 2,922.65 feet to a point on the South line of an Operating Agreement, identified as A0124, having Coordinates of X = 2,627,687.00 and Y = 390,018.65; thence East 493.00 feet along the South line of said A0124 to its Southeast corner having Coordinates of X = 2,628,180.00 and Y = 390,018.65; thence North 1,700.00 feet along the East line of said A0124 to its Northeast corner having Coordinates of X = 2,628,180.00 and Y = 391,718.65; thence West 493.00 feet along the North line of said A0124 to a point having Coordinates of X = 2,627,687.00 and Y = 391,718.65; thence North 4,361.35 feet to a point on the North line of said Block 70, Chandeleur Sound Area, having Coordinates of X = 2,627,687.00 and Y = 396,080.00; thence East 7,663.00 feet along the North line of said Block 70, Chandeleur Sound Area, to the point of beginning, containing approximately **1,401.20 acres**, as shown outlined on a plat on file in the Office of Mineral Resources, Department of Natural Resources, as provided by the applicant. All bearings, distances and coordinates are based on Louisiana Coordinate System of 1927 (South Zone).

NOTE: The above description of the tract nominated for lease has been provided exclusively by the party nominating the tract for lease.

Maps depicting the nominated tract, containing the bearings, distances and coordinates of the nominated tract based on the Louisiana Coordinate System of 1927, North or South Zone, as applicable, are available for public inspection and review at the offices of the Louisiana State Mineral Board from 10:00 a.m. to 3:00 p.m. Monday - Friday.

Any mineral lease selected from the nominated tract and awarded by the Louisiana State Mineral Board shall be without warranty of any kind, either express, implied, or statutory, including, but not limited to, the implied warranties or merchantability and fitness for a particular purpose. Should the mineral lease awarded by the Louisiana State Mineral Board be subsequently modified, cancelled or abrogated due to the existence of conflicting leases, operating agreements, private claims or other existing or future obligations or conditions which may affect all or any portion of the leased tract, it shall not relieve the Lessee of the obligation to pay any bonus due thereon to the Louisiana State Mineral Board, nor shall the Louisiana State Mineral Board be obligated to refund any consideration paid by the Lessee prior to such modification, cancellation, or abrogation, including, but not limited to, bonuses, rents and royalties.

NOTE: The Department of Wildlife and Fisheries has designated certain areas in the coastal waters of the State of Louisiana as Oyster Seed Bed Areas. The exact location of those Seed Bed Areas must be obtained from Wildlife and Fisheries and any work done under an oil, gas and other liquid or gaseous mineral lease from the State of Louisiana must be conducted in conformity with the rules and regulations promulgated by the said Department of Wildlife and Fisheries for Oyster Seed Bed Areas.

NOTE: The State of Louisiana does hereby reserve, and this lease shall be subject to, the imprescriptible right of surface use in the nature of a servitude in favor of the Department of Natural Resources and/or the Louisiana Department of Wildlife and Fisheries, including its Offices and Commissions, for the sole purpose of implementing, constructing, servicing and maintaining approved coastal zone management and/or restoration projects. Utilization of any and all rights derived under this lease by the mineral lessee, its agents, successors or assigns, shall not interfere with nor hinder the reasonable surface use by the Department of Natural Resources and/or the Louisiana Department of Wildlife and Fisheries, its Offices or Commissions, as hereinabove reserved.

Applicant: PT Oil & Gas



384

Blk. 48

Blk. 49

Blk. 50

P.O.B.

X = 2,635,350.00  
Y = 396,080.00

MEXICO

TR 34659  
1,401.20 ± ACS.  
JULY, 2002

A0124

OF

NAD 1927 (South Zone)

Blk. 71

Blk. 70

Blk. 69

S. L. 16798

S. L. 16866

GULF

CHANDELEUR SOUND AREA

MAIN PASS AREA, REVISED

Blk. 3

Blk. 4

Blk. 1

BRETON SOUND AREA

ST. BERNARD

PARISH,

LOUISIANA

SCALE : 1" = 3000'

**TRACT 34660 - PORTION OF BLOCK 50, CHANDELEUR SOUND AREA, St. Bernard Parish, Louisiana**

All of the lands now or formerly constituting the beds and bottoms of all water bodies of every nature and description and all islands and other lands formed by accretion or reliction, except tax lands, belonging to the State of Louisiana and not under mineral lease on July 10, 2002, situated in St. Bernard Parish, Louisiana, and more particularly described as follows: Beginning at the Northwest corner of Block 50, Chandeleur Sound Area, having Coordinates of X = 2,635,350.00 and Y = 410,830.00; thence East 2,800.00 feet along the North boundary of said Block 50 to a point having Coordinates of X = 2,638,150.00 and Y = 410,830.00; thence South 7,375.00 feet to a point having Coordinates of X = 2,638,150.00 and Y = 403,455.00; thence West 2,800.00 feet to a point on the West boundary of said Block 50 having Coordinates of X = 2,635,350.00 and Y = 403,455.00; thence North 7,375.00 feet along the said West boundary of Block 50 to the point of beginning, containing approximately **347 acres**, as shown outlined on a plat on file in the Office of Mineral Resources, Department of Natural Resources, as provided by the applicant. All bearings, distances and coordinates are based on Louisiana Coordinate System of 1927 (South Zone).

NOTE: The above description of the tract nominated for lease has been provided exclusively by the party nominating the tract for lease.

Maps depicting the nominated tract, containing the bearings, distances and coordinates of the nominated tract based on the Louisiana Coordinate System of 1927, North or South Zone, as applicable, are available for public inspection and review at the offices of the Louisiana State Mineral Board from 10:00 a.m. to 3:00 p.m. Monday - Friday.

Any mineral lease selected from the nominated tract and awarded by the Louisiana State Mineral Board shall be without warranty of any kind, either express, implied, or statutory, including, but not limited to, the implied warranties or merchantability and fitness for a particular purpose. Should the mineral lease awarded by the Louisiana State Mineral Board be subsequently modified, cancelled or abrogated due to the existence of conflicting leases, operating agreements, private claims or other existing or future obligations or conditions which may affect all or any portion of the leased tract, it shall not relieve the Lessee of the obligation to pay any bonus due thereon to the Louisiana State Mineral Board, nor shall the Louisiana State Mineral Board be obligated to refund any consideration paid by the Lessee prior to such modification, cancellation, or abrogation, including, but not limited to, bonuses, rents and royalties.

NOTE: The Department of Wildlife and Fisheries has designated certain areas in the coastal waters of the State of Louisiana as Oyster Seed Bed

Areas. The exact location of those Seed Bed Areas must be obtained from Wildlife and Fisheries and any work done under an oil, gas and other liquid or gaseous mineral lease from the State of Louisiana must be conducted in conformity with the rules and regulations promulgated by the said Department of Wildlife and Fisheries for Oyster Seed Bed Areas.

NOTE: The State of Louisiana does hereby reserve, and this lease shall be subject to, the imprescriptible right of surface use in the nature of a servitude in favor of the Department of Natural Resources and/or the Louisiana Department of Wildlife and Fisheries, including its Offices and Commissions, for the sole purpose of implementing, constructing, servicing and maintaining approved coastal zone management and/or restoration projects. Utilization of any and all rights derived under this lease by the mineral lessee, its agents, successors or assigns, shall not interfere with nor hinder the reasonable surface use by the Department of Natural Resources and/or the Louisiana Department of Wildlife and Fisheries, its Offices or Commissions, as hereinabove reserved.

Applicant: Southern Oil & Gas Company, Inc.

BLK. 43

BLK. 44

BLK. 50

BLK. 49

S.L. 2221

ST BERNARD PARISH  
CHANDELEUR SOUND AREA

CHANDELEUR SOUND AREA

P.O.B.  
X= 2,635,350.00'  
Y= 410,830.00'

TR 34660  
347 ± ACS.  
JULY, 2002

Platform ♦

Codfish Point  
▲ Codfish Point

TREASURE BAY GAS FIELD



387

2000' 0' 2000'



**TRACT 34661 - PORTION OF BLOCK 69, CHANDELEUR SOUND AREA, St. Bernard Parish, Louisiana**

All of the lands now or formerly constituting the beds and bottoms of all water bodies of every nature and description and all islands and other lands formed by accretion or reliction, except tax lands, belonging to the State of Louisiana and not under mineral lease on July 10, 2002, situated in St. Bernard Parish, Louisiana, and more particularly described as follows: Beginning at the Northwest corner of Block 69, Chandeleur Sound Area, having Coordinates of X = 2,635,350.00 and Y = 396,080.00; thence East 7,375.00 feet along the North line of said Block 69, Chandeleur Sound Area, to a point having Coordinates of X = 2,642,725.00 and Y = 396,080.00; thence South 8,703.65 feet to a point on the Northern boundary of State Lease No. 16799 having Coordinates of X = 2,642,725.00 and Y = 387,376.35; thence West 5,721.00 feet along the Northern boundary of said State Lease No. 16799 to an interior corner having Coordinates of X = 2,637,004.00 and Y = 387,376.35; thence North 1,328.65 feet along the Northern boundary of said State Lease No. 16799 to its most Northerly Northeast corner having Coordinates of X = 2,637,004.00 and Y = 388,705.00; thence West 1,654.00 feet along the Northern boundary of said State Lease No. 16799 to its Northwest corner, said corner also being a point on the West line of said Block 69, Chandeleur Sound Area, having Coordinates of X = 2,635,350.00 and Y = 388,705.00; thence North 7,375.00 feet along the West line of said Block 70, Chandeleur Sound Area, to the point of beginning, containing approximately **1,423.14 acres**, as shown outlined on a plat on file in the Office of Mineral Resources, Department of Natural Resources, as provided by the applicant. All bearings, distances and coordinates are based on Louisiana Coordinate System of 1927 (South Zone).

NOTE: The above description of the tract nominated for lease has been provided exclusively by the party nominating the tract for lease.

Maps depicting the nominated tract, containing the bearings, distances and coordinates of the nominated tract based on the Louisiana Coordinate System of 1927, North or South Zone, as applicable, are available for public inspection and review at the offices of the Louisiana State Mineral Board from 10:00 a.m. to 3:00 p.m. Monday - Friday.

Any mineral lease selected from the nominated tract and awarded by the Louisiana State Mineral Board shall be without warranty of any kind, either express, implied, or statutory, including, but not limited to, the implied warranties or merchantability and fitness for a particular purpose. Should the mineral lease awarded by the Louisiana State Mineral Board be subsequently modified, cancelled or abrogated due to the existence of conflicting leases, operating agreements, private claims or other existing or future obligations or conditions which may affect all or any portion of the leased tract, it shall not relieve the Lessee of the

obligation to pay any bonus due thereon to the Louisiana State Mineral Board, nor shall the Louisiana State Mineral Board be obligated to refund any consideration paid by the Lessee prior to such modification, cancellation, or abrogation, including, but not limited to, bonuses, rents and royalties.

NOTE: The Department of Wildlife and Fisheries has designated certain areas in the coastal waters of the State of Louisiana as Oyster Seed Bed Areas. The exact location of those Seed Bed Areas must be obtained from Wildlife and Fisheries and any work done under an oil, gas and other liquid or gaseous mineral lease from the State of Louisiana must be conducted in conformity with the rules and regulations promulgated by the said Department of Wildlife and Fisheries for Oyster Seed Bed Areas.

NOTE: The State of Louisiana does hereby reserve, and this lease shall be subject to, the imprescriptible right of surface use in the nature of a servitude in favor of the Department of Natural Resources and/or the Louisiana Department of Wildlife and Fisheries, including its Offices and Commissions, for the sole purpose of implementing, constructing, servicing and maintaining approved coastal zone management and/or restoration projects. Utilization of any and all rights derived under this lease by the mineral lessee, its agents, successors or assigns, shall not interfere with nor hinder the reasonable surface use by the Department of Natural Resources and/or the Louisiana Department of Wildlife and Fisheries, its Offices or Commissions, as hereinabove reserved.

Applicant: PT Oil & Gas

390

Blk. 49

Blk. 50

Blk. 51

P.O.B.  
X = 2,635,350.00  
Y = 396,080.00

MEXICO

S.L. 17004

TR 34661  
1,423.14 ± ACS.  
JULY, 2002

OF

NAD 1927 (South Zone)

Blk. 70

Blk. 69

Blk. 68

S.L. 16799

GULF

CHANDELEUR SOUND AREA

BRETON SOUND AREA

Blk. 4

MAIN PASS  
AREA, REVISED

Blk. 1

Blk. 2

ST. BERNARD PARISH, LOUISIANA

SCALE : 1" = 3000'

**TRACT 34662 - PORTION OF BLOCK 19, BRETON SOUND AREA, Plaquemines Parish, Louisiana**

All of the lands now or formerly constituting the beds and bottoms of all water bodies of every nature and description and all islands and other lands formed by accretion or reliction, except tax lands, belonging to the State of Louisiana and not under mineral lease on July 10, 2002, situated in Plaquemines Parish, Louisiana, and more particularly described as follows: Beginning at a point having Coordinates of X = 2,664,850.00 and Y = 351,830.00, said point also being the Northwest corner of Block 19, Breton Sound Area; thence East 14,750.00 feet on and along the North line of said Block 19, Breton Sound Area, to a point having Coordinates of X = 2,679,600.00 and Y = 351,830.00, said point also being the Northeast corner of said Block 19, Breton Sound Area; thence South 7,375.00 feet on and along the East line of said Block 19, Breton Sound Area, to a point having Coordinates of X = 2,679,600.00 and Y = 344,455.00; thence West 5,082.30 feet to a point having Coordinates of X = 2,674,517.70 and Y = 344,455.00, said point also being on the Northern boundary of State of Louisiana - State Lease No. 16612; thence West 317.70 feet on and along said Northern boundary of State of Louisiana - State Lease No. 16612 to a point having Coordinates of X = 2,674,200.00 and Y = 344,455.00, said point also being on the Eastern boundary of State of Louisiana - State Lease No. 17346; thence on and along the Eastern, Northern and Western boundaries of said State of Louisiana - State Lease No. 17346, the Southern, Eastern and Northern boundaries of State of Louisiana - State Lease No. 16823, the Northern boundary of State of Louisiana - State Lease No. 16610, and the Eastern and Northern boundaries of State of Louisiana - State Lease No. 16824 the following courses and distances, to-wit: North 1,375.00 feet to a point having Coordinates of X = 2,674,200.00 and Y = 345,830.00; East 4,000.00 feet to a point having Coordinates of X = 2,678,200.00 and Y = 345,830.00; North 19 degrees 05 minutes 37 seconds West 2,751.36 feet to a point having Coordinates of X = 2,677,300.00 and Y = 348,430.00; West 3,100.00 feet to a point having Coordinates of X = 2,674,200.00 and Y = 348,430.00; North 297.00 feet to a point having Coordinates of X = 2,674,200.00 and Y = 348,727.00; West 3,550.00 feet to a point having Coordinates of X = 2,670,650.00 and Y = 348,727.00; South 4,272.00 feet to a point having Coordinates of X = 2,670,650.00 and Y = 344,455.00; West 1,800.00 feet to a point having Coordinates of X = 2,668,850.00 and Y = 344,455.00; North 10 degrees 19 minutes 37 seconds West 4,725.00 feet to a point having Coordinates of X = 2,668,002.96 and Y = 349,103.46; and North 78 degrees 19 minutes 28 seconds West 3,219.58 feet to a point having Coordinates of X = 2,664,850.00 and Y = 349,755.00, said point also being on the West line of said Block 19, Breton Sound Area; thence North 2,075.00 feet on and along said West line of said Block 19, Breton Sound Area, to the point of beginning, containing approximately **1,531.99 acres**, as shown outlined on a plat on file in the Office of



Mineral Resources, Department of Natural Resources, as provided by the applicant. All bearings, distances and coordinates are based on Louisiana Coordinate System of 1927 (South Zone).

NOTE: The above description of the tract nominated for lease has been provided exclusively by the party nominating the tract for lease.

Maps depicting the nominated tract, containing the bearings, distances and coordinates of the nominated tract based on the Louisiana Coordinate System of 1927, North or South Zone, as applicable, are available for public inspection and review at the offices of the Louisiana State Mineral Board from 10:00 a.m. to 3:00 p.m. Monday - Friday.

Any mineral lease selected from the nominated tract and awarded by the Louisiana State Mineral Board shall be without warranty of any kind, either express, implied, or statutory, including, but not limited to, the implied warranties or merchantability and fitness for a particular purpose. Should the mineral lease awarded by the Louisiana State Mineral Board be subsequently modified, cancelled or abrogated due to the existence of conflicting leases, operating agreements, private claims or other existing or future obligations or conditions which may affect all or any portion of the leased tract, it shall not relieve the Lessee of the obligation to pay any bonus due thereon to the Louisiana State Mineral Board, nor shall the Louisiana State Mineral Board be obligated to refund any consideration paid by the Lessee prior to such modification, cancellation, or abrogation, including, but not limited to, bonuses, rents and royalties.

NOTE: The State of Louisiana does hereby reserve, and this lease shall be subject to, the imprescriptible right of surface use in the nature of a servitude in favor of the Department of Natural Resources and/or the Louisiana Department of Wildlife and Fisheries, including its Offices and Commissions, for the sole purpose of implementing, constructing, servicing and maintaining approved coastal zone management and/or restoration projects. Utilization of any and all rights derived under this lease by the mineral lessee, its agents, successors or assigns, shall not interfere with nor hinder the reasonable surface use by the Department of Natural Resources and/or the Louisiana Department of Wildlife and Fisheries, its Offices or Commissions, as hereinabove reserved.

Applicant: Robert A. Schroeder, Inc.

BLOCK 14

Texas General Pet.

2 SL 8974

SL 16445

EAST 14750.00'

TR 34662  
1,531.99 ± ACS.  
JULY, 2002

X = 2,679,600  
Y = 351,830

13

BLOCK 20

SL 16615

29

15

BLOCK 18

SL 16658

31

P.O.B.  
X = 2,664,850  
Y = 351,830

X = 2,664,850  
Y = 349,755

X = 2,668,002.96  
Y = 349,103.46

X = 2,670,650  
Y = 348,727

X = 2,674,200  
Y = 348,727

X = 2,677,300  
Y = 348,430

X = 2,678,200  
Y = 345,830

X = 2,679,600  
Y = 344,455

X = 2,670,650  
Y = 344,455

X = 2,674,200  
Y = 345,830

X = 2,668,850  
Y = 344,455

X = 2,674,200  
Y = 344,455

SL 16824

SL 17346

SL 16823

Texas Gas Expl.  
SL 5823

Samedan Oil Corp.  
SL 13252

Ripco  
SL 13063

Kerr McGee  
SL 1220

Ranger Oil  
SL 7002

Shoreline Exp  
SL 3196

Kerr McGee  
SL 4181

Mosbacher R.  
SL 4181

Gulf  
SL 3196

Pel Tex  
SL 4181

SL 16611

AHC  
SL 10950

Strata  
SL 9655

Texas Crude  
SL 3829

SL 16613  
Ocean Drilg. & Expl.  
SL 4406

MRGO FAIRWAY  
SL 16614

BLOCK 30

16444

CHANDELEUR SOUND

BLOCK 19  
BRETON SOUND AREA

LOCATED IN  
BLOCK 19  
BRETON SOUND AREA  
PLAQUEMINES PARISH, LOUISIANA  
SCALE 1" = 2000'



ALL COORDINATES, BEARINGS AND DISTANCES  
ARE GRID, AND ARE ON THE LOUISIANA  
LAMBERT PLANE COORDINATE SYSTEM,  
SOUTH ZONE, 1927 NORTH AMERICAN  
DATUM.

**TRACT 34663 - PORTION OF BLOCK 19, BRETON SOUND AREA, Plaquemines Parish, Louisiana**

All of the lands now or formerly constituting the beds and bottoms of all water bodies of every nature and description and all islands and other lands formed by accretion or reliction, except tax lands, belonging to the State of Louisiana and not under mineral lease on July 10, 2002, situated in Plaquemines Parish, Louisiana, and more particularly described as follows: Beginning at a point having Coordinates of X = 2,675,700.00 and Y = 337,080.00, said point being on the South line of Block 19, Breton Sound Area, said point also being on the Western boundary of State of Louisiana - State Lease No. 16612; thence West 5,050.00 feet on and along the South line of said Block 19, Breton Sound Area, to a point having Coordinates of X = 2,670,650.00 and Y = 337,080.00, said point also being on the Eastern boundary of State of Louisiana - State Lease No. 16610; thence North 7,375.00 feet on and along said Eastern boundary of said State of Louisiana - State Lease No. 16610 to a point having Coordinates of X = 2,670,650.00 and Y = 344,455.00, said point also being on the Southern boundary of State of Louisiana - State Lease No. 17346; thence East 2,219.00 feet on and along said Southern boundary of said State of Louisiana - State Lease No. 17346 to a point having Coordinates of X = 2,672,869.00 and Y = 344,455.00, said point also being on said Western boundary of said State of Louisiana - State Lease No. 16612; thence South 21 degrees 00 minutes 00 seconds East 7,899.69 feet on and along said Western boundary of State of Louisiana - State Lease No. 16612 to the point of beginning, containing approximately **615.35 acres**, as shown outlined on a plat on file in the Office of Mineral Resources, Department of Natural Resources, as provided by the applicant. All bearings, distances and coordinates are based on Louisiana Coordinate System of 1927 (South Zone).

NOTE: The above description of the tract nominated for lease has been provided exclusively by the party nominating the tract for lease.

Maps depicting the nominated tract, containing the bearings, distances and coordinates of the nominated tract based on the Louisiana Coordinate System of 1927, North or South Zone, as applicable, are available for public inspection and review at the offices of the Louisiana State Mineral Board from 10:00 a.m. to 3:00 p.m. Monday - Friday.

Any mineral lease selected from the nominated tract and awarded by the Louisiana State Mineral Board shall be without warranty of any kind, either express, implied, or statutory, including, but not limited to, the implied warranties or merchantability and fitness for a particular purpose. Should the mineral lease awarded by the Louisiana State Mineral Board be subsequently modified, cancelled or abrogated due to the existence of conflicting leases, operating agreements, private claims or other existing or future obligations or conditions which may affect all or

any portion of the leased tract, it shall not relieve the Lessee of the obligation to pay any bonus due thereon to the Louisiana State Mineral Board, nor shall the Louisiana State Mineral Board be obligated to refund any consideration paid by the Lessee prior to such modification, cancellation, or abrogation, including, but not limited to, bonuses, rents and royalties.

NOTE: It appears, according to our records, that a portion of this tract is located within the restrictive safety fairway area as set out by the Corps of Engineers, U.S. Army and/or the restrictive anchorage area as set out by the U.S. Coast Guard.

NOTE: The State of Louisiana does hereby reserve, and this lease shall be subject to, the imprescriptible right of surface use in the nature of a servitude in favor of the Department of Natural Resources and/or the Louisiana Department of Wildlife and Fisheries, including its Offices and Commissions, for the sole purpose of implementing, constructing, servicing and maintaining approved coastal zone management and/or restoration projects. Utilization of any and all rights derived under this lease by the mineral lessee, its agents, successors or assigns, shall not interfere with nor hinder the reasonable surface use by the Department of Natural Resources and/or the Louisiana Department of Wildlife and Fisheries, its Offices or Commissions, as hereinabove reserved.

Applicant: Robert A. Schroeder, Inc.

BLOCK 14

Texas General Pet.  
2-0 SL 8974

SL 16445

13

# BLOCK 19 BRETON SOUND AREA

## CHANDELEUR SOUND

396

Deeco  
SL 4127

SL 16824

National Energy Group, Inc.

Texas Gas Expl.  
SL 5823

SL 17346

Samedan Oil Corp.  
SL 13252Ripco  
SL 13063

SL 16823

X = 2,670,650.00  
Y = 344,455.00X = 2,672,869.00  
Y = 344,455.00

EAST

2219.00'

Kerr McGee  
SL 1220

1B

Oil & Gas Futures  
SL 4127

SL 16610

Kerr McGee  
SL 4181

SL 16612

1 Ranger Oil  
SL 7002Shoreline Exp  
SL 3196

TR 34663  
615.35 ± ACS.  
JULY, 2002

SL 16443

LLOG  
SL 16443  
O 2Texas Crude  
SL 3829LLOG  
SL 16443

SL 16613

Ocean Drilg. & Expl.  
SL 4406X = 2,670,650.00  
Y = 337,080.00

P.O.B.

X = 2,675,700.00  
Y = 337,080.00WEST  
5050.00'Gulf  
SL 3196Pel Tex  
SL 4181SL  
16611Llog  
SL 10950Strata  
SL 9655Ripco  
SL 12596MRGO  
FAIRWAY

SL 16614

BLOCK 30

16444

BLOCK 20

SL 16615

29

LOCATED IN  
BLOCK 19  
BRETON SOUND AREA  
PLAQUEMINES PARISH, LOUISIANA  
SCALE 1" = 2000'

ALL COORDINATES, BEARINGS AND DISTANCES  
ARE GRID, AND ARE ON THE LOUISIANA  
LAMBERT PLANE COORDINATE SYSTEM,  
SOUTH ZONE, 1927 NORTH AMERICAN  
DATUM.



**TRACT 34664 - PORTION OF BLOCK 19, BRETON SOUND AREA, Plaquemines Parish, Louisiana**

All of the lands now or formerly constituting the beds and bottoms of all water bodies of every nature and description and all islands and other lands formed by accretion or reliction, except tax lands, belonging to the State of Louisiana and not under mineral lease on July 10, 2002, situated in Plaquemines Parish, Louisiana, and more particularly described as follows: Beginning at a point having Coordinates of X = 2,679,600.00 and Y = 337,080.00, said point also being the Southeast corner of Block 19, Breton Sound Area; thence West 2,580.00 feet on and along the South line of said Block 19, Breton Sound Area, to a point having Coordinates of X = 2,677,020.00 and Y = 337,080.00, said point also being on the Eastern boundary of State of Louisiana - State Lease No. 16612; thence on and along said Eastern boundary of said State of Louisiana - State Lease No. 16612 the following courses and distances, to-wit: North 07 degrees 00 minutes 00 seconds West 4,300.00 feet to a point having Coordinates of X = 2,676,495.96 and Y = 341,347.95; and North 32 degrees 29 minutes 06 seconds West 3,683.38 feet to a point having Coordinates of X = 2,674,517.70 and Y = 344,455.00; thence East 5,082.30 feet to a point having Coordinates of X = 2,679,600.00 and Y = 344,455.00, said point also being on the East line of said Block 19, Breton Sound Area; thence South 2,985.00 feet on and along said East line of said Block 19, Breton Sound Area, to a point having Coordinates of X = 2,679,600.00 and Y = 341,470.00, said point also being on the Northern boundary of State of Louisiana - State Lease No. 16611; thence on and along the Northern, Western and Southern boundaries of said State of Louisiana - State Lease No. 16611 the following courses and distances, to-wit: West 1,700.00 feet to a point having Coordinates of X = 2,677,900.00 and Y = 341,470.00; South 3,150.00 feet to a point having Coordinates of X = 2,677,900.00 and Y = 338,320.00; and East 1,700.00 feet to a point having Coordinates of X = 2,679,600.00 and Y = 338,320.00, said point also being on the East line of said Block 19, Breton Sound Area; thence South 1,240.00 feet on and along said East line of said Block 19, Breton Sound Area, to the point of beginning, containing approximately **447.48 acres**, as shown outlined on a plat on file in the Office of Mineral Resources, Department of Natural Resources, as provided by the applicant. All bearings, distances and coordinates are based on Louisiana Coordinate System of 1927 (South Zone).

NOTE: The above description of the tract nominated for lease has been provided exclusively by the party nominating the tract for lease.

Maps depicting the nominated tract, containing the bearings, distances and coordinates of the nominated tract based on the Louisiana Coordinate System of 1927, North or South Zone, as applicable, are available for public inspection and review at the offices of the Louisiana State Mineral Board from 10:00 a.m. to 3:00 p.m. Monday - Friday.

Any mineral lease selected from the nominated tract and awarded by the Louisiana State Mineral Board shall be without warranty of any kind, either express, implied, or statutory, including, but not limited to, the implied warranties or merchantability and fitness for a particular purpose. Should the mineral lease awarded by the Louisiana State Mineral Board be subsequently modified, cancelled or abrogated due to the existence of conflicting leases, operating agreements, private claims or other existing or future obligations or conditions which may affect all or any portion of the leased tract, it shall not relieve the Lessee of the obligation to pay any bonus due thereon to the Louisiana State Mineral Board, nor shall the Louisiana State Mineral Board be obligated to refund any consideration paid by the Lessee prior to such modification, cancellation, or abrogation, including, but not limited to, bonuses, rents and royalties.

NOTE: The State of Louisiana does hereby reserve, and this lease shall be subject to, the imprescriptible right of surface use in the nature of a servitude in favor of the Department of Natural Resources and/or the Louisiana Department of Wildlife and Fisheries, including its Offices and Commissions, for the sole purpose of implementing, constructing, servicing and maintaining approved coastal zone management and/or restoration projects. Utilization of any and all rights derived under this lease by the mineral lessee, its agents, successors or assigns, shall not interfere with nor hinder the reasonable surface use by the Department of Natural Resources and/or the Louisiana Department of Wildlife and Fisheries, its Offices or Commissions, as hereinabove reserved.

Applicant: Robert A. Schroeder, Inc.



BLOCK 14

Texas General Pet.  
2 SL 8974

SL 16445

13

BLOCK 19  
BRETON SOUND AREA

CHANDELEUR SOUND

399

Deco  
SL 4127

SL 16824

National Energy Group, Inc.

Texas Gas Expl.  
SL 5823Samedan Oil Corp.  
SL 13252Ripco  
SL 13063

SL 16823

SL 17346

X = 2,674,517.70  
Y = 344,455.00X = 2,679,600  
Y = 344,455

EAST 5082.30'

Oil & Gas Futures  
SL 4127Kerr McGee  
SL 1220

SL 16610

SL 16443

AHC  
SL 16443  
O 2Texas Crude  
SL 3829

SL 16613

Ocean Drilg. & Expl.  
SL 4406Kerr McGee  
SL 4181X = 2,676,495.96  
Y = 341,347.95Mosbacher R.  
SL 4181Gulf  
SL 3196X = 2,677,900  
Y = 341,470TR 34664  
447.48 ± ACS.  
JULY, 2002X = 2,679,600  
Y = 341,470Pel Tex  
SL 4181  
SL 16611X = 2,677,900  
Y = 338,320

EAST 1700.00'

X = 2,679,600  
Y = 338,320Strata  
SL 9655  
WEST 2580.00'X = 2,677,020  
Y = 337,080X = 2,679,600  
Y = 337,080

SL 16614

BLOCK 30

16444

P.O.B.

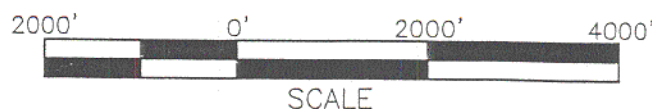
LOCATED IN  
BLOCK 19  
BRETON SOUND AREA  
PLAQUEMINES PARISH, LOUISIANA  
SCALE 1" = 2000'ALL COORDINATES, BEARINGS AND DISTANCES  
ARE GRID, AND ARE ON THE LOUISIANA  
LAMBERT PLANE COORDINATE SYSTEM,  
SOUTH ZONE, 1927 NORTH AMERICAN  
DATUM.

SCALE



**TRACT 34665 - PORTION OF BLOCK 41, CHANDELEUR SOUND AREA, ADDITION, REVISED, St. Bernard Parish, Louisiana**

All of the lands now or formerly constituting the beds and bottoms of all water bodies of every nature and description and all islands and other lands formed by accretion or reliction, except tax lands, belonging to the State of Louisiana and not under mineral lease on July 10, 2002, situated in St. Bernard Parish, Louisiana, and more particularly described as follows: Beginning at the Northeast corner of Block 41, Chandeleur Sound Area, Addition, Revised, having Coordinates of X = 2,709,100.00 and Y = 499,330.00; thence South 3,400.00 feet on the East line of said Block 41 to a point on the North line of Operating Agreement 249 having Coordinates of X = 2,709,100.00 and Y = 495,930.00; thence on the boundary of said Operating Agreement 249 the following courses: West 5,716.74 feet and South 3,975.00 feet to its Southwest corner having Coordinates of X = 2,703,383.26 and Y = 491,955.00; thence West 9,033.26 feet to a point on the West line of said Block 41 having Coordinates of X = 2,694,350.00 and Y = 491,955.00; thence North 7,375.00 feet on the West line of said Block 41 to its Northwest corner having Coordinates of X = 2,694,350.00 and Y = 499,330.00; thence East 14,750.00 feet to the point of beginning, containing approximately **1,975.60 acres**, as shown outlined on a plat on file in the Office of Mineral Resources, Department of Natural Resources, as provided by the applicant. All bearings, distances and coordinates are based on Louisiana Coordinate System of 1927 (South Zone).

NOTE: The above description of the tract nominated for lease has been provided exclusively by the party nominating the tract for lease.

Maps depicting the nominated tract, containing the bearings, distances and coordinates of the nominated tract based on the Louisiana Coordinate System of 1927, North or South Zone, as applicable, are available for public inspection and review at the offices of the Louisiana State Mineral Board from 10:00 a.m. to 3:00 p.m. Monday - Friday.

Any mineral lease selected from the nominated tract and awarded by the Louisiana State Mineral Board shall be without warranty of any kind, either express, implied, or statutory, including, but not limited to, the implied warranties or merchantability and fitness for a particular purpose. Should the mineral lease awarded by the Louisiana State Mineral Board be subsequently modified, cancelled or abrogated due to the existence of conflicting leases, operating agreements, private claims or other existing or future obligations or conditions which may affect all or any portion of the leased tract, it shall not relieve the Lessee of the obligation to pay any bonus due thereon to the Louisiana State Mineral Board, nor shall the Louisiana State Mineral Board be obligated to refund any consideration paid by the Lessee prior to such modification, cancellation, or abrogation, including, but not limited to, bonuses, rents and royalties.

NOTE: The Office of Mineral Resources will require a minimum bonus of \$130 per acre and a minimum royalty of 21%.

NOTE: The State of Louisiana does hereby reserve, and this lease shall be subject to, the imprescriptible right of surface use in the nature of a servitude in favor of the Department of Natural Resources and/or the Louisiana Department of Wildlife and Fisheries, including its Offices and Commissions, for the sole purpose of implementing, constructing, servicing and maintaining approved coastal zone management and/or restoration projects. Utilization of any and all rights derived under this lease by the mineral lessee, its agents, successors or assigns, shall not interfere with nor hinder the reasonable surface use by the Department of Natural Resources and/or the Louisiana Department of Wildlife and Fisheries, its Offices or Commissions, as hereinabove reserved.

Applicant: Christie G. O'Neal

402

Bik. 27

Bik. 28

Bik. 29

CHANDELEUR SOUND AREA  
ADDITION, REV.

P. O. B.  
X=2,709,100.00  
Y= 499,330.00

TR 34665  
1,975.60 ± ACS.  
JULY, 2002

OA 249

Bik. 42

Bik. 41

Bik. 40

GULF OF MEXICO

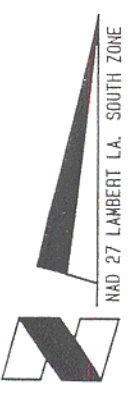

St. Bernard Parish, Louisiana

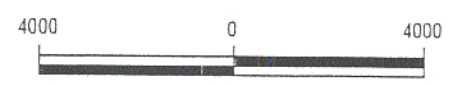

Scale in Feet

**TRACT 34666 - PORTION OF BLOCK 41, CHANDELEUR SOUND AREA, ADDITION, REVISED, St. Bernard Parish, Louisiana**

All of the lands now or formerly constituting the beds and bottoms of all water bodies of every nature and description and all islands and other lands formed by accretion or reliction, except tax lands, belonging to the State of Louisiana and not under mineral lease on July 10, 2002, situated in St. Bernard Parish, Louisiana, and more particularly described as follows: Beginning at a point on the East line of Block 41, Chandeleur Sound Area, Addition, Revised, also being a point on the South line of Operating Agreement 249 having Coordinates of X = 2,709,100.00 and Y = 491,955.00; thence South 7,375.00 feet on the East line of said Block 41 to its Southeast corner having Coordinates of X = 2,709,100.00 and Y = 484,580.00; thence West 14,750.00 feet on the South line of said Block 41 to its Southwest corner having Coordinates of X = 2,694,350.00 and Y = 484,580.00; thence North 7,375.00 feet on the West line of said Block 41 to a point having Coordinates of X = 2,694,350.00 and Y = 491,955.00; thence East 9,033.26 feet to the Southwest corner of said Operating Agreement 249 having Coordinates of X = 2,703,383.26 and Y = 491,955.00; thence East 5,716.74 feet to the point of beginning, containing approximately **2,497.27 acres**, as shown outlined on a plat on file in the Office of Mineral Resources, Department of Natural Resources, as provided by the applicant. All bearings, distances and coordinates are based on Louisiana Coordinate System of 1927 (South Zone).

NOTE: The above description of the tract nominated for lease has been provided exclusively by the party nominating the tract for lease.

Maps depicting the nominated tract, containing the bearings, distances and coordinates of the nominated tract based on the Louisiana Coordinate System of 1927, North or South Zone, as applicable, are available for public inspection and review at the offices of the Louisiana State Mineral Board from 10:00 a.m. to 3:00 p.m. Monday - Friday.

Any mineral lease selected from the nominated tract and awarded by the Louisiana State Mineral Board shall be without warranty of any kind, either express, implied, or statutory, including, but not limited to, the implied warranties or merchantability and fitness for a particular purpose. Should the mineral lease awarded by the Louisiana State Mineral Board be subsequently modified, cancelled or abrogated due to the existence of conflicting leases, operating agreements, private claims or other existing or future obligations or conditions which may affect all or any portion of the leased tract, it shall not relieve the Lessee of the obligation to pay any bonus due thereon to the Louisiana State Mineral Board, nor shall the Louisiana State Mineral Board be obligated to refund any consideration paid by the Lessee prior to such modification, cancellation, or abrogation, including, but not limited to, bonuses, rents and royalties.

NOTE: The Office of Mineral Resources will require a minimum bonus of \$130 per acre and a minimum royalty of 21%.

NOTE: The State of Louisiana does hereby reserve, and this lease shall be subject to, the imprescriptible right of surface use in the nature of a servitude in favor of the Department of Natural Resources and/or the Louisiana Department of Wildlife and Fisheries, including its Offices and Commissions, for the sole purpose of implementing, constructing, servicing and maintaining approved coastal zone management and/or restoration projects. Utilization of any and all rights derived under this lease by the mineral lessee, its agents, successors or assigns, shall not interfere with nor hinder the reasonable surface use by the Department of Natural Resources and/or the Louisiana Department of Wildlife and Fisheries, its Offices or Commissions, as hereinabove reserved.

Applicant: Christie G. O'Neal

465

Bik. 27

Bik. 28

Bik. 29

CHANDELEUR SOUND AREA  
ADDITION, REV.  
GULF OF MEXICO

OA 249

P. O. B.  
X=2,709,100.00  
Y= 491,955.00

Bik. 42

Bik. 41

Bik. 40

TR 34666  
2,497.27 ± ACS.  
JULY, 2002

NAD 27 LAMBERT LA. SOUTH ZONE

St. Bernard Parish, Louisiana



Scale in Feet

**TRACT 34667 - PORTION OF BLOCK 52, CHANDELEUR SOUND AREA, ADDITION, REVISED, St. Bernard Parish, Louisiana**

All of the lands now or formerly constituting the beds and bottoms of all water bodies of every nature and description and all islands and other lands formed by accretion or reliction, except tax lands, belonging to the State of Louisiana and not under mineral lease on July 10, 2002, situated in St. Bernard Parish, Louisiana, and more particularly described as follows: Beginning at a point on the East line of Block 52, Chandeleur Sound Area, Addition, Revised, having Coordinates of X = 2,709,100.00 and Y = 477,205.00; thence West 14,750.00 feet to a point on the West line of said Block 52 having Coordinates of X = 2,694,350.00 and Y = 477,205.00; thence North 7,375.00 feet on the West line of said Block 52 to its Northwest corner having Coordinates of X = 2,694,350.00 and Y = 484,580.00; thence East 14,750.00 feet on the North line of said Block 52 to its Northeast corner having Coordinates of X = 2,709,100.00 and Y = 484,580.00; thence South 7,375.00 feet to the point of beginning, containing approximately **2,497.27 acres**, as shown outlined on a plat on file in the Office of Mineral Resources, Department of Natural Resources, as provided by the applicant. All bearings, distances and coordinates are based on Louisiana Coordinate System of 1927 (South Zone).

NOTE: The above description of the tract nominated for lease has been provided exclusively by the party nominating the tract for lease.

Maps depicting the nominated tract, containing the bearings, distances and coordinates of the nominated tract based on the Louisiana Coordinate System of 1927, North or South Zone, as applicable, are available for public inspection and review at the offices of the Louisiana State Mineral Board from 10:00 a.m. to 3:00 p.m. Monday - Friday.

Any mineral lease selected from the nominated tract and awarded by the Louisiana State Mineral Board shall be without warranty of any kind, either express, implied, or statutory, including, but not limited to, the implied warranties or merchantability and fitness for a particular purpose. Should the mineral lease awarded by the Louisiana State Mineral Board be subsequently modified, cancelled or abrogated due to the existence of conflicting leases, operating agreements, private claims or other existing or future obligations or conditions which may affect all or any portion of the leased tract, it shall not relieve the Lessee of the obligation to pay any bonus due thereon to the Louisiana State Mineral Board, nor shall the Louisiana State Mineral Board be obligated to refund any consideration paid by the Lessee prior to such modification, cancellation, or abrogation, including, but not limited to, bonuses, rents and royalties.

NOTE: The Office of Mineral Resources will require a minimum bonus of \$130 per acre and a minimum royalty of 21%.

NOTE: The State of Louisiana does hereby reserve, and this lease shall be subject to, the imprescriptible right of surface use in the nature of a servitude in favor of the Department of Natural Resources and/or the Louisiana Department of Wildlife and Fisheries, including its Offices and Commissions, for the sole purpose of implementing, constructing, servicing and maintaining approved coastal zone management and/or restoration projects. Utilization of any and all rights derived under this lease by the mineral lessee, its agents, successors or assigns, shall not interfere with nor hinder the reasonable surface use by the Department of Natural Resources and/or the Louisiana Department of Wildlife and Fisheries, its Offices or Commissions, as hereinabove reserved.

Applicant: Christie G. O'Neal



Blk. 42

Blk. 41

Blk. 40

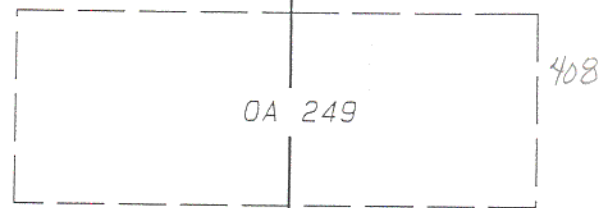

Blk. 51

TR 34667  
2,497.27 ± ACS.  
JULY, 2002

Blk. 53

Blk. 52

P. O. B.  
X=2,709,100.00  
Y= 477,205.00

GULF OF MEXICO  
CHANDELEUR SOUND AREA  
ADDITION, REV.

Blk. 5

CHANDELEUR SOUND AREA

Blk. 6

Blk. 7

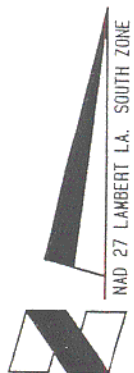

St. Bernard Parish, Louisiana

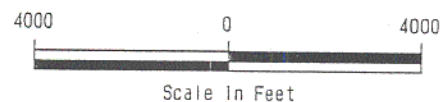

**TRACT 34668 - PORTION OF BLOCK 52, CHANDELEUR SOUND AREA, ADDITION, REVISED, St. Bernard Parish, Louisiana**

All of the lands now or formerly constituting the beds and bottoms of all water bodies of every nature and description and all islands and other lands formed by accretion or reliction, except tax lands, belonging to the State of Louisiana and not under mineral lease on July 10, 2002, situated in St. Bernard Parish, Louisiana, and more particularly described as follows: Beginning at a point on the East line of Block 52, Chandeleur Sound Area, Addition, Revised, having Coordinates of X = 2,709,100.00 and Y = 477,205.00; thence South 7,375.00 feet on the East line of said Block 52 to its Southeast corner having Coordinates of X = 2,709,100.00 and Y = 469,830.00; thence West 14,750.00 feet on the South line of said Block 52 to its Southwest corner having Coordinates of X = 2,694,350.00 and Y = 469,830.00; thence North 7,375.00 feet on the West line of said Block 52 to a point having Coordinates of X = 2,694,350.00 and Y = 477,205.00; thence East 14,750.00 feet to the point of beginning, containing approximately **2,497.27 acres**, as shown outlined on a plat on file in the Office of Mineral Resources, Department of Natural Resources, as provided by the applicant. All bearings, distances and coordinates are based on Louisiana Coordinate System of 1927 (South Zone).

NOTE: The above description of the tract nominated for lease has been provided exclusively by the party nominating the tract for lease.

Maps depicting the nominated tract, containing the bearings, distances and coordinates of the nominated tract based on the Louisiana Coordinate System of 1927, North or South Zone, as applicable, are available for public inspection and review at the offices of the Louisiana State Mineral Board from 10:00 a.m. to 3:00 p.m. Monday - Friday.

Any mineral lease selected from the nominated tract and awarded by the Louisiana State Mineral Board shall be without warranty of any kind, either express, implied, or statutory, including, but not limited to, the implied warranties or merchantability and fitness for a particular purpose. Should the mineral lease awarded by the Louisiana State Mineral Board be subsequently modified, cancelled or abrogated due to the existence of conflicting leases, operating agreements, private claims or other existing or future obligations or conditions which may affect all or any portion of the leased tract, it shall not relieve the Lessee of the obligation to pay any bonus due thereon to the Louisiana State Mineral Board, nor shall the Louisiana State Mineral Board be obligated to refund any consideration paid by the Lessee prior to such modification, cancellation, or abrogation, including, but not limited to, bonuses, rents and royalties.

NOTE: The Office of Mineral Resources will require a minimum bonus of \$130 per acre and a minimum royalty of 21%.

NOTE: The State of Louisiana does hereby reserve, and this lease shall be subject to, the imprescriptible right of surface use in the nature of a servitude in favor of the Department of Natural Resources and/or the Louisiana Department of Wildlife and Fisheries, including its Offices and Commissions, for the sole purpose of implementing, constructing, servicing and maintaining approved coastal zone management and/or restoration projects. Utilization of any and all rights derived under this lease by the mineral lessee, its agents, successors or assigns, shall not interfere with nor hinder the reasonable surface use by the Department of Natural Resources and/or the Louisiana Department of Wildlife and Fisheries, its Offices or Commissions, as hereinabove reserved.

Applicant: Christie G. O'Neal

Bik. 42

Bik. 41

Bik. 40

OA 249

411

GULF OF MEXICO  
CHANDELEUR SOUND AREA  
ADDITION, REV.

Bik. 51

Bik. 52

Bik. 53

TR 34668  
2,497.27 ± ACS.  
JULY, 2002

P. O. B.  
X=2,709,100.00  
Y= 477,205.00

Bik. 5

CHANDELEUR SOUND AREA

Bik. 6

Bik. 7



St. Bernard Parish, Louisiana

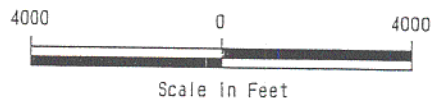

**TRACT 34669 - PORTION OF BLOCK 6, CHANDELEUR SOUND AREA, St. Bernard Parish, Louisiana**

All of the lands now or formerly constituting the beds and bottoms of all water bodies of every nature and description and all islands and other lands formed by accretion or reliction, except tax lands, belonging to the State of Louisiana and not under mineral lease on July 10, 2002, situated in St. Bernard Parish, Louisiana, and more particularly described as follows: Beginning at a point on the East line of Block 6, Chandeleur Sound Area, having Coordinates of X = 2,709,100.00 and Y = 462,455.00; thence West 14,750.00 feet to a point on the West line of said Block 6 having Coordinates of X = 2,694,350.00 and Y = 462,455.00; thence North 7,375.00 feet on the West line of said Block 6 to its Northwest corner having Coordinates of X = 2,694,350.00 and Y = 469,830.00; thence East 14,750.00 feet on the North line of said Block 6 to its Northeast corner having Coordinates of X = 2,709,100.00 and Y = 469,830.00; thence South 7,375.00 feet to the point of beginning, containing approximately **2,497.27 acres**, as shown outlined on a plat on file in the Office of Mineral Resources, Department of Natural Resources, as provided by the applicant. All bearings, distances and coordinates are based on Louisiana Coordinate System of 1927 (South Zone).

NOTE: The above description of the tract nominated for lease has been provided exclusively by the party nominating the tract for lease.

Maps depicting the nominated tract, containing the bearings, distances and coordinates of the nominated tract based on the Louisiana Coordinate System of 1927, North or South Zone, as applicable, are available for public inspection and review at the offices of the Louisiana State Mineral Board from 10:00 a.m. to 3:00 p.m. Monday - Friday.

Any mineral lease selected from the nominated tract and awarded by the Louisiana State Mineral Board shall be without warranty of any kind, either express, implied, or statutory, including, but not limited to, the implied warranties or merchantability and fitness for a particular purpose. Should the mineral lease awarded by the Louisiana State Mineral Board be subsequently modified, cancelled or abrogated due to the existence of conflicting leases, operating agreements, private claims or other existing or future obligations or conditions which may affect all or any portion of the leased tract, it shall not relieve the Lessee of the obligation to pay any bonus due thereon to the Louisiana State Mineral Board, nor shall the Louisiana State Mineral Board be obligated to refund any consideration paid by the Lessee prior to such modification, cancellation, or abrogation, including, but not limited to, bonuses, rents and royalties.

NOTE: The Office of Mineral Resources will require a minimum bonus of \$130 per acre and a minimum royalty of 21%.

NOTE: The State of Louisiana does hereby reserve, and this lease shall be subject to, the imprescriptible right of surface use in the nature of a servitude in favor of the Department of Natural Resources and/or the Louisiana Department of Wildlife and Fisheries, including its Offices and Commissions, for the sole purpose of implementing, constructing, servicing and maintaining approved coastal zone management and/or restoration projects. Utilization of any and all rights derived under this lease by the mineral lessee, its agents, successors or assigns, shall not interfere with nor hinder the reasonable surface use by the Department of Natural Resources and/or the Louisiana Department of Wildlife and Fisheries, its Offices or Commissions, as hereinabove reserved.

Applicant: Christie G. O'Neal

414

Bik. 51

Bik. 52

Bik. 53

CHANDELEUR SOUND AREA  
ADDITION, REV.

CHANDELEUR SOUND AREA

TR 34669  
2,497.27 ± ACS.  
JULY, 2002

Bik. 6

Bik. 5

Bik. 7

GULF OF MEXICO

P. O. B.  
X=2,709,100.00  
Y= 462,455.00

Bik. 18

Bik. 17

Bik. 16



St. Bernard Parish, Louisiana

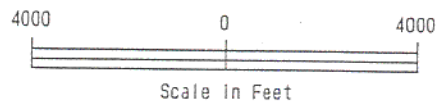

**TRACT 34670 - PORTION OF BLOCK 6, CHANDELEUR SOUND AREA, St. Bernard Parish, Louisiana**

All of the lands now or formerly constituting the beds and bottoms of all water bodies of every nature and description and all islands and other lands formed by accretion or reliction, except tax lands, belonging to the State of Louisiana and not under mineral lease on July 10, 2002, situated in St. Bernard Parish, Louisiana, and more particularly described as follows: Beginning at a point on the East line of Block 6, Chandeleur Sound Area, having Coordinates of X = 2,709,100.00 and Y = 462,455.00; thence South 7,375.00 feet on the East line of said Block 6 to its Southeast corner having Coordinates of X = 2,709,100.00 and Y = 455,080.00; thence West 14,750.00 feet on the South line of said Block 6 to its Southwest corner having Coordinates of X = 2,694,350.00 and Y = 455,080.00; thence North 7,375.00 feet to a point on the West line of said Block 6 to a point having Coordinates of X = 2,694,350.00 and Y = 462,455.00; thence East 14,750.00 feet to the point of beginning, containing approximately **2,497.27 acres**, as shown outlined on a plat on file in the Office of Mineral Resources, Department of Natural Resources, as provided by the applicant. All bearings, distances and coordinates are based on Louisiana Coordinate System of 1927 (South Zone).

NOTE: The above description of the tract nominated for lease has been provided exclusively by the party nominating the tract for lease.

Maps depicting the nominated tract, containing the bearings, distances and coordinates of the nominated tract based on the Louisiana Coordinate System of 1927, North or South Zone, as applicable, are available for public inspection and review at the offices of the Louisiana State Mineral Board from 10:00 a.m. to 3:00 p.m. Monday - Friday.

Any mineral lease selected from the nominated tract and awarded by the Louisiana State Mineral Board shall be without warranty of any kind, either express, implied, or statutory, including, but not limited to, the implied warranties or merchantability and fitness for a particular purpose. Should the mineral lease awarded by the Louisiana State Mineral Board be subsequently modified, cancelled or abrogated due to the existence of conflicting leases, operating agreements, private claims or other existing or future obligations or conditions which may affect all or any portion of the leased tract, it shall not relieve the Lessee of the obligation to pay any bonus due thereon to the Louisiana State Mineral Board, nor shall the Louisiana State Mineral Board be obligated to refund any consideration paid by the Lessee prior to such modification, cancellation, or abrogation, including, but not limited to, bonuses, rents and royalties.

NOTE: The Office of Mineral Resources will require a minimum bonus of \$130 per acre and a minimum royalty of 21%.



NOTE: The State of Louisiana does hereby reserve, and this lease shall be subject to, the imprescriptible right of surface use in the nature of a servitude in favor of the Department of Natural Resources and/or the Louisiana Department of Wildlife and Fisheries, including its Offices and Commissions, for the sole purpose of implementing, constructing, servicing and maintaining approved coastal zone management and/or restoration projects. Utilization of any and all rights derived under this lease by the mineral lessee, its agents, successors or assigns, shall not interfere with nor hinder the reasonable surface use by the Department of Natural Resources and/or the Louisiana Department of Wildlife and Fisheries, its Offices or Commissions, as hereinabove reserved.

Applicant: Christie G. O'Neal

Bik. 51

Bik. 52

<sup>417</sup>  
Bik. 53

CHANDELEUR SOUND AREA  
ADDITION, REV.

CHANDELEUR SOUND AREA

Bik. 6

P. O. B.  
X=2,709,100.00  
Y= 462,455.00

Bik. 5

Bik. 7

TR 34670  
2,497.27 ± ACS.  
JULY, 2002

GULF OF MEXICO

Bik. 18

Bik. 17

Bik. 16



St. Bernard Parish, Louisiana

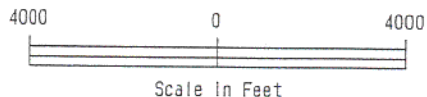

**TRACT 34671 - PORTION OF BLOCK 17, CHANDELEUR SOUND AREA, St. Bernard Parish, Louisiana**

All of the lands now or formerly constituting the beds and bottoms of all water bodies of every nature and description and all islands and other lands formed by accretion or reliction, except tax lands, belonging to the State of Louisiana and not under mineral lease on July 10, 2002, situated in St. Bernard Parish, Louisiana, and more particularly described as follows: Beginning at a point on the East line of Block 17, Chandeleur Sound Area, having Coordinates of X = 2,709,100.00 and Y = 447,705.00; thence West 14,750.00 feet to a point on the West line of said Block 17 having Coordinates of X = 2,694,350.00 and Y = 447,705.00; thence North 7,375.00 feet on the West line of said Block 17 to its Northwest corner having Coordinates of X = 2,694,350.00 and Y = 455,080.00; thence East 14,750.00 feet on the North line of said Block 17 to its Northeast corner having Coordinates of X = 2,709,100.00 and Y = 455,080.00; thence South 7,375.00 feet to the point of beginning, containing approximately **2,497.27 acres**, as shown outlined on a plat on file in the Office of Mineral Resources, Department of Natural Resources, as provided by the applicant. All bearings, distances and coordinates are based on Louisiana Coordinate System of 1927 (South Zone).

NOTE: The above description of the tract nominated for lease has been provided exclusively by the party nominating the tract for lease.

Maps depicting the nominated tract, containing the bearings, distances and coordinates of the nominated tract based on the Louisiana Coordinate System of 1927, North or South Zone, as applicable, are available for public inspection and review at the offices of the Louisiana State Mineral Board from 10:00 a.m. to 3:00 p.m. Monday - Friday.

Any mineral lease selected from the nominated tract and awarded by the Louisiana State Mineral Board shall be without warranty of any kind, either express, implied, or statutory, including, but not limited to, the implied warranties or merchantability and fitness for a particular purpose. Should the mineral lease awarded by the Louisiana State Mineral Board be subsequently modified, cancelled or abrogated due to the existence of conflicting leases, operating agreements, private claims or other existing or future obligations or conditions which may affect all or any portion of the leased tract, it shall not relieve the Lessee of the obligation to pay any bonus due thereon to the Louisiana State Mineral Board, nor shall the Louisiana State Mineral Board be obligated to refund any consideration paid by the Lessee prior to such modification, cancellation, or abrogation, including, but not limited to, bonuses, rents and royalties.

NOTE: The Office of Mineral Resources will require a minimum bonus of \$230 per acre and a minimum royalty of 23%.

NOTE: The State of Louisiana does hereby reserve, and this lease shall be subject to, the imprescriptible right of surface use in the nature of a servitude in favor of the Department of Natural Resources and/or the Louisiana Department of Wildlife and Fisheries, including its Offices and Commissions, for the sole purpose of implementing, constructing, servicing and maintaining approved coastal zone management and/or restoration projects. Utilization of any and all rights derived under this lease by the mineral lessee, its agents, successors or assigns, shall not interfere with nor hinder the reasonable surface use by the Department of Natural Resources and/or the Louisiana Department of Wildlife and Fisheries, its Offices or Commissions, as hereinabove reserved.

Applicant: Christie G. O'Neal

420

Bik. 5

Bik. 6

Bik. 7

CHANDELIER SOUND AREA

TR 34671  
2,497.27 ± ACS.  
JULY, 2002

Bik. 17

Bik. 18

Bik. 16

P. O. B.  
X=2,709,100.00  
Y=447,705.00

GULF OF MEXICO

Bik. 27

Bik. 28

Bik. 29

NAD 27 LAMBERT LA. SOUTH ZONE

St. Bernard Parish, Louisiana

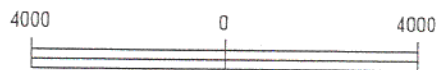

Scale in Feet