

portion of the bid area which is not unleaseable. If rejected, the bid and all monies accompanying the bid will be returned to the successful bidder and no lease will be issued. In all other cases a new lease will be issued and any additional per acre bonus/rental, 10% administration fee or \$10 and \$5 per acre fees due as a result of staff determination of more State acreage in the bid area than determined by the successful bidder will be paid prior to the lease being issued. A determination of less State acreage in the bid area will result in a return to the successful bidder of any overpayment.

Applicant: Petro-Guard Production, L.L.C.

Bidder	Cash Payment	Price / Acre	Rental	Oil	Gas	Other

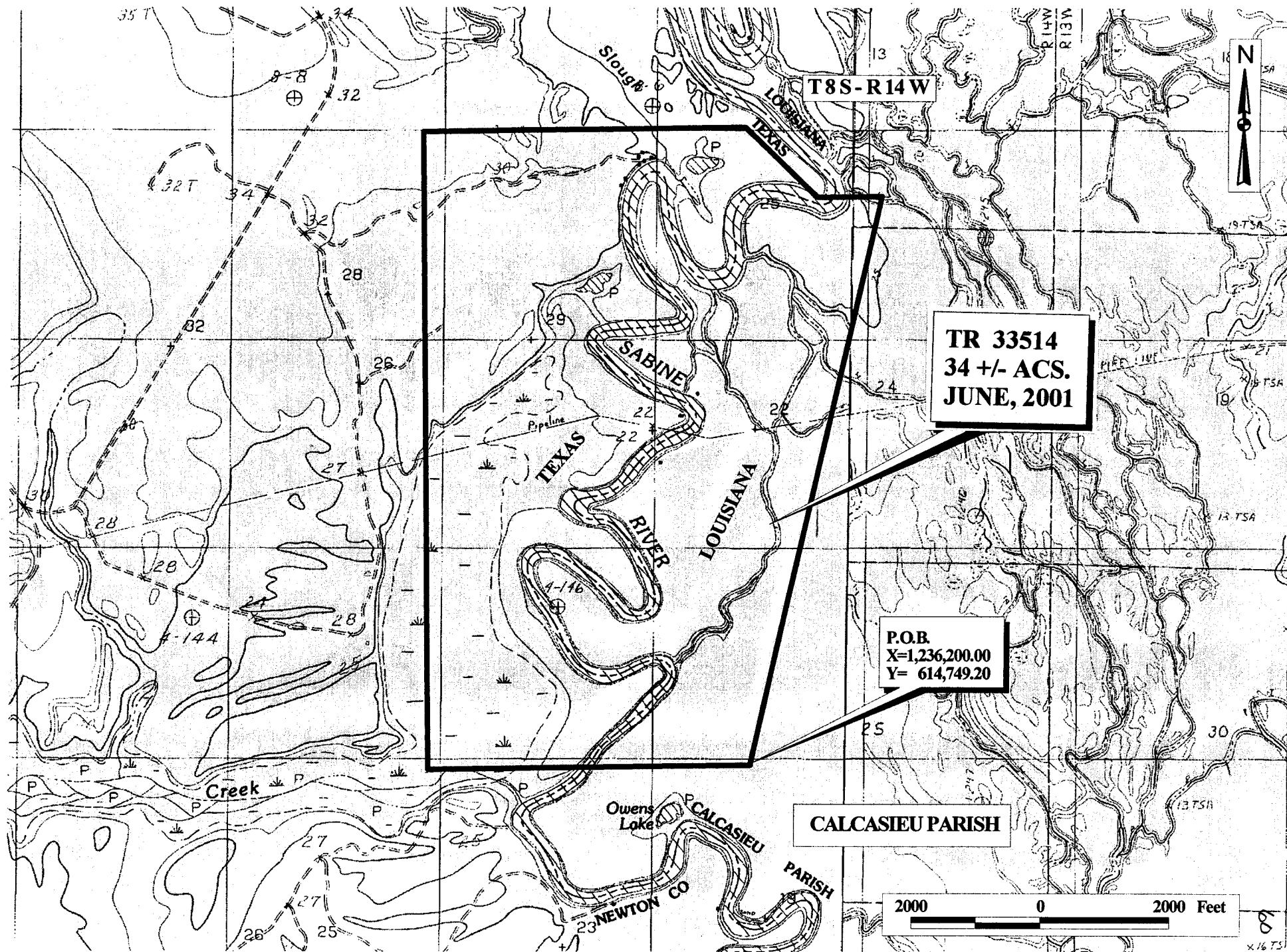

TRACT 33515 - Cameron Parish, Louisiana

All of the lands now or formerly constituting the beds and bottoms of all water bodies of every nature and description and all islands and other lands formed by accretion or reliction, except tax lands, owned by and not under mineral lease from the State of Louisiana on June 13, 2001, situated in Cameron Parish, Louisiana, within the following described boundaries: Beginning at a point having Coordinates of X = 1,214,900.00 and Y = 457,126.00; thence West 5,320.19 feet to a point on the Louisiana - Texas boundary having Coordinates of X = 1,209,579.81 and Y = 457,126.00; thence along the said Louisiana - Texas boundary the following courses: North 36 degrees 44 minutes 14 seconds East 535.25 feet, North 31 degrees 07 minutes 12 seconds East 3,773.06 feet, North 21 degrees 41 minutes 28 seconds East 2,895.03 feet, North 14 degrees 23 minutes 58 seconds East 1,188.29 feet to a point on the Louisiana - Texas boundary, also being the Southwest corner of State Lease No. 16092 having Coordinates of X = 1,213,215.52 and Y = 464,626.00; thence East 1,684.48 feet along the South line of said State Lease No. 16092 to a point having Coordinates of X = 1,214,900.00 and Y = 464,626.00; thence South 7,500.00 feet to the point of beginning, containing approximately **553.00 acres**, as shown outlined in red on a plat on file in the Office of Mineral Resources, Department of Natural Resources, as provided by the applicant, **LESS AND EXCEPT** that portion thereof, if any, located West of the boundary line between the States of Texas and Louisiana as determined by the report of the Special Master in litigation in the Supreme Court of the United States styled Texas v. Louisiana et al No. 36 Original, or as otherwise approved by said court. All bearings, distances and coordinates are based on Louisiana Coordinate System of 1927 (South Zone).

NOTE: The boundary description and plat for this tract as shown and as advertised were supplied by the nominating party and have not been checked for accuracy by the staff of the Office of Mineral Resources. Anything which may affect the acreage, the shape or the location of the tract, such as non-closure of or incorrect X, Y coordinates or title disputed acreage, or which may affect the status of the tract for leasing, such as overlap of prior leases or nominated tracts, or which may affect potential operations on leases taken, such as inclusion in areas under the jurisdiction of the Department of Wildlife and Fisheries, will not be specifically determined unless and until a bid on this tract is accepted by the Mineral Board; which bid will be accepted on a per acre basis and which acceptance will be conditional upon such specific determinations being made. Once a bid is conditionally accepted by the Mineral Board, the staff will, within a period following the date of the lease sale, determine the acreage, shape and location of the potential lease area of the tract, the status for leasing of all or any portion thereof, and any conditions which may affect potential operations thereon. These determinations may render all or a portion of the bid area unleaseable or may increase or decrease the State claimed acreage such that the total bonus/rental ultimately required may either exceed the bonus/rental paid at the lease sale, which will require additional payment by the successful bidder, or allow the successful bidder a refund of excessive payment. The successful bidder will be notified of the determinations by the staff and given an opportunity to view the bid area acreage, configuration and location as it has been

specifically determined. If all or a portion of the bid area is unleaseable due to overlap of an existing lease, the successful bidder will be given an opportunity to accept or reject a new lease on that portion of the bid area which is not unleaseable. If rejected, the bid and all monies accompanying the bid will be returned to the successful bidder and no lease will be issued. In all other cases a new lease will be issued and any additional per acre bonus/rental, 10% administration fee or \$10 and \$5 per acre fees due as a result of staff determination of more State acreage in the bid area than determined by the successful bidder will be paid prior to the lease being issued. A determination of less State acreage in the bid area will result in a return to the successful bidder of any overpayment.

NOTE: The State of Louisiana does hereby reserve, and this lease shall be subject to, the imprescriptible right of surface use in the nature of a servitude in favor of the Department of Natural Resources, including its Offices and Commissions, for the sole purpose of implementing, constructing, servicing and maintaining approved coastal zone management and/or restoration projects. Utilization of any and all rights derived under this lease by the mineral lessee, its agents, successors or assigns, shall not interfere with nor hinder the reasonable surface use by the Department of Natural Resources, its Offices or Commissions, as hereinabove reserved.

Applicant: Blevence Aucoin

Bidder	Cash Payment	Price / Acre	Rental	Oil	Gas	Other

A B I N E

A B

JEFFERSON CO.
CAMERON PARISH

SL 16092



TR 33515
553 +/- ACS.
JUNE, 2001

PROPOSED TRACT
±553.00 Acres

SL 16093

SL 16094

P.O.B.
X=1,214,900.00
Y= 457,126.00

TEXAS
LOUISIANA NA

SABINE LAKE

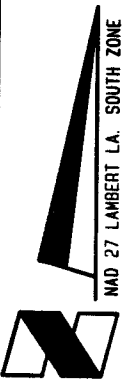

Topography obtained from U.S. Geological
Survey Quadrangles "WEST OF GREENS BAYOU, LA."
1993 Edition.

Cameron Parish, Louisiana

2000' 1000' 0' 2000'

TRACT 33516 - Cameron Parish, Louisiana

All of the lands now or formerly constituting the beds and bottoms of all water bodies of every nature and description and all islands and other lands formed by accretion or reliction, except tax lands, owned by and not under mineral lease from the State of Louisiana on June 13, 2001, situated in Cameron Parish, Louisiana, within the following described boundaries: Beginning at a point having Coordinates of X = 1,214,900.00 and Y = 449,626.00; thence West 9,856.83 feet to a point on the Louisiana - Texas boundary having Coordinates of X = 1,205,043.17 and Y = 449,626.00; thence along the said Louisiana - Texas boundary the following courses: North 35 degrees 51 minutes 28 seconds East 1,411.52 feet, North 24 degrees 40 minutes 16 seconds East 3,964.89 feet, North 36 degrees 44 minutes 14 seconds East 3,435.33 feet to a point having Coordinates of X = 1,209,579.81 and Y = 457,126.00; thence East 5,320.19 feet to a point having Coordinates of X = 1,214,900.00 and Y = 457,126.00; thence South 7,500.00 feet to the point of beginning, containing approximately 1,327.64 acres, as shown outlined in red on a plat on file in the Office of Mineral Resources, Department of Natural Resources, as provided by the applicant, **LESS AND EXCEPT** that portion thereof, if any, located West of the boundary line between the States of Texas and Louisiana as determined by the report of the Special Master in litigation in the Supreme Court of the United States styled Texas v. Louisiana et al No. 36 Original, or as otherwise approved by said court. All bearings, distances and coordinates are based on Louisiana Coordinate System of 1927 (South Zone).

NOTE: The boundary description and plat for this tract as shown and as advertised were supplied by the nominating party and have not been checked for accuracy by the staff of the Office of Mineral Resources. Anything which may affect the acreage, the shape or the location of the tract, such as non-closure of or incorrect X, Y coordinates or title disputed acreage, or which may affect the status of the tract for leasing, such as overlap of prior leases or nominated tracts, or which may affect potential operations on leases taken, such as inclusion in areas under the jurisdiction of the Department of Wildlife and Fisheries, will not be specifically determined unless and until a bid on this tract is accepted by the Mineral Board; which bid will be accepted on a per acre basis and which acceptance will be conditional upon such specific determinations being made. Once a bid is conditionally accepted by the Mineral Board, the staff will, within a period following the date of the lease sale, determine the acreage, shape and location of the potential lease area of the tract, the status for leasing of all or any portion thereof, and any conditions which may affect potential operations thereon. These determinations may render all or a portion of the bid area unleaseable or may increase or decrease the State claimed acreage such that the total bonus/rental ultimately required may either exceed the bonus/rental paid at the lease sale, which will require additional payment by the successful bidder, or allow the successful bidder a refund of excessive payment. The successful bidder will be notified of the determinations by the staff and given an opportunity to view the bid area acreage, configuration and location as it has been specifically determined. If all or a portion of the bid area is unleaseable due to overlap of an existing lease, the successful bidder

will be given an opportunity to accept or reject a new lease on that portion of the bid area which is not unleaseable. If rejected, the bid and all monies accompanying the bid will be returned to the successful bidder and no lease will be issued. In all other cases a new lease will be issued and any additional per acre bonus/rental, 10% administration fee or \$10 and \$5 per acre fees due as a result of staff determination of more State acreage in the bid area than determined by the successful bidder will be paid prior to the lease being issued. A determination of less State acreage in the bid area will result in a return to the successful bidder of any overpayment.

NOTE: The State of Louisiana does hereby reserve, and this lease shall be subject to, the imprescriptible right of surface use in the nature of a servitude in favor of the Department of Natural Resources, including its Offices and Commissions, for the sole purpose of implementing, constructing, servicing and maintaining approved coastal zone management and/or restoration projects. Utilization of any and all rights derived under this lease by the mineral lessee, its agents, successors or assigns, shall not interfere with nor hinder the reasonable surface use by the Department of Natural Resources, its Offices or Commissions, as hereinabove reserved.

Applicant: Blevence Aucoin

Bidder	Cash Payment	Price / Acre	Rental	Oil	Gas	Other

SABINE LAKE

TR 33516
1,327.64 +/- ACS.
JUNE, 2001

P. O. B.
X=1,214,900.00
Y= 449,626.00

SL 16092

TEXAS
LOUISIANA

JEFFERSON CO.
CAMERON PARISH

JEFFERSON CO.
CAMERON PARISH



Topography obtained from U.S. Geological
Survey Quadrangles "WEST OF GREENS BAYOU, LA."
1993 Edition.

Cameron Parish, Louisiana

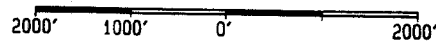

TRACT 33517 - Cameron Parish, Louisiana

All of the lands now or formerly constituting the beds and bottoms of all water bodies of every nature and description and all islands and other lands formed by accretion or reliction, except tax lands, owned by and not under mineral lease from the State of Louisiana on June 13, 2001, situated in Cameron Parish, Louisiana, within the following described boundaries: Beginning at a point having Coordinates of X = 1,214,900.00 and Y = 449,626.00; thence South 1,981.00 feet to the Northwest corner of State Lease No. 16095 having Coordinates of X = 1,214,900.00 and Y = 447,645.00; thence South 2,700.00 feet along the West line of said State Lease No. 16095 to its Southwest corner having Coordinates of X = 1,214,900.00 and Y = 444,945.00; thence South 2,819.00 feet to a point having Coordinates of X = 1,214,900.00 and Y = 442,126.00; thence West 10,000.00 feet to a point having Coordinates of X = 1,204,900.00 and Y = 442,126.00; thence North 7,301.92 feet to a point on the Louisiana - Texas boundary having Coordinates of X = 1,204,900.00 and Y = 449,427.92; thence North 35 degrees 51 minutes 28 seconds East 244.40 feet to a point on the Louisiana - Texas boundary having Coordinates of X = 1,205,043.17 and Y = 449,626.00; thence East 9,856.83 feet to the point of beginning, containing approximately 1,721.44 acres, as shown outlined in red on a plat on file in the Office of Mineral Resources, Department of Natural Resources, as provided by the applicant, **LESS AND EXCEPT** that portion thereof, if any, located West of the boundary line between the States of Texas and Louisiana as determined by the report of the Special Master in litigation in the Supreme Court of the United States styled Texas v. Louisiana et al No. 36 Original, or as otherwise approved by said court. All bearings, distances and coordinates are based on Louisiana Coordinate System of 1927 (South Zone).

NOTE: The boundary description and plat for this tract as shown and as advertised were supplied by the nominating party and have not been checked for accuracy by the staff of the Office of Mineral Resources. Anything which may affect the acreage, the shape or the location of the tract, such as non-closure of or incorrect X, Y coordinates or title disputed acreage, or which may affect the status of the tract for leasing, such as overlap of prior leases or nominated tracts, or which may affect potential operations on leases taken, such as inclusion in areas under the jurisdiction of the Department of Wildlife and Fisheries, will not be specifically determined unless and until a bid on this tract is accepted by the Mineral Board; which bid will be accepted on a per acre basis and which acceptance will be conditional upon such specific determinations being made. Once a bid is conditionally accepted by the Mineral Board, the staff will, within a period following the date of the lease sale, determine the acreage, shape and location of the potential lease area of the tract, the status for leasing of all or any portion thereof, and any conditions which may affect potential operations thereon. These determinations may render all or a portion of the bid area unleaseable or may increase or decrease the State claimed acreage such that the total bonus/rental ultimately required may either exceed the bonus/rental paid at the lease sale, which will require additional payment by the successful bidder, or allow the successful bidder a refund of excessive payment. The successful bidder will be notified of the determinations by the staff and given an opportunity to view

the bid area acreage, configuration and location as it has been specifically determined. If all or a portion of the bid area is unleaseable due to overlap of an existing lease, the successful bidder will be given an opportunity to accept or reject a new lease on that portion of the bid area which is not unleaseable. If rejected, the bid and all monies accompanying the bid will be returned to the successful bidder and no lease will be issued. In all other cases a new lease will be issued and any additional per acre bonus/rental, 10% administration fee or \$10 and \$5 per acre fees due as a result of staff determination of more State acreage in the bid area than determined by the successful bidder will be paid prior to the lease being issued. A determination of less State acreage in the bid area will result in a return to the successful bidder of any overpayment.

NOTE: The State of Louisiana does hereby reserve, and this lease shall be subject to, the imprescriptible right of surface use in the nature of a servitude in favor of the Department of Natural Resources, including its Offices and Commissions, for the sole purpose of implementing, constructing, servicing and maintaining approved coastal zone management and/or restoration projects. Utilization of any and all rights derived under this lease by the mineral lessee, its agents, successors or assigns, shall not interfere with nor hinder the reasonable surface use by the Department of Natural Resources, its Offices or Commissions, as hereinabove reserved.

Applicant: Blevence Aucoin

Bidder	Cash Payment	Price / Acre	Rental	Oil	Gas	Other

TEXAS
LOUISIANA

JEFFERSON CO.
CAMERON PARISH

P. O. B.
X=1,214,900.00
Y= 449,626.00

TR 33517
1,721.44 +/- ACS.
JUNE, 2001

SL 16095

SABINE LAKE



Topography obtained from U.S. Geological
Survey Quadrangles "WEST OF GREENS BAYOU, LA."
1993 Edition.

Cameron Parish, Louisiana

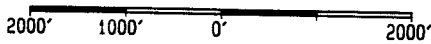

TRACT 33518 - Cameron Parish, Louisiana

All of the lands now or formerly constituting the beds and bottoms of all water bodies of every nature and description and all islands and other lands formed by accretion or reliction, except tax lands, owned by and not under mineral lease from the State of Louisiana on June 13, 2001, situated in Cameron Parish, Louisiana, within the following described boundaries: Beginning at a point having Coordinates of X = 1,224,700.00 and Y = 464,626.00; thence West 5,789.00 feet to the Southeast corner of State Lease No. 16092 having Coordinates of X = 1,218,911.00 and Y = 464,626.00; thence North 2,385.00 feet along the East line of said State Lease No. 16092 to its Northeast corner having Coordinates of X = 1,218,911.00 and Y = 467,011.00; thence West 5,083.15 feet along the North line of said State Lease No. 16092 to its Northwest corner, also being a point on the Louisiana - Texas boundary having Coordinates of X = 1,213,827.85 and Y = 467,011.00; thence along the said Louisiana - Texas boundary the following courses: North 14 degrees 23 minutes 58 seconds East 1,898.64 feet, North 11 degrees 52 minutes 43 seconds East 1,481.73 feet, North 25 degrees 46 minutes 49 seconds East 816.24 feet, North 48 degrees 11 minutes 45 seconds East 697.59 feet, North 13 degrees 32 minutes 16 seconds East 643.89 feet to a point having Coordinates of X = 1,215,630.73 and Y = 472,126.00; thence East 9,069.27 feet to a point having Coordinates of X = 1,224,700.00 and Y = 472,126.00; thence South 7,500.00 feet to the point of beginning, containing approximately **1,507.06 acres**, as shown outlined in red on a plat on file in the Office of Mineral Resources, Department of Natural Resources, as provided by the applicant, **LESS AND EXCEPT** that portion thereof, if any, located West of the boundary line between the States of Texas and Louisiana as determined by the report of the Special Master in litigation in the Supreme Court of the United States styled Texas v. Louisiana et al No. 36 Original, or as otherwise approved by said court. All bearings, distances and coordinates are based on Louisiana Coordinate System of 1927 (South Zone).

NOTE: The boundary description and plat for this tract as shown and as advertised were supplied by the nominating party and have not been checked for accuracy by the staff of the Office of Mineral Resources. Anything which may affect the acreage, the shape or the location of the tract, such as non-closure of or incorrect X, Y coordinates or title disputed acreage, or which may affect the status of the tract for leasing, such as overlap of prior leases or nominated tracts, or which may affect potential operations on leases taken, such as inclusion in areas under the jurisdiction of the Department of Wildlife and Fisheries, will not be specifically determined unless and until a bid on this tract is accepted by the Mineral Board; which bid will be accepted on a per acre basis and which acceptance will be conditional upon such specific determinations being made. Once a bid is conditionally accepted by the Mineral Board, the staff will, within a period following the date of the lease sale, determine the acreage, shape and location of the potential lease area of the tract, the status for leasing of all or any portion thereof, and any conditions which may affect potential operations thereon. These determinations may render all or a portion of the bid area unleaseable or may increase or decrease the State claimed acreage such that the total bonus/rental ultimately required may either exceed the bonus/rental paid at the lease sale, which will require additional