

INLAND TRACTS

TRACT 33506 - Bossier and Caddo Parishes, Louisiana

All of the lands now or formerly constituting the beds and bottoms of all water bodies of every nature and description and all islands and other lands formed by accretion or reliction, except tax lands, owned by and not under mineral lease from the State of Louisiana on June 13, 2001, situated in Bossier and Caddo Parishes, Louisiana, within the following described boundaries: Beginning at a point having Coordinates of X = 1,678,763.4 and Y = 594,007.6; thence Southerly to a point having Coordinates of X = 1,686,012.1 and Y = 587,946.4; thence Southerly to a point having Coordinates of X = 1,692,698.2 and Y = 579,198.2; thence Southerly to a point having Coordinates of X = 1,692,760.3 and Y = 575,698.6; thence Easterly to a point having Coordinates of X = 1,696,734.0 and Y = 575,664.7; thence Northerly to a point having Coordinates of X = 1,696,760.5 and Y = 580,448.3; thence Westerly to a point having Coordinates of X = 1,694,510.8 and Y = 580,635.6; thence Northerly to a point having Coordinates of X = 1,688,199.7 and Y = 589,821.4; thence Northerly to a point having Coordinates of X = 1,682,537.8 and Y = 593,943.8; thence Westerly back to the point of beginning, **LESS AND EXCEPT** all those portions of State Lease No. 16396 and State Lease No. 16397 that lie within the above described tract, containing approximately **346 acres**, as shown outlined in red on a plat on file in the Office of Mineral Resources, Department of Natural Resources. All bearings, distances and coordinates are based on Louisiana Coordinate System of 1927 (North Zone).

NOTE: The boundary description and plat for this tract as shown and as advertised were supplied by the nominating party and have not been checked for accuracy by the staff of the Office of Mineral Resources. Anything which may affect the acreage, the shape or the location of the tract, such as non-closure of or incorrect X, Y coordinates or title disputed acreage, or which may affect the status of the tract for leasing, such as overlap of prior leases or nominated tracts, or which may affect potential operations on leases taken, such as inclusion in areas under the jurisdiction of the Department of Wildlife and Fisheries, will not be specifically determined unless and until a bid on this tract is accepted by the Mineral Board; which bid will be accepted on a per acre basis and which acceptance will be conditional upon such specific determinations being made. Once a bid is conditionally accepted by the Mineral Board, the staff will, within a period following the date of the lease sale, determine the acreage, shape and location of the potential lease area of the tract, the status for leasing of all or any portion thereof, and any conditions which may affect potential operations thereon. These determinations may render all or a portion of the bid area unleaseable or may increase or decrease the State claimed acreage such that the total bonus/rental ultimately required may either exceed the bonus/rental paid at the lease sale, which will require additional payment by the successful bidder, or allow the successful bidder a refund of excessive payment. The successful bidder will be notified of the determinations by the staff and given an opportunity to view the bid area acreage, configuration and location as it has been specifically determined. If all or a portion of the bid area is unleaseable due to overlap of an existing lease, the successful bidder will be given an opportunity to accept or reject a new lease on that

portion of the bid area which is not unleaseable. If rejected, the bid and all monies accompanying the bid will be returned to the successful bidder and no lease will be issued. In all other cases a new lease will be issued and any additional per acre bonus/rental, 10% administration fee or \$10 and \$5 per acre fees due as a result of staff determination of more State acreage in the bid area than determined by the successful bidder will be paid prior to the lease being issued. A determination of less State acreage in the bid area will result in a return to the successful bidder of any overpayment.

Applicant: Chris Aymond

Bidder	Cash Payment	Price / Acre	Rental	Oil	Gas	Other

POB:
X:1678,763.4
Y: 594,007.6

SL 16397

SL 16396

TR 33506
346 +/- ACS.
JUNE, 2001

T15N R11W

Couterrville

Mary Magdalene

Couterrville

Mary Magdalene

Couterrville

Mary Magdalene

Couterrville

Mary Magdalene

Couterrville

Mary Magdalene

Couterrville

Mary Magdalene

Couterrville

Mary Magdalene

Couterrville

Mary Magdalene

Couterrville

Mary Magdalene

Couterrville

Mary Magdalene

Couterrville

Mary Magdalene

Couterrville

Mary Magdalene

Couterrville

Mary Magdalene

Couterrville

Mary Magdalene

Couterrville

Mary Magdalene

Bid 1: Caddo and Bossier Parish, Louisiana
T15N R11W Sections: 21, 28, 20, 17, 16, 18, 27, 34
Water Acreage: 623.8

Scale: 1" - 3,000'

TRACT 33507 - Bossier, Caddo and Red River Parishes, Louisiana

All of the lands now or formerly constituting the beds and bottoms of all water bodies of every nature and description and all islands and other lands formed by accretion or reliction, except tax lands, owned by and not under mineral lease from the State of Louisiana on June 13, 2001, situated in Bossier, Caddo and Red River Parishes, Louisiana, within the following described boundaries: Beginning at a point having Coordinates of X = 1,692,760.3 and Y = 575,698.6; thence Southerly to a point having Coordinates of X = 1,694,478.1 and Y = 569,324.6; thence Southerly to a point having Coordinates of X = 1,699,415.1 and Y = 567,700.3; thence Northerly to a point having Coordinates of X = 1,703,289.9 and Y = 569,138.0; thence Southerly to a point having Coordinates of X = 1,701,977.2 and Y = 566,263.0; thence Southerly to a point having Coordinates of X = 1,699,039.7 and Y = 565,013.2; thence Southerly to a point having Coordinates of X = 1,697,227.0 and Y = 562,263.3; thence Southerly to a point having Coordinates of X = 1,698,336.8 and Y = 557,472.5; thence Westerly to a point having Coordinates of X = 1,708,903.0 and Y = 557,428.3; thence Northerly to a point having Coordinates of X = 1,709,163.5 and Y = 560,202.1; thence Westerly to a point having Coordinates of X = 1,701,538.9 and Y = 560,514.0; thence Northerly to a point having Coordinates of X = 1,706,351.6 and Y = 565,076.3; thence Northerly to a point having Coordinates of X = 1,706,727.6 and Y = 571,325.6; thence Northerly to a point having Coordinates of X = 1,703,176.5 and Y = 575,686.45; thence Westerly back to the point of beginning, containing approximately 618.7 acres, as shown outlined in red on a plat on file in the Office of Mineral Resources, Department of Natural Resources, as provided by the applicant. All bearings, distances and coordinates are based on Louisiana Coordinate System of 1927 (North Zone).

NOTE: The boundary description and plat for this tract as shown and as advertised were supplied by the nominating party and have not been checked for accuracy by the staff of the Office of Mineral Resources. Anything which may affect the acreage, the shape or the location of the tract, such as non-closure of or incorrect X, Y coordinates or title disputed acreage, or which may affect the status of the tract for leasing, such as overlap of prior leases or nominated tracts, or which may affect potential operations on leases taken, such as inclusion in areas under the jurisdiction of the Department of Wildlife and Fisheries, will not be specifically determined unless and until a bid on this tract is accepted by the Mineral Board; which bid will be accepted on a per acre basis and which acceptance will be conditional upon such specific determinations being made. Once a bid is conditionally accepted by the Mineral Board, the staff will, within a period following the date of the lease sale, determine the acreage, shape and location of the potential lease area of the tract, the status for leasing of all or any portion thereof, and any conditions which may affect potential operations thereon. These determinations may render all or a portion of the bid area unleaseable or may increase or decrease the State claimed acreage such that the total bonus/rental ultimately required may either exceed the bonus/rental paid at the lease sale, which will require additional payment by the successful bidder, or allow the successful bidder a refund of excessive payment. The successful bidder will be notified of the determinations by the staff and given an opportunity to view

the bid area acreage, configuration and location as it has been specifically determined. If all or a portion of the bid area is unleaseable due to overlap of an existing lease, the successful bidder will be given an opportunity to accept or reject a new lease on that portion of the bid area which is not unleaseable. If rejected, the bid and all monies accompanying the bid will be returned to the successful bidder and no lease will be issued. In all other cases a new lease will be issued and any additional per acre bonus/rental, 10% administration fee or \$10 and \$5 per acre fees due as a result of staff determination of more State acreage in the bid area than determined by the successful bidder will be paid prior to the lease being issued. A determination of less State acreage in the bid area will result in a return to the successful bidder of any overpayment.

Applicant: Chris Aymond

Bidder	Cash Payment	Price / Acre	Rental	Oil	Gas	Other

POB:
X:1692,760.3
Y: 575,698.6

T15N R11W

TR 33507
618.7 +/- ACS.
JUNE, 2001

T14N R11W

Bid 4: Caddo, Bossier & Red River Parish, Louisiana Water Acreage: 618.7
T15N R11W Sections: 34, 35, 36
T14N R11W Section: 3, 11, 2, 1, 12, 13, 14
Scale: 1" - 3,000'

TRACT 33508 - Red River Parish, Louisiana

All of the lands now or formerly constituting the beds and bottoms of all water bodies of every nature and description and all islands and other lands formed by accretion or reliction, except tax lands, owned by and not under mineral lease from the State of Louisiana on June 13, 2001, situated in Red River Parish, Louisiana, within the following described boundaries: Beginning at a point having Coordinates of X = 1,698,336.8 and Y = 557,472.5; thence Southerly to a point having Coordinates of X = 1,707,098.0 and Y = 548,768.0; thence Southerly to a point having Coordinates of X = 1,704,322.0 and Y = 539,265.3; thence Easterly to a point having Coordinates of X = 1,709,229.9 and Y = 539,369.1; thence Northerly to a point having Coordinates of X = 1,708,903.0 and Y = 557,428.3; thence Westerly back to the point of beginning, containing approximately 483.2 acres, as shown outlined in red on a plat on file in the Office of Mineral Resources, Department of Natural Resources, as provided by the applicant. All bearings, distances and coordinates are based on Louisiana Coordinate System of 1927 (North Zone).

NOTE: The boundary description and plat for this tract as shown and as advertised were supplied by the nominating party and have not been checked for accuracy by the staff of the Office of Mineral Resources. Anything which may affect the acreage, the shape or the location of the tract, such as non-closure of or incorrect X, Y coordinates or title disputed acreage, or which may affect the status of the tract for leasing, such as overlap of prior leases or nominated tracts, or which may affect potential operations on leases taken, such as inclusion in areas under the jurisdiction of the Department of Wildlife and Fisheries, will not be specifically determined unless and until a bid on this tract is accepted by the Mineral Board; which bid will be accepted on a per acre basis and which acceptance will be conditional upon such specific determinations being made. Once a bid is conditionally accepted by the Mineral Board, the staff will, within a period following the date of the lease sale, determine the acreage, shape and location of the potential lease area of the tract, the status for leasing of all or any portion thereof, and any conditions which may affect potential operations thereon. These determinations may render all or a portion of the bid area unleaseable or may increase or decrease the State claimed acreage such that the total bonus/rental ultimately required may either exceed the bonus/rental paid at the lease sale, which will require additional payment by the successful bidder, or allow the successful bidder a refund of excessive payment. The successful bidder will be notified of the determinations by the staff and given an opportunity to view the bid area acreage, configuration and location as it has been specifically determined. If all or a portion of the bid area is unleaseable due to overlap of an existing lease, the successful bidder will be given an opportunity to accept or reject a new lease on that portion of the bid area which is not unleaseable. If rejected, the bid and all monies accompanying the bid will be returned to the successful bidder and no lease will be issued. In all other cases a new lease will be issued and any additional per acre bonus/rental, 10% administration fee or \$10 and \$5 per acre fees due as a result of staff determination of more State acreage in the bid area than determined by the successful bidder will be paid prior to the lease

being issued. A determination of less State acreage in the bid area will result in a return to the successful bidder of any overpayment.

Applicant: Chris Aymond

Bidder	Cash Payment	Price / Acre	Rental	Oil	Gas	Other

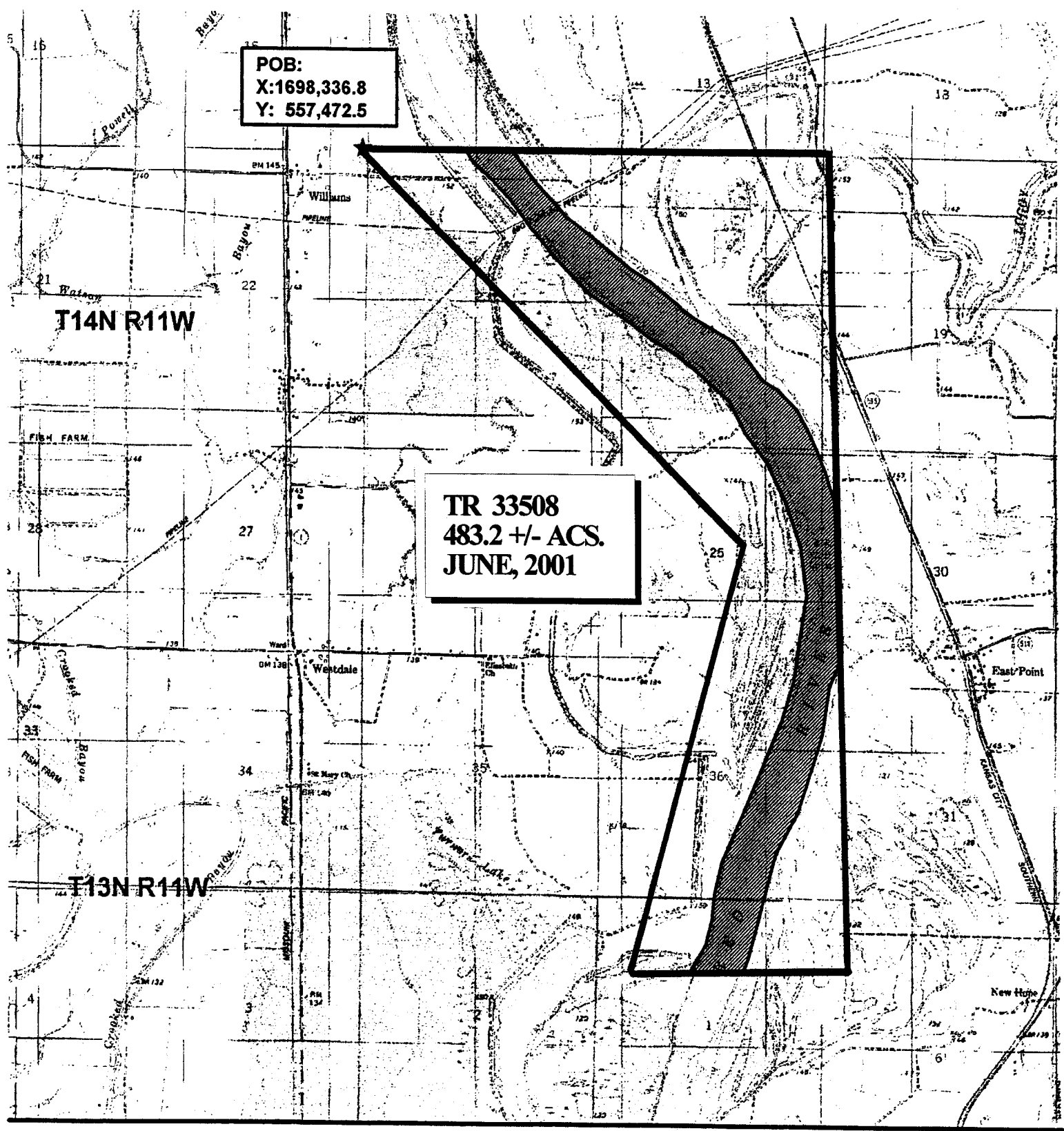

Bid 6: Red River Parish, Louisiana
 T14N R11W Sections: 23, 24, 25, 36
 T13N R11W Sections: 1

Water Acreage: 483.2
 Scale: 1" - 3,000'

TRACT 33509 - Bossier and Caddo Parishes, Louisiana

All of the lands now or formerly constituting the beds and bottoms of all water bodies of every nature and description and all islands and other lands formed by accretion or reliction, except tax lands, owned by and not under mineral lease from the State of Louisiana on June 13, 2001, situated in Bossier and Caddo Parishes, Louisiana, within the following described boundaries: Beginning at a point having Coordinates of X = 1,665,577.1 and Y = 612,152.6; thence Southerly to a point having Coordinates of X = 1,678,763.4 and Y = 594,007.6; thence Easterly to a point having Coordinates of X = 1,682,537.8 and Y = 593,943.8; thence Northerly to a point having Coordinates of X = 1,669,184.3 and Y = 612,234.8; thence Westerly back to the point of beginning, **LESS AND EXCEPT** all that portion of State Lease No. 16396 that lies within the above described tract, containing approximately **472 acres**, as shown outlined in red on a plat on file in the Office of Mineral Resources, Department of Natural Resources, as provided by the applicant. All bearings, distances and coordinates are based on Louisiana Coordinate System of 1927 (North Zone).

NOTE: The boundary description and plat for this tract as shown and as advertised were supplied by the nominating party and have not been checked for accuracy by the staff of the Office of Mineral Resources. Anything which may affect the acreage, the shape or the location of the tract, such as non-closure of or incorrect X, Y coordinates or title disputed acreage, or which may affect the status of the tract for leasing, such as overlap of prior leases or nominated tracts, or which may affect potential operations on leases taken, such as inclusion in areas under the jurisdiction of the Department of Wildlife and Fisheries, will not be specifically determined unless and until a bid on this tract is accepted by the Mineral Board; which bid will be accepted on a per acre basis and which acceptance will be conditional upon such specific determinations being made. Once a bid is conditionally accepted by the Mineral Board, the staff will, within a period following the date of the lease sale, determine the acreage, shape and location of the potential lease area of the tract, the status for leasing of all or any portion thereof, and any conditions which may affect potential operations thereon. These determinations may render all or a portion of the bid area unleaseable or may increase or decrease the State claimed acreage such that the total bonus/rental ultimately required may either exceed the bonus/rental paid at the lease sale, which will require additional payment by the successful bidder, or allow the successful bidder a refund of excessive payment. The successful bidder will be notified of the determinations by the staff and given an opportunity to view the bid area acreage, configuration and location as it has been specifically determined. If all or a portion of the bid area is unleaseable due to overlap of an existing lease, the successful bidder will be given an opportunity to accept or reject a new lease on that portion of the bid area which is not unleaseable. If rejected, the bid and all monies accompanying the bid will be returned to the successful bidder and no lease will be issued. In all other cases a new lease will be issued and any additional per acre bonus/rental, 10% administration fee or \$10 and \$5 per acre fees due as a result of staff determination of more State acreage in the bid area than

determined by the successful bidder will be paid prior to the lease being issued. A determination of less State acreage in the bid area will result in a return to the successful bidder of any overpayment.

Applicant: Chris Aymond

Bidder	Cash Payment	Price / Acre	Rental	Oil	Gas	Other