

TRACT 32544 - Iberville and St. Martin Parishes, Louisiana

All of the lands now or formerly constituting the beds and bottoms of all water bodies of every nature and description and all islands and other lands formed by accretion or reliction, except tax lands, owned by and not under mineral lease from the State of Louisiana on June 14, 2000, situated in Iberville and St. Martin Parishes, Louisiana, within the following described boundaries: Beginning at a point having Coordinates of X = 1,904,160.00 and Y = 644,480.00; thence East 9,240.00 feet; thence South 13,000.00 feet to a point on the North line of State Lease No. 16040 having Coordinates of X = 1,913,400.00 and Y = 631,480.00; thence West 1,720.00 feet along the North line of said State Lease No. 16040 to its Northwest corner having Coordinates of X = 1,911,680.00 and Y = 631,480.00; thence West 7,520.00 feet; thence North 13,000.00 feet to the point of beginning, containing approximately 21 acres, as shown outlined in red on a plat on file in the Office of Mineral Resources, Department of Natural Resources. All bearings, distances and coordinates are based on Louisiana Coordinate System of 1927 (South Zone).

Applicant: A.S. Ruffin, Jr.

Bidder	Cash Payment	Price / Acre	Rental	Oil	Gas	Other

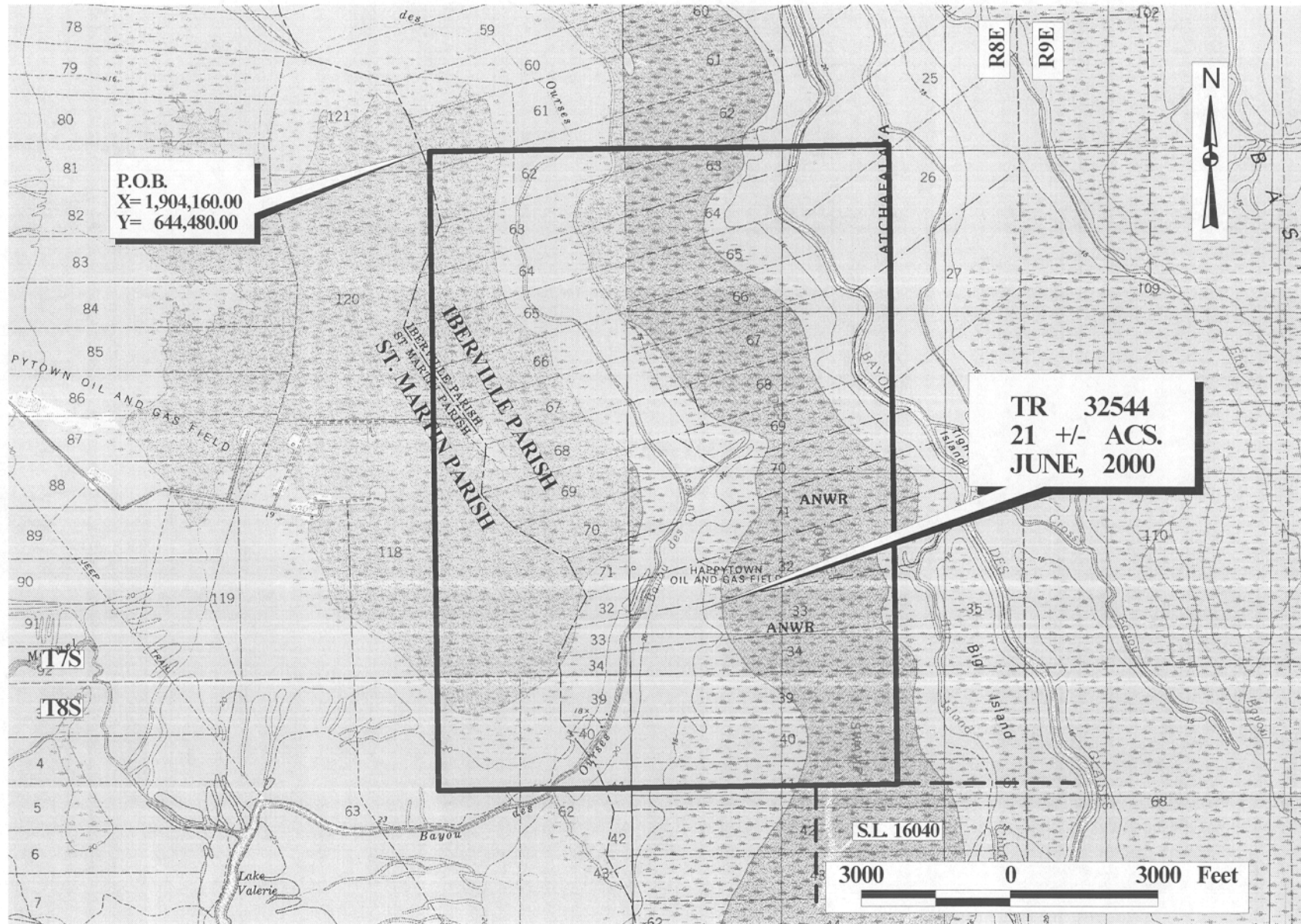

OFFICIAL COPY
OFFICE OF MINERAL RESOURCES
DEPT. OF NATURAL RESOURCES
DO NOT REMOVE

TRACT 32545 - Iberville Parish, Louisiana

All of the lands now or formerly constituting the beds and bottoms of all water bodies of every nature and description and all islands and other lands formed by accretion or reliction, except tax lands, owned by and not under mineral lease from the State of Louisiana on June 14, 2000, situated in Iberville Parish, Louisiana, within the following described boundaries: Beginning at a point having Coordinates of X = 1,913,400.00 and Y = 644,480.00; thence East 9,240.00 feet; thence South 13,000.00 feet to a point having Coordinates of X = 1,922,640.00 and Y = 631,480.00; thence West 3,760.00 feet to the Northeast corner of State Lease No. 16040 having Coordinates of X = 1,918,880.00 and Y = 631,480.00; thence West 5,480.00 feet along the North line of said State Lease No. 16040 to a point having Coordinates of X = 1,913,400.00 and Y = 631,480.00; thence North 13,000.00 feet to the point of beginning, containing approximately 25 acres, as shown outlined in red on a plat on file in the Office of Mineral Resources, Department of Natural Resources. All bearings, distances and coordinates are based on Louisiana Coordinate System of 1927 (South Zone).

Applicant: A.S. Ruffin, Jr.

Bidder	Cash Payment	Price / Acre	Rental	Oil	Gas	Other



OFFICIAL COPY
OFFICE OF MINERAL RESOURCES
DEPT. OF NATURAL RESOURCES
DO NOT REMOVE