

TRACT 32537 - Jefferson Davis Parish, Louisiana

All of the lands now or formerly constituting the beds and bottoms of Calcasieu River and all islands and other lands formed by accretion or reliction, except tax lands, owned by and not under mineral lease from the State of Louisiana on June 14, 2000, situated in Jefferson Davis Parish, Louisiana, within the following described boundaries: That portion of the Calcasieu River bounded on the West or downstream by a North-South line having a Coordinate of X = 1,457,700.00 and bounded on the East or upstream by a North-South line having a Coordinate of X = 1,463,125.00, containing approximately **48 acres**, as shown outlined in red on a plat on file in the Office of Mineral Resources, Department of Natural Resources. All bearings, distances and coordinates are based on Louisiana Coordinate System of 1927 (South Zone).

Applicant: Cash River Exploration, Inc.

Bidder	Cash Payment	Price / Acre	Rental	Oil	Gas	Other

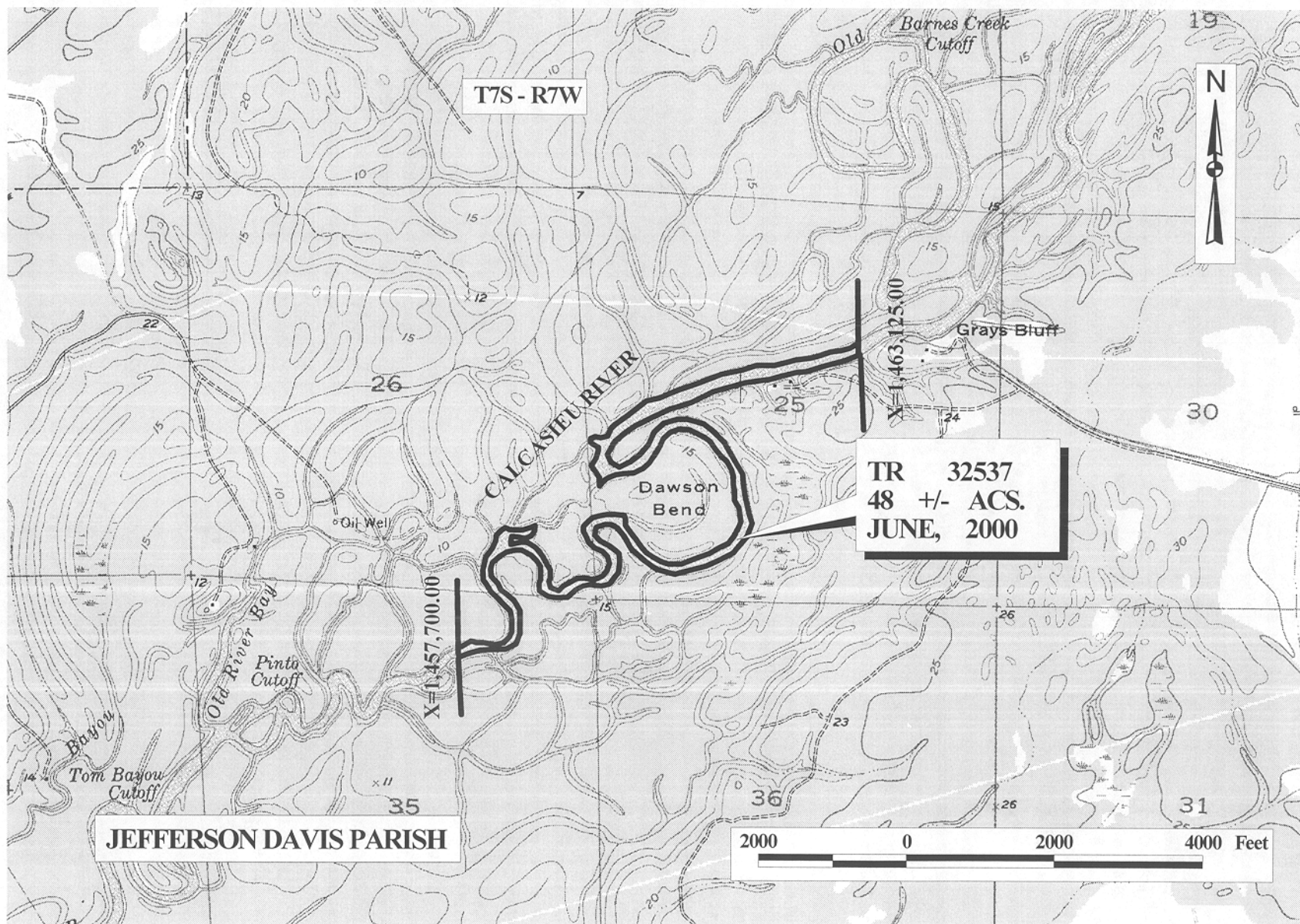

OFFICIAL COPY
OFFICE OF MINERAL RESOURCES
DEPT. OF NATURAL RESOURCES
DO NOT REMOVE

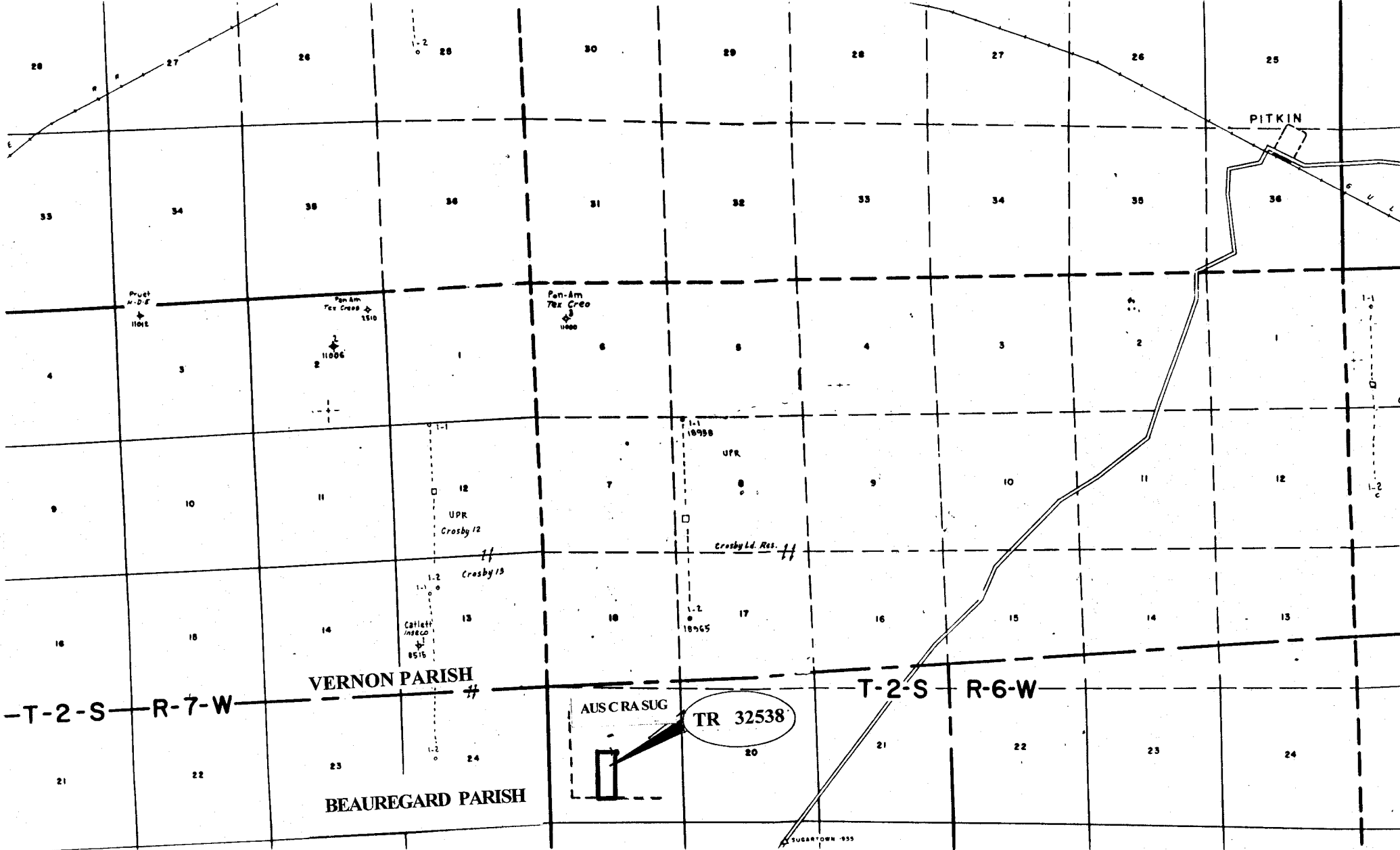

MAP NOT TO SCALE

NOT TO BE USED WITH A PORTION BID
FOR INFORMATIONAL PURPOSES ONLY!

F & A Map Services
Division of PI

TRACT 32538 - Beauregard Parish, Louisiana

All of the right, title and interest of the State of Louisiana in the mineral rights in and to the following described property, which is not under mineral lease from the State of Louisiana on June 14, 2000, situated in Beauregard Parish, Louisiana, and being more fully described as follows: The East Half of the East Half of the Southwest Quarter of Section 19, Township 2 South, Range 6 West, Beauregard Parish, Louisiana, adjudicated to the State of Louisiana for the 1931 unpaid taxes in the name of Henry L. Barington and entered as Homestead No. 340 to W.D. Harper in Patent No. 14135, containing 40 acres, only being that portion of the above described tract lying within the boundaries of sand unit designated as AUS C RA SUG, Commissioners Unit in the Sugartown Field, containing approximately 30.332 acres, as shown outlined in red on a plat on file in the Office of Mineral Resources, Department of Natural Resources.

Applicant: Gene Frasco, CPL

Bidder	Cash Payment	Price / Acre	Rental	Oil	Gas	Other

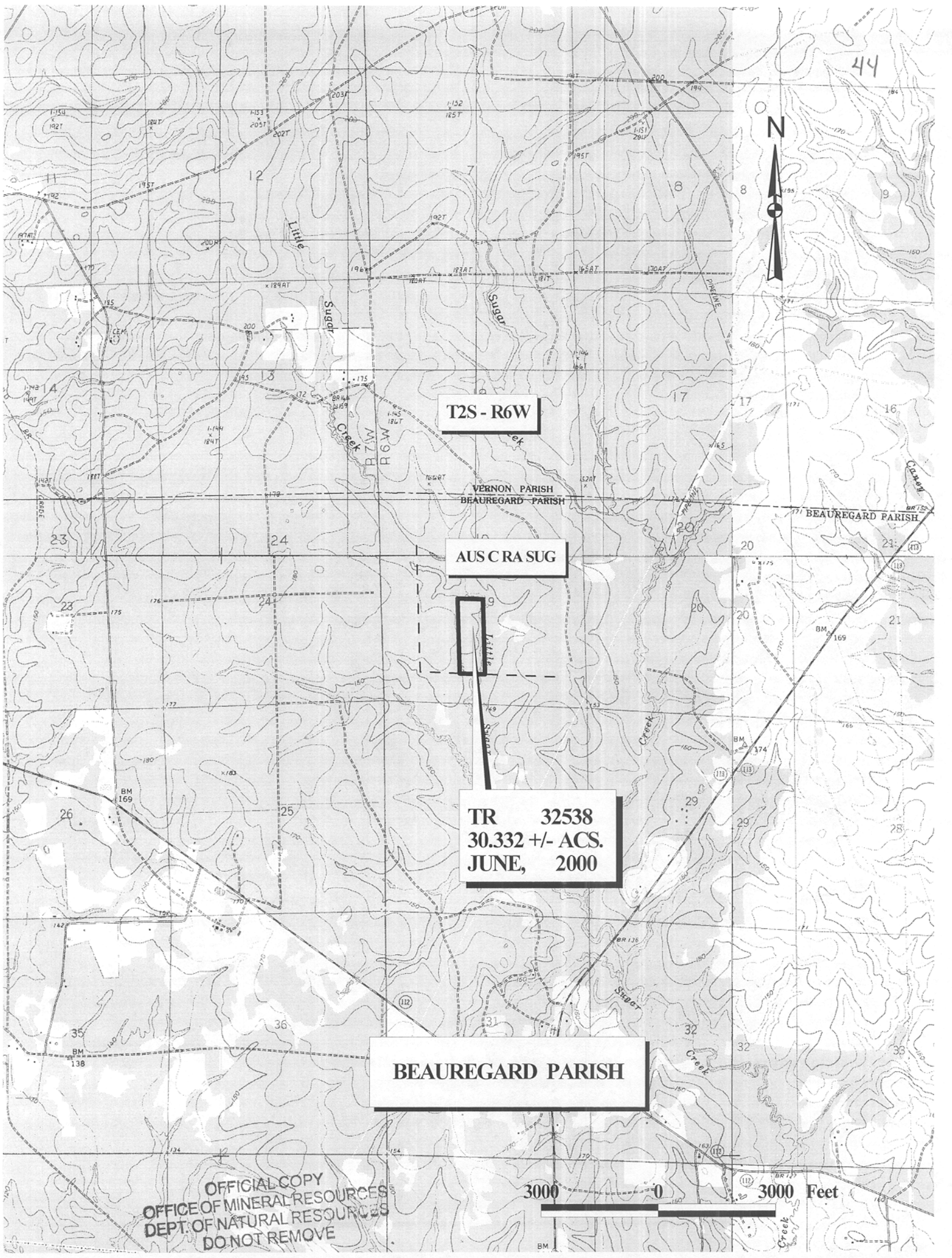

T2S - R6W

AUS CRA SUG

TR 32538
30.332 +/- ACS.
JUNE, 2000

BEAUREGARD PARISH

OFFICIAL COPY
OFFICE OF MINERAL RESOURCES
DEPT. OF NATURAL RESOURCES
DO NOT REMOVE

3000 0 3000 Feet