

TRACT 32584 - Plaquemines Parish, Louisiana

All of the lands now or formerly constituting the beds and bottoms of all water bodies of every nature and description and all islands and other lands formed by accretion or reliction, except tax lands, owned by and not under mineral lease from the State of Louisiana on June 14, 2000, situated in Plaquemines Parish, Louisiana, within the following described boundaries: Beginning at a point having Coordinates of X = 2,600,900.00 and Y = 261,300.00; thence East 2,400.00 feet to a point on the West line of State Lease No. 15939 having Coordinates of X = 2,603,300.00 and Y = 261,300.00; thence South approximately 2,050 feet along said West line of said State Lease No. 15939 to its Southwest corner having a Coordinate of X = 2,603,300.00; thence Southeasterly along the South line of said State Lease No. 15939 to its Southeast corner having a Coordinate of X = 2,609,200.00; thence North approximately 4,850 feet along the East line of said State Lease No. 15939 to a point having Coordinates of X = 2,609,200.00 and Y = 261,300.00; thence East 700 feet; thence South 18,000.00 feet to a point having Coordinates of X = 2,609,900.00 and Y = 243,300.00; thence West 9,000.00 feet; thence North 18,000.00 feet to the point of beginning, **LESS AND EXCEPT** any portion of State Lease No. 15939 that may lie within the above described tract, containing approximately 663 acres, as shown outlined in red on a plat on file in the Office of Mineral Resources, Department of Natural Resources. All bearings, distances and coordinates are based on Louisiana Coordinate System of 1927 (South Zone).

Applicant: D.J. Miller

Bidder	Cash Payment	Price / Acre	Rental	Oil	Gas	Other

P.O.B.
X=2,600,900.00
Y= 261,300.00

S.L. 15939

T20S - R30E

PLAQUEMINES PARISH

TR 32584
663 +/- ACS.
JUNE, 2000

OFFICIAL COPY
OFFICE OF MINERAL RESOURCES
DEPT. OF NATURAL RESOURCES
DO NOT REMOVE

3000 0 3000 Feet

TRACT 32585 - Plaquemines Parish, Louisiana

All of the lands now or formerly constituting the beds and bottoms of all water bodies of every nature and description and all islands and other lands formed by accretion or reliction, except tax lands, owned by and not under mineral lease from the State of Louisiana on June 14, 2000, situated in Plaquemines Parish, Louisiana, within the following described boundaries: Beginning at a point having Coordinates of X = 2,609,900.00 and Y = 261,300.00; thence East 15,000.00 feet; thence South 9,000.00 feet to a point having Coordinates of X = 2,624,900.00 and Y = 252,300.00; thence West 15,000.00 feet; thence North 9,000.00 feet to the point of beginning, **LESS AND EXCEPT** any portion of the Price Case that may lie within the above described tract, containing approximately 200 acres, as shown outlined in red on a plat on file in the Office of Mineral Resources, Department of Natural Resources. All bearings, distances and coordinates are based on Louisiana Coordinate System of 1927 (South Zone).

Applicant: D.J. Miller

Bidder	Cash Payment	Price / Acre	Rental	Oil	Gas	Other

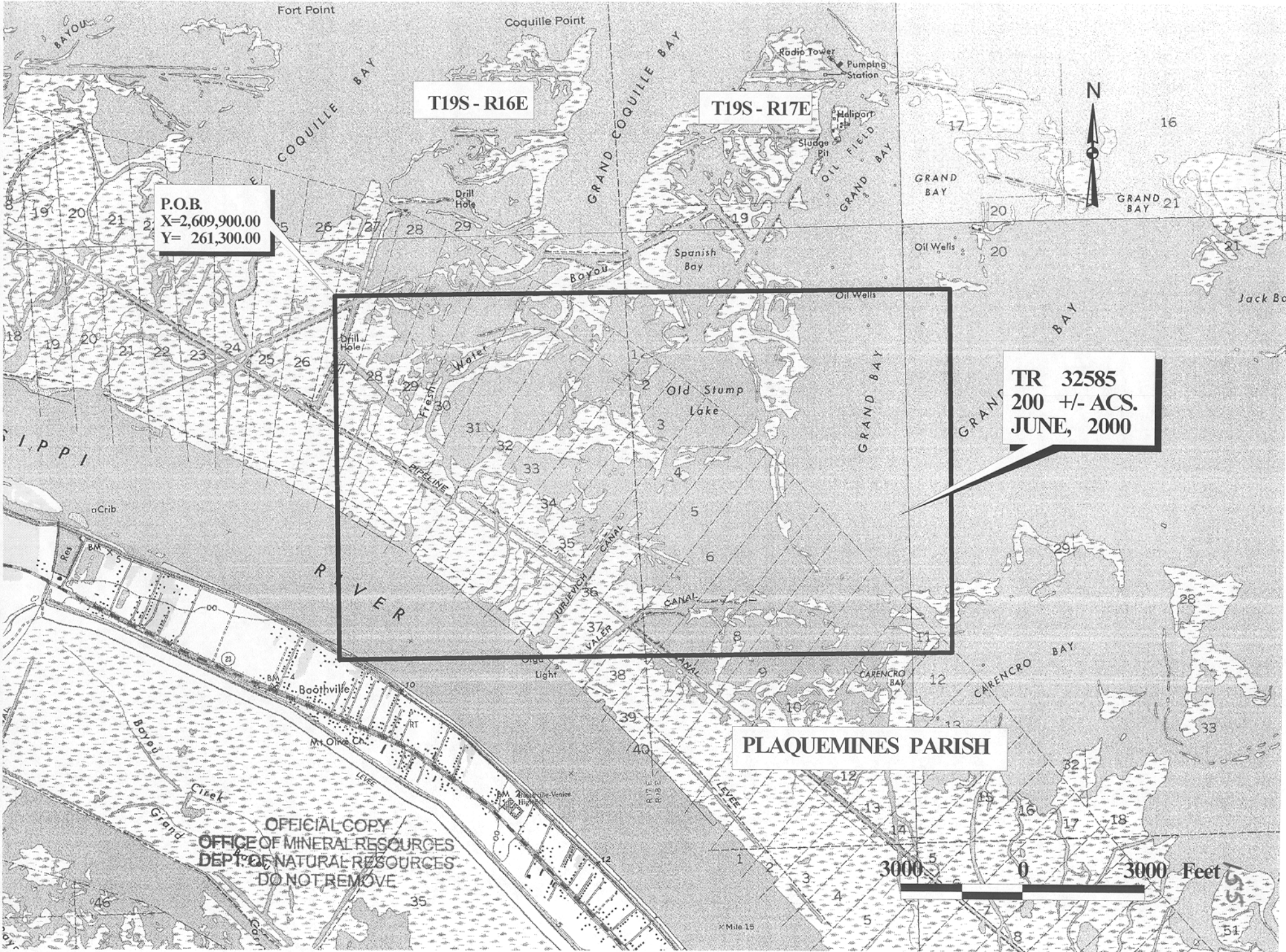

T19S - R16E

T19S - R17E

P.O.B.
X=2,609,900.00
Y= 261,300.00

TR 32585
200 +/- ACS.
JUNE, 2000

PLAQUEMINES PARISH

OFFICIAL COPY
OFFICE OF MINERAL RESOURCES
DEPT. OF NATURAL RESOURCES
DO NOT REMOVE

3000 0 3000 Feet

TRACT 32586 - Plaquemines Parish, Louisiana

All of the lands now or formerly constituting the beds and bottoms of all water bodies of every nature and description and all islands and other lands formed by accretion or reliction, except tax lands, owned by and not under mineral lease from the State of Louisiana on June 14, 2000, situated in Plaquemines Parish, Louisiana, within the following described boundaries: Beginning at a point having Coordinates of X = 2,609,900.00 and Y = 252,300.00; thence East 15,000.00 feet; thence South 9,000.00 feet to a point having Coordinates of X = 2,624,900.00 and Y = 243,300.00; thence West 15,000.00 feet; thence North 9,000.00 feet to the point of beginning, **LESS AND EXCEPT** any portion of the Price Case that may lie within the above described tract, containing approximately **800 acres**, as shown outlined in red on a plat on file in the Office of Mineral Resources, Department of Natural Resources. All bearings, distances and coordinates are based on Louisiana Coordinate System of 1927 (South Zone).

Applicant: D.J. Miller

Bidder	Cash Payment	Price / Acre	Rental	Oil	Gas	Other

P.O.B.
X=2,609,900.00
Y= 252,300.00

TR 32586
800 +/- ACS.
JUNE, 2000

T19S - R17E

T19S - R18E

T20S - R18E

T20S - R17E

PLAQUEMINES PARISH

OFFICIAL COPY
OFFICE OF MINERAL RESOURCES
DEPT. OF NATURAL RESOURCES
DO NOT REMOVE

Platform

N

3000

0

3000 Feet