

TRACT 32582 - Plaquemines Parish, Louisiana

All of the lands now or formerly constituting the beds and bottoms of all water bodies of every nature and description and all islands and other lands formed by accretion or reliction, except tax lands, owned by and not under mineral lease from the State of Louisiana on June 14, 2000, situated in Plaquemines Parish, Louisiana, within the following described boundaries: Beginning at a point having Coordinates of X = 2,582,900.00 and Y = 261,300.00; thence East 6,729.96 feet to a point on the West boundary of State Lease No. 16489 having Coordinates of X = 2,589,629.96 and Y = 261,300.00; thence South 4,231.70 feet along the West boundary of said State Lease No. 16489 to its Southwest corner having Coordinates of X = 2,589,629.96 and Y = 257,068.30; thence East 2,270.04 feet along the South boundary of said State Lease No. 16489 to a point having Coordinates of X = 2,591,900.00 and Y = 257,068.30; thence South 13,768.30 feet to a point having Coordinates of X = 2,591,900.00 and Y = 243,300.00; thence West 9,000.00 feet to a point having Coordinates of X = 2,582,900.00 and Y = 243,300.00; thence North 18,000.00 feet to the point of beginning, **LESS AND EXCEPT** State Lease No. 14267, State Lease No. 14645, as amended, State Lease No. 16660 and State Lease No. 6083, as amended, that lie entirely within the above described tract, containing approximately 400 acres, as shown outlined in red on a plat on file in the Office of Mineral Resources, Department of Natural Resources. All bearings, distances and coordinates are based on Louisiana Coordinate System of 1927 (South Zone).

NOTE: The above tract is located in or near an oyster restricted area and all operations in such area must be conducted in strict conformity with the stipulations and/or regulations of the Louisiana Department of Wildlife and Fisheries.

NOTE: The State of Louisiana does hereby reserve, and this lease shall be subject to, the imprescriptible right of surface use in the nature of a servitude in favor of the Department of Natural Resources, including its Offices and Commissions, for the sole purpose of implementing, constructing, servicing and maintaining approved coastal zone management and/or restoration projects. Utilization of any and all rights derived under this lease by the mineral lessee, its agents, successors or assigns, shall not interfere with nor hinder the reasonable surface use by the Department of Natural Resources, its Offices or Commissions, as hereinabove reserved.

Applicant: D.J. Miller

Bidder	Cash Payment	Price / Acre	Rental	Oil	Gas	Other

P.O.B.
X=2,582,900.00
Y= 261,300.00

T19S - R17E

S.L. 16489

S.L.14267

S.L.14645
S.L.16660

S.L. 6083

T20S - R19E

TR 32582
400 +/- ACS.
JUNE, 2000

PLAQUEMINES PARISH

OFFICIAL COPY
OFFICE OF MINERAL RESOURCES
DEPT. OF NATURAL RESOURCES
DO NOT REMOVE

3000 0 3000 Feet

TRACT 32583 - Plaquemines Parish, Louisiana

All of the lands now or formerly constituting the beds and bottoms of all water bodies of every nature and description and all islands and other lands formed by accretion or reliction, except tax lands, owned by and not under mineral lease from the State of Louisiana on June 14, 2000, situated in Plaquemines Parish, Louisiana, within the following described boundaries: Beginning at a point having Coordinates of X = 2,600,900.00 and Y = 261,300.00; thence South 18,000.00 feet; thence West 9,000.00 feet to a point having Coordinates of X = 2,591,900.00 and Y = 243,300.00; thence North 13,768.30 feet to a point on the most Southern boundary of State Lease No. 16489 having Coordinates of X = 2,591,900.00 and Y = 257,068.30; thence along the boundaries of said State Lease No. 16489 the following courses: East 2,029.96 feet, North 12 degrees 01 minutes 43 seconds West 1,700.00 feet, North 89 degrees 25 minutes 32 seconds East 2,717.19 feet and North 2,541.79 feet to a point having Coordinates of X = 2,596,292.73 and Y = 261,300.00; thence East 4,607.27 feet to the point of beginning, **LESS AND EXCEPT** State Lease No. 15406 which falls entirely within the above described tract, containing approximately 501 acres, as shown outlined in red on a plat on file in the Office of Mineral Resources, Department of Natural Resources. All bearings, distances and coordinates are based on Louisiana Coordinate System of 1927 (South Zone).

NOTE: The above tract is located in or near an oyster restricted area and all operations in such area must be conducted in strict conformity with the stipulations and/or regulations of the Louisiana Department of Wildlife and Fisheries.

NOTE: The State of Louisiana does hereby reserve, and this lease shall be subject to, the imprescriptible right of surface use in the nature of a servitude in favor of the Department of Natural Resources, including its Offices and Commissions, for the sole purpose of implementing, constructing, servicing and maintaining approved coastal zone management and/or restoration projects. Utilization of any and all rights derived under this lease by the mineral lessee, its agents, successors or assigns, shall not interfere with nor hinder the reasonable surface use by the Department of Natural Resources, its Offices or Commissions, as hereinabove reserved.

Applicant: D.J. Miller

Bidder	Cash Payment	Price / Acre	Rental	Oil	Gas	Other

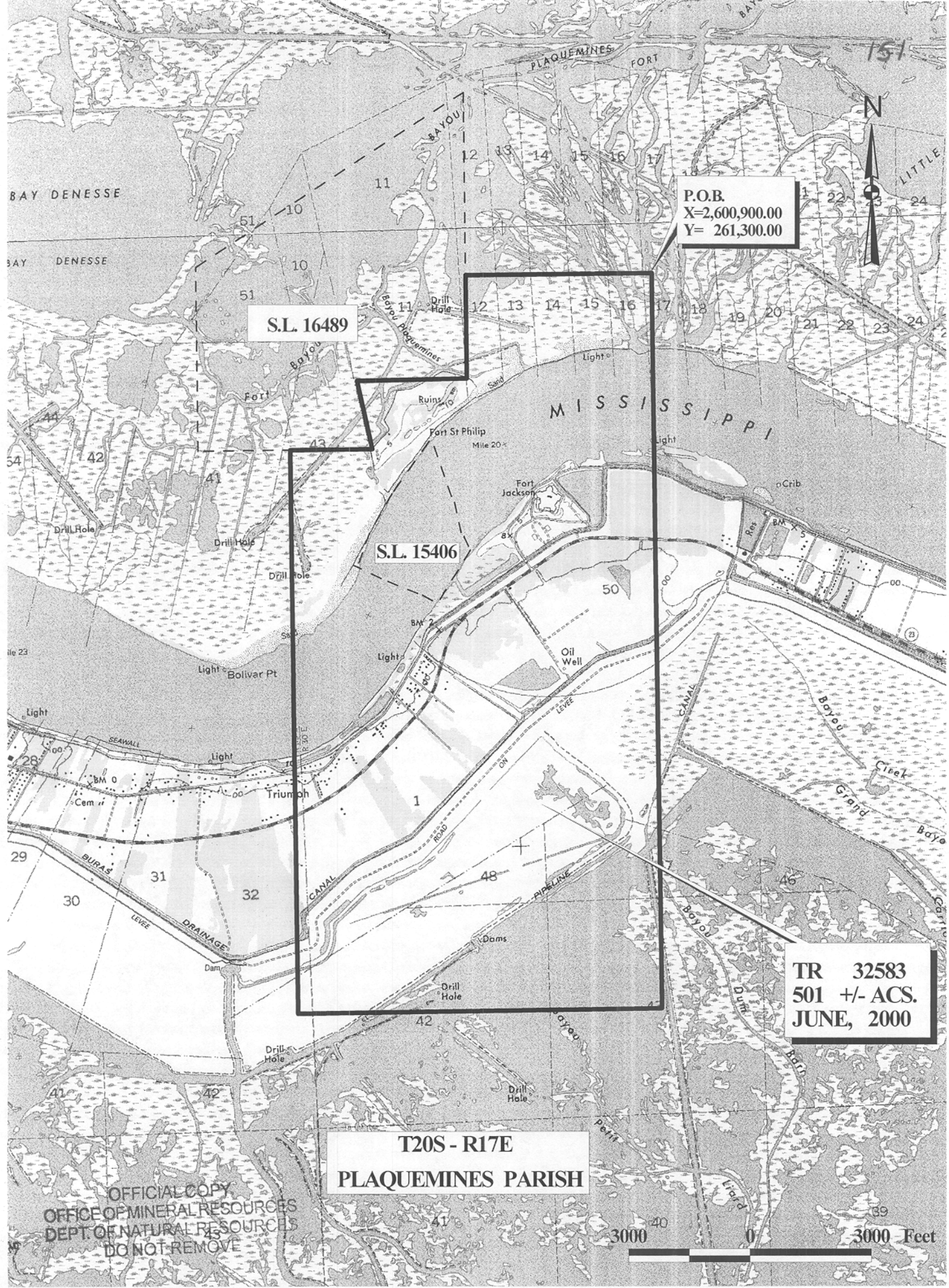

P.O.B.
X=2,600,900.00
Y= 261,300.00

S.L. 16489

S.L. 15406

TR 32583
501 +/- ACS.
JUNE, 2000

T20S - R17E
PLAQUEMINES PARISH

OFFICIAL COPY
OFFICE OF MINERAL RESOURCES
DEPT. OF NATURAL RESOURCES
DO NOT REMOVE

3000 0 3000 Feet