

TRACT 32576 - Lafourche Parish, Louisiana

All of the lands now or formerly constituting the beds and bottoms of Bayou Lafourche and all islands and other lands formed by accretion or reliction, except tax lands, owned by and not under mineral lease from the State of Louisiana on June 14, 2000, situated in Lafourche Parish, Louisiana, within the following described boundaries: All of Bayou Lafourche bounded on the West or upstream side by a North-South line having a Coordinate of X = 2,217,476.09 and on the East or downstream side by a North-South line having a Coordinate of X = 2,233,316.09, containing approximately **47 acres**, as shown outlined in red on a plat on file in the Office of Mineral Resources, Department of Natural Resources. All bearings, distances and coordinates are based on Louisiana Coordinate System of 1927 (South Zone).

Applicant: Chalk Oil

Bidder	Cash Payment	Price / Acre	Rental	Oil	Gas	Other

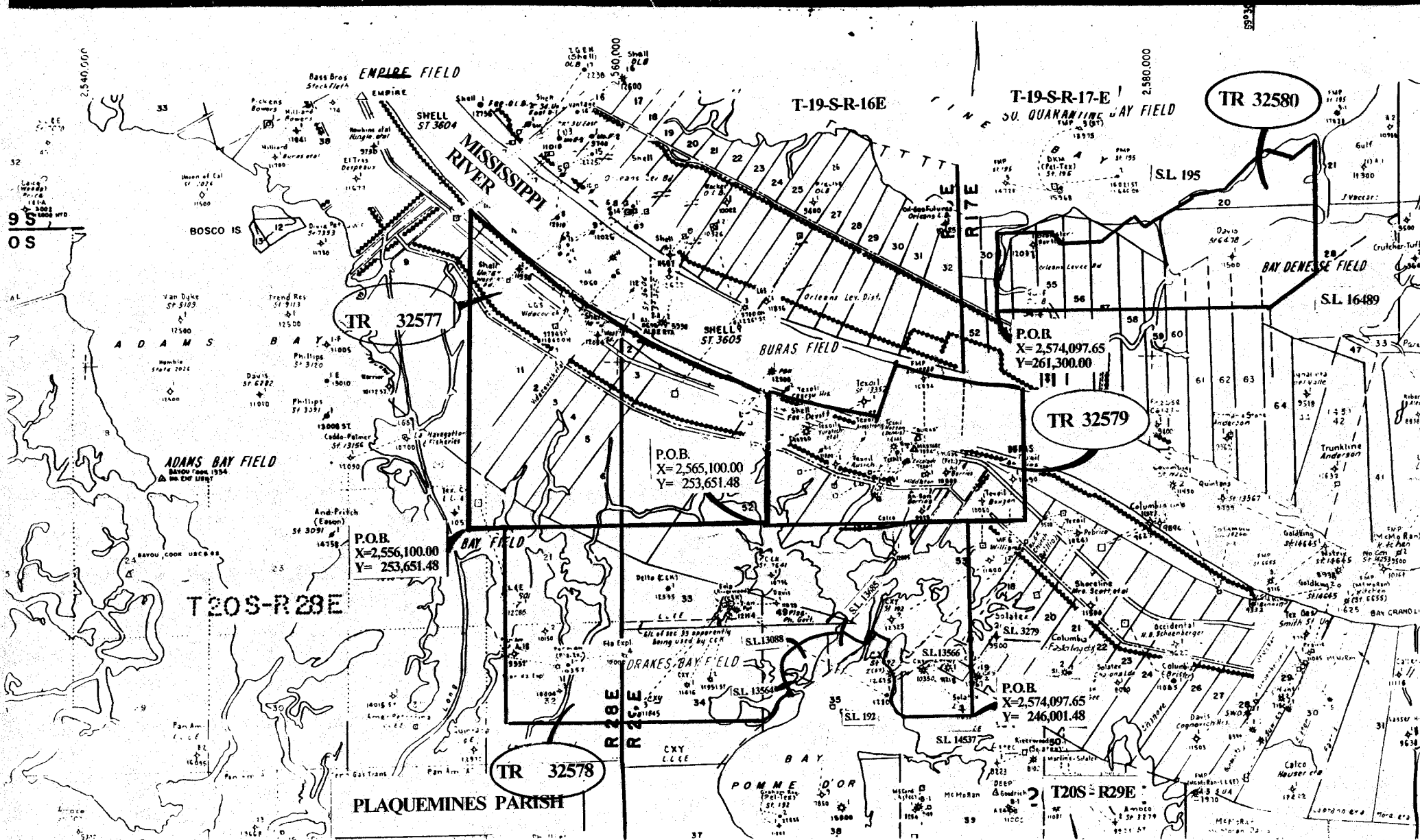

MAP NOT TO SCALE

NOT TO BE USED WITH A PORTION BID
FOR INFORMATIONAL PURPOSES ONLY!

T & A Map Services
Division of PI

TRACT 32577 - Plaquemines Parish, Louisiana

All of the lands now or formerly constituting the beds and bottoms of all water bodies of every nature and description and all islands and other lands formed by accretion or reliction, except tax lands, owned by and not under mineral lease from the State of Louisiana on June 14, 2000, situated in Plaquemines Parish, Louisiana, within the following described boundaries: Beginning at a point having Coordinates of X = 2,556,100.00 and Y = 253,651.48; thence North approximately 10,530 feet to the right descending bank of the Mississippi River; thence Southeasterly along the said right descending bank of the Mississippi River to a point having a Coordinate of X = 2,565,100.00; thence South approximately 5,100 feet to a point having Coordinates of X = 2,565,100.00 and Y = 253,651.48; thence West 9,000.00 feet to the point of beginning, containing approximately 20 acres, as shown outlined in red on a plat on file in the Office of Mineral Resources, Department of Natural Resources. All bearings, distances and coordinates are based on Louisiana Coordinate System of 1927 (South Zone).

NOTE: The above tract is located in or near an oyster restricted area and all operations in such area must be conducted in strict conformity with the stipulations and/or regulations of the Louisiana Department of Wildlife and Fisheries.

NOTE: The State of Louisiana does hereby reserve, and this lease shall be subject to, the imprescriptible right of surface use in the nature of a servitude in favor of the Department of Natural Resources, including its Offices and Commissions, for the sole purpose of implementing, constructing, servicing and maintaining approved coastal zone management and/or restoration projects. Utilization of any and all rights derived under this lease by the mineral lessee, its agents, successors or assigns, shall not interfere with nor hinder the reasonable surface use by the Department of Natural Resources, its Offices or Commissions, as hereinabove reserved.

Applicant: D.J. Miller

Bidder	Cash Payment	Price / Acre	Rental	Oil	Gas	Other

MISSISSIPPI
RIVER



TR 32577
20 +/-ACS.
JUNE, 2000

P.O.B.
X=2,556,100.00
Y= 253,651.48

T20S - R28E

T20S - R29E

PLAQUEMINES PARISH

OFFICIAL COPY
OFFICE OF MINERAL RESOURCES
DEPT. OF NATURAL RESOURCES
DO NOT REMOVE

3000 0 3000 Feet