

**TRACT 32396 - PORTION OF BLOCK 14, VERMILION AREA, REVISED, Vermilion Parish, Louisiana**

That portion of Block 14, Vermilion Area, Revised, Vermilion Parish, Louisiana, belonging to the State of Louisiana and not under mineral lease on March 8, 2000, described as follows: Beginning at the Northeast corner of Block 14, Vermilion Area, Revised, having Coordinates of X = 1,691,656.32 and Y = 311,024.77; thence South 5,449.65 feet to the boundary of State Lease No. 861, as amended; thence North 45 degrees 09 minutes 47 seconds West 7,729.00 feet on the boundary of said State Lease No. 861 to the North line of said Block 14; thence East 5,480.76 feet to the point of beginning, containing approximately **342.84 acres**, as shown outlined in red on a plat on file in the Office of Mineral Resources, Department of Natural Resources. All bearings, distances and coordinates are based on Louisiana Coordinate System of 1927 (South Zone).

NOTE: The State of Louisiana does hereby reserve, and this lease shall be subject to, the imprescriptible right of surface use in the nature of a servitude in favor of the Department of Natural Resources, including its Offices and Commissions, for the sole purpose of implementing, constructing, servicing and maintaining approved coastal zone management and/or restoration projects. Utilization of any and all rights derived under this lease by the mineral lessee, its agents, successors or assigns, shall not interfere with nor hinder the reasonable surface use by the Department of Natural Resources, its Offices or Commissions, as hereinabove reserved.

Applicant: Brigham Oil & Gas, L.P.

Bidder	Cash Payment	Price / Acre	Rental	Oil	Gas	Other

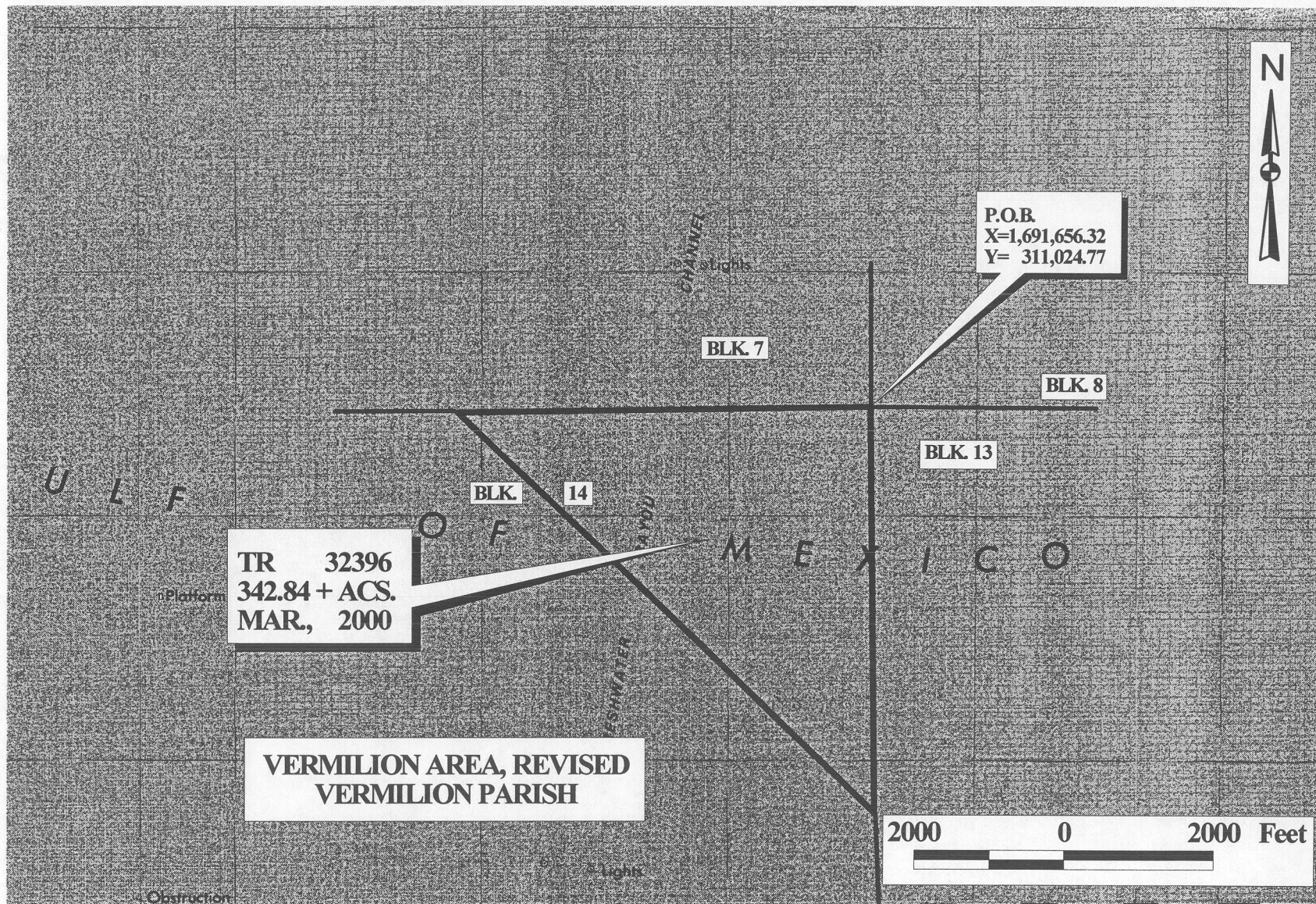

OFFICIAL COPY  
OFFICE OF MINERAL RESOURCES  
DEPT. OF NATURAL RESOURCES  
DO NOT REMOVE