

NOT TO BE USED WITH A PORTION BID
FOR INFORMATIONAL PURPOSES ONLY!

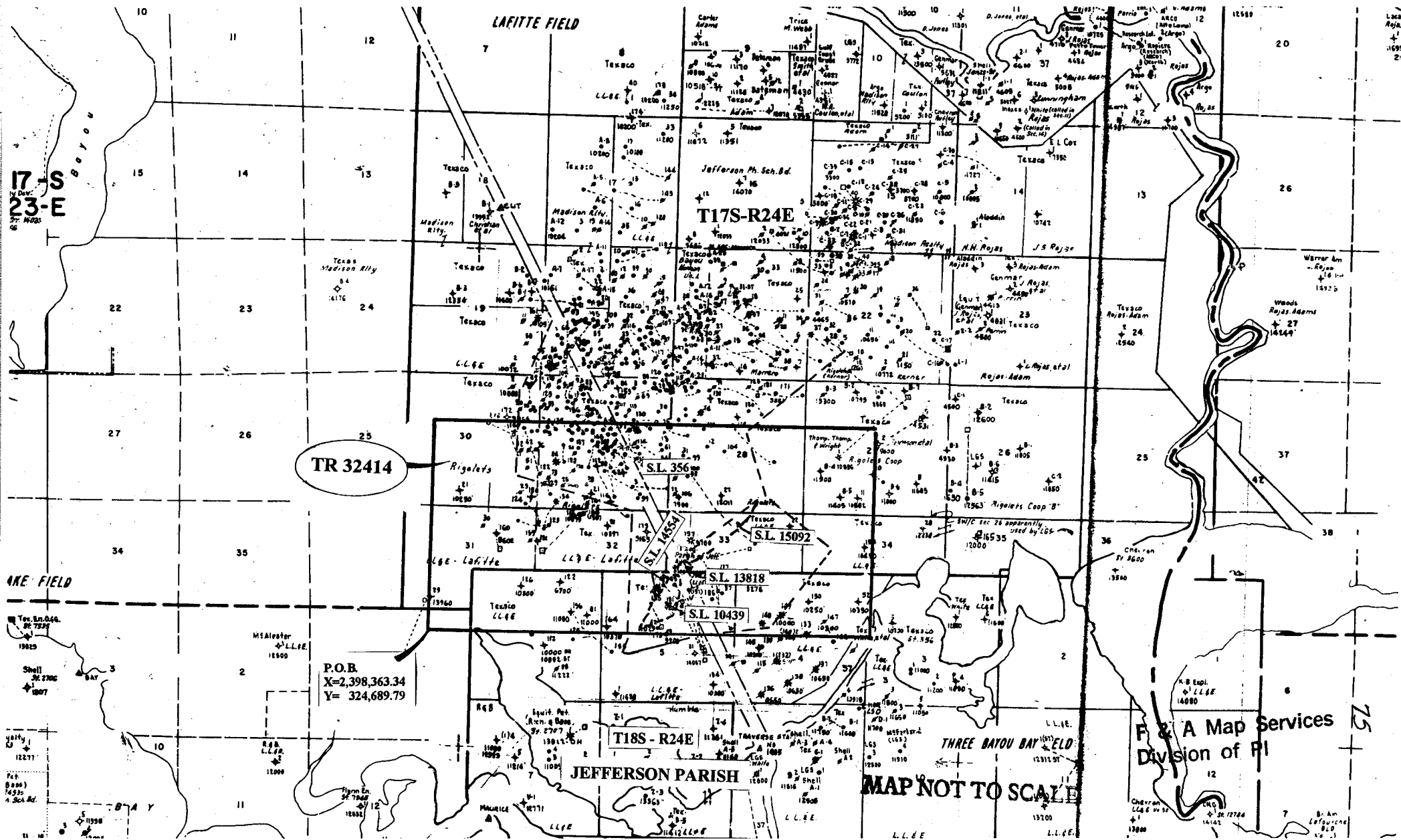

TRACT 32414 - Jefferson Parish, Louisiana

All of the lands now or formerly constituting the beds and bottoms of all water bodies of every nature and description and all islands and other lands formed by accretion or reliction, except tax lands, owned by and not under mineral lease from the State of Louisiana on March 8, 2000, situated in Jefferson Parish, Louisiana, within the following described boundaries: Beginning at a point having Coordinates of X = 2,398,363.34 and Y = 324,689.79; thence North 8,350.00 feet to a point having Coordinates of X = 2,398,363.34 and Y = 333,039.79; thence East 17,600.00 feet to a point having Coordinates of X = 2,415,963.34 and Y = 333,039.79; thence South 8,350.00 feet to a point having Coordinates of X = 2,415,963.34 and Y = 324,689.79; thence West 17,600.00 feet to the point of beginning, **LESS AND EXCEPT** all those portions of State Lease No. 356, as amended, State Lease No. 10439, as amended, State Lease No. 13818, as amended, State Lease No. 14554 and State Lease No. 15092, as amended, that lie within the above described tract, containing approximately 56 acres, as shown outlined in red on a plat on file in the Office of Mineral Resources, Department of Natural Resources. All bearings, distances and coordinates are based on Louisiana Coordinate System of 1927 (South Zone).

NOTE: The above tract is located in or near an oyster restricted area and all operations in such area must be conducted in strict conformity with the stipulations and/or regulations of the Louisiana Department of Wildlife and Fisheries.

NOTE: The State of Louisiana does hereby reserve, and this lease shall be subject to, the imprescriptible right of surface use in the nature of a servitude in favor of the Department of Natural Resources, including its Offices and Commissions, for the sole purpose of implementing, constructing, servicing and maintaining approved coastal zone management and/or restoration projects. Utilization of any and all rights derived under this lease by the mineral lessee, its agents, successors or assigns, shall not interfere with nor hinder the reasonable surface use by the Department of Natural Resources, its Offices or Commissions, as hereinabove reserved.

Applicant: Stone Energy Corporation

Bidder	Cash Payment	Price / Acre	Rental	Oil	Gas	Other

TR 32414
56 + ACS.
MAR, 2000

T17S - R24E



S.L. 356

P.O.B.
X=2,398,363.34
Y= 324,689.79

S.L. 15092

S.L. 14554

S.L. 13818

S.L. 10439

T18S - R24E

JEFFERSON PARISH

2000 0 2000 Feet