

TRACT 37160 - Plaquemines Parish, Louisiana

All State owned lands and water bottoms located within the boundaries of the Pass-A-Loutre Wildlife Management Area as defined by the Department of Wildlife and Fisheries incorporating a title opinion from the Office of the Governor dated August 3, 1998, not presently under mineral lease by the State of Louisiana on February 9, 2005, all as set forth following: Beginning at a point on the Northern boundary of the Pass-A-Loutre Wildlife Management Area having Coordinates of X = 2,728,512.77 and Y = 211,553.19; thence Easterly on an arc having a Radius of 19,550.00 feet and centered at X = 2,731,935.94 and Y = 192,305.22 to a point having Coordinates of X = 2,739,419.00 and Y = 210,366.40; thence Southeasterly on an arc having a radius of 21,825.00 feet and centered at X = 2,725,759.55 and Y = 193,344.35 to a point on the Western boundary of the Eastern portion of State Lease No. 988, as amended, having Coordinates of X = 2,741,447.13 and Y = 208,517.70; thence along the boundary of said State Lease No. 988 the following: South 33 degrees 41 minutes 24 seconds West 6,665.10 feet and East 2,302.40 feet to a point on the South line of said State Lease No. 988, having Coordinates of X = 2,740,052.40 and Y = 202,972.00; thence South 1,127.08 feet to a point having Coordinates of X = 2,740,052.40 and Y = 201,844.92; thence West 11,539.63 feet to a point having Coordinates of X = 2,728,512.77 and Y = 201,844.92; thence North 9,708.27 feet to the point of beginning, containing approximately 2,498.61 gross acres and **2,304.00 net acres, LESS AND EXCEPT** any privately owned land that may be located within the above described Tract, if any, comprising approximately 194.61 acres, leaving a total of 2,304 net acres of State owned land and water bottoms within the above described Tract, all as more particularly outlined on a plat on file in the Office of Mineral Resources, Department of Natural Resources. All bearings, distances and coordinates are based on Louisiana Coordinate System of 1927, (South Zone).

NOTE: The above description of the Tract nominated for lease has been provided and corrected, where required, exclusively by the nomination party. Any mineral lease selected from this Tract and awarded by the Louisiana State Mineral Board shall be without warranty of any kind, either express, implied, or statutory, including, but not limited to, the implied warranties of merchantability and fitness for a particular purpose. Should the mineral lease awarded by the Louisiana State Mineral Board be subsequently modified, cancelled or abrogated due to the existence of conflicting leases, operating agreements, private claims or other future obligations or conditions which may affect all or any portion of the leased Tract, it shall not relieve the Lessee of the obligation to pay any bonus due thereon to the Louisiana State Mineral Board, nor shall the Louisiana State Mineral Board be obligated to refund any consideration paid by the Lessor prior to such modification, cancellation, or abrogation, including, but not limited to, bonuses, rentals and royalties.

NOTE: The Office of Mineral Resources will require a minimum bonus of \$350 per acre and a minimum royalty of 25%.

NOTE: The mineral lease is located within the Pass A Loutre WMA under the jurisdiction of the Louisiana Department of Wildlife and Fisheries which has promulgated rules and regulations for the protection of game and wildlife on the aforesaid Tract and, therefore, shall be subject to said rules and regulations, a copy of which shall be attached to the mineral lease. In addition to the specific rules and regulations applicable, the following shall apply regarding operations under this mineral lease:

1. No activities will be allowed without written authorization from the Louisiana Department of Wildlife and Fisheries. All projects will be coordinated and approved by the Pass-A-Loutre WMA Supervisor prior to any activities on the wildlife management area.
2. Proposed projects will be evaluated on a case by case basis. Modifications to proposed project features including but not limited to access routes, well sites, flow lines and other appurtenant structures may be required unless otherwise specified by the Department.
3. Compliance with the said WMA regulations will be required unless otherwise specified by the Department.
4. Compensatory mitigation will be required to offset avoidable habitat impacts.
5. Removal of all structures, facilities and equipment will be required within 120 days of abandonment unless otherwise agreed to the Department.
6. No activities will be allowed during the hunting season unless approved by the Department.
7. Prior to submitting applications for wetland permits to Federal and State permitting agencies, the leaseholder shall coordinate project details with the Department. Contact person for the Department will be Mike Windham at (504) 568-5886.

NOTE: The State of Louisiana does hereby reserve, and this lease shall be subject to, the imprescriptible right of surface use in the nature of a servitude in favor of the Department of Natural Resources, including its Offices and Commissions, for the sole purpose of implementing, constructing, servicing and maintaining approved coastal zone management and/or restoration projects. Utilization of any and all rights derived under this lease by the mineral lessee, its agents, successors or assigns, shall not interfere with nor hinder the reasonable surface use by the Department of Natural Resources, its Offices or Commissions, as herein above reserved.

NOTE: The Department of Wildlife and Fisheries has designated certain areas in the coastal waters of the State of Louisiana as Oyster Seed Bed Areas. The exact location of those Seed Bed Areas must be obtained from the Department of Wildlife and Fisheries and any work done under a mineral lease from the State of Louisiana may necessarily be conducted in conformity with the rules and regulations promulgated by the said Department of Wildlife and Fisheries for Oyster Seed Bed Areas.

Applicant: Leslie M. Cooper

Bidder	Cash Payment	Price/Acre	Rental	Oil	Gas	Other

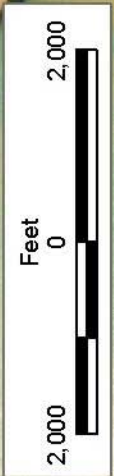
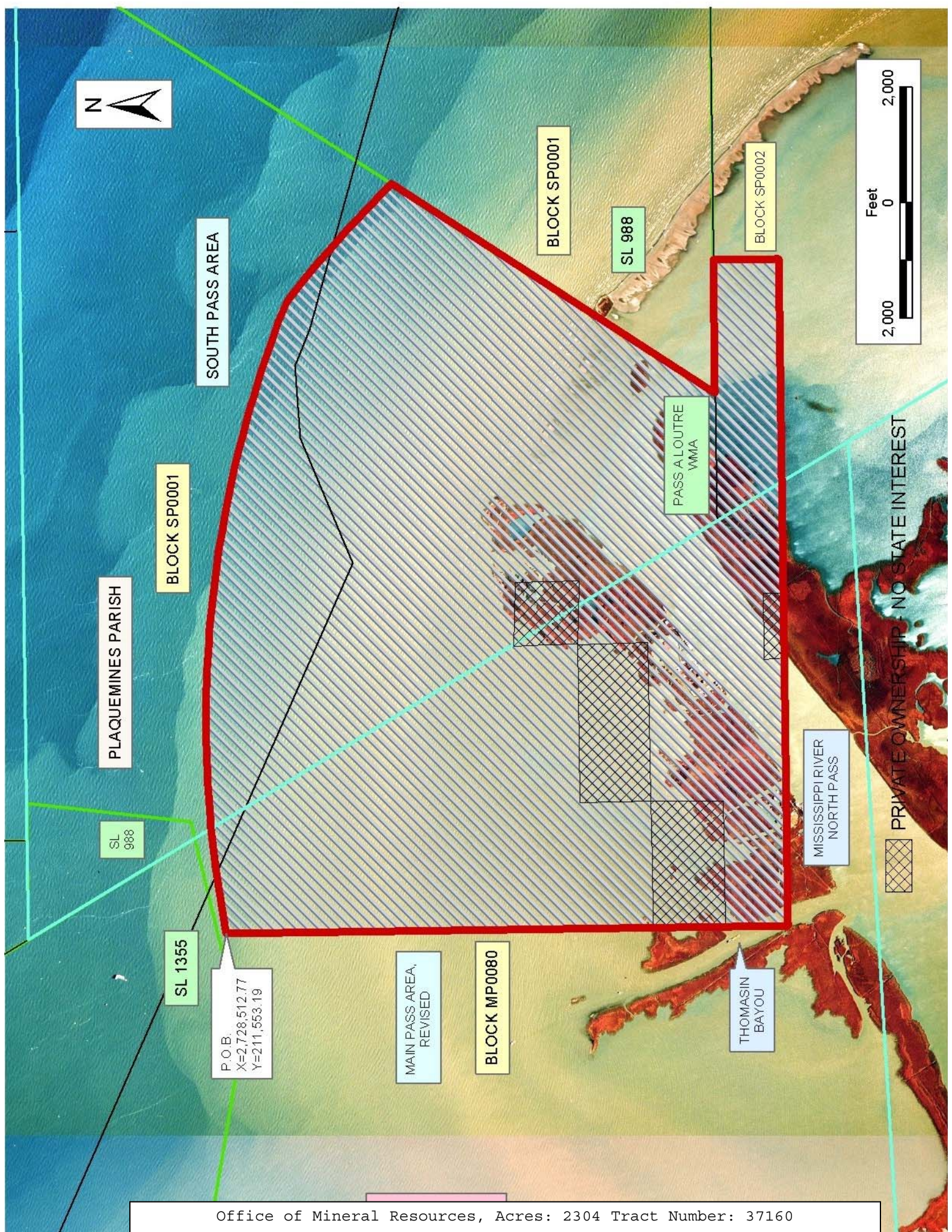

PLAQUEMINES PARISH

SOUTH PASS AREA

BLOCK SP0001

BLOCK SP0001

SL 988

BLOCK SP0002

PASS A LOUTRE
VMA

MISSISSIPPI RIVER
NORTH PASS

PRIVATE OWNERSHIP - NO STATE INTEREST

SL 988

SL 1355

P.O.B.
X=2,728,512.77
Y=211,553.19

MAIN PASS AREA,
REVISED

BLOCK MP0080

THOMASIN
BAYOU

TRACT 37161 - Plaquemines Parish, Louisiana

All State owned lands and water bottoms located within the boundaries of the Pass-A-Loutre Wildlife Management Area as defined by the Department of Wildlife and Fisheries incorporating a title opinion from the Office of the Governor dated August 3, 1998, not presently under mineral lease by the State of Louisiana on February 9, 2005, all as set forth following: Beginning at a point on the Northern boundary of the Pass-A-Loutre Wildlife Management Area having Coordinates of X = 2,728,512.77 and Y = 211,553.19; thence South 9,702.27 feet to a point having Coordinates of X = 2,728,512.77 and Y = 201,844.92; thence West 10,717.77 feet to a point having Coordinates of X = 2,717,795.00 and Y = 201,844.92 being a point on the West line of said Pass-A-Loutre Wildlife Management Area; thence along the boundary of said Pass-A-Loutre Wildlife Management Area the following: North 02 degrees 28 minutes 20 seconds West 325.53 feet, North 12 degrees 41 minutes 24 seconds West 2,972.05 feet to a point having Coordinates of X = 2,717,128.07 and Y = 205,069.60 and Northeasterly along an arc having a Radius of 19,550.00 feet and a center at X = 2,731,935.94 and Y = 192,305.22 to the point of beginning, containing approximately 1,891.35 gross acres and **1,866.00 net acres, LESS AND EXCEPT** any privately owned land that may be located within the above described Tract, if any, comprising approximately 25.35 acres, leaving a total of 1,866 net acres of State owned land and water bottoms within the above described Tract, all as more particularly outlined on a plat on file in the Office of Mineral Resources, Department of Natural Resources. All bearings, distances and coordinates are based on Louisiana Coordinate System of 1927, (South Zone).

NOTE: The above description of the Tract nominated for lease has been provided and corrected, where required, exclusively by the nomination party. Any mineral lease selected from this Tract and awarded by the Louisiana State Mineral Board shall be without warranty of any kind, either express, implied, or statutory, including, but not limited to, the implied warranties of merchantability and fitness for a particular purpose. Should the mineral lease awarded by the Louisiana State Mineral Board be subsequently modified, cancelled or abrogated due to the existence of conflicting leases, operating agreements, private claims or other future obligations or conditions which may affect all or any portion of the leased Tract, it shall not relieve the Lessee of the obligation to pay any bonus due thereon to the Louisiana State Mineral Board, nor shall the Louisiana State Mineral Board be obligated to refund any consideration paid by the Lessor prior to such modification, cancellation, or abrogation, including, but not limited to, bonuses, rentals and royalties.

NOTE: The Office of Mineral Resources will require a minimum bonus of \$350 per acre and a minimum royalty of 25%.

NOTE: The mineral lease is located within the Pass A Loutre WMA under the jurisdiction of the Louisiana Department of Wildlife and Fisheries which has promulgated rules and regulations for the protection of game and

wildlife on the aforesaid Tract and, therefore, shall be subject to said rules and regulations, a copy of which shall be attached to the mineral lease. In addition to the specific rules and regulations applicable, the following shall apply regarding operations under this mineral lease:

1. No activities will be allowed without written authorization from the Louisiana Department of Wildlife and Fisheries. All projects will be coordinated and approved by the Pass-A-Loutre WMA Supervisor prior to any activities on the wildlife management area.
2. Proposed projects will be evaluated on a case by case basis. Modifications to proposed project features including but not limited to access routes, well sites, flow lines and other appurtenant structures may be required unless otherwise specified by the Department.
3. Compliance with the said WMA regulations will be required unless otherwise specified by the Department.
4. Compensatory mitigation will be required to offset avoidable habitat impacts.
5. Removal of all structures, facilities and equipment will be required within 120 days of abandonment unless otherwise agreed to the Department.
6. No activities will be allowed during the hunting season unless approved by the Department.
7. Prior to submitting applications for wetland permits to Federal and State permitting agencies, the leaseholder shall coordinate project details with the Department. Contact person for the Department will be Mike Windham at (504) 568-5886.

NOTE: The State of Louisiana does hereby reserve, and this lease shall be subject to, the imprescriptible right of surface use in the nature of a servitude in favor of the Department of Natural Resources, including its Offices and Commissions, for the sole purpose of implementing, constructing, servicing and maintaining approved coastal zone management and/or restoration projects. Utilization of any and all rights derived under this lease by the mineral lessee, its agents, successors or assigns, shall not interfere with nor hinder the reasonable surface use by the Department of Natural Resources, its Offices or Commissions, as herein above reserved.

NOTE: The Department of Wildlife and Fisheries has designated certain areas in the coastal waters of the State of Louisiana as Oyster Seed Bed Areas. The exact location of those Seed Bed Areas must be obtained from the Department of Wildlife and Fisheries and any work done under a mineral lease from the State of Louisiana may necessarily be conducted in conformity with the rules and regulations promulgated by the said Department of Wildlife and Fisheries for Oyster Seed Bed Areas.

Applicant: Leslie M. Moore

Bidder	Cash Payment	Price/Acre	Rental	Oil	Gas	Other

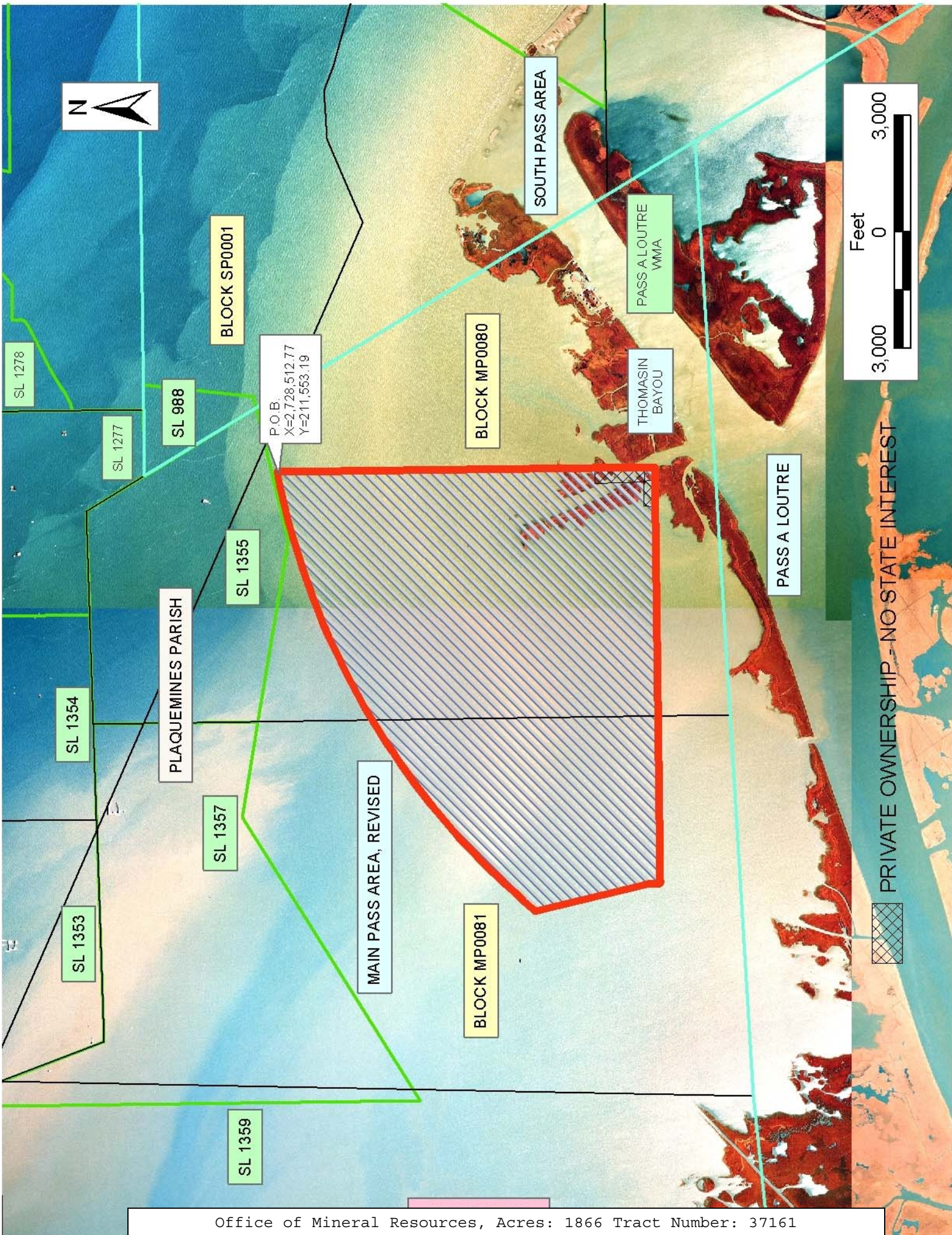

P.O.B.
 X=2,728,512.77
 Y=211,553.19

PRIVATE OWNERSHIP - NO STATE INTEREST

MAIN PASS AREA, REVISED

SOUTH PASS AREA

PASS A LOUTRE WMA

THOMASIN BAYOU

PASS A LOUTRE

BLOCK SP0001

BLOCK MP0080

BLOCK MP0081

PLAQUEMINES PARISH

SL 1278

SL 1277

SL 988

SL 1355

SL 1357

SL 1359

SL 1354

SL 1353