

TRACT 39541 - Portion of Block 6, Bay Marchand Area, and Block 15, South Timbalier Area, Revised, Lafourche Parish, Louisiana

The beds and bottoms of all water bodies belonging to the State of Louisiana located in Block 6, Bay Marchand Area, and Block 15, South Timbalier Area, Revised, together with any present lands formed by accretion to the shoreline or islands formed therein, located in Lafourche Parish, Louisiana, owned by and not presently under mineral lease as of January 9, 2008, from the State of Louisiana, the geographical area of which is more fully described as follows: Beginning at a point within Block 15, South Timbalier Area, Revised, also being a point on the Southern boundary of State Lease No. 1772, as amended, having Coordinates of X = 2,318,195.27 and Y = 142,701.00; thence along the boundary of said State Lease No. 1772 the following courses: South 89 degrees 58 minutes 33 seconds East 195.70 feet to a point having Coordinates of X = 2,318,390.97 and Y = 142,700.92 and North 67 degrees 05 minutes 13 seconds East 8,227.13 feet to its Easternmost Southeast corner located on the West boundary of State Lease No. 192, as amended, having Coordinates of X = 2,325,968.95 and Y = 145,904.02; thence South 21 degrees 37 minutes 47 seconds East 4,100.00 feet along the West boundary of said State Lease No. 192, as amended, to its Southwest corner having Coordinates of X = 2,327,480.24 and Y = 142,092.72; thence South 00 degrees 00 minutes 01 seconds West 7,762.72 feet to a point on the South line of Block 6, Bay Marchand Area, having Coordinates of X = 2,327,480.19 and Y = 134,330.00; thence West 12,654.83 feet to a point on the South line of said Block 15, also being the Southeast corner of State Lease No. 18773 having Coordinates of X = 2,314,825.36 and Y = 134,330.00; thence along the boundary of said State Lease No. 18773 the following courses: North 00 degrees 32 minutes 40 seconds East 1,751.08 feet to a point having Coordinates of X = 2,314,842.00 and Y = 136,081.00; North 72 degrees 16 minutes 00 seconds East 3,874.08 feet to a point having Coordinates of X = 2,318,532.00 and Y = 137,261.00; North 17 degrees 13 minutes 23 seconds West 1,121.28 feet to a point having Coordinates of X = 2,318,200.00 and Y = 138,332.00; North 71 degrees 32 minutes 07 seconds East 1,743.92 feet to a point having Coordinates of X = 2,319,854.14 and Y = 138,884.34 and North 1,597.92 feet to its Easternmost Northeast corner having Coordinates of X = 2,319,854.14 and Y = 140,482.26; thence North 36 degrees 47 minutes 03 seconds West 2,770.32 feet to the point of beginning, containing approximately **2,166.06 acres**, all as more particularly outlined on a plat on file in the Office of Mineral Resources, Department of Natural Resources. All bearings, distances and coordinates are based on Louisiana Coordinate System of 1927, (North or South Zone).

NOTE: The above description of the Tract nominated for lease has been provided and corrected, where required, exclusively by the nomination party. Any mineral lease selected from this Tract and awarded by the Louisiana State Mineral Board shall be without warranty of any kind, either express, implied, or statutory, including, but not limited to, the implied warranties of merchantability and fitness for a particular purpose. Should the mineral lease awarded by the Louisiana State Mineral

Board be subsequently modified, cancelled or abrogated due to the existence of conflicting leases, operating agreements, private claims or other future obligations or conditions which may affect all or any portion of the leased Tract, it shall not relieve the Lessee of the obligation to pay any bonus due thereon to the Louisiana State Mineral Board, nor shall the Louisiana State Mineral Board be obligated to refund any consideration paid by the Lessor prior to such modification, cancellation, or abrogation, including, but not limited to, bonuses, rentals and royalties.

NOTE: The State of Louisiana does hereby reserve, and this lease shall be subject to, the imprescriptible right of surface use in the nature of a servitude in favor of the Department of Natural Resources, including its Offices and Commissions, for the sole purpose of implementing, constructing, servicing and maintaining approved coastal zone management and/or restoration projects. Utilization of any and all rights derived under this lease by the mineral lessee, its agents, successors or assigns, shall not interfere with nor hinder the reasonable surface use by the Department of Natural Resources, its Offices or Commissions, as herein above reserved.

NOTE: The Department of Wildlife and Fisheries has designated certain areas in the coastal waters of the State of Louisiana as Oyster Seed Bed Areas. The exact location of those Seed Bed Areas must be obtained from the Department of Wildlife and Fisheries and any work done under a mineral lease from the State of Louisiana may necessarily be conducted in conformity with the rules and regulations promulgated by the said Department of Wildlife and Fisheries for Oyster Seed Bed Areas.

Applicant: AUDUBON OIL AND GAS CORPORATION

Bidder	Cash Payment	Price/Acre	Rental	Oil	Gas	Other

Legend

- 08010032
- Blocks
- Active_Leases

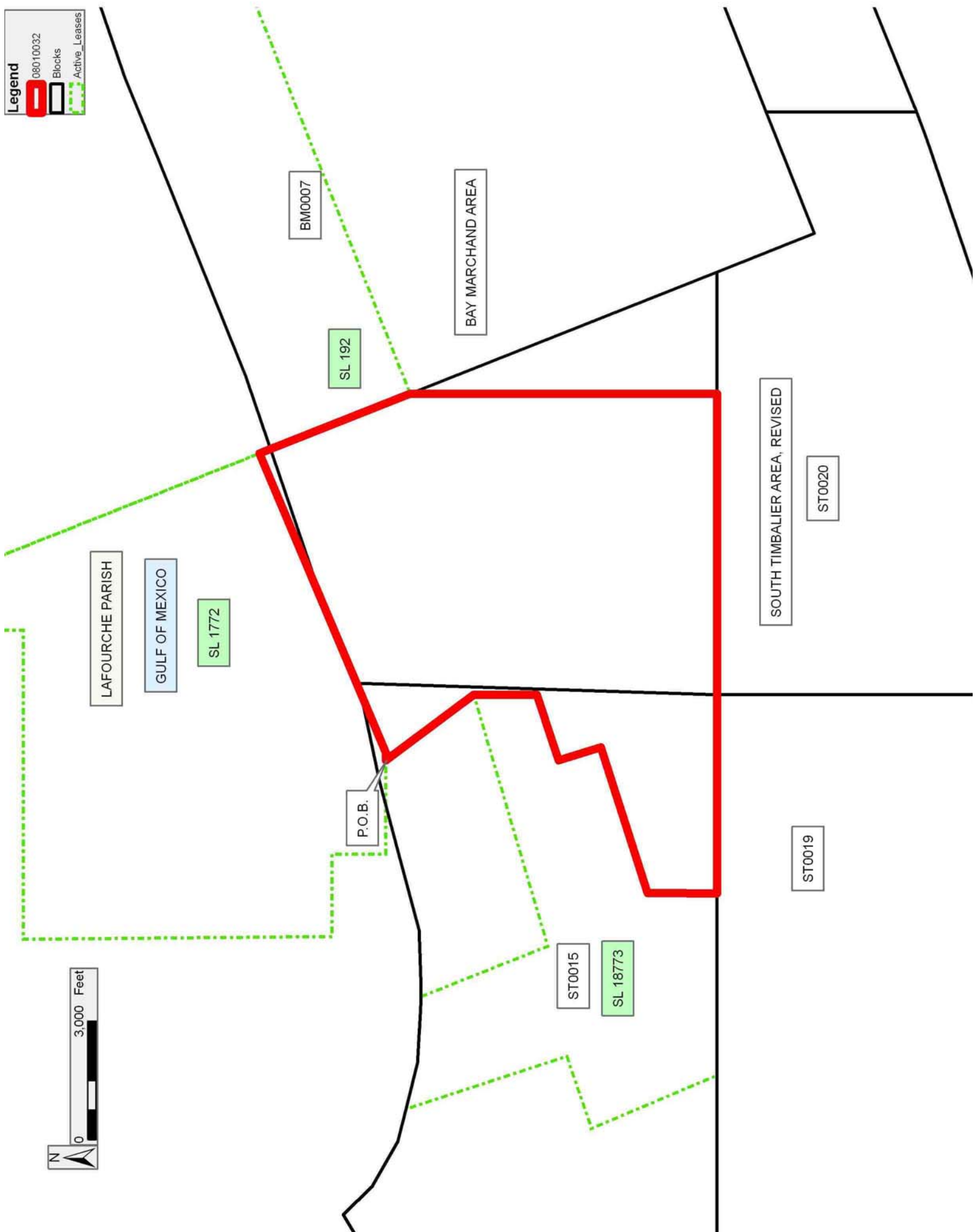

TRACT 39542 - Portion of Blocks 6, and 7, Bay Marchand Area, and Block 20, South Timbalier Area, Revised, Lafourche Parish, Louisiana

The beds and bottoms of all water bodies belonging to the State of Louisiana located in Blocks 6, and 7, Bay Marchand Area, and Block 20, South Timbalier Area, Revised, together with any present lands formed by accretion to the shoreline or islands formed therein, located in Lafourche Parish, Louisiana, owned by and not presently under mineral lease as of January 9, 2008, from the State of Louisiana, the geographical area of which is more fully described as follows: Beginning at a point on the West line of Block 7, Bay Marchand Area, said point being the Southwest corner of State Lease No. 192, as amended, having Coordinates of X = 2,327,480.24 and Y = 142,092.72; thence South 52 degrees 34 minutes 34 seconds East 5,368.89 feet to the Westernmost Northwest corner of State Lease No. 18772 having Coordinates of X = 2,331,744.00 and Y = 138,830.00; thence South 21 degrees 20 minutes 11 seconds East 1,624.33 feet along the Western boundary of said State Lease No. 18772 to its Southwest corner having Coordinates of X = 2,332,335.00 and Y = 137,317.00; thence South 61 degrees 05 minutes 55 seconds East 6,180.37 feet to the Northernmost Northwest corner of State Lease No. 18528 having Coordinates of X = 2,337,745.62 and Y = 134,330.00; thence along the boundary of said State Lease No. 18528 the following courses: South 68 degrees 22 minutes 13 seconds West 3,370.79 feet to a point having Coordinates of X = 2,334,612.18 and Y = 133,087.50 and South 1,608.21 feet to its Southwest corner, also being the Westernmost Northwest corner of State Lease No. 1423, as amended, having Coordinates of X = 2,334,612.18 and Y = 131,479.29; thence South 2,202.17 feet along the West boundary of said State Lease No. 1423 to its Southwest corner, also being a point on the Three Mile Line, as decreed by the Supreme Court of the United States, as determined by a Special Master appointed therein, in litigation styled *United States v. State of Louisiana et al No. 9 Original*, in 1975, having Coordinates of X = 2,334,612.18 and Y = 129,277.12; thence along said Three Mile Line the following: Southwesterly along an arc to the right having a radius of 18,240.60 feet and a center at X = 2,327,933 and Y = 146,251 to a point having Coordinates of 2,333,794 and Y = 128,978; Southwesterly on a straight line to a point having Coordinates of X = 2,328,327 and Y = 127,123 and Southwesterly along an arc to the right having a radius of 18,240.60 feet and a center at X = 2,322,466 and Y = 144,396 to a point having Coordinates of X = 2,327,480.19 and Y = 126,857.98; thence North 00 degrees 00 minutes 01 seconds East 15,234.74 feet to the point of beginning, containing approximately **1,909.79 acres, LESS AND EXCEPT** that portion thereof, if any, lying seaward of the line three nautical miles from the coast line of Louisiana, as said three mile line has been decreed by the Supreme Court of the United States, as determined by a Special Master appointed therein, in litigation styled **United States v. State of Louisiana et al No. 9 Original**, in 1975, all as more particularly outlined on a plat in the Office of Mineral Resources, Department of Natural Resources. All bearings, distances and coordinates are based on the Louisiana Coordinate System of 1927, (South Zone).

NOTE: The above description of the Tract nominated for lease has been provided and corrected, where required, exclusively by the nomination party. Any mineral lease selected from this Tract and awarded by the Louisiana State Mineral Board shall be without warranty of any kind, either express, implied, or statutory, including, but not limited to, the implied warranties of merchantability and fitness for a particular purpose. Should the mineral lease awarded by the Louisiana State Mineral Board be subsequently modified, cancelled or abrogated due to the existence of conflicting leases, operating agreements, private claims or other future obligations or conditions which may affect all or any portion of the leased Tract, it shall not relieve the Lessee of the obligation to pay any bonus due thereon to the Louisiana State Mineral Board, nor shall the Louisiana State Mineral Board be obligated to refund any consideration paid by the Lessor prior to such modification, cancellation, or abrogation, including, but not limited to, bonuses, rentals and royalties.

NOTE: The State of Louisiana does hereby reserve, and this lease shall be subject to, the imprescriptible right of surface use in the nature of a servitude in favor of the Department of Natural Resources, including its Offices and Commissions, for the sole purpose of implementing, constructing, servicing and maintaining approved coastal zone management and/or restoration projects. Utilization of any and all rights derived under this lease by the mineral lessee, its agents, successors or assigns, shall not interfere with nor hinder the reasonable surface use by the Department of Natural Resources, its Offices or Commissions, as herein above reserved.

NOTE: It appears, according to our records, that a portion of this Tract is located within the restrictive safety fairway area as set out by the Corps of Engineers, U.S. Army and/or the restrictive anchorage area as set out by the U.S. Coast Guard.

NOTE: The Department of Wildlife and Fisheries has designated certain areas in the coastal waters of the State of Louisiana as Oyster Seed Bed Areas. The exact location of those Seed Bed Areas must be obtained from the Department of Wildlife and Fisheries and any work done under a mineral lease from the State of Louisiana may necessarily be conducted in conformity with the rules and regulations promulgated by the said Department of Wildlife and Fisheries for Oyster Seed Bed Areas.

Applicant: AUDUBON OIL AND GAS CORPORATION

Bidder	Cash Payment	Price/Acre	Rental	Oil	Gas	Other

Legend

- 08010033
- Blocks
- Active_Leases

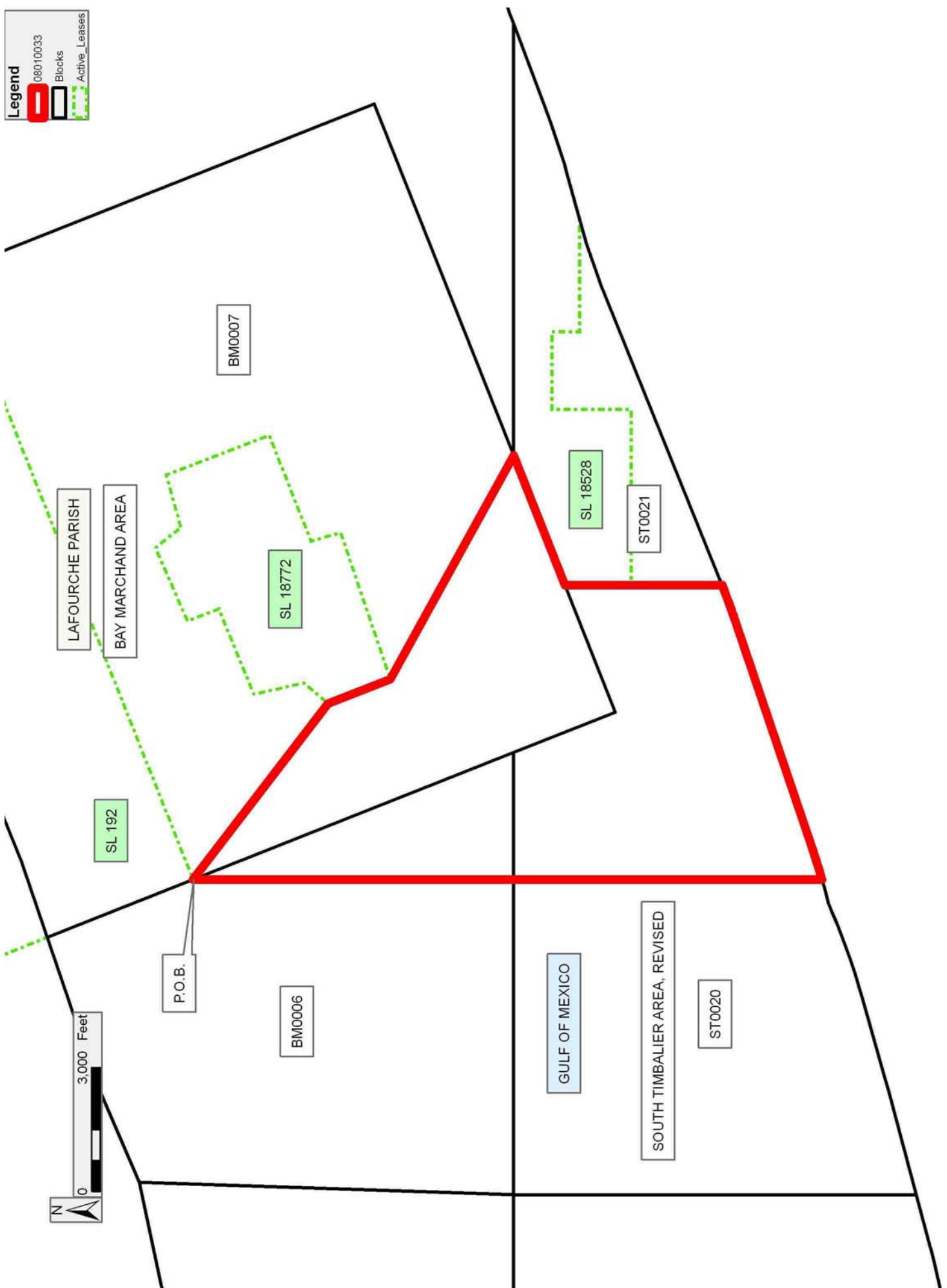

TRACT 39543 - Portion of Blocks 5, and 7, Bay Marchand Area, Lafourche Parish, Louisiana

The beds and bottoms of all water bodies belonging to the State of Louisiana located in Blocks 5, and 7, Bay Marchand Area, together with any present lands formed by accretion to the shoreline or islands formed therein, located in Lafourche Parish, Louisiana, owned by and not presently under mineral lease as of January 9, 2008, from the State of Louisiana, the geographical area of which is more fully described as follows: Beginning at a point within Block 7, Bay Marchand Area, said point being the Southwest corner of State Lease No. 19430 having Coordinates of X = 2,340,260.28 and Y = 142,000.00; thence East 9,483.72 feet along the South boundary of said State Lease No. 19430 to its Southeast corner located within Block 5, Bay Marchand Area, having Coordinates of X = 2,349,744.00 and Y = 142,000.00; thence South 7,121.00 feet to a point on the Three Mile Line, as decreed by the Supreme Court of the United States, as determined by a Special Master appointed therein, in litigation styled *United States v. State of Louisiana et al No. 9 Original*, in 1975, having Coordinates of X = 2,349,744 and Y = 134,879; thence along said Three Mile Line the following: Southwesterly on a straight line to a point having Coordinates of X = 2,348,372 and Y = 134,394 and Southwesterly on a straight line to the Northeast corner of State Lease No. 18528 having Coordinates of X = 2,348,202.62 and Y = 134,330.00; thence West 10,457.00 feet along the North Boundary of said State Lease No. 18528 to its Northwest corner having Coordinates of X = 2,337,745.62 and Y = 134,330.00; thence North 18 degrees 09 minutes 07 seconds East 8,071.70 feet to the point of beginning, containing approximately **1,881.49 acres, LESS AND EXCEPT** that portion thereof, if any, lying seaward of the line three nautical miles from the coast line of Louisiana, as said three mile line has been decreed by the Supreme Court of the United States, as determined by a Special Master appointed therein, in litigation styled **United States v. State of Louisiana et al No. 9 Original**, in 1975, all as more particularly outlined on a plat in the Office of Mineral Resources, Department of Natural Resources. All bearings, distances and coordinates are based on the Louisiana Coordinate System of 1927, (South Zone).

NOTE: The above description of the Tract nominated for lease has been provided and corrected, where required, exclusively by the nomination party. Any mineral lease selected from this Tract and awarded by the Louisiana State Mineral Board shall be without warranty of any kind, either express, implied, or statutory, including, but not limited to, the implied warranties of merchantability and fitness for a particular purpose. Should the mineral lease awarded by the Louisiana State Mineral Board be subsequently modified, cancelled or abrogated due to the existence of conflicting leases, operating agreements, private claims or other future obligations or conditions which may affect all or any portion of the leased Tract, it shall not relieve the Lessee of the obligation to pay any bonus due thereon to the Louisiana State Mineral Board, nor shall the Louisiana State Mineral Board be obligated to refund any consideration

paid by the Lessor prior to such modification, cancellation, or abrogation, including, but not limited to, bonuses, rentals and royalties.

NOTE: The State of Louisiana does hereby reserve, and this lease shall be subject to, the imprescriptible right of surface use in the nature of a servitude in favor of the Department of Natural Resources, including its Offices and Commissions, for the sole purpose of implementing, constructing, servicing and maintaining approved coastal zone management and/or restoration projects. Utilization of any and all rights derived under this lease by the mineral lessee, its agents, successors or assigns, shall not interfere with nor hinder the reasonable surface use by the Department of Natural Resources, its Offices or Commissions, as herein above reserved.

NOTE: It appears, according to our records, that a portion of this Tract is located within the restrictive safety fairway area as set out by the Corps of Engineers, U.S. Army and/or the restrictive anchorage area as set out by the U.S. Coast Guard.

Applicant: AUDUBON OIL AND GAS CORPORATION

Bidder	Cash Payment	Price/Acre	Rental	Oil	Gas	Other

Legend

- 08010034
- Blocks
- Active_Leases

