

TR 34094
2,024 ± ACS.
JAN., 2002

P.O.B.
X = 2,547,300.00
Y = 259,700.00

TRACT 34095 - Plaquemines Parish, Louisiana

All of the lands now or formerly constituting the beds and bottoms of all water bodies of every nature and description and all islands and other lands formed by accretion or reliction, except tax lands, owned by and not under mineral lease from the State of Louisiana on January 9, 2002, situated in Plaquemines Parish, Louisiana, within the following described boundaries: Beginning at the Northwest corner of State Lease No. 15280 having Coordinates of X = 2,534,597.32 and Y = 247,984.99; thence North 11,715.01 feet to a point having Coordinates of X = 2,534,597.32 and Y = 259,700.00; thence East 15,650.00 feet to a point having Coordinates of X = 2,550,247.32 and Y = 259,700.00; thence South 11,715.01 feet to the Northeast corner of said State Lease No. 15280 having Coordinates of X = 2,550,247.32 and Y = 247,984.99; thence West 15,650.00 feet along the North line of said State Lease No. 15280 to the point of beginning, containing approximately 2,084 acres, as shown outlined on a plat on file in the Office of Mineral Resources, Department of Natural Resources, as provided by the applicant. All bearings, distances and coordinates are based on Louisiana Coordinate System of 1927 (South Zone).

NOTE: The above description of the tract nominated for lease has been provided exclusively by the party nominating the tract for lease. The Louisiana State Mineral Board makes no representation as to the accuracy of the description of the nominated tract or its suitability for lease. The Louisiana State Mineral Board has made no inspection of the nominated tract for the existence of conflicting leases, operating agreements, private claims or other existing or future obligations or conditions which may affect all or any portion of the nominated tract or its suitability for lease.

Maps depicting the nominated tract, containing the bearings, distances and coordinates of the nominated tract based on the Louisiana Coordinate System of 1927, North or South Zone, as applicable, are available for public inspection and review at the offices of the Louisiana State Mineral Board from 10:00 a.m. to 3:00 p.m. Monday - Friday.

In the event of conflict between the description of the nominated tract set forth above and the description of the nominated property as contained on the maps maintained at the offices of the Louisiana State Mineral Board, the Louisiana State Mineral Board maps shall prevail and shall provide the final property description of the lease to be awarded of the nominated tract.

Any mineral lease of the nominated tract by the Louisiana State Mineral Board shall be without warranty of any kind, either express, implied, or statutory, including, but not limited to, the implied warranties or merchantability and fitness for a particular purpose. Should the mineral lease of the nominated tract awarded by the Louisiana State Mineral Board be subsequently modified, cancelled or abrogated due to the existence of conflicting leases, operating agreements, private claims or other existing of future obligations or conditions which may affect all or any portion of the leased tract, it shall not relieve the Lessee of the obligation to pay any bonus due thereon to the Louisiana State Mineral Board, nor shall the Louisiana State Mineral Board be obligated to refund any consideration paid by the Lessee prior to such modification, cancellation, or abrogation, including, but not limited to, bonuses,

rents and royalties.

NOTE: The above tract is located in or near an oyster restricted area and all operations in such area must be conducted in strict conformity with the stipulations and/or regulations of the Louisiana Department of Wildlife and Fisheries.

NOTE: The State of Louisiana does hereby reserve, and this lease shall be subject to, the imprescriptible right of surface use in the nature of a servitude in favor of the Department of Natural Resources, including its Offices and Commissions, for the sole purpose of implementing, constructing, servicing and maintaining approved coastal zone management and/or restoration projects. Utilization of any and all rights derived under this lease by the mineral lessee, its agents, successors or assigns, shall not interfere with nor hinder the reasonable surface use by the Department of Natural Resources, its Offices or Commissions, as hereinabove reserved.

Applicant: AK Resources

Bidder	Cash Payment	Price / Acre	Rental	Oil	Gas	Other

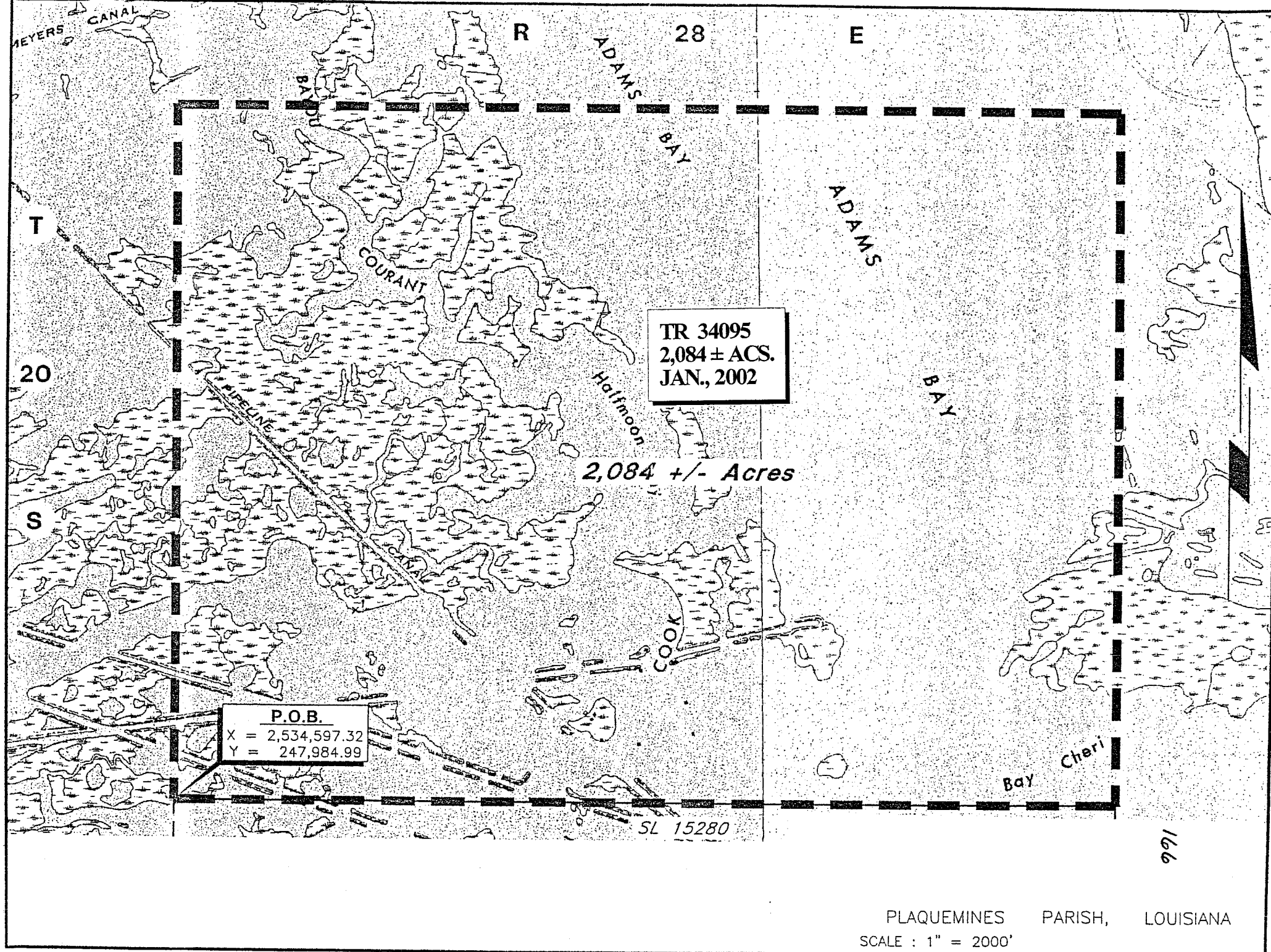

TR 34095
2,084 ± ACS.
JAN., 2002

2,084 +/- Acres

P.O.B.
X = 2,534,597.32
Y = 247,984.99

PLAQUEMINES PARISH, LOUISIANA
SCALE : 1" = 2000'

TRACT 34096 - Plaquemines Parish, Louisiana

All of the lands now or formerly constituting the beds and bottoms of all water bodies of every nature and description and all islands and other lands formed by accretion or reliction, except tax lands, owned by and not under mineral lease from the State of Louisiana on January 9, 2002, situated in Plaquemines Parish, Louisiana, within the following described boundaries: Beginning at a point having Coordinates of X = 2,599,360.33 and Y = 198,485.03, also being the Southeast corner of State Lease 16846; thence North 01 degrees 43 minutes 52 seconds West 5,280.08 feet on the East line of said State Lease 16846 to its Northeast corner having Coordinates of X = 2,599,200.80 and Y = 203,762.70; thence North 88 degrees 16 minutes 08 seconds East 13,200.02 feet to a point having Coordinates of X = 2,612,394.80 and Y = 204,161.45; thence South 01 degrees 43 minutes 51 seconds East 1,320.01 feet to a point having Coordinates of X = 2,612,434.67 and Y = 202,842.04; thence South 88 degrees 16 minutes 09 seconds West 2,640.00 feet to a point having Coordinates of X = 2,609,795.88 and Y = 202,762.30; thence South 01 degrees 43 minutes 51 seconds East 1,722.27 feet to a point having Coordinates of X = 2,609,847.90 and Y = 201,040.81; thence South 32 degrees 19 minutes 04 seconds West 2,700.75 feet to a point having Coordinates of X = 2,608,404.03 and Y = 198,758.42; thence South 88 degrees 16 minutes 07 seconds West 9,047.84 feet to the point of beginning, **LESS AND EXCEPT** all that portion of State Lease 16846 that may lie within the above described tract, containing approximately **57 acres**, as shown outlined on a plat on file in the Office of Mineral Resources, Department of Natural Resources, as provided by the applicant. All bearings, distances and coordinates are based on Louisiana Coordinate System of 1927 (South Zone).

NOTE: The above description of the tract nominated for lease has been provided exclusively by the party nominating the tract for lease. The Louisiana State Mineral Board makes no representation as to the accuracy of the description of the nominated tract or its suitability for lease. The Louisiana State Mineral Board has made no inspection of the nominated tract for the existence of conflicting leases, operating agreements, private claims or other existing or future obligations or conditions which may affect all or any portion of the nominated tract or its suitability for lease.

Maps depicting the nominated tract, containing the bearings, distances and coordinates of the nominated tract based on the Louisiana Coordinate System of 1927, North or South Zone, as applicable, are available for public inspection and review at the offices of the Louisiana State Mineral Board from 10:00 a.m. to 3:00 p.m. Monday - Friday.

In the event of conflict between the description of the nominated tract set forth above and the description of the nominated property as contained on the maps maintained at the offices of the Louisiana State Mineral Board, the Louisiana State Mineral Board maps shall prevail and shall provide the final property description of the lease to be awarded of the nominated tract.

Any mineral lease of the nominated tract by the Louisiana State Mineral Board shall be without warranty of any kind, either express, implied, or statutory, including, but not limited to, the implied warranties or merchantability and fitness for a particular purpose. Should the mineral lease of the nominated tract awarded by the

Louisiana State Mineral Board be subsequently modified, cancelled or abrogated due to the existence of conflicting leases, operating agreements, private claims or other existing or future obligations or conditions which may affect all or any portion of the leased tract, it shall not relieve the Lessee of the obligation to pay any bonus due thereon to the Louisiana State Mineral Board, nor shall the Louisiana State Mineral Board be obligated to refund any consideration paid by the Lessee prior to such modification, cancellation, or abrogation, including, but not limited to, bonuses, rents and royalties.

NOTE: The above tract is located in or near an oyster restricted area and all operations in such area must be conducted in strict conformity with the stipulations and/or regulations of the Louisiana Department of Wildlife and Fisheries.

NOTE: The State of Louisiana does hereby reserve, and this lease shall be subject to, the imprescriptible right of surface use in the nature of a servitude in favor of the Department of Natural Resources, including its Offices and Commissions, for the sole purpose of implementing, constructing, servicing and maintaining approved coastal zone management and/or restoration projects. Utilization of any and all rights derived under this lease by the mineral lessee, its agents, successors or assigns, shall not interfere with nor hinder the reasonable surface use by the Department of Natural Resources, its Offices or Commissions, as hereinabove reserved.

Applicant: Land Management Services, L.L.C.

Bidder	Cash Payment	Price / Acre	Rental	Oil	Gas	Other

TRACT 34097 - PORTION OF BLOCK 11, MAIN PASS AREA, REVISED, St. Bernard Parish, Louisiana

All of the lands now or formerly constituting the beds and bottoms of all water bodies of every nature and description and all islands and other lands formed by accretion or reliction, except tax lands, belonging to the State of Louisiana and not under mineral lease on January 9, 2002, situated in St. Bernard Parish, Louisiana, and more particularly described as follows: Beginning at a point having Coordinates of X = 2,591,100.00 and Y = 366,580.00, said point also being the Northwest corner of Block 11, Main Pass Area, Revised; thence East 4,675.00 feet on and along the North line of said Block 11, Main Pass Area, Revised, to a point having Coordinates of X = 2,595,775.00 and Y = 366,580.00, said point also being a Northwest corner of State of Louisiana - State Lease No. 16631; thence on and along the Western and Southern boundaries of said State of Louisiana - State Lease No. 16631 the following courses and distances, to-wit: South 2,600.00 feet to a point having Coordinates of X = 2,595,775.00 and Y = 363,980.00; East 5,900.00 feet to a point having Coordinates of X = 2,601,675.00 and Y = 363,980.00; South 2,650.00 feet to a point having Coordinates of X = 2,601,675.00 and Y = 361,330.00; and East 4,175.00 feet to a point having Coordinates of X = 2,605,850.00 and Y = 361,330.00, said point also being on the East line of said Block 11, Main Pass Area, Revised; thence South 2,125.00 feet on and along said East line of said Block 11, Main Pass Area, Revised, to a point having Coordinates of X = 2,605,850.00 and Y = 359,205.00; thence West 14,750.00 feet to a point having Coordinates of X = 2,591,100.00 and Y = 359,205.00, said point also being on the West line of said Block 11, Main Pass Area, Revised; thence North 7,375.00 feet on and along said West line of said Block 11, Main Pass Area, Revised, to the point of beginning, containing approximately **1,583 acres**, as shown outlined on a plat on file in the Office of Mineral Resources, Department of Natural Resources, as provided by the applicant. All bearings, distances and coordinates are based on Louisiana Coordinate System of 1927 (South Zone).

NOTE: The above description of the tract nominated for lease has been provided exclusively by the party nominating the tract for lease. The Louisiana State Mineral Board makes no representation as to the accuracy of the description of the nominated tract or its suitability for lease. The Louisiana State Mineral Board has made no inspection of the nominated tract for the existence of conflicting leases, operating agreements, private claims or other existing or future obligations or conditions which may affect all or any portion of the nominated tract or its suitability for lease.

Maps depicting the nominated tract, containing the bearings, distances and coordinates of the nominated tract based on the Louisiana Coordinate System of 1927, North or South Zone, as applicable, are available for public inspection and review at the offices of the Louisiana State Mineral Board from 10:00 a.m. to 3:00 p.m. Monday - Friday.

In the event of conflict between the description of the nominated tract set forth above and the description of the nominated property as contained on the maps maintained at the offices of the Louisiana State Mineral Board, the Louisiana State Mineral Board maps shall prevail and shall provide the final property description of the lease to be awarded of the nominated tract.

Any mineral lease of the nominated tract by the Louisiana State Mineral Board shall be without warranty of any kind, either express, implied, or statutory, including, but not limited to, the implied warranties or merchantability and fitness for a particular purpose. Should the mineral lease of the nominated tract awarded by the Louisiana State Mineral Board be subsequently modified, cancelled or abrogated due to the existence of conflicting leases, operating agreements, private claims or other existing or future obligations or conditions which may affect all or any portion of the leased tract, it shall not relieve the Lessee of the obligation to pay any bonus due thereon to the Louisiana State Mineral Board, nor shall the Louisiana State Mineral Board be obligated to refund any consideration paid by the Lessee prior to such modification, cancellation, or abrogation, including, but not limited to, bonuses, rents and royalties.

NOTE: The above tract is located in or near an oyster restricted area and all operations in such area must be conducted in strict conformity with the stipulations and/or regulations of the Louisiana Department of Wildlife and Fisheries.

NOTE: The State of Louisiana does hereby reserve, and this lease shall be subject to, the imprescriptible right of surface use in the nature of a servitude in favor of the Department of Natural Resources, including its Offices and Commissions, for the sole purpose of implementing, constructing, servicing and maintaining approved coastal zone management and/or restoration projects. Utilization of any and all rights derived under this lease by the mineral lessee, its agents, successors or assigns, shall not interfere with nor hinder the reasonable surface use by the Department of Natural Resources, its Offices or Commissions, as hereinabove reserved.

Applicant: Robert A. Schroeder, Inc.

Bidder	Cash Payment	Price / Acre	Rental	Oil	Gas	Other

A horizontal graphic scale bar with alternating black and white segments. It is labeled with '3000'' at the left end, '0'' in the middle, '3000'' at the right end, and '6000'' at the far right end. Below the bar is the word 'SCALE'.