

agreements, private claims or other existing of future obligations or conditions which may affect all or any portion of the leased tract, it shall not relieve the Lessee of the obligation to pay any bonus due thereon to the Louisiana State Mineral Board, nor shall the Louisiana State Mineral Board be obligated to refund any consideration paid by the Lessee prior to such modification, cancellation, or abrogation, including, but not limited to, bonuses, rents and royalties.

NOTE: The State of Louisiana does hereby reserve, and this lease shall be subject to, the imprescriptible right of surface use in the nature of a servitude in favor of the Department of Natural Resources, including its Offices and Commissions, for the sole purpose of implementing, constructing, servicing and maintaining approved coastal zone management and/or restoration projects. Utilization of any and all rights derived under this lease by the mineral lessee, its agents, successors or assigns, shall not interfere with nor hinder the reasonable surface use by the Department of Natural Resources, its Offices or Commissions, as hereinabove reserved.

Applicant: Louisiana Oil and Gas, Inc.

Bidder	Cash Payment	Price / Acre	Rental	Oil	Gas	Other

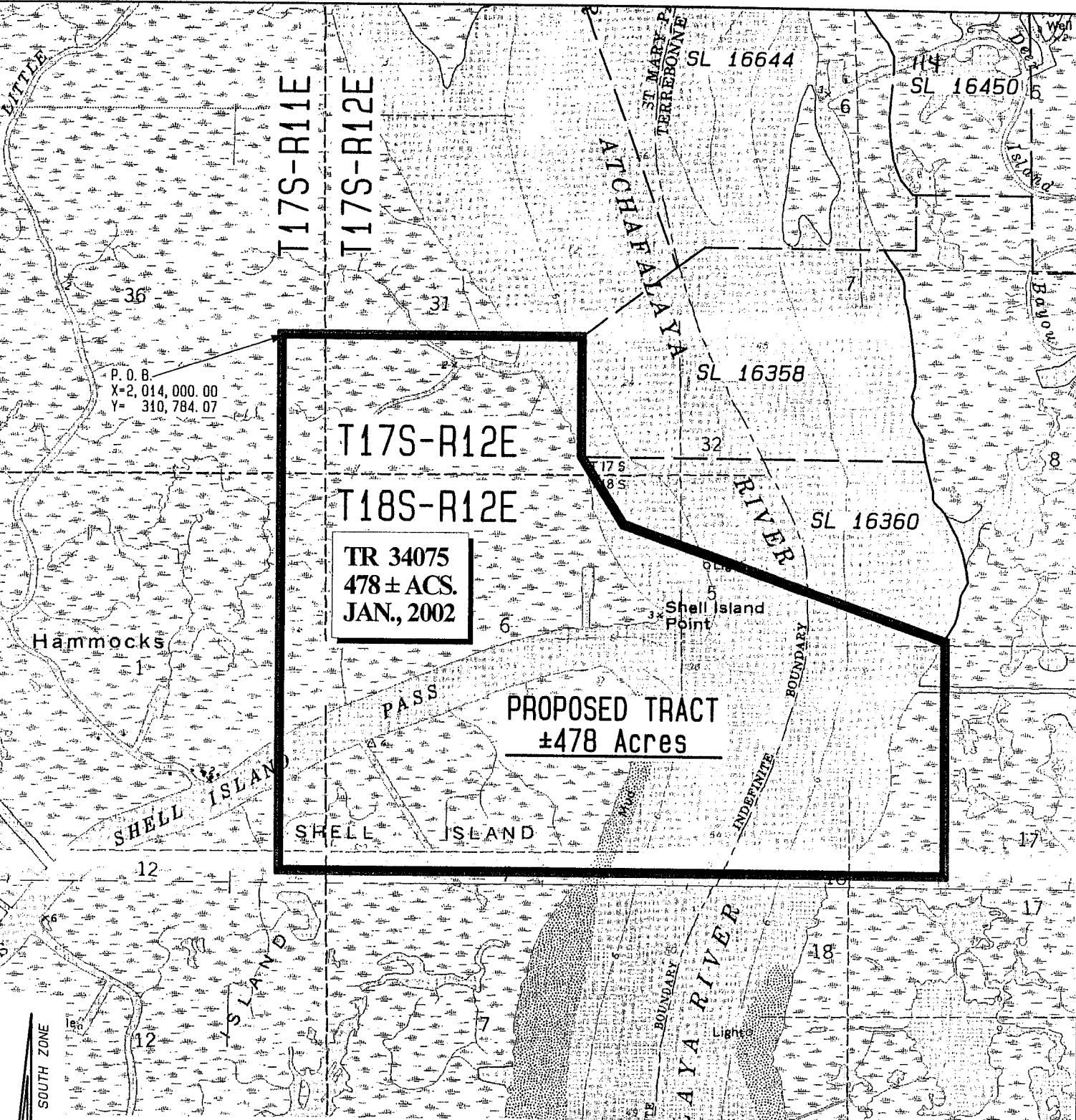

St. Mary & Terrebonne Parishes, Louisiana

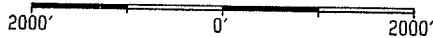

TRACT 34076 - Assumption Parish, Louisiana

All of the lands now or formerly constituting the beds and bottoms of all water bodies of every nature and description and all islands and other lands formed by accretion or reliction, except tax lands, owned by and not under mineral lease from the State of Louisiana on January 9, 2002, situated in Assumption Parish, Louisiana, within the following described boundaries: Beginning at a point having Coordinates of X = 2,040,750.00 and Y = 470,600.00; thence East 5,450.00 feet to a point having Coordinates of X = 2,046,200.00 and Y = 470,600.00; thence South 2,675.00 feet to the Northeast corner of State Lease No. 17229 having Coordinates of X = 2,046,200.00 and Y = 467,925.00; thence along the boundary of said State Lease No. 17229 the following courses: West 2,725.00 feet, South 2,675.00 feet and East 2,725.00 feet to its Southeast corner having Coordinates of X = 2,046,200.00 and Y = 465,250.00; thence South 5,350.00 feet to a point having Coordinates of X = 2,046,200.00 and Y = 459,900.00; thence West 5,450.00 feet to a point having Coordinates of X = 2,040,750.00 and Y = 459,900.00; thence North 10,700.00 feet to the point of beginning, containing approximately 356 acres, as shown outlined on a plat on file in the Office of Mineral Resources, Department of Natural Resources, as provided by the applicant. All bearings, distances and coordinates are based on Louisiana Coordinate System of 1927 (South Zone).

NOTE: The above description of the tract nominated for lease has been provided exclusively by the party nominating the tract for lease. The Louisiana State Mineral Board makes no representation as to the accuracy of the description of the nominated tract or its suitability for lease. The Louisiana State Mineral Board has made no inspection of the nominated tract for the existence of conflicting leases, operating agreements, private claims or other existing or future obligations or conditions which may affect all or any portion of the nominated tract or its suitability for lease.

Maps depicting the nominated tract, containing the bearings, distances and coordinates of the nominated tract based on the Louisiana Coordinate System of 1927, North or South Zone, as applicable, are available for public inspection and review at the offices of the Louisiana State Mineral Board from 10:00 a.m. to 3:00 p.m. Monday - Friday.

In the event of conflict between the description of the nominated tract set forth above and the description of the nominated property as contained on the maps maintained at the offices of the Louisiana State Mineral Board, the Louisiana State Mineral Board maps shall prevail and shall provide the final property description of the lease to be awarded of the nominated tract.

Any mineral lease of the nominated tract by the Louisiana State Mineral Board shall be without warranty of any kind, either express, implied, or statutory, including, but not limited to, the implied warranties or merchantability and fitness for a particular purpose. Should the mineral lease of the nominated tract awarded by the Louisiana State Mineral Board be subsequently modified, cancelled or abrogated due to the existence of conflicting leases, operating agreements, private claims or other existing of future obligations or conditions which may affect all or any portion of the leased tract, it shall not relieve the Lessee of the obligation to pay any bonus due thereon to the Louisiana State Mineral Board, nor shall the

Louisiana State Mineral Board be obligated to refund any consideration paid by the Lessee prior to such modification, cancellation, or abrogation, including, but not limited to, bonuses, rents and royalties.

NOTE: The State of Louisiana does hereby reserve, and this lease shall be subject to, the imprescriptible right of surface use in the nature of a servitude in favor of the Department of Natural Resources, including its Offices and Commissions, for the sole purpose of implementing, constructing, servicing and maintaining approved coastal zone management and/or restoration projects. Utilization of any and all rights derived under this lease by the mineral lessee, its agents, successors or assigns, shall not interfere with nor hinder the reasonable surface use by the Department of Natural Resources, its Offices or Commissions, as hereinabove reserved.

Applicant: Upstream Energy, Inc.

Bidder	Cash Payment	Price / Acre	Rental	Oil	Gas	Other

TRACT 34077 - Terrebonne Parish, Louisiana

All of the lands now or formerly constituting the beds and bottoms of all water bodies of every nature and description and all islands and other lands formed by accretion or reliction, except tax lands, owned by and not under mineral lease from the State of Louisiana on January 9, 2002, situated in Terrebonne Parish, Louisiana, within the following described boundaries: Beginning at the Southeast corner of State Lease No. 17211 having Coordinates of X = 2,056,925.00 and Y = 277,440.00; thence South 2,640.00 feet to a point having Coordinates of X = 2,056,925.00 and Y = 274,800.00; thence West 17,525.00 feet to a point having Coordinates of X = 2,039,400.00 and Y = 274,800.00; thence North 18,480.00 feet to a point having Coordinates of X = 2,039,400.00 and Y = 293,280.00; thence East 10,422.12 feet to a point on the West boundary of State Lease No. 17210 having Coordinates of X = 2,049,822.12 and Y = 293,280.00; thence along the said Western boundaries of State Lease No. 17210 the following courses: South 01 degrees 46 minutes 10 seconds East 3,846.87 feet to a corner having Coordinates of X = 2,049,940.89 and Y = 289,434.96; South 89 degrees 43 minutes 00 seconds West 1,342.48 feet to a corner having Coordinates of X = 2,048,598.43 and Y = 289,428.33; South 01 degrees 49 minutes 35 seconds East 3,966.71 feet to a corner having Coordinates of X = 2,048,724.85 and Y = 285,463.64; South 89 degrees 21 minutes 32 seconds West 2,756.89 feet to a corner having Coordinates of X = 2,045,968.13 and Y = 285,432.80; South 00 degrees 20 minutes 13 seconds East 3,994.60 feet to its Southwest corner having Coordinates of X = 2,045,991.63 and Y = 281,438.27; thence North 89 degrees 28 minutes 40 seconds East 1,415.15 feet along the South boundary of said State Lease No. 17210 to the Northwest corner of State Lease No. 17211 having Coordinates of X = 2,047,406.72 and Y = 281,451.17; thence South 00 degrees 19 minutes 53 seconds East 4,011.24 feet along the West boundary of said State Lease No. 17211 to its Southwest corner having Coordinates of X = 2,047,429.92 and Y = 277,440.00; thence East 9,495.08 feet along the South boundary of said State Lease No. 17211 to the point of beginning, containing approximately **136 acres**, as shown outlined on a plat on file in the Office of Mineral Resources, Department of Natural Resources, as provided by the applicant. All bearings, distances and coordinates are based on Louisiana Coordinate System of 1927 (South Zone).

NOTE: The above description of the tract nominated for lease has been provided exclusively by the party nominating the tract for lease. The Louisiana State Mineral Board makes no representation as to the accuracy of the description of the nominated tract or its suitability for lease. The Louisiana State Mineral Board has made no inspection of the nominated tract for the existence of conflicting leases, operating agreements, private claims or other existing or future obligations or conditions which may affect all or any portion of the nominated tract or its suitability for lease. Maps depicting the nominated tract, containing the bearings, distances and coordinates of the nominated tract based on the Louisiana Coordinate System of 1927, North or South Zone, as applicable, are available for public inspection and review at the offices of the Louisiana State Mineral Board from 10:00 a.m. to 3:00 p.m. Monday - Friday. In the event of conflict between the description of the nominated tract set forth above and the description of the nominated property

as contained on the maps maintained at the offices of the Louisiana State Mineral Board, the Louisiana State Mineral Board maps shall prevail and shall provide the final property description of the lease to be awarded of the nominated tract.

Any mineral lease of the nominated tract by the Louisiana State Mineral Board shall be without warranty of any kind, either express, implied, or statutory, including, but not limited to, the implied warranties or merchantability and fitness for a particular purpose. Should the mineral lease of the nominated tract awarded by the Louisiana State Mineral Board be subsequently modified, cancelled or abrogated due to the existence of conflicting leases, operating agreements, private claims or other existing of future obligations or conditions which may affect all or any portion of the leased tract, it shall not relieve the Lessee of the obligation to pay any bonus due thereon to the Louisiana State Mineral Board, nor shall the Louisiana State Mineral Board be obligated to refund any consideration paid by the Lessee prior to such modification, cancellation, or abrogation, including, but not limited to, bonuses, rents and royalties.

NOTE: The State of Louisiana does hereby reserve, and this lease shall be subject to, the imprescriptible right of surface use in the nature of a servitude in favor of the Department of Natural Resources, including its Offices and Commissions, for the sole purpose of implementing, constructing, servicing and maintaining approved coastal zone management and/or restoration projects. Utilization of any and all rights derived under this lease by the mineral lessee, its agents, successors or assigns, shall not interfere with nor hinder the reasonable surface use by the Department of Natural Resources, its Offices or Commissions, as hereinabove reserved.

Applicant: Gray Production Company

Bidder	Cash Payment	Price / Acre	Rental	Oil	Gas	Other

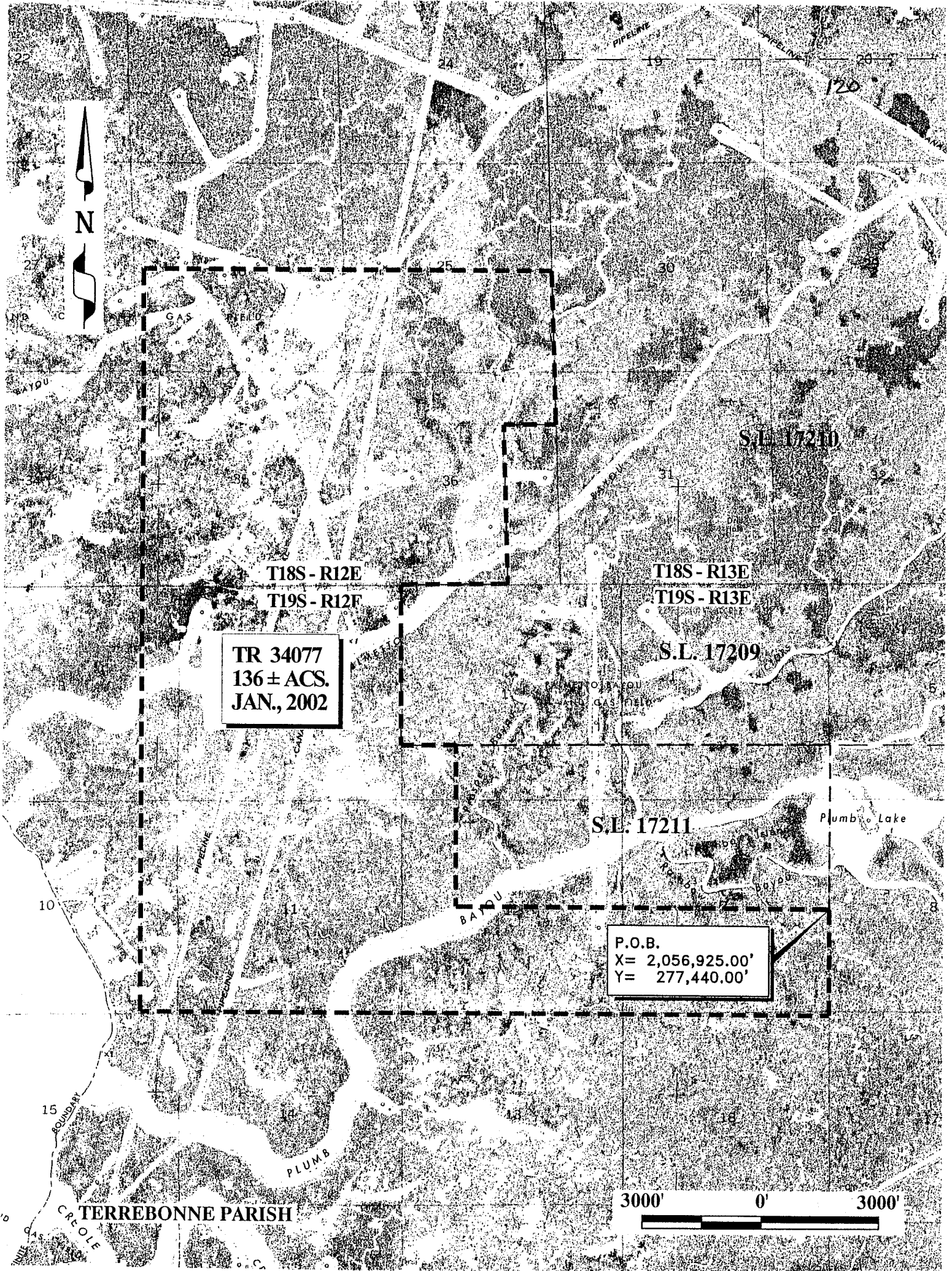

TR 34077
136 ± ACS.
JAN., 2002

P.O.B.
X= 2,056,925.00'
Y= 277,440.00'

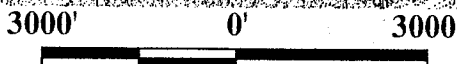

TRACT 34078 - Terrebonne Parish, Louisiana

All of the lands now or formerly constituting the beds and bottoms of all water bodies of every nature and description and all islands and other lands formed by accretion or reliction, except tax lands, owned by and not under mineral lease from the State of Louisiana on January 9, 2002, situated in Terrebonne Parish, Louisiana, within the following described boundaries: Beginning at a point having Coordinates of X = 2,134,005.93 and Y = 352,488.04; thence South to a point having Coordinates of X = 2,134,005.93 and Y = 349,012.51; thence West to a point having Coordinates of X = 2,121,978.10 and Y = 349,012.51, said point also being located on the Eastern line of Geophysical Agreement (EGA #2001-0701, effective July 11, 2001); thence Northeasterly along the Eastern line of said Geophysical Agreement (EGA #2001-0701) to a point having Coordinates of X = 2,122,636.06 and Y = 352,488.04, said point also being located on the Eastern line of Geophysical Agreement (EGA #2001-0701); thence East to the point of beginning, **LESS AND EXCEPT** any portion of the above described tract that falls within the limits of the Oil & Gas Unit (LL RA SU E - Order No. 478-G-3), containing approximately **17 acres**, as shown outlined on a plat on file in the Office of Mineral Resources, Department of Natural Resources, as provided by the applicant. All bearings, distances and coordinates are based on Louisiana Coordinate System of 1927 (South Zone).

NOTE: The above description of the tract nominated for lease has been provided exclusively by the party nominating the tract for lease. The Louisiana State Mineral Board makes no representation as to the accuracy of the description of the nominated tract or its suitability for lease. The Louisiana State Mineral Board has made no inspection of the nominated tract for the existence of conflicting leases, operating agreements, private claims or other existing or future obligations or conditions which may affect all or any portion of the nominated tract or its suitability for lease.

Maps depicting the nominated tract, containing the bearings, distances and coordinates of the nominated tract based on the Louisiana Coordinate System of 1927, North or South Zone, as applicable, are available for public inspection and review at the offices of the Louisiana State Mineral Board from 10:00 a.m. to 3:00 p.m. Monday - Friday.

In the event of conflict between the description of the nominated tract set forth above and the description of the nominated property as contained on the maps maintained at the offices of the Louisiana State Mineral Board, the Louisiana State Mineral Board maps shall prevail and shall provide the final property description of the lease to be awarded of the nominated tract.

Any mineral lease of the nominated tract by the Louisiana State Mineral Board shall be without warranty of any kind, either express, implied, or statutory, including, but not limited to, the implied warranties or merchantability and fitness for a particular purpose. Should the mineral lease of the nominated tract awarded by the Louisiana State Mineral Board be subsequently modified, cancelled or abrogated due to the existence of conflicting leases, operating agreements, private claims or other existing of future obligations or conditions which may affect all or any portion of the leased tract, it shall not relieve the Lessee of the obligation

to pay any bonus due thereon to the Louisiana State Mineral Board, nor shall the Louisiana State Mineral Board be obligated to refund any consideration paid by the Lessee prior to such modification, cancellation, or abrogation, including, but not limited to, bonuses, rents and royalties.

NOTE: The State of Louisiana does hereby reserve, and this lease shall be subject to, the imprescriptible right of surface use in the nature of a servitude in favor of the Department of Natural Resources, including its Offices and Commissions, for the sole purpose of implementing, constructing, servicing and maintaining approved coastal zone management and/or restoration projects. Utilization of any and all rights derived under this lease by the mineral lessee, its agents, successors or assigns, shall not interfere with nor hinder the reasonable surface use by the Department of Natural Resources, its Offices or Commissions, as hereinabove reserved.

Applicant: Cash River Exploration, Inc.

Bidder	Cash Payment	Price / Acre	Rental	Oil	Gas	Other