

TRACT 39534 - Webster Parish, Louisiana

A certain Tract of land, excluding the beds and bottoms of all navigable waters, belonging to and not presently under mineral lease from Webster Parish Police Jury on December 12, 2007, being more fully described as follows: All of the land under the roads and otherwise owned by the Webster Parish Police Jury in Section 28, T17N R10W, Webster Parish, LA, **LESS AND EXCEPT** any portion that falls within the boundaries of the Lake Bistineau State Park, containing approximately **18.62 acres**, all as more particularly outlined on a plat on file in the Office of Mineral Resources, Department of Natural Resources. The description is based on information provided by the State Agency regarding location and ownership of surface and mineral rights. All bearings, distances and coordinates, if applicable, are based on Louisiana Coordinate System of 1927, (North or South Zone).

NOTE: The above description of the Tract nominated for lease has been provided and corrected, where required, exclusively by the nomination party. Any mineral lease selected from this Tract and awarded by the Louisiana State Mineral Board shall be without warranty of any kind, either express, implied, or statutory, including, but not limited to, the implied warranties of merchantability and fitness for a particular purpose. Should the mineral lease awarded by the Louisiana State Mineral Board be subsequently modified, cancelled or abrogated due to the existence of conflicting leases, operating agreements, private claims or other future obligations or conditions which may affect all or any portion of the leased Tract, it shall not relieve the Lessee of the obligation to pay any bonus due thereon to the Louisiana State Mineral Board, nor shall the Louisiana State Mineral Board be obligated to refund any consideration paid by the Lessor prior to such modification, cancellation, or abrogation, including, but not limited to, bonuses, rentals and royalties.

NOTE: NOTE: Bidders be advised that tracts nominated in Lake Bistineau in Bienville, Bossier, and Webster Parishes are currently the subject of litigation. Devon Energy Production Co., L.P. v. Gail Norton, Secretary, United States Department of the Interior, Docket No. 04-2093 (W.D. La.), is a dispute between the State of Louisiana and the United States over title to the water bottoms of Lake Bistineau. Any bids accepted for Lake Bistineau tracts are done so with the caveat that title is currently in dispute and that a loss of title by the State of Louisiana may result in a cancellation of State mineral leases on Lake Bistineau by the United States. Any mineral lease selected from Lake Bistineau tracts and awarded by the Louisiana State Mineral Board shall be without warranty of any kind, either express, implied, or statutory, including, but not limited to, the implied warranties of merchantability and fitness for a particular purpose. Should the mineral lease awarded by the Louisiana State Mineral Board be subsequently modified, cancelled, or abrogated due to the existence of conflicting leases, operating agreements, private claims, the Devon Energy litigation, or other future obligations or conditions which may affect all or any portion of the leased tract, it shall not relieve

the Lessee of the obligation to pay any bonus due thereon to the Louisiana State Mineral Board, nor shall the Louisiana State Mineral Board be obligated to refund any consideration paid by the Lessor prior to such modification, cancellation, or abrogation, including, but not limited to, bonuses, rentals and royalties.

Applicant: CYPRESS ENERGY CORPORATION to Agency and by Resolution from the Webster Parish Police Jury authorizing the Mineral Board to act in its behalf

Bidder	Cash Payment	Price/Acre	Rental	Oil	Gas	Other

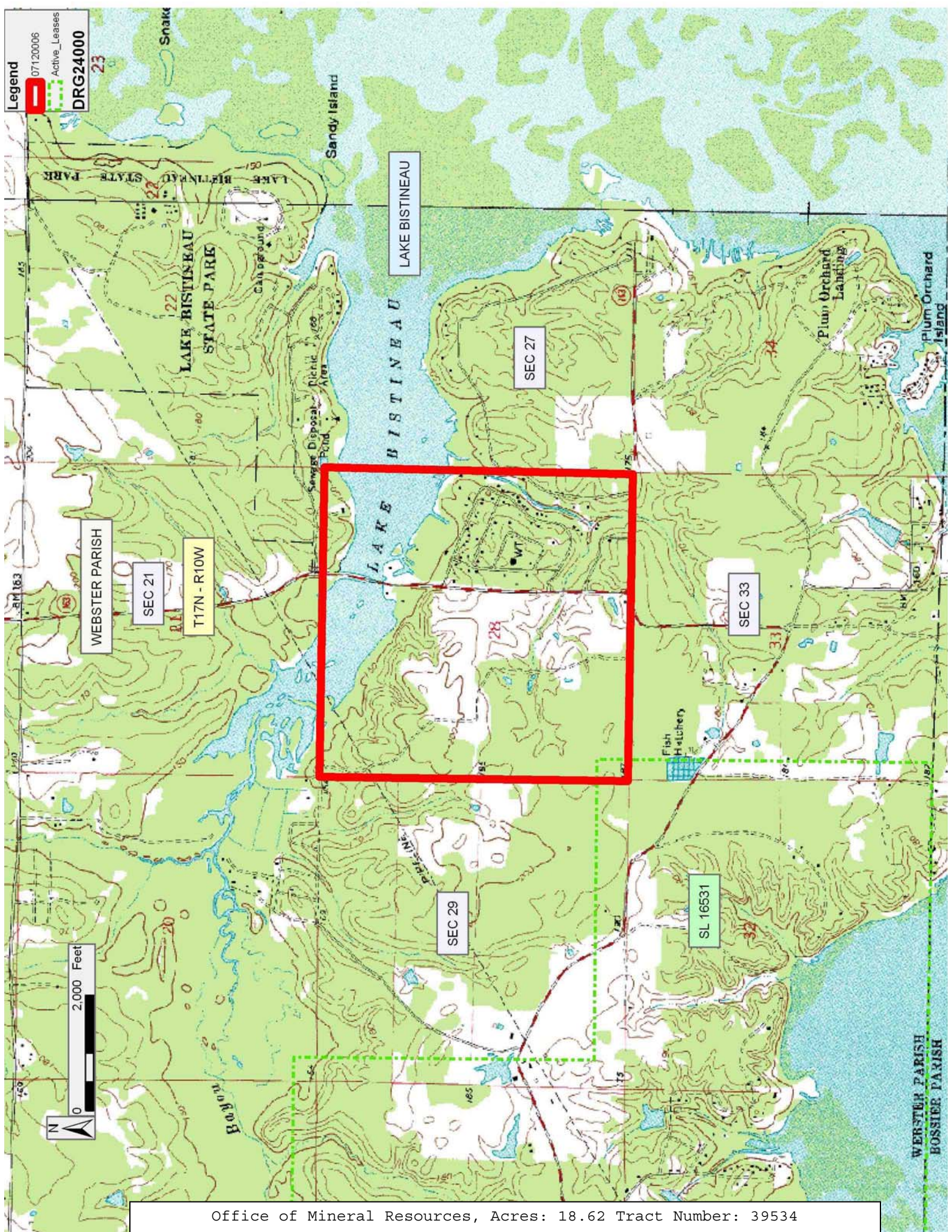

Legend
07120006
Active_Leases
DRG24000
23

WEBSTER PARISH

SEC 21

T17N - R10W

LAKE BISTINEAU

SEC 27

SEC 33

SEC 29

SL 16531

TRACT 39535 - Rapides Parish, Louisiana

A certain Tract of land, excluding the beds and bottoms of all navigable waters, belonging to and not presently under mineral lease from Red River, Atchafalaya & Bayou Boeuf Levee District on December 12, 2007, being more fully described as follows: Being the South Half of the Northeast Quarter of Section 18, Township 4 North Range 5 West, Rapides Parish, Louisiana, containing approximately **80.04 acres**, all as more particularly outlined on a plat on file in the Office of Mineral Resources, Department of Natural Resources. The description is based on information provided by the State Agency regarding location and ownership of surface and mineral rights. All bearings, distances and coordinates, if applicable, are based on Louisiana Coordinate System of 1927, (North or South Zone).

NOTE: The above description of the Tract nominated for lease has been provided and corrected, where required, exclusively by the nomination party. Any mineral lease selected from this Tract and awarded by the Louisiana State Mineral Board shall be without warranty of any kind, either express, implied, or statutory, including, but not limited to, the implied warranties of merchantability and fitness for a particular purpose. Should the mineral lease awarded by the Louisiana State Mineral Board be subsequently modified, cancelled or abrogated due to the existence of conflicting leases, operating agreements, private claims or other future obligations or conditions which may affect all or any portion of the leased Tract, it shall not relieve the Lessee of the obligation to pay any bonus due thereon to the Louisiana State Mineral Board, nor shall the Louisiana State Mineral Board be obligated to refund any consideration paid by the Lessor prior to such modification, cancellation, or abrogation, including, but not limited to, bonuses, rentals and royalties.

Applicant: CYPRESS ENERGY CORPORATION to Agency and by Resolution from the Red River, Atchafalaya & Bayou Boeuf Levee District authorizing the Mineral Board to act in its behalf

Bidder	Cash Payment	Price/Acre	Rental	Oil	Gas	Other

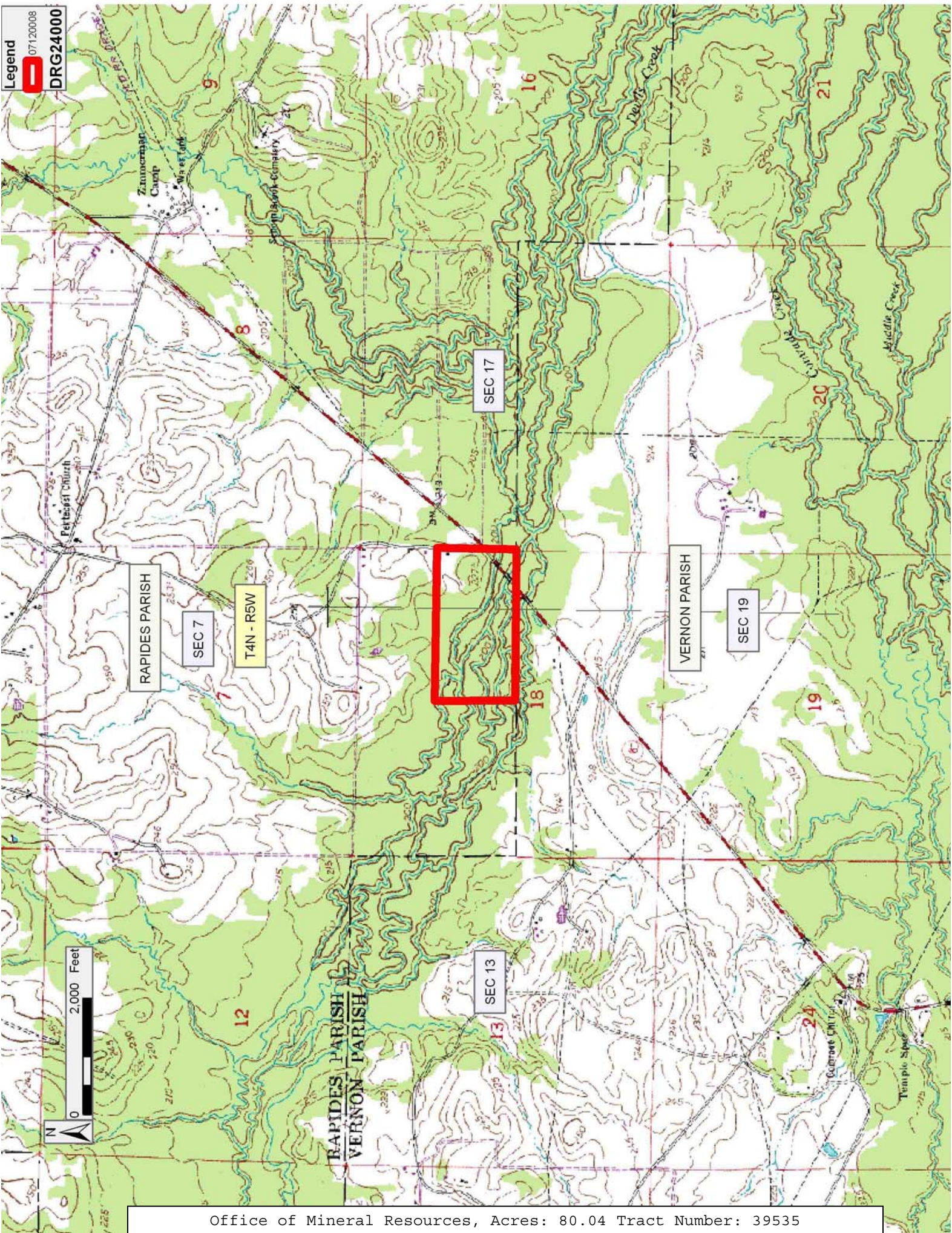

TRACT 39536 - East Baton Rouge Parish, Louisiana

A certain Tract of land, excluding the beds and bottoms of all navigable waters, belonging to and not presently under mineral lease from Louisiana Department Of Public Safety And Corrections on December 12, 2007, being more fully described as follows: All of Section 43, T5S R1W, lying North of the North Right of Way line of Baker Canal and East of the centerline of Louisiana State Route 964 and/or U. S. Hwy. 61; and All that portion of Section 86, T5S R1W, lying East of the centerline of Louisiana State Route 964, **LESS AND EXCEPT:** That part lying North of an East Extension line of the South line of Section 85, T5S R1W; and **LESS AND EXCEPT:** That part lying East of a North Extension line of the East line of Section 43, T5S R1W. Containing approximately **162.00 acres**, all as more particularly outlined on a plat on file in the Office of Mineral Resources, Department of Natural Resources. The description is based on information provided by the State Agency regarding location and ownership of surface and mineral rights. All bearings, distances and coordinates, if applicable, are based on Louisiana Coordinate System of 1927, (North or South Zone).

NOTE: The above description of the Tract nominated for lease has been provided and corrected, where required, exclusively by the nomination party. Any mineral lease selected from this Tract and awarded by the Louisiana State Mineral Board shall be without warranty of any kind, either express, implied, or statutory, including, but not limited to, the implied warranties of merchantability and fitness for a particular purpose. Should the mineral lease awarded by the Louisiana State Mineral Board be subsequently modified, cancelled or abrogated due to the existence of conflicting leases, operating agreements, private claims or other future obligations or conditions which may affect all or any portion of the leased Tract, it shall not relieve the Lessee of the obligation to pay any bonus due thereon to the Louisiana State Mineral Board, nor shall the Louisiana State Mineral Board be obligated to refund any consideration paid by the Lessor prior to such modification, cancellation, or abrogation, including, but not limited to, bonuses, rentals and royalties.

Applicant: SUNNYSIDE RESOURCES, INC. to Agency and by Resolution from the Louisiana Department Of Public Safety And Corrections authorizing the Mineral Board to act in its behalf

Bidder	Cash Payment	Price/Acre	Rental	Oil	Gas	Other

