

TRACT 36982 - Plaquemines Parish, Louisiana

All of the lands now or formerly constituting the beds and bottoms of all water bodies of every nature and description the title of which vests in the State of Louisiana, together with all islands arising therein and other lands formed by accretion or by reliction, where allowed by law, excepting tax adjudicated lands, and not presently under mineral lease on December 8, 2004, situated in Plaquemines Parish, Louisiana, and more particularly described as follows: Beginning at a point having Coordinates of X = 2,639,341.05 and Y = 186,487.35; thence South 01 degrees 43 minutes 52 seconds East approximately 2,640 feet to the point of intersection with the North boundary of State Lease No. 451; thence Westerly along the Northern boundary of State Lease No. 451 approximately 10,560 feet to the Southeast corner of State Lease No. 2203; thence Northerly along the Easternmost line of State Lease No. 2203, or a projection thereof, approximately 2640 feet to the point of intersection with a line that bears South 88 degrees 16 minutes 08 seconds West from the point of beginning; thence North 88 degrees 16 minutes 08 seconds East approximately 10,560 feet to the point of beginning, **LESS AND EXCEPT** that portion, if any, of State Lease No. 451, State Lease No. 2203, and State Lease No. 16885, that may lie within the above described tract, containing approximately **42 acres**, all as more particularly outlined on a plat on file in the Office of Mineral Resources, Department of Natural Resources. All bearings, distances and coordinates are based on Louisiana Coordinate System of 1927, (North or South Zone), where applicable.

NOTE: The above description of the Tract nominated for lease has been provided and corrected, where required, exclusively by the nomination party. Any mineral lease selected from this Tract and awarded by the Louisiana State Mineral Board shall be without warranty of any kind, either express, implied, or statutory, including, but not limited to, the implied warranties of merchantability and fitness for a particular purpose. Should the mineral lease awarded by the Louisiana State Mineral Board be subsequently modified, cancelled or abrogated due to the existence of conflicting leases, operating agreements, private claims or other future obligations or conditions which may affect all or any portion of the leased Tract, it shall not relieve the Lessee of the obligation to pay any bonus due thereon to the Louisiana State Mineral Board, nor shall the Louisiana State Mineral Board be obligated to refund any consideration paid by the Lessor prior to such modification, cancellation, or abrogation, including, but not limited to, bonuses, rentals and royalties.

NOTE: The State of Louisiana does hereby reserve, and this lease shall be subject to, the imprescriptible right of surface use in the nature of a servitude in favor of the Department of Natural Resources, including its Offices and Commissions, for the sole purpose of implementing, constructing, servicing and maintaining approved coastal zone management and/or restoration projects. Utilization of any and all rights derived under this lease by the mineral lessee, its agents, successors or assigns, shall not interfere with nor hinder the reasonable surface use by the

Department of Natural Resources, its Offices or Commissions, as herein above reserved.

NOTE: The Department of Wildlife and Fisheries has designated certain areas in the coastal waters of the State of Louisiana as Oyster Seed Bed Areas. The exact location of those Seed Bed Areas must be obtained from the Department of Wildlife and Fisheries and any work done under a mineral lease from the State of Louisiana may necessarily be conducted in conformity with the rules and regulations promulgated by the said Department of Wildlife and Fisheries for Oyster Seed Bed Areas.

Applicant: Midnight Energy, Inc.

Bidder	Cash Payment	Price/Acre	Rental	Oil	Gas	Other

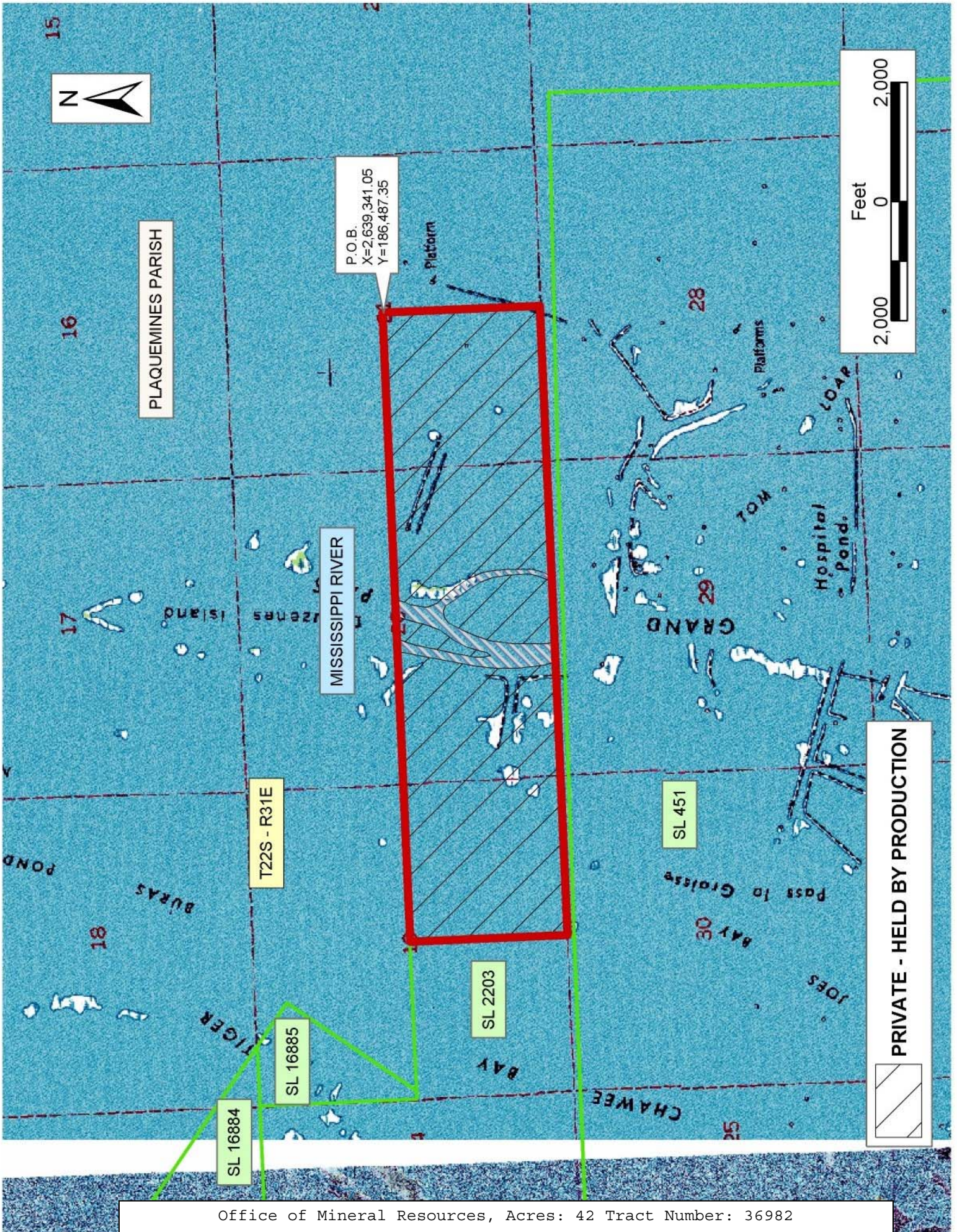

PLAQUEMINES PARISH

MISSISSIPPI RIVER

P.O.B.
X=2,639,341.05
Y=186,487.35

T22S - R31E

SL 16884

SL 16885

SL 2203

SL 451

15

16

17

18

28

29

30

25



PRIVATE - HELD BY PRODUCTION

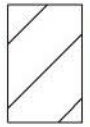

TRACT 36983 - Portion of Block 113, South Timbalier Area, Revised, Terrebonne Parish, Louisiana

All of the lands now or formerly constituting the beds and bottoms of all water bodies of every nature and description the title of which vests in the State of Louisiana, together with all islands arising therein and other lands formed by accretion or by reliction, where allowed by law, excepting tax adjudicated lands, and not presently under mineral lease on December 8, 2004, situated in Terrebonne Parish, Louisiana, and more particularly described as follows: Beginning at a point within Block 113, South Timbalier Area, Revised, having Coordinates of X = 2,221,365.00 and Y = 177,305.00; thence South 47 degrees 02 minutes 20 seconds East 1,093.17 feet to a point having Coordinates of X = 2,222,165.00 and Y = 176,560.00; thence South 28 degrees 56 minutes 09 seconds West 1,405.45 feet to a point having Coordinates of X = 2,221,485.00 and Y = 175,330.00; thence North 88 degrees 11 minutes 46 seconds West 635.31 feet to a point having Coordinates of X = 2,220,850.00 and Y = 175,350.00; thence North 22 degrees 39 minutes 42 seconds West 869.15 feet to a point on the East line of State Lease No. 199, as amended and having Coordinates of X = 2,220,515.12 and Y = 176,152.05; thence along the boundary of said State Lease No. 199 the following courses: North 64 degrees 59 minutes 54 seconds East 597.03 feet North 00 degrees 39 minutes 55 seconds East 144.00 feet, and North 07 degrees 04 minutes 55 seconds East 497.24 feet to a point having Coordinates of X = 2,221,119.19 and Y = 177,041.82; thence North 43 degrees 02 minutes 44 seconds East 360.13 feet to the point of beginning, **LESS AND EXCEPT** any portions of State Lease No. 199, as amended, and State Lease No. 18167 that may lie within the above described tract, containing approximately **39.564 acres**, all as more particularly outlined on a plat on file in the Office of Mineral Resources, Department of Natural Resources. All bearings, distances and coordinates are based on Louisiana Coordinate System of 1927, (North or South Zone), where applicable.

NOTE: The above description of the Tract nominated for lease has been provided and corrected, where required, exclusively by the nomination party. Any mineral lease selected from this Tract and awarded by the Louisiana State Mineral Board shall be without warranty of any kind, either express, implied, or statutory, including, but not limited to, the implied warranties of merchantability and fitness for a particular purpose. Should the mineral lease awarded by the Louisiana State Mineral Board be subsequently modified, cancelled or abrogated due to the existence of conflicting leases, operating agreements, private claims or other future obligations or conditions which may affect all or any portion of the leased Tract, it shall not relieve the Lessee of the obligation to pay any bonus due thereon to the Louisiana State Mineral Board, nor shall the Louisiana State Mineral Board be obligated to refund any consideration paid by the Lessor prior to such modification, cancellation, or abrogation, including, but not limited to, bonuses, rentals and royalties.

NOTE: The State of Louisiana does hereby reserve, and this lease shall be subject to, the imprescriptible right of surface use in the nature of a servitude in favor of the Department of Natural Resources, including its Offices and Commissions, for the sole purpose of implementing, constructing, servicing and maintaining approved coastal zone management and/or restoration projects. Utilization of any and all rights derived under this lease by the mineral lessee, its agents, successors or assigns, shall not interfere with nor hinder the reasonable surface use by the Department of Natural Resources, its Offices or Commissions, as herein above reserved.

NOTE: The Department of Wildlife and Fisheries has designated certain areas in the coastal waters of the State of Louisiana as Oyster Seed Bed Areas. The exact location of those Seed Bed Areas must be obtained from the Department of Wildlife and Fisheries and any work done under a mineral lease from the State of Louisiana may necessarily be conducted in conformity with the rules and regulations promulgated by the said Department of Wildlife and Fisheries for Oyster Seed Bed Areas.

Applicant: The Louisiana Land And Exploration Company

Bidder	Cash Payment	Price/Acre	Rental	Oil	Gas	Other

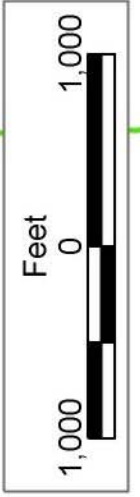

BLOCK ST0113

P.O.B.
X=2,221,365.00
Y=177,305.00

SL 18167

SL 199

T22S - R18E

SOUTH TIMBALIER AREA, REVISED

TERREBONNE PARISH

SL 18167

TRACT 36984 - Portion of Block 43, Ship Shoal Area, Terrebonne Parish, Louisiana

All of the lands now or formerly constituting the beds and bottoms of all water bodies of every nature and description the title of which vests in the State of Louisiana, together with all islands arising therein and other lands formed by accretion or by reliction, where allowed by law, excepting tax adjudicated lands, and not presently under mineral lease on December 8, 2004, situated in Terrebonne Parish, Louisiana, and more particularly described as follows: Beginning at a point within Block 43, Ship Shoal Area having Coordinates of X = 2,175,128.00 and Y = 140,225.99; thence East 8,809.76 feet to a point having Coordinates of X = 2,183,937.76 and Y = 140,225.99; thence South 4,589.31 feet to a point on the North line of State Lease No. 17189 having Coordinates of X = 2,183,937.76 and Y = 135,636.68; thence along the boundary of said State Lease No. 17189 the following courses: Northwesterly in a straight line to a point having Coordinates of X = 2,183,331.00 and Y = 135,655.00; thence Southwesterly in a straight line to a point having Coordinates of X = 2,182,166.00 and Y = 135,368.00; thence Northwesterly in a straight line to the Northwest corner of said State Lease No. 17189 having Coordinates of X = 2,180,645.00 and Y = 135,457.00; thence Northwesterly in a straight line to a point having Coordinates of X = 2,179,937.00 and Y = 135,695.00; thence Westerly in a straight line to a point having Coordinates of X = 2,179,656.74 and Y = 135,689.48; thence North 44 degrees 57 minutes 03 seconds West 6,410.10 feet to the point of beginning, **LESS AND EXCEPT** all that portion of Isles Dernieres Barrier Islands Refuge that lies within the above described tract, containing approximately **644 acres**, all as more particularly outlined on a plat on file in the Office of Mineral Resources, Department of Natural Resources. All bearings, distances and coordinates are based on Louisiana Coordinate System of 1927, (North or South Zone), where applicable.

NOTE: The above description of the Tract nominated for lease has been provided and corrected, where required, exclusively by the nomination party. Any mineral lease selected from this Tract and awarded by the Louisiana State Mineral Board shall be without warranty of any kind, either express, implied, or statutory, including, but not limited to, the implied warranties of merchantability and fitness for a particular purpose. Should the mineral lease awarded by the Louisiana State Mineral Board be subsequently modified, cancelled or abrogated due to the existence of conflicting leases, operating agreements, private claims or other future obligations or conditions which may affect all or any portion of the leased Tract, it shall not relieve the Lessee of the obligation to pay any bonus due thereon to the Louisiana State Mineral Board, nor shall the Louisiana State Mineral Board be obligated to refund any consideration paid by the Lessor prior to such modification, cancellation, or abrogation, including, but not limited to, bonuses, rentals and royalties.

NOTE: This tract is located within the boundaries of a wildlife management area or refuge and any operations conducted thereon in conjunction with

this mineral lease may be subject to rules and regulations promulgated by the Department of Wildlife and Fisheries for the protection of fish, birds and other wildlife including, but not necessarily limited to, the following:

1. No activities will be allowed without written authorization from the Louisiana Department of Wildlife and Fisheries. All projects will be coordinated and approved by the appropriate WMA Supervisor prior to any activities on the wildlife management area.
2. Proposed projects will be evaluated on a case by case basis. Modifications to proposed projects may be required including, but not limited to, access routes, spoil placement, well sites, flow lines and other appurtenant structures required by the Louisiana Department of Wildlife and Fisheries.
3. Compensatory mitigation will be required to offset unavoidable wetland impacts.
4. Removal of all structures, facilities, and equipment will be required within 120 days of abandonment unless otherwise agreed to by the Department of Wildlife and Fisheries.
5. No activities will be allowed during the hunting season unless approved by the Department.
6. Compliance with the said WMA regulations will be required unless otherwise specified by the Department.
7. Prior to submitting applications for wetland permits to Federal and State permitting agencies the lease holder shall coordinate project details with the Louisiana Department of Wildlife and Fisheries, Fur and Refuge Division. Contact person for the Department will be Mike Windham at (504) 568-5886.

NOTE: The State of Louisiana does hereby reserve, and this lease shall be subject to, the imprescriptible right of surface use in the nature of a servitude in favor of the Department of Natural Resources, including its Offices and Commissions, for the sole purpose of implementing, constructing, servicing and maintaining approved coastal zone management and/or restoration projects. Utilization of any and all rights derived under this lease by the mineral lessee, its agents, successors or assigns, shall not interfere with nor hinder the reasonable surface use by the Department of Natural Resources, its Offices or Commissions, as herein above reserved.

NOTE: The Department of Wildlife and Fisheries has designated certain areas in the coastal waters of the State of Louisiana as Oyster Seed Bed Areas. The exact location of those Seed Bed Areas must be obtained from the Department of Wildlife and Fisheries and any work done under a mineral lease from the State of Louisiana may necessarily be conducted in conformity with the rules and regulations promulgated by the said Department of Wildlife and Fisheries for Oyster Seed Bed Areas.

Applicant: The Louisiana Land And Exploration Company

Bidder	Cash Payment	Price/Acre	Rental	Oil	Gas	Other



ISLES DEMIERES
BARRIER ISLANDS
REFUGE

SHIP SHOAL AREA

TERREBONNE PARISH

BLOCK SS0043

P.O.B.
X=2,175,128.00
Y=140,225.99

SL 17604

SL 17596

BLOCK SS0043

SL 17190

SL 16558

SL 17189

