

ROCKEFELLER

TRACT

TRACT 34038 - Vermilion Parish, Louisiana

All State owned lands including high and marsh lands and land now or formerly constituting the beds and bottoms of all rivers, creeks, streams, bayous, lagoons, lakes, bays, coves, sounds, inlets and other water bodies, and also all islands and all other lands owned by the State of Louisiana and not under mineral lease on December 12, 2001, situated in Vermilion Parish, Louisiana, within the following described boundaries: Beginning at a point within the Rockefeller Wildlife and Game Preserve having Coordinates of X = 1,597,230.00 and Y = 359,370.00; thence West approximately 374 feet to the boundary of said Rockefeller Wildlife and Game Preserve; thence along the boundary of said Rockefeller Wildlife and Game Preserve the following courses: Northerly approximately 7,578 feet, Easterly approximately 5,280, Southerly approximately 1,320 feet, Easterly approximately 5,280 feet and Southerly approximately 6,090 feet to a point of intersection with an East-West line having a Coordinate of Y = 359,370.00; thence West approximately 10,193 feet to the point of beginning, containing approximately **1,655 acres**, as shown outlined on a plat on file in the Office of Mineral Resources, Department of Natural Resources, as provided by the applicant. All bearings, distances and coordinates are based on Louisiana Coordinate System of 1927 (South Zone).

NOTE: The above description of the tract nominated for lease has been provided exclusively by the party nominating the tract for lease. The Louisiana State Mineral Board makes no representation as to the accuracy of the description of the nominated tract or its suitability for lease. The Louisiana State Mineral Board has made no inspection of the nominated tract for the existence of conflicting leases, operating agreements, private claims or other existing or future obligations or conditions which may affect all or any portion of the nominated tract or its suitability for lease.

Maps depicting the nominated tract, containing the bearings, distances and coordinates of the nominated tract based on the Louisiana Coordinate System of 1927, North or South Zone, as applicable, are available for public inspection and review at the offices of the Louisiana State Mineral Board from 10:00 a.m. to 3:00 p.m. Monday - Friday.

In the event of conflict between the description of the nominated tract set forth above and the description of the nominated property as contained on the maps maintained at the offices of the Louisiana State Mineral Board, the Louisiana State Mineral Board maps shall prevail and shall provide the final property description of the lease to be awarded of the nominated tract.

Any mineral lease of the nominated tract by the Louisiana State Mineral Board shall be without warranty of any kind, either express, implied, or statutory, including, but not limited to, the implied warranties or merchantability and fitness for a particular purpose. Should the mineral lease of the nominated tract awarded by the Louisiana State Mineral Board be subsequently modified, cancelled or abrogated due to the existence of conflicting leases, operating agreements, private claims or other existing of future obligations or conditions which may affect all or any portion of the leased tract, it shall not relieve the Lessee of the obligation to pay any bonus due thereon to the Louisiana State Mineral Board, nor shall the Louisiana State Mineral Board be obligated to refund any

consideration paid by the Lessee prior to such modification, cancellation, or abrogation, including, but not limited to, bonuses, rents and royalties.

NOTE: This tract may be located within the Rockefeller Wildlife Management Area. Any operations on said tract shall be coordinated with the Louisiana Department of Wildlife and Fisheries. Special Rules and Regulations have been promulgated by the Louisiana Department of Wildlife and Fisheries for the protection of the game and wildlife for some management areas. Any lease awarded by the Board on said tract shall be subject to any applicable Rules and Regulations of said management area. Copies of these Rules and Regulations may be obtained from the Louisiana Department of Wildlife and Fisheries through the Assistant Secretary, Office of Wildlife, upon request.

NOTE: 1. Compliance with the Rockefeller mineral regulations shall be required.

2. No surface activities will be allowed in the vicinity of the Headquarters and associated facilities without written authorization from the Department.

3. Board road access will be required when feasible as determined by the Department.

4. In the event that board road access is not feasible, existing canals and waterways will be utilized to access proposed well locations. A maximum of 350 feet of new canal dredging will be allowed for individual well locations.

5. Compensatory mitigation will be required for unavoidable wetland losses.

6. No discharges will be allowed, including produced waters and drilling fluids. A containerized closed loop system will be required.

7. Seasonal restrictions may be imposed within specific management units dependent upon wildlife population levels.

NOTE: A minimum bonus of \$350.00 per acre and a minimum royalty of 25% will be required.

NOTE: This tract include Management Unit 14 of the Rockefeller Wildlife and Game Preserve. Lessor shall contact the Louisiana Department of Wildlife and Fisheries for additional restrictions within this tract.

NOTE: The State of Louisiana does hereby reserve, and this lease shall be subject to, the imprescriptible right of surface use in the nature of a servitude in favor of the Department of Natural Resources, including its Offices and Commissions, for the sole purpose of implementing, constructing, servicing and maintaining approved coastal zone management and/or restoration projects. Utilization of

any and all rights derived under this lease by the mineral lessee, its agents, successors or assigns, shall not interfere with nor hinder the reasonable surface use by the Department of Natural Resources, its Offices or Commissions, as hereinabove reserved.

Applicant: Bradley Broussard Land Services, Inc.

Bidder	Cash Payment	Price / Acre	Rental	Oil	Gas	Other

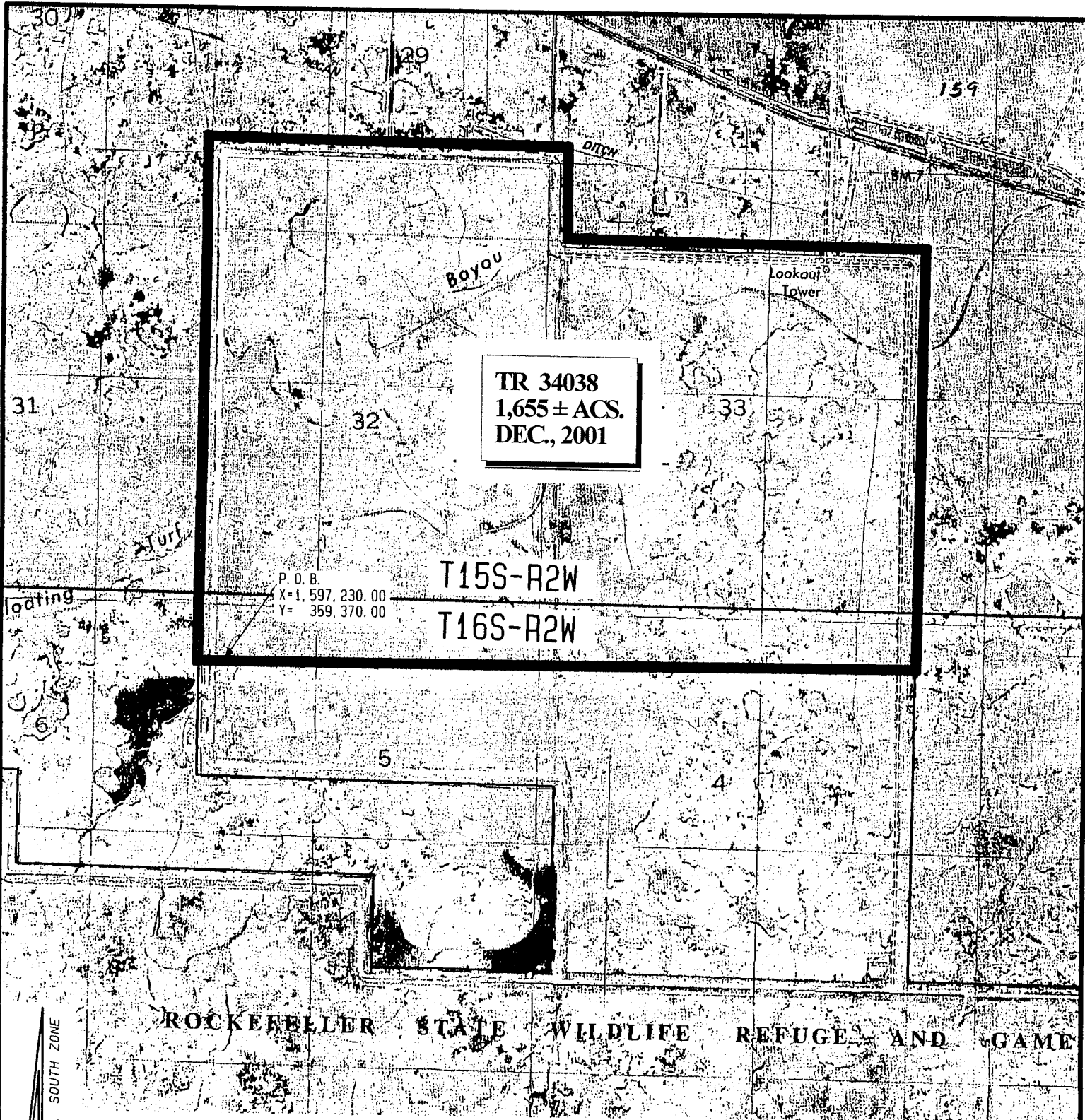

TR 34038
1,655 ± ACS.
DEC., 2001

P. O. B.
X=1,597,230.00
Y=359,370.00

T15S-R2W
T16S-R2W

ROCKEFELLER STATE WILDLIFE REFUGE AND GAME

Topography obtained from USC&GS Quadrangle
"FLOATING TURF, LA.", 1972 Edition.

Vermilion Parish, Louisiana

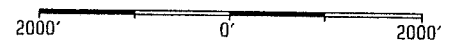

MAD 27 LAMBERT LA. SOUTH ZONE