

TRACT 41166 - Portion of Block 63, Chandeleur Sound Addition Area, Revised, and Block 28, Chandeleur Area, St. Bernard Parish, Louisiana

The beds and bottoms of all water bodies belonging to the State of Louisiana located in Block 63, Chandeleur Sound Addition Area, Revised, and Block 28, Chandeleur Area, together with any present lands formed by accretion to the shoreline or islands formed therein, located in St. Bernard Parish, Louisiana, owned by and not presently under mineral lease as of November 12, 2009, from the State of Louisiana, the geographical area of which is more fully described as follows: Beginning at the Northwest corner of Block 28, Chandeleur Area, having Coordinates of X = 2,782,850.00 and Y = 396,088.05, said point also being the Southwest corner of Block 63, Chandeleur Sound Area Addition, Revised; thence North 1,708.00 feet along the West line of said Block 63 to the Southwest corner of State Lease No. 9680, as amended having Coordinates of X = 2,782,850.00 and Y = 397,796.05; thence along the South boundary of said State Lease No. 9680 the following courses and distances: East 3,452.00 feet to a corner having Coordinates of X = 2,786,302.00 and Y = 397,796.05 and South 68 degrees 59 minutes 37 seconds East 4,764.66 feet to a corner on the South line of said Block 63 having Coordinates of X = 2,790,750.00 and Y = 396,088.05, said corner also located on the North line of said Block 28; thence West 520.98 feet along the North line of said Block 28 to a point having Coordinates of X = 2,790,229.02 and Y = 396,088.05; thence South 11,068.54 feet to a point having Coordinates of X = 2,790,229.02 and Y = 385,019.51; thence West 7,379.02 feet to a point on the West line of said Block 28 having Coordinates of X = 2,782,850.00 and Y = 385,019.51; thence North 11,068.54 feet along the West line of said Block 28 to the point of beginning, containing approximately **2,097.56 acres**, all as more particularly outlined on a plat on file in the Office of Mineral Resources, Department of Natural Resources. All bearings, distances and coordinates are based on Louisiana Coordinate System of 1927, (North or South Zone).

NOTE: The above description of the Tract nominated for lease has been provided and corrected, where required, exclusively by the nomination party. Any mineral lease selected from this Tract and awarded by the Louisiana State Mineral Board shall be without warranty of any kind, either express, implied, or statutory, including, but not limited to, the implied warranties of merchantability and fitness for a particular purpose. Should the mineral lease awarded by the Louisiana State Mineral Board be subsequently modified, cancelled or abrogated due to the existence of conflicting leases, operating agreements, private claims or other future obligations or conditions which may affect all or any portion of the leased Tract, it shall not relieve the Lessee of the obligation to pay any bonus due thereon to the Louisiana State Mineral Board, nor shall the Louisiana State Mineral Board be obligated to refund any consideration paid by the Lessor prior to such modification, cancellation, or abrogation, including, but not limited to, bonuses, rentals and royalties.

NOTE: The Office of Mineral Resources will require a minimum bonus of \$190 per acre and a minimum royalty of 22%.

NOTE: The State of Louisiana does hereby reserve, and this lease shall be subject to, the imprescriptible right of surface use in the nature of a servitude in favor of the Department of Natural Resources, including its Offices and Commissions, for the sole purpose of implementing, constructing, servicing and maintaining approved coastal zone management and/or restoration projects. Utilization of any and all rights derived under this lease by the mineral lessee, its agents, successors or assigns, shall not interfere with nor hinder the reasonable surface use by the Department of Natural Resources, its Offices or Commissions, as herein above reserved.

Applicant: THEOPHILUS OIL, GAS & LAND SERVICES, LLC

Bidder	Cash Payment	Price/ Acre	Rental	Oil	Gas	Other

Legend

- 09110017
- Blocks
- Active_Leases

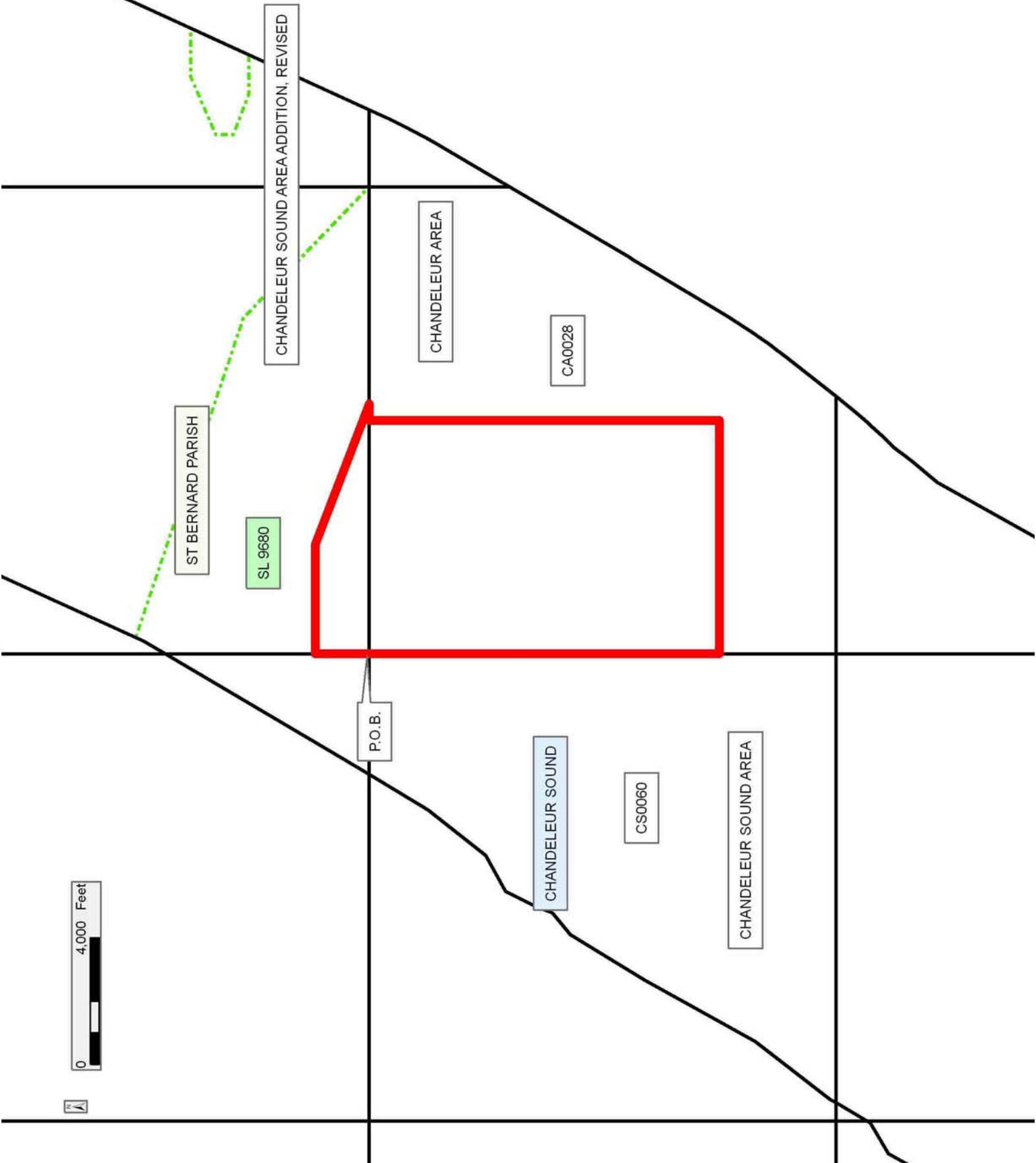

TRACT 41167 - Portion of Block 91, Main Pass Area, Revised, and Block 28, Chandeleur Area, St. Bernard Parish, Louisiana

The beds and bottoms of all water bodies belonging to the State of Louisiana located in Block 91, Main Pass Area, Revised, and Block 28, Chandeleur Area, together with any present lands formed by accretion to the shoreline or islands formed therein, located in St. Bernard Parish, Louisiana, owned by and not presently under mineral lease as of November 12, 2009, from the State of Louisiana, the geographical area of which is more fully described as follows: Beginning at the Northwest corner of Block 91, Main Pass Area, Revised having Coordinates of X = 2,782,850.00 and Y = 381,330.00, said point also being the Southwest corner of Block 28, Chandeleur Area; thence North 3,689.51 feet along the West line of said Block 28 to a point having Coordinates of X = 2,782,850.00 and Y = 385,019.51; thence East 7,379.02 feet to a point having Coordinates of X = 2,790,229.02 and Y = 385,019.51; thence North 3,689.51 feet to a point having Coordinates of X = 2,790,229.02 and Y = 388,709.02; thence East 5,647.50 feet to a point on the Three Mile Line, as decreed by the Supreme Court of the United States, as determined by a Special Master appointed therein, in litigation styled *United States v. State of Louisiana et al No. 9 Original*, in 1975, having Coordinates of X = 2,795,876.52 and Y = 388,709.02; thence Southwesterly along a straight line to a point having Coordinates of X = 2,795,394 and Y = 387,889; thence Southwesterly along an arc to the right having a radius of 18,240.60 feet and a center at X = 2,779,673 and Y = 397,140 to a point having Coordinates of X = 2,795,311 and Y = 387,750; thence Southwesterly on a straight line to a point having Coordinates of X = 2,793,560 and Y = 384,834; thence Southwesterly along an arc to the right having a radius of 18,240.60 feet and a center at X = 2,777,922 and Y = 394,224 to a point having Coordinates of X = 2,792,249 and Y = 382,934; thence Southwesterly on a straight line to a point having Coordinates of X = 2,790,814 and Y = 381,113; thence Southwesterly along an arc to the right having a radius of 18,240.60 feet and a center at X = 2,776,487 and Y = 392,403 to a point having Coordinates of X = 2,789,360 and Y = 379,480; thence Southwesterly along an arc having a radius of 18,240.60 feet and a center at X = 2,774,670 and Y = 390,293 to a point having Coordinates of X = 2,788,262 and Y = 378,129; thence Southwesterly along a straight line to a point having Coordinates of X = 2,786,553 and Y = 375,045; thence Southwesterly along an arc to the right having a radius of 18,240.60 feet and a center at X = 2,770,599 and Y = 383,887 to a point having Coordinates of X = 2,785,895.74 and Y = 373,950.97; thence West 3,045.74 feet to a point on the West line of said Block 91 having Coordinates of X = 2,782,850.00 and Y = 373,950.97; thence North 7,379.03 feet along the West line of said Block 91 to the point of beginning, containing approximately **2,099.38 acres, LESS AND EXCEPT** that portion thereof, if any, lying seaward of the line three nautical miles from the coast line of Louisiana, as said three mile line has been decreed by the Supreme Court of the United States, as determined by a Special Master appointed therein, in litigation styled **United States v. State of Louisiana et al No. 9 Original**, in 1975, all as more particularly outlined on a plat in the Office of Mineral Resources, Department of Natural

Resources. All bearings, distances and coordinates are based on the Louisiana Coordinate System of 1927, (South Zone).

NOTE: The above description of the Tract nominated for lease has been provided and corrected, where required, exclusively by the nomination party. Any mineral lease selected from this Tract and awarded by the Louisiana State Mineral Board shall be without warranty of any kind, either express, implied, or statutory, including, but not limited to, the implied warranties of merchantability and fitness for a particular purpose. Should the mineral lease awarded by the Louisiana State Mineral Board be subsequently modified, cancelled or abrogated due to the existence of conflicting leases, operating agreements, private claims or other future obligations or conditions which may affect all or any portion of the leased Tract, it shall not relieve the Lessee of the obligation to pay any bonus due thereon to the Louisiana State Mineral Board, nor shall the Louisiana State Mineral Board be obligated to refund any consideration paid by the Lessor prior to such modification, cancellation, or abrogation, including, but not limited to, bonuses, rentals and royalties.

NOTE: The Office of Mineral Resources will require a minimum bonus of \$190 per acre and a minimum royalty of 22%.

NOTE: The State of Louisiana does hereby reserve, and this lease shall be subject to, the imprescriptible right of surface use in the nature of a servitude in favor of the Department of Natural Resources, including its Offices and Commissions, for the sole purpose of implementing, constructing, servicing and maintaining approved coastal zone management and/or restoration projects. Utilization of any and all rights derived under this lease by the mineral lessee, its agents, successors or assigns, shall not interfere with nor hinder the reasonable surface use by the Department of Natural Resources, its Offices or Commissions, as herein above reserved.

Applicant: THEOPHILUS OIL, GAS & LAND SERVICES, LLC

Bidder	Cash Payment	Price/ Acre	Rental	Oil	Gas	Other

