

TRACT 38685 - Portion of Block 34, Breton Sound Area, Plaquemines Parish, Louisiana

All of the lands now or formerly constituting the beds and bottoms of all water bodies of every nature and description the title of which vests in the State of Louisiana, together with all islands arising therein and other lands formed by accretion or by reliction, where allowed by law, excepting tax adjudicated lands, and not presently under mineral lease and cross hatched on November 8, 2006, situated in Plaquemines Parish, Louisiana, and more particularly described as follows: Beginning at the Northeast corner of State Lease No. 17963, also being a point on the Southern boundary line of State Lease No. 5049 having Coordinates of X = 2,658,750.00 and Y = 319,330.00; thence along the boundary of said State Lease No. 5049 the following courses: East 225.00 feet and North 29 degrees 32 minutes 20 seconds East 2,552.76 feet to the Northwest corner of State Lease No. 14559, as amended, having Coordinates of X = 2,660,233.55 and Y = 321,550.96; thence South 2,220.96 feet along the Western boundary line of said State Lease No. 14559 to the Northwest corner of State Lease No. 14217, as amended, having Coordinates of X = 2,660,233.55 and Y = 319,330.00; thence South 2,114.46 feet along the Western boundary line of said State Lease No. 14217 to the Northern most Northeast corner of State Lease No. 17767 having Coordinates of X = 2,660,233.55 and Y = 317,215.54; thence West 1,483.55 feet along said Northern boundary line of said State Lease No. 17767 to its Northwest corner, also being the Northeast corner of State Lease No. 14217, as amended, and the Southeast corner of said State Lease No. 17963 having Coordinates of X = 2,658,750.00 and Y = 317,215.54; thence North 2,114.46 feet along the Western boundary line of said State Lease No. 17963 to the point of beginning, containing approximately **104.10 acres**, all as more particularly outlined on a plat on file in the Office of Mineral Resources, Department of Natural Resources. All bearings, distances and coordinates are based on Louisiana Coordinate System of 1927, (North or South Zone), where applicable.

NOTE: The above description of the Tract nominated for lease has been provided and corrected, where required, exclusively by the nomination party. Any mineral lease selected from this Tract and awarded by the Louisiana State Mineral Board shall be without warranty of any kind, either express, implied, or statutory, including, but not limited to, the implied warranties of merchantability and fitness for a particular purpose. Should the mineral lease awarded by the Louisiana State Mineral Board be subsequently modified, cancelled or abrogated due to the existence of conflicting leases, operating agreements, private claims or other future obligations or conditions which may affect all or any portion of the leased Tract, it shall not relieve the Lessee of the obligation to pay any bonus due thereon to the Louisiana State Mineral Board, nor shall the Louisiana State Mineral Board be obligated to refund any consideration paid by the Lessor prior to such modification, cancellation, or abrogation, including, but not limited to, bonuses, rentals and royalties.

NOTE: The State of Louisiana does hereby reserve, and this lease shall be subject to, the imprescriptible right of surface use in the nature of a servitude in favor of the Department of Natural Resources, including its Offices and Commissions, for the sole purpose of implementing, constructing, servicing and maintaining approved coastal zone management and/or restoration projects. Utilization of any and all rights derived under this lease by the mineral lessee, its agents, successors or assigns, shall not interfere with nor hinder the reasonable surface use by the Department of Natural Resources, its Offices or Commissions, as herein above reserved.

Applicant: HAROLD J. ANDERSON, INC.

Bidder	Cash Payment	Price/Acre	Rental	Oil	Gas	Other

Legend

- 06110047
- Blocks
- Active_Leases

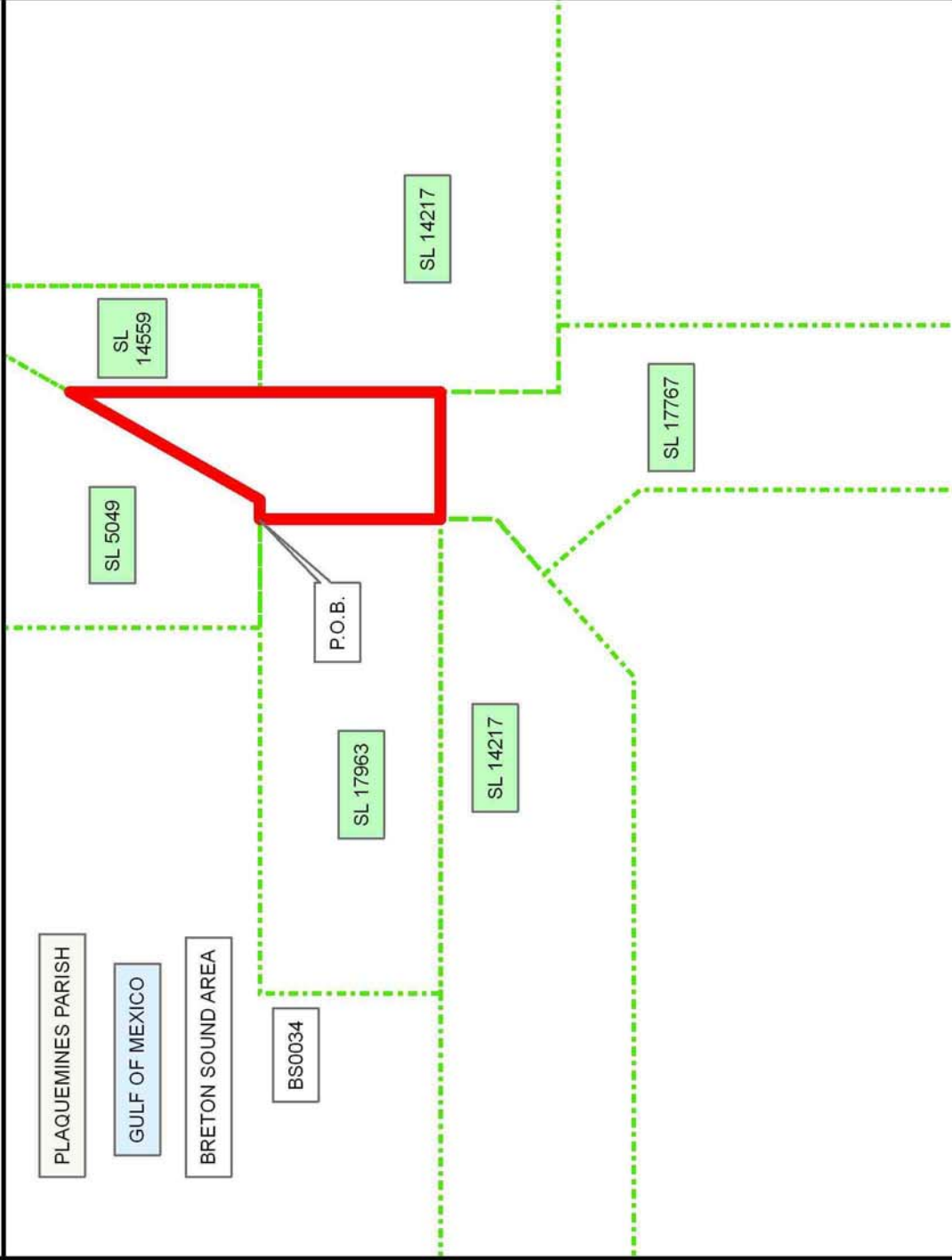

TRACT 38686 - Vermilion Parish, Louisiana

All of the lands now or formerly constituting the beds and bottoms of all water bodies of every nature and description the title of which vests in the State of Louisiana, together with all islands arising therein and other lands formed by accretion or by reliction, where allowed by law, excepting tax adjudicated lands, and not presently under mineral lease and cross hatched on November 8, 2006, situated in Vermilion Parish, Louisiana, and more particularly described as follows: Beginning at a Point on the Louisiana Coastline having Coordinates of X = 1,605,965.00 and Y = 331,030.00; Thence along said Louisiana Coastline the following courses: North 57 degrees 59 minutes 41 seconds West 471.70 feet to a point having Coordinates of X = 1,605,565.00 and Y = 331,280.00, North 83 degrees 52 minutes 49 seconds West 2,438.90 feet to a point having Coordinates of X = 1,603,140.00 and Y = 331,540.00, North 75 degrees 49 minutes 19 seconds West 2,449.62 feet to a point having Coordinates of X = 1,600,765.00 and Y = 332,140.00, North 76 degrees 17 minutes 35 seconds West 1,055.05 feet to a point having Coordinates of X = 1,599,740.00 and Y = 332,390.00, and Northwesterly approximately 3,222 feet to a point having an X Coordinate of X = 1,596,555.78; Thence leaving said Louisiana Coastline North approximately 2,244 feet to a point on the present day shoreline of the Gulf of Mexico having an X Coordinate of X = 1,596,555.78; Thence Southeasterly approximately 11,969 feet along said present day shoreline to a point having an X coordinate of X = 1,607,794.44; Thence leaving said present day shoreline South approximately 2,050 feet to a point on the Louisiana Coastline having an X Coordinate of X = 1,607,794.44; Thence along said Louisiana Coastline Northwesterly approximately 1,837 feet to the point of beginning, containing approximately **571 acres**, all as more particularly outlined on a plat on file in the Office of Mineral Resources, Department of Natural Resources. All bearings, distances and coordinates are based on Louisiana Coordinate System of 1927, (North or South Zone), where applicable.

NOTE: The above description of the Tract nominated for lease has been provided and corrected, where required, exclusively by the nomination party. Any mineral lease selected from this Tract and awarded by the Louisiana State Mineral Board shall be without warranty of any kind, either express, implied, or statutory, including, but not limited to, the implied warranties of merchantability and fitness for a particular purpose. Should the mineral lease awarded by the Louisiana State Mineral Board be subsequently modified, cancelled or abrogated due to the existence of conflicting leases, operating agreements, private claims or other future obligations or conditions which may affect all or any portion of the leased Tract, it shall not relieve the Lessee of the obligation to pay any bonus due thereon to the Louisiana State Mineral Board, nor shall the Louisiana State Mineral Board be obligated to refund any consideration paid by the Lessor prior to such modification, cancellation, or abrogation, including, but not limited to, bonuses, rentals and royalties.

NOTE: The State of Louisiana does hereby reserve, and this lease shall be subject to, the imprescriptible right of surface use in the nature of a servitude in favor of the Department of Natural Resources, including its Offices and Commissions, for the sole purpose of implementing, constructing, servicing and maintaining approved coastal zone management and/or restoration projects. Utilization of any and all rights derived under this lease by the mineral lessee, its agents, successors or assigns, shall not interfere with nor hinder the reasonable surface use by the Department of Natural Resources, its Offices or Commissions, as herein above reserved.

Applicant: GHJ LAND SERVICES, L.L.C.

Bidder	Cash Payment	Price/Acre	Rental	Oil	Gas	Other

Legend

- 06110103
- Wildlife
- Blocks

DOQQ2004

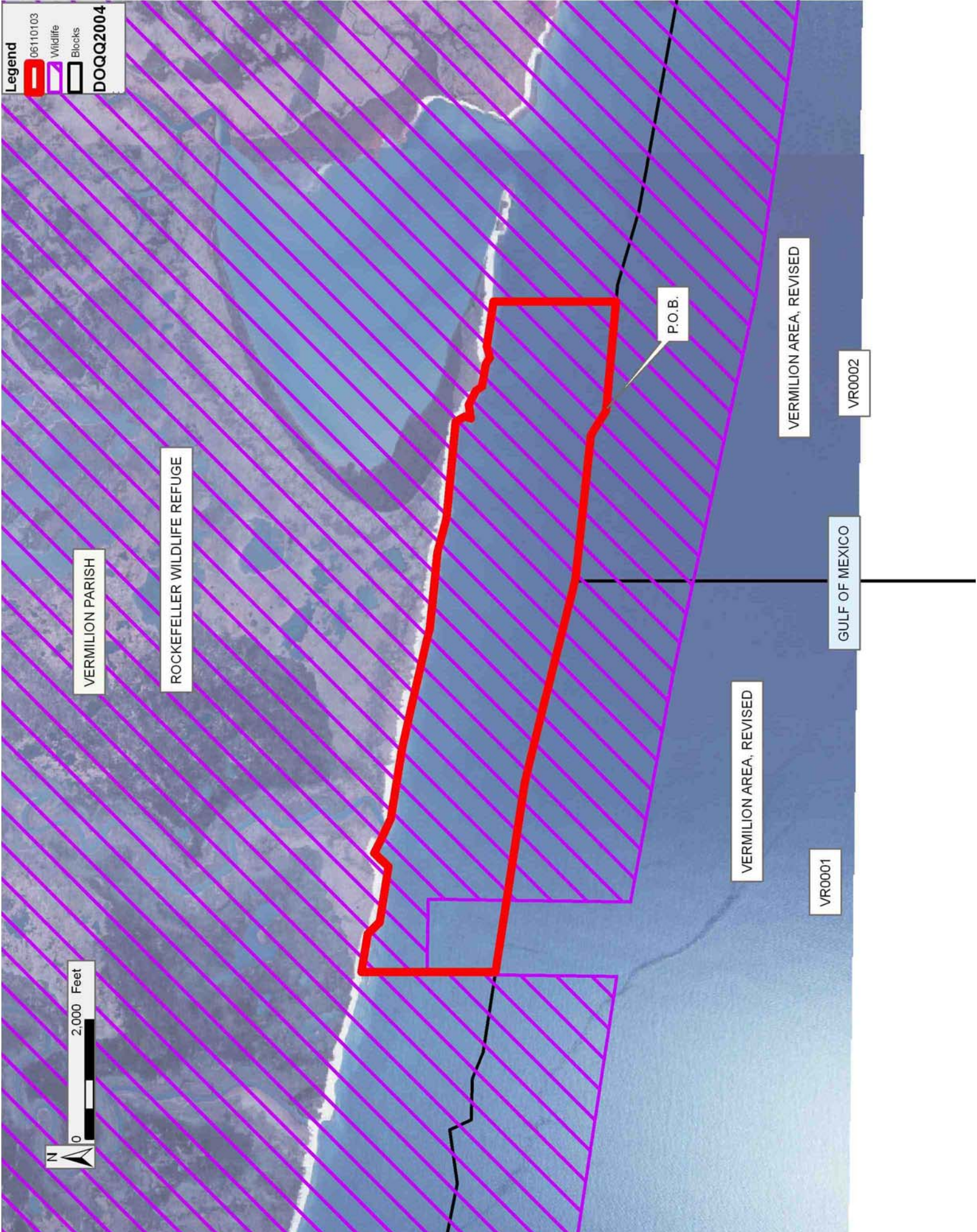

TRACT 38687 - Vermilion Parish, Louisiana

All of the lands now or formerly constituting the beds and bottoms of all water bodies of every nature and description the title of which vests in the State of Louisiana, together with all islands arising therein and other lands formed by accretion or by reliction, where allowed by law, excepting tax adjudicated lands, and not presently under mineral lease and cross hatched on November 8, 2006, situated in Vermilion Parish, Louisiana, and more particularly described as follows: Beginning at a Point on the Louisiana Coastline having Coordinates of X = 1,613,190.00 and Y = 329,780.00; Thence along said Louisiana Coastline the following courses: North 79 degrees 47 minutes 56 seconds West 3,952.48 feet to a point having Coordinates of X = 1,609,300.00 and Y = 330,480.00, North 73 degrees 46 minutes 33 seconds West 1,270.60 feet to a point having Coordinates of X = 1,608,080.00 and Y = 330,835.00, and Northwesterly approximately 287 feet to a point having an X Coordinate of X = 1,607,794.44; Thence leaving said Louisiana Coastline North approximately 2,050 feet to a point on the present day shoreline of the Gulf of Mexico having an X Coordinate of X = 1,607,794.44; Thence Southeasterly approximately 8,843 feet along said present day shoreline to a point having an X Coordinate of X = 1,616,294.44; Thence leaving said present day shoreline South approximately 1,658 feet to a point on the Louisiana Coastline having an X Coordinate of X = 1,616,294.44; Thence along said Louisiana Coastline Northwesterly approximately 3,113 feet to the point of beginning, containing approximately **389 acres**, all as more particularly outlined on a plat on file in the Office of Mineral Resources, Department of Natural Resources. All bearings, distances and coordinates are based on Louisiana Coordinate System of 1927, (North or South Zone), where applicable.

NOTE: The above description of the Tract nominated for lease has been provided and corrected, where required, exclusively by the nomination party. Any mineral lease selected from this Tract and awarded by the Louisiana State Mineral Board shall be without warranty of any kind, either express, implied, or statutory, including, but not limited to, the implied warranties of merchantability and fitness for a particular purpose. Should the mineral lease awarded by the Louisiana State Mineral Board be subsequently modified, cancelled or abrogated due to the existence of conflicting leases, operating agreements, private claims or other future obligations or conditions which may affect all or any portion of the leased Tract, it shall not relieve the Lessee of the obligation to pay any bonus due thereon to the Louisiana State Mineral Board, nor shall the Louisiana State Mineral Board be obligated to refund any consideration paid by the Lessor prior to such modification, cancellation, or abrogation, including, but not limited to, bonuses, rentals and royalties.

NOTE: The State of Louisiana does hereby reserve, and this lease shall be subject to, the imprescriptible right of surface use in the nature of a servitude in favor of the Department of Natural Resources, including its Offices and Commissions, for the sole purpose of implementing,

constructing, servicing and maintaining approved coastal zone management and/or restoration projects. Utilization of any and all rights derived under this lease by the mineral lessee, its agents, successors or assigns, shall not interfere with nor hinder the reasonable surface use by the Department of Natural Resources, its Offices or Commissions, as herein above reserved.

Applicant: GHJ LAND SERVICES, L.L.C.

Bidder	Cash Payment	Price/Acre	Rental	Oil	Gas	Other

Legend

- Wildlife
- Blocks

DOQQ2004

06110104

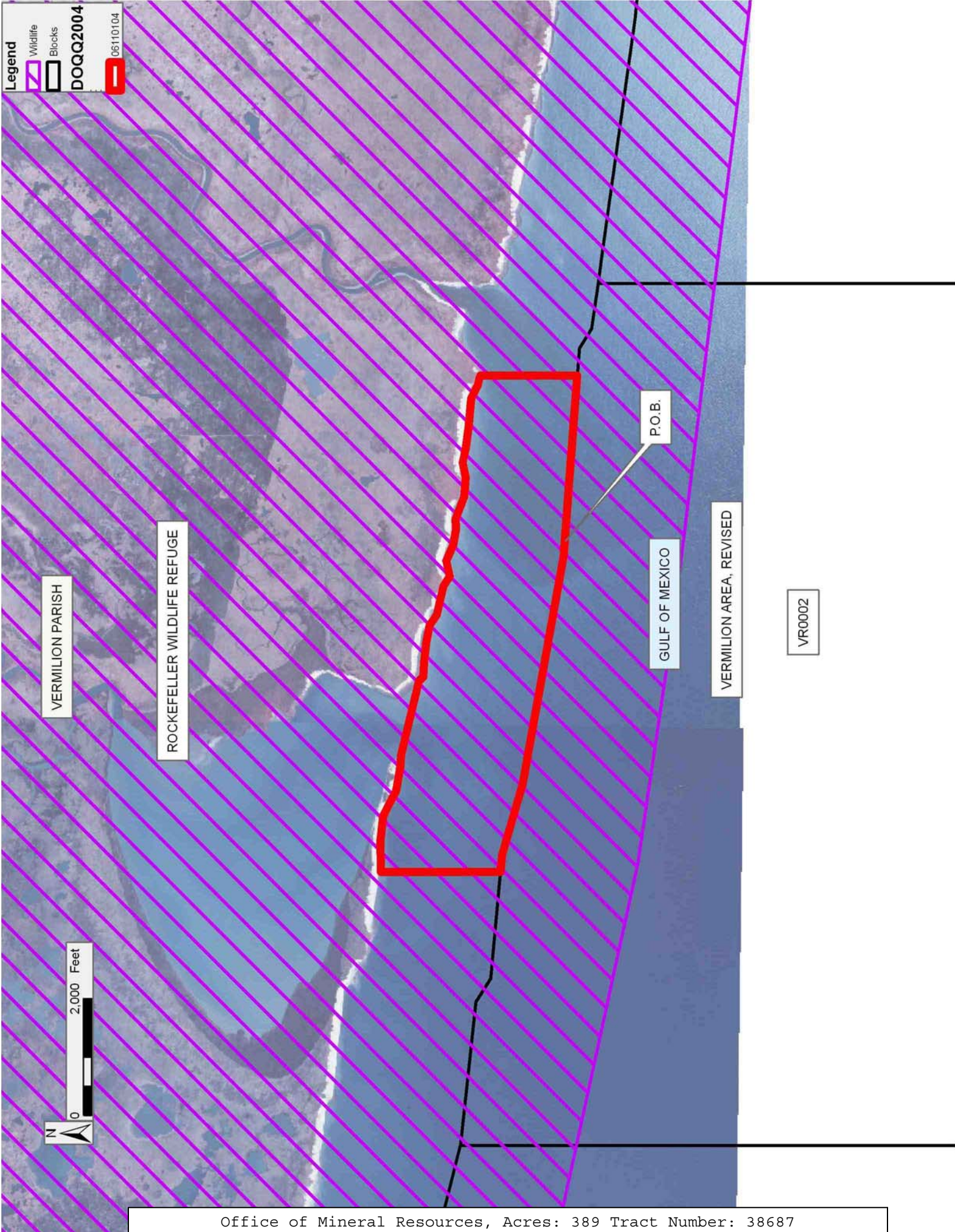

VERMILION PARISH

ROCKEFELLER WILDLIFE REFUGE

P.O.B.

GULF OF MEXICO

VERMILION AREA, REVISED

VR0002



TRACT 38688 - Portion of Block 36, Breton Sound Area, Plaquemines Parish, Louisiana

All of the lands now or formerly constituting the beds and bottoms of all water bodies of every nature and description the title of which vests in the State of Louisiana, together with all islands arising therein and other lands formed by accretion or by reliction, where allowed by law, excepting tax adjudicated lands, and not presently under mineral lease and cross hatched on November 8, 2006, situated in Plaquemines Parish, Louisiana, and more particularly described as follows: Beginning at a point on the West line of Block 36, Breton Sound Area, also being the Northwest corner of State Lease No. 1230, as amended, having Coordinates of X = 2,679,600.00 and Y = 317,280.00; thence along the boundary of said State Lease No. 1230 the following courses: East 7,500.00 feet, South 1,300.00 feet, South 37 degrees 20 minutes 00 seconds West 7,420.24 feet and South 21 degrees 48 minutes 05 seconds West 2,692.58 feet to its most Southerly Southwest corner, also being a point on the South line of said Block 36 having Coordinates of X = 2,681,600.00 and Y = 307,580.00; thence West 2,000.00 feet along the South line of said Block 36, to its Southwest corner, having Coordinates of X = 2,679,600.00 and Y = 307,580.00; thence North 9,700.00 feet along the West line of said Block 36, to the point of beginning, containing approximately **1,078.40 acres**, all as more particularly outlined on a plat on file in the Office of Mineral Resources, Department of Natural Resources. All bearings, distances and coordinates are based on Louisiana Coordinate System of 1927, (North or South Zone), where applicable.

NOTE: The above description of the Tract nominated for lease has been provided and corrected, where required, exclusively by the nomination party. Any mineral lease selected from this Tract and awarded by the Louisiana State Mineral Board shall be without warranty of any kind, either express, implied, or statutory, including, but not limited to, the implied warranties of merchantability and fitness for a particular purpose. Should the mineral lease awarded by the Louisiana State Mineral Board be subsequently modified, cancelled or abrogated due to the existence of conflicting leases, operating agreements, private claims or other future obligations or conditions which may affect all or any portion of the leased Tract, it shall not relieve the Lessee of the obligation to pay any bonus due thereon to the Louisiana State Mineral Board, nor shall the Louisiana State Mineral Board be obligated to refund any consideration paid by the Lessor prior to such modification, cancellation, or abrogation, including, but not limited to, bonuses, rentals and royalties.

NOTE: The State of Louisiana does hereby reserve, and this lease shall be subject to, the imprescriptible right of surface use in the nature of a servitude in favor of the Department of Natural Resources, including its Offices and Commissions, for the sole purpose of implementing, constructing, servicing and maintaining approved coastal zone management and/or restoration projects. Utilization of any and all rights derived under this lease by the mineral lessee, its agents, successors or assigns,

shall not interfere with nor hinder the reasonable surface use by the Department of Natural Resources, its Offices or Commissions, as herein above reserved.

NOTE: It appears, according to our records, that a portion of this Tract is located within the restrictive safety fairway area as set out by the Corps of Engineers, U.S. Army and/or the restrictive anchorage area as set out by the U.S. Coast Guard.

Applicant: HAROLD J. ANDERSON, INC.

Bidder	Cash Payment	Price/Acre	Rental	Oil	Gas	Other

Legend

- 06110043
- Blocks
- Active_Leases

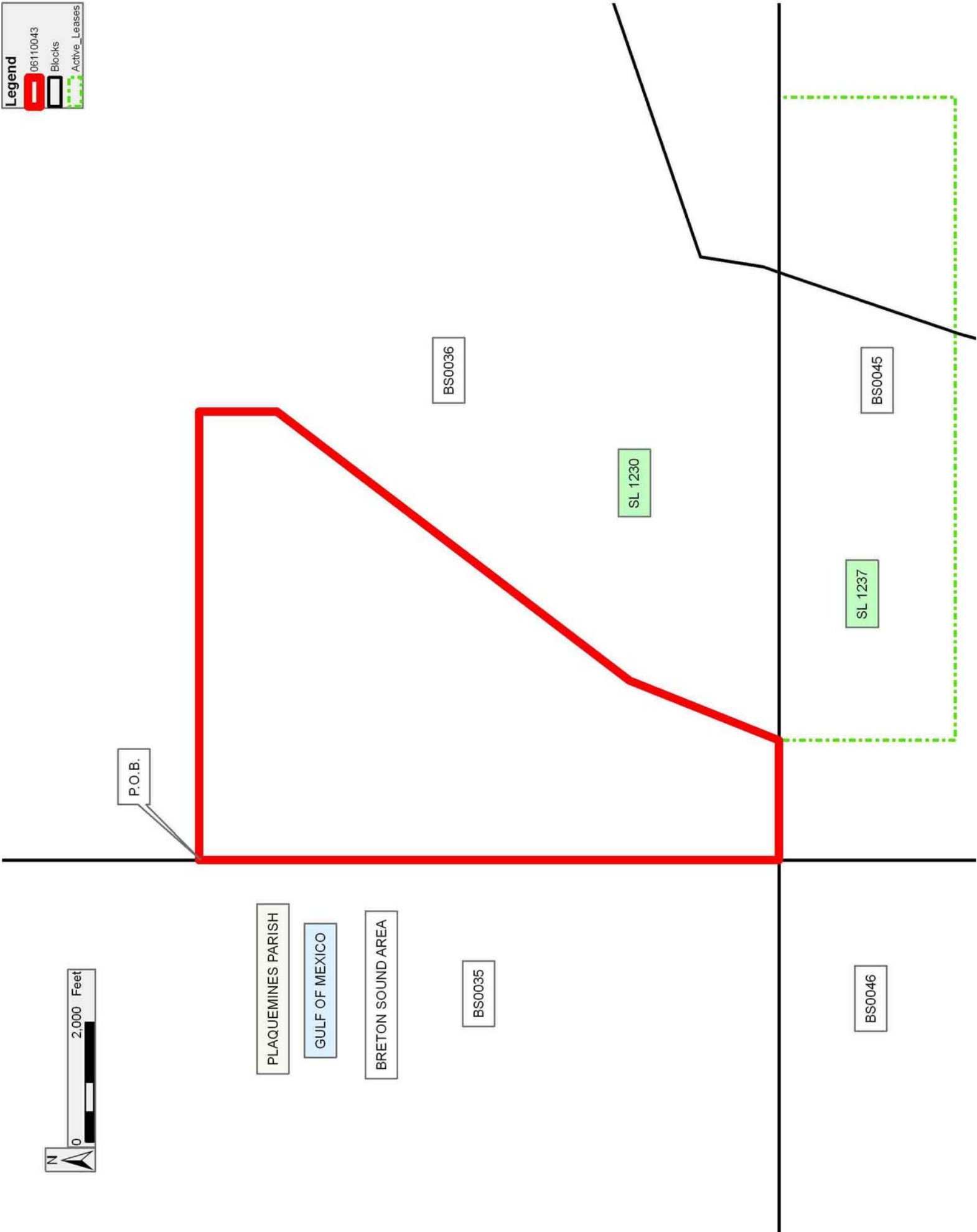

TRACT 38689 - Portion of Block 34, Breton Sound Area, Plaquemines Parish, Louisiana

All of the lands now or formerly constituting the beds and bottoms of all water bodies of every nature and description the title of which vests in the State of Louisiana, together with all islands arising therein and other lands formed by accretion or by reliction, where allowed by law, excepting tax adjudicated lands, and not presently under mineral lease and cross hatched on November 8, 2006, situated in Plaquemines Parish, Louisiana, and more particularly described as follows: Beginning at a point on the South boundary of the Eastern portion of State Lease No. 14217, as amended, also being a Northeast corner of State Lease No. 17767 having Coordinates of X = 2,661,015.00 and Y = 315,836.48; thence East 3,835.00 feet along the South boundary of said Eastern portion of State Lease No. 14217 to its Southeast corner, also being a point on the East line of Block 34, Breton Sound Area, having Coordinates of X = 2,664,850.00 and Y = 315,836.48; thence South 8,256.48 feet along said East line of said Block 34, to its Southeast corner having Coordinates of X = 2,664,850.00 and Y = 307,580.00; thence West 14,750.00 feet along the South line of said Block 34, to its Southwest corner having Coordinates of X = 2,650,100.00 and Y = 307,580.00; thence North 995.79 feet along the West line of said Block 34, to the Southwest corner of State Lease No. 14560, as amended, having Coordinates of X = 2,650,100.00 and Y = 308,575.79; thence along the boundary of said State Lease No. 14560 the following courses: East 4,590.00 feet and North 2,129.21 feet to the Southernmost Southwest corner of State Lease No. 17965 having Coordinates of X = 2,654,690.00 and Y = 310,705.00; thence East 4,395.00 feet along the South boundary of said State Lease No. 17965 to its Southeast corner, also being the Southwest corner of said State Lease No. 17767 having Coordinates of X = 2,659,085.00 and Y = 310,705.00; thence along the boundary of said State Lease No. 17767 the following courses: East 1,930.00 feet to its Southeast corner having Coordinates of X = 2,661,015.00 and Y = 310,705.00 and North 5,131.48 feet to the point of beginning, containing approximately **1,285.58 acres**, all as more particularly outlined on a plat on file in the Office of Mineral Resources, Department of Natural Resources. All bearings, distances and coordinates are based on Louisiana Coordinate System of 1927, (North or South Zone), where applicable.

NOTE: The above description of the Tract nominated for lease has been provided and corrected, where required, exclusively by the nomination party. Any mineral lease selected from this Tract and awarded by the Louisiana State Mineral Board shall be without warranty of any kind, either express, implied, or statutory, including, but not limited to, the implied warranties of merchantability and fitness for a particular purpose. Should the mineral lease awarded by the Louisiana State Mineral Board be subsequently modified, cancelled or abrogated due to the existence of conflicting leases, operating agreements, private claims or other future obligations or conditions which may affect all or any portion of the leased Tract, it shall not relieve the Lessee of the obligation to

pay any bonus due thereon to the Louisiana State Mineral Board, nor shall the Louisiana State Mineral Board be obligated to refund any consideration paid by the Lessor prior to such modification, cancellation, or abrogation, including, but not limited to, bonuses, rentals and royalties.

NOTE: The State of Louisiana does hereby reserve, and this lease shall be subject to, the imprescriptible right of surface use in the nature of a servitude in favor of the Department of Natural Resources, including its Offices and Commissions, for the sole purpose of implementing, constructing, servicing and maintaining approved coastal zone management and/or restoration projects. Utilization of any and all rights derived under this lease by the mineral lessee, its agents, successors or assigns, shall not interfere with nor hinder the reasonable surface use by the Department of Natural Resources, its Offices or Commissions, as herein above reserved.

Applicant: HAROLD J. ANDERSON, INC.

Bidder	Cash Payment	Price/Acre	Rental	Oil	Gas	Other

Legend

- 06110046
- Active_Leases
- Blocks

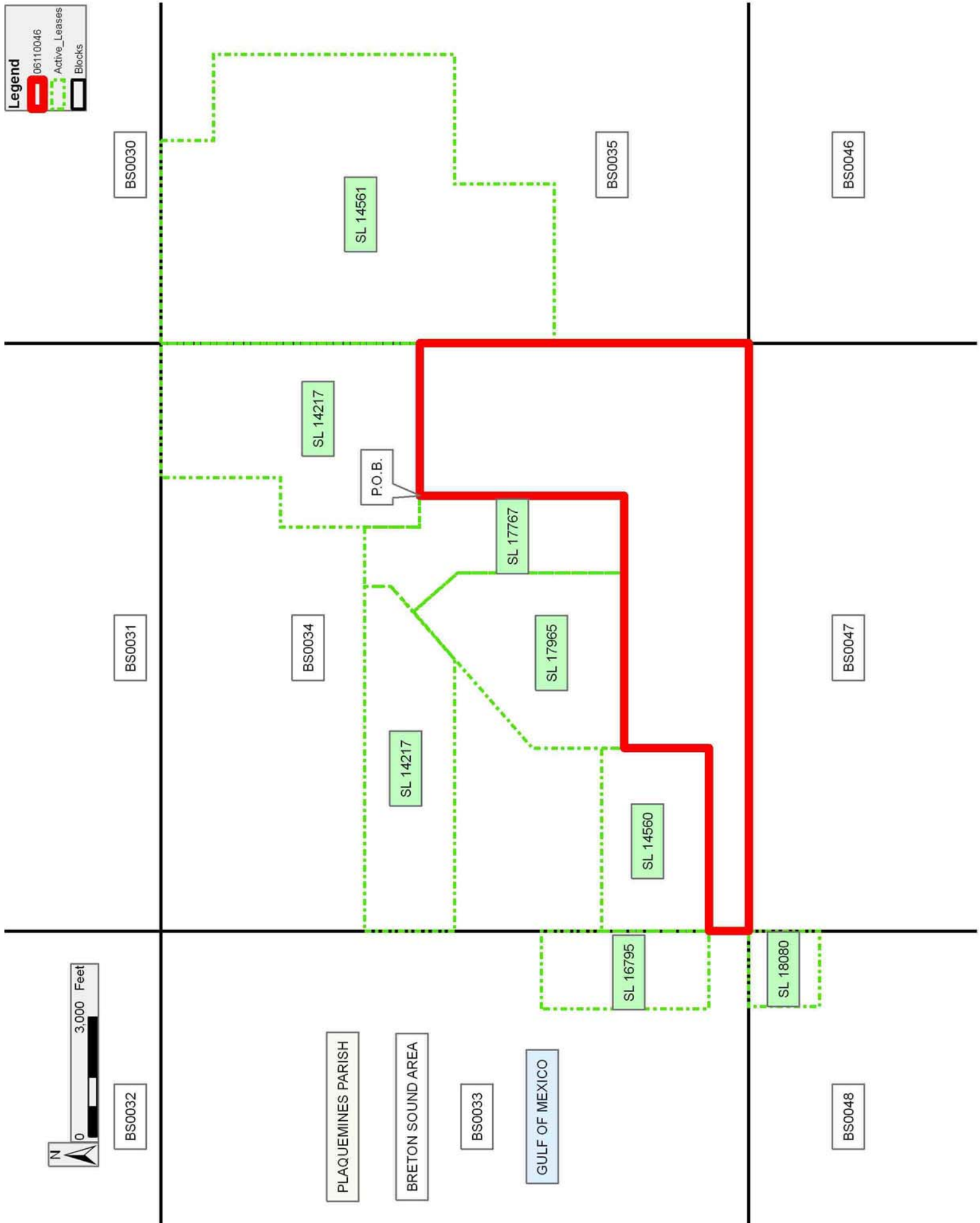

BS00032

PLAQUEMINES PARISH

BRETON SOUND AREA

BS00033

GULF OF MEXICO

TRACT 38690 - Portion of Block 35, Breton Sound Area, Plaquemines Parish, Louisiana

All of the lands now or formerly constituting the beds and bottoms of all water bodies of every nature and description the title of which vests in the State of Louisiana, together with all islands arising therein and other lands formed by accretion or by reliction, where allowed by law, excepting tax adjudicated lands, and not presently under mineral lease and cross hatched on November 8, 2006, situated in Plaquemines Parish, Louisiana, and more particularly described as follows: Beginning at a point on the West line of Block 35, Breton Sound Area, also being the Southwest corner of State Lease No. 14561 having Coordinates of X = 2,664,850.00 and Y = 312,455.00; thence East 3,999.40 feet along the South line of said State Lease No. 14561 to its Southern most Southeast corner, also being the Southwest corner of State Lease No. 18340 having Coordinates of X = 2,668,849.40 and Y = 312,455.00; thence South 39 degrees 22 minutes 25 seconds East 6,306.38 feet to the most Southerly Southwest corner of said State Lease No. 18340, also being a point on the South line of Block 35, having Coordinates of X = 2,672,850.00 and Y = 307,580.00; thence West 3,763.94 feet along said South line of said Block 34 to the Southeast corner of State Lease No. 17964 having Coordinates of X = 2,669,086.06 and Y = 307,580.00; thence along the boundary of said State Lease No. 17964 the following courses: North 3,048.68 feet, West 2,640.03 feet and South 3,048.68 feet to a point on the South line of said Block 35, having Coordinates of X = 2,666,446.03 and Y = 307,580.00; thence West 1,596.03 feet to its Southwest corner having Coordinates of X = 2,664,850.00 and Y = 307,580.00; thence North 4,875.00 feet along the West line of said Block 35, to the point of beginning, containing approximately **486.68 acres**, all as more particularly outlined on a plat on file in the Office of Mineral Resources, Department of Natural Resources. All bearings, distances and coordinates are based on Louisiana Coordinate System of 1927, (North or South Zone), where applicable.

NOTE: The above description of the Tract nominated for lease has been provided and corrected, where required, exclusively by the nomination party. Any mineral lease selected from this Tract and awarded by the Louisiana State Mineral Board shall be without warranty of any kind, either express, implied, or statutory, including, but not limited to, the implied warranties of merchantability and fitness for a particular purpose. Should the mineral lease awarded by the Louisiana State Mineral Board be subsequently modified, cancelled or abrogated due to the existence of conflicting leases, operating agreements, private claims or other future obligations or conditions which may affect all or any portion of the leased Tract, it shall not relieve the Lessee of the obligation to pay any bonus due thereon to the Louisiana State Mineral Board, nor shall the Louisiana State Mineral Board be obligated to refund any consideration paid by the Lessor prior to such modification, cancellation, or abrogation, including, but not limited to, bonuses, rentals and royalties.

NOTE: The State of Louisiana does hereby reserve, and this lease shall be subject to, the imprescriptible right of surface use in the nature of a servitude in favor of the Department of Natural Resources, including its Offices and Commissions, for the sole purpose of implementing, constructing, servicing and maintaining approved coastal zone management and/or restoration projects. Utilization of any and all rights derived under this lease by the mineral lessee, its agents, successors or assigns, shall not interfere with nor hinder the reasonable surface use by the Department of Natural Resources, its Offices or Commissions, as herein above reserved.

Applicant: HAROLD J. ANDERSON, INC.

Bidder	Cash Payment	Price/Acre	Rental	Oil	Gas	Other

Legend

- 06110042
- Blocks
- Active_Leases

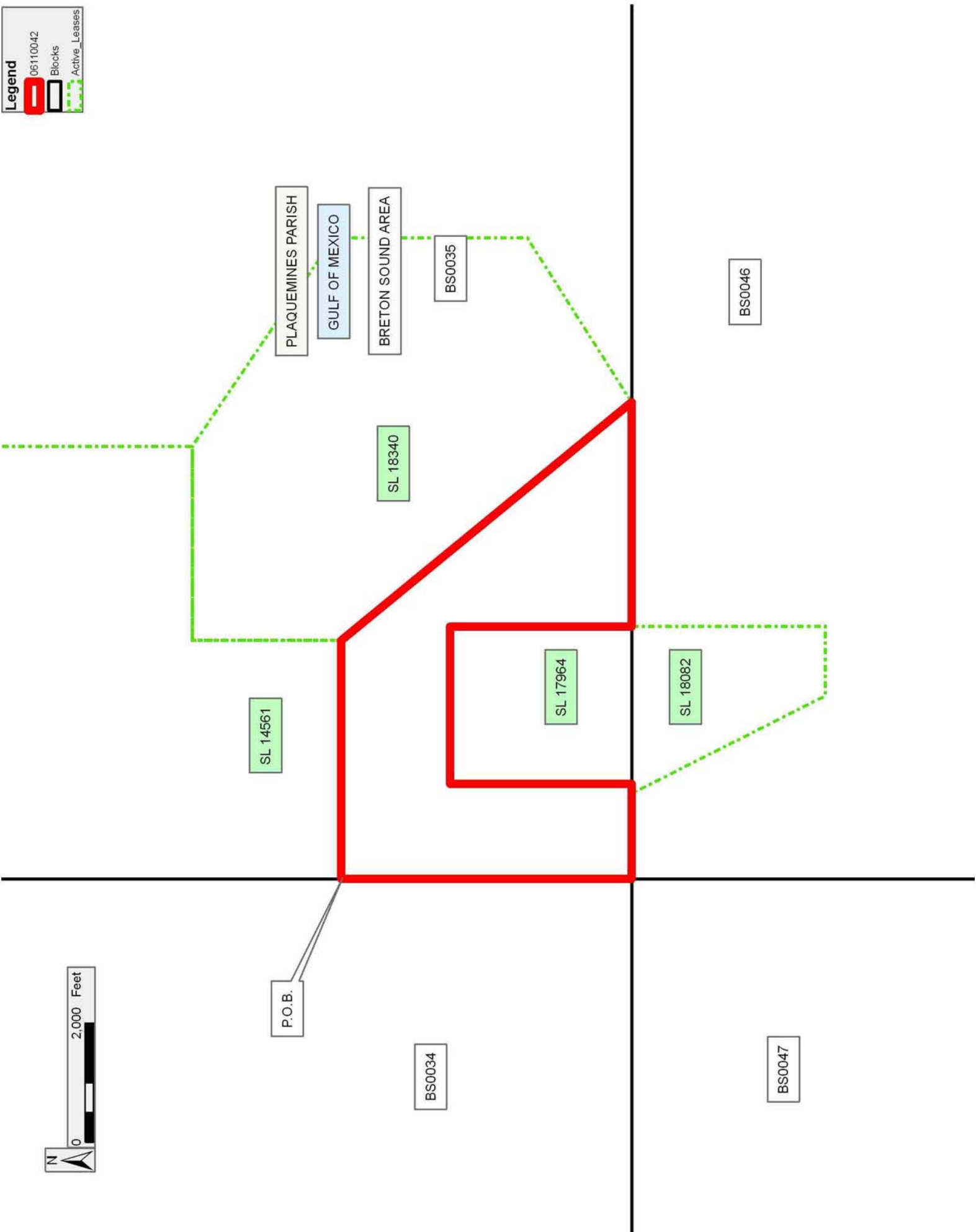

TRACT 38691 - Portion of Block 47, Breton Sound Area, Plaquemines Parish, Louisiana

All of the lands now or formerly constituting the beds and bottoms of all water bodies of every nature and description the title of which vests in the State of Louisiana, together with all islands arising therein and other lands formed by accretion or by reliction, where allowed by law, excepting tax adjudicated lands, and not presently under mineral lease and cross hatched on November 8, 2006, situated in Plaquemines Parish, Louisiana, and more particularly described as follows: Beginning at the Northwest corner of Block 47, Breton Sound Area, having Coordinates of X = 2,650,100.00 and Y = 307,580.00; thence East 14,750.00 feet along the North line of said Block 47, to its Northeast corner having Coordinates of X = 2,664,850.00 and Y = 307,580.00; thence South 7,375.00 feet along the East line of said Block 47 to its Southeast corner having Coordinates of X = 2,664,850.00 and Y = 300,205.00; thence West 3,552.00 feet to a point on the North line of State Lease No. 16569, as amended, having Coordinates of X = 2,661,298.00 and Y = 300,205.00; thence along the boundary of said State Lease No. 16569 the following courses: North 75 degrees 24 minutes 12 seconds West 1,289.62 feet, West 795.00 feet and South 56 degrees 27 minutes 32 seconds West 588.20 feet to a point having Coordinates of X = 2,658,764.74 and Y = 300,205.00; thence West 8,664.74 feet to a point on the West line of said Block 47, having Coordinates of X = 2,650,100.00 and Y = 300,205.00; thence North 7,375.00 feet along the West line of said Block 47, to the point of beginning, containing approximately **2,484.86 acres**, all as more particularly outlined on a plat on file in the Office of Mineral Resources, Department of Natural Resources. All bearings, distances and coordinates are based on Louisiana Coordinate System of 1927, (North or South Zone), where applicable.

NOTE: The above description of the Tract nominated for lease has been provided and corrected, where required, exclusively by the nomination party. Any mineral lease selected from this Tract and awarded by the Louisiana State Mineral Board shall be without warranty of any kind, either express, implied, or statutory, including, but not limited to, the implied warranties of merchantability and fitness for a particular purpose. Should the mineral lease awarded by the Louisiana State Mineral Board be subsequently modified, cancelled or abrogated due to the existence of conflicting leases, operating agreements, private claims or other future obligations or conditions which may affect all or any portion of the leased Tract, it shall not relieve the Lessee of the obligation to pay any bonus due thereon to the Louisiana State Mineral Board, nor shall the Louisiana State Mineral Board be obligated to refund any consideration paid by the Lessor prior to such modification, cancellation, or abrogation, including, but not limited to, bonuses, rentals and royalties.

NOTE: The State of Louisiana does hereby reserve, and this lease shall be subject to, the imprescriptible right of surface use in the nature of a servitude in favor of the Department of Natural Resources, including its Offices and Commissions, for the sole purpose of implementing,

constructing, servicing and maintaining approved coastal zone management and/or restoration projects. Utilization of any and all rights derived under this lease by the mineral lessee, its agents, successors or assigns, shall not interfere with nor hinder the reasonable surface use by the Department of Natural Resources, its Offices or Commissions, as herein above reserved.

Applicant: HAROLD J. ANDERSON, INC.

Bidder	Cash Payment	Price/Acre	Rental	Oil	Gas	Other

Legend

- 06110040
- Blocks
- Active_Leases

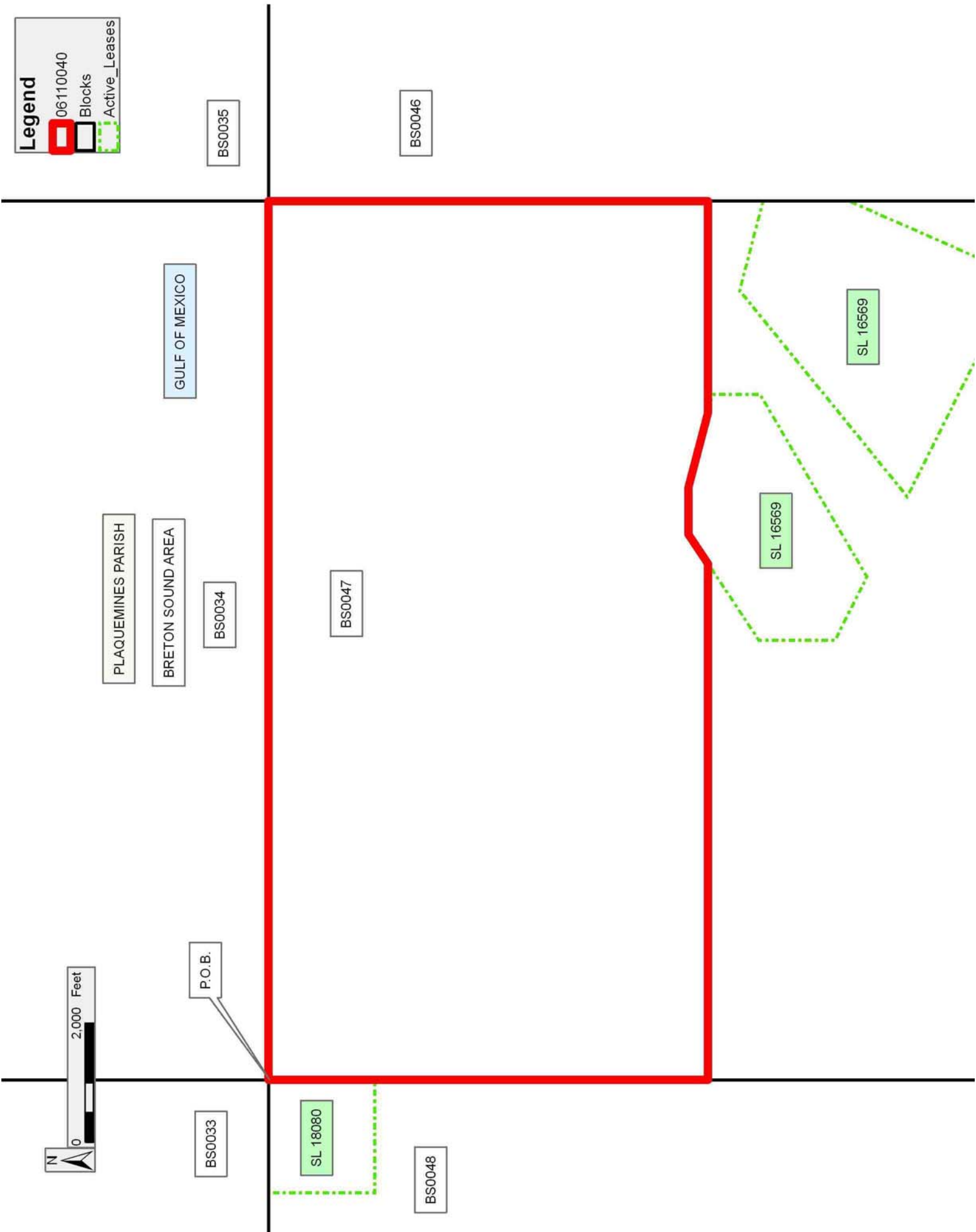

TRACT 38692 - Portion of Block 46, Breton Sound Area, Plaquemines Parish, Louisiana

All of the lands now or formerly constituting the beds and bottoms of all water bodies of every nature and description the title of which vests in the State of Louisiana, together with all islands arising therein and other lands formed by accretion or by reliction, where allowed by law, excepting tax adjudicated lands, and not presently under mineral lease and cross hatched on November 8, 2006, situated in Plaquemines Parish, Louisiana, and more particularly described as follows: Beginning at a point on the West line of Block 46, Breton Sound Area, having Coordinates of X = 2,664,850.00 and Y = 307,580.00; thence East 1,427.71 feet along the North line of said Block 46, to a point on the boundary of State Lease No. 18082 having Coordinates of X = 2,666,277.71 and Y = 307,580.00; thence along the boundary of said State Lease No. 18082 the following courses: South 26 degrees 48 minutes 13 seconds East 3,631.14 feet, East 1,170.95 feet, and North 3,241.00 feet to its Northeast corner having Coordinates of X = 2,669,086.06 and Y = 307,580.00; thence East 10,513.94 feet along the North line of said Block 46, to its Northeast corner, having Coordinates of X = 2,679,600.00 and Y = 307,580.00; thence South 6,350.00 feet along the East line of said Block 46 to the Eastern most Northeast corner of State Lease No. 17689, having Coordinates of X = 2,679,600.00 and Y = 301,230.00; thence along the boundary of said State Lease No. 17689 the following courses: West 2,361.55 feet and South 33 degrees 14 minutes 29 seconds West 1,225.54 feet to a point having Coordinates of X = 2,676,566.65 and Y = 300,205.00; thence West 11,716.65 feet to a point on the West line of said Block 46 having Coordinates of X = 2,664,850.00 and Y = 300,205.00; thence North 7,375.00 feet along the West line of said Block 46, to the point of beginning, containing approximately **2,285.76 acres**, all as more particularly outlined on a plat on file in the Office of Mineral Resources, Department of Natural Resources. All bearings, distances and coordinates are based on Louisiana Coordinate System of 1927, (North or South Zone), where applicable.

NOTE: The above description of the Tract nominated for lease has been provided and corrected, where required, exclusively by the nomination party. Any mineral lease selected from this Tract and awarded by the Louisiana State Mineral Board shall be without warranty of any kind, either express, implied, or statutory, including, but not limited to, the implied warranties of merchantability and fitness for a particular purpose. Should the mineral lease awarded by the Louisiana State Mineral Board be subsequently modified, cancelled or abrogated due to the existence of conflicting leases, operating agreements, private claims or other future obligations or conditions which may affect all or any portion of the leased Tract, it shall not relieve the Lessee of the obligation to pay any bonus due thereon to the Louisiana State Mineral Board, nor shall the Louisiana State Mineral Board be obligated to refund any consideration paid by the Lessor prior to such modification, cancellation, or abrogation, including, but not limited to, bonuses, rentals and royalties.

NOTE: The State of Louisiana does hereby reserve, and this lease shall be subject to, the imprescriptible right of surface use in the nature of a servitude in favor of the Department of Natural Resources, including its Offices and Commissions, for the sole purpose of implementing, constructing, servicing and maintaining approved coastal zone management and/or restoration projects. Utilization of any and all rights derived under this lease by the mineral lessee, its agents, successors or assigns, shall not interfere with nor hinder the reasonable surface use by the Department of Natural Resources, its Offices or Commissions, as herein above reserved.

Applicant: HAROLD J. ANDERSON, INC.

Bidder	Cash Payment	Price/Acre	Rental	Oil	Gas	Other

Legend

- 06110045
- Blocks
- Active_Leases

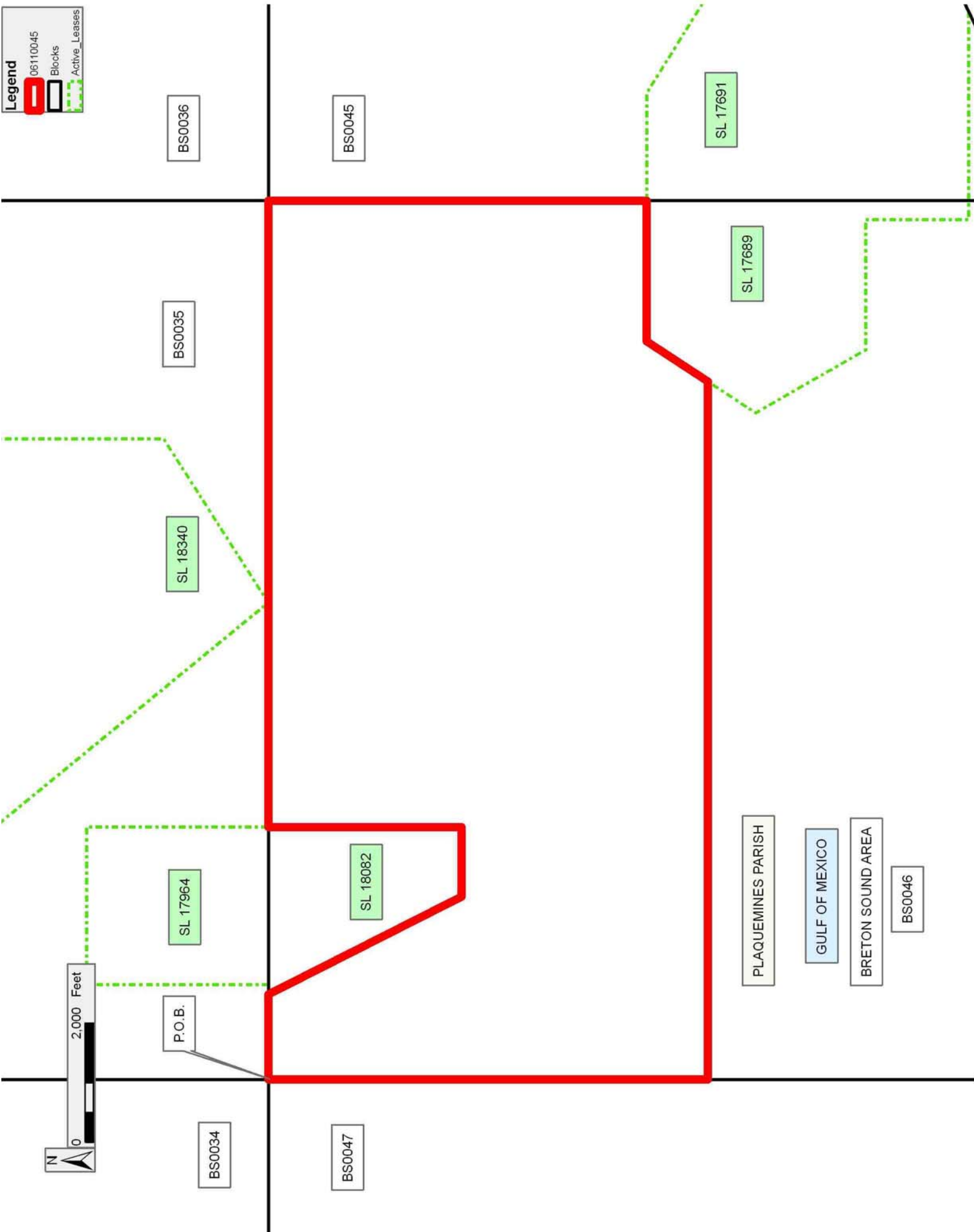

TRACT 38693 - Portion of Block 45, Breton Sound Area, Plaquemines Parish, Louisiana

All of the lands now or formerly constituting the beds and bottoms of all water bodies of every nature and description the title of which vests in the State of Louisiana, together with all islands arising therein and other lands formed by accretion or by reliction, where allowed by law, excepting tax adjudicated lands, and not presently under mineral lease and cross hatched on November 8, 2006, situated in Plaquemines Parish, Louisiana, and more particularly described as follows: Beginning at the Northwest corner of Block 45, Breton Sound Area, having Coordinates of X = 2,679,600.00 and Y = 307,580.00; thence East 2,000.00 feet along the North line of said Block 45, to the Northwest corner of State Lease No. 1237, as amended, having Coordinates of X = 2,681,600.00 and Y = 307,580.00; thence South 2,950.00 feet along the West boundary of said State Lease No. 1237 to its Southwest corner, also being the Northwest corner of State Lease No. 2001, as amended, having Coordinates of X = 2,681,600.00 and Y = 304,630.00; thence South 2,925.00 feet along the West boundary of said State Lease No. 2001 to its Southwest corner having Coordinates of X = 2,681,600.00 and Y = 301,705.00; thence East 6,025.35 feet along the South boundary of said State Lease No. 2001, to a point on the Louisiana Coastline having Coordinates of X = 2,687,625.35 and Y = 301,705.00; thence along the boundary of said Louisiana Coastline the following courses: Southwesterly along a straight line to a point having Coordinates of X = 2,687,610 and Y = 301,648, Southwesterly along a straight line to a point having Coordinates of X = 2,687,014 and Y = 300,054 and Southwesterly along a straight line to the Northeast corner of State Lease No. 19080 having Coordinates of X = 2,686,522.04 and Y = 299,430.00; thence West 2,222.04 feet along the North boundary of said State Lease No. 19080, to its Northwest corner, also being the Easternmost corner of State Lease No. 17691 having Coordinates of X = 2,684,300.00 and Y = 299,430.00; thence along the boundary said State Lease No. 17691 the following courses: North 58 degrees 10 minutes 21 seconds West 3,413.21 feet and West 1,800.00 feet to a point on the West line of Block 45, having Coordinates of X = 2,679,600.00 and Y = 301,230.00; thence North 6,350.00 feet along the West line of said Block 45, to the point of beginning, containing approximately **530.83 acres**, all as more particularly outlined on a plat on file in the Office of Mineral Resources, Department of Natural Resources. All bearings, distances and coordinates are based on Louisiana Coordinate System of 1927, (North or South Zone), where applicable.

NOTE: The above description of the Tract nominated for lease has been provided and corrected, where required, exclusively by the nomination party. Any mineral lease selected from this Tract and awarded by the Louisiana State Mineral Board shall be without warranty of any kind, either express, implied, or statutory, including, but not limited to, the implied warranties of merchantability and fitness for a particular purpose. Should the mineral lease awarded by the Louisiana State Mineral Board be subsequently modified, cancelled or abrogated due to the

existence of conflicting leases, operating agreements, private claims or other future obligations or conditions which may affect all or any portion of the leased Tract, it shall not relieve the Lessee of the obligation to pay any bonus due thereon to the Louisiana State Mineral Board, nor shall the Louisiana State Mineral Board be obligated to refund any consideration paid by the Lessor prior to such modification, cancellation, or abrogation, including, but not limited to, bonuses, rentals and royalties.

NOTE: The State of Louisiana does hereby reserve, and this lease shall be subject to, the imprescriptible right of surface use in the nature of a servitude in favor of the Department of Natural Resources, including its Offices and Commissions, for the sole purpose of implementing, constructing, servicing and maintaining approved coastal zone management and/or restoration projects. Utilization of any and all rights derived under this lease by the mineral lessee, its agents, successors or assigns, shall not interfere with nor hinder the reasonable surface use by the Department of Natural Resources, its Offices or Commissions, as herein above reserved.

Applicant: HAROLD J. ANDERSON, INC.

Bidder	Cash Payment	Price/Acre	Rental	Oil	Gas	Other

Legend

- 06110041
- Active_Leases
- Blocks

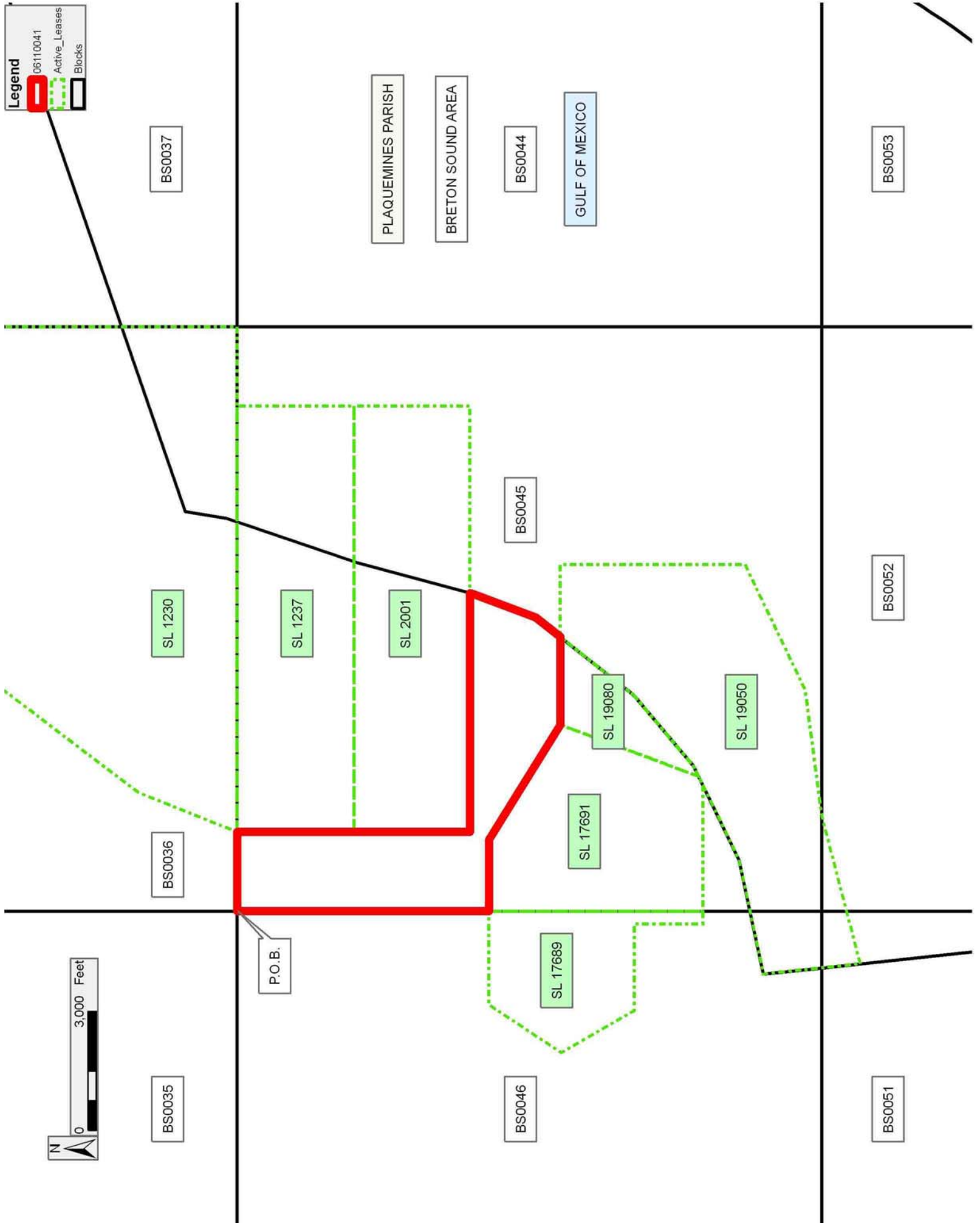

BS00037

PLAQUEMINES PARISH

BRETON SOUND AREA

BS00044

GULF OF MEXICO

BS00053

SL 1230

SL 1237

SL 2001

BS00045

BS00052

BS00036

SL 19080

SL 19050

P.O.B.

SL 17691

SL 17689

BS00035

BS00046

BS00051

TRACT 38694 - Portion of Block 47, Breton Sound Area, Plaquemines Parish, Louisiana

All of the lands now or formerly constituting the beds and bottoms of all water bodies of every nature and description the title of which vests in the State of Louisiana, together with all islands arising therein and other lands formed by accretion or by reliction, where allowed by law, excepting tax adjudicated lands, and not presently under mineral lease and cross hatched on November 8, 2006, situated in Plaquemines Parish, Louisiana, and more particularly described as follows: All of the lands now or formerly constituting the beds and bottoms of all water bodies of every nature and description the title of which vests in the State of Louisiana, together with all islands arising therein and other lands formed by accretion or by reliction, where allowed by law, excepting tax adjudicated lands, and not presently under mineral lease on November 08, 2006, situated in Plaquemines Parish, Louisiana, and more particularly described as follows: Beginning at a point on the West line of Block 47, Breton Sound Area, having Coordinates of X = 2,650,100.00 and Y = 300,205.00; thence East 8,664.74 feet to a point on the boundary of said State Lease No. 16569, as amended, having Coordinates of X = 2,658.764.74 and Y = 300,205.00; thence along the boundary of said State Lease No. 16569 the following courses: South 56 degrees 27 minutes 32 seconds West 1,547.40 feet, South 1,270.01 feet, South 63 degrees 19 minutes 34 seconds East 1,204.00 feet, North 59 degrees 36 minutes 34 seconds East 3,532.92 feet, North 800.00 feet and North 75 degrees 24 minutes 12 seconds West 310.38 feet to a point having Coordinates of X = 2,661,298.00 and Y = 300,205.00; thence East 3,552.00 feet to a point on the East line of said Block 47 having Coordinates of X = 2,664,850.00 and Y = 300,205.00; thence South 925.00 feet along the East line of said Block 47 to the Eastern most Northeast corner of State Lease No. 16569, as amended, having Coordinates of X = 2,664,850.00 and Y = 299,280.00; thence along the boundary of said State Lease No. 16569 the following courses: North 75 degrees 24 minutes 12 seconds West 1,560.09 feet, South 50 degrees 54 minutes 23 seconds West 4,448.56 feet, South 63 degrees 19 minutes 35 seconds East 3,203.23 feet, East 1,040.01 feet and North 23 degrees 40 minutes 37 seconds East 2,639.57 feet to a point on the East line of said Block 47, also being the Eastern most Southeast corner of said State Lease No. 16569 having Coordinates of X = 2,664,850.00 and Y = 297,847.38; thence South 5,017.38 feet along the East line of said Block 47 to its Southeast corner having Coordinates of X = 2,664,850.00 and Y = 292,830.00; thence West 14,750.00 feet along the South line of said Block 47 to its Southwest corner having Coordinates of X = 2,650,100.00 and Y = 292,830.00; thence North 7,375.00 feet along the West line of said Block 47, to the point of beginning, containing approximately 2,038.34 acres, all as more particularly outlined on a plat on file in the Office of Mineral Resources, Department of Natural Resources. All bearings, distances and coordinates are based on Louisiana Coordinate System of 1927 (South Zone).

, all as more particularly outlined on a plat on file in the Office of Mineral Resources, Department of Natural Resources. All bearings,

distances and coordinates are based on Louisiana Coordinate System of 1927, (North or South Zone), where applicable.



NOTE: The above description of the Tract nominated for lease has been provided and corrected, where required, exclusively by the nomination party. Any mineral lease selected from this Tract and awarded by the Louisiana State Mineral Board shall be without warranty of any kind, either express, implied, or statutory, including, but not limited to, the implied warranties of merchantability and fitness for a particular purpose. Should the mineral lease awarded by the Louisiana State Mineral Board be subsequently modified, cancelled or abrogated due to the existence of conflicting leases, operating agreements, private claims or other future obligations or conditions which may affect all or any portion of the leased Tract, it shall not relieve the Lessee of the obligation to pay any bonus due thereon to the Louisiana State Mineral Board, nor shall the Louisiana State Mineral Board be obligated to refund any consideration paid by the Lessor prior to such modification, cancellation, or abrogation, including, but not limited to, bonuses, rentals and royalties.

NOTE: The State of Louisiana does hereby reserve, and this lease shall be subject to, the imprescriptible right of surface use in the nature of a servitude in favor of the Department of Natural Resources, including its Offices and Commissions, for the sole purpose of implementing, constructing, servicing and maintaining approved coastal zone management and/or restoration projects. Utilization of any and all rights derived under this lease by the mineral lessee, its agents, successors or assigns, shall not interfere with nor hinder the reasonable surface use by the Department of Natural Resources, its Offices or Commissions, as herein above reserved.

Applicant: HAROLD J. ANDERSON, INC.

Bidder	Cash Payment	Price/Acre	Rental	Oil	Gas	Other

Legend

-  06110038
-  Blocks
-  Tracts
-  Active_Leases

