

NOT TO BE USED WITH A PORTION BID  
FOR INFORMATIONAL PURPOSES ONLY!

MAP NOT TO SCALE

TR 32915

NOTE: APPROXIMATE LOCATION  
FOR THE BOUNDARIES OF ORDER  
NOS. 360-K-1, 360-H-1, 360-H, 360-P &  
360-R

T 19 S - R 23 E

F & A Map Services  
Division of PI

LAFOURCHE PARISH

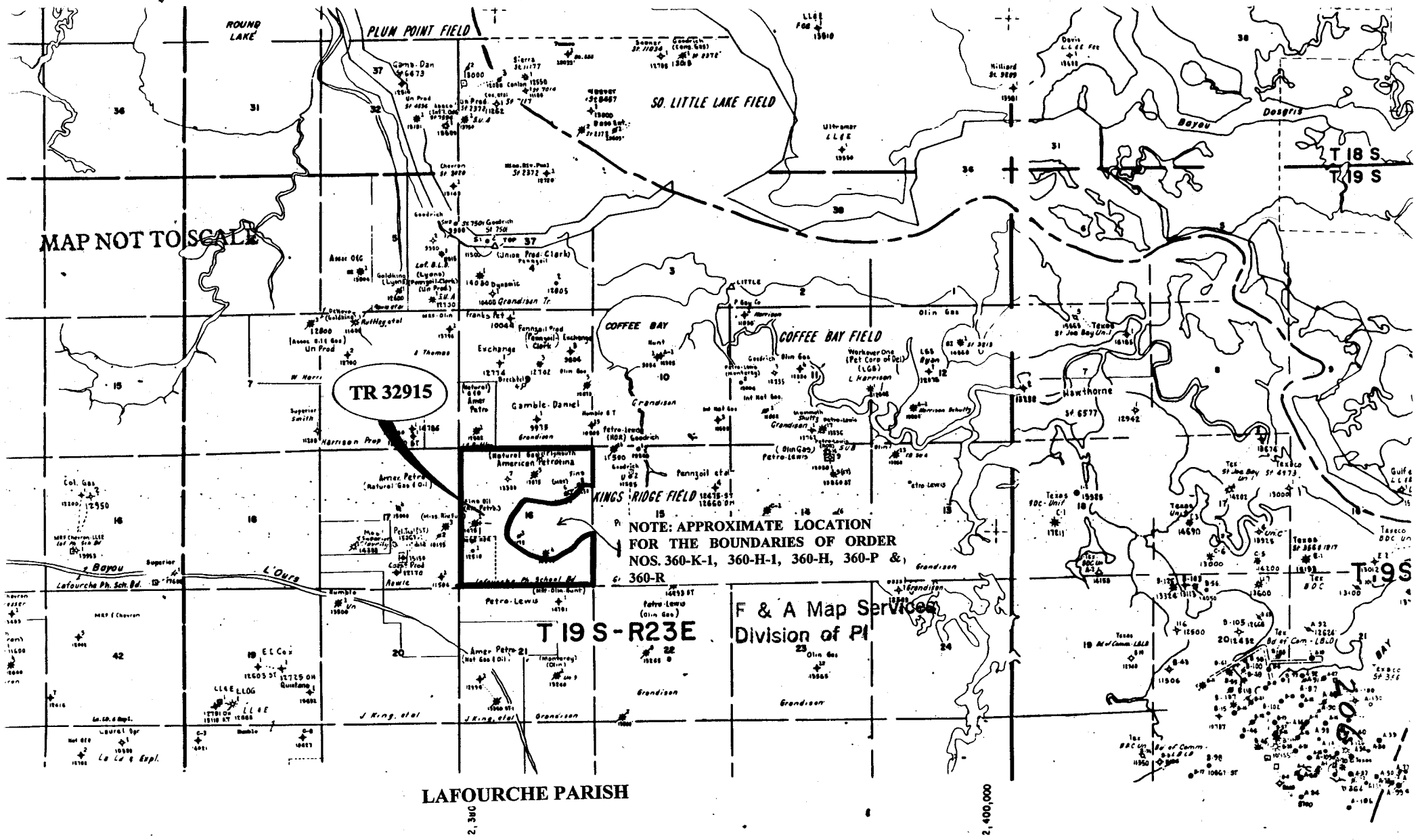

**TRACT 32915 - STATE AGENCY - Lafourche and Jefferson Parishes, Louisiana**

The State Mineral Board acting on behalf of the Lafourche Parish School Board and the Jefferson Parish School Board, pursuant to Resolutions adopted by those bodies and in accordance with Louisiana Revised Statutes 30:121-136 and 151-156, as amended, and Article 12, Section 18 of the Louisiana Constitution of 1921, as amended, which by Section 16 (A) 9, and 16 (B) of Article XIV of the 1974 Constitution is continued as a statute subject to arrangement in proper statutory form or modification provided by law, advertises the following described lands not under mineral lease on November 8, 2000: All of Section 16, Township 19 South, Range 23 East, Lafourche Parish, Louisiana, said township situated in Lafourche and Jefferson Parishes, Louisiana, excluding beds and bottoms of all navigable waters located in said section, **LESS AND EXCEPT** the following described units: Order #360-K-1, as shown on Unit Plat recorded November 29, 1999, in Book 1405, Entry #863540, Lafourche Parish, Louisiana, Order #360-H-1, as shown on Unit Plat recorded November 29, 1999, in Book 1405, Entry #863538, Lafourche Parish, Louisiana, Order #360-N, as shown on Unit Plat recorded November 29, 1999, in Book 1405, Entry #863539, Lafourche Parish, Louisiana, Order #360-P, as shown on Unit Plat recorded November 29, 1999, in Book 1405, Entry #863541, Lafourche Parish, Louisiana, Order #360-R, as shown on Unit Plat recorded November 29, 1999, in Book 1405, Entry #863542, Lafourche Parish, Louisiana, containing approximately **490.41 acres**, as shown outlined in red on a plat on file in the Office of Mineral Resources, Department of Natural Resources. All bearings, distances and coordinates are based on Louisiana Coordinate System of 1927 (South Zone).

NOTE: "Lessors acknowledge that said Township 19 South, Range 23 East, is located 98.64% in the Parish of Lafourche and 1.36% in the Parish of Jefferson; and Lessee is authorized and directed to pay any and all rentals and royalties which may accrue under the terms of this lease to Lessors separately and in the following proportions: Lafourche Parish School Board - 98.64% and Jefferson Parish School Board - 1.36%" and "prospective bidders are hereby placed on notice that execution by the State Mineral Board of oil, gas and mineral lease on behalf of the Lafourche Parish School Board and the Jefferson Parish School Board on the above described portion of section shall not be construed as a waiver by the State Mineral Board of any rights that it may have to lease for and on behalf of the State of Louisiana any navigable water bottoms that might be included within said portion of said section."

NOTE: Lessor will accept not less than one-fourth royalties on all minerals.

NOTE: Lessor will require all royalties to be paid on "current market value" for all hydrocarbons.

NOTE: The Lessee shall conduct its operations in such a manner as to reasonable minimize any interference with or disruption of Lessor's use of the surface of the leased property or its use by Lessor's Lessees of hunting, trapping and/or pasturage rights.

NOTE: The above tract is located in or near an oyster restricted area and

all operations in such area must be conducted in strict conformity with the stipulations and/or regulations of the Louisiana Department of Wildlife and Fisheries.

NOTE: The State of Louisiana does hereby reserve, and this lease shall be subject to, the imprescriptible right of surface use in the nature of a servitude in favor of the Department of Natural Resources, including its Offices and Commissions, for the sole purpose of implementing, constructing, servicing and maintaining approved coastal zone management and/or restoration projects. Utilization of any and all rights derived under this lease by the mineral lessee, its agents, successors or assigns, shall not interfere with nor hinder the reasonable surface use by the Department of Natural Resources, its Offices or Commissions, as hereinabove reserved.

Applicant: Harold J. Anderson, Inc. to Agency and by Resolution from the Lafourche Parish School Board and Jefferson Parish School Board authorizing the Mineral Board to act in its behalf.

Bidder	Cash Payment	Price / Acre	Rental	Oil	Gas	Other

OFFICIAL COPY  
OFFICE OF MINERAL RESOURCES  
DEPT. OF NATURAL RESOURCES  
DO NOT REMOVE

T 19 S - R 23 E

LAFOURCHE PARISH

TR 32915  
490.41 +/- ACS.  
NOV., 2000

APPROXIMATE LOCATION  
FOR THE BOUNDARIES OF  
ORDER NOS. 360-K-1,  
360-H-1, 360-N, 360-P, & 360-R

2000 0 2000 Feet



Coffee Bay

SOUTH LITTLE LAKE

OIL AND GAS FIELD

Tanks

7

18

16

15