

**STATE
AGENCY
TRACTS**

NOT TO BE USED WITH A PORTION BID
FOR INFORMATIONAL PURPOSES ONLY!

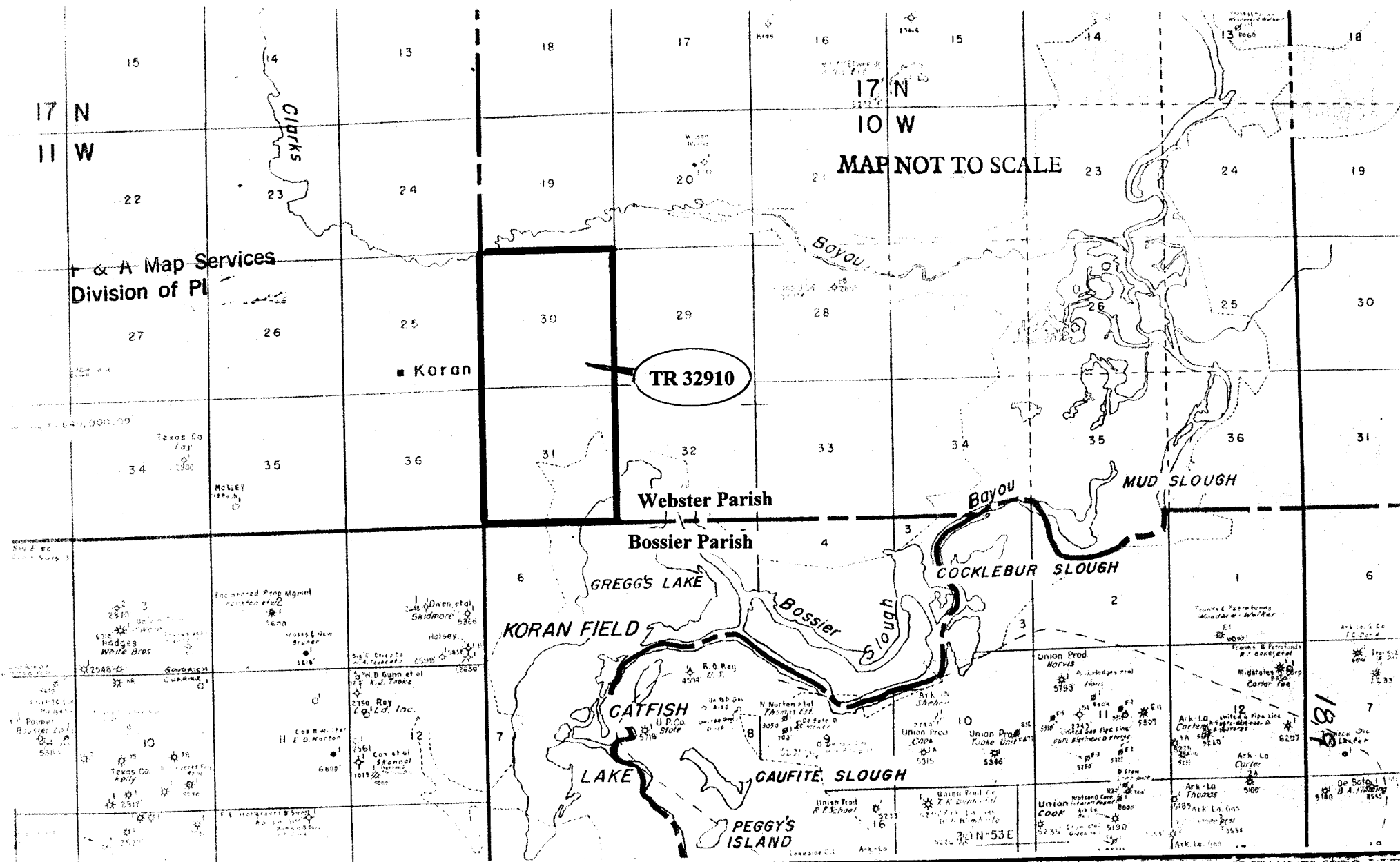

F & A Map Services
Division of Pl

MAP NOT TO SCALE

TR 32910

Webster Parish

Bossier Parish

KORAN FIELD

CATFISH LAKE

GAUFITE SLOUGH

PEGGY'S ISLAND

Union Prod Norvis

Union COOK

Ark-La Thomas

Ark-La Gas

18

TRACT 32910 - STATE AGENCY - Webster Parish, Louisiana

A certain tract of land belonging to and not under mineral lease from the Webster Parish Police Jury, on November 8, 2000, being more fully described as follows: All streets and roads situated within Sections 30 and 31, Township 17 North, Range 10 West, Webster Parish, Louisiana, excluding beds and bottoms of all navigable waters, containing approximately **20.00 acres**, as shown outlined in red on a plat on file in the Office of Mineral Resources, Department of Natural Resources. All bearings, distances and coordinates are based on Louisiana Coordinate System of 1927 (South Zone).

Applicant: Elm Grove Efforts to Agency and by Resolution from the Webster Parish Police Jury authorizing the Mineral Board to act in its behalf.

Bidder	Cash Payment	Price / Acre	Rental	Oil	Gas	Other

TR 32910
20.00 ± ACS.
NOV., 2000

T17N-R10W

Clarke

Bayou

N

St Pauls Cem

Gilmer Cem

PIPELINE

Koran

Fish Hatchery

Compressor Station

Spring

WEBSTER PARISH
BOSSIER PARISH

OFFICIAL COPY
OFFICE OF MINERAL RESOURCES
DEPT. OF NATURAL RESOURCES 2000
DO NOT REMOVE

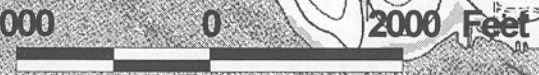

NOT TO BE USED WITH A PORTION BID
FOR INFORMATIONAL PURPOSES ONLY!

MAP NOT TO SCALE

F & A Map Services
Division of PI

TR 32911
Eureka

CARLTON FIELD

Ouachita Parish

TREMONT FIELD

U

18 N
1 E

Carlton

Tremont
TTCO
Tremont

192

