

PASS-A-LOUTRE

TRACTS

**NOT TO BE USED WITH A PORTION BID
FOR INFORMATIONAL PURPOSES ONLY!**

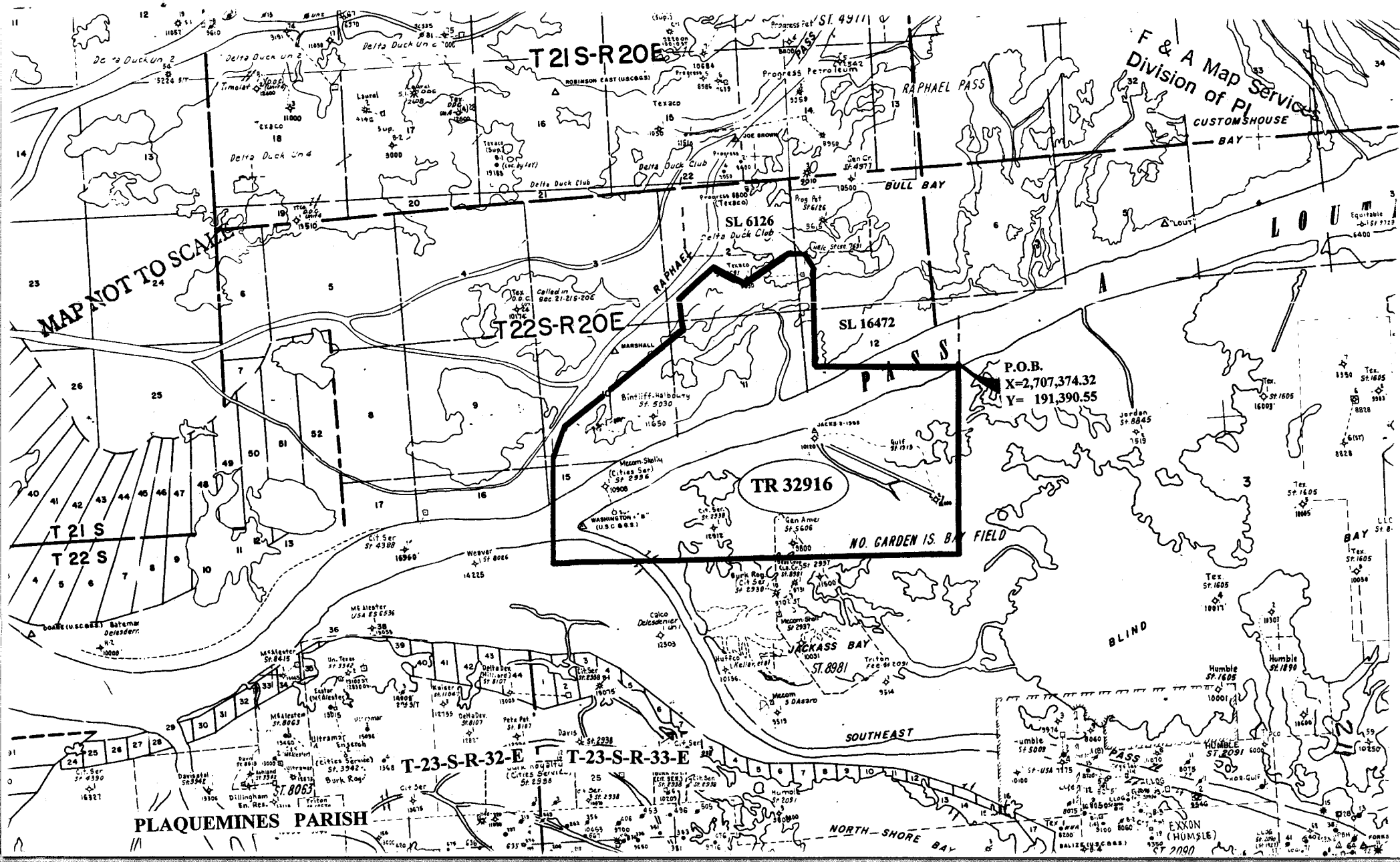

TRACT 32916 - Plaquemines Parish, Louisiana

All state owned lands and water bottoms not under mineral lease on November 8, 2000, within the confines of the Pass-A-Loutre Wildlife Management Area as defined by the Department of Wildlife & Fisheries and included in a title opinion from the Office of the Governor, dated August 3, 1998, situated in Plaquemines Parish, Louisiana, within the following boundaries: Beginning at the Southeast corner of State Lease No. 16472 having Coordinates of X = 2,707,374.32 and Y = 191,390.55; thence South 5,470.46 feet to a point having Coordinates of X = 2,707,374.32 and Y = 185,920.09; thence West 15,639.60 feet to a point having Coordinates of X = 2,691,734.72 and Y = 185,920.09; thence North 2,250.00 feet to a point on the North boundary of Pass-a-Loutre Wildlife Management Area having Coordinates of X = 2,691,734.72 and Y = 188,170.09; thence along the boundary of said Pass-a-Loutre Wildlife Management Area the following courses: North 17 degrees 44 minutes 54 seconds East 1,133.27 feet; North 51 degrees 54 minutes 17 seconds East 6,013.98; North 08 degrees 56 minutes 28 seconds West 1,219.79 feet; North 46 degrees 26 minutes 00 seconds East 1,803.56 feet; South 61 degrees 03 minutes 05 seconds East 1,517.78 feet; Northeasterly on an arc having a radius of 3,825.00 feet and a center at X = 2,702,184.92 and Y = 192,210.20 to a point having Coordinates of X = 2,700,418.06 and Y = 195,602.67; thence Northeasterly on an arc having a radius of 5,575.00 feet and a center at X = 2,698,285.38 and Y = 200,753.62 to a point having Coordinates of X = 2,701,011.40 and Y = 195,890.55, also being a point on the South line of State Lease No. 6126; thence East 483.59 feet on the South line of said State Lease No. 6126 to a point having Coordinates of X = 2,701,494.99 and Y = 195,890.55; thence along the boundary of said Pass-a-Loutre Wildlife Management Area the following courses: South 48 degrees 11 minutes 50 seconds East 95.74 feet; South 27 degrees 56 minutes 17 seconds East 601.97 feet and South 57 degrees 53 minutes 08 seconds East 30.61 feet to the Northwest corner of said State Lease No. 16472 having Coordinates of X = 2,701,874.32 and Y = 195,278.65; thence South 3,888.10 feet on the West line of said State Lease No. 16472 to its Southwest corner having Coordinates of X = 2,701,874.32 and Y = 191,390.55; thence East 5,500.00 feet to the point of beginning, containing approximately 2,363 gross acres, **Less and Except** 429 acres privately owned land, leaving **1,934 net acres**, as shown outlined in red on a plat on file in the Office of Mineral Resources, Department of Natural Resources. All bearings, distances and coordinates are based on Louisiana Coordinate System of 1927 (South Zone).

NOTE: The above tract is located in or near an oyster restricted area and all operations in such area must be conducted in strict conformity with the stipulations and/or regulations of the Louisiana Department of Wildlife and Fisheries.

NOTE: 1. No activities will be allowed without written authorization of the Louisiana Department of Wildlife and Fisheries.

2. Proposed projects will be evaluated on a case by case basis. Modifications to proposed project features including but not limited to access routes, spoil placement, well sites, flowlines and appurtenant structures may be required by the Department of Wildlife and Fisheries.

3. Compliance with the Pass-A-Loutre Wildlife Management Area mineral regulations will be required unless otherwise specified by the Department of Wildlife and Fisheries.

4. Compensatory mitigation will be required to offset unavoidable wetland impacts.

5. Removal of all structures, facilities and equipment will be required within 120 days of abandonment unless otherwise agreed to in writing by the Department of Wildlife and Fisheries.

6. No activities will be allowed during the waterfowl season unless authorized by the Department.

7. Prior to submitting applications for wetland permits to Federal and State permitting agencies, the leaseholder shall coordinate project details with the Department of Wildlife and Fisheries, Fur and Refuge Division. Contact person for the Department will be Mike Windham at (504) 568-5886.

NOTE: The Department will require a minimum bonus of \$350.00 per acre and a minimum royalty of 25%.

NOTE: This tract is located within the Pass-A-Loutre Wildlife Management Area. Any operations on said tract shall be coordinated with the Louisiana Department of Wildlife and Fisheries. Special Rules and Regulations have been promulgated by the Louisiana Department of Wildlife and Fisheries for the protection of the game and wildlife for some management areas. Any lease awarded by the Board on said tract shall be subject to any applicable Rules and Regulations of said management area. Copies of these Rules and Regulations may be obtained from the Louisiana Department of Wildlife and Fisheries through the Assistant Secretary, Office of Wildlife, upon request.

NOTE: The State of Louisiana does hereby reserve, and this lease shall be subject to, the imprescriptible right of surface use in the nature of a servitude in favor of the Department of Natural Resources, including its Offices and Commissions, for the sole purpose of implementing, constructing, servicing and maintaining approved coastal zone management and/or restoration projects. Utilization of any and all rights derived under this lease by the mineral lessee, its agents, successors or assigns, shall not interfere with nor hinder the reasonable surface use by the Department of Natural Resources, its Offices or Commissions, as hereinabove reserved.

Applicant: Lafreniere & Co., Ltd.

Bidder	Cash Payment	Price / Acre	Rental	Oil	Gas	Other



OFFICIAL COPY
OFFICE OF MINERAL RESOURCES
DEPT. OF NATURAL RESOURCES
DO NOT REMOVE

T 21 S - R 20 E

SL 6126

APPROXIMATE BOUNDARY
PASS-A-LOUTRE MANAGEMENT AREA

P.O.B.
X=2,707,374.32
Y= 191,390.55

SL 16472

TR 32916
2,363 +/- GROSS ACS.
1,934 +/- NET ACS.
NOV., 2000

PLAQUEMINES PARISH

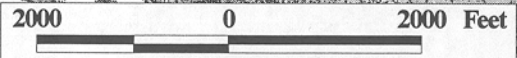

315