

MAP NOT TO SCALE

F & A Map Services  
Division of PI

NOT TO BE USED WITH A PORTION BID  
FOR INFORMATIONAL PURPOSES ONLY!

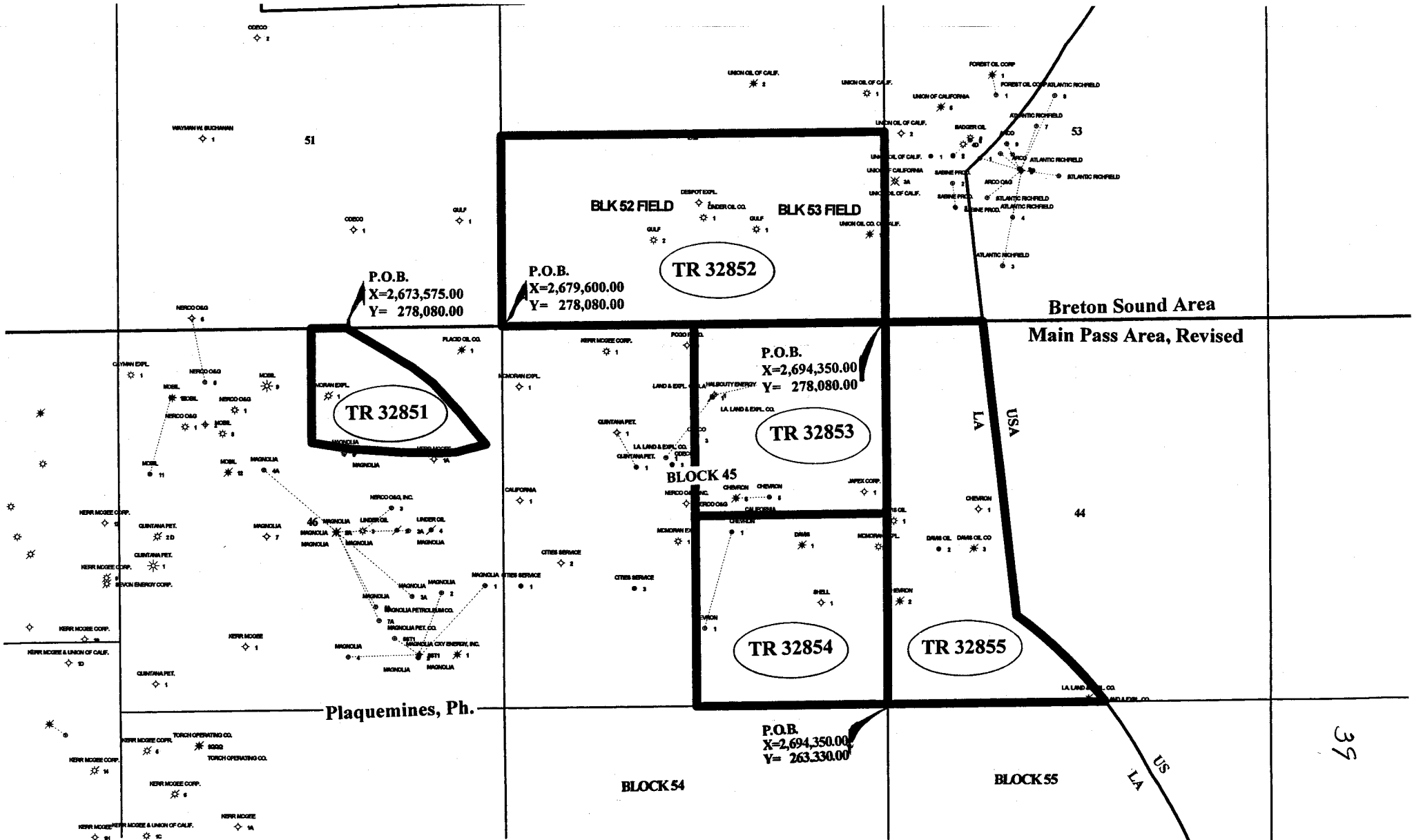

**TRACT 32851 - PORTION OF BLOCK 46, MAIN PASS AREA, REVISED, Plaquemines Parish, Louisiana**

That portion of Block 46, Main Pass Area, Revised, Plaquemines Parish, Louisiana, belonging to the State of Louisiana and not under mineral lease on November 8, 2000, lying 9,300 feet below the surface and described as follows: Beginning at a point on the North line of Block 46, Main Pass Area, Revised, having Coordinates of X = 2,673,575.00 and Y = 278,080.00; thence South 59 degrees East 3,000.00 feet; thence South 52 degrees East 1,000.00 feet; thence South 42 degrees East 1,500.00 feet; thence South 38 degrees 27 minutes East 1,627.30 feet; thence South 76 degrees 21 minutes West 1,188.60 feet; thence South 87 degrees 30 minutes West 600.00 feet; thence North 88 degrees 30 minutes West 1,500.00 feet; thence North 85 degrees 30 minutes West 2,000.00 feet; thence North 80 degrees West 1,500.00 feet; thence North 4,400.00 feet; thence East 1,350.00 feet to the point of beginning, containing approximately **495.43 acres**, lying 9,300 feet below the surface as shown outlined in red on a plat on file in the Office of Mineral Resources, Department of Natural Resources. All bearings, distances and coordinates are based on Louisiana Coordinate System of 1927 (South Zone).

NOTE: The State of Louisiana does hereby reserve, and this lease shall be subject to, the imprescriptible right of surface use in the nature of a servitude in favor of the Department of Natural Resources, including its Offices and Commissions, for the sole purpose of implementing, constructing, servicing and maintaining approved coastal zone management and/or restoration projects. Utilization of any and all rights derived under this lease by the mineral lessee, its agents, successors or assigns, shall not interfere with nor hinder the reasonable surface use by the Department of Natural Resources, its Offices or Commissions, as hereinabove reserved.

Applicant: Robert A. Schroeder, Inc.

Bidder	Cash Payment	Price / Acre	Rental	Oil	Gas	Other



**BLOCK 51**

P.O.B.  
X=2,673,575.00  
Y= 278,080.00

**BRETON SOUND AREA**

**MAIN PASS AREA, REVISED**

**TR 32851**  
**495.43 +/- ACS.**  
**NOV., 2000**

**BLOCK 46**

OFFICIAL COPY  
OFFICE OF MINERAL RESOURCES  
DEPT. OF NATURAL RESOURCES  
DO NOT REMOVE

**PLAQUEMINES PARISH**



**TRACT 32852 - PORTION OF BLOCK 52, BRETON SOUND AREA, Plaquemines Parish, Louisiana**

That portion of Block 52, Breton Sound Area, Plaquemines Parish, Louisiana, belonging to the State of Louisiana and not under mineral lease on November 8, 2000, described as follows: Beginning at the Southwest corner of Block 52, Breton Sound Area, having Coordinates of X = 2,679,600.00 and Y = 278,080.00; thence North 7,375.00 feet along the West line of said Block 52 to a point having Coordinates of X = 2,679,600.00 and Y = 285,455.00; thence East 14,750.00 feet to a point on the East line of said Block 52 having Coordinates of X = 2,694,350.00 and Y = 285,455.00; thence South 7,375.00 feet along said East line of said Block 52 to a point on the South line of said Block 52 having Coordinates of X = 2,694,350.00 and Y = 278,080.00; thence West 14,750.00 feet along said South line of said Block 52 to the point of beginning, containing approximately **2,497.27 acres**, as shown outlined in red on a plat on file in the Office of Mineral Resources, Department of Natural Resources. All bearings, distances and coordinates are based on Louisiana Coordinate System of 1927 (South Zone).

NOTE: The State of Louisiana does hereby reserve, and this lease shall be subject to, the imprescriptible right of surface use in the nature of a servitude in favor of the Department of Natural Resources, including its Offices and Commissions, for the sole purpose of implementing, constructing, servicing and maintaining approved coastal zone management and/or restoration projects. Utilization of any and all rights derived under this lease by the mineral lessee, its agents, successors or assigns, shall not interfere with nor hinder the reasonable surface use by the Department of Natural Resources, its Offices or Commissions, as hereinabove reserved.

Applicant: Robert A. Schroeder, Inc.

Bidder	Cash Payment	Price / Acre	Rental	Oil	Gas	Other



TR 32852  
2,497.27 +/- ACS.  
NOV., 2000

BLOCK 52

BLOCK 51

BLOCK 53

BLOCK 46

BLOCK 45

BLOCK 44

P.O.B.  
X=2,679,600.00  
Y= 278,080.00

BRETON SOUND AREA  
PLAQUEMINES PARISH

OFFICIAL COPY  
OFFICE OF MINERAL RESOURCES  
DEPT. OF NATURAL RESOURCES  
DO NOT REMOVE

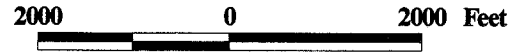

**TRACT 32853 - PORTION OF BLOCK 45, MAIN PASS AREA, REVISED, Plaquemines Parish, Louisiana**

That portion of Block 45, Main Pass Area, Revised, Plaquemines Parish, Louisiana, belonging to the State of Louisiana and not under mineral lease on November 8, 2000, described as follows: Beginning at the Northeast corner of Block 45, Main Pass Area, Revised, having Coordinates of X = 2,694,350.00 and Y = 278,080.00; thence South 7,375.00 feet along the East line of said Block 45 to a point having Coordinates of X = 2,694,350.00 and Y = 270,705.00; thence West 7,375.00 feet to a point having Coordinates of X = 2,686,975.00 and Y = 270,705.00; thence North 7,375.00 feet to a point on the North line of said Block 45 having Coordinates of X = 2,686,975.00 and Y = 278,080.00; thence East 7,375.00 feet along said North line of said Block 45 to the point of beginning, containing approximately 1,248.64 acres, as shown outlined in red on a plat on file in the Office of Mineral Resources, Department of Natural Resources. All bearings, distances and coordinates are based on Louisiana Coordinate System of 1927 (South Zone).

NOTE: The State of Louisiana does hereby reserve, and this lease shall be subject to, the imprescriptible right of surface use in the nature of a servitude in favor of the Department of Natural Resources, including its Offices and Commissions, for the sole purpose of implementing, constructing, servicing and maintaining approved coastal zone management and/or restoration projects. Utilization of any and all rights derived under this lease by the mineral lessee, its agents, successors or assigns, shall not interfere with nor hinder the reasonable surface use by the Department of Natural Resources, its Offices or Commissions, as hereinabove reserved.

Applicant: Robert A. Schroeder, Inc.

Bidder	Cash Payment	Price / Acre	Rental	Oil	Gas	Other



BLOCK 52

BLOCK 53

BRETON SOUND AREA

P.O.B.  
X=2,694,350.00  
Y= 278,080.00

MAIN PASS AREA, REVISED

BLOCK 44

BLOCK 45

TR 32853  
1,248.64 +/- ACS.  
NOV., 2000

OFFICIAL COPY  
OFFICE OF MINERAL RESOURCES  
DEPT. OF NATURAL RESOURCES  
DO NOT REMOVE

PLAQUEMINES PARISH



45

**TRACT 32854 - PORTION OF BLOCK 45, MAIN PASS AREA, REVISED, Plaquemines Parish, Louisiana**

That portion of Block 45, Main Pass Area, Revised, Plaquemines Parish, Louisiana, belonging to the State of Louisiana and not under mineral lease on November 8, 2000, described as follows: Beginning at the Southeast corner of Block 45, Main Pass Area, Revised, having Coordinates of X = 2,694,350.00 and Y = 263,330.00; thence West 7,375.00 feet on the South line of said Block 45 to a point having Coordinates of X = 2,686,975.00 and Y = 263,330.00; thence North 7,375.00 feet to a point having Coordinates of X = 2,686,975.00 and Y = 270,705.00; thence East 7,375.00 feet to a point on the East line of said Block 45 having Coordinates of X = 2,694,350.00 and Y = 270,705.00; thence South 7,375.00 feet on the East line of said Block 45 to the point of beginning, containing approximately **1,248.64 acres**, as shown outlined in red on a plat on file in the Office of Mineral Resources, Department of Natural Resources. All bearings, distances and coordinates are based on Louisiana Coordinate System of 1927 (South Zone).

NOTE: The State of Louisiana does hereby reserve, and this lease shall be subject to, the imprescriptible right of surface use in the nature of a servitude in favor of the Department of Natural Resources, including its Offices and Commissions, for the sole purpose of implementing, constructing, servicing and maintaining approved coastal zone management and/or restoration projects. Utilization of any and all rights derived under this lease by the mineral lessee, its agents, successors or assigns, shall not interfere with nor hinder the reasonable surface use by the Department of Natural Resources, its Offices or Commissions, as hereinabove reserved.

Applicant: Acadian Land Services, Inc.

Bidder	Cash Payment	Price / Acre	Rental	Oil	Gas	Other





BLOCK 45

TR 32854  
1,248.64 +/- ACS.  
NOV., 2000

OFFICIAL COPY  
OFFICE OF MINERAL RESOURCES  
DEPT. OF NATURAL RESOURCES  
DO NOT REMOVE

BLOCK 44

BLOCK 54

P.O.B.  
X=2,694,350.00  
Y= 263,330.00

BLOCK 55

MAIN PASS AREA, REVISED  
PLAQUEMINES PARISH

2000 0 2000 Feet

47

**TRACT 32855 - PORTION OF BLOCK 44, MAIN PASS AREA, REVISED, Plaquemines Parish, Louisiana**

That portion of Block 44, Main Pass Area, Revised, Plaquemines Parish, Louisiana, belonging to the State of Louisiana and not under mineral lease on November 8, 2000, described as follows: Beginning at the Northwest corner of Block 44, Main Pass Area, Revised, having Coordinates of X = 2,694,350.00 and Y = 278,080.00; thence East 3,737.39 feet on the North line of said Block 44 to a point having Coordinates of X = 2,698,087.39 and Y = 278,080.00; thence Southeasterly on a straight line to a point having Coordinates of X = 2,699,302 and Y = 266,715; thence Southeasterly on an arc having a radius of 18,240.60 feet and center at X = 2,688,235 and Y = 252,215 to a point on the South line of said Block 44 having Coordinates of X = 2,702,697.99 and Y = 263,330.00; thence West 8,347.99 feet on the South line of said Block 44 to its Southwest corner having Coordinates of X = 2,694,350.00 and Y = 263,330.00; thence North 14,750.00 feet on the West line of said Block 44 to the point of beginning, containing approximately **1,661.94 acres**, as shown outlined in red on a plat on file in the Office of Mineral Resources, Department of Natural Resources, **LESS AND EXCEPT** that portion thereof, if any, which is more than three nautical miles from the coast line as determined by the Report of the Special Master in the litigation in the Supreme Court of the United States styled United States v. State of Louisiana et al No. 9 Original, said three mile line as set out in the June, 1975, decree of the Supreme Court. All bearings, distances and coordinates are based on Louisiana Coordinate System of 1927 (South Zone).

NOTE: The State of Louisiana does hereby reserve, and this lease shall be subject to, the imprescriptible right of surface use in the nature of a servitude in favor of the Department of Natural Resources, including its Offices and Commissions, for the sole purpose of implementing, constructing, servicing and maintaining approved coastal zone management and/or restoration projects. Utilization of any and all rights derived under this lease by the mineral lessee, its agents, successors or assigns, shall not interfere with nor hinder the reasonable surface use by the Department of Natural Resources, its Offices or Commissions, as hereinabove reserved.

Applicant: Acadian Land Services, Inc.

Bidder	Cash Payment	Price / Acre	Rental	Oil	Gas	Other



BLOCK 52

BLOCK 53

BRETON SOUND AREA

MAIN PASS AREA, REVISED

P.O.B.  
X=2,694,350.00  
Y= 278,080.00

OFFICIAL COPY  
OFFICE OF MINERAL RESOURCES  
DEPT. OF NATURAL RESOURCES  
DO NOT REMOVE

BLOCK 45

BLOCK 44

LA  
USA

TR 32855  
1,661.94 +/- ACS.  
NOV., 2000

BLOCK 54

BLOCK 55

PLAQUEMINES PARISH

2000 0 2000 Feet