

T-17-S-R-22-E

T-17-S
R-23-E

F & A Map Services
Division of PI

MAP NOT TO SCALE

TR 32882

TR 32883

TR 32884

T-18-S-R-22-E

T-18-S-R-23-E

LAFOURCHE & JEFFERSON PARISHES

TR 32885

P.O.B.
X=2,376,500.00
Y= 346,100.00

P.O.B.
X=2,382,806.15
Y= 334,934.09

S.L. 2561

S.L. 2381

P.O.B.
X=2,366,336.27
Y= 326,268.38

S.L. 1972

NOT TO BE USED WITH A PORTION BID
FOR INFORMATIONAL PURPOSES ONLY!

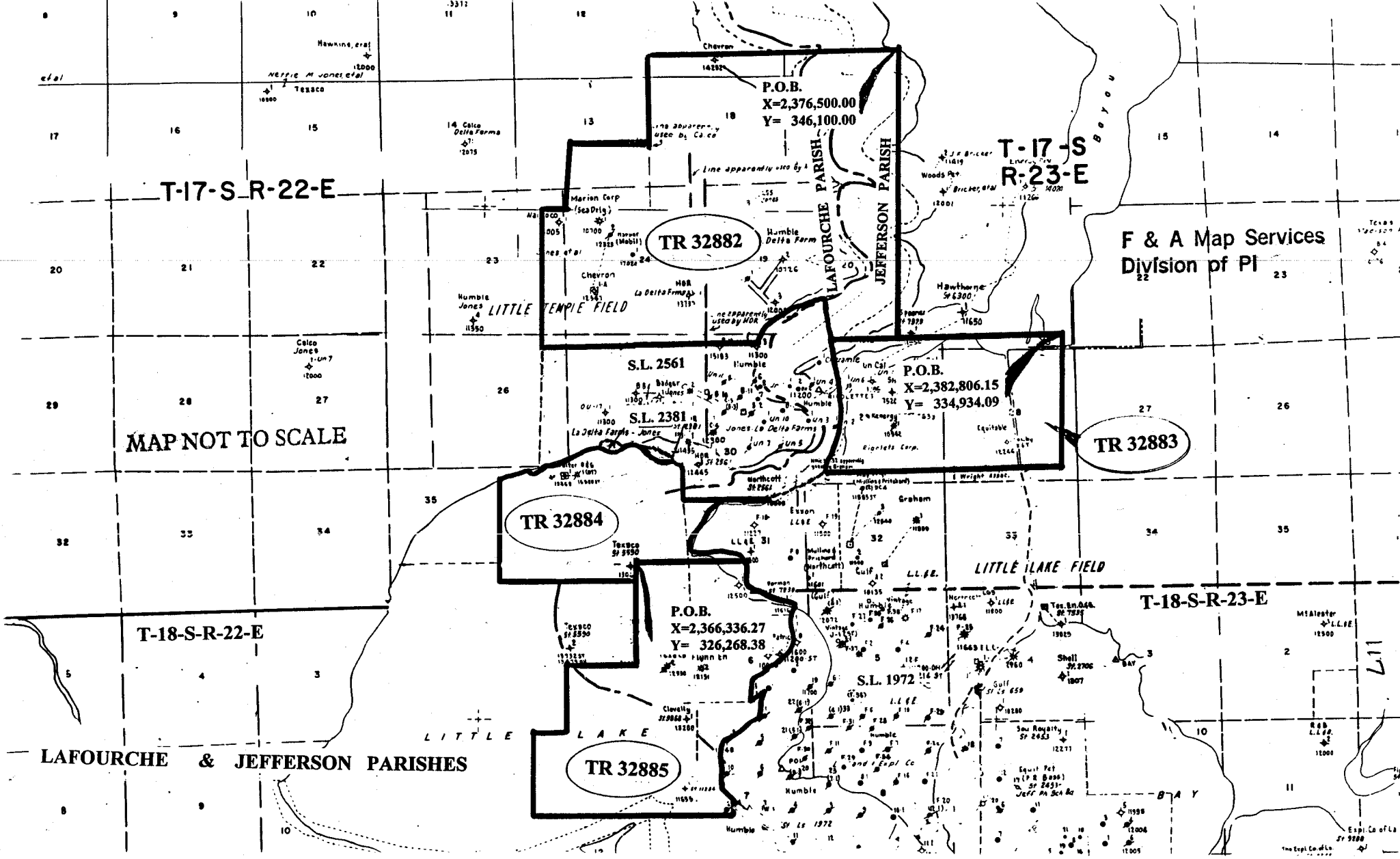

TRACT 32882 - Jefferson and Lafourche Parishes, Louisiana

All of the lands now or formerly constituting the beds and bottoms of all water bodies of every nature and description and all islands and other lands formed by accretion or reliction, except tax lands, owned by and not under mineral lease from the State of Louisiana on November 8, 2000, situated in Jefferson and Lafourche Parishes, Louisiana, within the following described boundaries: Beginning at a point having Coordinates of X = 2,376,500.00 and Y = 346,100.00; thence South 11,279.29 feet to a point having Coordinates of X = 2,376,500.00 and Y = 334,820.71; thence South 88 degrees 58 minutes 13 seconds West approximately 2,700 feet to the Eastern boundary of State Lease No. 2561, as amended; thence along the Eastern and Northern boundaries of said State Lease No. 2561 the following courses: Northwesterly, Southwesterly and Westerly to its Northwest corner; thence Northerly approximately 5,440 feet to a point having Coordinates of X = 2,362,678.93 and Y = 340,013.11; thence East 1,145.20 feet to a point having Coordinates of X = 2,363,824.13 and Y = 340,013.11; thence North 2,640.00 feet to a point having Coordinates of X = 2,363,824.13 and Y = 342,653.11; thence East 2,640.00 feet to a point having Coordinates of X = 2,366,464.13 and Y = 342,653.11; thence North 3,446.89 feet to a point having Coordinates of X = 2,366,464.13 and Y = 346,100.00; thence East 10,035.87 feet to the point of beginning, **LESS AND EXCEPT**, if any, that portion of State Lease No. 2561 that may lie within the above described tract, containing approximately **1,370 acres**, as shown outlined in red on a plat on file in the Office of Mineral Resources, Department of Natural Resources. All bearings, distances and coordinates are based on Louisiana Coordinate System of 1927 (South Zone).

NOTE: The above tract is located in or near an oyster restricted area and all operations in such area must be conducted in strict conformity with the stipulations and/or regulations of the Louisiana Department of Wildlife and Fisheries.

NOTE: The State of Louisiana does hereby reserve, and this lease shall be subject to, the imprescriptible right of surface use in the nature of a servitude in favor of the Department of Natural Resources, including its Offices and Commissions, for the sole purpose of implementing, constructing, servicing and maintaining approved coastal zone management and/or restoration projects. Utilization of any and all rights derived under this lease by the mineral lessee, its agents, successors or assigns, shall not interfere with nor hinder the reasonable surface use by the Department of Natural Resources, its Offices or Commissions, as hereinabove reserved.

Applicant: Mineral Services, Inc.

Bidder	Cash Payment	Price / Acre	Rental	Oil	Gas	Other

OFFICIAL COPY
OFFICE OF MINERAL RESOURCES
DEPT. OF NATURAL RESOURCES
DO NOT REMOVE



T17S-R22E

T17S-R23E

TR 32882
1,370 +/- ACS.
NOV., 2000

LAFOURCHE
PARISH

JEFFERSON
PARISH

P.O.B.
X=2,376,500.00
Y= 346,100.00

PEROT

JEFFERSON PARISH
LAFOURCHE PARISH

SL 2561

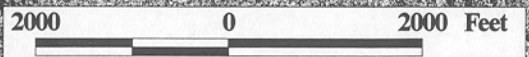

TRACT 32883 - Jefferson Parish, Louisiana

All of the lands now or formerly constituting the beds and bottoms of all water bodies of every nature and description and all islands and other lands formed by accretion or reliction, except tax lands, owned by and not under mineral lease from the State of Louisiana on November 8, 2000, situated in Jefferson Parish, Louisiana, within the following described boundaries: Beginning at a point having Coordinates of X = 2,382,806.15 and Y = 334,934.09; thence South 5,264.09 feet to a point having Coordinates of X = 2,382,806.15 and Y = 329,670.00; thence West 1,486.15 feet to the Northeast corner of State Lease No. 1972, as amended, having Coordinates of X = 2,381,320.00 and Y = 329,670.00; thence West approximately 7,765 feet along the North boundary of said State Lease No. 1972 to its intersection with the East boundary of State Lease No. 2561, as amended; thence Northeasterly, Northerly and Northwesterly along the East boundary of said State Lease No. 2561 to its intersection with a line having a bearing of South 88 degrees 58 minutes 13 seconds West extended from a point having Coordinates of X = 2,382,806.15 and Y = 334,934.09; thence North 88 degrees 58 minutes 13 seconds East approximately 9,017 feet along said line to the point of beginning, **LESS AND EXCEPT**, if any, that part of said State Lease No. 2561 and said State Lease No. 1972 that may lie within the above described tract, containing approximately **320 acres**, as shown outlined in red on a plat on file in the Office of Mineral Resources, Department of Natural Resources. All bearings, distances and coordinates are based on Louisiana Coordinate System of 1927 (South Zone).

NOTE: The above tract is located in or near an oyster restricted area and all operations in such area must be conducted in strict conformity with the stipulations and/or regulations of the Louisiana Department of Wildlife and Fisheries.

NOTE: The State of Louisiana does hereby reserve, and this lease shall be subject to, the imprescriptible right of surface use in the nature of a servitude in favor of the Department of Natural Resources, including its Offices and Commissions, for the sole purpose of implementing, constructing, servicing and maintaining approved coastal zone management and/or restoration projects. Utilization of any and all rights derived under this lease by the mineral lessee, its agents, successors or assigns, shall not interfere with nor hinder the reasonable surface use by the Department of Natural Resources, its Offices or Commissions, as hereinabove reserved.

Applicant: Mineral Services, Inc.

Bidder	Cash Payment	Price / Acre	Rental	Oil	Gas	Other

