

TRACT 32871 - Cameron Parish, Louisiana

All of the lands now or formerly constituting the beds and bottoms of all water bodies of every nature and description and all islands and other lands formed by accretion or reliction, except tax lands, owned by and not under mineral lease from the State of Louisiana on November 8, 2000, situated in Cameron Parish, Louisiana, within the following described boundaries: Beginning at a point having Coordinates of X = 1,499,070.88 and Y = 413,340.12; thence East 8,024.99 feet to a point having Coordinates of X = 1,507,095.87 and Y = 413,340.12; thence South 10,077.65 feet to a point having Coordinates of X = 1,507,095.87 and Y = 403,262.47; thence West 8,024.99 feet to a point having Coordinates of X = 1,499,070.88 and Y = 403,262.47; thence North 10,077.65 feet to the point of beginning, containing approximately **614 acres**, as shown outlined in red on a plat on file in the Office of Mineral Resources, Department of Natural Resources. All bearings, distances and coordinates are based on Louisiana Coordinate System of 1927 (South Zone).

NOTE: The State of Louisiana does hereby reserve, and this lease shall be subject to, the imprescriptible right of surface use in the nature of a servitude in favor of the Department of Natural Resources, including its Offices and Commissions, for the sole purpose of implementing, constructing, servicing and maintaining approved coastal zone management and/or restoration projects. Utilization of any and all rights derived under this lease by the mineral lessee, its agents, successors or assigns, shall not interfere with nor hinder the reasonable surface use by the Department of Natural Resources, its Offices or Commissions, as hereinabove reserved.

Applicant: Stephen M. Jenkins & Associates, Inc.

Bidder	Cash Payment	Price / Acre	Rental	Oil	Gas	Other

OFFICIAL COPY
OFFICE OF MINERAL RESOURCES
DEPT. OF NATURAL RESOURCES
DO NOT REMOVE



P.O.B.
X=1,499,070.88
Y= 413,340.12

TR 32871
614 +/- ACS.
NOV., 2000

T14S-R5W

T15S-R5W

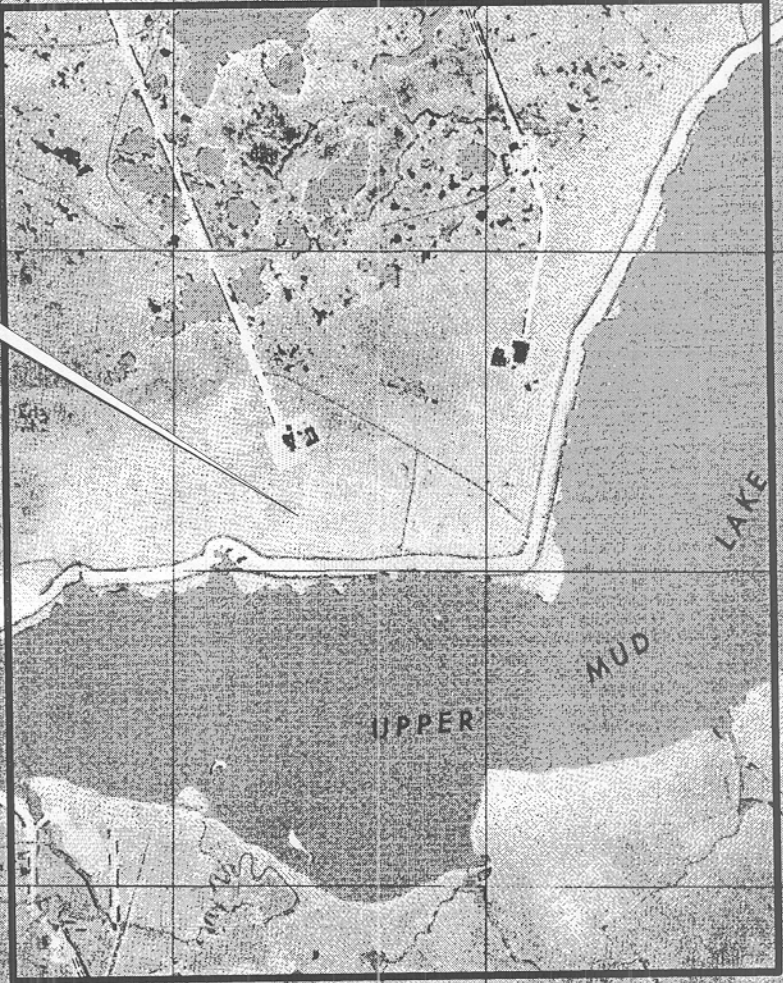

Little Lake

CANAL

DR. MILLER

LAKE

MUD

UPPER

Indian Point

Widstrom

Island Bayou

Bayou

Hackberry Ridge

CAMERON PARISH

2000 0 2000 Feet

Radio Tower

Yard

BM-JD

McCall

TRACT 32872 - Cameron Parish, Louisiana

All of the lands now or formerly constituting the beds and bottoms of all water bodies of every nature and description and all islands and other lands formed by accretion or reliction, except tax lands, owned by and not under mineral lease from the State of Louisiana on November 8, 2000, situated in Cameron Parish, Louisiana, within the following described boundaries: Beginning at a point having Coordinates of X = 1,507,095.87 and Y = 415,879.97; thence East 8,074.46 feet to a point having Coordinates of X = 1,515,170.33 and Y = 415,879.97; thence South 10,077.65 feet to a point having Coordinates of X = 1,515,170.33 and Y = 405,802.32; thence West 8,074.46 feet to a point having Coordinates of X = 1,507,095.87 and Y = 405,802.32; thence North 10,077.65 feet to the point of beginning, containing approximately **367 acres**, as shown outlined in red on a plat on file in the Office of Mineral Resources, Department of Natural Resources. All bearings, distances and coordinates are based on Louisiana Coordinate System of 1927 (South Zone).

NOTE: The State of Louisiana does hereby reserve, and this lease shall be subject to, the imprescriptible right of surface use in the nature of a servitude in favor of the Department of Natural Resources, including its Offices and Commissions, for the sole purpose of implementing, constructing, servicing and maintaining approved coastal zone management and/or restoration projects. Utilization of any and all rights derived under this lease by the mineral lessee, its agents, successors or assigns, shall not interfere with nor hinder the reasonable surface use by the Department of Natural Resources, its Offices or Commissions, as hereinabove reserved.

Applicant: Stephen M. Jenkins & Associates, Inc.

Bidder	Cash Payment	Price / Acre	Rental	Oil	Gas	Other



OFFICIAL COPY
OFFICE OF MINERAL RESOURCES
DEPT. OF NATURAL RESOURCES
DO NOT REMOVE

P.O.B.
X=1,507,095.87
Y= 415,879.97

TR 32872
367 +/- ACS.
NOV., 2000

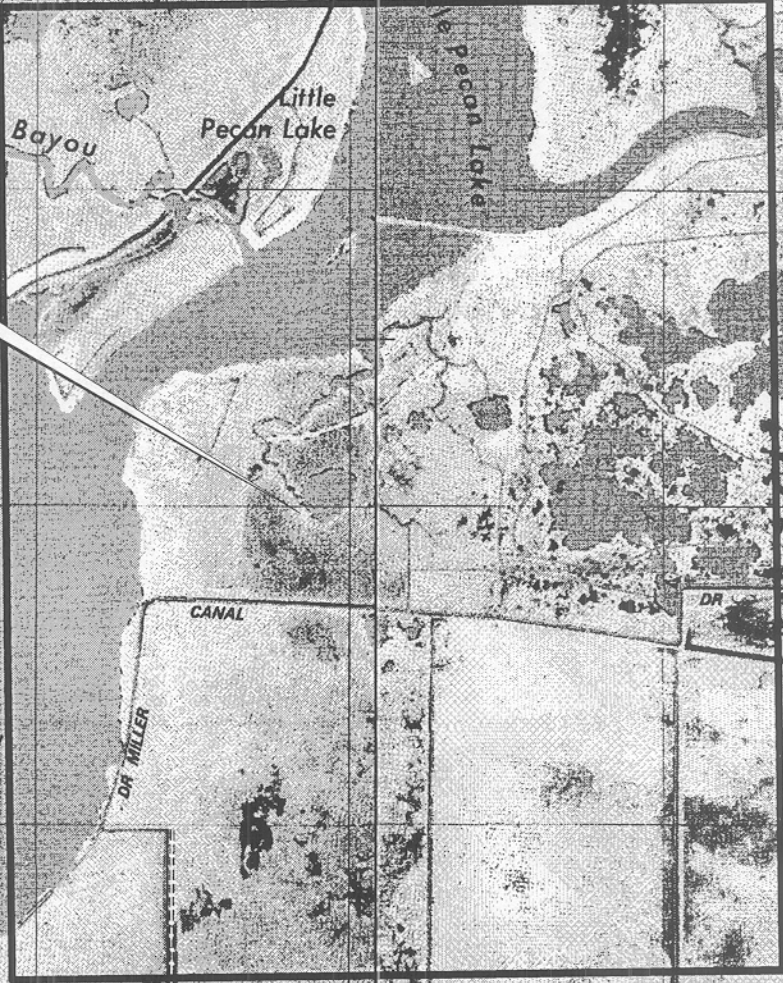

T14S-R5W

T15S-R5W

CAMERON PARISH

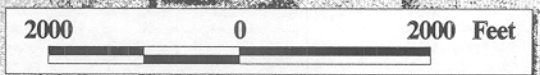

TRACT 32873 - Cameron Parish, Louisiana

All of the lands now or formerly constituting the beds and bottoms of all water bodies of every nature and description and all islands and other lands formed by accretion or reliction, except tax lands, owned by and not under mineral lease from the State of Louisiana on November 8, 2000, situated in Cameron Parish, Louisiana, within the following described boundaries: Beginning at a point having Coordinates of X = 1,507,095.87 and Y = 425,957.62; thence East 5,204.13 feet to a point on the West line of State Lease No. 16138 having Coordinates of X = 1,512,300.00 and Y = 425,957.62; thence on the boundary of said State Lease No. 16138 the following courses: South 3,007.62 feet, East 2,399.99 feet and North 3,007.62 feet to a point on its East line having Coordinates of X = 1,514,699.99 and Y = 425,997.62; thence East 470.34 feet to a point having Coordinates of X = 1,515,170.33 and Y = 425,957.62; thence South 10,077.65 feet to a point having Coordinates of X = 1,515,170.33 and Y = 415,879.97; thence West 8,074.46 feet to a point having Coordinates of X = 1,507,095.87 and Y = 415,879.97; thence North 10,077.65 feet to the point of beginning, containing approximately 156 acres, as shown outlined in red on a plat on file in the Office of Mineral Resources, Department of Natural Resources. All bearings, distances and coordinates are based on Louisiana Coordinate System of 1927 (South Zone).

NOTE: The State of Louisiana does hereby reserve, and this lease shall be subject to, the imprescriptible right of surface use in the nature of a servitude in favor of the Department of Natural Resources, including its Offices and Commissions, for the sole purpose of implementing, constructing, servicing and maintaining approved coastal zone management and/or restoration projects. Utilization of any and all rights derived under this lease by the mineral lessee, its agents, successors or assigns, shall not interfere with nor hinder the reasonable surface use by the Department of Natural Resources, its Offices or Commissions, as hereinabove reserved.

Applicant: Stephen M. Jenkins & Associates, Inc.

Bidder	Cash Payment	Price / Acre	Rental	Oil	Gas	Other

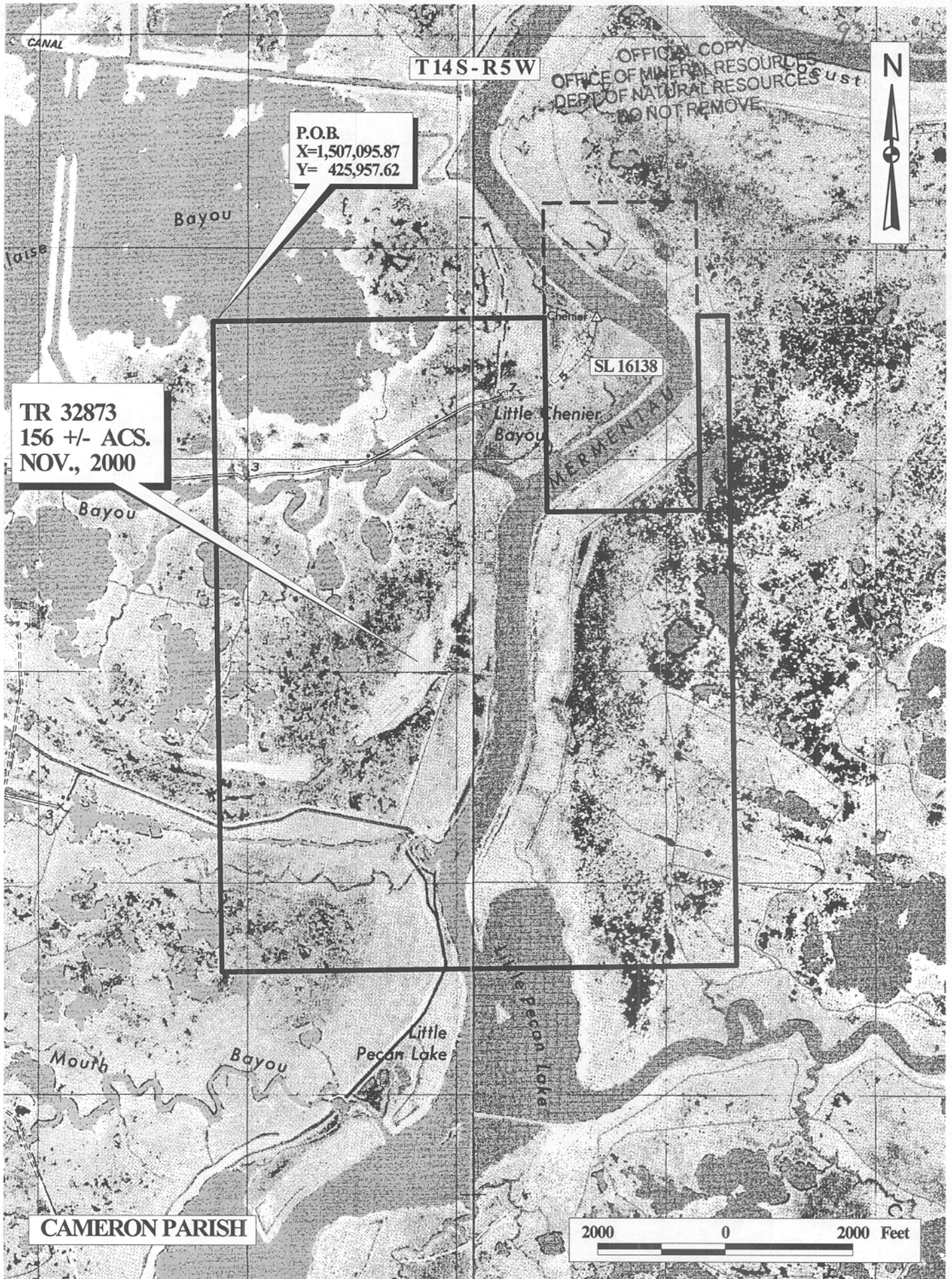

T14S-R5W

OFFICIAL COPY
OFFICE OF MINERAL RESOURCES
DEPT. OF NATURAL RESOURCES
DO NOT REMOVE



P.O.B.
X=1,507,095.87
Y= 425,957.62

TR 32873
156 +/- ACS.
NOV., 2000

SL 16138

CAMERON PARISH

2000 0 2000 Feet