

NOT TO BE USED WITH A PORTION BID
FOR INFORMATIONAL PURPOSES ONLY!

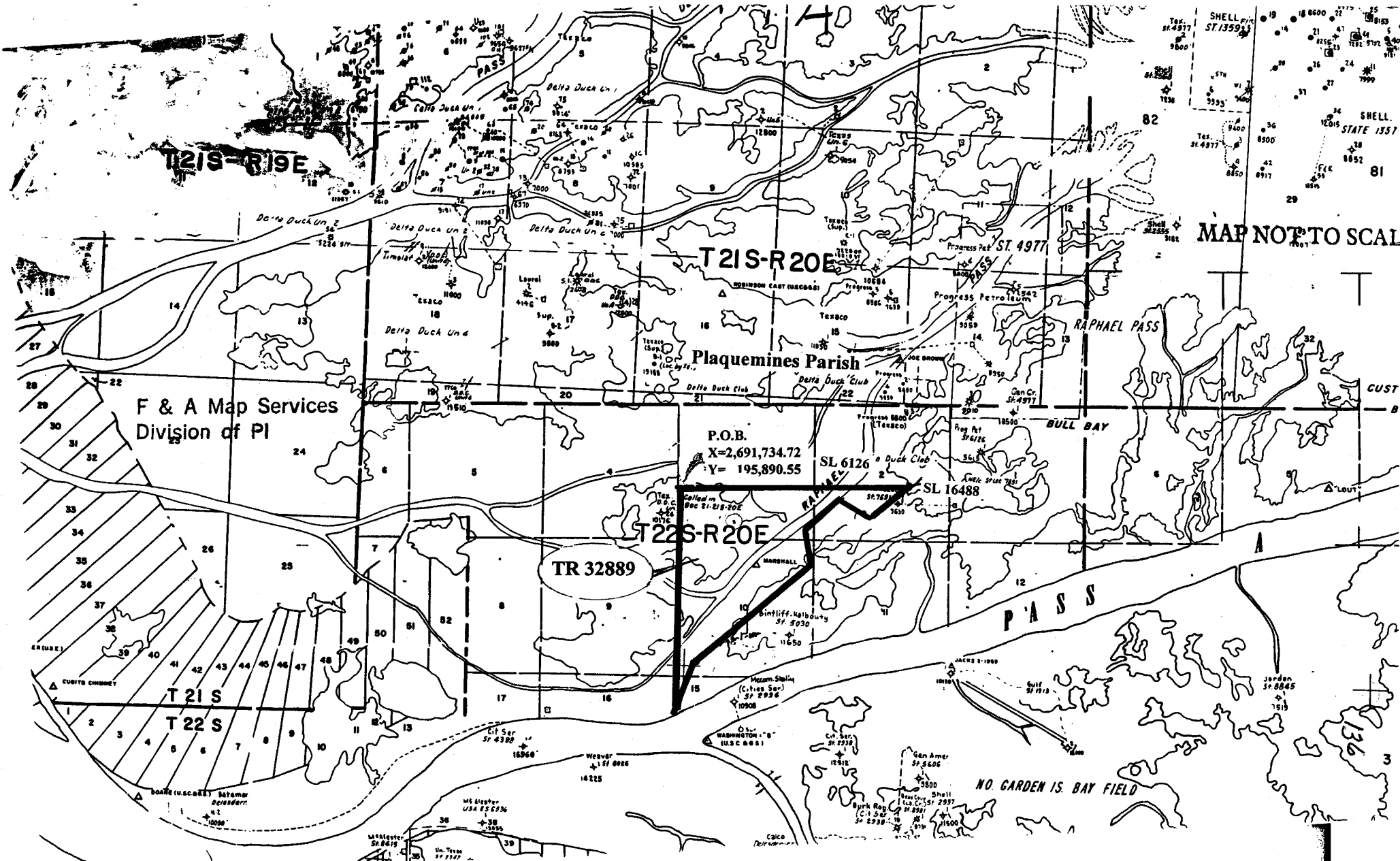

F & A Map Services
Division of PI

MAP NOT TO SCALE

P.O.B.
X=2,691,734.72
Y=195,890.55

TR 32889

SL 6126

SL 16488

T 21 S

T 22 S

T 22 S-R 20 E

T 21 S-R 20 E

T 21 S-R 19 E

Plaquemines Parish

RAPHAEL PASS

BULL BAY

PASS

NO. GARDEN IS. BAY FIELD

TRACT 32889 - Plaquemines Parish, Louisiana

All of the lands now or formerly constituting the beds and bottoms of all water bodies of every nature and description and all islands and other lands formed by accretion or reliction, except tax lands, owned by and not under mineral lease from the State of Louisiana on November 8, 2000, situated in Plaquemines Parish, Louisiana, within the following described boundaries: Beginning at a point having Coordinates of X = 2,691,734.72 and Y = 195,890.55; thence East 4,830.28 feet to the Southwest corner of State Lease No. 6126 having Coordinates of X = 2,696,565.00 and Y = 195,890.55; thence East 4,446.40 feet on the South line of said State Lease No. 6126 to a point on the North boundary of Pass-a-Loutre Wildlife Management Area having Coordinates of X = 2,701,011.40 and Y = 195,890.55; thence along the boundary of said Pass-a-Loutre Wildlife Management Area the following courses: Southwesterly on an arc having a radius of 5,575.00 feet and a center at X = 2,698,285.38 and Y = 200,753.62 to a point having Coordinates of X = 2,700,418.06 and Y = 195,602.67; Southwesterly on an arc having a radius of 3,825.00 feet and a center at X = 2,702,184.92 and Y = 192,210.20 to a point having Coordinates of X = 2,699,258.46 and Y = 194,673.22; North 61 degrees 03 minutes 05 seconds West 1,517.78 feet; South 46 degrees 26 minutes 00 seconds West 1,803.56 feet; South 08 degrees 56 minutes 28 seconds East 1,219.79 feet; South 51 degrees 54 minutes 17 seconds West 6,013.98 feet and South 17 degrees 44 minutes 54 seconds West 1,133.27 feet to a point having Coordinates of X = 2,691,734.72 and Y = 188,170.09; thence North 7,720.46 feet to the point of beginning, containing approximately 100 acres, as shown outlined in red on a plat on file in the Office of Mineral Resources, Department of Natural Resources. All bearings, distances and coordinates are based on Louisiana Coordinate System of 1927 (South Zone).

NOTE: The above tract is located in or near an oyster restricted area and all operations in such area must be conducted in strict conformity with the stipulations and/or regulations of the Louisiana Department of Wildlife and Fisheries.

NOTE: The State of Louisiana does hereby reserve, and this lease shall be subject to, the imprescriptible right of surface use in the nature of a servitude in favor of the Department of Natural Resources, including its Offices and Commissions, for the sole purpose of implementing, constructing, servicing and maintaining approved coastal zone management and/or restoration projects. Utilization of any and all rights derived under this lease by the mineral lessee, its agents, successors or assigns, shall not interfere with nor hinder the reasonable surface use by the Department of Natural Resources, its Offices or Commissions, as hereinabove reserved.

Applicant: Lafreniere & Co., Ltd.

Bidder	Cash Payment	Price / Acre	Rental	Oil	Gas	Other

P.O.B.
X=2,691,734.72
Y= 195,890.55

T 21 S - R 20 E

SL 6126

TR 32889
100 +/- ACS.
NOV., 2000

APPROXIMATE BOUNDARY
PASS-A-LOUTRE MANAGEMENT AREA



PLAQUEMINES PARISH

OFFICIAL COPY
OFFICE OF MINERAL RESOURCES
DEPT. OF NATURAL RESOURCES
DO NOT REMOVE

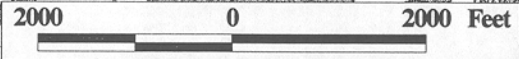

139

**NOT TO BE USED WITH A PORTION BID
FOR INFORMATIONAL PURPOSES ONLY!**

F & A Map Services
Division of PI

MAP NOT TO SCALE

P.O.B.
X=2,664,850.00
Y= 292,830.00



KERR MCGEE
ST. 8671

TR 32890

P.O.B.
X=2,679,600.00
Y= 292,830.00

TR 32891

BRETON SO. BLK. 49 FIELD

P.O.B.
X=2,679,600.00
Y= 288,130.00

TR 32893

TR 32892

P.O.B.
X=2,679,600.00
Y= 278,080.00

TR 32894

MAIN PASS BLK. 4

SL 16393

BRETON SOUND AREA

MAIN PASS AREA, REVISED

P.O.B.
X=2,664,850.00
Y= 278,080.00

SL 16392 KERR-MCGEE
ST. 1000
063-0330

PLAQUEMINES PARISH

MAIN PASS BLK. 47 FIELD

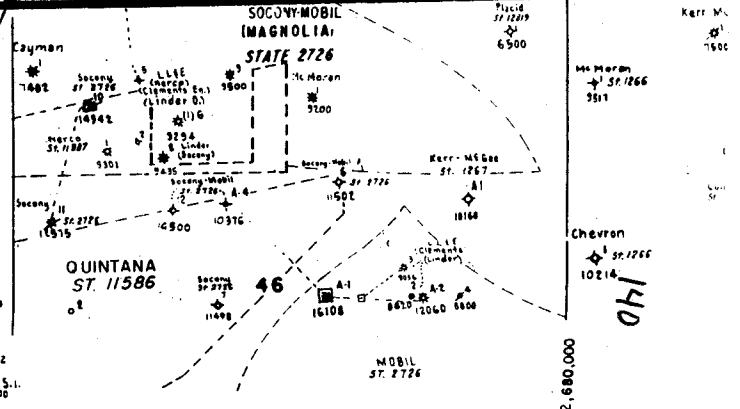

QUINTANA
ST. 11586

140

2,660,000

2,660,000

2,660,000

MOORE-McCORMACK)
ST. 12154

ASS-BLK- 49 FIELD
10444

SANTA FE
ST. 10445

Amrock Tide
ST. 8791

Century Min.
ST. 16317

Ar-La 0701
ST. 2782
10010

An-Son
ST. 2782
10070

Willford
ST. 0676
10000

Phillips
ST. 2782
10000

Kerr Mc
ST. 1266
9511

McMoran
ST. 1266
9511

Chevron
ST. 1266
10214

140

TRACT 32890 - PORTION OF BLOCK 50, BRETON SOUND AREA, Plaquemines Parish, Louisiana

All of the lands now or formerly constituting the beds and bottoms of all water bodies of every nature and description and all islands and other lands formed by accretion or reliction, except tax lands, belonging to the State of Louisiana and not under mineral lease on November 8, 2000, situated in Plaquemines Parish, Louisiana, and more particularly described as follows: Beginning at the Northeast corner of Block 50, Breton Sound Area, having Coordinates of X = 2,664,850.00 and Y = 292,830.00; thence South 7,375.00 feet along the East line of said Block 50 to a point having Coordinates of X = 2,664,850.00 and Y = 285,455.00; thence West 14,750.00 feet to a point on the West line of said Block 50 having Coordinates of X = 2,650,100.00 and Y = 295,455.00; thence North 7,375.00 feet along said West line of said Block 50 to a point having Coordinates of X = 2,650,100.00 and Y = 292,830.00; thence East 14,750.00 feet along the North line of said Block 50 to the point of beginning, containing approximately **2,497.27 acres**, as shown outlined in red on a plat on file in the Office of Mineral Resources, Department of Natural Resources. All bearings, distances and coordinates are based on Louisiana Coordinate System of 1927 (South Zone).

NOTE: The State of Louisiana does hereby reserve, and this lease shall be subject to, the imprescriptible right of surface use in the nature of a servitude in favor of the Department of Natural Resources, including its Offices and Commissions, for the sole purpose of implementing, constructing, servicing and maintaining approved coastal zone management and/or restoration projects. Utilization of any and all rights derived under this lease by the mineral lessee, its agents, successors or assigns, shall not interfere with nor hinder the reasonable surface use by the Department of Natural Resources, its Offices or Commissions, as hereinabove reserved.

Applicant: Robert A. Schroeder, Inc.

Bidder	Cash Payment	Price / Acre	Rental	Oil	Gas	Other

D
BLOCK 48

BLOCK 47

P.O.B.
X=2,664,850.00
Y= 292,830.00



BLOCK 46

BLOCK 49

BLOCK 51

BLOCK 50

TR 32890
2,497.27 +/- ACS.
NOV., 2000

BRETON SOUND AREA

PLAQUEMINES PARISH

OFFICIAL COPY
OFFICE OF MINERAL RESOURCES
DEPT. OF NATURAL RESOURCES
DO NOT REMOVE



142