

**TRACT 44415 - Tangipahoa Parish, Louisiana**

All of the mineral rights only under land adjudicated to and acquired by the State of Louisiana in and through a proper tax sale, and subsequently alienated by the State which retained the mineral rights thereto, and which is not under valid mineral lease from the State of Louisiana on October 14, 2015, situated in Tangipahoa Parish, Louisiana, and being more fully described as follows: 120 acres, more or less in the West 1/2 of North West 1/4 and North East 1/4 of North West 1/4 of Section No. One (1) in Township No. One (1) South, Range No. Six (6) East in the Greensburg Land District, Parish of Tangipahoa, containing one hundred twenty and no/100 **120.00 acres**, all as more particularly outlined on a plat on file in the Office of Mineral Resources, Department of Natural Resources. All bearings, distances and coordinates are based on Louisiana Coordinate System of 1927, (North or South Zone), where applicable.

NOTE: The above description of the Tract nominated for the purpose of acquiring a mineral lease or a geophysical agreement has been provided and corrected, where required, exclusively by the nominating party. Any mineral lease or geophysical agreement selected from this Tract and awarded by the Louisiana State Mineral and Energy Board shall be without warranty of any kind, either express, implied or statutory including, but not limited to, title or the implied warranties of merchantability and fitness for a particular purpose.

An error or omission in the nominating party's Tract description may require that a State mineral lease or geophysical agreement be modified, canceled or abrogated due to the existence of conflicting leases, operating agreements, private claims or other future obligations or conditions within the Tract described. In such case, however, the Louisiana State Mineral and Energy Board shall not be obligated to refund any consideration paid by the Lessee prior to such modification, cancellation or abrogation including, but not limited to, bonuses, rentals and royalties.

NOTE: No surface activity on this tract undertaken in conjunction with any operations under any mineral lease given on this tract will be allowed without prior approval of the surface owner and further, no such right of surface use shall be deemed to have been given as part of any mineral lease by the State of Louisiana on this tract.

Bidder	Cash Payment	Price/Acre	Rental	Oil	Gas	Other

Applicant: PALOMA PARTNERS IV, LLC





0 1,500 Feet

**Legend**

-  15100025
-  Counties

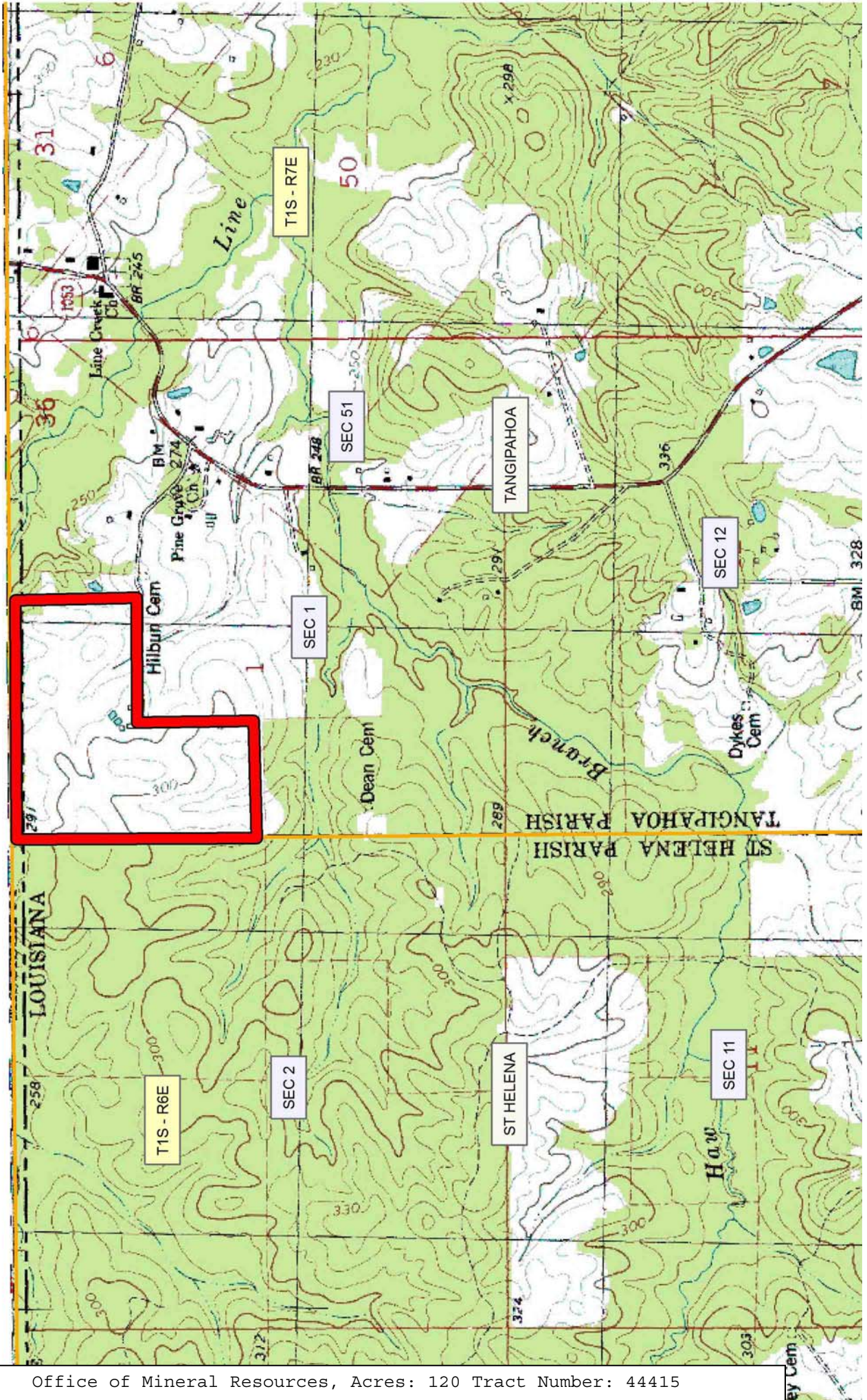



**TRACT 44416 - Tangipahoa Parish, Louisiana**

All of the mineral rights only under land adjudicated to and acquired by the State of Louisiana in and through a proper tax sale, and subsequently alienated by the State which retained the mineral rights thereto, and which is not under valid mineral lease from the State of Louisiana on October 14, 2015, situated in Tangipahoa Parish, Louisiana, and being more fully described as follows: The following described property adjudicated to the State in the name of Mrs. Pearl George, for the unpaid taxes of the year 1937, conveyed to Mrs. Mae George on January 26, 1948: 48 acres, more or less, in Township 1 South, Range 7 East, Section 4, abounded by now or formally by North by State Line; East by Lee, South by Simonds, West by Simonds, in NW1/4 of NE1/4 and SW1/4 of NE1/4 and North part of W1/2 of SE1/4 of Section 4, Township 1 South, Range No. 7 East, in the Greensburg Land District, Parish of Tangipahoa, containing **48.0 acres**, all as more particularly outlined on a plat on file in the Office of Mineral Resources, Department of Natural Resources. All bearings, distances and coordinates are based on Louisiana Coordinate System of 1927, (North or South Zone), where applicable.

NOTE: The above description of the Tract nominated for the purpose of acquiring a mineral lease or a geophysical agreement has been provided and corrected, where required, exclusively by the nominating party. Any mineral lease or geophysical agreement selected from this Tract and awarded by the Louisiana State Mineral and Energy Board shall be without warranty of any kind, either express, implied or statutory including, but not limited to, title or the implied warranties of merchantability and fitness for a particular purpose.

An error or omission in the nominating party's Tract description may require that a State mineral lease or geophysical agreement be modified, canceled or abrogated due to the existence of conflicting leases, operating agreements, private claims or other future obligations or conditions within the Tract described. In such case, however, the Louisiana State Mineral and Energy Board shall not be obligated to refund any consideration paid by the Lessee prior to such modification, cancellation or abrogation including, but not limited to, bonuses, rentals and royalties.

NOTE: No surface activity on this tract undertaken in conjunction with any operations under any mineral lease given on this tract will be allowed without prior approval of the surface owner and further, no such right of surface use shall be deemed to have been given as part of any mineral lease by the State of Louisiana on this tract.

Applicant: PALOMA PARTNERS IV, LLC

Bidder	Cash Payment	Price/Acre	Rental	Oil	Gas	Other

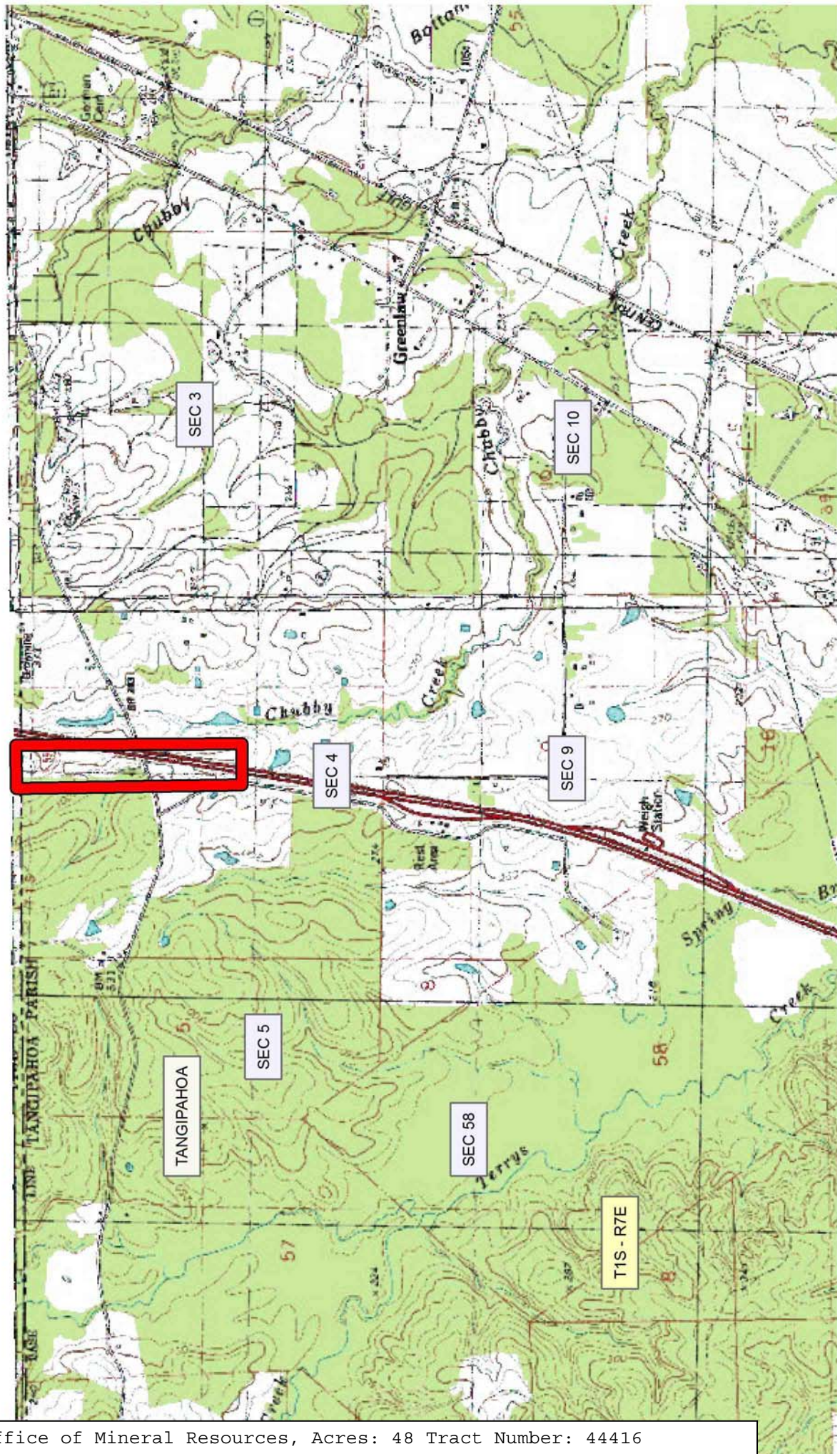



**TRACT 44417 - Tangipahoa Parish, Louisiana**

All of the mineral rights only under land adjudicated to and acquired by the State of Louisiana in and through a proper tax sale, and subsequently alienated by the State which retained the mineral rights thereto, and which is not under valid mineral lease from the State of Louisiana on October 14, 2015, situated in Tangipahoa Parish, Louisiana, and being more fully described as follows: 18.0 acres, more or less in the North 1/2 of South West 1/4 of Section No. One (1) in Township No. One (1) South, Range No. Six (6) East in the Greensburg Land District, Parish of Tangipahoa. Being the same property adjudicated to the State of Louisiana for the unpaid taxes of 1919, in the name of Mary LaRosa, and purchased by Clarence Wall at a Sheriff's Sale on December 23, 1944, containing **18 acres**, all as more particularly outlined on a plat on file in the Office of Mineral Resources, Department of Natural Resources. All bearings, distances and coordinates are based on Louisiana Coordinate System of 1927, (North or South Zone), where applicable.

NOTE: The above description of the Tract nominated for the purpose of acquiring a mineral lease or a geophysical agreement has been provided and corrected, where required, exclusively by the nominating party. Any mineral lease or geophysical agreement selected from this Tract and awarded by the Louisiana State Mineral and Energy Board shall be without warranty of any kind, either express, implied or statutory including, but not limited to, title or the implied warranties of merchantability and fitness for a particular purpose.

An error or omission in the nominating party's Tract description may require that a State mineral lease or geophysical agreement be modified, canceled or abrogated due to the existence of conflicting leases, operating agreements, private claims or other future obligations or conditions within the Tract described. In such case, however, the Louisiana State Mineral and Energy Board shall not be obligated to refund any consideration paid by the Lessee prior to such modification, cancellation or abrogation including, but not limited to, bonuses, rentals and royalties.

NOTE: No surface activity on this tract undertaken in conjunction with any operations under any mineral lease given on this tract will be allowed without prior approval of the surface owner and further, no such right of surface use shall be deemed to have been given as part of any mineral lease by the State of Louisiana on this tract.

Applicant: PALOMA PARTNERS IV, LLC

Bidder	Cash Payment	Price/Acre	Rental	Oil	Gas	Other



**Legend**

- 15100024
- Active\_Leases
- Counties

N

0 1,000 Feet

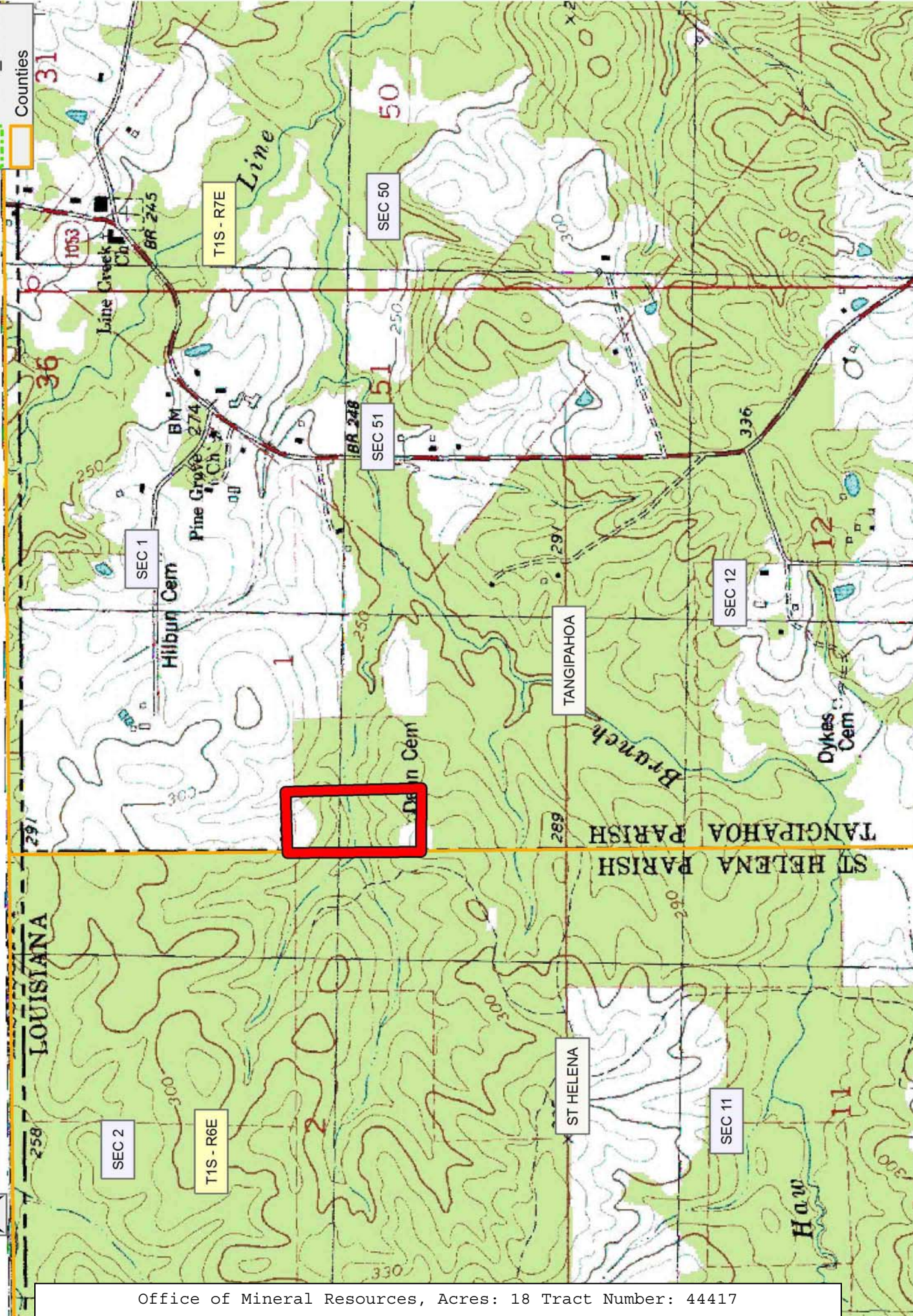



**TRACT 44418 - Tangipahoa Parish, Louisiana**

All of the mineral rights only under land adjudicated to and acquired by the State of Louisiana in and through a proper tax sale, and subsequently alienated by the State which retained the mineral rights thereto, and which is not under valid mineral lease from the State of Louisiana on October 14, 2015, situated in Tangipahoa Parish, Louisiana, and being more fully described as follows: 16.21 acres, more or less, being Lots 1, 2, and 3, of Section 7, Township No. 1, Range 7 East, Tangipahoa Parish, State of Louisiana. Being same lands adjudicated to the State at a sheriff's sale on June 12, 1943, for unpaid taxes of the year 1942 by Mrs. E. R. Simond, containing **16.21 acres**, all as more particularly outlined on a plat on file in the Office of Mineral Resources, Department of Natural Resources. All bearings, distances and coordinates are based on Louisiana Coordinate System of 1927, (North or South Zone), where applicable.

NOTE: The above description of the Tract nominated for the purpose of acquiring a mineral lease or a geophysical agreement has been provided and corrected, where required, exclusively by the nominating party. Any mineral lease or geophysical agreement selected from this Tract and awarded by the Louisiana State Mineral and Energy Board shall be without warranty of any kind, either express, implied or statutory including, but not limited to, title or the implied warranties of merchantability and fitness for a particular purpose.

An error or omission in the nominating party's Tract description may require that a State mineral lease or geophysical agreement be modified, canceled or abrogated due to the existence of conflicting leases, operating agreements, private claims or other future obligations or conditions within the Tract described. In such case, however, the Louisiana State Mineral and Energy Board shall not be obligated to refund any consideration paid by the Lessee prior to such modification, cancellation or abrogation including, but not limited to, bonuses, rentals and royalties.

NOTE: No surface activity on this tract undertaken in conjunction with any operations under any mineral lease given on this tract will be allowed without prior approval of the surface owner and further, no such right of surface use shall be deemed to have been given as part of any mineral lease by the State of Louisiana on this tract.

Applicant: PALOMA PARTNERS IV, LLC

Bidder	Cash Payment	Price/Acre	Rental	Oil	Gas	Other





Office of Mineral Resources, Acres: 16.21 Tract Number: 44418



**TRACT 44419 - St. Helena Parish, Louisiana**

All of the mineral rights only under land adjudicated to and acquired by the State of Louisiana in and through a proper tax sale, and subsequently alienated by the State which retained the mineral rights thereto, and which is not under valid mineral lease from the State of Louisiana on October 14, 2015, situated in St. Helena Parish, Louisiana, and being more fully described as follows: 25.0 acres, more or less situated in Lot 4, Section 8, Township 1 South, Range 6 East, in the Greensburg Land District, Parish of St. Helena, State of Louisiana. Being same lands adjudicated to the State of Louisiana in the name of Homes Bros. for the unpaid taxes of the year 1932 and conveyed to H.C. Newman on May 9, 1952, containing **25.0 acres**, all as more particularly outlined on a plat on file in the Office of Mineral Resources, Department of Natural Resources. All bearings, distances and coordinates are based on Louisiana Coordinate System of 1927, (North or South Zone), where applicable.

NOTE: The above description of the Tract nominated for the purpose of acquiring a mineral lease or a geophysical agreement has been provided and corrected, where required, exclusively by the nominating party. Any mineral lease or geophysical agreement selected from this Tract and awarded by the Louisiana State Mineral and Energy Board shall be without warranty of any kind, either express, implied or statutory including, but not limited to, title or the implied warranties of merchantability and fitness for a particular purpose.

An error or omission in the nominating party's Tract description may require that a State mineral lease or geophysical agreement be modified, canceled or abrogated due to the existence of conflicting leases, operating agreements, private claims or other future obligations or conditions within the Tract described. In such case, however, the Louisiana State Mineral and Energy Board shall not be obligated to refund any consideration paid by the Lessee prior to such modification, cancellation or abrogation including, but not limited to, bonuses, rentals and royalties.

NOTE: No surface activity on this tract undertaken in conjunction with any operations under any mineral lease given on this tract will be allowed without prior approval of the surface owner and further, no such right of surface use shall be deemed to have been given as part of any mineral lease by the State of Louisiana on this tract.

Applicant: PALOMA PARTNERS IV, LLC

Bidder	Cash Payment	Price/Acre	Rental	Oil	Gas	Other



Legend



15100028

T1S - R6E

ST HELENA

SEC 8

SEC 17



SEC 38

SEC 7

SEC 39

T1S - R5E

