

TRACT 40402 - Iberia St. Martin and St. Mary Parishes, LOUISIANA

All land, and land now or formerly constituting the beds and bottoms of any water body of whatever description and nature, all belonging to the State of Louisiana located within the geographical boundaries of the Attakapas Wildlife Management Area, and not presently under mineral lease by the State of Louisiana as of October 8, 2008, the area of which is set forth as follows: Beginning at a point having Coordinates of X = 1,947,385.00 and Y = 472,700.00; thence East 13,615.00 feet to a point having Coordinates of X = 1,961,000.00 and Y = 472,700.00; thence South 12,079.01 feet to a point on the North boundary of State Lease No. 14521 having Coordinates of X = 1,961,000.00 and Y = 460,620.99; thence West 5,000.00 feet along the North boundary of said State Lease No. 14521 to the Southeast corner of State Lease No. 14912 having Coordinates of X = 1,956,000.00 and Y = 460,620.99; thence along the East and North boundary of said State Lease No. 14912 the following courses and distances: North 6,579.01 feet to a corner having Coordinates of X = 1,956,000.00 and Y = 467,200.00 and West 3,597.18 feet to its Northwest corner, also being the Northeast corner of State Lease No. 14520 having Coordinates of X = 1,952,402.82 and Y = 467,200.00; thence West 5,017.82 feet along the North boundary of said State Lease No. 14520 to its Northwest corner, also being the Northeast corner of State Lease No. 14519, having Coordinates of X = 1,947,385.00 and Y = 467,200.00; thence North 5,500.00 feet to the point of beginning, **LESS AND EXCEPT** that portion, if any, of the above described tract which may lie outside of the boundary of said Attakapas Wildlife Management Area, containing approximately **2,054 acres**, all as more particularly outlined on a plat on file in the Office of Mineral Resources, Department of Natural Resources. All bearings, distances and coordinates are based on Louisiana Coordinate System of 1927, (North or South Zone).

NOTE: The above description of the Tract nominated for lease has been provided and corrected, where required, exclusively by the nomination party. Any mineral lease selected from this Tract and awarded by the Louisiana State Mineral Board shall be without warranty of any kind, either express, implied, or statutory, including, but not limited to, the implied warranties of merchantability and fitness for a particular purpose. Should the mineral lease awarded by the Louisiana State Mineral Board be subsequently modified, cancelled or abrogated due to the existence of conflicting leases, operating agreements, private claims or other future obligations or conditions which may affect all or any portion of the leased Tract, it shall not relieve the Lessee of the obligation to pay any bonus due thereon to the Louisiana State Mineral Board, nor shall the Louisiana State Mineral Board be obligated to refund any consideration paid by the Lessor prior to such modification, cancellation, or abrogation, including, but not limited to, bonuses, rentals and royalties.

NOTE: This tract is located within the boundaries of the Attakapas Wildlife Management Area or refuge and any operations conducted thereon in conjunction with this mineral lease may be subject to rules and

regulations promulgated by the Department of Wildlife and Fisheries for the protection of fish, birds and other wildlife including, but not necessarily limited to, the following:

1. No activities will be allowed without written authorization of the Louisiana Department of Wildlife and Fisheries.
2. Proposed projects will be evaluated on a case by case basis. Modifications to proposed project features including but not limited to access routes, spoil placement, well sites, flowlines and appurtenant structures may be required by the Louisiana Department of Wildlife and Fisheries.
3. Compliance with the Attakapas WMA regulations will be required unless otherwise specified by the Department of Wildlife and Fisheries.
4. Compensatory mitigation will be required to offset unavoidable wetland impacts.
5. Removal of all structures, facilities and equipment will be required within 120 days of abandonment unless otherwise agreed to by the Louisiana Department of Wildlife and Fisheries.
6. No activities will be allowed during the hunting season unless authorized by the Department.
7. Prior to submitting applications for wetland permits to Federal and State permitting agencies, the leaseholder shall coordinate project details with the Department. Contact person for the Department will be Mike Windham at (504) 284-5268.

Additionally, the Department will require a minimum bonus of \$350 per acre and a minimum royalty of 25%

NOTE: The State of Louisiana does hereby reserve, and this lease shall be subject to, the imprescriptible right of surface use in the nature of a servitude in favor of the Department of Natural Resources, including its Offices and Commissions, for the sole purpose of implementing, constructing, servicing and maintaining approved coastal zone management and/or restoration projects. Utilization of any and all rights derived under this lease by the mineral lessee, its agents, successors or assigns, shall not interfere with nor hinder the reasonable surface use by the Department of Natural Resources, its Offices or Commissions, as herein above reserved.

Applicant: THEOPHILUS OIL, GAS & LAND SERVICES, LLC

Bidder	Cash Payment	Price/Acre	Rental	Oil	Gas	Other

Legend

- ▭ 08100062
- ▭ Wildlife
- ▭ Active_Leases
- ▭ Counties

DOQQ2004

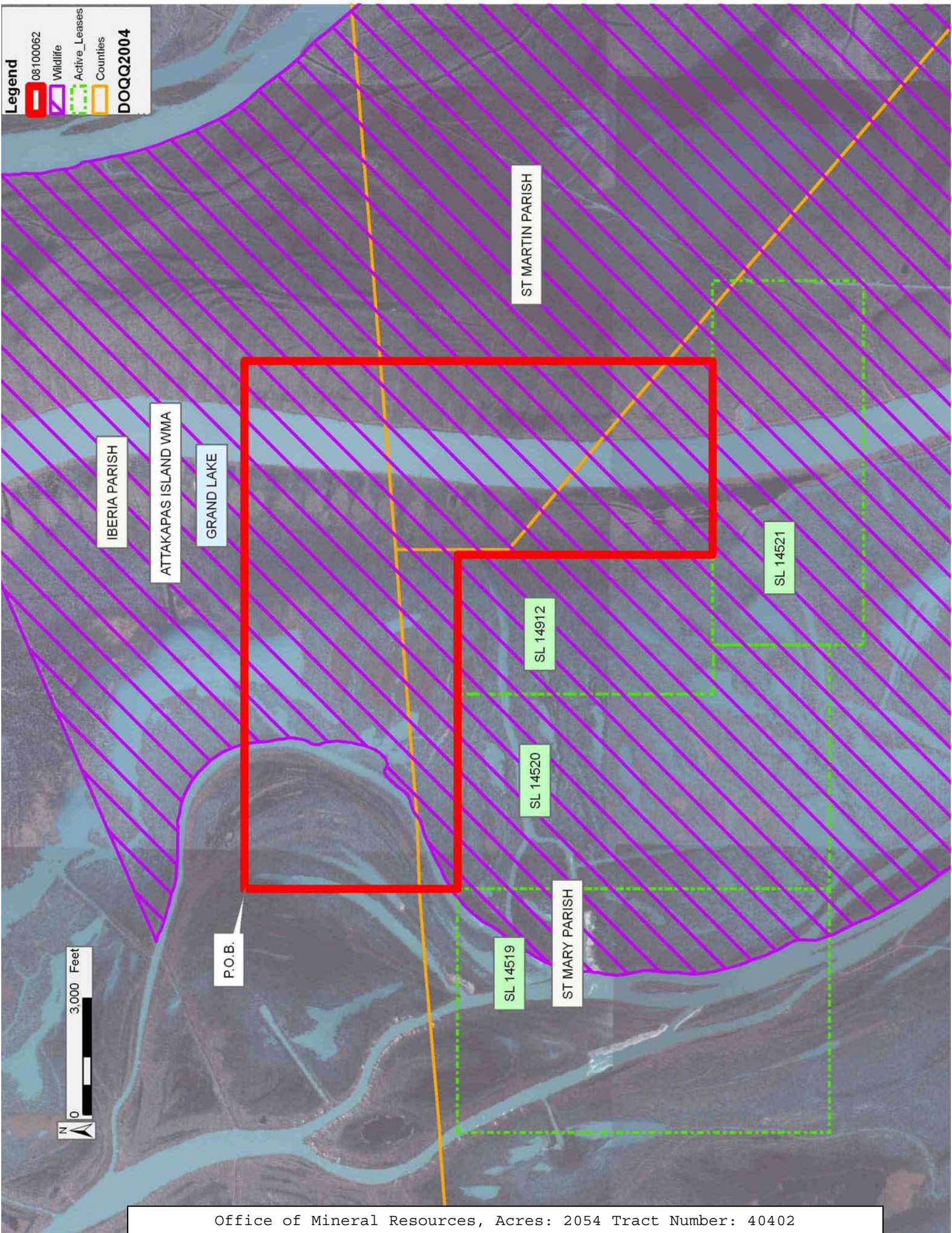

TRACT 40403 - Iberia St. Martin and St. Mary Parishes, LOUISIANA

All land, and land now or formerly constituting the beds and bottoms of any water body of whatever description and nature, all belonging to the State of Louisiana located within the geographical boundaries of the Attakapas Wildlife Management Area, and not presently under mineral lease by the State of Louisiana as of October 8, 2008, the area of which is set forth as follows: Beginning at a point having Coordinates of X = 1,961,000.00 and Y = 472,700.00; thence East 4,600.00 feet to a point having Coordinates of X = 1,965,600.00 and Y = 472,700.00; thence South 12,079.01 feet to a point having Coordinates of X = 1,965,600.00 and Y = 460,620.99; thence West 2,525.51 feet to the Northeast corner of State Lease No. 14521 having Coordinates of X = 1,963,074.49 and Y = 460,620.99; thence West 2,074.49 feet along the North boundary of said State Lease No. 14521 to a point having Coordinates of X = 1,961,000.00 and Y = 460,620.99; thence North 12,079.01 feet to the point of beginning, containing approximately **1,275.56 acres**, all as more particularly outlined on a plat on file in the Office of Mineral Resources, Department of Natural Resources. All bearings, distances and coordinates are based on Louisiana Coordinate System of 1927, (North or South Zone).

NOTE: The above description of the Tract nominated for lease has been provided and corrected, where required, exclusively by the nomination party. Any mineral lease selected from this Tract and awarded by the Louisiana State Mineral Board shall be without warranty of any kind, either express, implied, or statutory, including, but not limited to, the implied warranties of merchantability and fitness for a particular purpose. Should the mineral lease awarded by the Louisiana State Mineral Board be subsequently modified, cancelled or abrogated due to the existence of conflicting leases, operating agreements, private claims or other future obligations or conditions which may affect all or any portion of the leased Tract, it shall not relieve the Lessee of the obligation to pay any bonus due thereon to the Louisiana State Mineral Board, nor shall the Louisiana State Mineral Board be obligated to refund any consideration paid by the Lessor prior to such modification, cancellation, or abrogation, including, but not limited to, bonuses, rentals and royalties.

NOTE: This tract is located within the boundaries of the Attakapas Wildlife Management Area or refuge and any operations conducted thereon in conjunction with this mineral lease may be subject to rules and regulations promulgated by the Department of Wildlife and Fisheries for the protection of fish, birds and other wildlife including, but not necessarily limited to, the following:

1. No activities will be allowed without written authorization of the Louisiana Department of Wildlife and Fisheries.
2. Proposed projects will be evaluated on a case by case basis. Modifications to proposed project features including but not limited to

access routes, spoil placement, well sites, flowlines and appurtenant structures may be required by the Louisiana Department of Wildlife and Fisheries.

3. Compliance with the Attakapas WMA regulations will be required unless otherwise specified by the Department of Wildlife and Fisheries.

4. Compensatory mitigation will be required to offset unavoidable wetland impacts.

5. Removal of all structures, facilities and equipment will be required within 120 days of abandonment unless otherwise agreed to by the Louisiana Department of Wildlife and Fisheries.

6. No activities will be allowed during the hunting season unless authorized by the Department.

7. Prior to submitting applications for wetland permits to Federal and State permitting agencies, the leaseholder shall coordinate project details with the Department. Contact person for the Department will be Mike Windham at (504) 284-5268.

Additionally, the Department will require a minimum bonus of \$350 per acre and a minimum royalty of 25%

NOTE: The State of Louisiana does hereby reserve, and this lease shall be subject to, the imprescriptible right of surface use in the nature of a servitude in favor of the Department of Natural Resources, including its Offices and Commissions, for the sole purpose of implementing, constructing, servicing and maintaining approved coastal zone management and/or restoration projects. Utilization of any and all rights derived under this lease by the mineral lessee, its agents, successors or assigns, shall not interfere with nor hinder the reasonable surface use by the Department of Natural Resources, its Offices or Commissions, as herein above reserved.

Applicant: THEOPHILUS OIL, GAS & LAND SERVICES, LLC

Bidder	Cash Payment	Price/Acre	Rental	Oil	Gas	Other

Legend

- 08100063
- Wildlife
- Active_Leases
- Counties
- DOQQ2004

