

PASS-A-LOUTRE

TRACTS

TRACT 32833 - WITHDRAWN PER APPLICANT

TRACT 32834 - WITHDRAWN PER APPLICANT

TRACT 32835 - WITHDRAWN PER APPLICANT

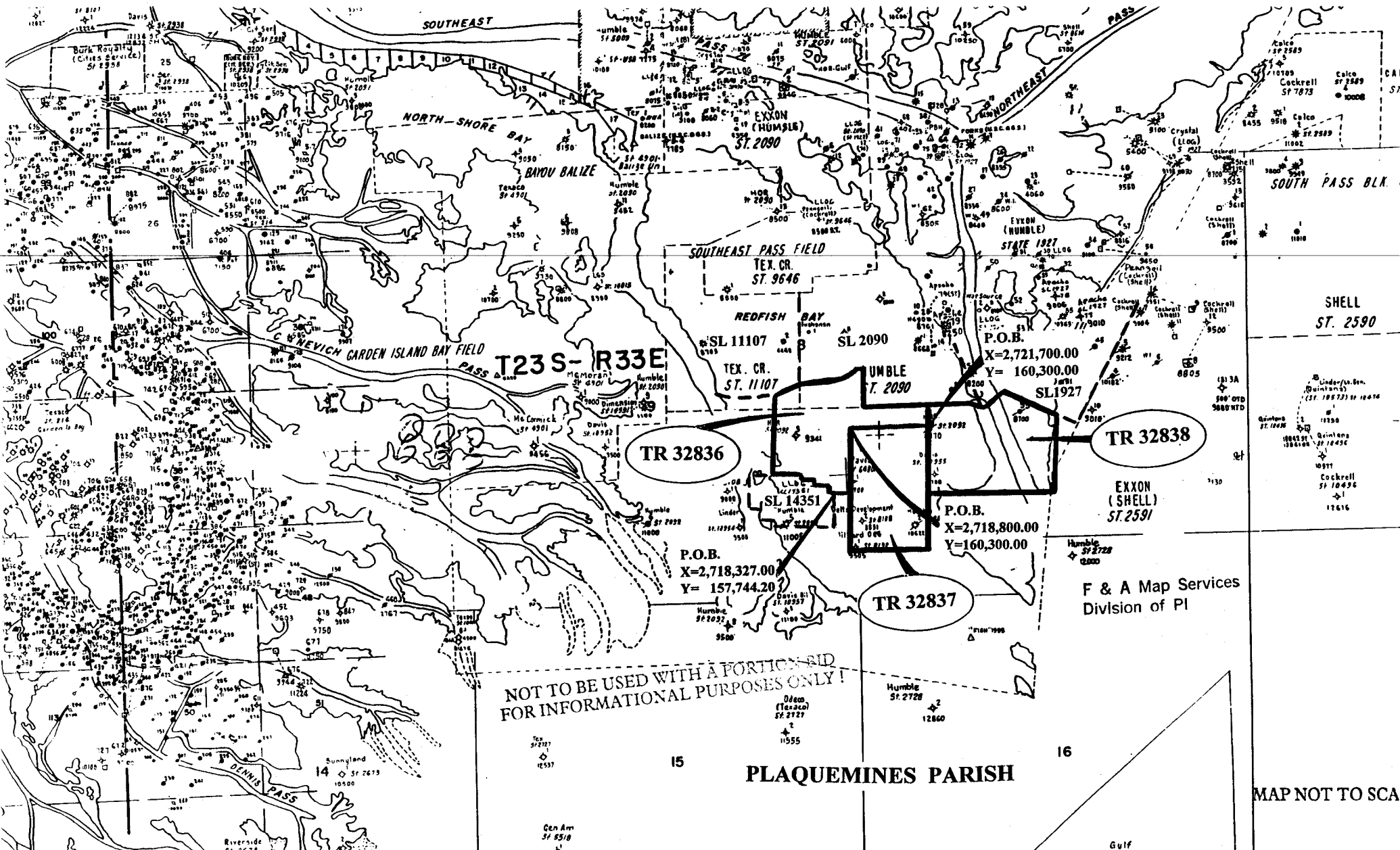

NOT TO BE USED WITH A PORTION-RID
FOR INFORMATIONAL PURPOSES ONLY!

TR 32836

TR 32838

TR 32837

P.O.B.
X=2,718,327.00
Y=157,744.20

P.O.B.
X=2,718,800.00
Y=160,300.00

EXXON
(SHELL)
ST. 2591

F & A Map Services
Division of PI

PLAQUEMINES PARISH

MAP NOT TO SCALE

TRACT 32836 - Plaquemines Parish, Louisiana

All state owned lands and water bottoms not under mineral lease on October 11, 2000, within the confines of the Pass-A-Loutre Wildlife Management Area as defined by the Department of Wildlife & Fisheries and included in a title opinion from the Office of the Governor, dated August 3, 1998, situated in Plaquemines Parish, Louisiana, within the following boundaries: Beginning at the most Eastern Northeast corner of State Lease No. 14351 having Coordinates of X = 2,718,327.00 and Y = 157,744.20; thence along the boundaries of said State Lease No. 14351 as follows: West 300.00 feet, North 300.00 feet, West 600.00 feet, North 200.00 feet, West 500.00 feet, North 200.00 feet and West 1,043.52 feet to a point having Coordinates of X = 2,715,883.48 and Y = 158,444.20; thence North approximately 3,220 feet to a point on the South line of State Lease No. 11107, as amended; thence Northeasterly along the South line of said State Lease No. 11107 to its Southeast corner and the most Western Southwest corner of the Southern portion of State Lease No. 2090, as amended; thence continue Northeasterly, East, South and East to a point on the South line of the Southern portion of said State Lease No. 2090 having a Coordinate of X = 2,721,700.00; thence South approximately 811 feet to a point having Coordinates of X = 2,721,700.00 and Y = 160,300.00; thence West 2,900.00 feet to a point having Coordinates of X = 2,718,800.00 and Y = 160,300.00; thence South 2,555.80 feet to a point having Coordinates of X = 2,718,800.00 and Y = 157,744.20; thence West 473.00 feet to the point of beginning, **LESS AND EXCEPT** any portion of State Lease No. 11107, as amended, and State Lease No. 2090, as amended, that may lie within the above described tract, also **LESS AND EXCEPT** any privately owned land that may be located within the above described tract containing approximately 347.91 acres, as shown outlined in red on a plat on file in the Office of Mineral Resources, Department of Natural Resources. All bearings, distances and coordinates are based on Louisiana Coordinate System of 1927 (South Zone).

- NOTE: No activities will be allowed without written authorization of the Louisiana Department of Wildlife and Fisheries.
- NOTE: Proposed projects will be evaluated on a case by case basis. Modifications to proposed project features including but not limited to access routes, spoil placement, well sites, flowlines and appurtenant structures may be required by the Louisiana Department of Wildlife and Fisheries.
- NOTE: Compliance with the Pass-A-Loutre WMA mineral regulations will be required unless otherwise specified by the Louisiana Department of Wildlife and Fisheries.
- NOTE: Compensatory mitigation will be required to offset unavoidable wetland impacts.
- NOTE: Removal of all structures, facilities and equipment will be required within 120 days of abandonment unless otherwise agreed to in writing by the Louisiana Department of Wildlife and Fisheries.
- NOTE: No activities will be allowed during the waterfowl season unless authorized by the Department.
- NOTE: Prior to submitting applications for wetland permits to Federal and State permitting agencies, the leaseholder shall coordinate project

details with the Louisiana Department Wildlife and Fisheries, Fur and Refuge Division. Contact person for the Department will be Mike Windham at (504) 568-5886.

NOTE: The Department will require a minimum bonus of \$350.00 per acre and a minimum royalty of 25%.

NOTE: The above tract is located in or near an oyster restricted area and all operations in such area must be conducted in strict conformity with the stipulations and/or regulations of the Louisiana Department of Wildlife and Fisheries.

NOTE: This tract is located within the Pass-A-Loutre Wildlife Management Area. Any operations on said tract shall be coordinated with the Louisiana Department of Wildlife and Fisheries. Special Rules and Regulations have been promulgated by the Louisiana Department of Wildlife and Fisheries for the protection of the game and wildlife for some management areas. Any lease awarded by the Board on said tract shall be subject to any applicable Rules and Regulations of said management area. Copies of these Rules and Regulations may be obtained from the Louisiana Department of Wildlife and Fisheries through the Assistant Secretary, Office of Wildlife, upon request.

NOTE: The State of Louisiana does hereby reserve, and this lease shall be subject to, the imprescriptible right of surface use in the nature of a servitude in favor of the Department of Natural Resources, including its Offices and Commissions, for the sole purpose of implementing, constructing, servicing and maintaining approved coastal zone management and/or restoration projects. Utilization of any and all rights derived under this lease by the mineral lessee, its agents, successors or assigns, shall not interfere with nor hinder the reasonable surface use by the Department of Natural Resources, its Offices or Commissions, as hereinabove reserved.

Applicant: Cypress Energy Corporation

Bidder	Cash Payment	Price / Acre	Rental	Oil	Gas	Other

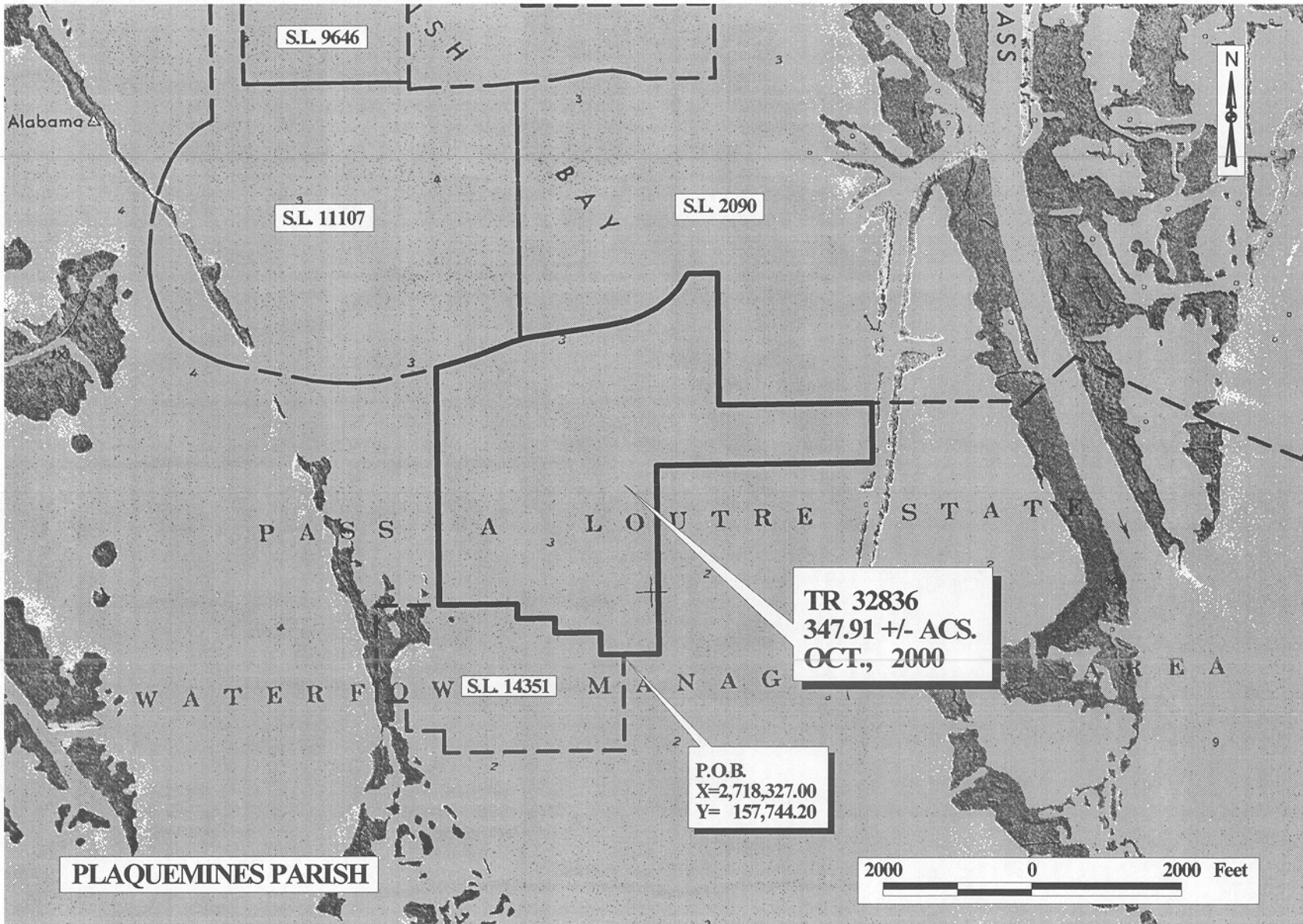

OFFICIAL COPY
OFFICE OF MINERAL RESOURCES
DEPT. OF NATURAL RESOURCES
DO NOT REMOVE

TRACT 32837 - Plaquemines Parish, Louisiana

All state owned lands and water bottoms not under mineral lease on October 11, 2000, within the confines of the Pass-A-Loutre Wildlife Management Area as defined by the Department of Wildlife & Fisheries and included in a title opinion from the Office of the Governor, dated August 3, 1998, situated in Plaquemines Parish, Louisiana, within the following boundaries: Beginning at a point having Coordinates of X = 2,718,800.00 and Y = 160,300.00; thence East 2,900.00 feet to a point having Coordinates of X = 2,721,700.00 and Y = 160,300.00; thence South 4,800.00 feet to a point having Coordinates of X = 2,721,700.00 and Y = 155,500.00; thence West 2,900.00 feet to a point having Coordinates of X = 2,718,800.00 and Y = 155,500.00; thence North 4,800.00 feet to the point of beginning, **LESS AND EXCEPT** any privately owned land that may be located within the above described tract containing approximately 319.56 acres, as shown outlined in red on a plat on file in the Office of Mineral Resources, Department of Natural Resources. All bearings, distances and coordinates are based on Louisiana Coordinate System of 1927 (South Zone).

- NOTE: No activities will be allowed without written authorization of the Louisiana Department of Wildlife and Fisheries.
- NOTE: Proposed projects will be evaluated on a case by case basis. Modifications to proposed project features including but not limited to access routes, spoil placement, well sites, flowlines and appurtenant structures may be required by the Louisiana Department of Wildlife and Fisheries.
- NOTE: Compliance with the Pass-A-Loutre WMA mineral regulations will be required unless otherwise specified by the Louisiana Department of Wildlife and Fisheries.
- NOTE: Compensatory mitigation will be required to offset unavoidable wetland impacts.
- NOTE: Removal of all structures, facilities and equipment will be required within 120 days of abandonment unless otherwise agreed to in writing by the Louisiana Department of Wildlife and Fisheries.
- NOTE: No activities will be allowed during the waterfowl season unless authorized by the Department.
- NOTE: Prior to submitting applications for wetland permits to Federal and State permitting agencies, the leaseholder shall coordinate project details with the Louisiana Department Wildlife and Fisheries, Fur and Refuge Division. Contact person for the Department will be Mike Windham at (504) 568-5886.
- NOTE: The Department will require a minimum bonus of \$350.00 per acre and a minimum royalty of 25%.
- NOTE: The above tract is located in or near an oyster restricted area and all operations in such area must be conducted in strict conformity with the stipulations and/or regulations of the Louisiana Department of Wildlife and Fisheries.

NOTE: This tract is located within the Pass-A-Loutre Wildlife Management Area. Any operations on said tract shall be coordinated with the Louisiana Department of Wildlife and Fisheries. Special Rules and Regulations have been promulgated by the Louisiana Department of Wildlife and Fisheries for the protection of the game and wildlife for some management areas. Any lease awarded by the Board on said tract shall be subject to any applicable Rules and Regulations of said management area. Copies of these Rules and Regulations may be obtained from the Louisiana Department of Wildlife and Fisheries through the Assistant Secretary, Office of Wildlife, upon request.

NOTE: The State of Louisiana does hereby reserve, and this lease shall be subject to, the imprescriptible right of surface use in the nature of a servitude in favor of the Department of Natural Resources, including its Offices and Commissions, for the sole purpose of implementing, constructing, servicing and maintaining approved coastal zone management and/or restoration projects. Utilization of any and all rights derived under this lease by the mineral lessee, its agents, successors or assigns, shall not interfere with nor hinder the reasonable surface use by the Department of Natural Resources, its Offices or Commissions, as hereinabove reserved.

Applicant: Cypress Energy Corporation

Bidder	Cash Payment	Price / Acre	Rental	Oil	Gas	Other

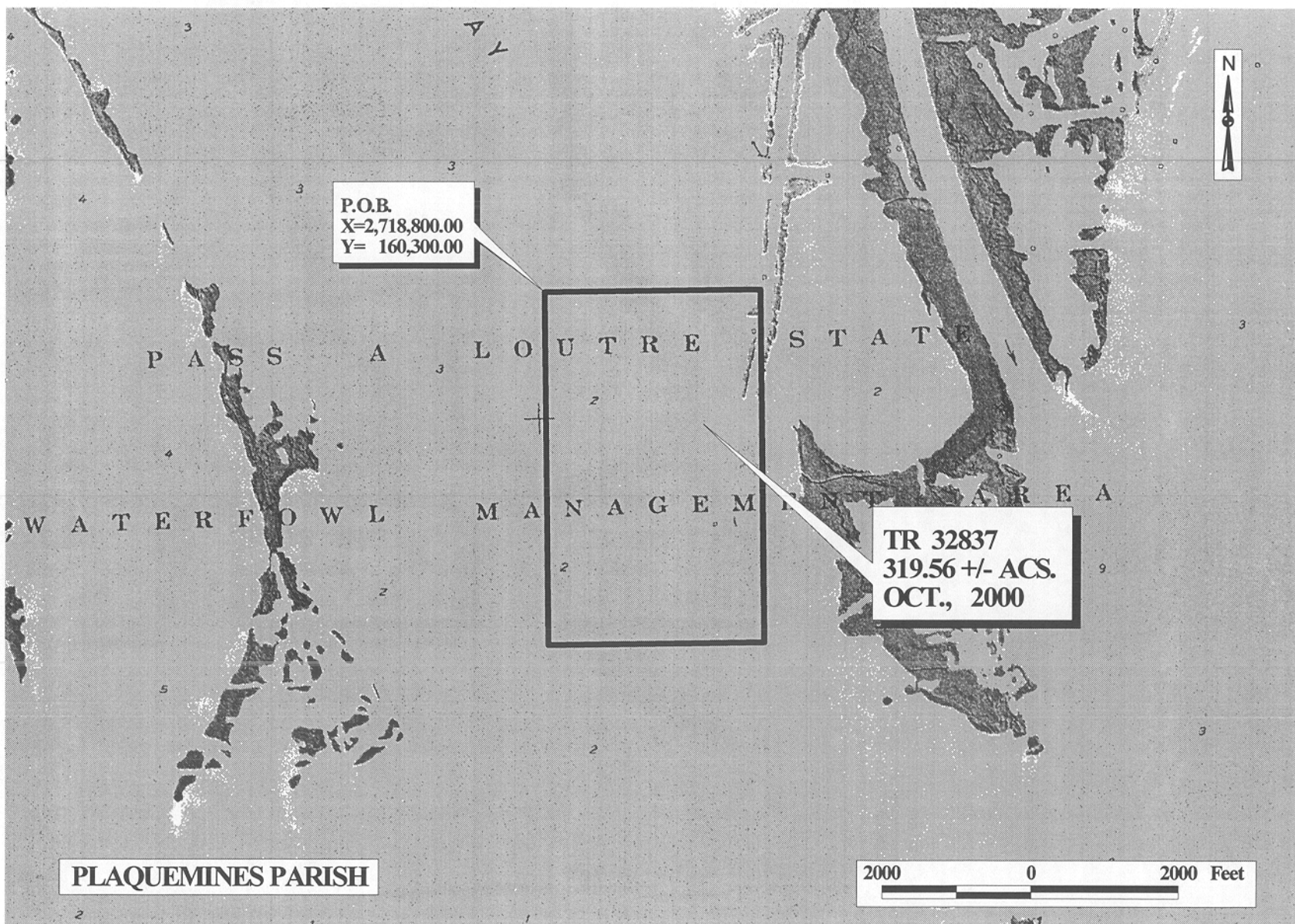

OFFICIAL COPY
OFFICE OF MINERAL RESOURCES
DEPT. OF NATURAL RESOURCES
DO NOT REMOVE

79

TRACT 32838 - Plaquemines Parish, Louisiana

All state owned lands and water bottoms not under mineral lease on October 11, 2000, within the confines of the Pass-A-Loutre Wildlife Management Area as defined by the Department of Wildlife & Fisheries and included in a title opinion from the Office of the Governor, dated August 3, 1998, situated in Plaquemines Parish, Louisiana, within the following boundaries: Beginning at a point having Coordinates of X = 2,721,700.00 and Y = 160,300.00; thence North approximately 810 feet to a point on the South line of the Southern portion of State Lease No. 2090, as amended; thence Easterly along the South line of the Southern portion of said State Lease No. 2090 to its Southeast corner and the Southwest corner of State Lease No. 1927, as amended; thence Southeasterly, Northeasterly and Southeasterly along the South line of said State Lease No. 1927 to a point having a Coordinate of X = 2,726,500.00; thence South approximately 2,927 feet to a point having Coordinates of X = 2,726,500.00 and Y = 157,744.20; thence West 4,800.00 feet to a point having Coordinates of X = 2,721,700.00 and Y = 157,744.20; thence North 2,555.80 feet to the point of beginning, **LESS AND EXCEPT** any portion of State Lease No. 2090, as amended, and State Lease No. 1927, as amended, that may lie within the above described tract, **LESS AND EXCEPT** any privately owned land that may be located within the above described tract containing approximately **379.43 acres**, as shown outlined in red on a plat on file in the Office of Mineral Resources, Department of Natural Resources. All bearings, distances and coordinates are based on Louisiana Coordinate System of 1927 (South Zone).

- NOTE: No activities will be allowed without written authorization of the Louisiana Department of Wildlife and Fisheries.
- NOTE: Proposed projects will be evaluated on a case by case basis. Modifications to proposed project features including but not limited to access routes, spoil placement, well sites, flowlines and appurtenant structures may be required by the Louisiana Department of Wildlife and Fisheries.
- NOTE: Compliance with the Pass-A-Loutre WMA mineral regulations will be required unless otherwise specified by the Louisiana Department of Wildlife and Fisheries.
- NOTE: Compensatory mitigation will be required to offset unavoidable wetland impacts.
- NOTE: Removal of all structures, facilities and equipment will be required within 120 days of abandonment unless otherwise agreed to in writing by the Louisiana Department of Wildlife and Fisheries.
- NOTE: No activities will be allowed during the waterfowl season unless authorized by the Department.
- NOTE: Prior to submitting applications for wetland permits to Federal and State permitting agencies, the leaseholder shall coordinate project details with the Louisiana Department Wildlife and Fisheries, Fur and Refuge Division. Contact person for the Department will be Mike Windham at (504) 568-5886.
- NOTE: The Department will require a minimum bonus of \$350.00 per acre and

a minimum royalty of 25%.

NOTE: The above tract is located in or near an oyster restricted area and all operations in such area must be conducted in strict conformity with the stipulations and/or regulations of the Louisiana Department of Wildlife and Fisheries.

NOTE: This tract is located within the Pass-A-Loutre Wildlife Management Area. Any operations on said tract shall be coordinated with the Louisiana Department of Wildlife and Fisheries. Special Rules and Regulations have been promulgated by the Louisiana Department of Wildlife and Fisheries for the protection of the game and wildlife for some management areas. Any lease awarded by the Board on said tract shall be subject to any applicable Rules and Regulations of said management area. Copies of these Rules and Regulations may be obtained from the Louisiana Department of Wildlife and Fisheries through the Assistant Secretary, Office of Wildlife, upon request.

NOTE: The State of Louisiana does hereby reserve, and this lease shall be subject to, the imprescriptible right of surface use in the nature of a servitude in favor of the Department of Natural Resources, including its Offices and Commissions, for the sole purpose of implementing, constructing, servicing and maintaining approved coastal zone management and/or restoration projects. Utilization of any and all rights derived under this lease by the mineral lessee, its agents, successors or assigns, shall not interfere with nor hinder the reasonable surface use by the Department of Natural Resources, its Offices or Commissions, as hereinabove reserved.

Applicant: Cypress Energy Corporation

Bidder	Cash Payment	Price / Acre	Rental	Oil	Gas	Other

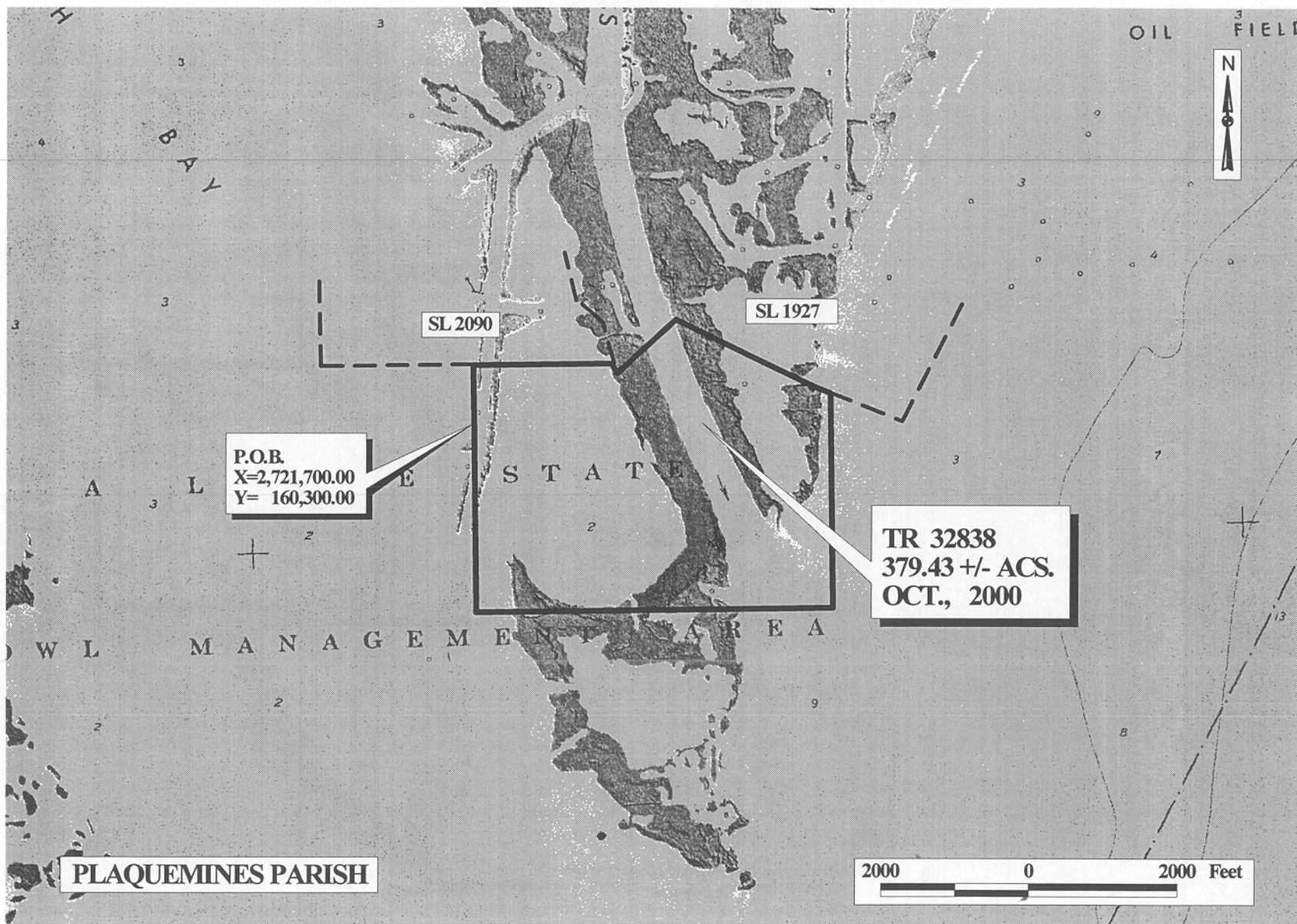

OFFICIAL COPY
OFFICE OF MINERAL RESOURCES
DEPT. OF NATURAL RESOURCES
DO NOT REMOVE