

**STATE
AGENCY
TRACTS**

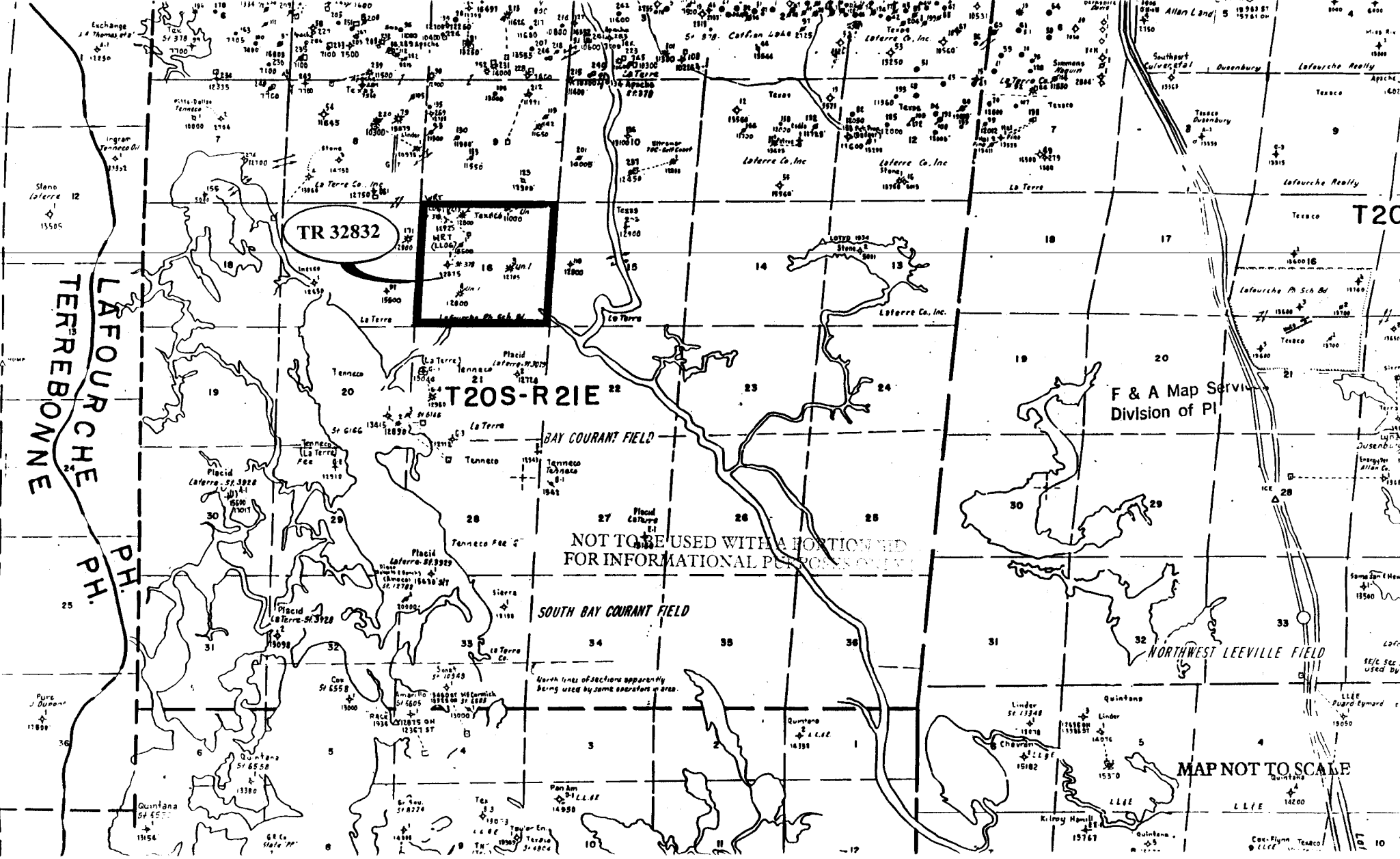

TR 32832

T20S-R21E

LAFOURCHE
TERRERBONNE
PH.

NOT TO BE USED WITH A PORTIONED
FOR INFORMATIONAL PURPOSES ONLY

F & A Map Service
Division of PI

MAP NOT TO SCALE

TRACT 32832 - STATE AGENCY - Lafourche Parish, Louisiana

The State Mineral Board acting on behalf of the Lafourche Parish School Board, pursuant to Resolution adopted by that body and in accordance with Louisiana Revised Statutes 30:121-136 and 151-156, as amended, and Article 12, Section 18 of the Louisiana Constitution of 1921, as amended, which by Section 16 (A) 9, and 16 (B) of Article XIV of the 1974 Constitution is continued as a statute subject to arrangement in proper statutory form or modification provided by law, advertises the following described lands not under mineral lease on October 11, 2000: All of Section 16, Township 20 South, Range 21 East, Lafourche Parish, Louisiana, excluding beds and bottoms of all navigable waters located in said section, containing approximately **640 acres**, as shown outlined in red on a plat on file in the Office of Mineral Resources, Department of Natural Resources.

NOTE: Lessor will accept not less than one-fourth royalties on all minerals.

NOTE: Lessor will require all royalties to be paid on "current market value" for all hydrocarbons.

NOTE: The Lessee shall conduct its operations in such a manner as to reasonably minimize any interference with or disruption of Lessor's use of the surface of the leased property or its use by Lessor's Lessees of hunting, trapping and/or pasturage rights.

NOTE: The above tract is located in or near an oyster restricted area and all operations in such area must be conducted in strict conformity with the stipulations and/or regulations of the Louisiana Department of Wildlife and Fisheries.

NOTE: The State of Louisiana does hereby reserve, and this lease shall be subject to, the imprescriptible right of surface use in the nature of a servitude in favor of the Department of Natural Resources, including its Offices and Commissions, for the sole purpose of implementing, constructing, servicing and maintaining approved coastal zone management and/or restoration projects. Utilization of any and all rights derived under this lease by the mineral lessee, its agents, successors or assigns, shall not interfere with nor hinder the reasonable surface use by the Department of Natural Resources, its Offices or Commissions, as hereinabove reserved.

Applicant: Leslie L. Moore to Agency and by Resolution from the Lafourche Parish School Board authorizing the Mineral Board to act in its behalf.

Bidder	Cash Payment	Price / Acre	Rental	Oil	Gas	Other

TR 32832
640 +/- ACS.
OCT., 2000

SEC. 16

T 20 S R 21 E
LAFOURCHE PARISH

OFFICIAL COPY
OFFICE OF WILDLIFE RESOURCES
DEPT. OF NATURAL RESOURCES
DO NOT REMOVE

2000 0 2000 Feet

