

IBERVILLE PARISH

P.O.B.  
X=1,918,880.00  
Y=631,480.00

TR 32812

NOT TO BE USED WITH A PORTION RIB  
FOR INFORMATIONAL PURPOSES ONLY

MAP NOT TO SCALE

**TRACT 32812 - Iberville Parish, Louisiana**

All of the lands now or formerly constituting the beds and bottoms of all water bodies of every nature and description and all islands and other lands formed by accretion or reliction, except tax lands, owned by and not under mineral lease from the State of Louisiana on October 11, 2000, situated in Iberville Parish, Louisiana, within the following described boundaries: Beginning at the Northwest corner of State Lease No. 16746, said point also located on the South boundary of State Lease No. 16742 having Coordinates of X = 1,918,880.00 and Y = 631,480.00; thence South 14,000.00 feet along the West boundary of said State Lease No. 16746 to its Southwest corner, also being the Northeast corner of State Lease No. 16750, having Coordinates of X = 1,918,880.00 and Y = 617,480.00; thence West 7,200.00 feet along the North boundary of said State Lease No. 16750 to the Southeast corner of State Lease No. 16745 having Coordinates of X = 1,911,680.00 and Y = 617,480.00; thence North 14,000.00 feet along the East boundary of said State Lease No. 16745 to its Northeast corner located on the South boundary of State Lease No. 16741 having Coordinates of X = 1,911,680.00 and Y = 631,480.00; thence East 1,720.00 feet along the South boundary of said State Lease No. 16741 to its Southeast corner, also being the Southwest corner of said State Lease No. 16742; thence East 5,480.00 feet along the South boundary of said State Lease No. 16742 to the point of beginning, containing approximately 26 acres, as shown outlined in red on a plat on file in the Office of Mineral Resources, Department of Natural Resources. All bearings, distances and coordinates are based on Louisiana Coordinate System of 1927 (South Zone).

Applicant: A.S. Ruffin, Jr.

Bidder	Cash Payment	Price / Acre	Rental	Oil	Gas	Other

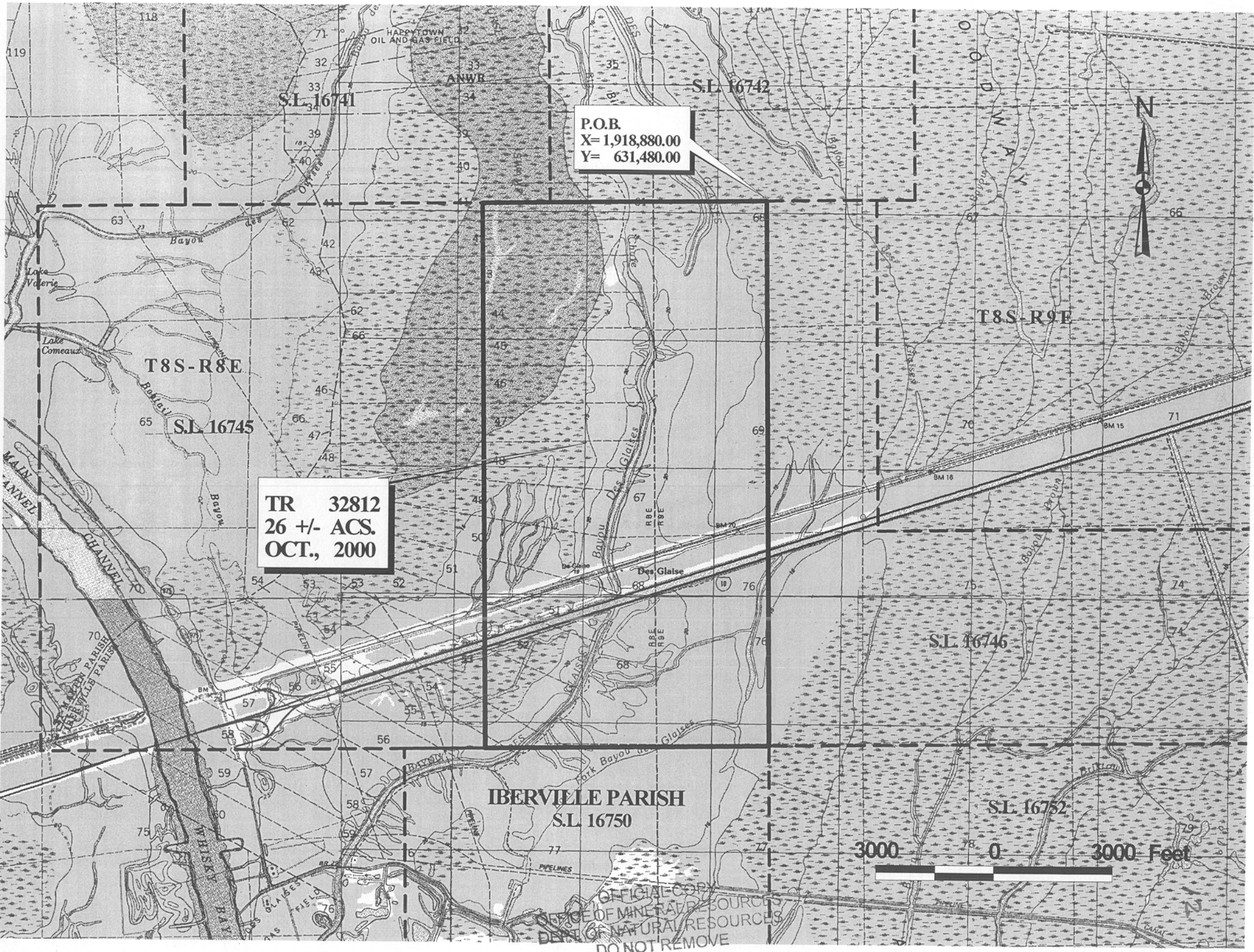

S.L. 16741

S.L. 16742

P.O.B.  
X= 1,918,880.00  
Y= 631,480.00

T8S-R8E

T8S-R9E

S.L. 16745

TR 32812  
26 +/- ACS.  
OCT., 2000

S.L. 16746

IBERVILLE PARISH  
S.L. 16750

S.L. 16752



OFFICIAL COPY  
STATE OF LOUISIANA  
DEPARTMENT OF NATURAL RESOURCES  
DO NOT REMOVE

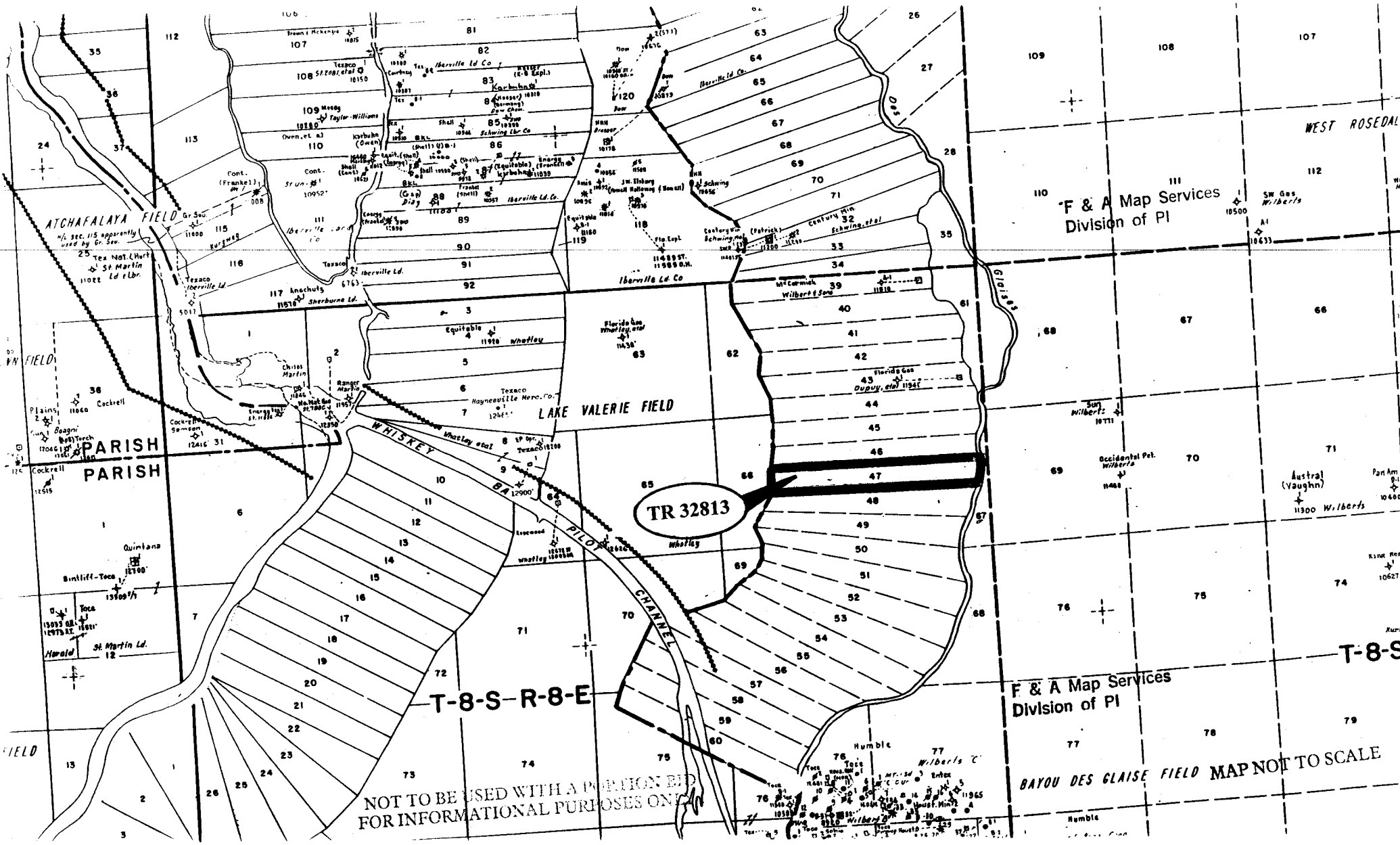

**TRACT 32813 - Iberville Parish, Louisiana**

All of the right, title and interest of the State of Louisiana in and to the land owned by and not under mineral lease from the State of Louisiana on October 11, 2000, situated in Iberville Parish, Louisiana, and being more fully described as follows: All of Section 47, Township 8 South, Range 8 East, Iberville Parish, Louisiana, containing approximately 163.77 acres, as shown outlined in red on a plat on file in the Office of Mineral Resources, Department of Natural Resources.

Applicant: Albert S. Ruffin, Jr.

Bidder	Cash Payment	Price / Acre	Rental	Oil	Gas	Other



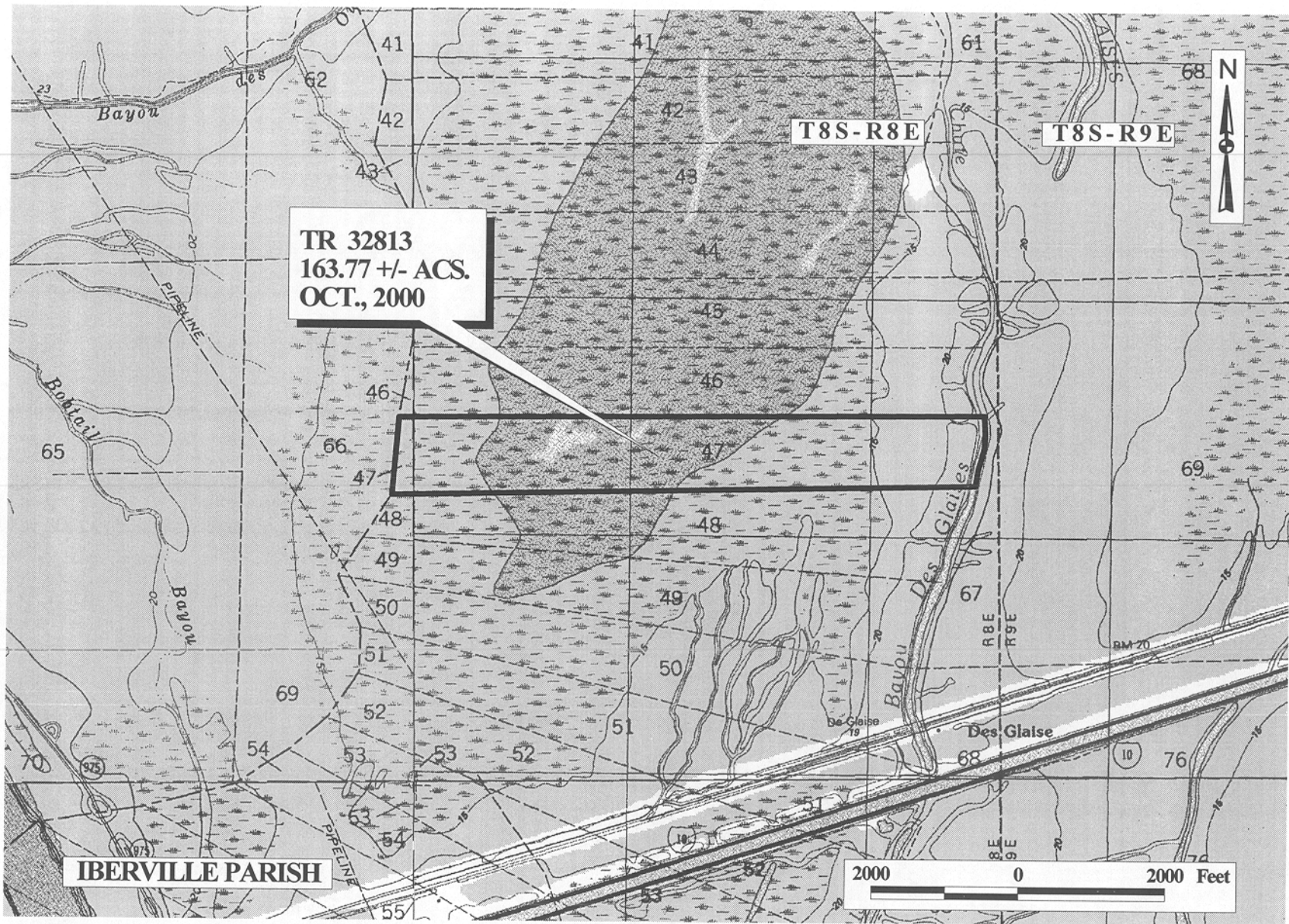

OFFICIAL COPY  
 OFFICE OF MINERAL RESOURCES  
 DEPT. OF NATURAL RESOURCES  
 DO NOT REMOVE