

**WHITE LAKE**

**TRACTS**

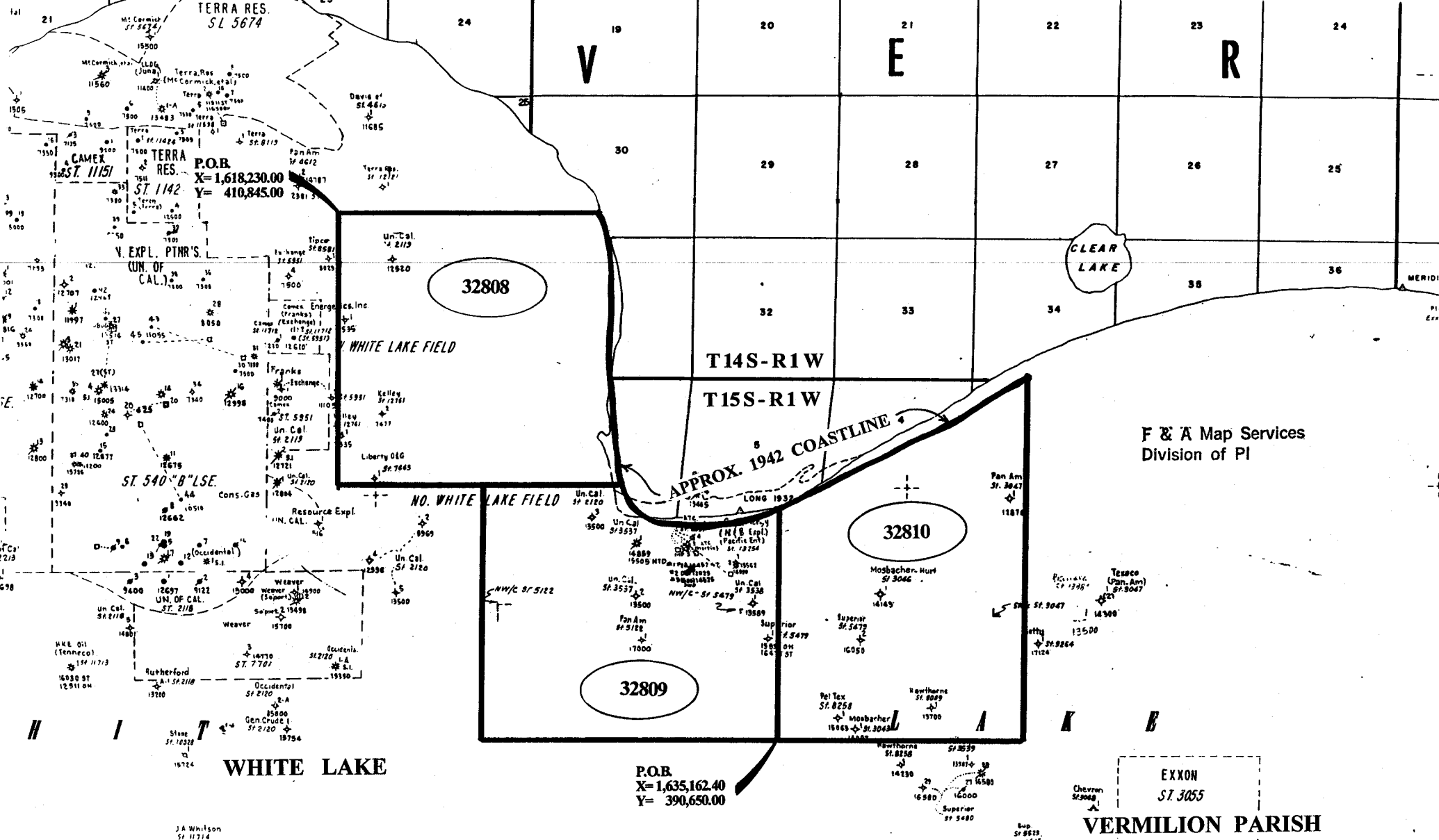

MAP NOT TO SCALE

NOT TO BE USED WITH A PORTION BID  
FOR INFORMATIONAL PURPOSES ONLY!

**TRACT 32808 - Vermilion Parish, Louisiana**

A portion of the entirety of the beds and bottoms embraced within the meanders of White Lake as the same presently exists and not under mineral lease on September 13, 2000, located in any parts of Township 14 South, Ranges 1, 2 and 3 West and 1 East, and Township 15 South, Ranges 1, 2 and 3 West and 1 East, all in Vermilion Parish, Louisiana, (subject to the understanding that: "Nothing herein shall affect the rights if any, of any person who may claim title to any portion of what was formerly land adjoining White Lake and which is now water-covered because of erosion"), which area, for all purposes of said lease, shall be considered to comprise 50,000 acres, whether it actually comprises more or less and more specifically described as follows: Beginning at a point having Coordinates of X = 1,618,230.00 and Y = 410,845.00; thence East approximately 9,960 feet to the point of intersection with the 1942 coastline of White Lake; thence Southerly along said coastline to its point of intersection with an East-West line having a Coordinate of Y = 400,464.20; thence West approximately 10,960 feet to a point having Coordinates of X = 1,618,230.00 and Y = 400,464.20; thence North 10,380.80 feet to the point of beginning, containing approximately 2,490 acres, as shown outlined in red on a plat on file in the Office of Mineral Resources, Department of Natural Resources. All bearings, distances and coordinates are based on Louisiana Coordinate System of 1927 (South Zone).

NOTE: A total aggregate royalty for the State Lease and the required private lease for this tract shall be a minimum of 25%. The State Lease will also contain a provision that at the end of the primary term of the Lease, the Lessee will release all right, title and interest in the Lease as to all depths 100 feet below the deepest producing formation on each respective lease at the time of expiration or deepest formation behind pipe capable of producing on each respective lease at expiration.

NOTE: The State of Louisiana does hereby reserve, and this lease shall be subject to, the imprescriptible right of surface use in the nature of a servitude in favor of the Department of Natural Resources, including its Offices and Commissions, for the sole purpose of implementing, constructing, servicing and maintaining approved coastal zone management and/or restoration projects. Utilization of any and all rights derived under this lease by the mineral lessee, its agents, successors or assigns, shall not interfere with nor hinder the reasonable surface use by the Department of Natural Resources, its Offices or Commissions, as hereinabove reserved.

Applicant: Harold J. Anderson, Inc.

Bidder	Cash Payment	Price / Acre	Rental	Oil	Gas	Other



P.O.B.  
X= 1,618,230.00  
Y= 410,845.00

TR 32808  
2490 +/- ACS.  
SEPT., 2000

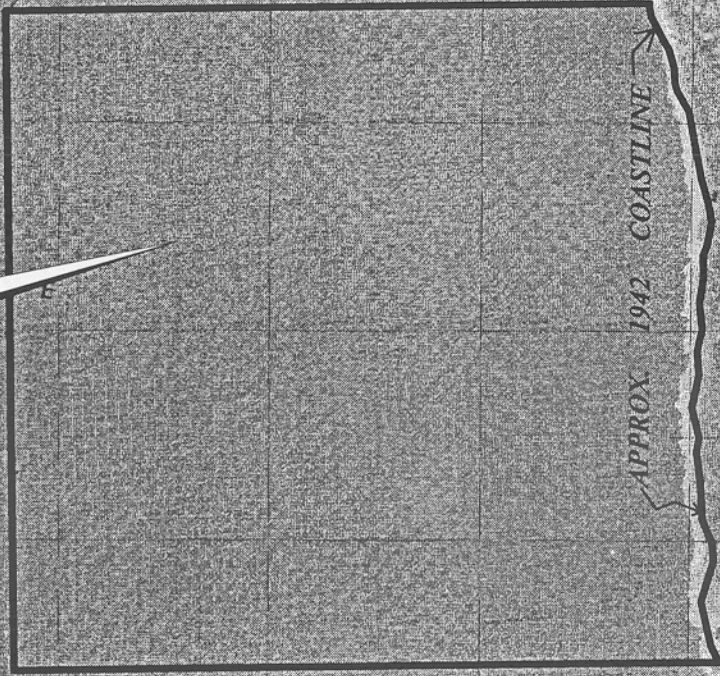

OFFICIAL COPY  
OFFICE OF MINERAL RESOURCES  
DEPT. OF NATURAL RESOURCES  
DO NOT REMOVE

T14S-R1W

T15S-R1W

OFFICIAL COPY  
OFFICE OF MINERAL RESOURCES  
DEPT. OF NATURAL RESOURCES  
DO NOT REMOVE

VERMILION PARISH

WHITE LAKE



**TRACT 32809 - Vermilion Parish, Louisiana**

A portion of the entirety of the beds and bottoms embraced within the meanders of White Lake as the same presently exists and not under mineral lease on September 13, 2000, located in any parts of Township 14 South, Ranges 1, 2 and 3 West and 1 East, and Township 15 South, Ranges 1, 2 and 3 West and 1 East, all in Vermilion Parish, Louisiana, (subject to the understanding that: "Nothing herein shall affect the rights if any, of any person who may claim title to any portion of what was formerly land adjoining White Lake and which is now water-covered because of erosion"), which area, for all purposes of said lease, shall be considered to comprise 50,000 acres, whether it actually comprises more or less and more specifically described as follows: Beginning at a point having Coordinates of X = 1,635,162.40 and Y = 390,650.00; thence West 11,370.00 feet to a point having Coordinates of X = 1,623,792.40 and Y = 390,650.00; thence North 9,814.20 feet to a point having Coordinates of X = 1,623,792.40 and Y = 400,464.20; thence East approximately 5,400 feet to a point on the 1942 coastline of White Lake having a Coordinate of Y = 400,464.20; thence Southerly, Southeasterly and Easterly along the said coastline to its intersection with a North-South line having a Coordinate of X = 1,635,162.40; thence South approximately 8,865 feet to the point of beginning, containing approximately 2,390 acres, as shown outlined in red on a plat on file in the Office of Mineral Resources, Department of Natural Resources. All bearings, distances and coordinates are based on Louisiana Coordinate System of 1927 (South Zone).

NOTE: A total aggregate royalty for the State Lease and the required private lease for this tract shall be a minimum of 25%. The State Lease will also contain a provision that at the end of the primary term of the Lease, the Lessee will release all right, title and interest in the Lease as to all depths 100 feet below the deepest producing formation on each respective lease at the time of expiration or deepest formation behind pipe capable of producing on each respective lease at expiration.

NOTE: The State of Louisiana does hereby reserve, and this lease shall be subject to, the imprescriptible right of surface use in the nature of a servitude in favor of the Department of Natural Resources, including its Offices and Commissions, for the sole purpose of implementing, constructing, servicing and maintaining approved coastal zone management and/or restoration projects. Utilization of any and all rights derived under this lease by the mineral lessee, its agents, successors or assigns, shall not interfere with nor hinder the reasonable surface use by the Department of Natural Resources, its Offices or Commissions, as hereinabove reserved.

Applicant: Harold J. Anderson, Inc.

Bidder	Cash Payment	Price / Acre	Rental	Oil	Gas	Other

T14S-R1W

T15S-R1W

APPROX. 1942 COASTLINE

TR 32809  
2390 +/- ACS.  
SEPT., 2000

P.O.B.  
X= 1,635,162.40  
Y= 390,650.00

VERMILLION PARISH

WHITE LAKE



OFFICIAL COPY  
OFFICE OF MINERAL RESOURCES  
DEPT. OF NATURAL RESOURCES  
DO NOT REMOVE

**TRACT 32810 - Vermilion Parish, Louisiana**

A portion of the entirety of the beds and bottoms embraced within the meanders of White Lake as the same presently exists and not under mineral lease on September 13, 2000, located in any parts of Township 14 South, Ranges 1, 2 and 3 West and 1 East, and Township 15 South, Ranges 1, 2 and 3 West and 1 East, all in Vermilion Parish, Louisiana, (subject to the understanding that: "Nothing herein shall affect the rights if any, of any person who may claim title to any portion of what was formerly land adjoining White Lake and which is now water-covered because of erosion"), which area, for all purposes of said lease, shall be considered to comprise 50,000 acres, whether it actually comprises more or less and more specifically described as follows: Beginning at a point having Coordinates of X = 1,635,162.40 and Y = 390,650.00; thence North approximately 8,865 feet to a point on the 1942 coastline of White Lake having a Coordinate of X = 1,635,162.40; thence Northeasterly along the said coastline to its intersection with a North-South line having a Coordinate of X = 1,644,565.13; thence South approximately 14,220 feet to a point having Coordinates of X = 1,644,565.13 and Y = 390,650.00; thence West 9,402.73 feet to the point of beginning, containing approximately 2,490 acres, as shown outlined in red on a plat on file in the Office of Mineral Resources, Department of Natural Resources. All bearings, distances and coordinates are based on Louisiana Coordinate System of 1927 (South Zone).

NOTE: A total aggregate royalty for the State Lease and the required private lease for this tract shall be a minimum of 25%. The State Lease will also contain a provision that at the end of the primary term of the Lease, the Lessee will release all right, title and interest in the Lease as to all depths 100 feet below the deepest producing formation on each respective lease at the time of expiration or deepest formation behind pipe capable of producing on each respective lease at expiration.

NOTE: The State of Louisiana does hereby reserve, and this lease shall be subject to, the imprescriptible right of surface use in the nature of a servitude in favor of the Department of Natural Resources, including its Offices and Commissions, for the sole purpose of implementing, constructing, servicing and maintaining approved coastal zone management and/or restoration projects. Utilization of any and all rights derived under this lease by the mineral lessee, its agents, successors or assigns, shall not interfere with nor hinder the reasonable surface use by the Department of Natural Resources, its Offices or Commissions, as hereinabove reserved.

Applicant: Harold J. Anderson, Inc.

Bidder	Cash Payment	Price / Acre	Rental	Oil	Gas	Other

Clear Lake



T14S-R1W

T15S-R1W

APPROX. 1942 COASTLINE

TR 32810  
2490+/- ACS.  
SEPT., 2000

P.O.B.  
X= 1,635,162.40  
Y= 390,650.00

OFFICIAL COPY  
OFFICE OF MINERAL RESOURCES  
DEPT. OF NATURAL RESOURCES  
DO NOT REMOVE

WHITE LAKE

VERMILION PARISH

3000 0 3000 Feet

