

MAP NOT TO SCALE

NOT TO BE USED WITH A PORTION EID
FOR INFORMATIONAL PURPOSES ONLY!

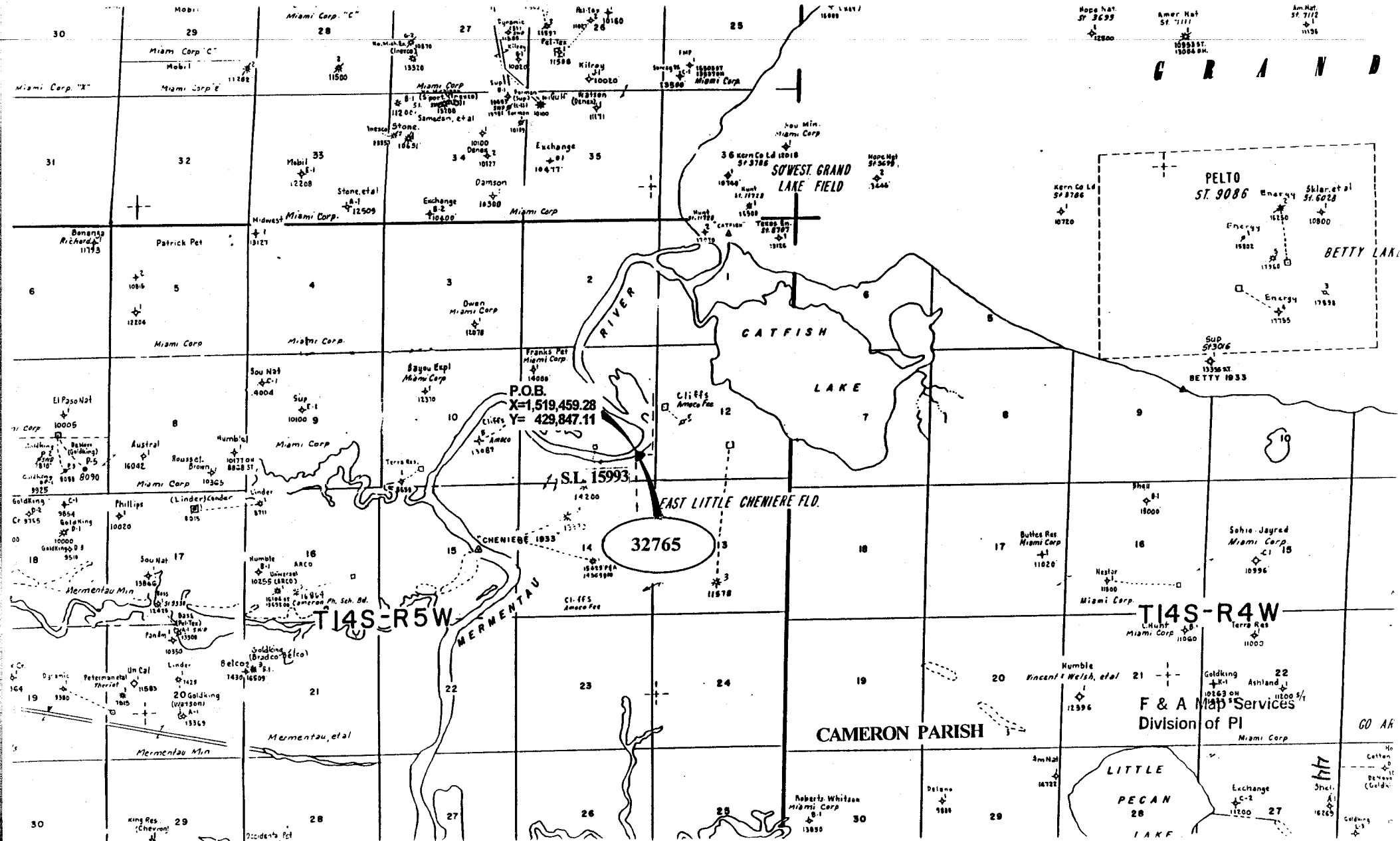

TRACT 32765 - Cameron Parish, Louisiana

All of the lands now or formerly constituting the beds and bottoms of all water bodies of every nature and description and all islands and other lands formed by accretion or reliction, except tax lands, owned by and not under mineral lease from the State of Louisiana on September 13, 2000, situated in Cameron Parish, Louisiana, within the following described boundaries: Beginning at a corner of State Lease No. 15993 having Coordinates of X = 1,519,459.28 and Y = 429,847.11; thence South 88 degrees 33 minutes 21 seconds East 170.82 feet along a Southern boundary of said State Lease No. 15993 to a point having Coordinates of X = 1,519,630.04 and Y = 429,842.80; thence South 61 degrees 52 minutes 50 seconds West 196.38 feet to a point on the Eastern boundary of said State Lease No. 15993 having Coordinates of X = 1,519,456.84 and Y = 429,750.24; thence North 01 degrees 26 minutes 39 seconds East 96.89 feet along the Eastern boundary of said State Lease No. 15993 to the point of beginning, containing approximately 0.19 acres, as shown outlined in red on a plat on file in the Office of Mineral Resources, Department of Natural Resources. All bearings, distances and coordinates are based on Louisiana Coordinate System of 1927 (South Zone).

NOTE: The State of Louisiana does hereby reserve, and this lease shall be subject to, the imprescriptible right of surface use in the nature of a servitude in favor of the Department of Natural Resources, including its Offices and Commissions, for the sole purpose of implementing, constructing, servicing and maintaining approved coastal zone management and/or restoration projects. Utilization of any and all rights derived under this lease by the mineral lessee, its agents, successors or assigns, shall not interfere with nor hinder the reasonable surface use by the Department of Natural Resources, its Offices or Commissions, as hereinabove reserved.

Applicant: Rebel Minerals, Inc.

Bidder	Cash Payment	Price / Acre	Rental	Oil	Gas	Other

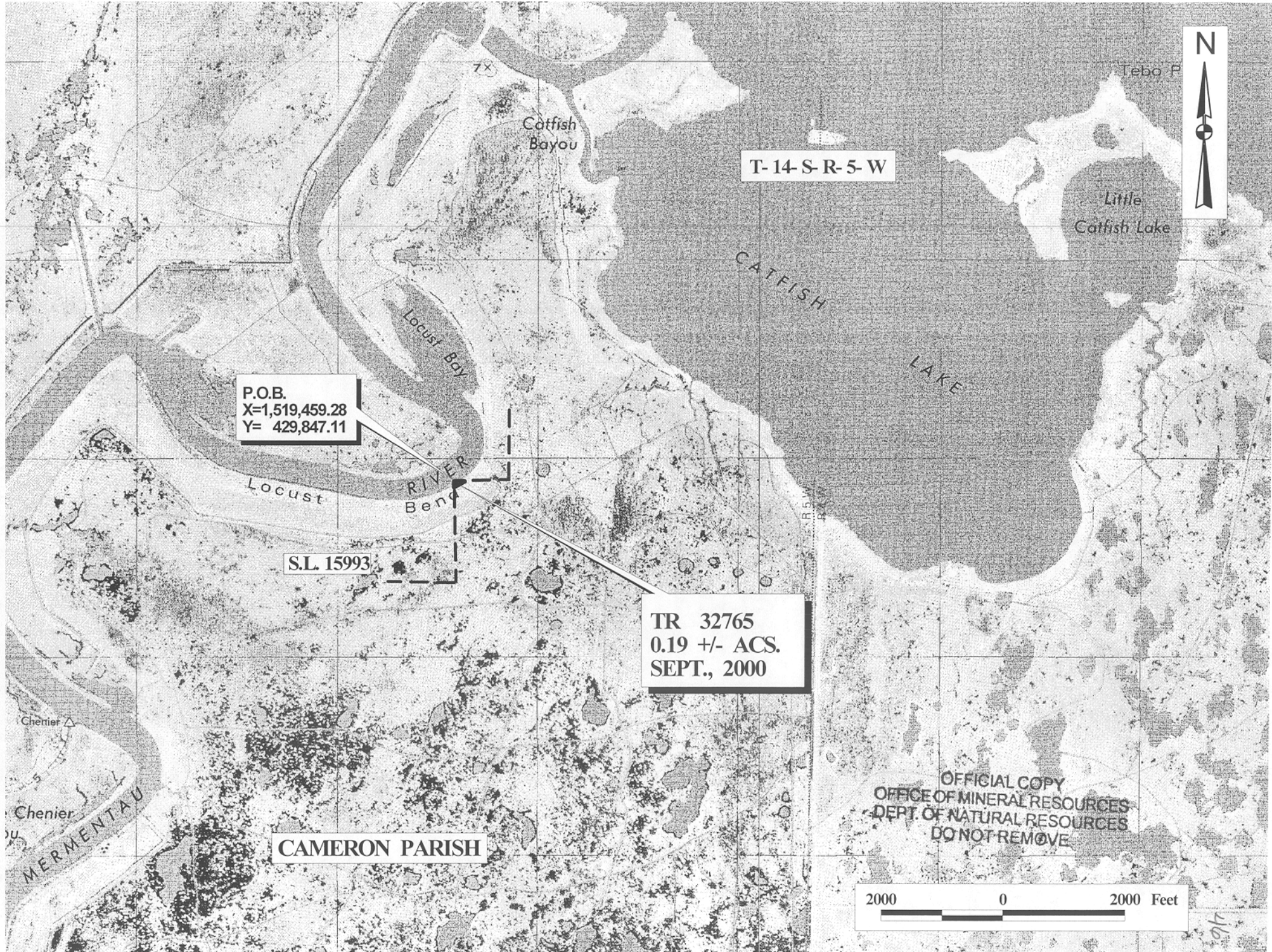

T-14-S-R-5-W

P.O.B.
X=1,519,459.28
Y= 429,847.11

S.L. 15993

TR 32765
0.19 +/- ACS.
SEPT., 2000

CAMERON PARISH

OFFICIAL COPY
OFFICE OF MINERAL RESOURCES
DEPT. OF NATURAL RESOURCES
DO NOT REMOVE

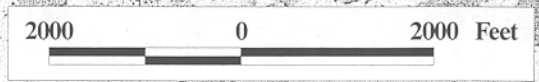

1/16

MAP NOT TO SCALE

NOT TO BE USED WITH A PORTION BID
FOR INFORMATIONAL PURPOSES ONLY!

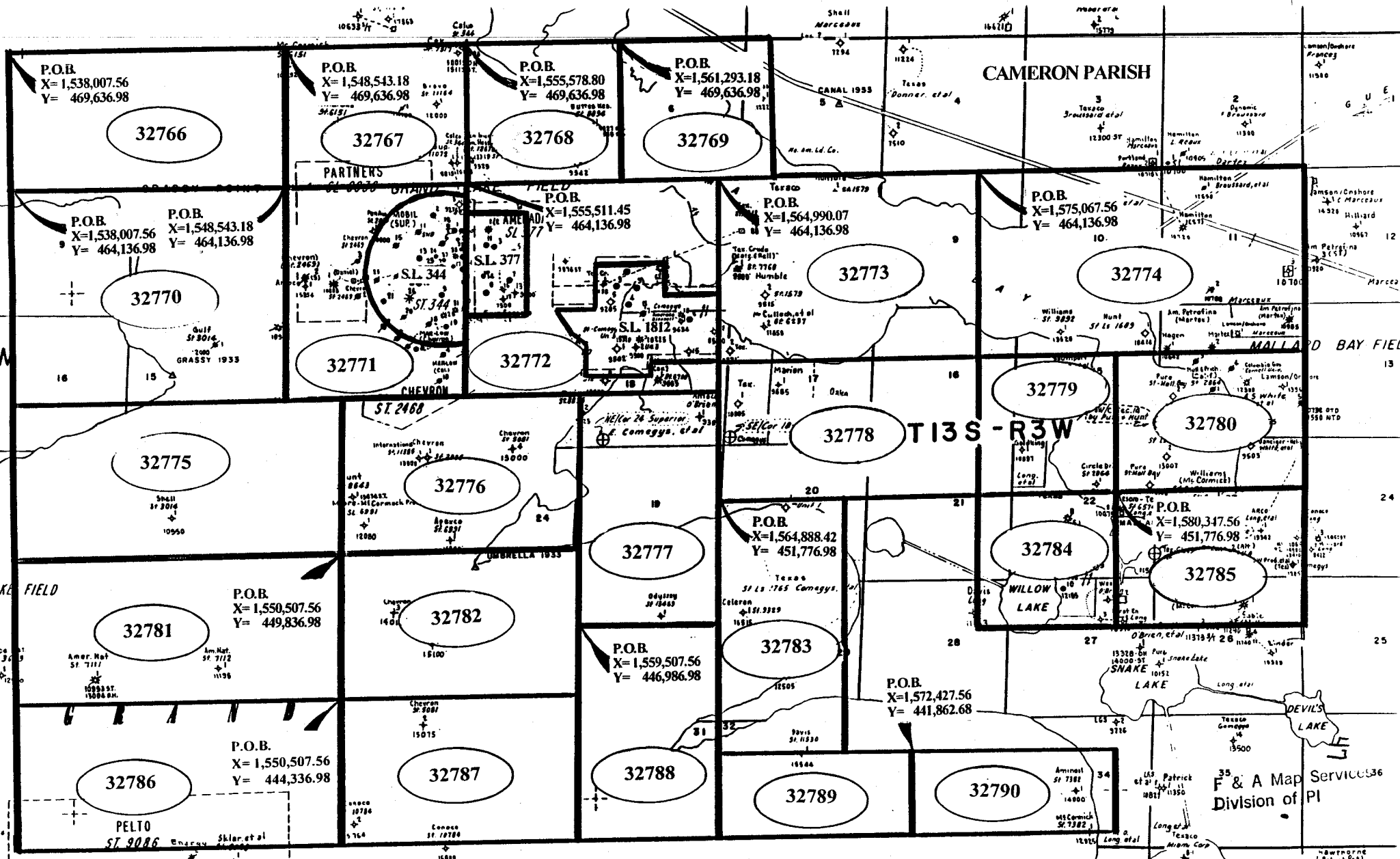

F & A Map Services
Division of PI

TRACT 32766 - Cameron Parish, Louisiana

All of the lands now or formerly constituting the beds and bottoms of all water bodies of every nature and description and all islands and other lands formed by accretion or reliction, except tax lands, owned by and not under mineral lease from the State of Louisiana on September 13, 2000, situated in Cameron Parish, Louisiana, within the following described boundaries: Beginning at a point having Coordinates of X = 1,538,007.56 and Y = 469,636.98; thence East 10,535.62 feet to a point having Coordinates of X = 1,548,543.18 and Y = 469,636.98; thence South 5,500.00 feet to a point having Coordinates of X = 1,548,543.18 and Y = 464,136.98; thence West 10,535.62 feet to a point having Coordinates of X = 1,538,007.56 and Y = 464,136.98; thence North 5,500.00 feet to the point of beginning, containing approximately **1,330.26 acres**, as shown outlined in red on a plat on file in the Office of Mineral Resources, Department of Natural Resources. All bearings, distances and coordinates are based on Louisiana Coordinate System of 1927 (South Zone).

NOTE: The State of Louisiana does hereby reserve, and this lease shall be subject to, the imprescriptible right of surface use in the nature of a servitude in favor of the Department of Natural Resources, including its Offices and Commissions, for the sole purpose of implementing, constructing, servicing and maintaining approved coastal zone management and/or restoration projects. Utilization of any and all rights derived under this lease by the mineral lessee, its agents, successors or assigns, shall not interfere with nor hinder the reasonable surface use by the Department of Natural Resources, its Offices or Commissions, as hereinabove reserved.

Applicant: Stephen M. Jenkins & Associates, Inc.

Bidder	Cash Payment	Price / Acre	Rental	Oil	Gas	Other

P.O.B.
X= 1,538,007.56
Y= 469,636.98

TR 32766
1,330.26 +/- ACS.
SEPT., 2000

G
R
A
Z
D

Negro Island

Pits

X12



Grassy Point

CAMERON PARISH

Flat Ridge

Wild Ridge

OFFICIAL COPY
OFFICE OF MINERAL RESOURCES
DEPT. OF NATURAL RESOURCES
DO NOT REMOVE



Platform

57