

**TRACT 40048 - De Soto Parish, LOUISIANA**

All land, LESS AND EXCEPT land now or formerly constituting the beds and bottoms of any water body of whatever description and nature, all belonging to the State of Louisiana located within the geographical boundaries of the (WMA) and not presently under mineral lease by the State of Louisiana as of August 13, 2008, the area of which is set forth as follows: Beginning at a point on the East boundary of State Agency Lease No. 19182 having Coordinates of X = 1,661,898.48 and Y = 560,032.00; thence East 3,506.11 feet to a point having Coordinates of X = 1,665,404.59 and Y = 560,032.00; thence South 68 degrees 50 minutes 31 seconds East 417.56 feet to a point having Coordinates of X = 1,665,794.00 and Y = 559,881.29; thence South 1,220.00 feet to a point having Coordinates of X = 1,665,794.00 and Y = 558,661.29; thence East 1,146.77 feet to a point having Coordinates of X = 1,666,940.77 and Y = 558,661.29; thence South 04 degrees 22 minutes 12 seconds East 1,287.00 feet to a point having Coordinates of X = 1,667,038.83 and Y = 557,378.02; thence South 03 degrees 54 minutes 03 seconds East 2,598.20 feet to a point having Coordinates of X = 1,667,215.59 and Y = 554,785.84; thence South 23 degrees 50 minutes 31 seconds West 178.20 feet to a point having Coordinates of X = 1,667,143.56 and Y = 554,622.85; thence South 82 degrees 01 minutes 44 seconds West 792.03 feet to a point having Coordinates of X = 1,666,359.18 and Y = 554,513.01; thence North 80 degrees 58 minutes 19 seconds West 990.50 feet to a point having Coordinates of X = 1,665,380.96 and Y = 554,668.44; thence North 58 degrees 58 minutes 35 seconds West 594.00 feet to a point having Coordinates of X = 1,664,871.92 and Y = 554,974.58; thence North 19 degrees 58 minutes 35 seconds West 660.00 feet to a point having Coordinates of X = 1,664,646.45 and Y = 555,594.87; thence North 75 degrees 58 minutes 35 seconds West 132.90 feet to a point having Coordinates of X = 1,664,517.51 and Y = 555,627.08; thence North 00 degrees 57 minutes 08 seconds West 1,816.37 feet to a point having Coordinates of X = 1,664,487.32 and Y = 557,443.20; thence North 88 degrees 32 minutes 12 seconds West 2,552.33 feet to a point having Coordinates of X = 1,661,935.82 and Y = 557,508.37; thence North 02 degrees 11 minutes 28 seconds West 1,296.96 feet to a point having Coordinates of X = 1,661,886.23 and Y = 558,804.38; thence North 89 degrees 18 minutes 30 seconds West 256.25 feet to a point on the East boundary of State Agency Lease No. 19027 having Coordinates of X = 1,661,630.00 and Y = 558,807.48; thence North 31.28 feet along the East boundary of said State Agency Lease No. 19027 to the Southwest corner of said State Agency Lease No. 19182 having Coordinates of X = 1,661,630.00 and Y = 558,838.76; thence along the boundary of said State Agency Lease No. 19182 the following courses: East 268.48 feet and North 1,193.24 feet to the point of beginning, **LESS AND EXCEPT** that portion of the above described tract lying North of Bayou Pierre, **ALSO LESS AND EXCEPT** all that portion of the above described tract lying outside the boundaries of the Bayou Pierre Wildlife Management Area, containing approximately 424 gross acres and **212 net acres**, all as more particularly outlined on a plat on file in the Office of Mineral Resources, Department of Natural Resources.

All bearings, distances and coordinates are based on Louisiana Coordinate System of 1927, (North or South Zone).

NOTE: The above description of the Tract nominated for lease has been provided and corrected, where required, exclusively by the nomination party. Any mineral lease selected from this Tract and awarded by the Louisiana State Mineral Board shall be without warranty of any kind, either express, implied, or statutory, including, but not limited to, the implied warranties of merchantability and fitness for a particular purpose. Should the mineral lease awarded by the Louisiana State Mineral Board be subsequently modified, cancelled or abrogated due to the existence of conflicting leases, operating agreements, private claims or other future obligations or conditions which may affect all or any portion of the leased Tract, it shall not relieve the Lessee of the obligation to pay any bonus due thereon to the Louisiana State Mineral Board, nor shall the Louisiana State Mineral Board be obligated to refund any consideration paid by the Lessor prior to such modification, cancellation, or abrogation, including, but not limited to, bonuses, rentals and royalties.

NOTE: The Department of Wildlife and Fisheries will require a minimum bonus of \$350 per acre and a minimum royalty of 25%.

NOTE: The mineral lease is located within the Bayou Pierre WMA under the jurisdiction of the Louisiana Department of Wildlife and Fisheries which has promulgated rules and regulations for the protection of game and wildlife on the aforesaid Tract and, therefore, shall be subject to said rules and regulations, a copy of which shall be attached to the mineral lease. In addition to the specific rules and regulations applicable, the following shall apply regarding operations under this mineral lease:

1. No activities will be allowed without written authorization from the Louisiana Department of Wildlife and Fisheries.
2. Projects will be evaluated on a case by case basis. Modifications to projects may be required including, but not limited to, access routes, spoil placement, well sites, flow lines and other appurtenant structures.
3. Mitigation will be required to offset avoidable wetland impacts.
4. Removal of all structures, facilities and equipment will be required within 120 days of abandonment unless otherwise agreed to by the Louisiana Department of Wildlife and Fisheries.
5. No activities will be allowed during the hunting season unless approved by the Department.
6. Compliance with the said WMA regulations will be required unless otherwise specified by the Department.
7. Prior to submitting applications for wetland permits to Federal and State permitting agencies the lease holder shall coordinate project details with the Louisiana Department of Wildlife and Fisheries, Fur and Refuge Division. Contact person for the Department will be Mike Windham at (504) 568-5886.

Applicant: JUSTISS OIL COMPANY

Bidder	Cash Payment	Price/Acre	Rental	Oil	Gas	Other

**Legend**

-  08080006
-  Wildlife
-  Active\_Leases

**DOQQ2004**

RED RIVER PARISH

BAYOU PIERRE WMA

DE SOTO PARISH

T14N - R12W

SL 17914

SL 19180

SL 19181

P.O.B.

SL 19027C

SL 19182



**TRACT 40049 - De Soto Parish, LOUISIANA**

All land, LESS AND EXCEPT land now or formerly constituting the beds and bottoms of any water body of whatever description and nature, all belonging to the State of Louisiana located within the geographical boundaries of the (WMA) and not presently under mineral lease by the State of Louisiana as of August 13, 2008, the area of which is set forth as follows: Beginning at a point on the East boundary of State Lease No. 19027 having Coordinates of X = 1,661,630.00 and Y = 558,807.48; thence South 89 degrees 18 minutes 30 seconds East 230.39 feet to a point having Coordinates of X = 1,661,860.37 and Y = 558,804.70; thence South 01 degrees 50 minutes 22 seconds East approximately 52 feet to a point of intersection with the boundary of the Bayou Pierre Wildlife Management Area; thence Westerly approximately 232 feet along the boundary of said Bayou Pierre Wildlife Management Area to a point of intersection with the East boundary of State Lease No. 19011 having a Coordinate of X = 1,661,630.00; thence North approximately 52 feet along the East boundary of said State Lease No. 19011 and the East boundary of said State Lease No. 19027 to the point of beginning, **LESS AND EXCEPT** that portion, if any, of the above described tract lying outside the boundary of the Bayou Pierre Wildlife Management Area, containing approximately 0.28 gross acres and **0.14 net acres**, all as more particularly outlined on a plat on file in the Office of Mineral Resources, Department of Natural Resources. All bearings, distances and coordinates are based on Louisiana Coordinate System of 1927, (North or South Zone).

NOTE: The above description of the Tract nominated for lease has been provided and corrected, where required, exclusively by the nomination party. Any mineral lease selected from this Tract and awarded by the Louisiana State Mineral Board shall be without warranty of any kind, either express, implied, or statutory, including, but not limited to, the implied warranties of merchantability and fitness for a particular purpose. Should the mineral lease awarded by the Louisiana State Mineral Board be subsequently modified, cancelled or abrogated due to the existence of conflicting leases, operating agreements, private claims or other future obligations or conditions which may affect all or any portion of the leased Tract, it shall not relieve the Lessee of the obligation to pay any bonus due thereon to the Louisiana State Mineral Board, nor shall the Louisiana State Mineral Board be obligated to refund any consideration paid by the Lessor prior to such modification, cancellation, or abrogation, including, but not limited to, bonuses, rentals and royalties.

NOTE: The Department of Wildlife and Fisheries will require a minimum bonus of \$350 per acre and a minimum royalty of 25%.

NOTE: The mineral lease is located within the Bayou Pierre WMA under the jurisdiction of the Louisiana Department of Wildlife and Fisheries which has promulgated rules and regulations for the protection of game and wildlife on the aforesaid Tract and, therefore, shall be subject to said rules and regulations, a copy of which shall be attached to the mineral

lease. In addition to the specific rules and regulations applicable, the following shall apply regarding operations under this mineral lease:

1. No activities will be allowed without written authorization from the Louisiana Department of Wildlife and Fisheries.
2. Projects will be evaluated on a case by case basis. Modifications to projects may be required including, but not limited to, access routes, spoil placement, well sites, flow lines and other appurtenant structures.
3. Mitigation will be required to offset avoidable wetland impacts.
4. Removal of all structures, facilities and equipment will be required within 120 days of abandonment unless otherwise agreed to by the Louisiana Department of Wildlife and Fisheries.
5. No activities will be allowed during the hunting season unless approved by the Department.
6. Compliance with the said WMA regulations will be required unless otherwise specified by the Department.
7. Prior to submitting applications for wetland permits to Federal and State permitting agencies the lease holder shall coordinate project details with the Louisiana Department of Wildlife and Fisheries, Fur and Refuge Division. Contact person for the Department will be Mike Windham at (504) 568-5886.

Applicant: PALMER & PALMER to Agency and by Resolution from the Louisiana Department Of Wildlife And Fisheries authorizing the Mineral Board to act in its behalf

Bidder	Cash Payment	Price/Acre	Rental	Oil	Gas	Other

**Legend**

-  08080026
-  Wildlife
-  Active\_Leases

**DOQQ2004**

DE SOTO PARISH

BAYOU PIERRE WMA

P.O.B.

T14N - R12W



**TRACT 40050 - Lafayette Parish, Louisiana**

A certain Tract of land, excluding the beds and bottoms of all navigable waters, belonging to and not presently under mineral lease from Lafayette City-Parish Consolidated Government on August 13, 2008, being more fully described as follows: All of the rights, title and interest in any highways, right of ways, roads, alleys, or other lands owned by and not presently under mineral lease from the Lafayette City-Parish Consolidated Government, located within the following described boundaries: Beginning at a point having Coordinates of X = 1,762,006.91 and Y = 569,934.30; thence South 89 degrees 49 minutes 00 seconds East 8,347.60 feet to a point having Coordinates of X = 1,770,354.47 and Y = 569,907.60; thence South 3,099.79 feet to a point having Coordinates of X = 1,770,354.47 and Y = 566,807.81; thence South 41 degrees 11 minutes 53 seconds West 2,057.10 feet to a point having Coordinates of X = 1,768,999.53 and Y = 565,259.97; thence South 1,788.66 feet to a point having Coordinates of X = 1,768,999.53 and Y = 563,471.31; thence South 89 degrees 58 minutes 16 seconds West 4,371.81 feet to a point having Coordinates of X = 1,764,627.72 and Y = 563,469.10; thence North 3,189.82 feet to a point having Coordinates of X = 1,764,627.72 and Y = 566,658.92; thence North 89 degrees 42 minutes 47 seconds West 2,614.33 feet to a point having Coordinates of X = 1,762,013.42 and Y = 566,672.01; thence North 00 degrees 06 minutes 52 seconds West 3,262.30 feet to the point of beginning, excluding beds and bottoms of all navigable waters, containing approximately **59.18 acres**, all as more particularly outlined on a plat on file in the Office of Mineral Resources, Department of Natural Resources. The description is based on information provided by the State Agency regarding location and ownership of surface and mineral rights. All bearings, distances and coordinates, if applicable, are based on Louisiana Coordinate System of 1927, (North or South Zone).

NOTE: The above description of the Tract nominated for lease has been provided and corrected, where required, exclusively by the nomination party. Any mineral lease selected from this Tract and awarded by the Louisiana State Mineral Board shall be without warranty of any kind, either express, implied, or statutory, including, but not limited to, the implied warranties of merchantability and fitness for a particular purpose. Should the mineral lease awarded by the Louisiana State Mineral Board be subsequently modified, cancelled or abrogated due to the existence of conflicting leases, operating agreements, private claims or other future obligations or conditions which may affect all or any portion of the leased Tract, it shall not relieve the Lessee of the obligation to pay any bonus due thereon to the Louisiana State Mineral Board, nor shall the Louisiana State Mineral Board be obligated to refund any consideration paid by the Lessor prior to such modification, cancellation, or abrogation, including, but not limited to, bonuses, rentals and royalties.

NOTE: There shall be no drilling or surface operations (including particularly geophysical operations) on the lands vested in the Lafayette City-Parish Consolidated Government.



NOTE: The Lessee, or any assignee, shall be required to obtain consent from the Lafayette City-Parish Consolidated Government prior to the execution of any assignments, sublease or other transfer.

NOTE: The Lessee shall at all times comply with all applicable environmental and wetlands laws and regulations promulgated by the federal government, the State of Louisiana, and/or any department, office, or agency thereof, and that the Lessee shall obtain all licenses and/or permits required under such laws and regulations.

Applicant: THEOPHILUS OIL, GAS & LAND SERVICES, LLC to Agency and by Resolution from the Lafayette City-Parish Consolidated Government authorizing the Mineral Board to act in its behalf

Bidder	Cash Payment	Price/Acre	Rental	Oil	Gas	Other

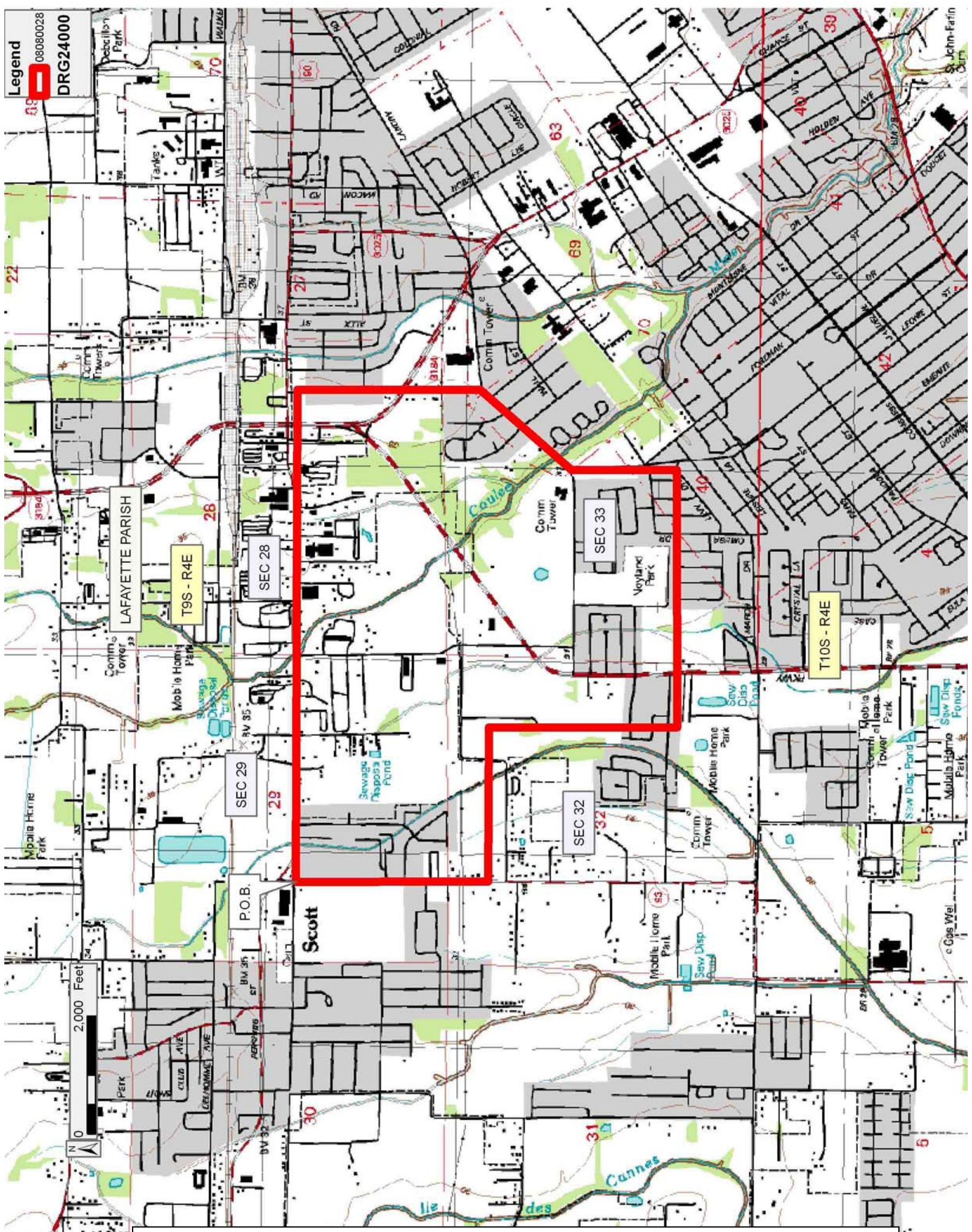

Office of Mineral Resources, Acres: 59.18 Tract Number: 40050

**TRACT 40051 - Terrebonne Parish, Louisiana**

A certain Tract of land, excluding the beds and bottoms of all navigable waters, belonging to and not presently under mineral lease from Louisiana Department Of Transportation And Development on August 13, 2008, being more fully described as follows: Beginning at a point having Coordinates of X = 2,204,282.48 and Y = 331,316.70; thence West 14,475.40 feet to a point having Coordinates of X = 2,189,807.08 and Y = 331,316.70; thence North approximately 2,969 feet to a point on the Southern boundary of State Lease No. 2234 having Coordinates of X = 2,189,807.08; thence along the boundary of said State Lease No. 2234 the following courses: Northeasterly; Northwesterly and Northeasterly to a point of intersection with the Southern boundary of State Lease No. 1691; thence Easterly along the meanders of said State Lease No. 1691 to a point intersection with a North-South line having a Coordinate of X = 2,204,282.48; thence South approximately 7,590 feet along said line to the point of beginning, containing approximately **82.36 acres**, all as more particularly outlined on a plat on file in the Office of Mineral Resources, Department of Natural Resources. The description is based on information provided by the State Agency regarding location and ownership of surface and mineral rights. All bearings, distances and coordinates, if applicable, are based on Louisiana Coordinate System of 1927, (North or South Zone).

NOTE: The above description of the Tract nominated for lease has been provided and corrected, where required, exclusively by the nomination party. Any mineral lease selected from this Tract and awarded by the Louisiana State Mineral Board shall be without warranty of any kind, either express, implied, or statutory, including, but not limited to, the implied warranties of merchantability and fitness for a particular purpose. Should the mineral lease awarded by the Louisiana State Mineral Board be subsequently modified, cancelled or abrogated due to the existence of conflicting leases, operating agreements, private claims or other future obligations or conditions which may affect all or any portion of the leased Tract, it shall not relieve the Lessee of the obligation to pay any bonus due thereon to the Louisiana State Mineral Board, nor shall the Louisiana State Mineral Board be obligated to refund any consideration paid by the Lessor prior to such modification, cancellation, or abrogation, including, but not limited to, bonuses, rentals and royalties.

Bidder	Cash Payment	Price/Acre	Rental	Oil	Gas	Other

Applicant: JESSE NEWTON to Agency and by Resolution from the Louisiana Department Of Transportation And Development authorizing the Mineral Board to act in its behalf

**Legend**

08080072

Active\_Leases

**DRG24000**

