

TRACT 40006 - Portion of Block 66, Ship Shoal Area, Terrebonne Parish, Louisiana

The beds and bottoms of all water bodies belonging to the State of Louisiana located in Block 66, Ship Shoal Area, together with any present lands formed by accretion to the shoreline or islands formed therein, located in Terrebonne Parish, Louisiana, owned by and not presently under mineral lease as of August 13, 2008, from the State of Louisiana, the geographical area of which is more fully described as follows: Beginning at a point on the Northern most boundary line of Block 66, Ship Shoal Area having Coordinates of X = 2,162,081.25 and Y = 127,591.99; thence East 9,518.75 feet along the North boundary to a point having Coordinates of X = 2,171,600.00 and Y = 127,591.99; thence South 7,894.55 feet along the East boundary of Block 66 to a the Northeast corner of State Lease No. 14689, having Coordinates of X = 2,171,600.00 and Y = 119,697.44; thence along the boundaries of said State Lease No. 14689 the following courses: West 1,200.00 feet, North 59 degrees 15 minutes 7 seconds West 6,248.36 feet, South 17 degrees 47 minutes 39 seconds East 621.73 feet, South 23 degrees 40 minutes 56 seconds East 622.41 feet, South 31 degrees 53 minutes 27 seconds East 1,060.00 feet, South 39 degree 38 minutes 39 seconds East 454.53 feet, South 43 degrees 15 minutes 52 seconds East 466.90 feet, South 07 degrees 07 minutes 30 seconds West 564.36, South 51 degrees 45 minutes 13 seconds East 1,082.32 feet, South 55 degrees 51 minutes 51 seconds East 1,425.62 feet, South 810.00 feet, South 78 degrees 18 minutes 38 seconds West 296.14 feet, South 55 degrees 50 minutes 25 seconds West 41.37 feet to a point on its Southwestern boundary and a point on the Southeastern boundary of State Lease No. 10830, having Coordinates of X = 2,168,275.77 and Y = 117,216.77; thence along the boundaries of said State Lease No. 10830 the following courses: North 40 degrees 17 minutes 55 seconds West 121.03 feet, North 36 degrees 48 minutes 10 seconds West 320.58 feet, North 38 degrees 45 minutes 18 second West 305.06 feet, North 37 degrees 55 minutes 35 seconds West 1,744.18 feet, South 29 degrees 47 minutes 54 seconds West 647.03 feet, South 09 degrees 04 minutes 04 seconds East 2,040.65 feet to its Southernmost Southwest point and intersection with the Three Mile Line, as decreed by the Supreme Court of the United States, as determined by a Special Master appointed therein, in litigation styled United States v. State of Louisiana et al No. 9 original, in 1975 having Coordinates of X = 2,166,742.49 and Y = 116,602.84; thence Southwesterly in a straight line along the Three Mile Line to a point having Coordinates of X = 2,165,394 and Y = 116,535; thence Northwesterly along an arc having a radius of 18,240.60 feet and a center of X = 2,164,477 and Y = 134,753 to a point on said Three Mile Line having Coordinates of X = 2,163,450.00 and Y = 116,541.33; thence North 21 degrees 19 minutes 20 seconds West 385.03 feet to a point having Coordinates of X = 2,163,310.00 and Y = 116,900.00; thence North 27 degrees 53 minutes 50 seconds West 384.71 feet to a point having Coordinates of X = 2,163,130.00 and Y = 117,240.00; thence North 30 degrees 57 minutes 50 seconds West 583.10 to a point having Coordinates of X = 2,162,830.00 and Y = 117,740.00; thence North 35 degrees 05 minutes 45 seconds West 904.43 feet to a point having X = 2,162,310.00 and Y =

118,480.00; thence North 46 degrees 07 minutes 01 second West 317.37 feet to a point having Coordinates of X = 2,162,081.25 and Y = 118,700.00; thence North 2,191.99 to the Southwest corner of State Lease No. 10830 and the Southeast Corner of State Lease No. 17595 to a point having Coordinates of X = 2,162,081.25 and Y = 120,891.99; thence along the boundaries of said State Lease No. 10830 the following courses: East 1,462.09 feet, North 2,000 feet, and West 1,462.09 feet to its Northwest corner and the Northeast Corner of State Lease No. 17595 having Coordinates of X = 2,162,081.25 and Y = 122,891.99; thence North 4,700.00 feet to the point of beginning, containing approximately **1837.43 acres, LESS AND EXCEPT** that portion thereof, if any, lying seaward of the line three nautical miles from the coast line of Louisiana, as said three mile line has been decreed by the Supreme Court of the United States, as determined by a Special Master appointed therein, in litigation styled **United States v. State of Louisiana et al No. 9 Original**, in 1975, all as more particularly outlined on a plat in the Office of Mineral Resources, Department of Natural Resources. All bearings, distances and coordinates are based on the Louisiana Coordinate System of 1927, (South Zone).



NOTE: The above description of the Tract nominated for lease has been provided and corrected, where required, exclusively by the nomination party. Any mineral lease selected from this Tract and awarded by the Louisiana State Mineral Board shall be without warranty of any kind, either express, implied, or statutory, including, but not limited to, the implied warranties of merchantability and fitness for a particular purpose. Should the mineral lease awarded by the Louisiana State Mineral Board be subsequently modified, cancelled or abrogated due to the existence of conflicting leases, operating agreements, private claims or other future obligations or conditions which may affect all or any portion of the leased Tract, it shall not relieve the Lessee of the obligation to pay any bonus due thereon to the Louisiana State Mineral Board, nor shall the Louisiana State Mineral Board be obligated to refund any consideration paid by the Lessor prior to such modification, cancellation, or abrogation, including, but not limited to, bonuses, rentals and royalties.

NOTE: The State of Louisiana does hereby reserve, and this lease shall be subject to, the imprescriptible right of surface use in the nature of a servitude in favor of the Department of Natural Resources, including its Offices and Commissions, for the sole purpose of implementing, constructing, servicing and maintaining approved coastal zone management and/or restoration projects. Utilization of any and all rights derived under this lease by the mineral lessee, its agents, successors or assigns, shall not interfere with nor hinder the reasonable surface use by the Department of Natural Resources, its Offices or Commissions, as herein above reserved.

Applicant: REAGAN ENERGY SERVICES, LLC

| Bidder | Cash Payment | Price/Acre | Rental | Oil | Gas | Other |
|--------|--------------|------------|--------|-----|-----|-------|
| | | | | | | |
| | | | | | | |
| | | | | | | |
| | | | | | | |

Legend

-  08080022
-  Blocks
-  Active_Leases



TRACT 40007 - Portion of Block 66, Ship Shoal Area, Terrebonne Parish, Louisiana

The beds and bottoms of all water bodies belonging to the State of Louisiana located in Block 66, Ship Shoal Area, together with any present lands formed by accretion to the shoreline or islands formed therein, located in Terrebonne Parish, Louisiana, owned by and not presently under mineral lease as of August 13, 2008, from the State of Louisiana, the geographical area of which is more fully described as follows: Beginning at the Northwest corner of Block 66, Ship Shoal Area, having Coordinates of X = 2,156,000.00 and Y = 127,591.99; thence East 6,081.25 feet to a point on the North line of said Block 66 having Coordinates of X = 2,162,081.25 and Y = 127,591.99; thence South 4,700.00 feet to the Northeast corner of State Lease No. 17595 having Coordinates of X = 2,162,081.25 and Y = 122,891.99; thence on the boundaries of said State Lease No. 17595 the following courses: Westerly 1,500.00 feet, South 2,000.00 feet and East 1,500.00 feet to the intersection of its Southeast corner and the Southwest corner of State Lease No. 10830 having Coordinates of X = 2,162,081.25 and Y = 120,891.99; thence South 2,191.99 feet to a point having Coordinates of X = 2,162,081.25 and Y = 118,700.00; thence South 46 degrees 07 minutes 01 second East 317.37 feet to a point having Coordinates of X = 2,162,310.00 and Y = 118,480.00; thence South 35 degrees 05 minutes 45 seconds East 904.43 feet to a point having Coordinates of X = 2,162,830.00 and Y = 117,740.00; thence South 30 degrees 57 minutes 50 seconds East 583.10 feet to a point having Coordinates of X = 2,163,130.00 and Y = 117,240.00; thence South 27 degrees 53 minutes 50 seconds East 384.71 feet to a point having Coordinates of X = 2,163,310.00 and Y = 116,900.00; thence South 21 degrees 19 minutes 20 seconds East 385.03 feet to a point that intersects the Three Mile Line, as decreed by the Supreme Court of the United States, as determined by a Special Master appointed therein, in litigation styled *United States v. State of Louisiana et al No. 9 Original*, in 1975, having Coordinates of X = 2,163,450.00 and Y = 116,541.33; thence along said Three Mile Line the following: Northwesterly on an arc having a radius of 18,240.60 feet and a center at X = 2,164,477 and Y = 134,753 to a point having Coordinates of X = 2,160,352 and Y = 116,985, Northwesterly on a straight line to a point having Coordinates of X = 2,156,273 and Y = 117,355 and Northwesterly on an arc having a radius of 18,240.60 feet and a center at X = 2,157,920 and Y = 135,521 to its intersection with the West line of said Block 66 and the Southwest corner of State Lease No. 14572 having Coordinates of X = 2,156,000.00 and Y = 117,381.73; thence on the boundaries of the said State Lease No. 14572 the following courses: North 73 degrees 41 minutes 54 seconds East 2,871.03 feet and North 26 degrees 10 minutes 58 seconds West 6,245.19 feet to its intersection with the Northeast corner of State Lease No. 14571; thence North 3,800 feet to the point of beginning, containing approximately **1,233.29 acres, LESS AND EXCEPT** that portion thereof, if any, lying seaward of the line three nautical miles from the coast line of Louisiana, as said three mile line has been decreed by the Supreme Court of the United States, as determined by a Special Master appointed therein, in litigation styled **United States**

v. State of Louisiana et al No. 9 Original, in 1975, all as more particularly outlined on a plat in the Office of Mineral Resources, Department of Natural Resources. All bearings, distances and coordinates are based on the Louisiana Coordinate System of 1927, (South Zone).

NOTE: The above description of the Tract nominated for lease has been provided and corrected, where required, exclusively by the nomination party. Any mineral lease selected from this Tract and awarded by the Louisiana State Mineral Board shall be without warranty of any kind, either express, implied, or statutory, including, but not limited to, the implied warranties of merchantability and fitness for a particular purpose. Should the mineral lease awarded by the Louisiana State Mineral Board be subsequently modified, cancelled or abrogated due to the existence of conflicting leases, operating agreements, private claims or other future obligations or conditions which may affect all or any portion of the leased Tract, it shall not relieve the Lessee of the obligation to pay any bonus due thereon to the Louisiana State Mineral Board, nor shall the Louisiana State Mineral Board be obligated to refund any consideration paid by the Lessor prior to such modification, cancellation, or abrogation, including, but not limited to, bonuses, rentals and royalties.

NOTE: The State of Louisiana does hereby reserve, and this lease shall be subject to, the imprescriptible right of surface use in the nature of a servitude in favor of the Department of Natural Resources, including its Offices and Commissions, for the sole purpose of implementing, constructing, servicing and maintaining approved coastal zone management and/or restoration projects. Utilization of any and all rights derived under this lease by the mineral lessee, its agents, successors or assigns, shall not interfere with nor hinder the reasonable surface use by the Department of Natural Resources, its Offices or Commissions, as herein above reserved.

Applicant: REAGAN ENERGY SERVICES, LLC

| Bidder | Cash Payment | Price/Acre | Rental | Oil | Gas | Other |
|--------|--------------|------------|--------|-----|-----|-------|
| | | | | | | |
| | | | | | | |
| | | | | | | |
| | | | | | | |

Legend

- 08080023
- Blocks
- Active_Leases

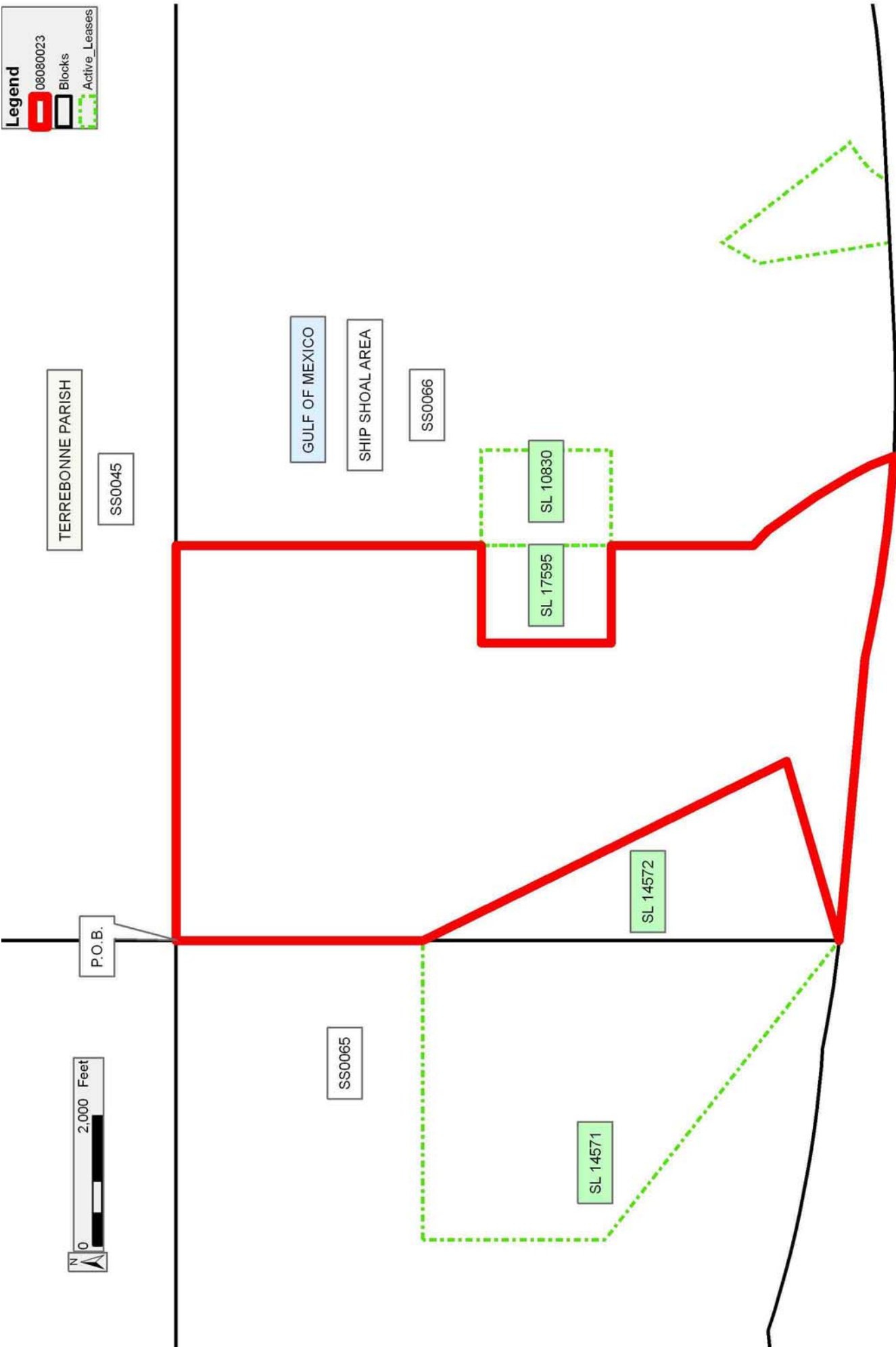

TRACT 40008 - Portion of Block 65, Ship Shoal Area, Terrebonne Parish, Louisiana

The beds and bottoms of all water bodies belonging to the State of Louisiana located in Block 65, Ship Shoal Area, together with any present lands formed by accretion to the shoreline or islands formed therein, located in Terrebonne Parish, Louisiana, owned by and not presently under mineral lease as of August 13, 2008, from the State of Louisiana, the geographical area of which is more fully described as follows: Beginning at a point on the Northern most line of Block 65, Ship Shoal Area, having Coordinates of X = 2,148,200.00 and Y = 127,591.99; thence East 7,800.00 feet on the North line of said Block 65 to a point having Coordinates of X = 2,156,000.00 and Y = 127,591.99; thence South 3,800.00 feet on the East line of said Block 65 to the Northeast corner of State Lease No. 14571 and the Northernmost point of State Lease No. 14572, having Coordinates of X = 2,156,000.00 and Y = 123,791.99; thence on the boundaries of said State Lease No. 14571 the following courses: West 4,600.00 feet, South 2,805.78 feet and South 51 degrees 55 minutes 06 seconds East 5,843.99 feet on the East line of said Block 65 to its intersection with the Three Mile Line, as decreed by the Supreme Court of the United States, as determined by a Special Master appointed therein, in litigation styled *United States v. State of Louisiana et al No. 9 Original*, in 1975, being the Southwest corner of State Lease No. 14572 having Coordinates of X = 2,156,000.00 and Y = 117,381.73; thence along said Three Mile Line the following courses: Northwesterly on the arc having a radius of 18,240.60 feet and a center at X = 2,157,920 and Y = 135,521 to a point having Coordinates of X = 2,154,346 and Y = 117,634; Northwesterly on an arc having a radius of 18,240.60 feet and a center at X = 2,155,349 and Y = 135,847 to a point having Coordinates of X = 2,149,793 and Y = 118,473; Southwesterly on an arc having a radius of 18,240.60 feet and a center at X = 2,147,751 and Y = 136,599 to a point having Coordinates of X = 2,149,162 and Y = 118,413 and Southwesterly on a straight line to a point having Coordinates of X = 2,148,200.00 and Y = 118,338.34; thence North 9,253.65 feet to a point on the North line of said Block 65 to the point of beginning, containing approximately **1,240.32 acres, LESS AND EXCEPT** that portion thereof, if any, lying seaward of the line three nautical miles from the coast line of Louisiana, as said three mile line has been decreed by the Supreme Court of the United States, as determined by a Special Master appointed therein, in litigation styled **United States v. State of Louisiana et al No. 9 Original**, in 1975, all as more particularly outlined on a plat in the Office of Mineral Resources, Department of Natural Resources. All bearings, distances and coordinates are based on the Louisiana Coordinate System of 1927, (South Zone).

NOTE: The above description of the Tract nominated for lease has been provided and corrected, where required, exclusively by the nomination party. Any mineral lease selected from this Tract and awarded by the Louisiana State Mineral Board shall be without warranty of any kind, either express, implied, or statutory, including, but not limited to, the implied warranties of merchantability and fitness for a particular

purpose. Should the mineral lease awarded by the Louisiana State Mineral Board be subsequently modified, cancelled or abrogated due to the existence of conflicting leases, operating agreements, private claims or other future obligations or conditions which may affect all or any portion of the leased Tract, it shall not relieve the Lessee of the obligation to pay any bonus due thereon to the Louisiana State Mineral Board, nor shall the Louisiana State Mineral Board be obligated to refund any consideration paid by the Lessor prior to such modification, cancellation, or abrogation, including, but not limited to, bonuses, rentals and royalties.

NOTE: The State of Louisiana does hereby reserve, and this lease shall be subject to, the imprescriptible right of surface use in the nature of a servitude in favor of the Department of Natural Resources, including its Offices and Commissions, for the sole purpose of implementing, constructing, servicing and maintaining approved coastal zone management and/or restoration projects. Utilization of any and all rights derived under this lease by the mineral lessee, its agents, successors or assigns, shall not interfere with nor hinder the reasonable surface use by the Department of Natural Resources, its Offices or Commissions, as herein above reserved.

Applicant: REAGAN ENERGY SERVICES, LLC

| Bidder | Cash Payment | Price/Acre | Rental | Oil | Gas | Other |
|--------|--------------|------------|--------|-----|-----|-------|
| | | | | | | |
| | | | | | | |
| | | | | | | |
| | | | | | | |

Legend

- 08080024
- Blocks
- Active_Leases

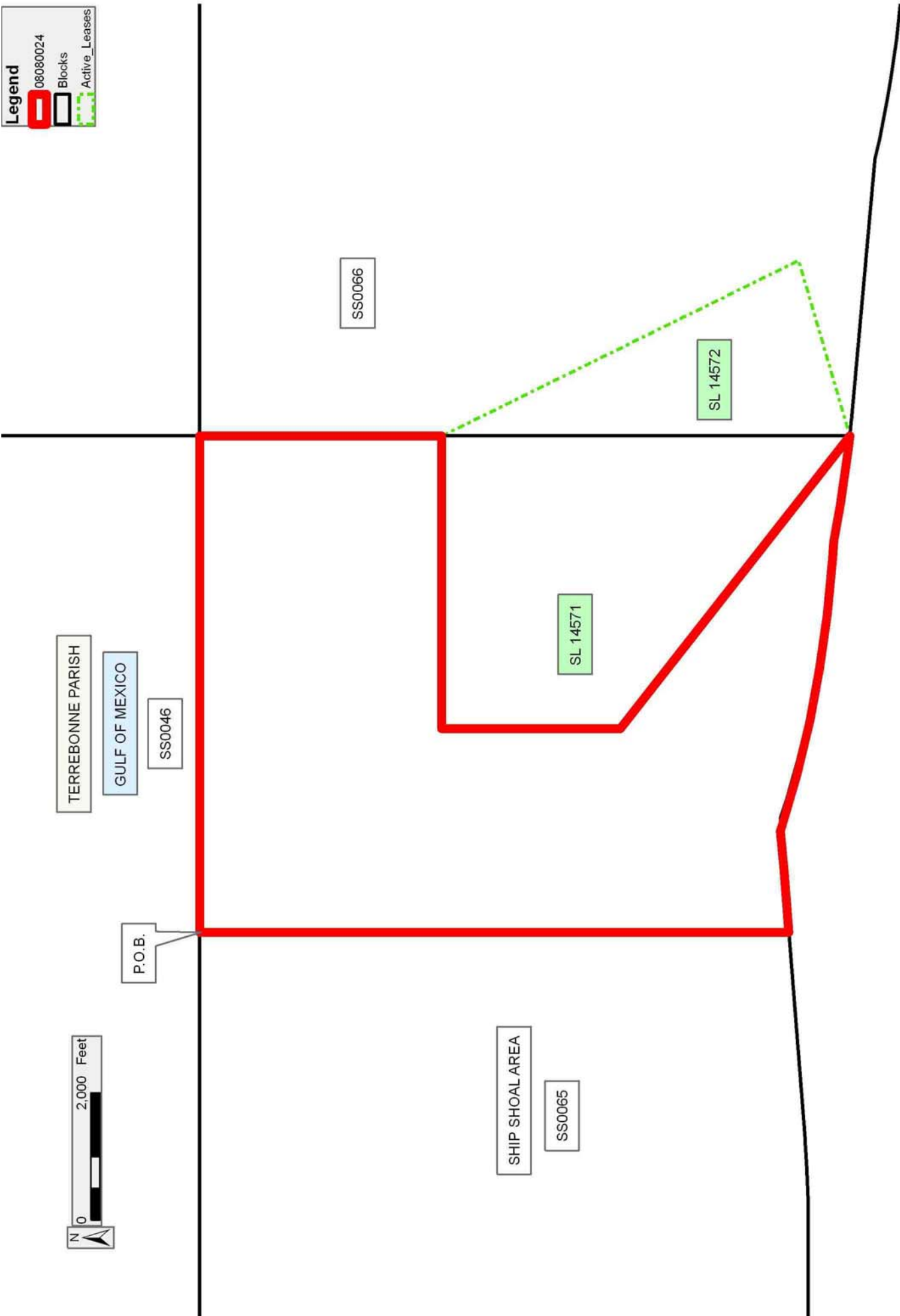

TRACT 40009 - Portion of Block 65, Ship Shoal Area, Terrebonne Parish, Louisiana

The beds and bottoms of all water bodies belonging to the State of Louisiana located in Block 65, Ship Shoal Area, together with any present lands formed by accretion to the shoreline or islands formed therein, located in Terrebonne Parish, Louisiana, owned by and not presently under mineral lease as of August 13, 2008, from the State of Louisiana, the geographical area of which is more fully described as follows: Beginning at a point on the Northern most line of Block 65, Ship Shoal Area and the Northeast corner of the State Lease No. 15067, having Coordinates of X = 2,145,405.00 and Y = 127,591.99; thence East 2,795.00 feet on the North line of said Block 65 to a point having Coordinates of X = 2,148,200.00 and Y = 127,591.99; thence South 9,253.65 feet to a point on the Three Mile Line, as decreed by the Supreme Court of the United States, as determined by a Special Master appointed therein, in litigation styled *United States v. State of Louisiana et al No. 9 Original*, in 1975, having Coordinates of X = 2,148,200.00 and Y = 118,338.34; thence along said Three Mile Line the following courses: Southwesterly on a straight line to a point having Coordinates of X = 2,145,000 and Y = 118,090; Southwesterly on an arc having a radius of 18,240.60 feet and a center at X = 2,143,589 and Y = 136,276 to a point having Coordinates of X = 2,143,589 and Y = 118,035; then West 3,189.00 feet on a straight line to its intersection with the West line of said Block 65 having Coordinates of X = 2,140,400.00 and Y = 118,035.00; thence North 3,916.99 feet on the West line of said Block 65 to the Southeast corner of State Lease No. 14851 having Coordinates of X = 2,140,400.00 and Y = 121,951.99; thence North 3,400.00 feet on the West line of said Block 65 to the Southwest corn of State Lease No. 14796 having Coordinates of X = 2,140,400.00 and Y = 125,351.99; thence on the boundaries of said State Lease No. 14796 the following courses: East 1,480.00 feet and North 690.00 feet to the Southwest corner of State Lease No. 15067 having Coordinates of X = 2,141,880.00 and Y = 126,041.99; thence on the boundaries of said State Lease No. 15067 the following courses: East 3,525.00 feet and North 1,550.00 feet to the point of beginning, containing approximately **1,496.01 acres, LESS AND EXCEPT** that portion thereof, if any, lying seaward of the line three nautical miles from the coast line of Louisiana, as said three mile line has been decreed by the Supreme Court of the United States, as determined by a Special Master appointed therein, in litigation styled **United States v. State of Louisiana et al No. 9 Original**, in 1975, all as more particularly outlined on a plat in the Office of Mineral Resources, Department of Natural Resources. All bearings, distances and coordinates are based on the Louisiana Coordinate System of 1927, (South Zone).

NOTE: The above description of the Tract nominated for lease has been provided and corrected, where required, exclusively by the nomination party. Any mineral lease selected from this Tract and awarded by the Louisiana State Mineral Board shall be without warranty of any kind, either express, implied, or statutory, including, but not limited to, the implied warranties of merchantability and fitness for a particular

purpose. Should the mineral lease awarded by the Louisiana State Mineral Board be subsequently modified, cancelled or abrogated due to the existence of conflicting leases, operating agreements, private claims or other future obligations or conditions which may affect all or any portion of the leased Tract, it shall not relieve the Lessee of the obligation to pay any bonus due thereon to the Louisiana State Mineral Board, nor shall the Louisiana State Mineral Board be obligated to refund any consideration paid by the Lessor prior to such modification, cancellation, or abrogation, including, but not limited to, bonuses, rentals and royalties.

NOTE: The State of Louisiana does hereby reserve, and this lease shall be subject to, the imprescriptible right of surface use in the nature of a servitude in favor of the Department of Natural Resources, including its Offices and Commissions, for the sole purpose of implementing, constructing, servicing and maintaining approved coastal zone management and/or restoration projects. Utilization of any and all rights derived under this lease by the mineral lessee, its agents, successors or assigns, shall not interfere with nor hinder the reasonable surface use by the Department of Natural Resources, its Offices or Commissions, as herein above reserved.

Applicant: REAGAN ENERGY SERVICES, LLC

| Bidder | Cash Payment | Price/Acre | Rental | Oil | Gas | Other |
|--------|--------------|------------|--------|-----|-----|-------|
| | | | | | | |
| | | | | | | |
| | | | | | | |
| | | | | | | |

Legend

- 08080025
- Blocks
- Active_Leases

TERREBONNE PARISH

SS0046

P.O.B.

SL 15067

SL 14796

SL 14851

SHIP SHOAL AREA

GULF OF MEXICO

SS0065

SS0064

