

TRACT 39282 - Portion of Block 5, West Cameron Area, Revised, Cameron Parish, Louisiana

The beds and bottoms of all water bodies belonging to the State of Louisiana located in Block 5, West Cameron Area, Revised, together with any present lands formed by accretion to the shoreline or islands formed therein, located in Cameron Parish, Louisiana, owned by and not presently under mineral lease as of August 8, 2007, from the State of Louisiana, the geographical area of which is more fully described as follows: Beginning at a point where the West boundary of Block 5 intersects with the a point on the Louisiana Coastline, as decreed by the Supreme Court of the United States, as determined by a Special Master appointed therein, in litigation styled *United States v. State of Louisiana et al No. 9 Original*, in 1975, having Coordinates of X = 1,361,935.62 and Y = 398,180.72; thence along said Coastline the following courses: Southeasterly on a straight line to a point having Coordinates of X = 1,362,416 and Y = 397,822; thence Northeasterly on a straight line to a point having Coordinates of X = 1,363,392 and Y = 397,870; thence Northeasterly on a straight line to a point having Coordinates of X = 1,371,462 and Y = 405,466; thence South 11,675.64 feet to a point on the South boundary of said Block 5 having Coordinates of X = 1,371,461.78 and Y = 393,790.24; thence West 9,526.16 feet along the South boundary of said Block 5 to its Southwest corner having Coordinates of X = 1,361,935.62 and Y = 393,790.24; thence North 4,390.48 feet along the West line of said Block 5 to the point of beginning, containing approximately **1,596.71 acres**, all as more particularly outlined on a plat on file in the Office of Mineral Resources, Department of Natural Resources. All bearings, distances and coordinates are based on Louisiana Coordinate System of 1927, (North or South Zone).

NOTE: The above description of the Tract nominated for lease has been provided and corrected, where required, exclusively by the nomination party. Any mineral lease selected from this Tract and awarded by the Louisiana State Mineral Board shall be without warranty of any kind, either express, implied, or statutory, including, but not limited to, the implied warranties of merchantability and fitness for a particular purpose. Should the mineral lease awarded by the Louisiana State Mineral Board be subsequently modified, cancelled or abrogated due to the existence of conflicting leases, operating agreements, private claims or other future obligations or conditions which may affect all or any portion of the leased Tract, it shall not relieve the Lessee of the obligation to pay any bonus due thereon to the Louisiana State Mineral Board, nor shall the Louisiana State Mineral Board be obligated to refund any consideration paid by the Lessor prior to such modification, cancellation, or abrogation, including, but not limited to, bonuses, rentals and royalties.

NOTE: The State of Louisiana does hereby reserve, and this lease shall be subject to, the imprescriptible right of surface use in the nature of a servitude in favor of the Department of Natural Resources, including its Offices and Commissions, for the sole purpose of implementing,

constructing, servicing and maintaining approved coastal zone management and/or restoration projects. Utilization of any and all rights derived under this lease by the mineral lessee, its agents, successors or assigns, shall not interfere with nor hinder the reasonable surface use by the Department of Natural Resources, its Offices or Commissions, as herein above reserved.

NOTE: It appears, according to our records, that a portion of this Tract is located within the restrictive safety fairway area as set out by the Corps of Engineers, U.S. Army and/or the restrictive anchorage area as set out by the U.S. Coast Guard.

Applicant: MONTEGO BAY RESOURCES

Bidder	Cash Payment	Price/Acre	Rental	Oil	Gas	Other

Legend

07080080

Blocks



CAMERON PARISH

WC0005

WEST CAMERON AREA, REVISED

WC0026

GULF OF MEXICO

WC0006

P.O.B.

TRACT 39283 - Portion of Block 6, West Cameron Area, Revised, Cameron Parish, Louisiana

The beds and bottoms of all water bodies belonging to the State of Louisiana located in Block 6, West Cameron Area, Revised, together with any present lands formed by accretion to the shoreline or islands formed therein, located in Cameron Parish, Louisiana, owned by and not presently under mineral lease as of August 8, 2007, from the State of Louisiana, the geographical area of which is more fully described as follows: Beginning at the Northwest corner of said Block 6, West Cameron Area, Revised having Coordinates of X = 1,347,177.57 and Y = 405,200.53; thence South 7,381.66 feet along the West Line of said Block 6 to a point on the Western most corner of SL 19097 having Coordinates of X = 1,347,177.57 and Y = 397,818.88; thence North 21 degrees 50 minutes 24 seconds East 1,076.38 feet along SL 19097 to its Northwest corner having Coordinates of X = 1,347,578.00 and Y = 398,818.00; thence East 13,504.18 feet to a point on the Louisiana Coastline, as decreed by the Supreme Court of the United States, as determined by a Special Master appointed therein, in litigation styled *United States v. State of Louisiana et al No. 9 Original*, in 1975, having Coordinates of X = 1,361,082 and Y = 398,818; thence along said Coastline the following courses: Northwesterly on a straight line to a point having Coordinates of X = 1,354,310 and Y = 403,875; thence Northwesterly on a straight line to a point having Coordinates of X = 1,351,162 and Y = 404,620; thence Northwesterly on a straight line to the point of beginning, containing approximately **1,347.33 acres**, all as more particularly outlined on a plat on file in the Office of Mineral Resources, Department of Natural Resources. All bearings, distances and coordinates are based on Louisiana Coordinate System of 1927, (North or South Zone).

NOTE: The above description of the Tract nominated for lease has been provided and corrected, where required, exclusively by the nomination party. Any mineral lease selected from this Tract and awarded by the Louisiana State Mineral Board shall be without warranty of any kind, either express, implied, or statutory, including, but not limited to, the implied warranties of merchantability and fitness for a particular purpose. Should the mineral lease awarded by the Louisiana State Mineral Board be subsequently modified, cancelled or abrogated due to the existence of conflicting leases, operating agreements, private claims or other future obligations or conditions which may affect all or any portion of the leased Tract, it shall not relieve the Lessee of the obligation to pay any bonus due thereon to the Louisiana State Mineral Board, nor shall the Louisiana State Mineral Board be obligated to refund any consideration paid by the Lessor prior to such modification, cancellation, or abrogation, including, but not limited to, bonuses, rentals and royalties.

NOTE: The State of Louisiana does hereby reserve, and this lease shall be subject to, the imprescriptible right of surface use in the nature of a servitude in favor of the Department of Natural Resources, including its Offices and Commissions, for the sole purpose of implementing,

constructing, servicing and maintaining approved coastal zone management and/or restoration projects. Utilization of any and all rights derived under this lease by the mineral lessee, its agents, successors or assigns, shall not interfere with nor hinder the reasonable surface use by the Department of Natural Resources, its Offices or Commissions, as herein above reserved.

NOTE: It appears, according to our records, that a portion of this Tract is located within the restrictive safety fairway area as set out by the Corps of Engineers, U.S. Army and/or the restrictive anchorage area as set out by the U.S. Coast Guard.

Applicant: MONTEGO BAY RESOURCES

Bidder	Cash Payment	Price/Acre	Rental	Oil	Gas	Other

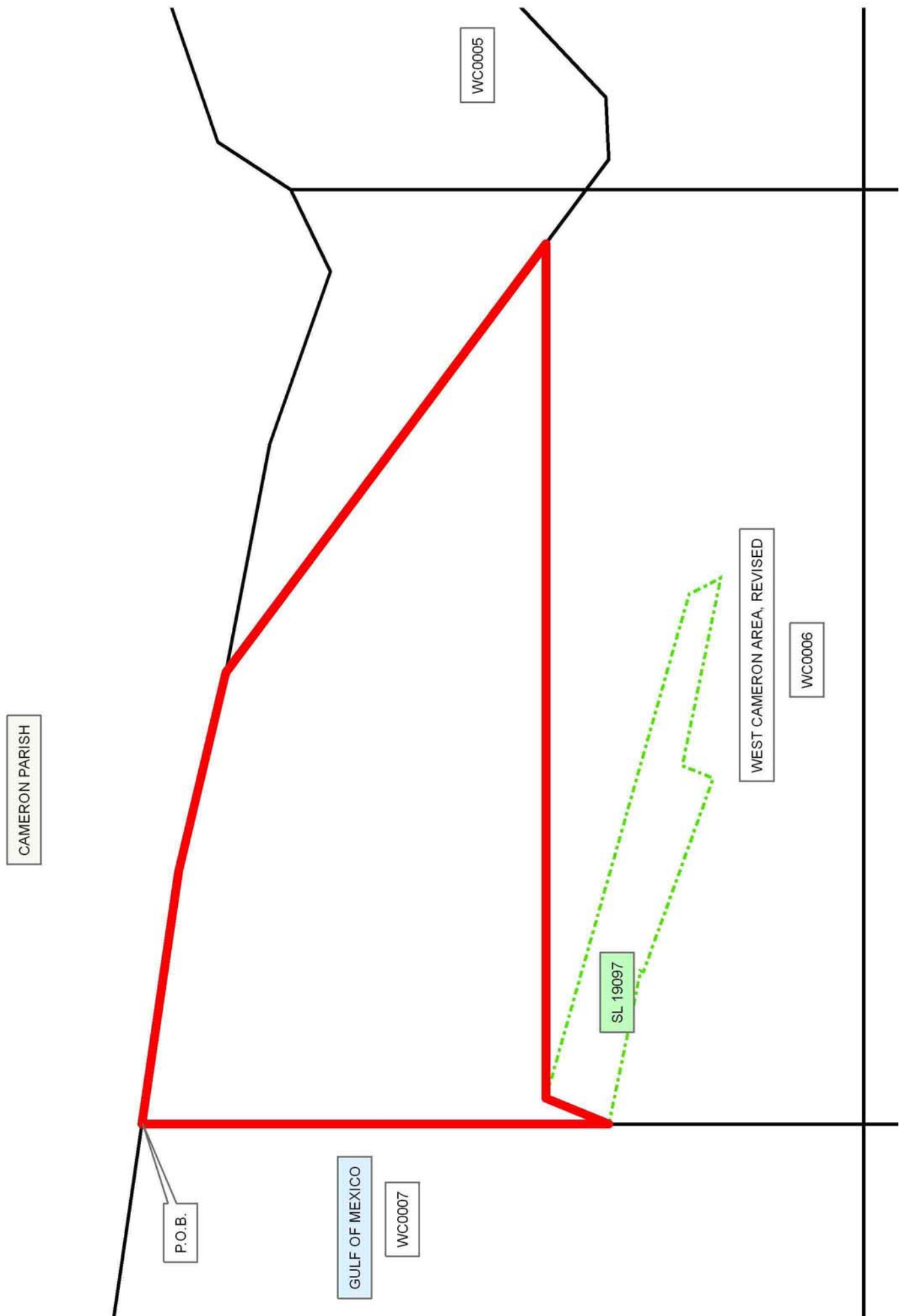
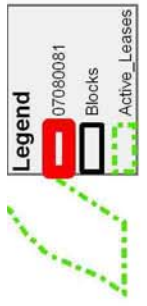

TRACT 39284 - Portion of Blocks 120, 121, and 122, South Timbalier Area, Revised, Terrebonne Parish, Louisiana

The beds and bottoms of all water bodies belonging to the State of Louisiana located in Blocks 120, 121, and 122, South Timbalier Area, Revised, together with any present lands formed by accretion to the shoreline or islands formed therein, located in Terrebonne Parish, Louisiana, owned by and not presently under mineral lease as of August 8, 2007, from the State of Louisiana, the geographical area of which is more fully described as follows: Beginning at a point within Block 120, South Timbalier Area, Revised, having Coordinates of X = 2,241,084.02 and Y = 149,809.46; thence North 1,309.63 feet to a point on the Louisiana Coastline, as decreed by the Supreme Court of the United States, as determined by a Special Master appointed therein, in litigation styled *United States v. State of Louisiana et al No. 9 Original*, in 1975, having Coordinates of X = 2,241,084.02 and Y = 151,119.09; thence along said Louisiana Coastline the following courses: Northeasterly on a straight line to point on the East line of said Block 120, also being a point on the West line of Block 121 South Timbalier Area, Revised, having Coordinates of X = 2,242,289.88 and Y = 151,413.40; Northeasterly on a straight line to a point having Coordinates of X = 2,253,306 and Y = 154,102; Southeasterly on a straight line to a point on the East line of said Block 121, also being a point on the West line of Block 122 South Timbalier Area, Revised, having Coordinates of X = 2,253,808.04 and Y = 153,444.85 and Southeasterly on a straight line to a point on the West boundary of State Lease No. 1249, as amended, having Coordinates of X = 2,253,964.83 and Y = 153,239.62; thence along the boundary of said State Lease No. 1249 the following courses: South 09 degrees 41 minutes 15 seconds East 268.45 feet to a point having Coordinates of X = 2,254,010.00 and Y = 152,975.00 and South 16 degrees 17 minutes 29 seconds East 3,297.96 feet to a point having Coordinates of X = 2,254,935.16 and Y = 149,809.46; thence West 1,127.12 feet to a point on the West line of said Block 122, also being a point on the East line of said Block 121 having Coordinates of X = 2,253,808.04 and Y = 149,809.46; thence West 11,518.16 feet to a point on the West line of said Block 121, also being a point on the East line of said Block 120 having Coordinates of X = 2,242,289.88 and Y = 149,809.46; thence West 1,205.86 feet to the point of beginning, containing approximately **881.36 acres**, all as more particularly outlined on a plat on file in the Office of Mineral Resources, Department of Natural Resources. All bearings, distances and coordinates are based on Louisiana Coordinate System of 1927, (North or South Zone).

NOTE: The above description of the Tract nominated for lease has been provided and corrected, where required, exclusively by the nomination party. Any mineral lease selected from this Tract and awarded by the Louisiana State Mineral Board shall be without warranty of any kind, either express, implied, or statutory, including, but not limited to, the implied warranties of merchantability and fitness for a particular purpose. Should the mineral lease awarded by the Louisiana State Mineral Board be subsequently modified, cancelled or abrogated due to the

existence of conflicting leases, operating agreements, private claims or other future obligations or conditions which may affect all or any portion of the leased Tract, it shall not relieve the Lessee of the obligation to pay any bonus due thereon to the Louisiana State Mineral Board, nor shall the Louisiana State Mineral Board be obligated to refund any consideration paid by the Lessor prior to such modification, cancellation, or abrogation, including, but not limited to, bonuses, rentals and royalties.

NOTE: The State of Louisiana does hereby reserve, and this lease shall be subject to, the imprescriptible right of surface use in the nature of a servitude in favor of the Department of Natural Resources, including its Offices and Commissions, for the sole purpose of implementing, constructing, servicing and maintaining approved coastal zone management and/or restoration projects. Utilization of any and all rights derived under this lease by the mineral lessee, its agents, successors or assigns, shall not interfere with nor hinder the reasonable surface use by the Department of Natural Resources, its Offices or Commissions, as herein above reserved.



NOTE: It appears, according to our records, that a portion of this Tract is located within the restrictive safety fairway area as set out by the Corps of Engineers, U.S. Army and/or the restrictive anchorage area as set out by the U.S. Coast Guard.

NOTE: The Department of Wildlife and Fisheries has designated certain areas in the coastal waters of the State of Louisiana as Oyster Seed Bed Areas. The exact location of those Seed Bed Areas must be obtained from the Department of Wildlife and Fisheries and any work done under a mineral lease from the State of Louisiana may necessarily be conducted in conformity with the rules and regulations promulgated by the said Department of Wildlife and Fisheries for Oyster Seed Bed Areas.

Applicant: LAND MANAGEMENT SERVICES, L.L.C.

Bidder	Cash Payment	Price/Acre	Rental	Oil	Gas	Other

Legend

-  07080037
-  Blocks
-  Active_Leases

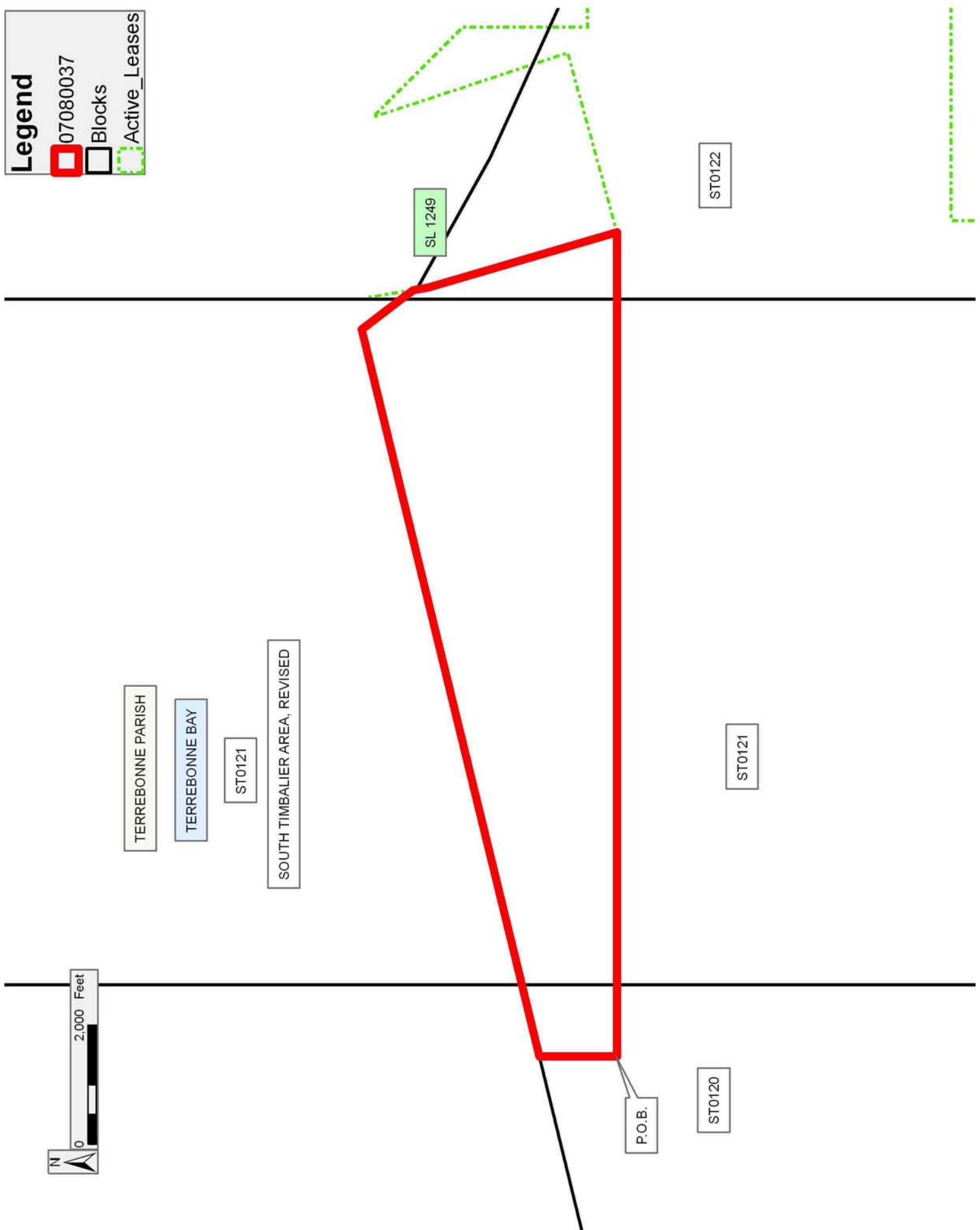

TRACT 39285 - Portion of Blocks 120, 121, and 122, South Timbalier Area, Revised, Terrebonne Parish, Louisiana

The beds and bottoms of all water bodies belonging to the State of Louisiana located in Blocks 120, 121, and 122, South Timbalier Area, Revised, together with any present lands formed by accretion to the shoreline or islands formed therein, located in Terrebonne Parish, Louisiana, owned by and not presently under mineral lease as of August 8, 2007, from the State of Louisiana, the geographical area of which is more fully described as follows: Beginning at a point within Block 120, South Timbalier Area, Revised, having Coordinates of X = 2,241,084.02 and Y = 144,193.53; thence North 5,615.93 feet to a point having Coordinates of X = 2,241,084.02 and Y = 149,809.46; thence East 1,205.86 feet to a point on the East line of said Block 120, also being a point on the West line of Block 121, South Timbalier Area, Revised, having Coordinates of X = 2,242,289.88 and Y = 149,809.46; thence East 11,518.16 feet to a point on the East line of said Block 121, also being a point on the West line of Block 122, South Timbalier Area, Revised, having Coordinates of X = 2,253,808.04 and Y = 149,809.46; thence East 1,127.12 feet to a point on the West boundary of State Lease No. 1249, as amended, having Coordinates of X = 2,254,935.16 and Y = 149,809.46; thence along the boundary of said State Lease No. 1249 the following courses: North 74 degrees 44 minutes 41 seconds East 3,135.50 feet to a point having Coordinates of X = 2,257,960.18 and Y = 150,634.47 and North 18 degrees 14 minutes 36 seconds West 627.22 feet to a point on the Louisiana Coastline, as decreed by the Supreme Court of the United States, as determined by a Special Master appointed therein, in litigation styled *United States v. State of Louisiana et al No. 9 Original*, in 1975, having Coordinates of X = 2,257,763.82 and Y = 151,230.16; thence Southeasterly on a straight line along said Louisiana Coastline to a point on the boundary of said State Lease No. 1249 having Coordinates of X = 2,258,386.02 and Y = 150,946.98; thence along the boundary of said State Lease No. 1249 the following courses: South 641.98 feet to a point having Coordinates of X = 2,258,386.02 and Y = 150,305.00; East 1,200.00 feet to a point having Coordinates of X = 2,259,586.02 and Y = 150,305.00; South 2,280.00 feet to a point having Coordinates of X = 2,259,586.02 and Y = 148,025.00; East 480.00 feet to a point having Coordinates of X = 2,260,066.02 and Y = 148,025.00 and South 2,040.00 feet to a point on the North boundary of State Lease No. 19233 having Coordinates of X = 2,260,066.02 and Y = 145,985.00; thence along the boundary of said State Lease No. 19233 the following courses: West 3,455.10 feet to its Northwest corner having Coordinates of X = 2,256,610.92 and Y = 145,985.00 and South 1,791.47 feet to its Southwest corner, also being a point on the boundary of said State Lease No. 1249 having Coordinates of X = 2,256,610.92 and Y = 144,193.53; thence West 1,482.88 feet along the boundary of said State Lease No. 1249 to a point having Coordinates of X = 2,255,128.04 and Y = 144,193.53; thence West 1,320.00 feet to a point on the West line of said Block 122, also being a point on the East line of said Block 121 having Coordinates of X = 2,253,808.04 and Y = 144,193.53; thence West 11,518.16 feet to a point on the West line of said Block 121, also being a point on the East

line of said Block 120 having Coordinates of X = 2,242,289.88 and Y = 144,193.53; thence West 1,205.86 feet to the point of beginning, containing approximately **2,340.98 acres**, all as more particularly outlined on a plat on file in the Office of Mineral Resources, Department of Natural Resources. All bearings, distances and coordinates are based on Louisiana Coordinate System of 1927, (North or South Zone).

NOTE: The above description of the Tract nominated for lease has been provided and corrected, where required, exclusively by the nomination party. Any mineral lease selected from this Tract and awarded by the Louisiana State Mineral Board shall be without warranty of any kind, either express, implied, or statutory, including, but not limited to, the implied warranties of merchantability and fitness for a particular purpose. Should the mineral lease awarded by the Louisiana State Mineral Board be subsequently modified, cancelled or abrogated due to the existence of conflicting leases, operating agreements, private claims or other future obligations or conditions which may affect all or any portion of the leased Tract, it shall not relieve the Lessee of the obligation to pay any bonus due thereon to the Louisiana State Mineral Board, nor shall the Louisiana State Mineral Board be obligated to refund any consideration paid by the Lessor prior to such modification, cancellation, or abrogation, including, but not limited to, bonuses, rentals and royalties.

NOTE: The State of Louisiana does hereby reserve, and this lease shall be subject to, the imprescriptible right of surface use in the nature of a servitude in favor of the Department of Natural Resources, including its Offices and Commissions, for the sole purpose of implementing, constructing, servicing and maintaining approved coastal zone management and/or restoration projects. Utilization of any and all rights derived under this lease by the mineral lessee, its agents, successors or assigns, shall not interfere with nor hinder the reasonable surface use by the Department of Natural Resources, its Offices or Commissions, as herein above reserved.

NOTE: It appears, according to our records, that a portion of this Tract is located within the restrictive safety fairway area as set out by the Corps of Engineers, U.S. Army and/or the restrictive anchorage area as set out by the U.S. Coast Guard.

NOTE: The Department of Wildlife and Fisheries has designated certain areas in the coastal waters of the State of Louisiana as Oyster Seed Bed Areas. The exact location of those Seed Bed Areas must be obtained from the Department of Wildlife and Fisheries and any work done under a mineral lease from the State of Louisiana may necessarily be conducted in conformity with the rules and regulations promulgated by the said Department of Wildlife and Fisheries for Oyster Seed Bed Areas.

Applicant: LAND MANAGEMENT SERVICES, L.L.C.

Bidder	Cash Payment	Price/Acre	Rental	Oil	Gas	Other

Legend

- 07080036
- Blocks
- Active_Leases

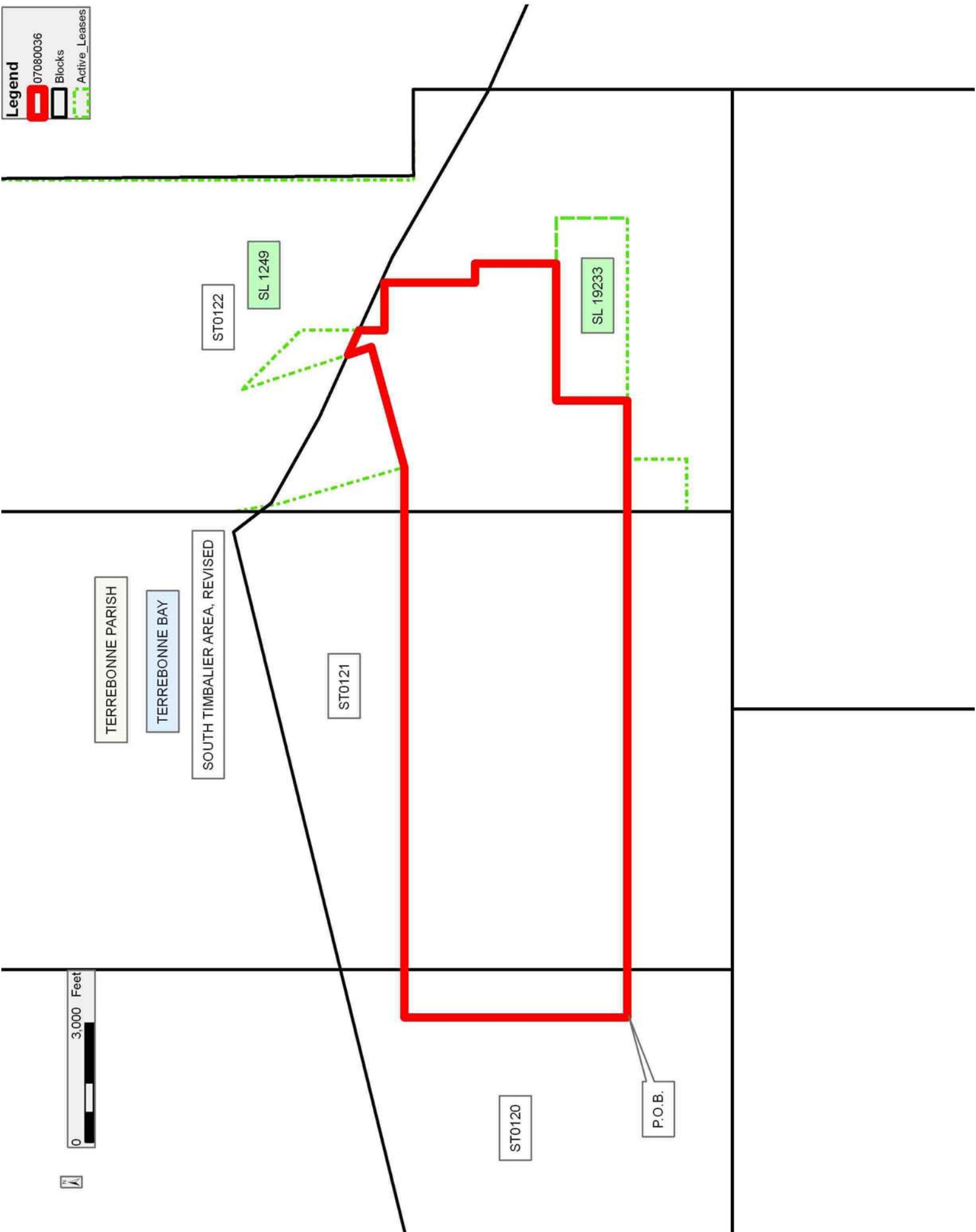

TRACT 39286 - Portion of Blocks 10, 11, 120, 121, and 122, South Timbalier Area, Revised, Terrebonne Parish, Louisiana

The beds and bottoms of all water bodies belonging to the State of Louisiana located in Blocks 10, 11, 120, 121, and 122, South Timbalier Area, Revised, together with any present lands formed by accretion to the shoreline or islands formed therein, located in Terrebonne Parish, Louisiana, owned by and not presently under mineral lease as of August 8, 2007, from the State of Louisiana, the geographical area of which is more fully described as follows: Beginning at a point within Block 120, South Timbalier Area, Revised, having Coordinates of X = 2,241,084.02 and Y = 144,193.53; thence East 1,205.86 feet to a point on the East line of said Block 120, also being a point on the West line of Block 121, South Timbalier Area, Revised, having Coordinates of X = 2,242,289.88 and Y = 144,193.53; thence East 11,518.16 feet to a point on the East line of said Block 121, also being a point on the West line of Block 122, South Timbalier Area, Revised, having Coordinates of X = 2,253,808.04 and Y = 144,193.53; thence East 1,320.00 feet to a point on the West boundary of State Lease No. 1249, as amended, having Coordinates of X = 2,255,128.04 and Y = 144,193.53; thence along the boundary of said State Lease No. 1249 the following courses: South 1,485.00 feet to a point having Coordinates of X = 2,255,128.04 and Y = 142,708.53; West 1,320.00 feet to a point on the West line of said Block 122, also being a point on the East line of said Block 121, having Coordinates of X = 2,253,808.04 and Y = 142,708.53 and South 1,155.00 feet to the Southeast corner of said Block 121, also being the Southernmost Southwest corner of said Lease No. 1249, also being a point on the North boundary of State Lease No. 2986, as amended, having Coordinates of X = 2,253,808.04 and Y = 141,553.53; thence along the boundary of said State Lease No. 2986 the following courses: West 3,295.81 feet to its Northwest corner having Coordinates of X = 2,250,512.23 and Y = 141,553.53; South 2,550.00 feet to a point having Coordinates of X = 2,250,512.23 and Y = 139,003.53; East 3,325.81 feet to a point having Coordinates of X = 2,253,838.04 and Y = 139,003.53 and South 2,040.00 feet to its Southernmost Southwest corner having Coordinates of X = 2,253,838.04 and Y = 136,963.53; thence South 1,360.00 feet to a point having Coordinates of X = 2,253,838.04 and Y = 135,603.53; thence West 4,992.02 feet to a point on the West line of Block 11, South Timbalier Area, Revised, also being a point on the East line of Block 10, South Timbalier, Revised, having Coordinates of X = 2,248,846.02 and Y = 135,603.53; thence West 7,762.00 feet to a point having Coordinates of X = 2,241,084.02 and Y = 135,603.53; thence North 5,950.00 feet to a point on the North line of said Block 10, also being a point on the South line of said Block 120 having Coordinates of X = 2,241,084.02 and Y = 141,553.53; thence North 2,640.00 feet to the point of beginning, containing approximately **2,363.57 acres**, all as more particularly outlined on a plat on file in the Office of Mineral Resources, Department of Natural Resources. All bearings, distances and coordinates are based on Louisiana Coordinate System of 1927, (North or South Zone).

NOTE: The above description of the Tract nominated for lease has been provided and corrected, where required, exclusively by the nomination party. Any mineral lease selected from this Tract and awarded by the Louisiana State Mineral Board shall be without warranty of any kind, either express, implied, or statutory, including, but not limited to, the implied warranties of merchantability and fitness for a particular purpose. Should the mineral lease awarded by the Louisiana State Mineral Board be subsequently modified, cancelled or abrogated due to the existence of conflicting leases, operating agreements, private claims or other future obligations or conditions which may affect all or any portion of the leased Tract, it shall not relieve the Lessee of the obligation to pay any bonus due thereon to the Louisiana State Mineral Board, nor shall the Louisiana State Mineral Board be obligated to refund any consideration paid by the Lessor prior to such modification, cancellation, or abrogation, including, but not limited to, bonuses, rentals and royalties.

NOTE: The State of Louisiana does hereby reserve, and this lease shall be subject to, the imprescriptible right of surface use in the nature of a servitude in favor of the Department of Natural Resources, including its Offices and Commissions, for the sole purpose of implementing, constructing, servicing and maintaining approved coastal zone management and/or restoration projects. Utilization of any and all rights derived under this lease by the mineral lessee, its agents, successors or assigns, shall not interfere with nor hinder the reasonable surface use by the Department of Natural Resources, its Offices or Commissions, as herein above reserved.

NOTE: It appears, according to our records, that a portion of this Tract is located within the restrictive safety fairway area as set out by the Corps of Engineers, U.S. Army and/or the restrictive anchorage area as set out by the U.S. Coast Guard.

Applicant: LAND MANAGEMENT SERVICES, L.L.C.

Bidder	Cash Payment	Price/Acre	Rental	Oil	Gas	Other

Legend

- 07080035
- Blocks
- Active_Leases

