

or conditions which may affect all or any portion of the leased tract, it shall not relieve the Lessee of the obligation to pay any bonus due thereon to the Louisiana State Mineral Board, nor shall the Louisiana State Mineral Board be obligated to refund any consideration paid by the Lessee prior to such modification, cancellation, or abrogation, including, but not limited to, bonuses, rents and royalties.

NOTE: The State of Louisiana does hereby reserve, and this lease shall be subject to, the imprescriptible right of surface use in the nature of a servitude in favor of the Department of Natural Resources, including its Offices and Commissions, for the sole purpose of implementing, constructing, servicing and maintaining approved coastal zone management and/or restoration projects. Utilization of any and all rights derived under this lease by the mineral lessee, its agents, successors or assigns, shall not interfere with nor hinder the reasonable surface use by the Department of Natural Resources, its Offices or Commissions, as hereinabove reserved.

Applicant: Cypress Energy Corporation

Bidder	Cash Payment	Price / Acre	Rental	Oil	Gas	Other

T 13 S - R 4 W

T 13 S - R 3 W

P.O.B.
X= 1,557,100.00'
Y= 437,800.00'

T 14 S - R 4 W

T 14 S - R 3 W

TR 33714
2,288.35 +/- ACS.
AUG. 2001



16950

Wash
Lake

CAMERON PARISH, LOUISIANA

2000' 0' 2000'



Chambers

125

TRACT 33715 - Vermilion Parish, Louisiana

All of the lands now or formerly constituting the beds and bottoms of all water bodies of every nature and description and all islands and other lands formed by accretion or reliction, except tax lands, owned by and not under mineral lease from the State of Louisiana on August 8, 2001, situated in Vermilion Parish, Louisiana, within the following described boundaries: Beginning at the North corner of State Lease No. 16995 having Coordinates of X = 1,737,400.00 and Y = 399,100.00; thence South 43 degrees 52 minutes 36 seconds West 7,213.88 feet on the Western boundary of said State Lease No. 16995 to its Southwest corner having Coordinates of X = 1,732,400.00 and Y = 393,900.00; thence West 2,100.00 feet to a point having Coordinates of X = 1,730,300.00 and Y = 393,900.00; thence North 3,800.00 feet to a point having Coordinates of X = 1,730,300.00 and Y = 397,700.00; thence North 71 degrees 33 minutes 54 seconds East 3,162.28 feet to a point having Coordinates of X = 1,733,300.00 and Y = 398,700.00; thence North 84 degrees 25 minutes 40 seconds East 4,119.47 feet to the point of beginning, containing approximately **223 gross acres and 164.26 net acres**, as shown outlined in red on a plat on file in the Office of Mineral Resources, Department of Natural Resources, as provided by the applicant. All bearings, distances and coordinates are based on Louisiana Coordinate System of 1927 (South Zone).

NOTE: The above description of the tract nominated for lease has been provided exclusively by the party nominating the tract for lease. The Louisiana State Mineral Board makes no representation as to the accuracy of the description of the nominated tract or its suitability for lease. The Louisiana State Mineral Board has made no inspection of the nominated tract for the existence of conflicting leases, operating agreements, private claims or other existing or future obligations or conditions which may affect all or any portion of the nominated tract or its suitability for lease.

Maps depicting the nominated tract, containing the bearings, distances and coordinates of the nominated tract based on the Louisiana Coordinate System of 1927, North or South Zone, as applicable, are available for public inspection and review at the offices of the Louisiana State Mineral Board from 10:00 a.m. to 3:00 p.m. Monday - Friday.

In the event of conflict between the description of the nominated tract set forth above and the description of the nominated property as contained on the maps maintained at the offices of the Louisiana State Mineral Board, the Louisiana State Mineral Board maps shall prevail and shall provide the final property description of the lease to be awarded of the nominated tract.

Any mineral lease of the nominated tract by the Louisiana State Mineral Board shall be without warranty of any kind, either express, implied, or statutory, including, but not limited to, the implied warranties or merchantability and fitness for a particular purpose. Should the mineral lease of the nominated tract awarded by the Louisiana State Mineral Board be subsequently modified, cancelled or abrogated due to the existence of conflicting leases, operating agreements, private claims or other existing of future obligations or conditions which may affect all or any portion of the leased tract, it shall not relieve the Lessee of the obligation to pay any bonus due thereon to the Louisiana State Mineral Board, nor shall the

Louisiana State Mineral Board be obligated to refund any consideration paid by the Lessee prior to such modification, cancellation, or abrogation, including, but not limited to, bonuses, rents and royalties.

NOTE: The State of Louisiana does hereby reserve, and this lease shall be subject to, the imprescriptible right of surface use in the nature of a servitude in favor of the Department of Natural Resources, including its Offices and Commissions, for the sole purpose of implementing, constructing, servicing and maintaining approved coastal zone management and/or restoration projects. Utilization of any and all rights derived under this lease by the mineral lessee, its agents, successors or assigns, shall not interfere with nor hinder the reasonable surface use by the Department of Natural Resources, its Offices or Commissions, as hereinabove reserved.

Applicant: Harold J. Anderson, Inc.

Bidder	Cash Payment	Price / Acre	Rental	Oil	Gas	Other

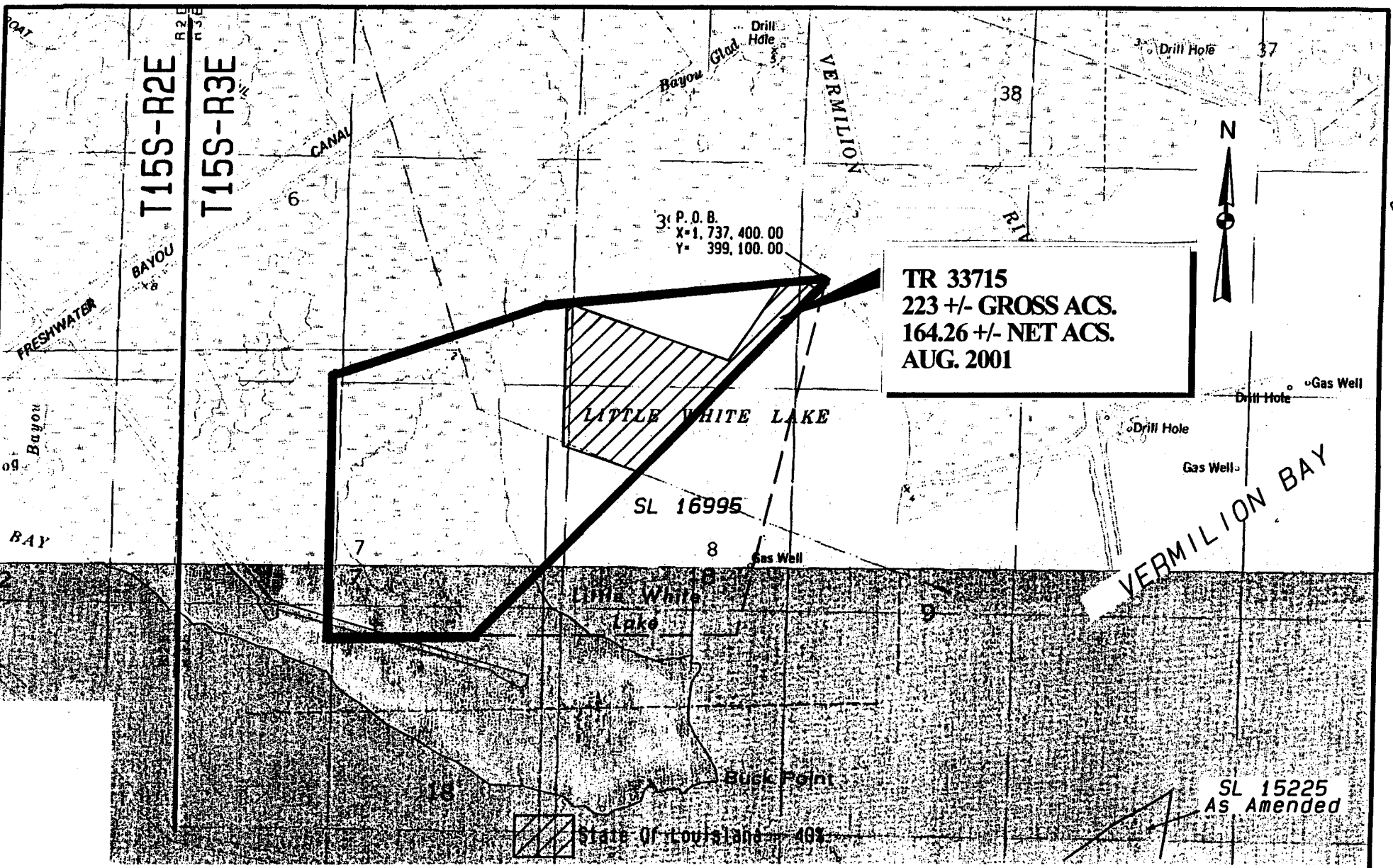

TR 33715
223 +/- GROSS ACS.
164.26 +/- NET ACS.
AUG. 2001

3 P. O. B.
 X=1,737,400.00
 Y=399,100.00

LITTLE WHITE LAKE

SL 16995

Little White Lake

Gas Well

Buck Point

State of Louisiana - 40%

SL 15225
 AS Amended

Vermilion Parish

2000 0 2000



Scale in Feet

Aug #17

188

TRACT 33716 - Pointe Coupee and West Feliciana Parishes, Louisiana

All of the lands now or formerly constituting the beds and bottoms of all water bodies of every nature and description and all islands and other lands formed by accretion or reliction, except tax lands, owned by and not under mineral lease from the State of Louisiana on August 8, 2001, situated in Pointe Coupee and West Feliciana Parishes, Louisiana, within the following described boundaries: Beginning at a point having Coordinates of X = 1,962,000.00 and Y = 748,000.00; thence run due West approximately 12,000 feet to a point having Coordinates of X = 1,950,000 and Y = 748,000; thence run due North for approximately 12,000 feet to a point having Coordinates of X = 1,950,000 and Y = 760,000; thence run due East for approximately 12,000 feet to a point having Coordinates of X = 1,962,000 and Y = 760,000; thence run due South for approximately 12,000 feet to the point of beginning, containing approximately **1,100 acres**, as shown outlined in red on a plat on file in the Office of Mineral Resources, Department of Natural Resources, as provided by the applicant. All bearings, distances and coordinates are based on Louisiana Coordinate System of 1927 (South Zone).

NOTE: The above description of the tract nominated for lease has been provided exclusively by the party nominating the tract for lease. The Louisiana State Mineral Board makes no representation as to the accuracy of the description of the nominated tract or its suitability for lease. The Louisiana State Mineral Board has made no inspection of the nominated tract for the existence of conflicting leases, operating agreements, private claims or other existing or future obligations or conditions which may affect all or any portion of the nominated tract or its suitability for lease.

Maps depicting the nominated tract, containing the bearings, distances and coordinates of the nominated tract based on the Louisiana Coordinate System of 1927, North or South Zone, as applicable, are available for public inspection and review at the offices of the Louisiana State Mineral Board from 10:00 a.m. to 3:00 p.m. Monday - Friday.

In the event of conflict between the description of the nominated tract set forth above and the description of the nominated property as contained on the maps maintained at the offices of the Louisiana State Mineral Board, the Louisiana State Mineral Board maps shall prevail and shall provide the final property description of the lease to be awarded of the nominated tract.

Any mineral lease of the nominated tract by the Louisiana State Mineral Board shall be without warranty of any kind, either express, implied, or statutory, including, but not limited to, the implied warranties or merchantability and fitness for a particular purpose. Should the mineral lease of the nominated tract awarded by the Louisiana State Mineral Board be subsequently modified, cancelled or abrogated due to the existence of conflicting leases, operating agreements, private claims or other existing of future obligations or conditions which may affect all or any portion of the leased tract, it shall not relieve the Lessee of the obligation to pay any bonus due thereon to the Louisiana State Mineral Board, nor shall the Louisiana State Mineral Board be obligated to refund any consideration paid by the Lessee prior to such modification, cancellation, or abrogation, including, but not limited to, bonuses,

rents and royalties.

Applicant: McGinty-Durham, Inc.

Bidder	Cash Payment	Price / Acre	Rental	Oil	Gas	Other

37 • Henderson Camp

Davis Lake Slough

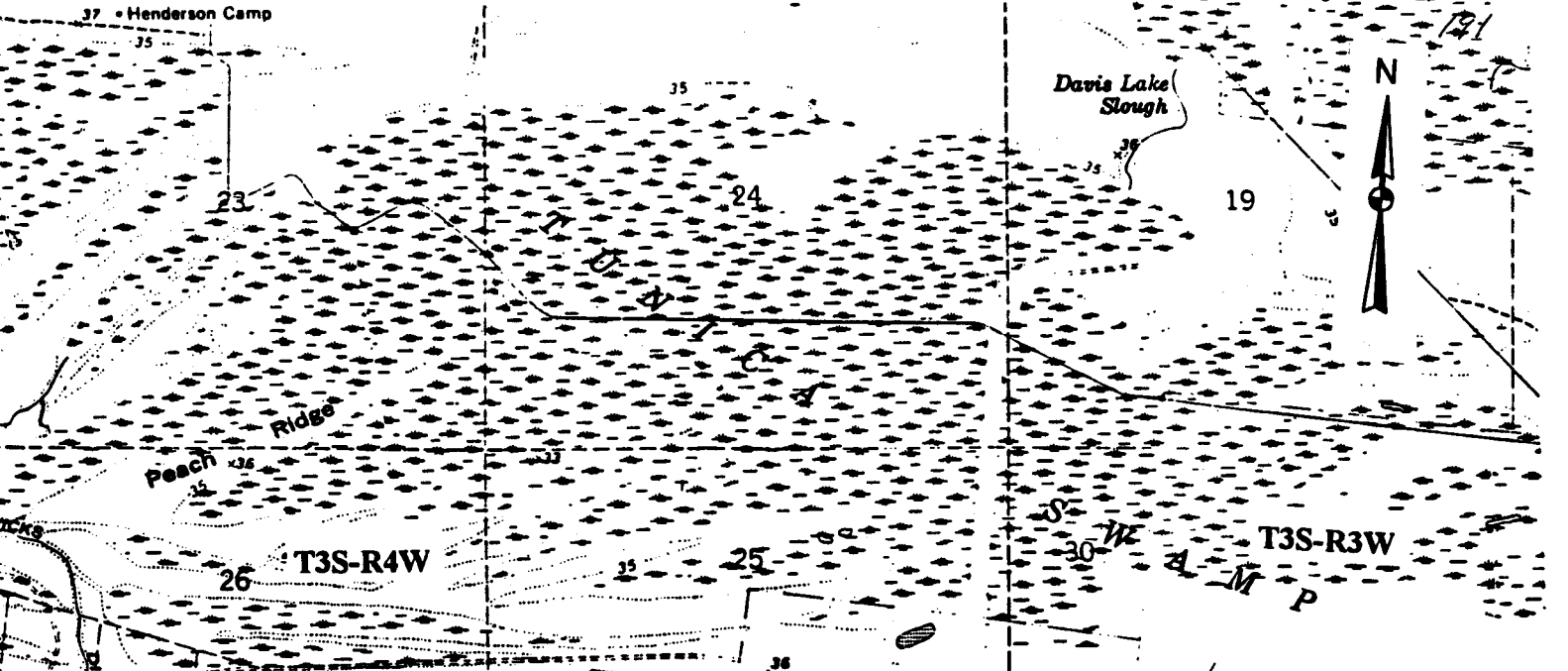

T3S-R4W

T3S-R3W

X=1,950,000
Y=760,000

X=1,962,000
Y=760,000

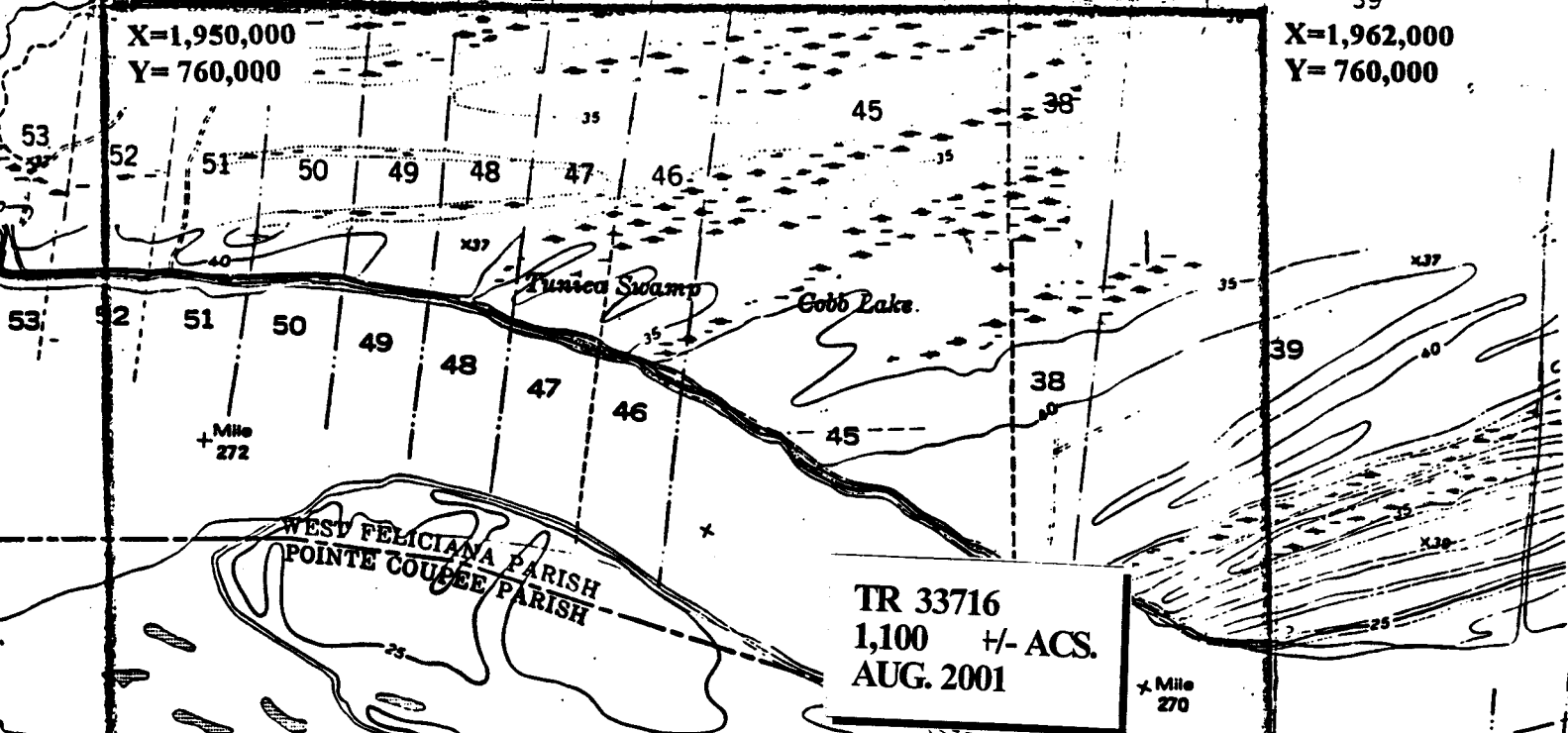

+ Mile 272

+ Mile 270

WEST FELICIANA PARISH
POINTE COUÉE PARISH

TR 33716
1,100 +/- ACS.
AUG. 2001

MISSISSIPPI

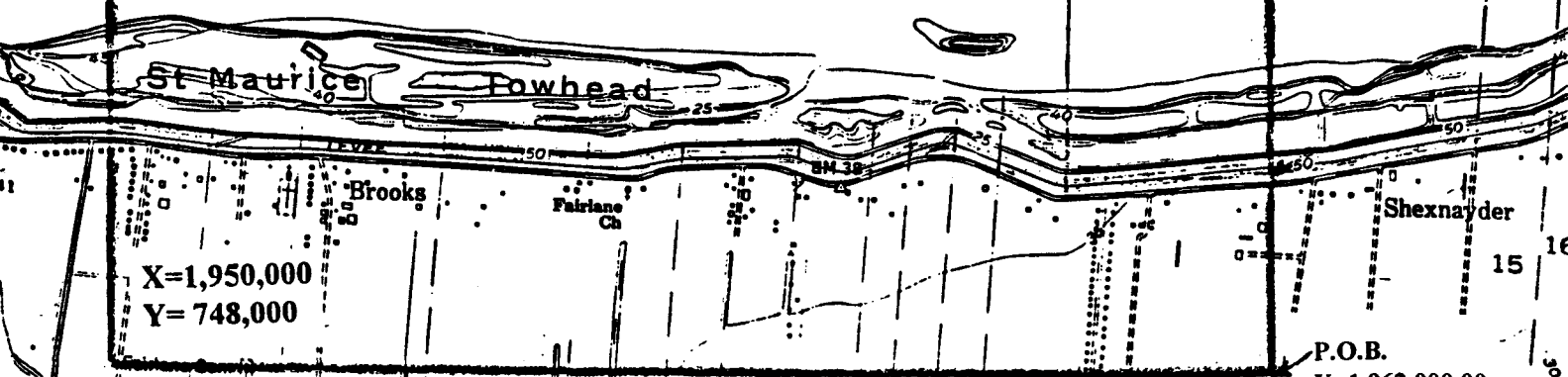

X=1,950,000
Y=748,000

P.O.B.
X=1,962,000.00
Y=748,000.00

T4S-R10E

Aug 72

TRACT 33717 - Pointe Coupee and West Feliciana Parishes, Louisiana

All of the lands now or formerly constituting the beds and bottoms of all water bodies of every nature and description and all islands and other lands formed by accretion or reliction, except tax lands, owned by and not under mineral lease from the State of Louisiana on August 8, 2001, situated in Pointe Coupee and West Feliciana Parishes, Louisiana, within the following described boundaries: Beginning at a point having Coordinates of X = 1,980,000 and Y = 750,000; thence run due West approximately 18,000 feet to a point having Coordinates of X = 1,962,000 and Y = 750,000; thence run due North for approximately 14,000 feet to a point having Coordinates of X = 1,962,000 and Y = 764,000; thence run due East for approximately 18,000 feet to a point having Coordinates of X = 1,980,000 and Y = 764,000; thence run due South for approximately 14,000 feet to the point of beginning, containing approximately 1,300.00 acres, as shown outlined in red on a plat on file in the Office of Mineral Resources, Department of Natural Resources, as provided by the applicant. All bearings, distances and coordinates are based on Louisiana Coordinate System of 1927 (South Zone).

NOTE: The above description of the tract nominated for lease has been provided exclusively by the party nominating the tract for lease. The Louisiana State Mineral Board makes no representation as to the accuracy of the description of the nominated tract or its suitability for lease. The Louisiana State Mineral Board has made no inspection of the nominated tract for the existence of conflicting leases, operating agreements, private claims or other existing or future obligations or conditions which may affect all or any portion of the nominated tract or its suitability for lease.

Maps depicting the nominated tract, containing the bearings, distances and coordinates of the nominated tract based on the Louisiana Coordinate System of 1927, North or South Zone, as applicable, are available for public inspection and review at the offices of the Louisiana State Mineral Board from 10:00 a.m. to 3:00 p.m. Monday - Friday.

In the event of conflict between the description of the nominated tract set forth above and the description of the nominated property as contained on the maps maintained at the offices of the Louisiana State Mineral Board, the Louisiana State Mineral Board maps shall prevail and shall provide the final property description of the lease to be awarded of the nominated tract.

Any mineral lease of the nominated tract by the Louisiana State Mineral Board shall be without warranty of any kind, either express, implied, or statutory, including, but not limited to, the implied warranties or merchantability and fitness for a particular purpose. Should the mineral lease of the nominated tract awarded by the Louisiana State Mineral Board be subsequently modified, cancelled or abrogated due to the existence of conflicting leases, operating agreements, private claims or other existing of future obligations or conditions which may affect all or any portion of the leased tract, it shall not relieve the Lessee of the obligation to pay any bonus due thereon to the Louisiana State Mineral Board, nor shall the Louisiana State Mineral Board be obligated to refund any consideration paid by the Lessee prior to such modification, cancellation, or abrogation, including, but not limited to, bonuses,

rents and royalties.

Applicant: McGinty-Durham, Inc.

Bidder	Cash Payment	Price / Acre	Rental	Oil	Gas	Other

X=1,962,000
Y= 764,000

X=1,980,000
Y= 764,000

T3S-R3W

TR 33717
1,300 +/- ACS.
AUG. 2001

T4S-R10E

* Mile
270

MISSISSIPPI

X=1,962,000
Y= 750,000

Shexnander

T4S-R11E

P.O.B.
X=1,980,000.00
Y= 750,000.00

