

NOT TO BE USED WITH A PORTION BID  
 FOR INFORMATIONAL PURPOSES ONLY !

MAP NOT TO SCALE

**TRACT 32722 - Assumption and St. Mary Parishes, Louisiana**

All of the lands now or formerly constituting the beds and bottoms of all water bodies of every nature and description and all islands and other lands formed by accretion or reliction, except tax lands, owned by and not under mineral lease from the State of Louisiana on August 9, 2000, situated in Assumption and St. Mary Parishes, Louisiana, within the following described boundaries: Beginning at a point having Coordinates of X = 2,079,500.00 and Y = 359,400.00; thence South approximately 5,010 feet to the Northeast corner of State Lease No. 16049, as amended, having a Coordinate of X = 2,079,500.00; thence Westerly approximately 2,595 feet along the North line of said State Lease No. 16049 to its Northwest corner; thence Southerly approximately 4,960 feet along the West line of said State Lease No. 16049 to its Southwest corner having a Coordinate of Y = 349,400.00; thence West approximately 11,470 feet to a point on the East line of State Lease No. 16443 having Coordinates of X = 2,065,500.00 and Y = 349,400.00; thence North 900.00 feet along the East line of said State Lease No. 16443 to its Northeast corner; being the Southeast corner of State Lease No. 16726 having Coordinates of X = 2,065,500.00 and Y = 350,300.00; thence North 4,253.47 feet along the East line of said State Lease No. 16726 to its Northeast corner, also being the Southeast corner of State Lease No. 15651 having Coordinates of X = 2,065,500.00 and Y = 354,553.47; thence North 4,846.53 feet along the East line of said State Lease No. 15651 to a point having Coordinates of X = 2,065,500.00 and Y = 359,400.00; thence East 14,000.00 feet to the point of beginning, **LESS AND EXCEPT**, that portion of AO233 and the sands associates therewith as same lies within the geographical boundaries of Tract 32722, and further **LESS AND EXCEPT**, AO PPPPP as limited to the Operc B sand within the geographical boundaries of the Operc B RA SUA Unit established by Commissioner's Order No. 389-F, and further **LESS AND EXCEPT**, any portion of Tract 32722 which may fall within the geographical boundaries of the Units established by Conservation Order No. 389-H recorded in COB 300-A, Folio 683, Entry No. 189809; Conservation Order No. 389-D-2 recorded in COB 300-A, Folio 675, Entry No. 189807; and Conservation Order No. 389-F-1 recorded in COB 300-A, Folio 679, Entry No. 189808; all in Assumption Parish, State of Louisiana, and further **LESS AND EXCEPT** all of the lands now or formerly constituting the beds and bottoms of all water bodies of every nature and description and all islands and other lands formed by accretion or reliction, except tax lands, owned by and not under mineral lease from the State of Louisiana, situated in Assumption and St. Mary Parish, Louisiana, within the following described boundaries: Beginning at a point having Coordinates of X = 2,075,696.2187 and Y = 359,392.0966; thence South to a point having Coordinates of X = 2,075,696.2187 and Y = 352,809.3673; thence West to a point having Coordinates of X = 2,067,636.1589 and Y = 352,809.3673; thence North to a point having Coordinates of X = 2,067,636.1589 and Y = 359,392.0966; thence East to the point of beginning, containing approximately 169.73 acres as limited to: UPPER ROB L from 14950' to 15120' as seen in the Induction - Electrical Log of the Amerada Petroleum No. 1 C.M. Thibodeaux well located in St. Mary Parish in Section 46 - 16S - 13E. LOWER ROB L from 16820' to 16900' as seen in the Induction - Electrical Log of the Amerada Petroleum No. 2 Avoca, Inc. well in St. Mary Parish in Sec. 47 - 16S - 13E. UPPER OPERC A from 17656' to 17676' as seen in the Induction - Electrical Log of the Amerada Petroleum No. 1 C.M. Thibodeaux well in St. Mary Parish in Sec. 46 - 16S - 13E. UPPER OPERC B from 17970' to 18120' as seen in the Induction - Electrical Log of the Amerada Petroleum No. 2 Avoca, Inc. well in St. Mary Parish in Sec. 47 - 16S - 13E. OPERC 3 (0 - 3) as defined in Conservation Order No. 389-D, that lies

within the above described tract, containing approximately 193 acres, as shown outlined in red on a plat on file in the Office of Mineral Resources, Department of Natural Resources. All bearings, distances and coordinates are based on Louisiana Coordinate System of 1927 (South Zone).

NOTE: The State of Louisiana does hereby reserve, and this lease shall be subject to, the imprescriptible right of surface use in the nature of a servitude in favor of the Department of Natural Resources, including its Offices and Commissions, for the sole purpose of implementing, constructing, servicing and maintaining approved coastal zone management and/or restoration projects. Utilization of any and all rights derived under this lease by the mineral lessee, its agents, successors or assigns, shall not interfere with nor hinder the reasonable surface use by the Department of Natural Resources, its Offices or Commissions, as hereinabove reserved.

Applicant: Lilly Boom

Bidder	Cash Payment	Price / Acre	Rental	Oil	Gas	Other

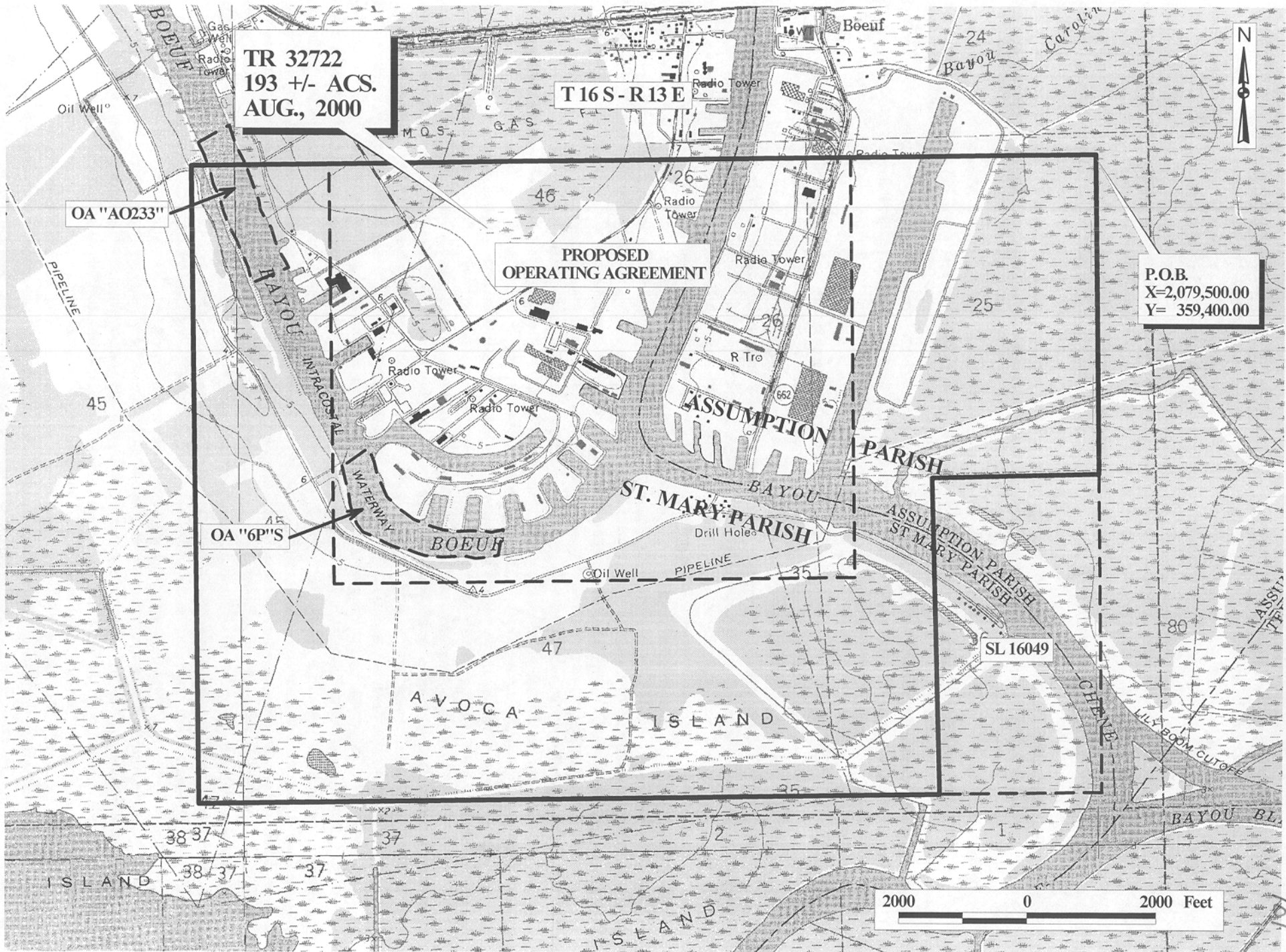

TR 32722  
193 +/- ACS.  
AUG., 2000

T 16 S - R 13 E

OA "AO233"

PROPOSED  
OPERATING AGREEMENT

P.O.B.  
X=2,079,500.00  
Y= 359,400.00

OA "6P"S

SL 16049

2000 0 2000 Feet

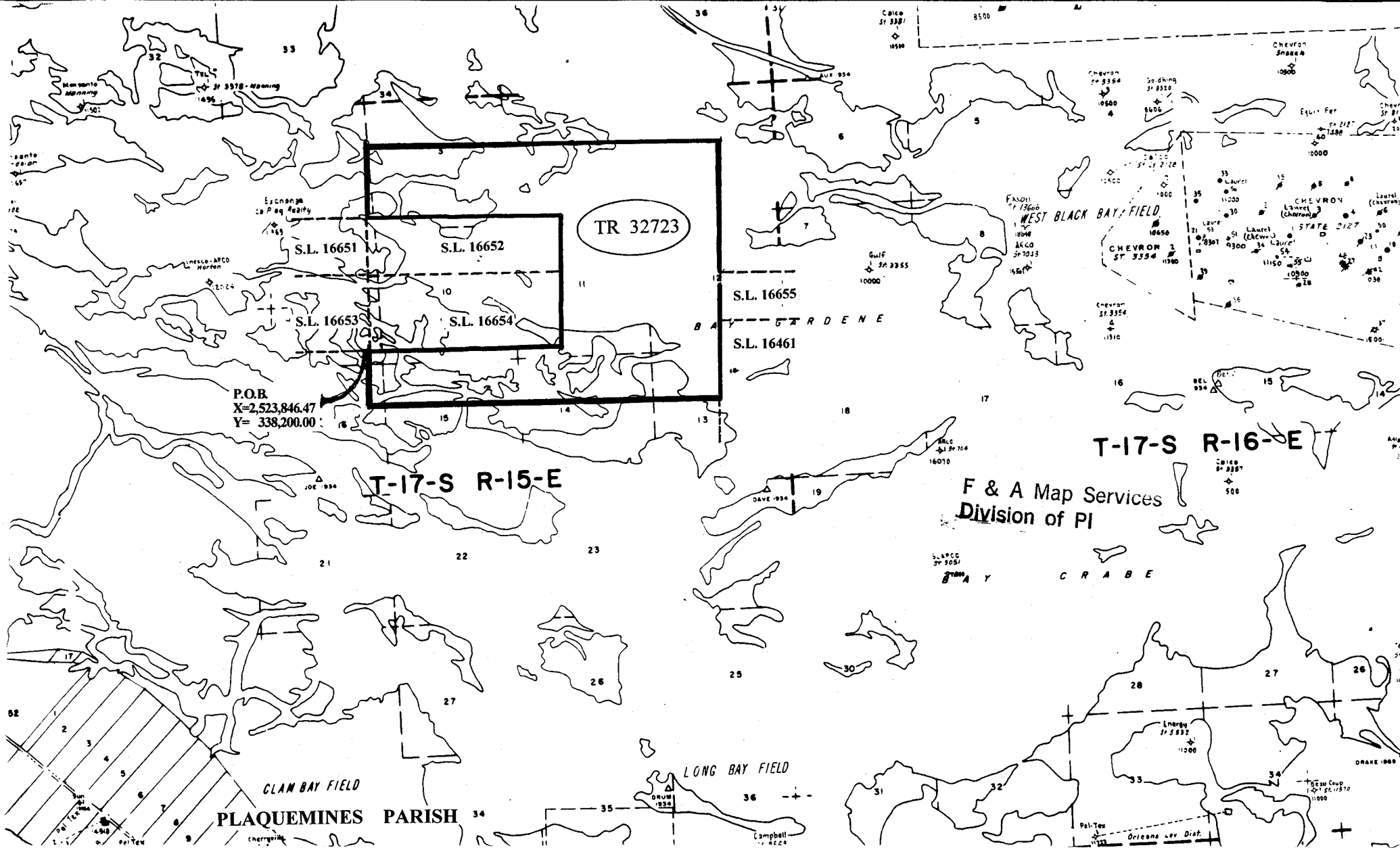

F & A Map Services  
Division of PI

MAP NOT TO SCALE

NOT TO BE USED WITH A POINTED  
FOR INFORMATIONAL PURPOSES ONLY!

**TRACT 32723 - Plaquemines Parish, Louisiana**

All of the lands now or formerly constituting the beds and bottoms of all water bodies of every nature and description and all islands and other lands formed by accretion or reliction, except tax lands, owned by and not under mineral lease from the State of Louisiana on August 9, 2000, situated in Plaquemines Parish, Louisiana, within the following described boundaries: Beginning at the Southeast corner of State Lease No. 16653, also being the Southwest corner of State Lease No. 16654 having Coordinates of X = 2,523,846.47 and Y = 338,200.00; thence East 7,453.53 feet along the South boundary of said State Lease No. 16654 to its Southeast corner having Coordinates of X = 2,531,300.00 and Y = 338,200.00; thence North 2,950.00 feet along the East line of said State Lease No. 16654 to its Northeast corner, also being the Southeast corner of State Lease No. 16652 having Coordinates of X = 2,531,300.00 and Y = 341,150.00; thence North 2,150.00 feet along the East line of said State Lease No. 16652 to its Northeast corner having Coordinates of X = 2,531,300.00 and Y = 343,300.00; thence North 89 degrees 29 minutes 35 seconds West 7,453.82 feet along the North line of said State Lease No. 16652 to its Northwest corner, also being the Northeast corner of State Lease No. 16651, having Coordinates of X = 2,523,846.47 and Y = 343,365.96; thence North 2,784.04 feet to a point having Coordinates of X = 2,523,846.47 and Y = 346,150.00; thence East 13,535.53 feet to a point having Coordinates of X = 2,537,382.00 and Y = 346,150.00; thence South 5,000.00 feet to the Northwest corner of State Lease No. 16655 having Coordinates of X = 2,537,382.00 and Y = 341,150.00; thence South 1,885.00 feet along the West line of said State Lease No. 16655 to its Southwest corner, also being the Northwest corner of State Lease No. 16461 having Coordinates of X = 2,537,382.00 and Y = 339,265.00; thence South 3,115.00 feet along the West line of said State Lease No. 16461 to a point having Coordinates of X = 2,537,382.00 and Y = 336,150.00; thence West 13,535.53 feet to a point having Coordinates of X = 2,523,846.47 and Y = 336,150.00; thence North 2,050.00 feet to the point of beginning, containing approximately 1,812 acres, as shown outlined in red on a plat on file in the Office of Mineral Resources, Department of Natural Resources. All bearings, distances and coordinates are based on Louisiana Coordinate System of 1927 (South Zone).

NOTE: The above tract is located in or near an oyster restricted area and all operations in such area must be conducted in strict conformity with the stipulations and/or regulations of the Louisiana Department of Wildlife and Fisheries.

NOTE: The State of Louisiana does hereby reserve, and this lease shall be subject to, the imprescriptible right of surface use in the nature of a servitude in favor of the Department of Natural Resources, including its Offices and Commissions, for the sole purpose of implementing, constructing, servicing and maintaining approved coastal zone management and/or restoration projects. Utilization of any and all rights derived under this lease by the mineral lessee, its agents, successors or assigns, shall not interfere with nor hinder the reasonable surface use by the Department of Natural Resources, its Offices or Commissions, as hereinabove reserved.

Applicant: G. Philip White

Bidder	Cash Payment	Price / Acre	Rental	Oil	Gas	Other

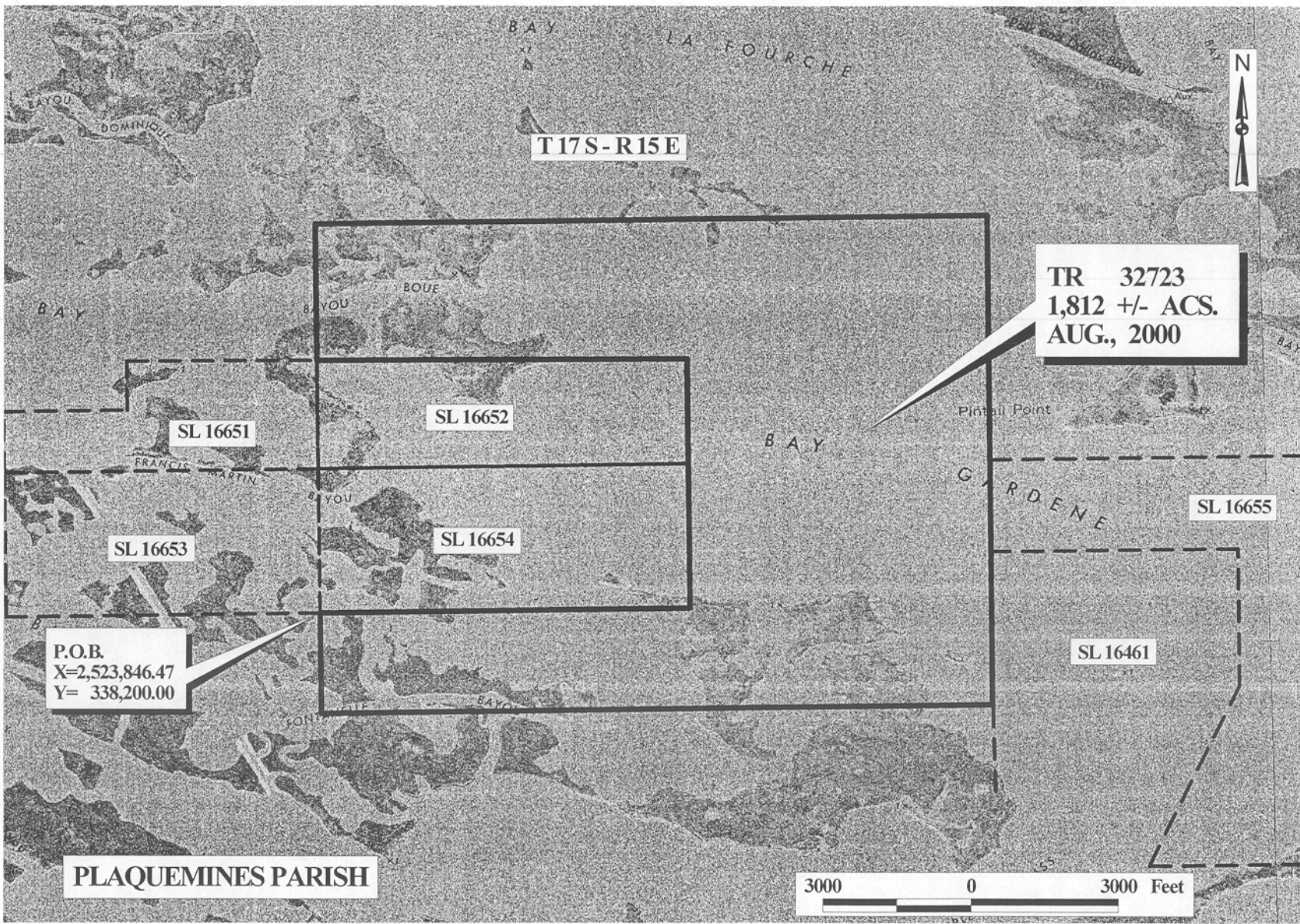

T17S-R15E

TR 32723  
1,812 +/- ACS.  
AUG., 2000

SL 16651

SL 16652

SL 16653

SL 16654

SL 16655

SL 16461

P.O.B.  
X=2,523,846.47  
Y= 338,200.00

PLAQUEMINES PARISH

3000 0 3000 Feet

OFFICIAL COPY  
OFFICE OF MINERAL RESOURCES  
DEPT. OF NATURAL RESOURCES  
DO NOT REMOVE

105