

TRACT 41053 - St. Mary Parish, Louisiana

All of the lands now or formerly constituting the beds and bottoms of all water bodies of every nature and description as to which title is vested in the State of Louisiana, together with all islands arising therein and other lands formed by accretion or by reliction, where allowed by law, excepting tax adjudicated lands, and not presently under mineral lease on July 8, 2009, situated in St. Mary Parish, Louisiana, and more particularly described as follows: Beginning at a point having Coordinates of X = 1,959,114.67 and Y = 407,200.00; thence East 14,342.67 feet to a point having Coordinates of X = 1,973,457.33 and Y = 407,200.00; thence South 13,720.00 feet to a point having Coordinates of X = 1,973,457.33 and Y = 393,480.00; thence West 14,342.67 feet to a point having Coordinates of X = 1,959,114.67 and Y = 393,480.00; thence North 13,720.00 feet to the point of beginning, containing approximately **101 acres**, all as more particularly outlined on a plat on file in the Office of Mineral Resources, Department of Natural Resources. All bearings, distances and coordinates are based on Louisiana Coordinate System of 1927, (North or South Zone), where applicable.

NOTE: The above description of the Tract nominated for lease has been provided and corrected, where required, exclusively by the nomination party. Any mineral lease selected from this Tract and awarded by the Louisiana State Mineral Board shall be without warranty of any kind, either express, implied, or statutory, including, but not limited to, the implied warranties of merchantability and fitness for a particular purpose. Should the mineral lease awarded by the Louisiana State Mineral Board be subsequently modified, cancelled or abrogated due to the existence of conflicting leases, operating agreements, private claims or other future obligations or conditions which may affect all or any portion of the leased Tract, it shall not relieve the Lessee of the obligation to pay any bonus due thereon to the Louisiana State Mineral Board, nor shall the Louisiana State Mineral Board be obligated to refund any consideration paid by the Lessor prior to such modification, cancellation, or abrogation, including, but not limited to, bonuses, rentals and royalties.

NOTE: The State of Louisiana does hereby reserve, and this lease shall be subject to, the imprescriptible right of surface use in the nature of a servitude in favor of the Department of Natural Resources, including its Offices and Commissions, for the sole purpose of implementing, constructing, servicing and maintaining approved coastal zone management and/or restoration projects. Utilization of any and all rights derived under this lease by the mineral lessee, its agents, successors or assigns, shall not interfere with nor hinder the reasonable surface use by the Department of Natural Resources, its Offices or Commissions, as herein above reserved.

Applicant: ROBERT A. SCHROEDER, INC.

Bidder	Cash Payment	Price/ Acre	Rental	Oil	Gas	Other

SIX MILE LAKE

T14S - R10E

BAYOU TECHE

YELLOW BAYOU

ST MARY PARISH

P.O.B.

0 3,000 Feet



TRACT 41054 - St. Mary Parish, Louisiana

All of the lands now or formerly constituting the beds and bottoms of all water bodies of every nature and description as to which title is vested in the State of Louisiana, together with all islands arising therein and other lands formed by accretion or by reliction, where allowed by law, excepting tax adjudicated lands, and not presently under mineral lease on July 8, 2009, situated in St. Mary Parish, Louisiana, and more particularly described as follows: Beginning at a point having Coordinates of X = 1,973,457.33 and Y = 401,008.00; thence East 14,342.67 feet to a point having Coordinates of X = 1,987,800.00 and Y = 401,008.00; thence South 15,528.00 feet to the Northeast corner of Operating Agreement AO (FSL 17647) having Coordinates of X = 1,987,800.00 and Y = 385,480.00; thence West 8,000.00 feet along the Northern boundary of said Operating Agreement AO (FSL 17647) to its Northwest corner having Coordinates of X = 1,979,800.00 and Y = 385,480.00; thence West 6,342.67 feet to a point having Coordinates of X = 1,973,457.33 and Y = 385,480.00; thence North 15,528.00 to the point of beginning, containing approximately **758 acres**, all as more particularly outlined on a plat on file in the Office of Mineral Resources, Department of Natural Resources. All bearings, distances and coordinates are based on Louisiana Coordinate System of 1927, (North or South Zone), where applicable.

NOTE: The above description of the Tract nominated for lease has been provided and corrected, where required, exclusively by the nomination party. Any mineral lease selected from this Tract and awarded by the Louisiana State Mineral Board shall be without warranty of any kind, either express, implied, or statutory, including, but not limited to, the implied warranties of merchantability and fitness for a particular purpose. Should the mineral lease awarded by the Louisiana State Mineral Board be subsequently modified, cancelled or abrogated due to the existence of conflicting leases, operating agreements, private claims or other future obligations or conditions which may affect all or any portion of the leased Tract, it shall not relieve the Lessee of the obligation to pay any bonus due thereon to the Louisiana State Mineral Board, nor shall the Louisiana State Mineral Board be obligated to refund any consideration paid by the Lessor prior to such modification, cancellation, or abrogation, including, but not limited to, bonuses, rentals and royalties.

NOTE: The State of Louisiana does hereby reserve, and this lease shall be subject to, the imprescriptible right of surface use in the nature of a servitude in favor of the Department of Natural Resources, including its Offices and Commissions, for the sole purpose of implementing, constructing, servicing and maintaining approved coastal zone management and/or restoration projects. Utilization of any and all rights derived under this lease by the mineral lessee, its agents, successors or assigns, shall not interfere with nor hinder the reasonable surface use by the Department of Natural Resources, its Offices or Commissions, as herein above reserved.

Applicant: ROBERT A. SCHROEDER, INC.

Bidder	Cash Payment	Price/ Acre	Rental	Oil	Gas	Other

Legend
09070045
Active_Leases
DOQQ2004

WAX LAKE OUTLET

SIX MILE LAKE

T14S - R10E

ST MARY PARISH

AO (FSL 17647)

T15S - R10E

0 3,000 Feet

P.O.B.

BAYOU TECHE

TRACT 41055 - Portion of Block 33, Breton Sound Area, and Block 26, Main Pass Area, Revised, Plaquemines Parish, Louisiana

All of the lands now or formerly constituting the beds and bottoms of all water bodies of every nature and description as to which title is vested in the State of Louisiana, together with all islands arising therein and other lands formed by accretion or by reliction, where allowed by law, excepting tax adjudicated lands, and not presently under mineral lease on July 8, 2009, situated in Plaquemines Parish, Louisiana, and more particularly described as follows: Beginning at a point having Coordinates of X = 2,635,350.00 and Y = 322,330.00, said point being the Northeast corner of Block 26, Main Pass Area, Revised, said point also being the Northwest corner of Block 33, Breton Sound Area; thence East 14,750.00 feet along the North line of said Block 33, Breton Sound Area, to a point having Coordinates of X = 2,650,100.00 and Y = 322,330.00, said point being the Northeast corner of said Block 33, Breton Sound Area; thence South 3,860.00 feet along the East line of said Block 33, Breton Sound Area, to a point having Coordinates of X = 2,650,100.00 and Y = 318,470.00; thence West 411.00 feet to a point having Coordinates of X = 2,649,689.00 and Y = 318,470.00, said point being a Northeast corner of State Lease No. 19078; thence along the Northern boundary of said State Lease No. 19078 the following bearings and distances, to wit: North 61 degrees 34 minutes 26 seconds West 4,117.43 feet to a point having Coordinates of X = 2,646,068.00 and Y = 320,430.00; and South 41 degrees 38 minutes 11 seconds West 1,614.99 feet to a point having Coordinates of X = 2,644,995.00 and Y = 319,223.00, said point being a Northwest corner of said State Lease No. 19078; thence North 83 degrees 17 minutes 16 seconds West 2,669.30 feet to a point having Coordinates of X = 2,642,344.00 and Y = 319,535.00, said point being a Northeast corner of State Lease No. 20003; thence along the Northern and Western boundaries of said State Lease No. 20003 the following bearings and distances, to wit: North 64 degrees 22 minutes 04 seconds West 3,076.79 feet to a point having Coordinates of X = 2,639,570.00 and Y = 320,866.00, North 88 degrees 44 minutes 51 seconds West 2,470.59 feet to a point having Coordinates of X = 2,637,100.00 and Y = 320,920.00, said point being the Northwest corner of said State Lease No. 20003; South 1,185.00 feet to a point having Coordinates of X = 2,637,100.00 and Y = 319,735.00, said point being a Southwest corner of said State Lease No. 20003; and South 56 degrees 41 minutes 40 seconds East 1,764.59 feet to a point having Coordinates of X = 2,638,574.76 and Y = 318,766.06, said point being the Northernmost corner of State Lease No. 18078; thence South 50 degrees 07 minutes 57 seconds West 4,201.48 feet along the Northern boundary of said State Lease No. 18078 to a point having Coordinates of X = 2,635,350.00 and Y = 316,072.86, said point being the Westernmost Northwest corner of said State Lease No. 18078, said point also being on the line common to said Block 26, Main Pass Area, Revised, and said Block 33, Breton Sound Area; thence West 2,280.00 feet to a point having Coordinates of X = 2,633,070.00 and Y = 316,072.86; thence North 3,599.14 feet to a point having Coordinates of X = 2,633,070.00 and Y = 319,672.00, said point being the Southeast corner of State Lease No. 16935; thence North 2,148.00

feet on and along the Eastern boundary of said State Lease No. 16935 to a point having Coordinates of X = 2,633,070.00 and Y = 321,820.00, said point being the Northeast corner of said State Lease No. 16935; thence North 510.00 feet to a point having Coordinates of X = 2,633,070.00 and Y = 322,330.00, said point being on the North line of said Block 26, Main Pass Area, Revised; thence East 2,280.00 feet on and along said North line of said Block 26, Main Pass Area, Revised, to the point of beginning, containing **1,320.96 acres**, all as more particularly outlined on a plat on file in the Office of Mineral Resources, Department of Natural Resources. All bearings, distances and coordinates are based on Louisiana Coordinate System of 1927, (North or South Zone), where applicable.

NOTE: The above description of the Tract nominated for lease has been provided and corrected, where required, exclusively by the nomination party. Any mineral lease selected from this Tract and awarded by the Louisiana State Mineral Board shall be without warranty of any kind, either express, implied, or statutory, including, but not limited to, the implied warranties of merchantability and fitness for a particular purpose. Should the mineral lease awarded by the Louisiana State Mineral Board be subsequently modified, cancelled or abrogated due to the existence of conflicting leases, operating agreements, private claims or other future obligations or conditions which may affect all or any portion of the leased Tract, it shall not relieve the Lessee of the obligation to pay any bonus due thereon to the Louisiana State Mineral Board, nor shall the Louisiana State Mineral Board be obligated to refund any consideration paid by the Lessor prior to such modification, cancellation, or abrogation, including, but not limited to, bonuses, rentals and royalties.

NOTE: The State of Louisiana does hereby reserve, and this lease shall be subject to, the imprescriptible right of surface use in the nature of a servitude in favor of the Department of Natural Resources, including its Offices and Commissions, for the sole purpose of implementing, constructing, servicing and maintaining approved coastal zone management and/or restoration projects. Utilization of any and all rights derived under this lease by the mineral lessee, its agents, successors or assigns, shall not interfere with nor hinder the reasonable surface use by the Department of Natural Resources, its Offices or Commissions, as herein above reserved.

NOTE: The Department of Wildlife and Fisheries has designated certain areas in the coastal waters of the State of Louisiana as Oyster Seed Bed Areas. The exact location of those Seed Bed Areas must be obtained from the Department of Wildlife and Fisheries and any work done under a mineral lease from the State of Louisiana may necessarily be conducted in conformity with the rules and regulations promulgated by the said Department of Wildlife and Fisheries for Oyster Seed Bed Areas.

Applicant: ROBERT A. SCHROEDER, INC.

Bidder	Cash Payment	Price/ Acre	Rental	Oil	Gas	Other

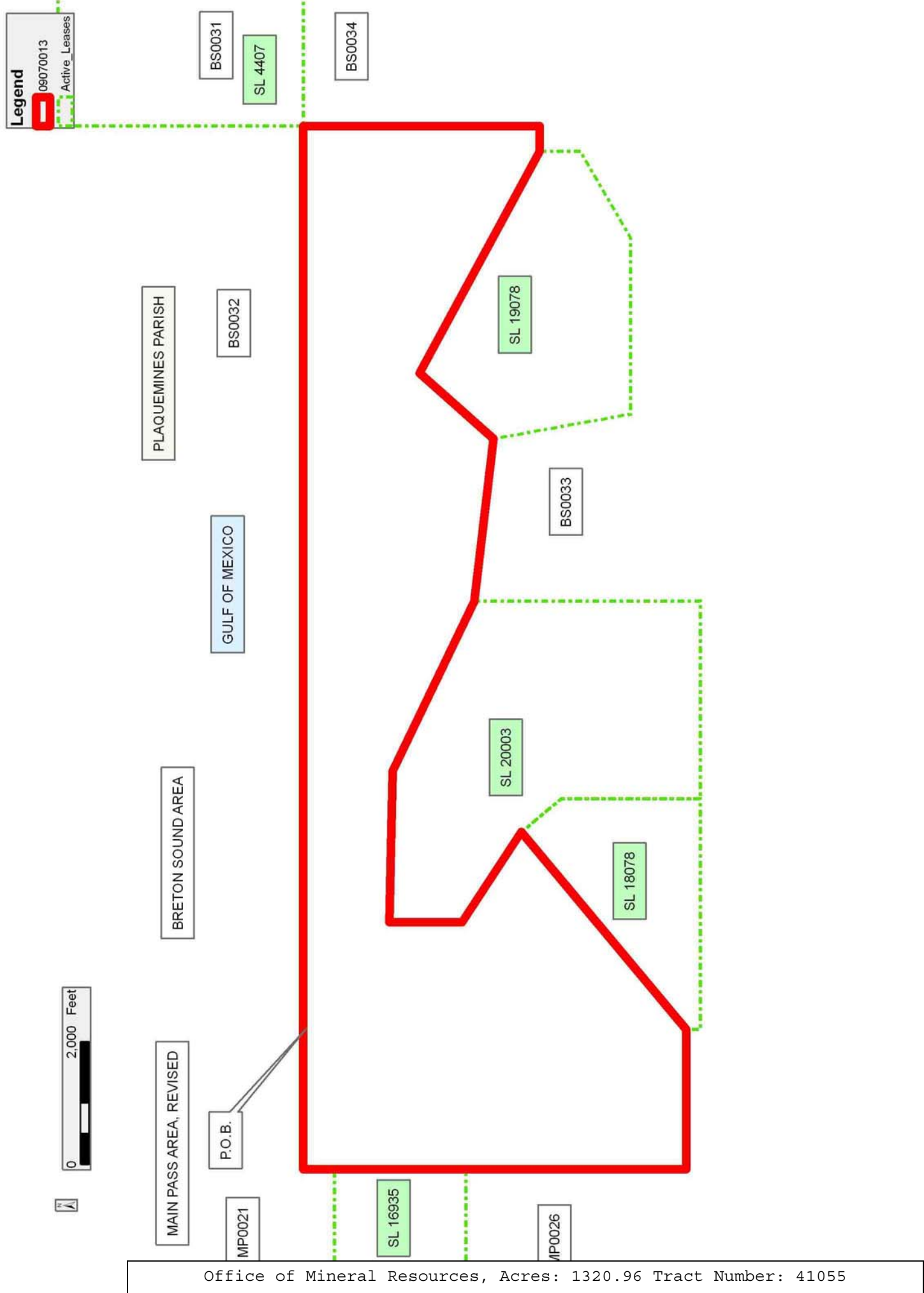

TRACT 41056 - Portion of Blocks 290, and 291, South Marsh Island Area, Iberia and Vermilion Parishes, Louisiana

All of the lands now or formerly constituting the beds and bottoms of all water bodies of every nature and description as to which title is vested in the State of Louisiana, together with all islands arising therein and other lands formed by accretion or by reliction, where allowed by law, excepting tax adjudicated lands, and not presently under mineral lease on July 8, 2009, situated in Iberia and Vermilion Parishes, Louisiana, and more particularly described as follows: Beginning at a point lying within Block 290, South Marsh Island Area, said point located on the Louisiana Coastline, as decreed by the Supreme Court of the United States, as determined by a Special Master appointed therein, in litigation styled *United States v. State of Louisiana et al No. 9 Original*, in 1975, having Coordinates of X = 1,770,962.99 and Y = 329,157.81; thence Northwesterly on a straight line along said Louisiana Coastline to a point having Coordinates of X = 1,763,190 and Y = 333,540; thence South 88 degrees 21 minutes 22 seconds East 6,622.73 feet to a point having Coordinates of X = 1,769,810.00 and Y = 333,350.00; thence North 79 degrees 31 minutes 41 seconds East 3,405.73 feet to a point having Coordinates of X = 1,773,159.00 and Y = 333,969.00; thence South 62 degrees 06 minutes 05 seconds East 4,150.37 feet to a point having Coordinates of X = 1,776,827.00 and Y = 332,027.00; thence South 30 degrees 10 minutes 39 seconds East 3,319.01 feet to a point having Coordinates of X = 1,778,495.40 and Y = 329,157.81; thence West 7,532.41 feet to the point of beginning, containing approximately **984.97 acres**, all as more particularly outlined on a plat on file in the Office of Mineral Resources, Department of Natural Resources. All bearings, distances and coordinates are based on Louisiana Coordinate System of 1927, (North or South Zone), where applicable.

NOTE: The above description of the Tract nominated for lease has been provided and corrected, where required, exclusively by the nomination party. Any mineral lease selected from this Tract and awarded by the Louisiana State Mineral Board shall be without warranty of any kind, either express, implied, or statutory, including, but not limited to, the implied warranties of merchantability and fitness for a particular purpose. Should the mineral lease awarded by the Louisiana State Mineral Board be subsequently modified, cancelled or abrogated due to the existence of conflicting leases, operating agreements, private claims or other future obligations or conditions which may affect all or any portion of the leased Tract, it shall not relieve the Lessee of the obligation to pay any bonus due thereon to the Louisiana State Mineral Board, nor shall the Louisiana State Mineral Board be obligated to refund any consideration paid by the Lessor prior to such modification, cancellation, or abrogation, including, but not limited to, bonuses, rentals and royalties.

NOTE: The acreage contained herein, being a portion of State Lease 335, 340 or 341, was subject to the litigation between Texaco, Inc. and the State of Louisiana which resulted in the Global Settlement Agreement

compromise whereby this acreage was reassigned through various mesne conveyances to the successors of William T. Burton, the original lessee of said leases from the State, (hereinafter otherwise referred to as the "ORRO's) and approved by the State Mineral Board, becoming effective April 25, 1994. Under separate agreement by and between the State and the ORRO's, certain obligations were to be met within a specified time frame or the ORRO's became obligated to release the reassigned acreage back to the State. The obligations were not met within the specified time frame and the State began securing the releases for the acreage contained herein. Due to the extremely large number of ORRO's, their nationwide and worldwide dispersal, the unreliability of available contact information and/or a present inability to obtain full, requisite cooperation, the State has, as yet, not secured releases from certain ORRO's representing approximately a .0258336 interest in this acreage. Accordingly, although the State is diligently pursuing the requisite releases affecting this acreage (the furnishing of which the ORRO's representing the stated decimal interest are obligated), nevertheless, a party obtaining a mineral lease from the State of Louisiana on the acreage contained herein shall do so with full knowledge that a complete release of all specific ORRO interest in this acreage has not as yet been secured and shall assume a business risk commensurate with the unsecured interest release.

NOTE: The Office of Mineral Resources will require a minimum bonus of \$300 per acre and a minimum royalty of 25%.

NOTE: The State of Louisiana does hereby reserve, and this lease shall be subject to, the imprescriptible right of surface use in the nature of a servitude in favor of the Department of Natural Resources, including its Offices and Commissions, for the sole purpose of implementing, constructing, servicing and maintaining approved coastal zone management and/or restoration projects. Utilization of any and all rights derived under this lease by the mineral lessee, its agents, successors or assigns, shall not interfere with nor hinder the reasonable surface use by the Department of Natural Resources, its Offices or Commissions, as herein above reserved.

NOTE: It appears, according to our records, that a portion of this Tract is located within the restrictive safety fairway area as set out by the Corps of Engineers, U.S. Army and/or the restrictive anchorage area as set out by the U.S. Coast Guard.

NOTE: The Department of Wildlife and Fisheries has designated certain areas in the coastal waters of the State of Louisiana as Oyster Seed Bed Areas. The exact location of those Seed Bed Areas must be obtained from the Department of Wildlife and Fisheries and any work done under a mineral lease from the State of Louisiana may necessarily be conducted in conformity with the rules and regulations promulgated by the said Department of Wildlife and Fisheries for Oyster Seed Bed Areas.

NOTE: All or a portion of this Tract lies within one nautical mile of the boundary of the Russell Sage or Marsh Island Wildlife Refuge and Game Preserve. Any activities connected with this lease conducted within this Tract which may pose potential environmental impacts to the said Wildlife Refuge and Game Preserve should be coordinated with the Louisiana Department of Wildlife and Fisheries.

Applicant: THEOPHILUS OIL, GAS & LAND SERVICES, LLC

Bidder	Cash Payment	Price/ Acre	Rental	Oil	Gas	Other

Legend

- 09070031
- Wildlife
- Blocks
- Counties

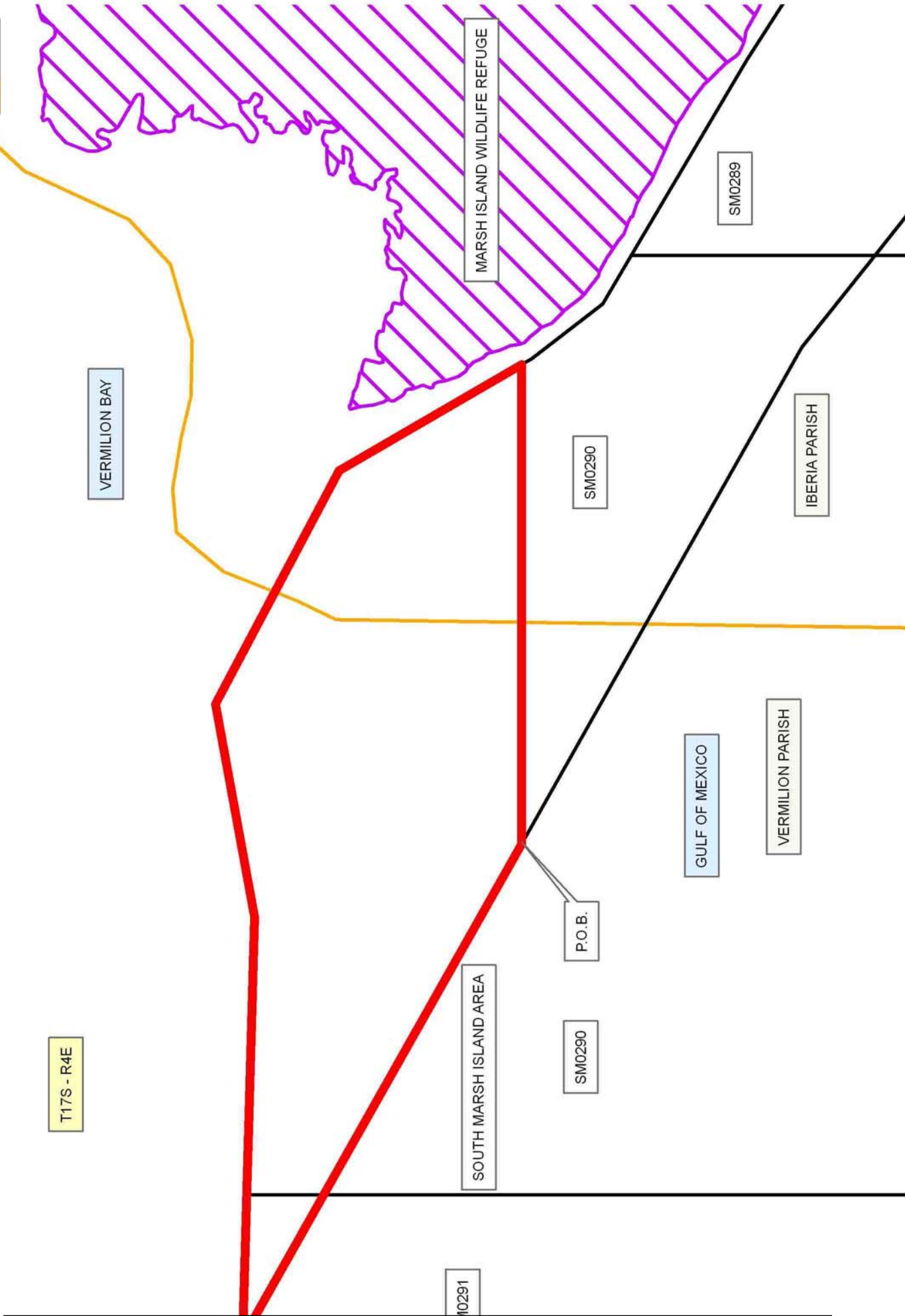

TRACT 41057 - Portion of Blocks 289, 290, and 293, South Marsh Island Area, Iberia and Vermilion Parishes, Louisiana

All of the lands now or formerly constituting the beds and bottoms of all water bodies of every nature and description as to which title is vested in the State of Louisiana, together with all islands arising therein and other lands formed by accretion or by reliction, where allowed by law, excepting tax adjudicated lands, and not presently under mineral lease on July 8, 2009, situated in Iberia and Vermilion Parishes, Louisiana, and more particularly described as follows: Beginning at a point on the Western boundary of Parcel II, Lighthouse Point, State Lease No. 340, amended, also being a point on the Louisiana Coastline, as decreed by the Supreme Court of the United States, as determined by a Special Master appointed therein, in litigation styled *United States v. State of Louisiana et al No. 9 Original*, in 1975, having Coordinates of X = 1,787,583.60 and Y = 314,020.23; thence along the boundary of said Louisiana Coastline the following: Northwesterly along a straight line to a point having Coordinates of X = 1,783,067 and Y = 321,331; Northwesterly along a straight line to a point having Coordinates of X = 1,782,391 and Y = 321,876; Northwesterly along a straight line to a point having Coordinates of X = 1,778,769 and Y = 324,757 and Northwesterly along a straight line to a point having Coordinates of X = 1,770,962.99 and Y = 329,157.81; thence East 7,859.97 feet to a point said to be on the boundary of Marsh Island Wildlife Refuge having Coordinates of X = 1,778,822.96 and Y = 329,157.81; thence along the meanders of said Marsh Island Refuge the following: Southeasterly to a point having Coordinates of X = 1,779,888.62 and Y = 327,953.78; Southeasterly to a point having Coordinates of X = 1,781,853.56 and Y = 326,910.34; Southeasterly to a point having Coordinates of X = 1,783,344.33 and Y = 325,788.32; Southeasterly to a point having Coordinates of X = 1,784,935.93 and Y = 325,103.64; Southeasterly to a point having Coordinates of X = 1,786,187.08 and Y = 324,367.15; Southeasterly to a point having Coordinates of X = 1,786,864.54 and Y = 323,692.45 and Southeasterly to a point having Coordinates of X = 1,787,583.60 and Y = 323,419.49; thence South 9,399.26 feet to the point of beginning, **LESS AND EXCEPT** that portion, if any, of the Marsh Island Wildlife Refuge that may lie within the above described tract, containing approximately **1,564.41 acres**, all as more particularly outlined on a plat on file in the Office of Mineral Resources, Department of Natural Resources. All bearings, distances and coordinates are based on Louisiana Coordinate System of 1927, (North or South Zone), where applicable.

NOTE: The above description of the Tract nominated for lease has been provided and corrected, where required, exclusively by the nomination party. Any mineral lease selected from this Tract and awarded by the Louisiana State Mineral Board shall be without warranty of any kind, either express, implied, or statutory, including, but not limited to, the implied warranties of merchantability and fitness for a particular purpose. Should the mineral lease awarded by the Louisiana State Mineral Board be subsequently modified, cancelled or abrogated due to the

existence of conflicting leases, operating agreements, private claims or other future obligations or conditions which may affect all or any portion of the leased Tract, it shall not relieve the Lessee of the obligation to pay any bonus due thereon to the Louisiana State Mineral Board, nor shall the Louisiana State Mineral Board be obligated to refund any consideration paid by the Lessor prior to such modification, cancellation, or abrogation, including, but not limited to, bonuses, rentals and royalties.

NOTE: The acreage contained herein, being a portion of State Lease 335, 340 or 341, was subject to the litigation between Texaco, Inc. and the State of Louisiana which resulted in the Global Settlement Agreement compromise whereby this acreage was reassigned through various mesne conveyances to the successors of William T. Burton, the original lessee of said leases from the State, (hereinafter otherwise referred to as the "ORRO's) and approved by the State Mineral Board, becoming effective April 25, 1994. Under separate agreement by and between the State and the ORRO's, certain obligations were to be met within a specified time frame or the ORRO's became obligated to release the reassigned acreage back to the State. The obligations were not met within the specified time frame and the State began securing the releases for the acreage contained herein. Due to the extremely large number of ORRO's, their nationwide and worldwide dispersal, the unreliability of available contact information and/or a present inability to obtain full, requisite cooperation, the State has, as yet, not secured releases from certain ORRO's representing approximately a .0258336 interest in this acreage. Accordingly, although the State is diligently pursuing the requisite releases affecting this acreage (the furnishing of which the ORRO's representing the stated decimal interest are obligated), nevertheless, a party obtaining a mineral lease from the State of Louisiana on the acreage contained herein shall do so with full knowledge that a complete release of all specific ORRO interest in this acreage has not as yet been secured and shall assume a business risk commensurate with the unsecured interest release.

NOTE: The Office of Mineral Resources will require a minimum bonus of \$300 per acre and a minimum royalty of 25%.

NOTE: The State of Louisiana does hereby reserve, and this lease shall be subject to, the imprescriptible right of surface use in the nature of a servitude in favor of the Department of Natural Resources, including its Offices and Commissions, for the sole purpose of implementing, constructing, servicing and maintaining approved coastal zone management and/or restoration projects. Utilization of any and all rights derived under this lease by the mineral lessee, its agents, successors or assigns, shall not interfere with nor hinder the reasonable surface use by the Department of Natural Resources, its Offices or Commissions, as herein above reserved.

NOTE: It appears, according to our records, that a portion of this Tract is located within the restrictive safety fairway area as set out by the

Corps of Engineers, U.S. Army and/or the restrictive anchorage area as set out by the U.S. Coast Guard.

NOTE: The Department of Wildlife and Fisheries has designated certain areas in the coastal waters of the State of Louisiana as Oyster Seed Bed Areas. The exact location of those Seed Bed Areas must be obtained from the Department of Wildlife and Fisheries and any work done under a mineral lease from the State of Louisiana may necessarily be conducted in conformity with the rules and regulations promulgated by the said Department of Wildlife and Fisheries for Oyster Seed Bed Areas.

NOTE: All or a portion of this Tract lies within one nautical mile of the boundary of the Russell Sage or Marsh Island Wildlife Refuge and Game Preserve. Any activities connected with this lease conducted within this Tract which may pose potential environmental impacts to the said Wildlife Refuge and Game Preserve should be coordinated with the Louisiana Department of Wildlife and Fisheries.

Applicant: THEOPHILUS OIL, GAS & LAND SERVICES, LLC

Bidder	Cash Payment	Price/ Acre	Rental	Oil	Gas	Other

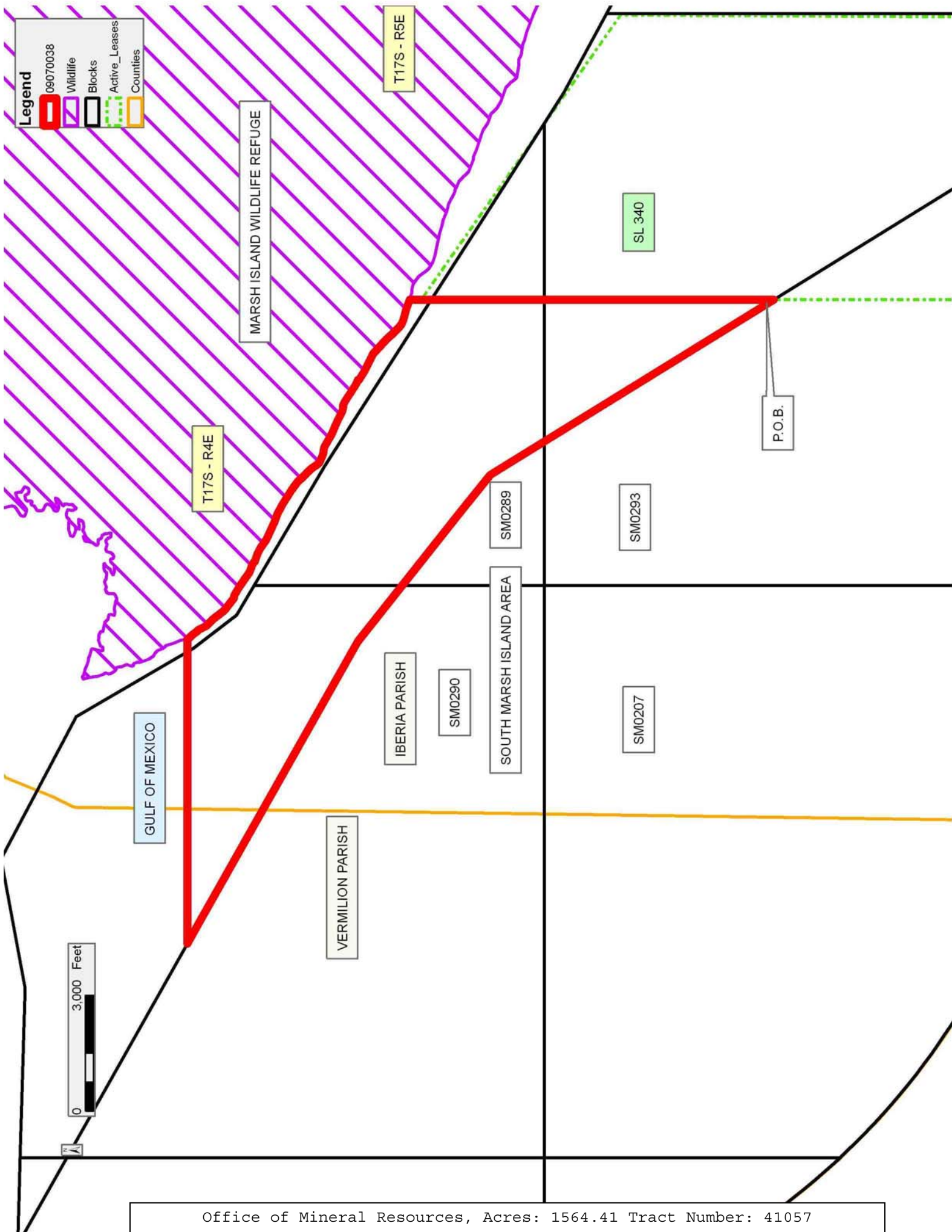

TRACT 41058 - Jefferson Parish, Louisiana

All of the lands now or formerly constituting the beds and bottoms of all water bodies of every nature and description as to which title is vested in the State of Louisiana, together with all islands arising therein and other lands formed by accretion or by reliction, where allowed by law, excepting tax adjudicated lands, and not presently under mineral lease on July 8, 2009, situated in Jefferson Parish, Louisiana, and more particularly described as follows: Beginning at the Southwest corner of State Lease No. 19908 having Coordinates of X = 2,377,350.00 and Y = 315,180.00; thence East 2,128.60 feet along the South boundary of said State Lease No. 19908 to its Southeast corner, also being a point on the Western boundary of State Lease No. 2453, as amended, having Coordinates of X = 2,379,478.60 and Y = 315,180.00; thence South 2,116.05 feet along the Western boundary of said State Lease No. 2453 to the Northeast corner of State Lease No. 18010, as amended, having Coordinates of X = 2,379,478.60 and Y = 313,063.95; thence along the boundary of said State Lease No. 18010 the following courses: Southwesterly along a curve to the right having a radius of 8,600.00 feet and a chord bearing of South 82 degrees 20 minutes 58 seconds West 175.95 feet to a point having Coordinates of X = 2,379,304.22 and Y = 313,040.53; Southwesterly along a curve to the right having a radius of 8,600.00 feet and a chord bearing of South 84 degrees 11 minutes 02 seconds West 374.78 feet to a point having Coordinates of X = 2,378,931.37 and Y = 313,002.55; South 88 degrees 07 minutes 49 seconds West 133.78 feet to a point having Coordinates of X = 2,378,797.67 and Y = 312,998.18; Southwesterly along a curve to the left having a radius of 1,422.00 feet and a chord bearing of South 81 degrees 59 minutes 37 seconds West 240.96 feet to a point having Coordinates of X = 2,378,559.05 and Y = 312,964.62; Southwesterly along a curve to the left having a radius of 465.99 feet and a chord bearing of South 62 degrees 25 minutes 10 seconds West 137.69 feet to a point having Coordinates of X = 2,378,437.01 and Y = 312,900.87; Southwesterly along a curve to the left having a radius of 317.99 feet and a chord bearing of South 31 degrees 26 minutes 54 seconds West 197.70 feet to a point having Coordinates of X = 2,378,333.86 and Y = 312,732.22; South 14 degrees 01 minutes 01 seconds West 124.80 feet to a point having Coordinates of X = 2,378,303.63 and Y = 312,611.13; Southwesterly along a curve to the left having a radius of 1,587.99 feet and a chord bearing of South 04 degrees 20 minutes 51 seconds West 298.75 feet to a point having Coordinates of X = 2,378,280.99 and Y = 312,313.24; South 00 degrees 31 minutes 56 seconds West 260.77 feet to a point having Coordinates of X = 2,378,278.57 and Y = 312,052.48; Southwesterly along a curve to the right having a radius of 8,032.00 feet and a chord bearing of South 01 degrees 38 minutes 10 seconds West 466.98 feet to a point having Coordinates of X = 2,378,265.23 and Y = 311,585.70; South 85 degrees 45 minutes 00 seconds West 180.24 feet to a point having Coordinates of X = 2,378,085.49 and Y = 311,572.34; North 04 degrees 15 minutes 00 seconds West 1,320.00 feet to a point having Coordinates of X = 2,377,987.66 and Y = 312,888.71 and South 85 degrees 45 minutes 00 seconds West 817.47 feet to its Northwest corner, also being a point on the Eastern boundary of State Lease No. 19487 having Coordinates of X =

2,377,172.44 and Y = 312,828.12; thence North 04 degrees 19 minutes 03 seconds East 1,355.72 feet along the Eastern boundary of said State Lease No. 19487 its Northeast corner having Coordinates of X = 2,377,274.50 and Y = 314,180.00; thence North 04 degrees 19 minutes 03 seconds East 1,002.85 feet to the point of beginning, containing approximately **97 acres**, all as more particularly outlined on a plat on file in the Office of Mineral Resources, Department of Natural Resources. All bearings, distances and coordinates are based on Louisiana Coordinate System of 1927, (North or South Zone), where applicable.

NOTE: The above description of the Tract nominated for lease has been provided and corrected, where required, exclusively by the nomination party. Any mineral lease selected from this Tract and awarded by the Louisiana State Mineral Board shall be without warranty of any kind, either express, implied, or statutory, including, but not limited to, the implied warranties of merchantability and fitness for a particular purpose. Should the mineral lease awarded by the Louisiana State Mineral Board be subsequently modified, cancelled or abrogated due to the existence of conflicting leases, operating agreements, private claims or other future obligations or conditions which may affect all or any portion of the leased Tract, it shall not relieve the Lessee of the obligation to pay any bonus due thereon to the Louisiana State Mineral Board, nor shall the Louisiana State Mineral Board be obligated to refund any consideration paid by the Lessor prior to such modification, cancellation, or abrogation, including, but not limited to, bonuses, rentals and royalties.

NOTE: The State of Louisiana does hereby reserve, and this lease shall be subject to, the imprescriptible right of surface use in the nature of a servitude in favor of the Department of Natural Resources, including its Offices and Commissions, for the sole purpose of implementing, constructing, servicing and maintaining approved coastal zone management and/or restoration projects. Utilization of any and all rights derived under this lease by the mineral lessee, its agents, successors or assigns, shall not interfere with nor hinder the reasonable surface use by the Department of Natural Resources, its Offices or Commissions, as herein above reserved.

NOTE: The Department of Wildlife and Fisheries has designated certain areas in the coastal waters of the State of Louisiana as Oyster Seed Bed Areas. The exact location of those Seed Bed Areas must be obtained from the Department of Wildlife and Fisheries and any work done under a mineral lease from the State of Louisiana may necessarily be conducted in conformity with the rules and regulations promulgated by the said Department of Wildlife and Fisheries for Oyster Seed Bed Areas.

Applicant: MINERAL SERVICES, INC.

Bidder	Cash Payment	Price/ Acre	Rental	Oil	Gas	Other

Legend

- 09070046
- Active_Leases
- Counties
- DOQQ2004

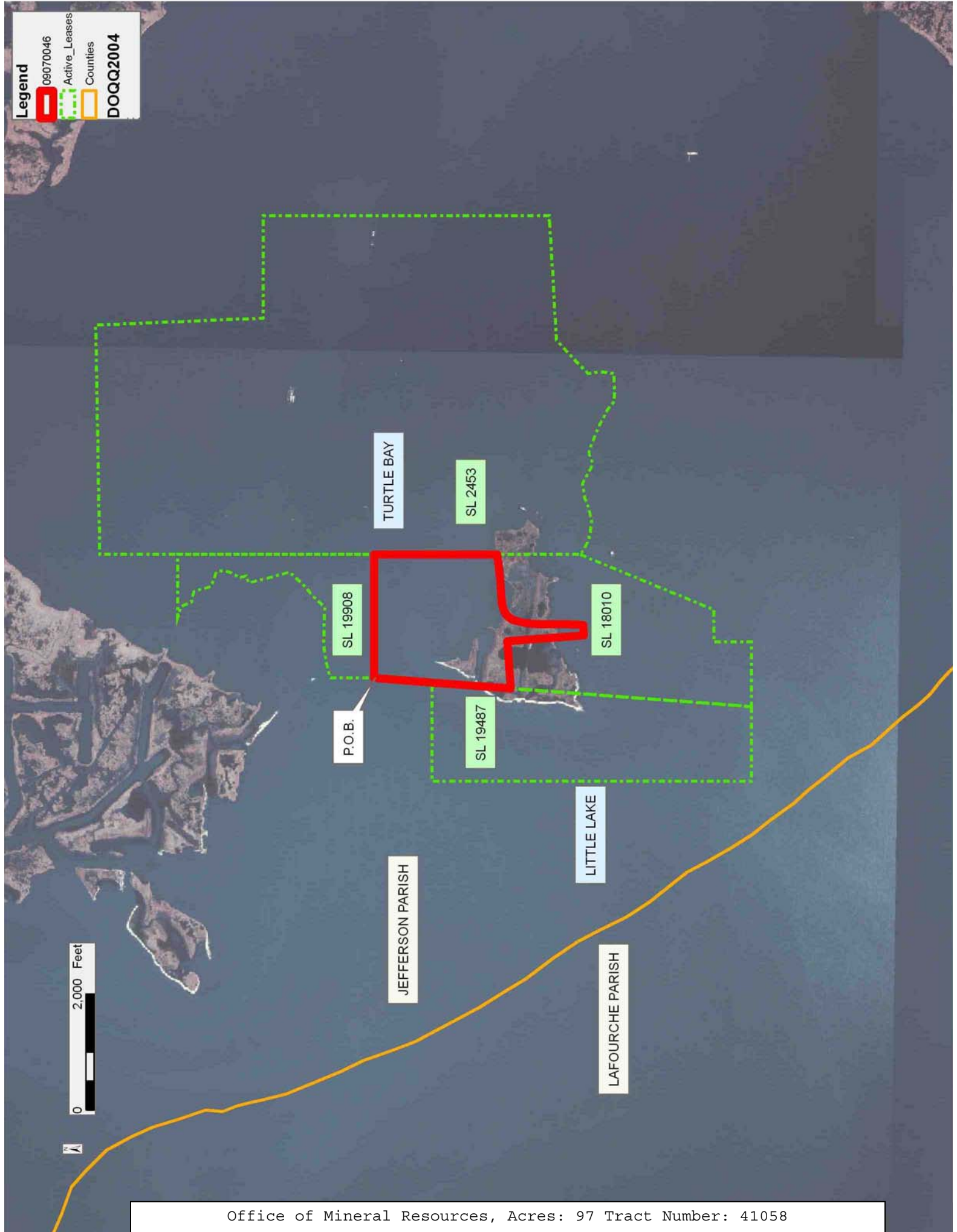

TRACT 41059 - Portion of Blocks 31, and 32, Main Pass Area, Revised, Plaquemines Parish, Louisiana

All of the lands now or formerly constituting the beds and bottoms of all water bodies of every nature and description as to which title is vested in the State of Louisiana, together with all islands arising therein and other lands formed by accretion or by reliction, where allowed by law, excepting tax adjudicated lands, and not presently under mineral lease on July 8, 2009, situated in Plaquemines Parish, Louisiana, and more particularly described as follows: Beginning at a point having Coordinates of X = 2,620,600.00 and Y = 302,216.36, said point being on the line common to Blocks 31 and 32, Main Pass Area, Revised, said point also being the Southeast corner of State Lease No. 14441; thence East 6,170.00 feet to a point having Coordinates of X = 2,626,770.00 and Y = 302,216.36; thence South 5,366.36 feet to a point having Coordinates of X = 2,626,770.00 and Y = 296,850.00, said point being a Northeast corner of State Lease No. 2125, as amended; thence along the Northern boundary of said State Lease No. 2125, as amended, the following bearings and distances, to wit: South 83 degrees 19 minutes 25 seconds West 3,010.42 feet to a point having Coordinates of X = 2,623,780.00 and Y = 296,500.00; South 55 degrees 44 minutes 20 seconds West 3,339.46 feet to a point having Coordinates of X = 2,621,020.00 and Y = 294,620.00; and North 63 degrees 26 minutes 06 seconds West 469.57 feet to a point having Coordinates of X = 2,620,600.00 and Y = 294,830.00, said point being the Northwest corner of said State Lease No. 2125, as amended, said point also being on said line common to said Blocks 31 and 32, Main Pass Area, Revised, said point also being on the Eastern boundary of State Lease No. 1958, as amended; thence along the Eastern and Northern boundaries of said State Lease No. 1958, as amended, the following bearings and distances, to wit: North 2,450.00 feet along said line common to said Blocks 31 and 32, Main Pass Area, Revised, to a point having Coordinates of X = 2,620,600.00 and Y = 297,280.00, said point being the Northeast corner of said State Lease No. 1958, as amended; and West 5,503.13 feet to a point having Coordinates of X = 2,615,096.87 and Y = 297,280.00; thence North 4,936.36 feet to a point having Coordinates of X = 2,615,096.87 and Y = 302,216.36; thence East 3,332.56 feet to a point having Coordinates of X = 2,618,429.43 and Y = 302,216.36, said point being the Southwest corner of said State Lease No. 14441; thence East 2,170.57 feet along the Southern boundary of said State Lease No. 14441 to the point of beginning, containing **1,497.98 acres**, all as more particularly outlined on a plat on file in the Office of Mineral Resources, Department of Natural Resources. All bearings, distances and coordinates are based on Louisiana Coordinate System of 1927, (North or South Zone), where applicable.

NOTE: The above description of the Tract nominated for lease has been provided and corrected, where required, exclusively by the nomination party. Any mineral lease selected from this Tract and awarded by the Louisiana State Mineral Board shall be without warranty of any kind, either express, implied, or statutory, including, but not limited to, the implied warranties of merchantability and fitness for a particular

purpose. Should the mineral lease awarded by the Louisiana State Mineral Board be subsequently modified, cancelled or abrogated due to the existence of conflicting leases, operating agreements, private claims or other future obligations or conditions which may affect all or any portion of the leased Tract, it shall not relieve the Lessee of the obligation to pay any bonus due thereon to the Louisiana State Mineral Board, nor shall the Louisiana State Mineral Board be obligated to refund any consideration paid by the Lessor prior to such modification, cancellation, or abrogation, including, but not limited to, bonuses, rentals and royalties.

NOTE: The State of Louisiana does hereby reserve, and this lease shall be subject to, the imprescriptible right of surface use in the nature of a servitude in favor of the Department of Natural Resources, including its Offices and Commissions, for the sole purpose of implementing, constructing, servicing and maintaining approved coastal zone management and/or restoration projects. Utilization of any and all rights derived under this lease by the mineral lessee, its agents, successors or assigns, shall not interfere with nor hinder the reasonable surface use by the Department of Natural Resources, its Offices or Commissions, as herein above reserved.

NOTE: The Department of Wildlife and Fisheries has designated certain areas in the coastal waters of the State of Louisiana as Oyster Seed Bed Areas. The exact location of those Seed Bed Areas must be obtained from the Department of Wildlife and Fisheries and any work done under a mineral lease from the State of Louisiana may necessarily be conducted in conformity with the rules and regulations promulgated by the said Department of Wildlife and Fisheries for Oyster Seed Bed Areas.

Applicant: ROBERT A. SCHROEDER, INC.

Bidder	Cash Payment	Price/ Acre	Rental	Oil	Gas	Other

Legend

09070012

Blocks

Active_Leases

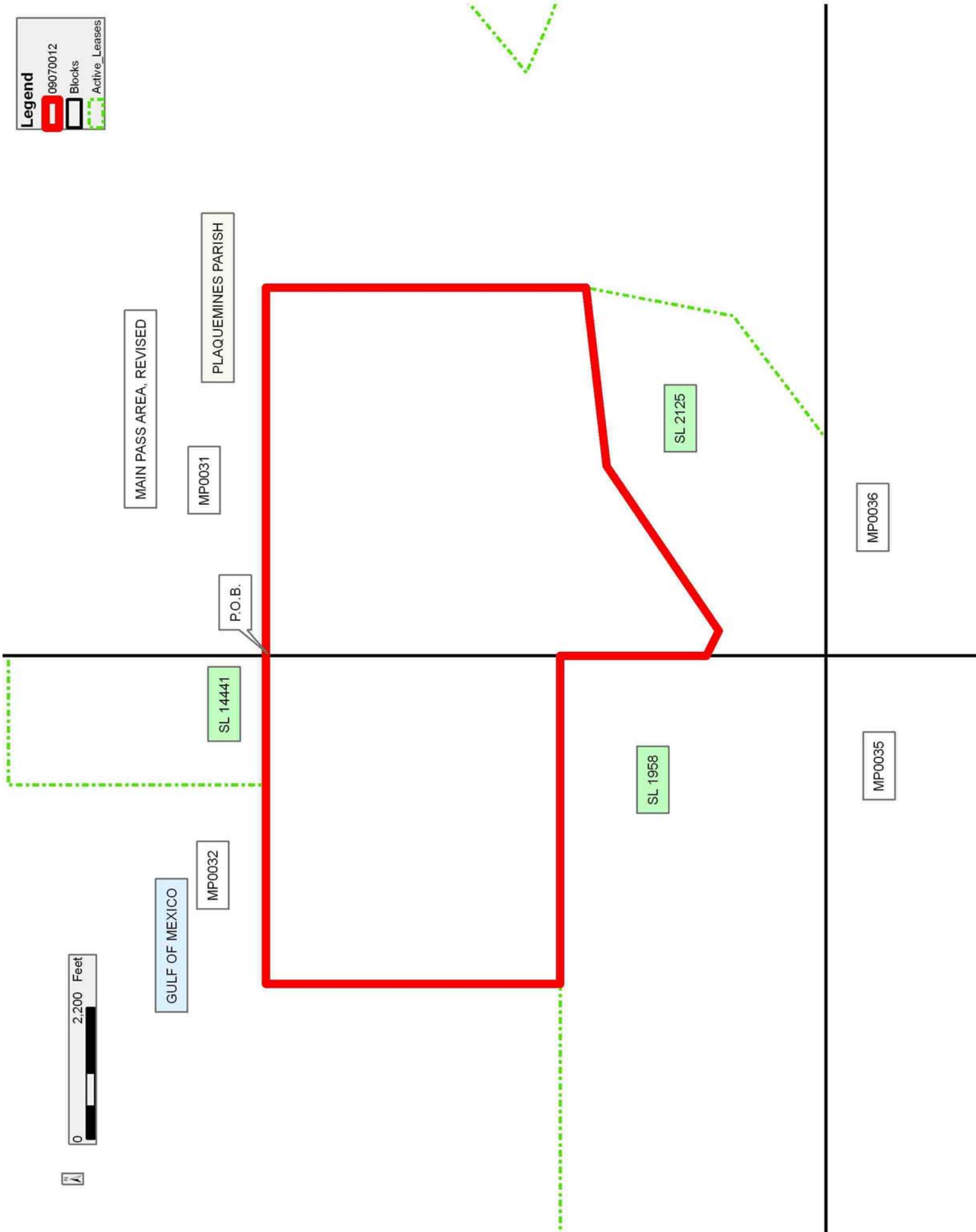

TRACT 41060 - Portion of Blocks 295, and 297, South Marsh Island Area, Iberia Parish, Louisiana

All of the lands now or formerly constituting the beds and bottoms of all water bodies of every nature and description as to which title is vested in the State of Louisiana, together with all islands arising therein and other lands formed by accretion or by reliction, where allowed by law, excepting tax adjudicated lands, and not presently under mineral lease on July 8, 2009, situated in Iberia Parish, Louisiana, and more particularly described as follows: Beginning at a point on the Northern boundary of the Mound Point portion of State Lease No. 340, as amended, said point lying within Block 295, South Marsh Island Area, having Coordinates of X = 1,810,720.72 and Y = 310,138.24; thence South 68 degrees 27 minutes 08 seconds East 3,665.45 feet to a point having Coordinates of X = 1,814,130.00 and Y = 308,792.00; thence South 72 degrees 34 minutes 33 seconds East 7,296.83 feet to a point having Coordinates of X = 1,821,092.00 and Y = 306,607.00; thence South 48 degrees 33 minutes 26 seconds East 4,518.00 feet to a point having Coordinates of X = 1,824,478.76 and Y = 303,616.65; thence South 2,572.16 feet to a point on the North boundary of State Lease No. 19408 having Coordinates of X = 1,824,478.76 and Y = 301,044.49; thence North 81 degrees 10 minutes 00 seconds West 1,002.59 feet along the North boundary of said State Lease No. 19408 to its Northwest corner located on the Northern Boundary of said Mound Point portion of State Lease No. 340 having Coordinates of X = 1,823,488.07 and Y = 301,198.45; thence North 55 degrees 00 minutes 00 seconds West 15,586.05 feet along the Northern boundary of said Mound Point portion of State Lease No. 340 to the point of beginning, containing approximately **681.93 acres**, all as more particularly outlined on a plat on file in the Office of Mineral Resources, Department of Natural Resources. All bearings, distances and coordinates are based on Louisiana Coordinate System of 1927, (North or South Zone), where applicable.

NOTE: The above description of the Tract nominated for lease has been provided and corrected, where required, exclusively by the nomination party. Any mineral lease selected from this Tract and awarded by the Louisiana State Mineral Board shall be without warranty of any kind, either express, implied, or statutory, including, but not limited to, the implied warranties of merchantability and fitness for a particular purpose. Should the mineral lease awarded by the Louisiana State Mineral Board be subsequently modified, cancelled or abrogated due to the existence of conflicting leases, operating agreements, private claims or other future obligations or conditions which may affect all or any portion of the leased Tract, it shall not relieve the Lessee of the obligation to pay any bonus due thereon to the Louisiana State Mineral Board, nor shall the Louisiana State Mineral Board be obligated to refund any consideration paid by the Lessor prior to such modification, cancellation, or abrogation, including, but not limited to, bonuses, rentals and royalties.

NOTE: The acreage contained herein, being a portion of State Lease 335, 340 or 341, was subject to the litigation between Texaco, Inc. and the

State of Louisiana which resulted in the Global Settlement Agreement compromise whereby this acreage was reassigned through various mesne conveyances to the successors of William T. Burton, the original lessee of said leases from the State, (hereinafter otherwise referred to as the "ORRO's) and approved by the State Mineral Board, becoming effective April 25, 1994. Under separate agreement by and between the State and the ORRO's, certain obligations were to be met within a specified time frame or the ORRO's became obligated to release the reassigned acreage back to the State. The obligations were not met within the specified time frame and the State began securing the releases for the acreage contained herein. Due to the extremely large number of ORRO's, their nationwide and worldwide dispersal, the unreliability of available contact information and/or a present inability to obtain full, requisite cooperation, the State has, as yet, not secured releases from certain ORRO's representing approximately a .0258336 interest in this acreage. Accordingly, although the State is diligently pursuing the requisite releases affecting this acreage (the furnishing of which the ORRO's representing the stated decimal interest are obligated), nevertheless, a party obtaining a mineral lease from the State of Louisiana on the acreage contained herein shall do so with full knowledge that a complete release of all specific ORRO interest in this acreage has not as yet been secured and shall assume a business risk commensurate with the unsecured interest release.

NOTE: The Office of Mineral Resources will require a minimum bonus of \$300 per acre and a minimum royalty of 25%.

NOTE: The State of Louisiana does hereby reserve, and this lease shall be subject to, the imprescriptible right of surface use in the nature of a servitude in favor of the Department of Natural Resources, including its Offices and Commissions, for the sole purpose of implementing, constructing, servicing and maintaining approved coastal zone management and/or restoration projects. Utilization of any and all rights derived under this lease by the mineral lessee, its agents, successors or assigns, shall not interfere with nor hinder the reasonable surface use by the Department of Natural Resources, its Offices or Commissions, as herein above reserved.

NOTE: The Department of Wildlife and Fisheries has designated certain areas in the coastal waters of the State of Louisiana as Oyster Seed Bed Areas. The exact location of those Seed Bed Areas must be obtained from the Department of Wildlife and Fisheries and any work done under a mineral lease from the State of Louisiana may necessarily be conducted in conformity with the rules and regulations promulgated by the said Department of Wildlife and Fisheries for Oyster Seed Bed Areas.

NOTE: All or a portion of this Tract lies within one nautical mile of the boundary of the Russell Sage or Marsh Island Wildlife Refuge and Game Preserve. Any activities connected with this lease conducted within this Tract which may pose potential environmental impacts to the said Wildlife

Refuge and Game Preserve should be coordinated with the Louisiana Department of Wildlife and Fisheries.

Applicant: THEOPHILUS OIL, GAS & LAND SERVICES, LLC

Bidder	Cash Payment	Price/ Acre	Rental	Oil	Gas	Other

Legend

- 09070034
- Wildlife
- Blocks
- Active_Leases

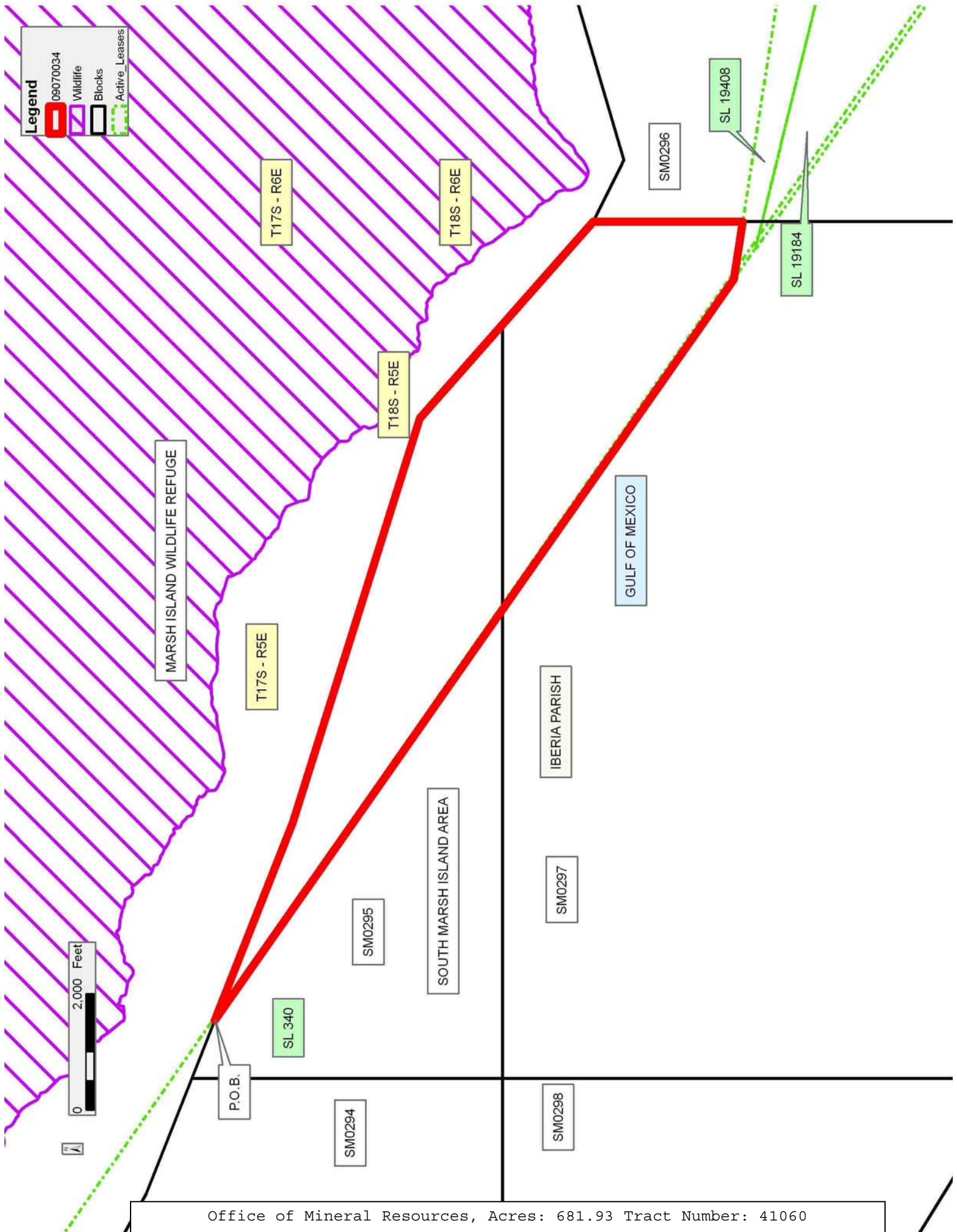

TRACT 41061 - Portion of Block 1, Eugene Island Area, Revised, and Block 296, South Marsh Island Area, Iberia Parish, Louisiana

All of the lands now or formerly constituting the beds and bottoms of all water bodies of every nature and description as to which title is vested in the State of Louisiana, together with all islands arising therein and other lands formed by accretion or by reliction, where allowed by law, excepting tax adjudicated lands, and not presently under mineral lease on July 8, 2009, situated in Iberia Parish, Louisiana, and more particularly described as follows: Beginning at a point on the West line of Block 296, South Marsh Island Area, having Coordinates of X = 1,824,478.76 and Y = 303,616.65; thence South 63 degrees 37 minutes 41 seconds East 1,185.63 feet to a point having Coordinates of X = 1,825,541.00 and Y = 303,090.00; thence North 73 degrees 36 minutes 14 seconds East 3,857.89 feet to a point having Coordinates of X = 1,829,242.00 and Y = 304,179.00; thence South 50 degrees 19 minutes 25 seconds East 6,752.30 feet to a point having Coordinates of X = 1,834,439.00 and Y = 299,868.00; thence South 55 degrees 21 minutes 26 seconds East 842.81 feet to a point on the North boundary of State Lease No. 19408 having Coordinates of X = 1,835,132.39 and Y = 299,388.89; thence North 81 degrees 10 minutes 00 seconds West 10,781.50 feet along the North boundary of said State Lease No. 19408 to a point located on the West line of said Block 296 having Coordinates of X = 1,824,478.76 and Y = 301,044.49; thence North 2,572.16 feet along the West line of said Block 296 to the point of beginning, containing approximately **573.08 acres**, all as more particularly outlined on a plat on file in the Office of Mineral Resources, Department of Natural Resources. All bearings, distances and coordinates are based on Louisiana Coordinate System of 1927, (North or South Zone), where applicable.

NOTE: The above description of the Tract nominated for lease has been provided and corrected, where required, exclusively by the nomination party. Any mineral lease selected from this Tract and awarded by the Louisiana State Mineral Board shall be without warranty of any kind, either express, implied, or statutory, including, but not limited to, the implied warranties of merchantability and fitness for a particular purpose. Should the mineral lease awarded by the Louisiana State Mineral Board be subsequently modified, cancelled or abrogated due to the existence of conflicting leases, operating agreements, private claims or other future obligations or conditions which may affect all or any portion of the leased Tract, it shall not relieve the Lessee of the obligation to pay any bonus due thereon to the Louisiana State Mineral Board, nor shall the Louisiana State Mineral Board be obligated to refund any consideration paid by the Lessor prior to such modification, cancellation, or abrogation, including, but not limited to, bonuses, rentals and royalties.

NOTE: The acreage contained herein, being a portion of State Lease 335, 340 or 341, was subject to the litigation between Texaco, Inc. and the State of Louisiana which resulted in the Global Settlement Agreement compromise whereby this acreage was reassigned through various mesne conveyances to the successors of William T. Burton, the original lessee of

said leases from the State, (hereinafter otherwise referred to as the "ORRO's) and approved by the State Mineral Board, becoming effective April 25, 1994. Under separate agreement by and between the State and the ORRO's, certain obligations were to be met within a specified time frame or the ORRO's became obligated to release the reassigned acreage back to the State. The obligations were not met within the specified time frame and the State began securing the releases for the acreage contained herein. Due to the extremely large number of ORRO's, their nationwide and worldwide dispersal, the unreliability of available contact information and/or a present inability to obtain full, requisite cooperation, the State has, as yet, not secured releases from certain ORRO's representing approximately a .0258336 interest in this acreage. Accordingly, although the State is diligently pursuing the requisite releases affecting this acreage (the furnishing of which the ORRO's representing the stated decimal interest are obligated), nevertheless, a party obtaining a mineral lease from the State of Louisiana on the acreage contained herein shall do so with full knowledge that a complete release of all specific ORRO interest in this acreage has not as yet been secured and shall assume a business risk commensurate with the unsecured interest release.

NOTE: The Office of Mineral Resources will require a minimum bonus of \$300 per acre and a minimum royalty of 25%.

NOTE: The State of Louisiana does hereby reserve, and this lease shall be subject to, the imprescriptible right of surface use in the nature of a servitude in favor of the Department of Natural Resources, including its Offices and Commissions, for the sole purpose of implementing, constructing, servicing and maintaining approved coastal zone management and/or restoration projects. Utilization of any and all rights derived under this lease by the mineral lessee, its agents, successors or assigns, shall not interfere with nor hinder the reasonable surface use by the Department of Natural Resources, its Offices or Commissions, as herein above reserved.

NOTE: The Department of Wildlife and Fisheries has designated certain areas in the coastal waters of the State of Louisiana as Oyster Seed Bed Areas. The exact location of those Seed Bed Areas must be obtained from the Department of Wildlife and Fisheries and any work done under a mineral lease from the State of Louisiana may necessarily be conducted in conformity with the rules and regulations promulgated by the said Department of Wildlife and Fisheries for Oyster Seed Bed Areas.

NOTE: All or a portion of this Tract lies within one nautical mile of the boundary of the Russell Sage or Marsh Island Wildlife Refuge and Game Preserve. Any activities connected with this lease conducted within this Tract which may pose potential environmental impacts to the said Wildlife Refuge and Game Preserve should be coordinated with the Louisiana Department of Wildlife and Fisheries.

Applicant: THEOPHILUS OIL, GAS & LAND SERVICES, LLC

Bidder	Cash Payment	Price/ Acre	Rental	Oil	Gas	Other

Legend

- 09070035
- Wildlife
- Blocks
- Active Leases

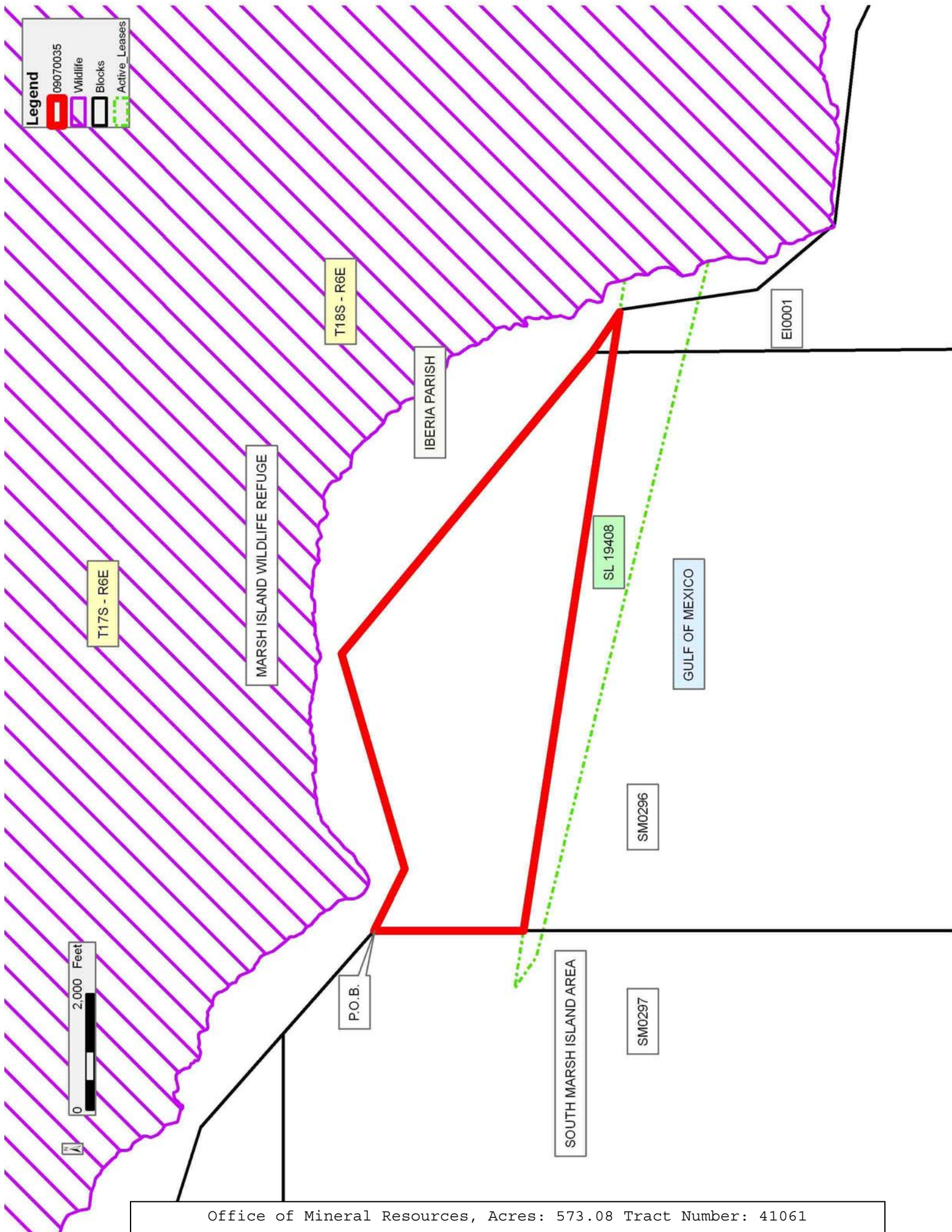

TRACT 41062 - Portion of Block 1, Eugene Island Area, Revised, Iberia Parish, Louisiana

All of the lands now or formerly constituting the beds and bottoms of all water bodies of every nature and description as to which title is vested in the State of Louisiana, together with all islands arising therein and other lands formed by accretion or by reliction, where allowed by law, excepting tax adjudicated lands, and not presently under mineral lease on July 8, 2009, situated in Iberia Parish, Louisiana, and more particularly described as follows: Beginning at a point on the East boundary of State Lease No. 19148, said point located within Block 1, Eugene Island Area, Revised, having Coordinates of X = 1,839,078.07 and Y = 295,410.67; thence South 83 degrees 29 minutes 03 seconds East 904.78 feet to a point having Coordinates of X = 1,839,977.00 and Y = 295,308.00; thence South 64 degrees 26 minutes 15 seconds East 5,367.39 feet to a point having Coordinates of X = 1,844,819.00 and Y = 292,992.00; thence North 47 degrees 24 minutes 38 seconds East 891.04 feet to a point having Coordinates of X = 1,845,475.00 and Y = 293,595.00; thence North 45 degrees 45 minutes 03 seconds East 1,596.16 feet to a point on the West boundary of State Lease No. 19409 having Coordinates of X = 1,846,618.35 and Y = 294,708.77; thence along the boundary of said State Lease No. 19409 the following courses: South 43 degrees 30 minutes 28 seconds East 1,075.90 feet to its Southwest corner having Coordinates of X = 1,847,359.05 and Y = 293,928.44 and East 2,346.54 feet to its Southeast corner having Coordinates of X = 1,849,705.59 and Y = 293,928.44; thence South 01 degrees 25 minutes 49 seconds East 2,916.77 feet to the Northwest corner of State Lease No. 19297 having Coordinates of X = 1,849,778.40 and Y = 291,012.58; thence South 3,730.10 feet along the West boundary of said State Lease No. 19297 to a point on the Northern boundary of State Lease No. 19414 having Coordinates of X = 1,849,778.40 and Y = 287,282.48; thence North 77 degrees 23 minutes 11 seconds West 3,810.20 feet along the Northern boundary of said State Lease No. 19414 to its Northwest corner having Coordinates of X = 1,846,060.16 and Y = 288,114.53; thence North 70 degrees 44 minutes 39 seconds West 2,700.13 feet to the Northeast corner of State Lease No. 19415 having Coordinates of X = 1,843,511.09 and Y = 289,005.00; thence West 3,285.09 feet along the North boundary of said State Lease No. 19415 to the Southeast corner of said State Lease No. 19148 having Coordinates of X = 1,840,226.00 and Y = 289,005.00; thence along the boundary of said State Lease No. 19148 the following courses: North 02 degrees 02 minutes 36 seconds West 789.74 feet to a corner having Coordinates of X = 1,840,197.84 and Y = 289,794.24; North 03 degrees 27 minutes 39 seconds West 4,475.64 feet to a corner having Coordinates of X = 1,839,927.66 and Y = 294,261.72 and North 36 degrees 28 minutes 52 seconds West 1,428.95 feet to the point of beginning, containing approximately **1,268.92 acres**, all as more particularly outlined on a plat on file in the Office of Mineral Resources, Department of Natural Resources. All bearings, distances and coordinates are based on Louisiana Coordinate System of 1927, (North or South Zone), where applicable.

NOTE: The above description of the Tract nominated for lease has been provided and corrected, where required, exclusively by the nomination party. Any mineral lease selected from this Tract and awarded by the Louisiana State Mineral Board shall be without warranty of any kind, either express, implied, or statutory, including, but not limited to, the implied warranties of merchantability and fitness for a particular purpose. Should the mineral lease awarded by the Louisiana State Mineral Board be subsequently modified, cancelled or abrogated due to the existence of conflicting leases, operating agreements, private claims or other future obligations or conditions which may affect all or any portion of the leased Tract, it shall not relieve the Lessee of the obligation to pay any bonus due thereon to the Louisiana State Mineral Board, nor shall the Louisiana State Mineral Board be obligated to refund any consideration paid by the Lessor prior to such modification, cancellation, or abrogation, including, but not limited to, bonuses, rentals and royalties.

NOTE: The Office of Mineral Resources will require a minimum bonus of \$300 per acre and a minimum royalty of 25%.

NOTE: The State of Louisiana does hereby reserve, and this lease shall be subject to, the imprescriptible right of surface use in the nature of a servitude in favor of the Department of Natural Resources, including its Offices and Commissions, for the sole purpose of implementing, constructing, servicing and maintaining approved coastal zone management and/or restoration projects. Utilization of any and all rights derived under this lease by the mineral lessee, its agents, successors or assigns, shall not interfere with nor hinder the reasonable surface use by the Department of Natural Resources, its Offices or Commissions, as herein above reserved.

NOTE: The Department of Wildlife and Fisheries has designated certain areas in the coastal waters of the State of Louisiana as Oyster Seed Bed Areas. The exact location of those Seed Bed Areas must be obtained from the Department of Wildlife and Fisheries and any work done under a mineral lease from the State of Louisiana may necessarily be conducted in conformity with the rules and regulations promulgated by the said Department of Wildlife and Fisheries for Oyster Seed Bed Areas.

NOTE: All or a portion of this Tract lies within one nautical mile of the boundary of the Russell Sage or Marsh Island Wildlife Refuge and Game Preserve. Any activities connected with this lease conducted within this Tract which may pose potential environmental impacts to the said Wildlife Refuge and Game Preserve should be coordinated with the Louisiana Department of Wildlife and Fisheries.

Applicant: THEOPHILUS OIL, GAS & LAND SERVICES, LLC

Bidder	Cash Payment	Price/ Acre	Rental	Oil	Gas	Other

