

NOT TO BE USED WITH A PORTION ONLY
FOR INFORMATIONAL PURPOSES ONLY

TR 32654

P.O.B.
X=2,598,000.00
Y= 243,300.00

T-20-S R-30-E

F & A Map Services
Division of PI

MAP NOT TO SCALE

PLAQUEMINES PARISH

TRACT 32654 - Plaquemines Parish, Louisiana

All of the lands now or formerly constituting the beds and bottoms of all water bodies of every nature and description and all islands and other lands formed by accretion or reliction, except tax lands, owned by and not under mineral lease from the State of Louisiana on July 12, 2000, situated in Plaquemines Parish, Louisiana, within the following described boundaries: Beginning at a point having Coordinates of X = 2,598,000.00 and Y = 243,300.00; thence East 13,600.00 feet to a point having Coordinates of X = 2,611,600.00 and Y = 243,300.00; thence South 8,000.00 feet to a point having Coordinates of X = 2,611,600.00 and Y = 235,300.00; thence West 13,600.00 feet to a point having Coordinates of X = 2,598,000.00 and Y = 235,300.00; thence North 8,000.00 feet to the point of beginning, containing approximately **705 acres**, as shown outlined in red on a plat on file in the Office of Mineral Resources, Department of Natural Resources. All bearings, distances and coordinates are based on Louisiana Coordinate System of 1927 (South Zone).

NOTE: The above tract is located in or near an oyster restricted area and all operations in such area must be conducted in strict conformity with the stipulations and/or regulations of the Louisiana Department of Wildlife and Fisheries.

NOTE: The State of Louisiana does hereby reserve, and this lease shall be subject to, the imprescriptible right of surface use in the nature of a servitude in favor of the Department of Natural Resources, including its Offices and Commissions, for the sole purpose of implementing, constructing, servicing and maintaining approved coastal zone management and/or restoration projects. Utilization of any and all rights derived under this lease by the mineral lessee, its agents, successors or assigns, shall not interfere with nor hinder the reasonable surface use by the Department of Natural Resources, its Offices or Commissions, as hereinabove reserved.

Applicant: The Louisiana Land and Exploration Company

Bidder	Cash Payment	Price / Acre	Rental	Oil	Gas	Other

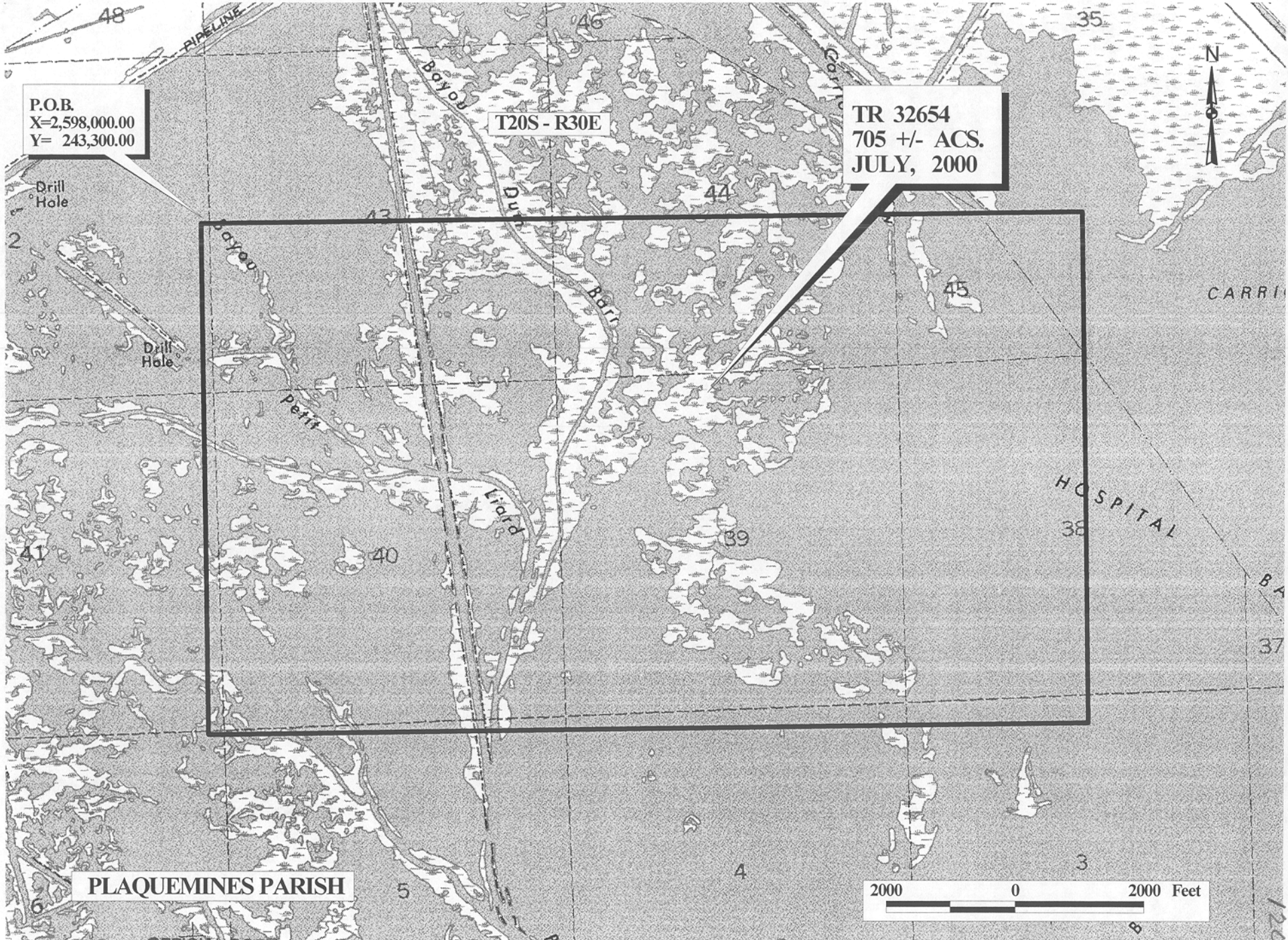

P.O.B.
X=2,598,000.00
Y= 243,300.00

T20S - R30E

TR 32654
705 +/- ACS.
JULY, 2000

PLAQUEMINES PARISH

OFFICIAL COPY
OFFICE OF MINERAL RESOURCES
DEPT. OF NATURAL RESOURCES
DO NOT REMOVE

NOT TO BE USED WITH A PORTION BLD.
FOR INFORMATIONAL PURPOSES ONLY

P.O.B
X= 2,562,300.00
Y= 307,300.00

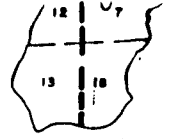

TR 32655

AUGUSTE BAY

CALIFORNIA
SOUTHAMPTON BAY

MANGROVE PT

F & A Map Services
Division of PI

T-18-S-R-16-E
T-19-S-R-16-E

T-18-S-R-17-E
T-19-S-R-17-E

MAP NOT TO SCALE

PLAQUEMINES PARISH

WAIN FIELD

SHREVEPORT

SHREVEPORT

SHREVEPORT

SHREVEPORT

SHREVEPORT

SHREVEPORT

SHREVEPORT

SHREVEPORT

SHREVEPORT

SHREVEPORT

SHREVEPORT

SHREVEPORT

SHREVEPORT

SHREVEPORT

SHREVEPORT

SHREVEPORT

SHREVEPORT

SHREVEPORT

SHREVEPORT

SHREVEPORT

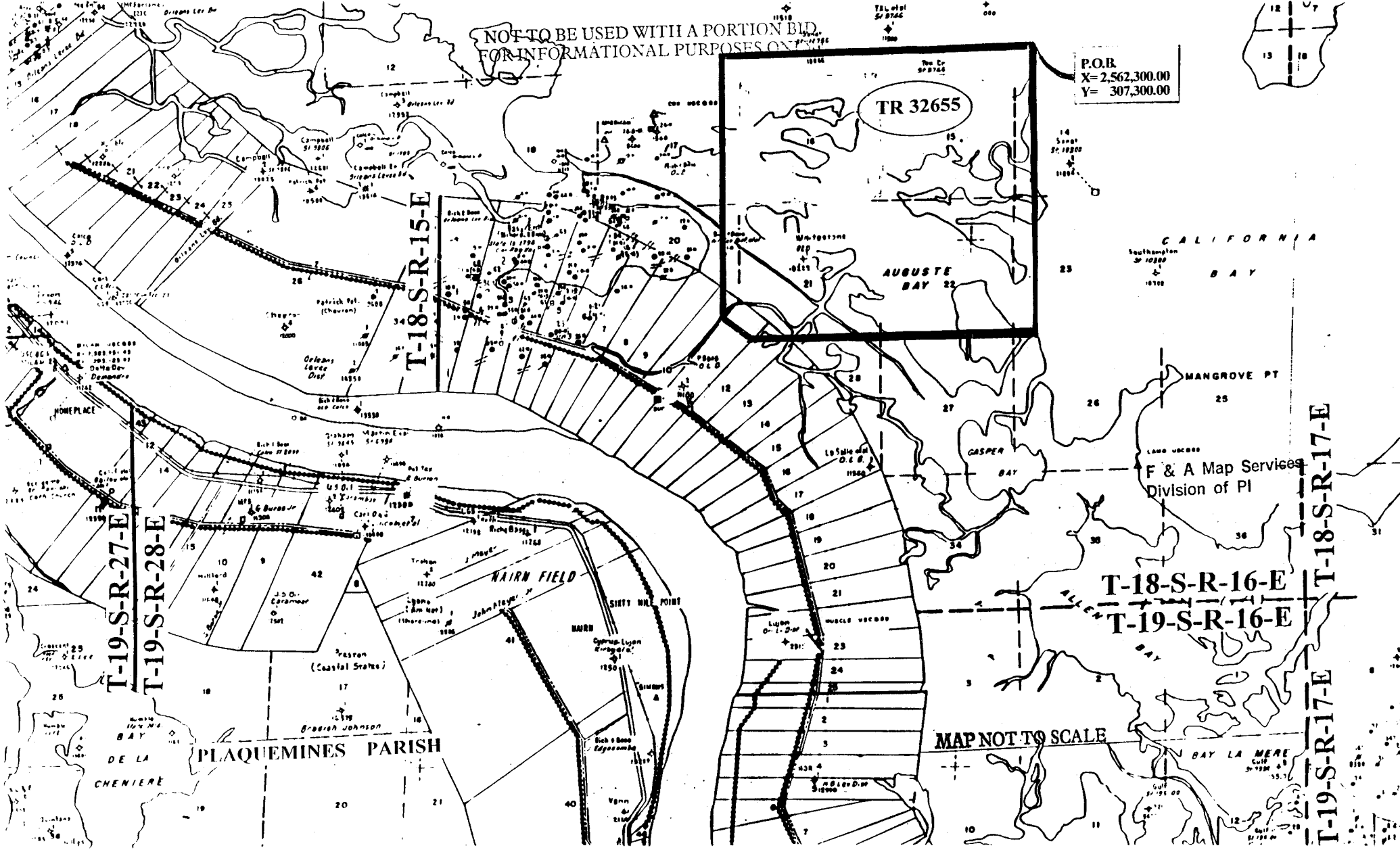

TRACT 32655 - Plaquemines Parish, Louisiana

All of the lands now or formerly constituting the beds and bottoms of all water bodies of every nature and description and all islands and other lands formed by accretion or reliction, except tax lands, owned by and not under mineral lease from the State of Louisiana on July 12, 2000, situated in Plaquemines Parish, Louisiana, within the following described boundaries: Beginning at a point having Coordinates of X = 2,562,300.00 and Y = 307,300.00; thence South 11,000.00 feet to a point having Coordinates of X = 2,562,300.00 and Y = 296,300.00; thence West 9,700.00 feet to a point having Coordinates of X = 2,552,600.00 and Y = 296,300.00; thence North 53 degrees 07 minutes 48 seconds West 2,500.00 feet to a point having Coordinates of X = 2,550,600.00 and Y = 297,800.00; thence North 9,500.00 feet to a point having Coordinates of X = 2,550,600.00 and Y = 307,300.00; thence East 11,700.00 feet to the point of beginning, containing approximately 1,761 acres, as shown outlined in red on a plat on file in the Office of Mineral Resources, Department of Natural Resources. All bearings, distances and coordinates are based on Louisiana Coordinate System of 1927 (South Zone).

NOTE: The above tract is located in or near an oyster restricted area and all operations in such area must be conducted in strict conformity with the stipulations and/or regulations of the Louisiana Department of Wildlife and Fisheries.

NOTE: The State of Louisiana does hereby reserve, and this lease shall be subject to, the imprescriptible right of surface use in the nature of a servitude in favor of the Department of Natural Resources, including its Offices and Commissions, for the sole purpose of implementing, constructing, servicing and maintaining approved coastal zone management and/or restoration projects. Utilization of any and all rights derived under this lease by the mineral lessee, its agents, successors or assigns, shall not interfere with nor hinder the reasonable surface use by the Department of Natural Resources, its Offices or Commissions, as hereinabove reserved.

Applicant: Boudreaux & Thibodeaux, Ltd.

Bidder	Cash Payment	Price / Acre	Rental	Oil	Gas	Other

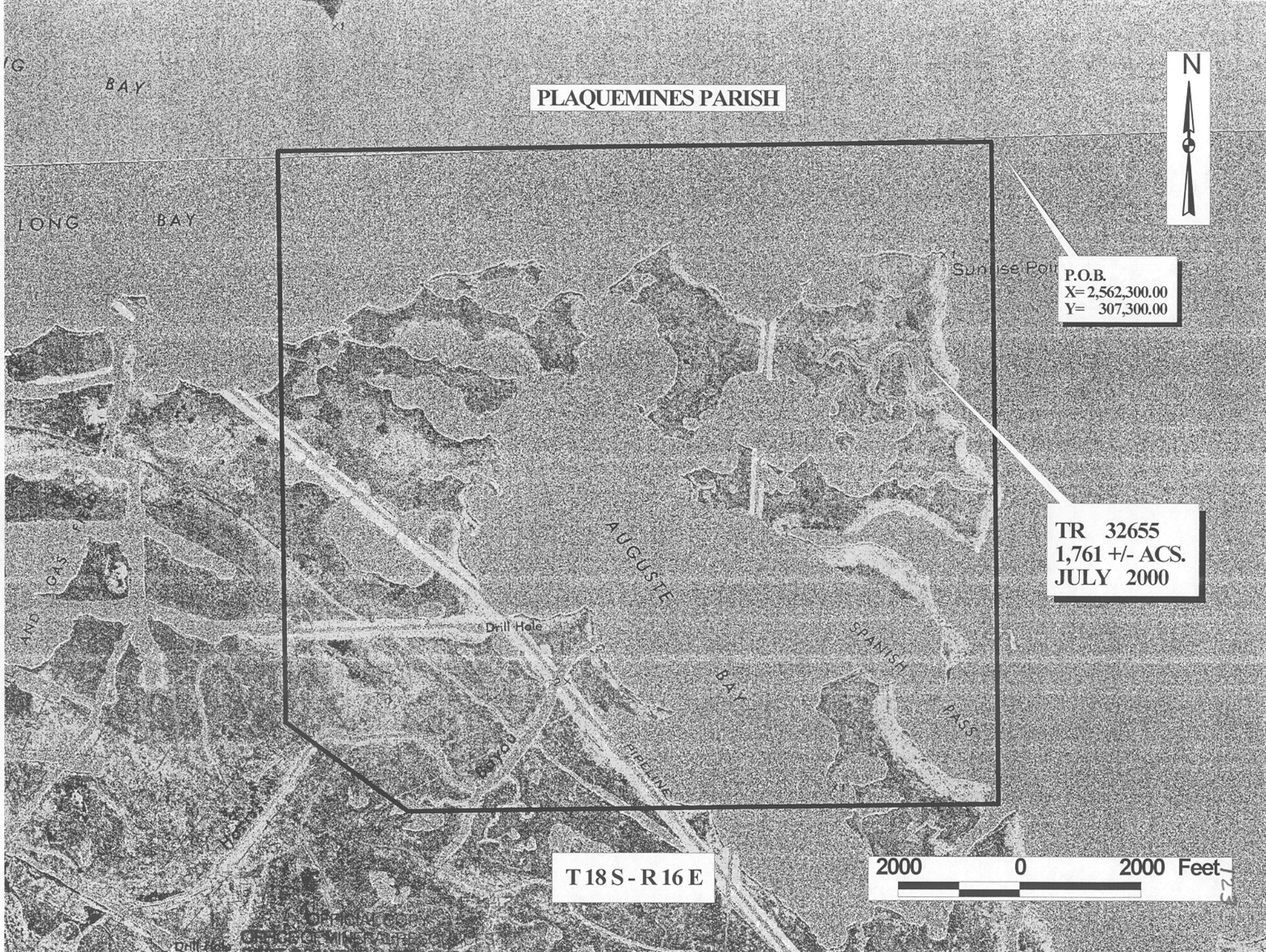

PLAQUEMINES PARISH



P.O.B.
X= 2,562,300.00
Y= 307,300.00

TR 32655
1,761 +/- ACS.
JULY 2000

T18 S - R 16 E

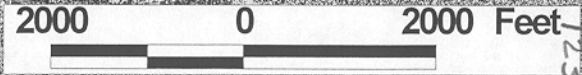

OFFICIAL COPY
OFFICE OF MINERAL RIGHTS
DEPT. OF NATURAL RESOURCES
DO NOT REMOVE