

NOT TO BE USED WITH A PORTION OF PL...
FOR INFORMATIONAL PURPOSES ONLY

F & A Map Services
Division of R.I.

SO LITTLE LAKE FIELD

COFFEE BAY FIELD

P.O.B.
X= 2,379,100.00
Y= 283,000.00

P.O.B.
X= 2,384,700.00
Y= 283,000.00

TR 32650

TR 32651

T 19 S - R 23 E

T-19-S-R-24-E

T-19-S-R-22-E

LAFOURCHE PARISH

MAP NOT TO SCALE

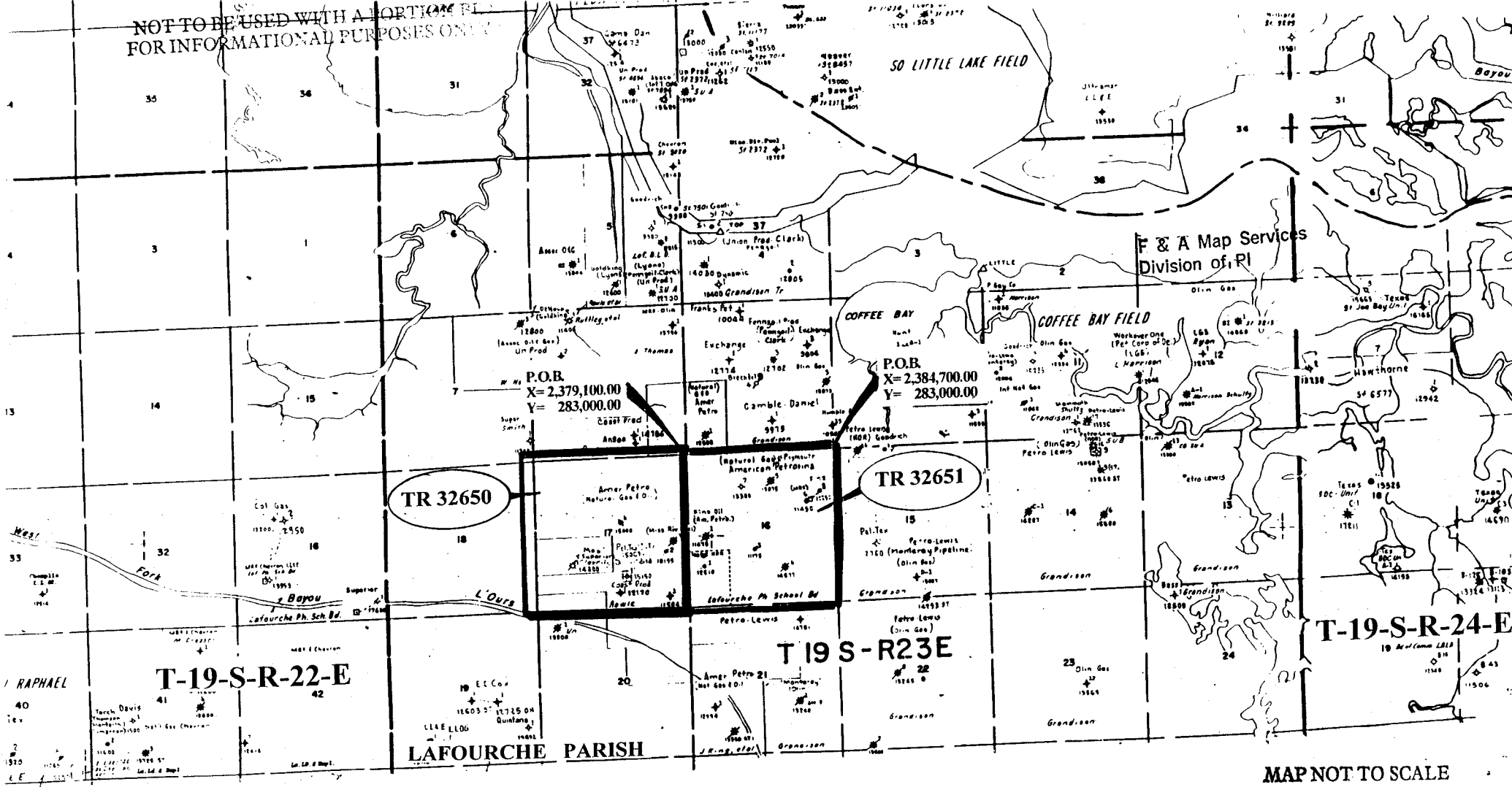

TRACT 32650 - Lafourche Parish, Louisiana

All of the lands now or formerly constituting the beds and bottoms of all water bodies of every nature and description and all islands and other lands formed by accretion or reliction, except tax lands, owned by and not under mineral lease from the State of Louisiana on July 12, 2000, situated in Lafourche Parish, Louisiana, within the following described boundaries: Beginning at a point having Coordinates of X = 2,379,100.00 and Y = 283,000.00; thence South 5,600.00 feet to a point having Coordinates of X = 2,379,100.00 and Y = 277,400.00; thence West 5,600.00 feet to a point having Coordinates of X = 2,373,500.00 and Y = 277,400.00; thence North 5,600.00 feet to a point having Coordinates of X = 2,373,500.00 and Y = 283,000.00; thence East 5,600.00 feet to the point of beginning, containing approximately **5 acres**, as shown outlined in red on a plat on file in the Office of Mineral Resources, Department of Natural Resources. All bearings, distances and coordinates are based on Louisiana Coordinate System of 1927 (South Zone).

NOTE: The above tract is located in or near an oyster restricted area and all operations in such area must be conducted in strict conformity with the stipulations and/or regulations of the Louisiana Department of Wildlife and Fisheries.

NOTE: The State of Louisiana does hereby reserve, and this lease shall be subject to, the imprescriptible right of surface use in the nature of a servitude in favor of the Department of Natural Resources, including its Offices and Commissions, for the sole purpose of implementing, constructing, servicing and maintaining approved coastal zone management and/or restoration projects. Utilization of any and all rights derived under this lease by the mineral lessee, its agents, successors or assigns, shall not interfere with nor hinder the reasonable surface use by the Department of Natural Resources, its Offices or Commissions, as hereinabove reserved.

Applicant: Harold J. Anderson, Inc.

Bidder	Cash Payment	Price / Acre	Rental	Oil	Gas	Other

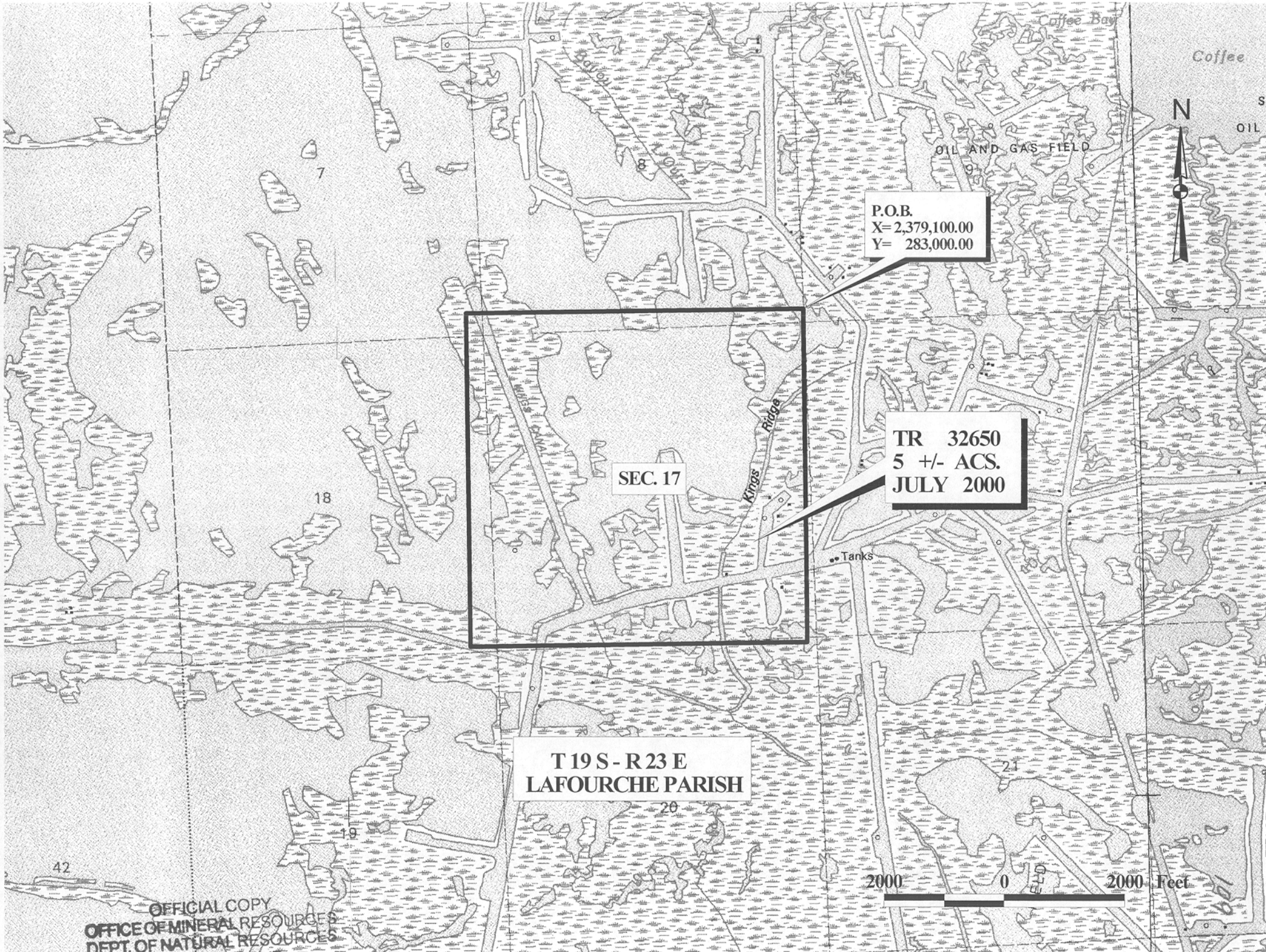

SEC. 17

P.O.B.
X= 2,379,100.00
Y= 283,000.00

TR 32650
5 +/- ACS.
JULY 2000

T 19 S - R 23 E
LAFOURCHE PARISH

OFFICIAL COPY
OFFICE OF MINERAL RESOURCES
DEPT. OF NATURAL RESOURCES
DO NOT REMOVE

2000 0 2000 Feet

TRACT 32651 - Lafourche Parish, Louisiana

All of the lands now or formerly constituting the beds and bottoms of all water bodies of every nature and description and all islands and other lands formed by accretion or reliction, except tax lands, owned by and not under mineral lease from the State of Louisiana on July 12, 2000, situated in Lafourche Parish, Louisiana, within the following described boundaries: Beginning at a point having Coordinates of X = 2,384,700.00 and Y = 283,000.00; thence South 5,600.00 feet to a point having Coordinates of X = 2,384,700.00 and Y = 277,400.00; thence West 5,600.00 feet to a point having Coordinates of X = 2,379,100.00 and Y = 277,400.00; thence North 5,600.00 feet to a point having Coordinates of X = 2,379,100.00 and Y = 283,000.00; thence East 5,600.00 feet to the point of beginning, containing approximately **8 acres**, as shown outlined in red on a plat on file in the Office of Mineral Resources, Department of Natural Resources. All bearings, distances and coordinates are based on Louisiana Coordinate System of 1927 (South Zone).

NOTE: The above tract is located in or near an oyster restricted area and all operations in such area must be conducted in strict conformity with the stipulations and/or regulations of the Louisiana Department of Wildlife and Fisheries.

NOTE: The State of Louisiana does hereby reserve, and this lease shall be subject to, the imprescriptible right of surface use in the nature of a servitude in favor of the Department of Natural Resources, including its Offices and Commissions, for the sole purpose of implementing, constructing, servicing and maintaining approved coastal zone management and/or restoration projects. Utilization of any and all rights derived under this lease by the mineral lessee, its agents, successors or assigns, shall not interfere with nor hinder the reasonable surface use by the Department of Natural Resources, its Offices or Commissions, as hereinabove reserved.

Applicant: Harold J. Anderson, Inc.

Bidder	Cash Payment	Price / Acre	Rental	Oil	Gas	Other

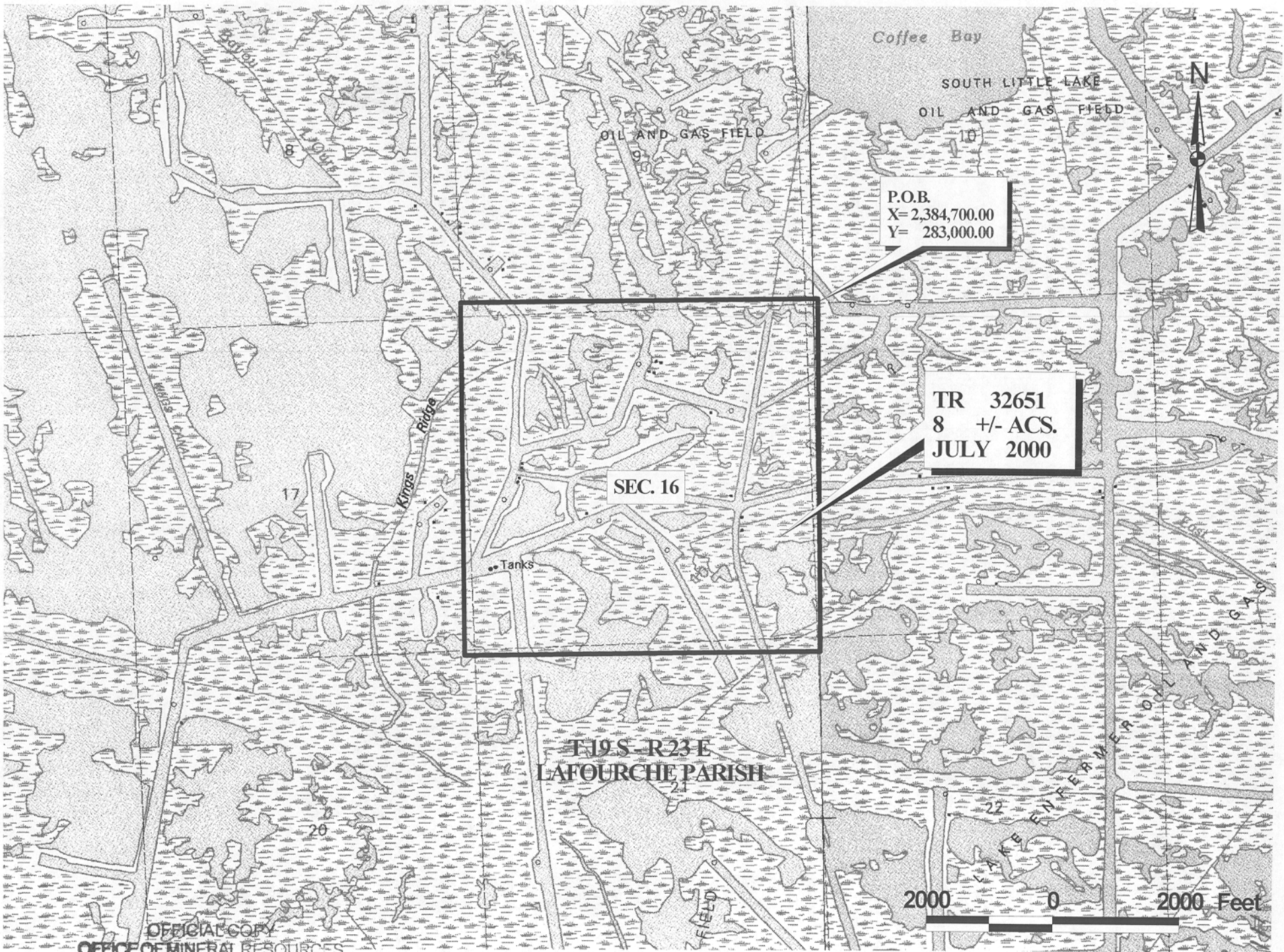

P.O.B.
X= 2,384,700.00
Y= 283,000.00

TR 32651
8 +/- ACS.
JULY 2000

SEC. 16

T19S R23E
LAFOURCHE PARISH

2000 0 2000 Feet

OFFICIAL COPY
OFFICE OF MINERAL RESOURCES
DEPT. OF NATURAL RESOURCES
DO NOT REMOVE