

TRACT 45144 - Portion of Blocks 63, and 64, Ship Shoal Area, Terrebonne Parish, Louisiana

The beds and bottoms of all water bodies belonging to the State of Louisiana located in Blocks 63, and 64, Ship Shoal Area, together with any present lands formed by accretion to the shoreline or islands formed therein, located in Terrebonne Parish, Louisiana, owned by and not presently under mineral lease as of June 12, 2019, from the State of Louisiana, the geographical area of which is more fully described as follows: Beginning at a point on the North line of Block 64, Ship Shoal Area, having Coordinates of X = 2,128,725.00 and Y = 127,591.99; thence South 8,362.91 feet to a point having Coordinates of X = 2,128,725.00 and Y = 119,229.09, said point being on the Three Mile Line, as decreed by the Supreme Court of the United States, as determined by a Special Master appointed therein, in litigation styled *United States v. State of Louisiana et al No. 9 Original*, in 1975; thence Northwesterly on an arc having a radius of 18,240.60 feet and a center at X = 2,133,089 and Y = 139,940 to a point having Coordinates of X = 2,126,750.00 and Y = 119,835.90, said point being the Southeast corner of State Lease No. 17669; thence along the boundary of said of State Lease No. 17669 the following: North 775.30 feet to a point having Coordinates of X = 2,126,750.00 and Y = 120,611.20 and West 1,916.21 feet to a point being its Northwest corner having Coordinates of X = 2,124,833.79 and Y = 120,611.20, said point also being a point on said Three Mile Line; thence continue Northwesterly along said Three Mile Line to a point having Coordinates of X = 2,122,637 and Y = 121,514, said point being the southernmost southeast corner of State Lease No. 21900; thence along the boundary of said of State Lease No. 21900 the following: North 69 degrees 25 minutes 08 seconds East 2,406.60 feet to a point having Coordinates of X = 2,124,890.00 and Y = 122,360.00, North 60 degrees 47 minutes 19 seconds East 2,131.01 feet to a point having Coordinates of X = 2,126,750.00 and Y = 123,400.00, North 2,150.00 feet to a point having Coordinates of X = 2,126,750.00 and Y = 125,550.00, West 1,290.00 feet to a point having Coordinates of X = 2,125,460.00 and Y = 125,550.00, South 870.00 feet to a point having Coordinates of X = 2,125,460.00 and Y = 124,680.00, South 43 degrees 41 minutes 07 seconds West 2,157.24 feet to a point having Coordinates of X = 2,123,970.00 and Y = 123,120.00, and South 61 degrees 35 minutes 15 seconds West 2,769.84 feet to a point being its Southwest corner having Coordinates of X = 2,121,533.80 and Y = 121,802.06, said point also being a point on said Three Mile Line; thence continue along said Three Mile Line the following courses: Northwesterly along a straight line to a point having Coordinates of X = 2,118,740 and Y = 122,394, Northwesterly on an arc having a radius of 18,240.60 feet and a center at X = 2,122,523 and Y = 140,238 to a point having Coordinates of X = 2,114,776 and Y = 123,724, and Northwesterly along a straight line to a point having Coordinates of X = 2,111,636.53 and Y = 125,196.84; thence North 2,395.15 to a point having Coordinates of X = 2,111,636.53 and Y = 127,591.99, said point being on the North line of said Block 63, Ship Shoal Area; thence East 13,163.47 feet along North line of said Block 63, Ship Shoal Area, to a point having Coordinates of X = 2,124,800.00 and Y = 127,591.99 being the Northwest corner of said Block 64, Ship Shoal Area, thence 3,925.00 feet along the North line of said Block 64,

Ship Shoal Area to the to the point of beginning, containing approximately **1,981.02 acres, LESS AND EXCEPT** that portion thereof, if any, lying seaward of the line three nautical miles from the coast line of Louisiana, as said three mile line has been decreed by the Supreme Court of the United States, as determined by a Special Master appointed therein, in litigation styled **United States v. State of Louisiana et al No. 9 Original**, in 1975, all as more particularly outlined on a plat in the Office of Mineral Resources, Department of Natural Resources. All bearings, distances and coordinates are based on the Louisiana Coordinate System of 1927, (South Zone).

NOTE: The above description of the Tract nominated for lease has been provided and corrected, where required, exclusively by the nomination party. Any mineral lease selected from this Tract and awarded by the Louisiana State Mineral and Energy Board shall be without warranty of any kind, either express, implied, or statutory, including, but not limited to, the implied warranties of merchantability and fitness for a particular purpose. Should the mineral lease awarded by the Louisiana State Mineral and Energy Board be subsequently modified, cancelled or abrogated due to the existence of conflicting leases, operating agreements, private claims or other future obligations or conditions which may affect all or any portion of the leased Tract, it shall not relieve the Lessee of the obligation to pay any bonus due thereon to the Louisiana State Mineral and Energy Board, nor shall the Louisiana State Mineral and Energy Board be obligated to refund any consideration paid by the Lessor prior to such modification, cancellation, or abrogation, including, but not limited to, bonuses, rentals and royalties.

NOTE: The State of Louisiana does hereby reserve, and this lease shall be subject to, the imprescriptible right of surface use in the nature of a servitude in favor of the Department of Natural Resources, including its Offices and Commissions, for the sole purpose of implementing, constructing, servicing and maintaining approved coastal zone management and/or restoration projects. Utilization of any and all rights derived under this lease by the mineral lessee, its agents, successors or assigns, shall not interfere with nor hinder the reasonable surface use by the Department of Natural Resources, its Offices or Commissions, as herein above reserved.

NOTE: It appears, according to our records, that a portion of this Tract is located within the restrictive safety fairway area as set out by the Corps of Engineers, U.S. Army and/or the restrictive anchorage area as set out by the U.S. Coast Guard.

Applicant: ROBERT A. SCHROEDER, INC.

Bidder	Cash Payment	Price/ Acre	Rental	Oil	Gas	Other

Legend

- 19060025
- Blocks
- Active_Leases
- Counties

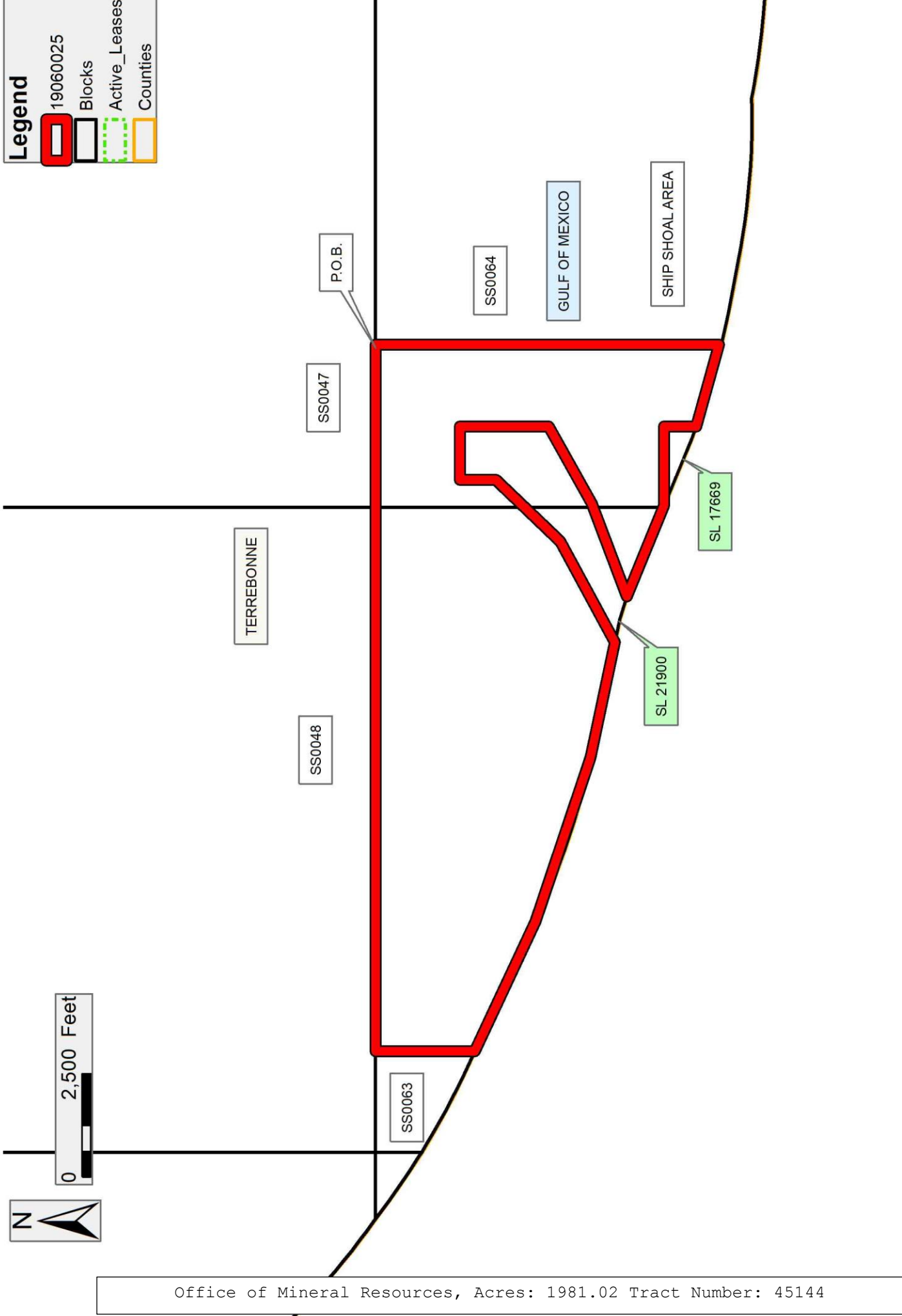

Office of Mineral Resources, Acres: 1981.02 Tract Number: 45144

TRACT 45145 - Portion of Block 64, Ship Shoal Area, Terrebonne Parish, Louisiana

The beds and bottoms of all water bodies belonging to the State of Louisiana located in Block 64, Ship Shoal Area, together with any present lands formed by accretion to the shoreline or islands formed therein, located in Terrebonne Parish, Louisiana, owned by and not presently under mineral lease as of June 12, 2019, from the State of Louisiana, the geographical area of which is more fully described as follows: Beginning at a point having Coordinates of X = 2,128,725.00 and Y = 127,591.99, said point being on the North line of Block 64, Ship Shoal Area; thence East 5,500.00 feet along said North line of said Block 64, Ship Shoal Area, to a point having Coordinates of X = 2,134,225.00 and Y = 127,591.99, said point being the Northwest corner of State Lease No. 21870; thence along the boundary of said State Lease No. 21870 the following courses: South 791.99 feet to a point having Coordinates of X = 2,134,225.00 and Y = 126,800.00, East 2,125.00 feet to a point having Coordinates of X = 2,136,350.00 and Y = 126,800.00, and North 791.99 feet to a point being its Northeast corner having Coordinates of X = 2,136,350.00 and Y = 127,591.99, said point also being on said North line of said Block 64, Ship Shoal Area; thence East 2,750.01 feet along said North Line of said Block 64, Ship Shoal Area, to a point having Coordinates of X = 2,139,100.01 and Y = 127,591.99, said point being the Northwest corner of State Lease No. 14851, as amended; thence South 20 degrees 23 minutes 06 seconds West 2,205.08 feet along the Western boundary of said State Lease No. 14851, as amended, to a point having Coordinates of X = 2,138,331.92 and Y = 125,525.00, said point being the easternmost northeast corner of State Lease No. 21869; thence along the boundary of said State Lease No. 21869 the following courses: West 1,056.92 feet to a point having Coordinates of X = 2,137,275.00 and Y = 125,525.00, North 13 degrees 45 minutes 18 seconds West 988.35 feet to a point having Coordinates of X = 2,137,040.00 and Y = 126,485.00, West 377.00 feet to a point having Coordinates of X = 2,136,663.00 and Y = 126,485.00, South 43 degrees 07 minutes 53 seconds West 2,103.35 feet to a point having Coordinates of X = 2,135,225.00 and Y = 124,950.00, East 1,525.47 feet to a point having Coordinates of X = 2,136,750.47 and Y = 124,950.00, and South 42 degrees 22 minutes 19 seconds West 2,633.88 feet to a point being on the Northern boundary of State Lease No. 21635 having Coordinates of X = 2,134,975.39 and Y = 123,004.13; thence along the boundary of said State Lease No. 21635 the following courses: South 84 degrees 55 minutes 43 seconds West 325.01 feet to a point having Coordinates of X = 2,134,651.65 and Y = 122,975.40, South 39 degrees 24 minutes 41 seconds West 400.00 feet to a point having Coordinates of X = 2,134,397.70 and Y = 122,666.36, South 10 degrees 37 minutes 23 seconds East 2,741.88 feet to a point having Coordinates of X = 2,134,903.15 and Y = 119,971.47, East 715.00 feet to a point having Coordinates of X = 2,135,618.15 and Y = 119,971.47, North 20 degrees 23 minutes 03 seconds East 199.99 feet to a point having Coordinates of X = 2,135,687.81 and Y = 120,158.94, and North 07 degrees 39 minutes 47 seconds West 1,490.55 feet to a point having Coordinates of X = 2,135,489.05 and Y = 121,636.18, said point being the southernmost southwest corner of said State Lease No. 21869; thence along the boundary of said State Lease No.

21869 the following courses: North 70 degrees 26 minutes 06 seconds East 489.20 feet to a point having Coordinates of X = 2,135,950.00 and Y = 121,800.00 and North 46 degrees 39 minutes 36 seconds East 2,112.65 feet to a point being the southeast corner of said State Lease No. 21869 having Coordinates of X = 2,137,486.52 and Y = 123,249.97, said point also being the southwest corner of said State Lease No. 14851, as amended; thence East 2,913.48 feet along the southern boundary of said State Lease No. 14851, as amended, to a point being its southeast corner having Coordinates of X = 2,140,400.00 and Y = 123,249.97, said point also being point being on the East line of said Block 64, Ship Shoal Area; thence South 5,214.97 feet along said East line of said Block 64, Ship Shoal Area, to a point having Coordinates of X = 2,140,400.00 and Y = 118,035.00, said point being on the Three Mile Line, as decreed by the Supreme Court of the United States, as determined by a Special Master appointed therein, in litigation styled *United States v. State of Louisiana et al No. 9 Original*, in 1975; thence along said Three Mile Line the following courses: Northwesterly along a straight line to a point having Coordinates of X = 2,139,529 and Y = 118,035, Northwesterly on an arc having a radius of 18,240.60 feet and a center at X = 2,139,529 and Y = 136,276 to a point having Coordinates of X = 2,137,975 and Y = 118,102, Northwesterly along a straight line to a point having Coordinates of X = 2,136,677 and Y = 118,213, Northwesterly on an arc having a radius of 18,240.60 feet and a center at X = 2,138,231 and Y = 136,387 to a point having Coordinates of X = 2,134,698 and Y = 118,492, Northwesterly on an arc having a radius of 18,240.60 feet and a center at X = 2,134,210 and Y = 136,726 to a point having Coordinates of X = 2,130,790 and Y = 118,809, Northwesterly along a straight line to a point having Coordinates of X = 2,129,669 and Y = 119,023, Northwesterly on an arc having a radius of 18,240.60 feet and a center at X = 2,133,089 and Y = 136,940 to a point having Coordinates of X = 2,128,725.00 and Y = 119,229.09; thence North 8,362.91 feet to the to the point of beginning, containing approximately **1,964.24 acres, LESS AND EXCEPT** that portion thereof, if any, lying seaward of the line three nautical miles from the coast line of Louisiana, as said three mile line has been decreed by the Supreme Court of the United States, as determined by a Special Master appointed therein, in litigation styled **United States v. State of Louisiana et al No. 9 Original**, in 1975, all as more particularly outlined on a plat in the Office of Mineral Resources, Department of Natural Resources. All bearings, distances and coordinates are based on the Louisiana Coordinate System of 1927, (South Zone).

NOTE: The above description of the Tract nominated for lease has been provided and corrected, where required, exclusively by the nomination party. Any mineral lease selected from this Tract and awarded by the Louisiana State Mineral and Energy Board shall be without warranty of any kind, either express, implied, or statutory, including, but not limited to, the implied warranties of merchantability and fitness for a particular purpose. Should the mineral lease awarded by the Louisiana State Mineral and Energy Board be subsequently modified, cancelled or abrogated due to the existence of conflicting leases, operating agreements, private claims or other future obligations or conditions which may affect all or any portion of the leased

Tract, it shall not relieve the Lessee of the obligation to pay any bonus due thereon to the Louisiana State Mineral and Energy Board, nor shall the Louisiana State Mineral and Energy Board be obligated to refund any consideration paid by the Lessor prior to such modification, cancellation, or abrogation, including, but not limited to, bonuses, rentals and royalties.

NOTE: The State of Louisiana does hereby reserve, and this lease shall be subject to, the imprescriptible right of surface use in the nature of a servitude in favor of the Department of Natural Resources, including its Offices and Commissions, for the sole purpose of implementing, constructing, servicing and maintaining approved coastal zone management and/or restoration projects. Utilization of any and all rights derived under this lease by the mineral lessee, its agents, successors or assigns, shall not interfere with nor hinder the reasonable surface use by the Department of Natural Resources, its Offices or Commissions, as herein above reserved.

Applicant: ROBERT A. SCHROEDER, INC.

Bidder	Cash Payment	Price/ Acre	Rental	Oil	Gas	Other

Legend

- 19060024
- Blocks
- Active_Leases
- Counties

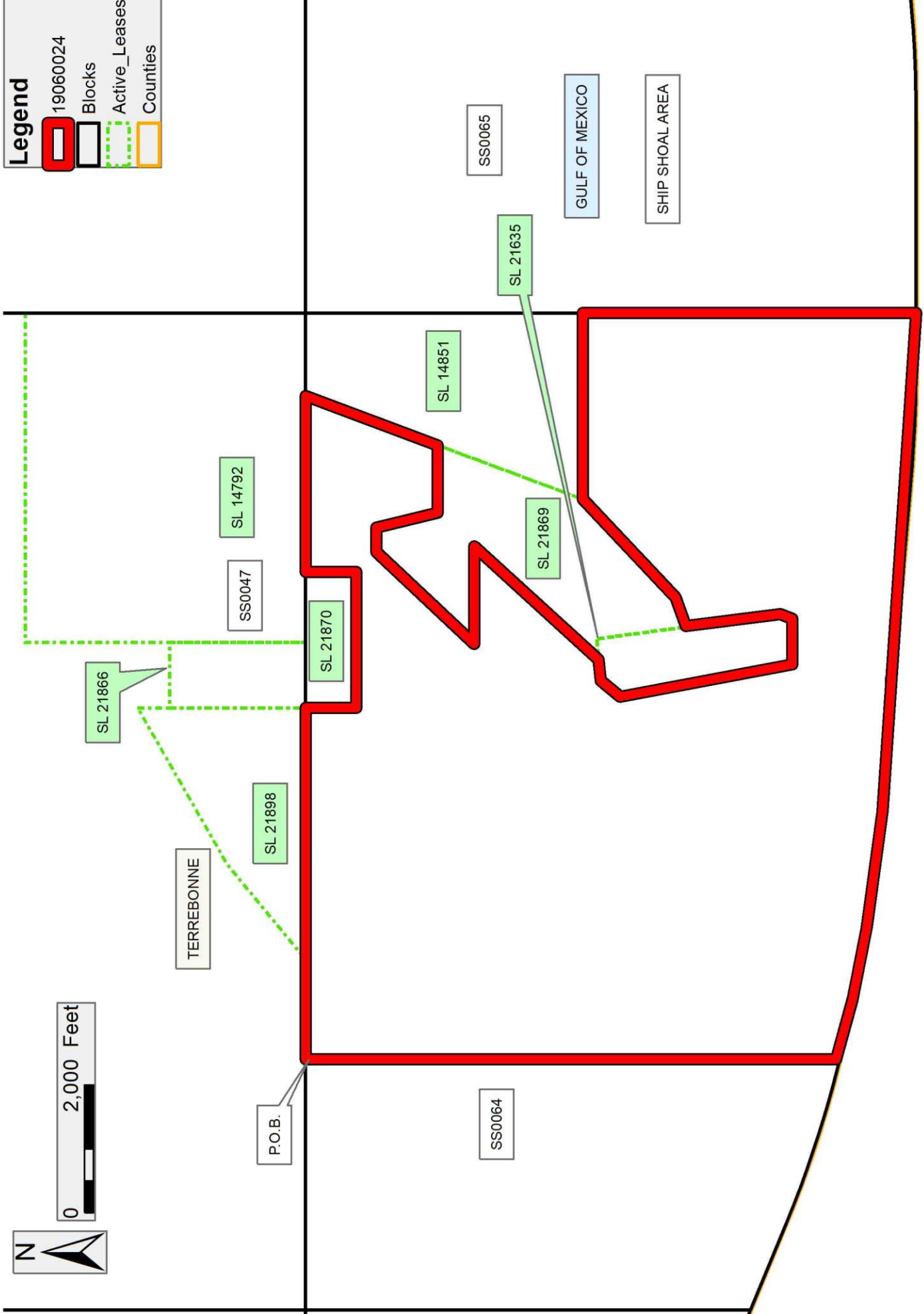

0 2,000 Feet

N