

**TRACT 39858 - Portion of Block 11, Grand Isle Area, Jefferson Parish, Louisiana**

The beds and bottoms of all water bodies belonging to the State of Louisiana located in Block 11, Grand Isle Area, together with any present lands formed by accretion to the shoreline or islands formed therein, located in Jefferson Parish, Louisiana, owned by and not presently under mineral lease as of June 11, 2008, from the State of Louisiana, the geographical area of which is more fully described as follows: Beginning at a point on the South line of Block 11, Grand Isle Area, having Coordinates of X = 2,435,522.83 and Y = 185,535.39; thence West 6,954.65 feet to the Southernmost Southeast corner of State Lease No. 14602 having Coordinates of X = 2,428,568.18 and Y = 185,535.39; thence along the boundary of said State Lease No. 14602 the following courses: North 1,532.59 feet, East 3,043.72 feet, North 4,605.53 feet and West 3,468.09 feet to its Northwest corner and a point on the West line of said Block 11 having Coordinates of X = 2,428,143.81 and Y = 191,673.51; thence North 1,972.97 feet along said Block 11 to a point the Louisiana Coastline, as decreed by the Supreme Court of the United States, as determined by a Special Master appointed therein, in litigation styled *United States v. State of Louisiana et al No. 9 Original*, in 1975, having Coordinates of X = 2,428,143.81 and Y = 193,646.48; thence Northeasterly on a straight line along said Louisiana Coastline to a point having Coordinates of X = 2,435,522.83 and Y = 195,005.19; thence South 9,469.80 feet to the point of beginning, containing approximately **1,107.49 acres, LESS AND EXCEPT** that portion thereof, if any, lying seaward of the line three nautical miles from the coast line of Louisiana, as said three mile line has been decreed by the Supreme Court of the United States, as determined by a Special Master appointed therein, in litigation styled **United States v. State of Louisiana et al No. 9 Original**, in 1975

, all as more particularly outlined on a plat on file in the Office of Mineral Resources, Department of Natural Resources. All bearings, distances and coordinates are based on Louisiana Coordinate System of 1927, (North or South Zone).

NOTE: The above description of the Tract nominated for lease has been provided and corrected, where required, exclusively by the nomination party. Any mineral lease selected from this Tract and awarded by the Louisiana State Mineral Board shall be without warranty of any kind, either express, implied, or statutory, including, but not limited to, the implied warranties of merchantability and fitness for a particular purpose. Should the mineral lease awarded by the Louisiana State Mineral Board be subsequently modified, cancelled or abrogated due to the existence of conflicting leases, operating agreements, private claims or other future obligations or conditions which may affect all or any portion of the leased Tract, it shall not relieve the Lessee of the obligation to pay any bonus due thereon to the Louisiana State Mineral Board, nor shall the Louisiana State Mineral Board be obligated to refund any consideration paid by the Lessor prior to such modification, cancellation, or abrogation, including, but not limited to, bonuses, rentals and royalties.

NOTE: The State of Louisiana does hereby reserve, and this lease shall be subject to, the imprescriptible right of surface use in the nature of a servitude in favor of the Department of Natural Resources, including its Offices and Commissions, for the sole purpose of implementing, constructing, servicing and maintaining approved coastal zone management and/or restoration projects. Utilization of any and all rights derived under this lease by the mineral lessee, its agents, successors or assigns, shall not interfere with nor hinder the reasonable surface use by the Department of Natural Resources, its Offices or Commissions, as herein above reserved.

Applicant: KARE-SUE ENERGY, INC.

Bidder	Cash Payment	Price/Acre	Rental	Oil	Gas	Other

**Legend**

- 08060029
- Blocks
- Active\_Leases

JEFFERSON PARISH  
GRAND ISLE AREA

GI0011

GULF OF MEXICO

P.O.B.

GI0017

SL 800

SL 14602

SL 16477

GI0012



**TRACT 39859 - Portion of Blocks 12, and 13, Grand Isle Area, Jefferson Parish, Louisiana**

The beds and bottoms of all water bodies belonging to the State of Louisiana located in Blocks 12, and 13, Grand Isle Area, together with any present lands formed by accretion to the shoreline or islands formed therein, located in Jefferson Parish, Louisiana, owned by and not presently under mineral lease as of June 11, 2008, from the State of Louisiana, the geographical area of which is more fully described as follows: Beginning at a point on the East line of Block 12, Grand Isle Area, also being a the Northeast corner of State Lease No. 16477, as amended, having Coordinates of X = 2,428,143.81 and Y = 191,673.51; thence West 2,031.91 feet along the North line of said State Least No. 16477 to its Southwest corner and also being the Northeast corner of State Lease No. 18737 having Coordinates of X = 2,426,111.90 and Y = 191,673.51; thence West 5,347.11 feet along the North line of said State Lease No. 18737 to its Northwest corner and also being the Northeast corner of State Lease No. 18738 having Coordinates of X = 2,420,764.79 and Y = 191,673.51; thence along the boundary of said State Lease No. 18738 the following courses: West 2,164.79 feet and South 6,138.12 feet to its Southwest corner and also being a point on the South line of said Block 12 having Coordinates of X = 2,418,600.00 and Y = 185,535.39; thence West 5,214.23 feet along the South line of said Block 12 to its Southwest corner having Coordinates of X = 2,413,385.77 and Y = 185,535.39; thence North 5,393.67 feet along the West line of said Block 12 to a point on the Louisiana Coastline, as decreed by the Supreme Court of the United States, as determined by a Special Master appointed therein, in litigation styled *United States v. State of Louisiana et al No. 9 Original*, in 1975, having Coordinates of X = 2,413,385.77 and Y = 190,929.06; thence Northeasterly on a straight line to a point on said Louisiana Coastline and the a point on the East line of said Block 12 having Coordinates of X = 2,428,143.81 and Y = 193,646.48; thence South 1,972.97 feet to the point of beginning, containing approximately **942.86 acres, LESS AND EXCEPT** that portion thereof, if any, lying seaward of the line three nautical miles from the coast line of Louisiana, as said three mile line has been decreed by the Supreme Court of the United States, as determined by a Special Master appointed therein, in litigation styled **United States v. State of Louisiana et al No. 9 Original**, in 1975, all as more particularly outlined on a plat on file in the Office of Mineral Resources, Department of Natural Resources. All bearings, distances and coordinates are based on Louisiana Coordinate System of 1927, (North or South Zone).

NOTE: The above description of the Tract nominated for lease has been provided and corrected, where required, exclusively by the nomination party. Any mineral lease selected from this Tract and awarded by the Louisiana State Mineral Board shall be without warranty of any kind, either express, implied, or statutory, including, but not limited to, the implied warranties of merchantability and fitness for a particular purpose. Should the mineral lease awarded by the Louisiana State Mineral Board be subsequently modified, cancelled or abrogated due to the existence of conflicting leases, operating agreements, private claims or other future obligations or conditions which may affect all or any portion

of the leased Tract, it shall not relieve the Lessee of the obligation to pay any bonus due thereon to the Louisiana State Mineral Board, nor shall the Louisiana State Mineral Board be obligated to refund any consideration paid by the Lessor prior to such modification, cancellation, or abrogation, including, but not limited to, bonuses, rentals and royalties.

NOTE: The State of Louisiana does hereby reserve, and this lease shall be subject to, the imprescriptible right of surface use in the nature of a servitude in favor of the Department of Natural Resources, including its Offices and Commissions, for the sole purpose of implementing, constructing, servicing and maintaining approved coastal zone management and/or restoration projects. Utilization of any and all rights derived under this lease by the mineral lessee, its agents, successors or assigns, shall not interfere with nor hinder the reasonable surface use by the Department of Natural Resources, its Offices or Commissions, as herein above reserved.

NOTE: The Department of Wildlife and Fisheries has designated certain areas in the coastal waters of the State of Louisiana as Oyster Seed Bed Areas. The exact location of those Seed Bed Areas must be obtained from the Department of Wildlife and Fisheries and any work done under a mineral lease from the State of Louisiana may necessarily be conducted in conformity with the rules and regulations promulgated by the said Department of Wildlife and Fisheries for Oyster Seed Bed Areas.

Applicant: KARE-SUE ENERGY, INC.

Bidder	Cash Payment	Price/Acre	Rental	Oil	Gas	Other

**Legend**

- 08060026
- Blocks
- Active\_Leases

JEFFERSON PARISH  
 GULF OF MEXICO  
 GRAND ISLE AREA  
 GI0012



P.O.B.

SL 14602

SL 16477

SL 18737

SL 18738

SL 799

GI0016

**TRACT 39860 - Portion of Block 10, Grand Isle Area, Jefferson and Plaquemines Parishes, Louisiana**

The beds and bottoms of all water bodies belonging to the State of Louisiana located in Block 10, Grand Isle Area, together with any present lands formed by accretion to the shoreline or islands formed therein, located in Jefferson and Plaquemines Parishes, Louisiana, owned by and not presently under mineral lease as of June 11, 2008, from the State of Louisiana, the geographical area of which is more fully described as follows: Beginning at a point within Block 10, Grand Isle Area, also being the Northwest corner of State Lease No. 19428 and a point on the South line of State Lease No. 18736 having Coordinates of X = 2,450,280.87 and Y = 192,914.41; thence East 7,379.02 feet along the South line of said State Lease No. 18736 to its Southeast corner and also a point on the East line of said Block 10 to a point having Coordinates of X = 2,457,659.89 and Y = 192,914.41; thence South 7,379.02 feet along the East line of said Block 10 to its Southeast corner having Coordinates of X = 2,457,659.89 and Y = 185,535.39; thence West 7,379.02 feet along the South line of said Block 10 to the Southeast corner of said State Lease No. 19428 having Coordinates of X = 2,450,280.87 and Y = 185,535.39; thence North 7,379.02 feet along the East line of said State Lease No. 19428 to the point of beginning, containing approximately **1,250.00 acres, LESS AND EXCEPT** that portion thereof, if any, lying seaward of the line three nautical miles from the coast line of Louisiana, as said three mile line has been decreed by the Supreme Court of the United States, as determined by a Special Master appointed therein, in litigation styled **United States v. State of Louisiana et al No. 9 Original**, in 1975, all as more particularly outlined on a plat on file in the Office of Mineral Resources, Department of Natural Resources. All bearings, distances and coordinates are based on Louisiana Coordinate System of 1927, (North or South Zone).

NOTE: The above description of the Tract nominated for lease has been provided and corrected, where required, exclusively by the nomination party. Any mineral lease selected from this Tract and awarded by the Louisiana State Mineral Board shall be without warranty of any kind, either express, implied, or statutory, including, but not limited to, the implied warranties of merchantability and fitness for a particular purpose. Should the mineral lease awarded by the Louisiana State Mineral Board be subsequently modified, cancelled or abrogated due to the existence of conflicting leases, operating agreements, private claims or other future obligations or conditions which may affect all or any portion of the leased Tract, it shall not relieve the Lessee of the obligation to pay any bonus due thereon to the Louisiana State Mineral Board, nor shall the Louisiana State Mineral Board be obligated to refund any consideration paid by the Lessor prior to such modification, cancellation, or abrogation, including, but not limited to, bonuses, rentals and royalties.

NOTE: The State of Louisiana does hereby reserve, and this lease shall be subject to, the imprescriptible right of surface use in the nature of a servitude in favor of the Department of Natural Resources, including its Offices and Commissions, for the sole purpose of implementing,

constructing, servicing and maintaining approved coastal zone management and/or restoration projects. Utilization of any and all rights derived under this lease by the mineral lessee, its agents, successors or assigns, shall not interfere with nor hinder the reasonable surface use by the Department of Natural Resources, its Offices or Commissions, as herein above reserved.

Applicant: KARE-SUE ENERGY, INC.

Bidder	Cash Payment	Price/Acre	Rental	Oil	Gas	Other



**Legend**

- 08060030
- Blocks
- Active\_Leases
- Counties

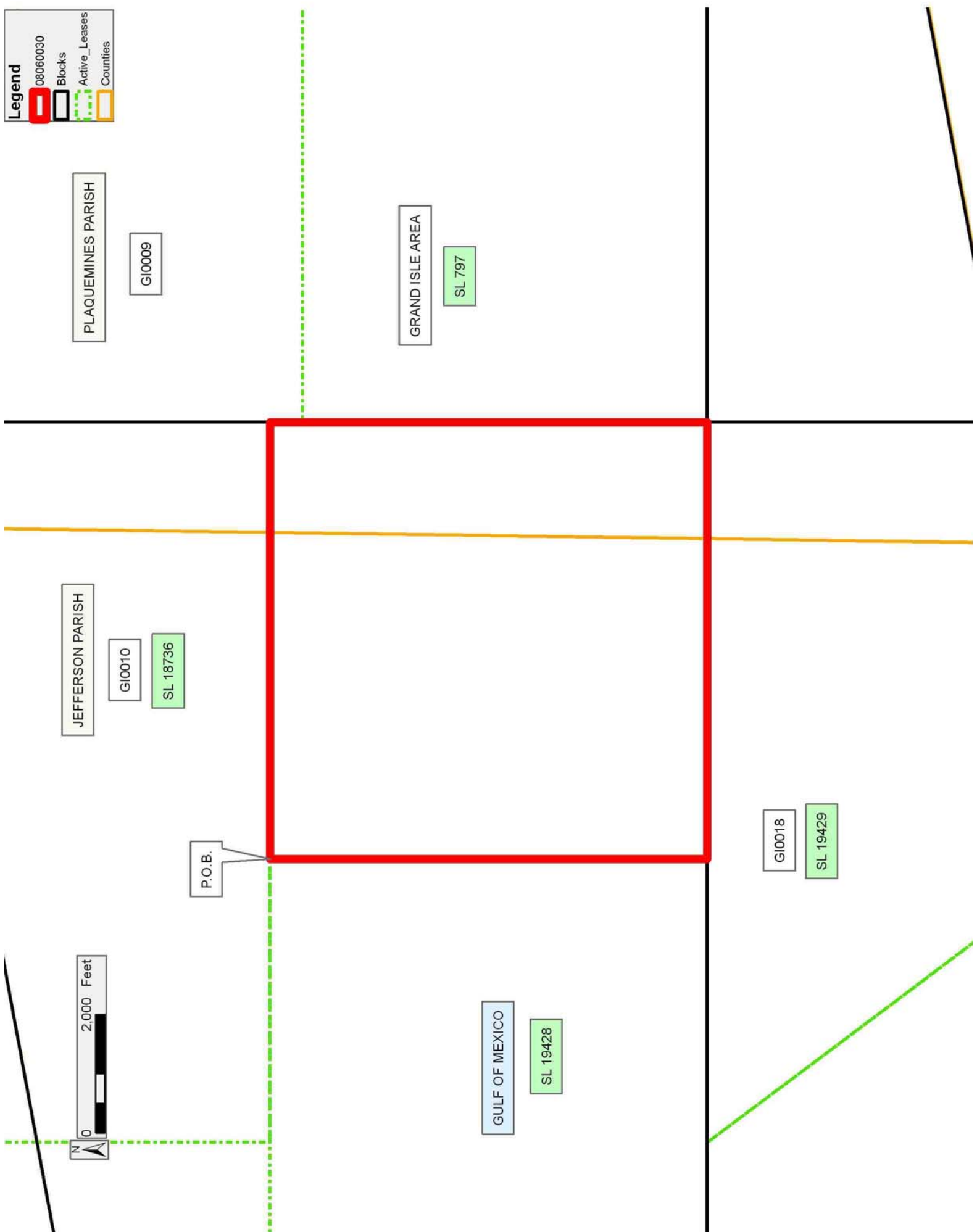

**TRACT 39861 - Portion of Block 13, Grand Isle Area, Jefferson Parish, Louisiana**

The beds and bottoms of all water bodies belonging to the State of Louisiana located in Block 13, Grand Isle Area, together with any present lands formed by accretion to the shoreline or islands formed therein, located in Jefferson Parish, Louisiana, owned by and not presently under mineral lease as of June 11, 2008, from the State of Louisiana, the geographical area of which is more fully described as follows: Beginning at the Southeast corner of Block 13, Grand Isle Area, having Coordinates of X = 2,413,385.77 and Y = 185,535.39; thence West 11,456.74 feet along the South line of said Block 13 to a point on the Louisiana Coastline, as decreed by the Supreme Court of the United States, as determined by a Special Master appointed therein, in litigation styled *United States v. State of Louisiana et al No. 9 Original*, in 1975, having Coordinates of X = 2,401,929.03 and Y = 185,535.39; thence Northeasterly on a straight line along said Louisiana Coastline to a point having Coordinates of X = 2,406,890 and Y = 189,733; thence Northeasterly on a straight line along said Louisiana Coastline to a point on the East line of said Block 13 having Coordinates of X = 2,413,385.77 and Y = 190,929.07; thence South 5,393.67 feet to the point of beginning, containing approximately **954.17 acres, LESS AND EXCEPT** that portion thereof, if any, lying seaward of the line three nautical miles from the coast line of Louisiana, as said three mile line has been decreed by the Supreme Court of the United States, as determined by a Special Master appointed therein, in litigation styled **United States v. State of Louisiana et al No. 9 Original**, in 1975, all as more particularly outlined on a plat on file in the Office of Mineral Resources, Department of Natural Resources. All bearings, distances and coordinates are based on Louisiana Coordinate System of 1927, (North or South Zone).

NOTE: The above description of the Tract nominated for lease has been provided and corrected, where required, exclusively by the nomination party. Any mineral lease selected from this Tract and awarded by the Louisiana State Mineral Board shall be without warranty of any kind, either express, implied, or statutory, including, but not limited to, the implied warranties of merchantability and fitness for a particular purpose. Should the mineral lease awarded by the Louisiana State Mineral Board be subsequently modified, cancelled or abrogated due to the existence of conflicting leases, operating agreements, private claims or other future obligations or conditions which may affect all or any portion of the leased Tract, it shall not relieve the Lessee of the obligation to pay any bonus due thereon to the Louisiana State Mineral Board, nor shall the Louisiana State Mineral Board be obligated to refund any consideration paid by the Lessor prior to such modification, cancellation, or abrogation, including, but not limited to, bonuses, rentals and royalties.

NOTE: The State of Louisiana does hereby reserve, and this lease shall be subject to, the imprescriptible right of surface use in the nature of a servitude in favor of the Department of Natural Resources, including its

Offices and Commissions, for the sole purpose of implementing, constructing, servicing and maintaining approved coastal zone management and/or restoration projects. Utilization of any and all rights derived under this lease by the mineral lessee, its agents, successors or assigns, shall not interfere with nor hinder the reasonable surface use by the Department of Natural Resources, its Offices or Commissions, as herein above reserved.

NOTE: The Department of Wildlife and Fisheries has designated certain areas in the coastal waters of the State of Louisiana as Oyster Seed Bed Areas. The exact location of those Seed Bed Areas must be obtained from the Department of Wildlife and Fisheries and any work done under a mineral lease from the State of Louisiana may necessarily be conducted in conformity with the rules and regulations promulgated by the said Department of Wildlife and Fisheries for Oyster Seed Bed Areas.

Applicant: KARE-SUE ENERGY, INC.

Bidder	Cash Payment	Price/Acre	Rental	Oil	Gas	Other

JEFFERSON PARISH

P.O.B.

GRAND ISLE AREA

GULF OF MEXICO

T22S - R23E

