

TRACT 38389 - Jefferson and Lafourche Parishes, Louisiana

All of the lands now or formerly constituting the beds and bottoms of all water bodies of every nature and description the title of which vests in the State of Louisiana, together with all islands arising therein and other lands formed by accretion or by reliction, where allowed by law, excepting tax adjudicated lands, and not presently under mineral lease and cross hatched on June 14, 2006, situated in Jefferson and Lafourche Parishes, Louisiana, and more particularly described as follows: Beginning at a point on the East boundary of State Lease No. 18851, having Coordinates of X = 2,422,138.52 and Y = 246,050.00; thence East approximately 1,877 feet to a point on the West boundary of State Lease No. 2084, as amended; thence Southerly approximately 4,955 feet along the West boundary of said State Lease No. 2084 to a point on the North boundary of State Lease No. 18676; thence along the boundary of said State Lease No. 18676 the following courses and distances: Northwesterly approximately 936 feet to a point having Coordinates of X = 2,423,200.00 and Y = 241,370.00, North 82 degrees 14 minutes 05 seconds West 222.04 feet to a point having Coordinates of X = 2,422,979.99 and Y = 241,400.00, South 86 degrees 38 minutes 01 seconds West 170.29 feet to a point having Coordinates of X = 2,422,810.00 and Y = 241,390.00, South 69 degrees 26 minutes 38 seconds West 256.32 feet to a point having Coordinates of X = 2,422,570.00 and Y = 241,300.00, South 66 degrees 17 minutes 50 seconds West 447.77 feet to a point having Coordinates of X = 2,422,160.00 and Y = 241,120.00, South 60 degrees 42 minutes 31 seconds West 470.11 feet to a point having Coordinates of X = 2,421,750.00 and Y = 240,890.00, South 37 degrees 36 minutes 50 seconds West 770.06 feet to a point having Coordinates of X = 2,421,280.00 and Y = 240,280.00, South 30 degrees 57 minutes 50 seconds West 233.24 feet to a point having Coordinates of X = 2,421,160.00 and Y = 240,080.00, South 25 degrees 15 minutes 11 seconds West 586.00 feet to a point having Coordinates of X = 2,420,910.00 and Y = 239,550.00, South 79 degrees 35 minutes 30 seconds East 498.20 feet to a point having Coordinates of X = 2,421,400.01 and Y = 239,459.99, South 78 degrees 21 minutes 59 seconds East 347.13 feet to a point having Coordinates of X = 2,421,740.01 and Y = 239,389.99, South 71 degrees 11 minutes 17 seconds East 961.35 feet to a point having Coordinates of X = 2,422,650.00 and Y = 239,079.99, South 74 degrees 17 minutes 29 seconds East 664.83 feet to a point having Coordinates of X = 2,423,290.00 and Y = 238,900.00, South 78 degrees 00 minutes 10 seconds East 496.90 feet to a point having Coordinates of X = 2,423,776.05 and Y = 238,796.71, South 83 degrees 43 minutes 36 seconds East 335.96 feet to a point having Coordinates of X = 2,424,110.00 and Y = 238,760.00 and South 85 degrees 30 minutes 55 seconds East approximately 22 feet to a point on the West boundary of said State Lease No. 2084; thence Southerly approximately 3,136 feet along the West boundary of said State Lease No. 2084 to its Southwest corner; thence Southerly approximately 222 feet to a point having Coordinates of X = 2,424,183.00 and Y = 235,400.00; thence West 2,678.22 feet to a point on the Southern boundary of State Lease No. 18675 having Coordinates of X = 2,421,504.78 and Y = 235,400.00; thence along the boundary of said State Lease No. 18675 the following courses and

distances: North 74 degrees 15 minutes 35 seconds East 1,295.25 feet to a point having Coordinates of X = 2,422,751.46 and Y = 235,751.37, North 20 degrees 07 minutes 55 seconds West 3,106.69 feet to a point having Coordinates of X = 2,421,682.19 and Y = 238,668.25, North 89 degrees 18 minutes 22 seconds West 2,621.38 feet to a point having Coordinates of X = 2,419,061.00 and Y = 238,700.00 and South 67 degrees 12 minutes 48 seconds West 988.12 feet to a point having Coordinates of X = 2,418,150.00 and Y = 238,317.30; thence North 5,301.62 feet to a point on the South boundary of said State Lease No. 18851 having Coordinates of X = 2,418,150.00 and Y = 243,618.92; thence along the boundary of said State Lease No. 18851 the following courses and distances: South 83 degrees 24 minutes 53 seconds East 3,931.94 feet to a point having Coordinates of X = 2,422,056.00 and Y = 243,168.00 and North 01 degrees 38 minutes 25 seconds East 2,883.18 feet to the point of beginning, **LESS AND EXCEPT** those portions of State Lease No. 2084, as amended, and State Lease No. 18676 that may lie within the above described tract, containing approximately **776 acres**, all as more particularly outlined on a plat on file in the Office of Mineral Resources, Department of Natural Resources. All bearings, distances and coordinates are based on Louisiana Coordinate System of 1927, (North or South Zone), where applicable.

NOTE: The above description of the Tract nominated for lease has been provided and corrected, where required, exclusively by the nomination party. Any mineral lease selected from this Tract and awarded by the Louisiana State Mineral Board shall be without warranty of any kind, either express, implied, or statutory, including, but not limited to, the implied warranties of merchantability and fitness for a particular purpose. Should the mineral lease awarded by the Louisiana State Mineral Board be subsequently modified, cancelled or abrogated due to the existence of conflicting leases, operating agreements, private claims or other future obligations or conditions which may affect all or any portion of the leased Tract, it shall not relieve the Lessee of the obligation to pay any bonus due thereon to the Louisiana State Mineral Board, nor shall the Louisiana State Mineral Board be obligated to refund any consideration paid by the Lessor prior to such modification, cancellation, or abrogation, including, but not limited to, bonuses, rentals and royalties.

NOTE: The State of Louisiana does hereby reserve, and this lease shall be subject to, the imprescriptible right of surface use in the nature of a servitude in favor of the Department of Natural Resources, including its Offices and Commissions, for the sole purpose of implementing, constructing, servicing and maintaining approved coastal zone management and/or restoration projects. Utilization of any and all rights derived under this lease by the mineral lessee, its agents, successors or assigns, shall not interfere with nor hinder the reasonable surface use by the Department of Natural Resources, its Offices or Commissions, as herein above reserved.

NOTE: The Department of Wildlife and Fisheries has designated certain areas in the coastal waters of the State of Louisiana as Oyster Seed Bed Areas. The exact location of those Seed Bed Areas must be obtained from the Department of Wildlife and Fisheries and any work done under a mineral lease from the State of Louisiana may necessarily be conducted in conformity with the rules and regulations promulgated by the said Department of Wildlife and Fisheries for Oyster Seed Bed Areas.

Applicant: THEOPHILUS OIL, GAS & LAND SERVICES LLC

Bidder	Cash Payment	Price/Acre	Rental	Oil	Gas	Other

Legend

- 06060039
- Active_Leases
- Counties

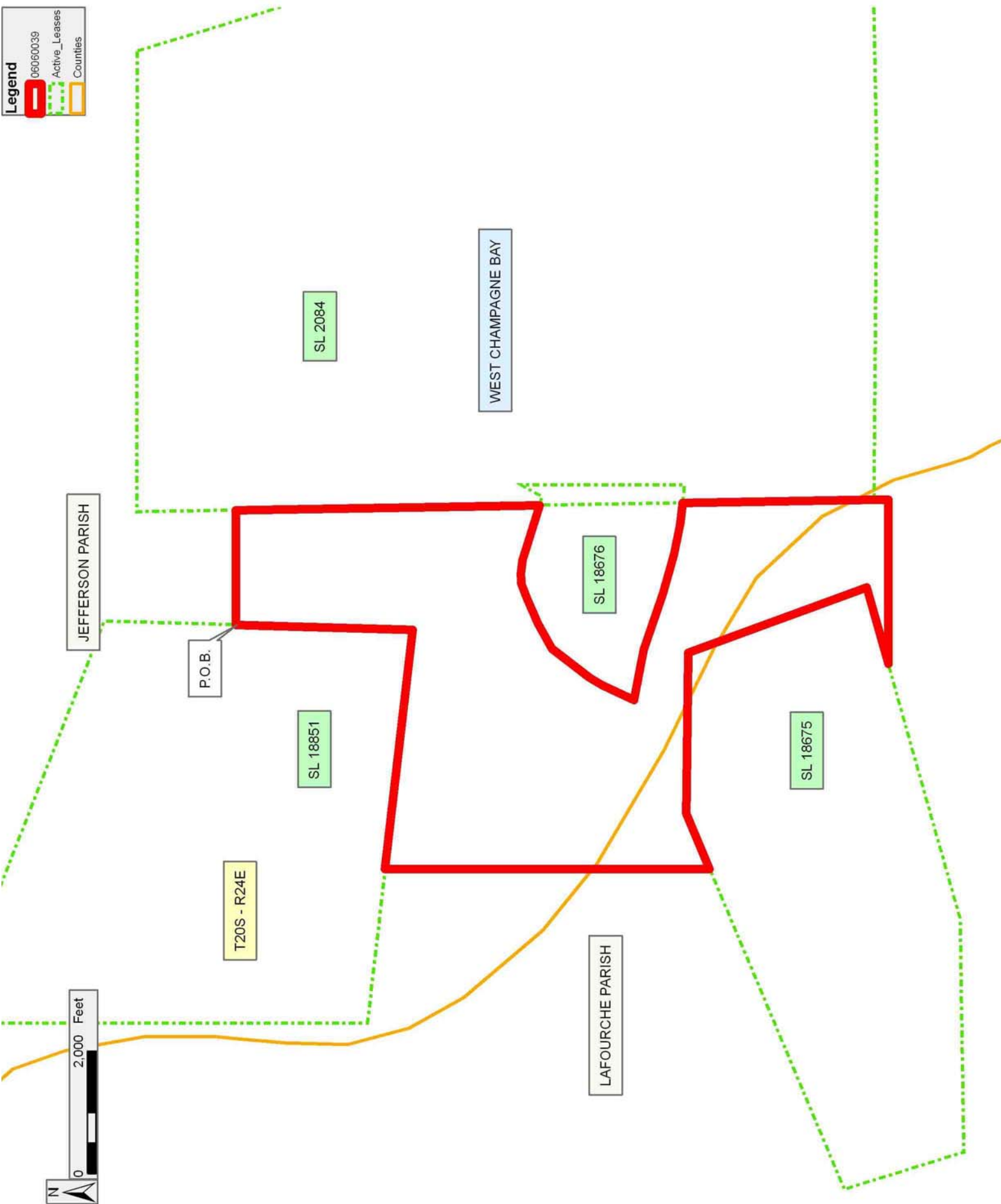

TRACT 38390 --- WITHDRAWN PER APPLICANTS REQUEST