

**TRACT 39802 - Portion of Block 40, South Pass Area, Plaquemines Parish, Louisiana**

The beds and bottoms of all water bodies belonging to the State of Louisiana located in Block 40, South Pass Area, together with any present lands formed by accretion to the shoreline or islands formed therein, located in Plaquemines Parish, Louisiana, owned by and not presently under mineral lease as of May 14, 2008, from the State of Louisiana, the geographical area of which is more fully described as follows: Beginning at a point within Block 40, South Pass Area, having Coordinates of X = 2,627,531.90 and Y = 105,603.31; thence West 2,312.64 feet to a point on the Eastern boundary of State Lease No. 2552, as amended, having Coordinates of X = 2,625,219.26 and Y = 105,603.31; thence along the boundary of said State Lease No. 2552 the following courses: North 35 degrees 47 minutes 41 seconds West 186.88 feet to a point having Coordinates of X = 2,625,109.96 and Y = 105,754.89; North 31 degrees 13 minutes 55 seconds West 549.66 feet to a point having Coordinates of X = 2,624,824.96 and Y = 106,224.89 and North 28 degrees 34 minutes 29 seconds West approximately 579 feet to a point of intersection with the Eastern boundary of State Lease No. 2565, as amended; thence Northeasterly along the meanders of the Eastern boundary of said State Lease No. 2565 to its intersection with an East-West line having a Coordinate of Y = 111,371.81; thence East approximately 2,092 feet to a point on the East line of said Block 40 having Coordinates X = 2,630,686.00 and Y = 111,371.81; thence South 28.36 feet along the East line of said Block 40 to the Northernmost corner of State Lease No. 17194, as amended, having Coordinates X = 2,630,686.00 and Y = 111,343.45; thence along the boundary of said State Lease No. 17194 the following courses: South 17 degrees 19 minutes 26 seconds West 379.48 feet to a point having Coordinates of X = 2,630,573.00 and Y = 110,981.18; South 19 degrees 58 minutes 42 seconds West 407.42 feet to a point having Coordinates of X = 2,630,433.80 and Y = 110,598.28; Southwesterly along an arc to the right having a radius of 2,702.50 feet and a center at X = 2,627,898.87 and Y = 111,535.11 to a point having Coordinates of X = 2,630,218.40 and Y = 110,148.28; South 38 degrees 24 minutes 07 seconds West 336.62 feet to a point having Coordinates of X = 2,630,009.30 and Y = 109,884.48; South 40 degrees 46 minutes 14 seconds West 723.86 feet to a point having Coordinates of X = 2,629,536.60 and Y = 109,336.28; South 45 degrees 55 minutes 20 seconds West 1,137.81 feet to a point having Coordinates of X = 2,628,719.20 and Y = 108,544.78; Southwesterly along an arc to the left having a radius of 786.30 feet and a center at X = 2,629,216.84 and Y = 107,935.99 to a point having Coordinates X = 2,628,455.80 and Y = 108,133.68; South 19 degrees 29 minutes 22 seconds West 719.95 feet to a point having Coordinates of X = 2,628,215.60 and Y = 107,454.98 and South 17 degrees 25 minutes 59 seconds West 1,065.12 feet to a point having Coordinates X = 2,627,896.50 and Y = 106,438.78; thence South 53 degrees 02 minutes 34 seconds West 736.47 feet to a point having Coordinates X = 2,627,308.00 and Y = 105,996.00; thence South 58 degrees 01 minutes 13 seconds East 263.96 feet to a point having Coordinates X = 2,627,531.90 and Y = 105,856.20; thence South 252.89 feet to the point of beginning, **LESS AND EXCEPT** that portion, if any, of State

Lease No. 2552, as amended, and State Lease No. 2565, as amended, which may lie within the above described tract, containing approximately **350 acres**, all as more particularly outlined on a plat on file in the Office of Mineral Resources, Department of Natural Resources. All bearings, distances and coordinates are based on Louisiana Coordinate System of 1927, (North or South Zone).

NOTE: The above description of the Tract nominated for lease has been provided and corrected, where required, exclusively by the nomination party. Any mineral lease selected from this Tract and awarded by the Louisiana State Mineral Board shall be without warranty of any kind, either express, implied, or statutory, including, but not limited to, the implied warranties of merchantability and fitness for a particular purpose. Should the mineral lease awarded by the Louisiana State Mineral Board be subsequently modified, cancelled or abrogated due to the existence of conflicting leases, operating agreements, private claims or other future obligations or conditions which may affect all or any portion of the leased Tract, it shall not relieve the Lessee of the obligation to pay any bonus due thereon to the Louisiana State Mineral Board, nor shall the Louisiana State Mineral Board be obligated to refund any consideration paid by the Lessor prior to such modification, cancellation, or abrogation, including, but not limited to, bonuses, rentals and royalties.

NOTE: The State of Louisiana does hereby reserve, and this lease shall be subject to, the imprescriptible right of surface use in the nature of a servitude in favor of the Department of Natural Resources, including its Offices and Commissions, for the sole purpose of implementing, constructing, servicing and maintaining approved coastal zone management and/or restoration projects. Utilization of any and all rights derived under this lease by the mineral lessee, its agents, successors or assigns, shall not interfere with nor hinder the reasonable surface use by the Department of Natural Resources, its Offices or Commissions, as herein above reserved.

NOTE: It appears, according to our records, that a portion of this Tract is located within the restrictive safety fairway area as set out by the Corps of Engineers, U.S. Army and/or the restrictive anchorage area as set out by the U.S. Coast Guard.

NOTE: The Department of Wildlife and Fisheries has designated certain areas in the coastal waters of the State of Louisiana as Oyster Seed Bed Areas. The exact location of those Seed Bed Areas must be obtained from the Department of Wildlife and Fisheries and any work done under a mineral lease from the State of Louisiana may necessarily be conducted in conformity with the rules and regulations promulgated by the said Department of Wildlife and Fisheries for Oyster Seed Bed Areas.

Applicant: DELTA LANDS EXPLORATION, INC.

Bidder	Cash Payment	Price/ Acre	Rental	Oil	Gas	Other

**Legend**

- 08050011
- Blocks
- Active\_Leases



**TRACT 39803 - Portion of Block 40, South Pass Area, Plaquemines Parish, Louisiana**

The beds and bottoms of all water bodies belonging to the State of Louisiana located in Block 40, South Pass Area, together with any present lands formed by accretion to the shoreline or islands formed therein, located in Plaquemines Parish, Louisiana, owned by and not presently under mineral lease as of May 14, 2008, from the State of Louisiana, the geographical area of which is more fully described as follows: Beginning at a point within Block 40, South Pass Area, having Coordinates of X = 2,627,531.90 and Y = 99,806.44; thence West 5,800.95 feet to a point having Coordinates X = 2,621,730.95 and Y = 99,806.44; thence North 2,899.07 feet to a point on the Eastern boundary of State Lease No. 2552, as amended, having Coordinates of X = 2,621,730.95 and Y = 102,705.50; thence along the boundary of said State Lease No. 2552 the following courses: North 57 degrees 59 minutes 41 seconds East 753.54 feet to a point having Coordinates of X = 2,622,369.95 and Y = 103,104.88; North 62 degrees 02 minutes 38 seconds East 1,013.24 feet to a point having Coordinates of X = 2,623,264.95 and Y = 103,579.88; North 63 degrees 44 minutes 00 seconds East 858.67 feet to a point having Coordinates of X = 2,624,034.96 and Y = 103,959.88; North 65 degrees 43 minutes 23 seconds East 1,653.91 feet to a point having Coordinates of X = 2,625,542.61 and Y = 104,639.88; North 515.00 feet to a point having Coordinates of X = 2,625,542.61 and Y = 105,154.88 and North 35 degrees 47 minutes 41 seconds West 552.85 feet to a point having Coordinates of X = 2,625,219.26 and Y = 105,603.31; thence East 2,312.64 feet to a point having Coordinates X = 2,627,531.90 and Y = 105,603.31; thence South 5,796.88 feet to the point of beginning, containing approximately **610.09 acres**, all as more particularly outlined on a plat on file in the Office of Mineral Resources, Department of Natural Resources. All bearings, distances and coordinates are based on Louisiana Coordinate System of 1927, (North or South Zone).

NOTE: The above description of the Tract nominated for lease has been provided and corrected, where required, exclusively by the nomination party. Any mineral lease selected from this Tract and awarded by the Louisiana State Mineral Board shall be without warranty of any kind, either express, implied, or statutory, including, but not limited to, the implied warranties of merchantability and fitness for a particular purpose. Should the mineral lease awarded by the Louisiana State Mineral Board be subsequently modified, cancelled or abrogated due to the existence of conflicting leases, operating agreements, private claims or other future obligations or conditions which may affect all or any portion of the leased Tract, it shall not relieve the Lessee of the obligation to pay any bonus due thereon to the Louisiana State Mineral Board, nor shall the Louisiana State Mineral Board be obligated to refund any consideration paid by the Lessor prior to such modification, cancellation, or abrogation, including, but not limited to, bonuses, rentals and royalties.

NOTE: The State of Louisiana does hereby reserve, and this lease shall be subject to, the imprescriptible right of surface use in the nature of a servitude in favor of the Department of Natural Resources, including its Offices and Commissions, for the sole purpose of implementing, constructing, servicing and maintaining approved coastal zone management and/or restoration projects. Utilization of any and all rights derived under this lease by the mineral lessee, its agents, successors or assigns, shall not interfere with nor hinder the reasonable surface use by the Department of Natural Resources, its Offices or Commissions, as herein above reserved.

NOTE: It appears, according to our records, that a portion of this Tract is located within the restrictive safety fairway area as set out by the Corps of Engineers, U.S. Army and/or the restrictive anchorage area as set out by the U.S. Coast Guard.

NOTE: The Department of Wildlife and Fisheries has designated certain areas in the coastal waters of the State of Louisiana as Oyster Seed Bed Areas. The exact location of those Seed Bed Areas must be obtained from the Department of Wildlife and Fisheries and any work done under a mineral lease from the State of Louisiana may necessarily be conducted in conformity with the rules and regulations promulgated by the said Department of Wildlife and Fisheries for Oyster Seed Bed Areas.

Applicant: DELTA LANDS EXPLORATION, INC.

Bidder	Cash Payment	Price/ Acre	Rental	Oil	Gas	Other

**Legend**

- 08050012
- Blocks
- Active\_Leases



**TRACT 39804 - Portion of Blocks 40, and 42, South Pass Area, Plaquemines Parish, Louisiana**

The beds and bottoms of all water bodies belonging to the State of Louisiana located in Blocks 40, and 42, South Pass Area, together with any present lands formed by accretion to the shoreline or islands formed therein, located in Plaquemines Parish, Louisiana, owned by and not presently under mineral lease as of May 14, 2008, from the State of Louisiana, the geographical area of which is more fully described as follows: Beginning at a point within Block 42, South Pass Area, having Coordinates of X = 2,621,730.95 and Y = 95,342.10; thence West 5,802.95 feet to the Southeast corner of State Lease No. 17193 having Coordinates of X = 2,615,928.00 and Y = 95,342.10; thence North 3,842.91 feet along the East boundary of said State Lease No. 17193 to its Northeast corner, also being a point on the Eastern boundary of State Lease No. 2566, as amended, having Coordinates of X = 2,615,928.00 and Y = 99,185.01; thence Northeasterly approximately 674 feet along the Eastern boundary of said State Lease No. 2566 to the Westernmost point of State Lease No. 2552, as amended; thence along the boundary of said State Lease No. 2552 the following courses: South 81 degrees 39 minutes 13 seconds East approximately 606 feet to a point having Coordinates of X = 2,617,059.91 and Y = 99,509.84; North 48 degrees 27 minutes 12 seconds East 821.74 feet to a point having Coordinates of X = 2,617,674.91 and Y = 100,054.85; North 49 degrees 50 minutes 38 seconds East 628.04 feet to a point having Coordinates of X = 2,618,154.92 and Y = 100,459.85; North 51 degrees 45 minutes 58 seconds East 630.18 feet to a point having Coordinates of X = 2,618,649.92 and Y = 100,849.85; North 54 degrees 27 minutes 44 seconds East 430.12 feet to a point having Coordinates of X = 2,618,999.92 and Y = 101,099.86; North 54 degrees 14 minutes 46 seconds East 924.18 feet to a point having Coordinates of X = 2,619,749.92 and Y = 101,639.86; South 04 degrees 53 minutes 07 seconds East 587.14 feet to a point having Coordinates of X = 2,619,799.92 and Y = 101,054.85; North 41 degrees 51 minutes 49 seconds East 516.97 feet to a point having Coordinates of X = 2,620,144.93 and Y = 101,439.86; North 45 degrees 37 minutes 47 seconds East 321.76 feet to a point having Coordinates of X = 2,620,374.93 and Y = 101,664.86; North 47 degrees 56 minutes 08 seconds East 276.14 feet to a point having Coordinates of X = 2,620,579.94 and Y = 101,849.87; North 48 degrees 40 minutes 40 seconds East 386.15 feet to a point having Coordinates of X = 2,620,869.94 and Y = 102,104.84; North 53 degrees 38 minutes 23 seconds East 447.04 feet to a point having Coordinates of X = 2,621,229.94 and Y = 102,369.87; North 56 degrees 10 minutes 40 seconds East 601.86 feet to a point having Coordinates of X = 2,621,729.95 and Y = 102,704.88 and North 57 degrees 59 minutes 41 seconds East 1.18 feet to a point having Coordinates of X = 2,621,730.95 and Y = 102,705.50; thence South 7,363.40 feet to the point of beginning, **LESS AND EXCEPT** that portion, if any, of State Lease No. 2552, as amended, and State Lease No. 2566, as amended, which may lie within the above described tract, containing approximately **734 acres**, all as more particularly outlined on a plat on file in the Office of Mineral Resources, Department of Natural



Resources. All bearings, distances and coordinates are based on Louisiana Coordinate System of 1927, (North or South Zone).

NOTE: The above description of the Tract nominated for lease has been provided and corrected, where required, exclusively by the nomination party. Any mineral lease selected from this Tract and awarded by the Louisiana State Mineral Board shall be without warranty of any kind, either express, implied, or statutory, including, but not limited to, the implied warranties of merchantability and fitness for a particular purpose. Should the mineral lease awarded by the Louisiana State Mineral Board be subsequently modified, cancelled or abrogated due to the existence of conflicting leases, operating agreements, private claims or other future obligations or conditions which may affect all or any portion of the leased Tract, it shall not relieve the Lessee of the obligation to pay any bonus due thereon to the Louisiana State Mineral Board, nor shall the Louisiana State Mineral Board be obligated to refund any consideration paid by the Lessor prior to such modification, cancellation, or abrogation, including, but not limited to, bonuses, rentals and royalties.

NOTE: The State of Louisiana does hereby reserve, and this lease shall be subject to, the imprescriptible right of surface use in the nature of a servitude in favor of the Department of Natural Resources, including its Offices and Commissions, for the sole purpose of implementing, constructing, servicing and maintaining approved coastal zone management and/or restoration projects. Utilization of any and all rights derived under this lease by the mineral lessee, its agents, successors or assigns, shall not interfere with nor hinder the reasonable surface use by the Department of Natural Resources, its Offices or Commissions, as herein above reserved.

NOTE: It appears, according to our records, that a portion of this Tract is located within the restrictive safety fairway area as set out by the Corps of Engineers, U.S. Army and/or the restrictive anchorage area as set out by the U.S. Coast Guard.

NOTE: The Department of Wildlife and Fisheries has designated certain areas in the coastal waters of the State of Louisiana as Oyster Seed Bed Areas. The exact location of those Seed Bed Areas must be obtained from the Department of Wildlife and Fisheries and any work done under a mineral lease from the State of Louisiana may necessarily be conducted in conformity with the rules and regulations promulgated by the said Department of Wildlife and Fisheries for Oyster Seed Bed Areas.

Applicant: DELTA LANDS EXPLORATION, INC.

Bidder	Cash Payment	Price/ Acre	Rental	Oil	Gas	Other

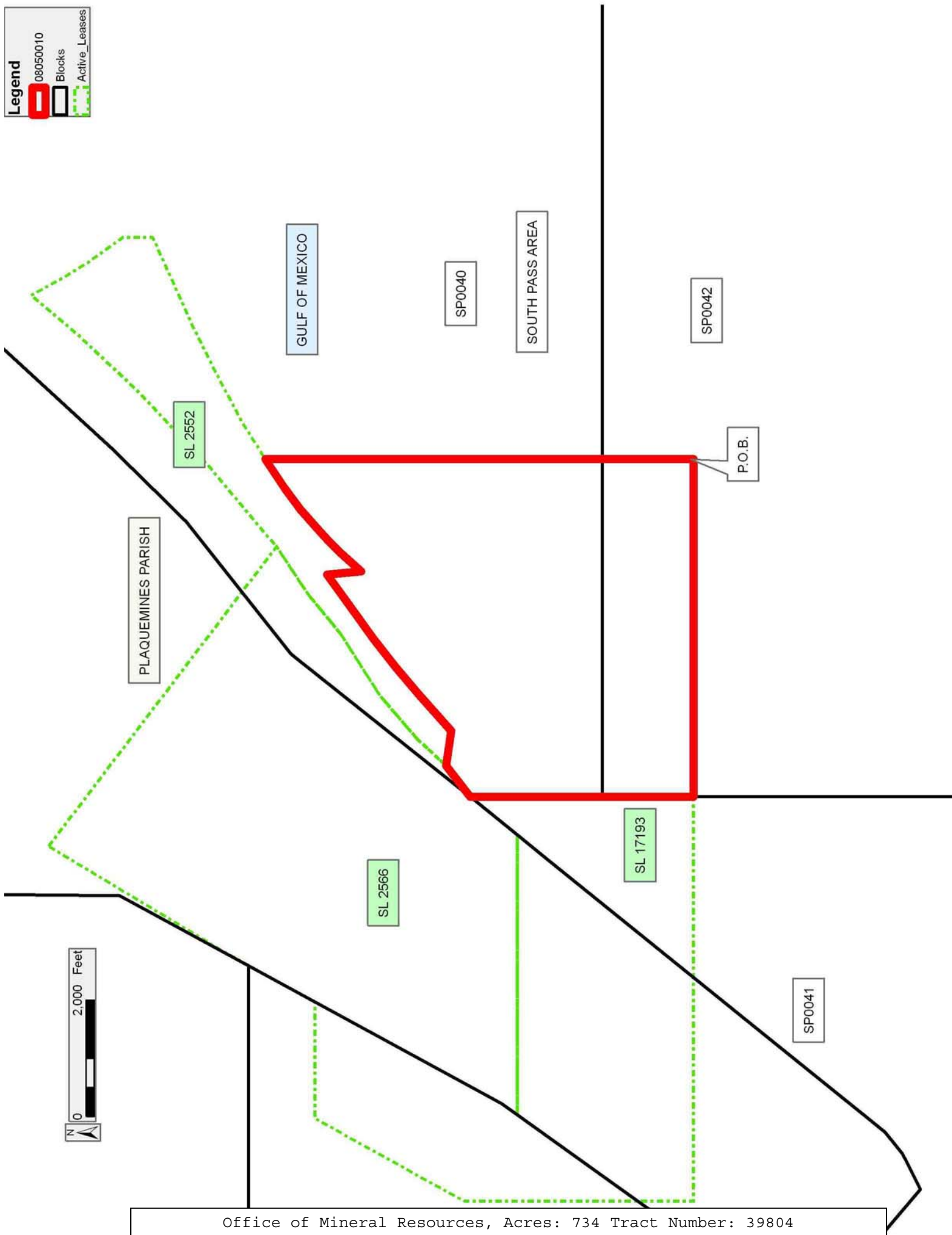

**TRACT 39805 - Portion of Blocks 40, and 42, South Pass Area, Plaquemines Parish, Louisiana**

The beds and bottoms of all water bodies belonging to the State of Louisiana located in Blocks 40, and 42, South Pass Area, together with any present lands formed by accretion to the shoreline or islands formed therein, located in Plaquemines Parish, Louisiana, owned by and not presently under mineral lease as of May 14, 2008, from the State of Louisiana, the geographical area of which is more fully described as follows: Beginning at a point within Block 42, South Pass Area, having Coordinates of X = 2,627,531.90 and Y = 95,342.10; thence West 5,800.95 feet to a point having Coordinates X = 2,621,730.95 and Y = 95,342.10; thence North 4,464.34 feet to a point within Block 40, South Pass Area, having Coordinates X = 2,621,730.95 and Y = 99,806.44; thence East 5,800.95 feet to a point having Coordinates X = 2,627,531.90 and Y = 99,806.44; thence South 4,464.34 feet to the point of beginning, containing approximately **594.52 acres**, all as more particularly outlined on a plat on file in the Office of Mineral Resources, Department of Natural Resources. All bearings, distances and coordinates are based on Louisiana Coordinate System of 1927, (North or South Zone).

NOTE: The above description of the Tract nominated for lease has been provided and corrected, where required, exclusively by the nomination party. Any mineral lease selected from this Tract and awarded by the Louisiana State Mineral Board shall be without warranty of any kind, either express, implied, or statutory, including, but not limited to, the implied warranties of merchantability and fitness for a particular purpose. Should the mineral lease awarded by the Louisiana State Mineral Board be subsequently modified, cancelled or abrogated due to the existence of conflicting leases, operating agreements, private claims or other future obligations or conditions which may affect all or any portion of the leased Tract, it shall not relieve the Lessee of the obligation to pay any bonus due thereon to the Louisiana State Mineral Board, nor shall the Louisiana State Mineral Board be obligated to refund any consideration paid by the Lessor prior to such modification, cancellation, or abrogation, including, but not limited to, bonuses, rentals and royalties.

NOTE: The State of Louisiana does hereby reserve, and this lease shall be subject to, the imprescriptible right of surface use in the nature of a servitude in favor of the Department of Natural Resources, including its Offices and Commissions, for the sole purpose of implementing, constructing, servicing and maintaining approved coastal zone management and/or restoration projects. Utilization of any and all rights derived under this lease by the mineral lessee, its agents, successors or assigns, shall not interfere with nor hinder the reasonable surface use by the Department of Natural Resources, its Offices or Commissions, as herein above reserved.

NOTE: It appears, according to our records, that a portion of this Tract is located within the restrictive safety fairway area as set out by the

Corps of Engineers, U.S. Army and/or the restrictive anchorage area as set out by the U.S. Coast Guard.

NOTE: The Department of Wildlife and Fisheries has designated certain areas in the coastal waters of the State of Louisiana as Oyster Seed Bed Areas. The exact location of those Seed Bed Areas must be obtained from the Department of Wildlife and Fisheries and any work done under a mineral lease from the State of Louisiana may necessarily be conducted in conformity with the rules and regulations promulgated by the said Department of Wildlife and Fisheries for Oyster Seed Bed Areas.

Applicant: DELTA LANDS EXPLORATION, INC.

Bidder	Cash Payment	Price/ Acre	Rental	Oil	Gas	Other

Legend

08050009

Blocks

