

TRACT 38272 - Portion of Block 18, Eugene Island Area, Revised, St. Mary Parish, Louisiana

The beds and bottoms of all water bodies belonging to the State of Louisiana located in Block 18, Eugene Island Area, Revised, together with any present lands formed by accretion to the shoreline or islands formed therein, located in St. Mary Parish, Louisiana, owned by and not presently under mineral lease and cross hatched as of May 10, 2006, from the State of Louisiana, the geographical area of which is more fully described as follows: Beginning at a point on the West line of Block 18, Eugene Island Area, Revised, also being the Southwest corner of State Lease No. 1667, as amended, having Coordinates of X = 1,939,911.36 and Y = 247,079.31; thence along the boundary of said State Lease No. 1667 the following courses and distances: East 7,511.08 feet and North 1,316.11 feet to the Western most Southwest corner of State Lease No.1536, as amended, having Coordinates of X = 1,947,422.44 and Y = 248,395.42; thence along the boundary of said State Lease No. 1536 the following courses and distances: East 741.08 feet, South 2,246.75 feet, North 67 degrees 53 minutes 47 seconds East 481.90 feet, South 67 degrees 45 minutes 04 seconds East 237.70 feet and North 87 degrees 03 minutes 52 seconds East 406.75 feet to the Western most Northwest corner of State Lease No. 17121 having Coordinates of X = 1,949,236.22 and Y = 246,260.83; thence South 26 degrees 40 minutes 51 seconds East 3,438.11 feet along the boundary of said State Lease No. 17121 to its Southern most Southwest corner, also being the Southwest corner of State Lease No. 14354 having Coordinates of X = 1,950,780.00 and Y = 243,188.80; thence East 126.83 feet along the South line of said State Lease No. 14354 to the Northwest corner of State Lease No. 18696 having Coordinates of X = 1,950,906.83 and Y = 243,188.80; thence South 2,293.38 feet along the West line of said State Lease No. 18696 to its Southwest corner, also being a point on the South line of said Block 18 having Coordinates of X = 1,950,906.83 and Y = 240,895.42; thence West 636.39 feet along the South line of said Block 18 to a point having Coordinates of X = 1,950,270.44 and Y = 240,895.42; thence Northwesterly on a straight line to a point on the West line of said Block 18 having Coordinates of X = 1,939,911.36 and Y = 245,426.62; thence North 1,652.69 feet along the West line of said Block 18 to the point of beginning, containing approximately **929.43 acres, LESS AND EXCEPT** that portion thereof, if any, lying seaward of the line three nautical miles from the coast line of Louisiana, as said three mile line has been decreed by the Supreme Court of the United States, as determined by a Special Master appointed therein, in litigation styled **United States v. State of Louisiana et al No. 9 Original**, in 1975, all as more particularly outlined on a plat in the Office of Mineral Resources, Department of Natural Resources. All bearings, distances and coordinates are based on the Louisiana Coordinate System of 1927, (South Zone).

NOTE: The above description of the Tract nominated for lease has been provided and corrected, where required, exclusively by the nomination party. Any mineral lease selected from this Tract and awarded by the Louisiana State Mineral Board shall be without warranty of any kind,

either express, implied, or statutory, including, but not limited to, the implied warranties of merchantability and fitness for a particular purpose. Should the mineral lease awarded by the Louisiana State Mineral Board be subsequently modified, cancelled or abrogated due to the existence of conflicting leases, operating agreements, private claims or other future obligations or conditions which may affect all or any portion of the leased Tract, it shall not relieve the Lessee of the obligation to pay any bonus due thereon to the Louisiana State Mineral Board, nor shall the Louisiana State Mineral Board be obligated to refund any consideration paid by the Lessor prior to such modification, cancellation, or abrogation, including, but not limited to, bonuses, rentals and royalties.

NOTE: The above described tract may be in the vicinity of existing shell reefs where drilling and dredging operations must be conducted in strict conformity with the regulations adopted by the Louisiana Department of Wildlife and Fisheries and/or the U.S. Corps of Engineers, U.S. Army.

NOTE: The State of Louisiana does hereby reserve, and this lease shall be subject to, the imprescriptible right of surface use in the nature of a servitude in favor of the Department of Natural Resources, including its Offices and Commissions, for the sole purpose of implementing, constructing, servicing and maintaining approved coastal zone management and/or restoration projects. Utilization of any and all rights derived under this lease by the mineral lessee, its agents, successors or assigns, shall not interfere with nor hinder the reasonable surface use by the Department of Natural Resources, its Offices or Commissions, as herein above reserved.

NOTE: The Department of Wildlife and Fisheries has designated certain areas in the coastal waters of the State of Louisiana as Oyster Seed Bed Areas. The exact location of those Seed Bed Areas must be obtained from the Department of Wildlife and Fisheries and any work done under a mineral lease from the State of Louisiana may necessarily be conducted in conformity with the rules and regulations promulgated by the said Department of Wildlife and Fisheries for Oyster Seed Bed Areas.

Applicant: PATRICK L. DONOHUE PETROLEUM PROPERTIES, INC.

Bidder	Cash Payment	Price/Acre	Rental	Oil	Gas	Other

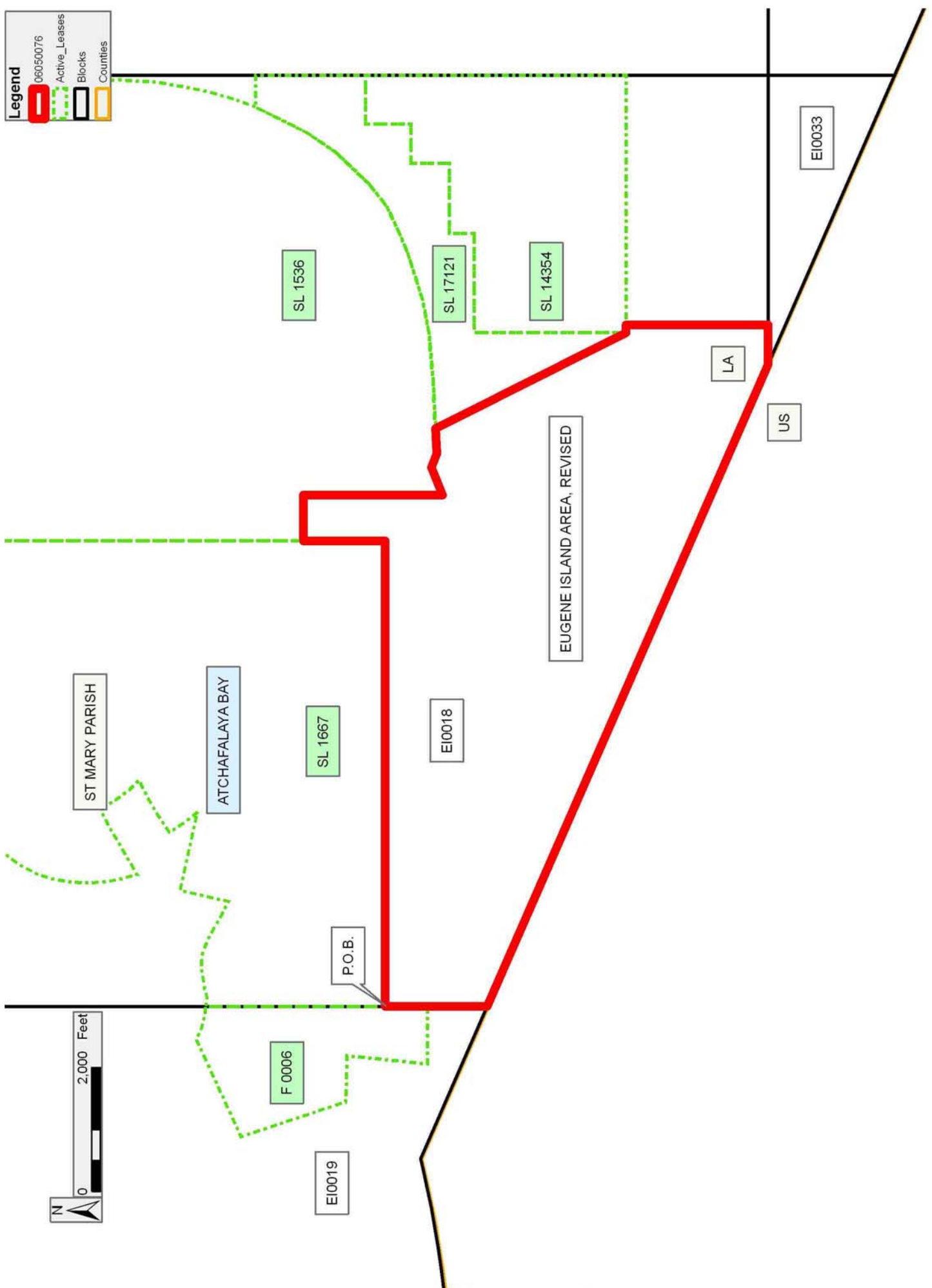

TRACT 38273 - Portion of Block 17, Eugene Island Area, Revised, St. Mary Parish, Louisiana

The beds and bottoms of all water bodies belonging to the State of Louisiana located in Block 17, Eugene Island Area, Revised, together with any present lands formed by accretion to the shoreline or islands formed therein, located in St. Mary Parish, Louisiana, owned by and not presently under mineral lease as of May 10, 2006, from the State of Louisiana, the geographical area of which is more fully described as follows: Beginning at a point on the West line of Block 17, Eugene Island Area, Revised, also being the Western most Northwest corner of State Lease No. 18697 having Coordinates of X = 1,954,933.52 and Y = 244,144.71; thence North 2,050.70 feet along the West line of said Block 17 to the Northern most Southwest corner of State Lease No. 18501 having Coordinates of X = 1,954,933.52 and Y = 246,195.41; thence South 35 degrees 02 minutes 33 seconds East 1,885.38 feet along the boundary of said State Lease No. 18501 to a Southwest corner, also being the Northern most Northwest corner of said State Lease No. 18697 having Coordinates of X = 1,956,016.07 and Y = 244,651.80; thence along the boundary of said State Lease No. 18697 the following courses and distances: South 43 degrees 34 minutes 46 seconds West 700.00 feet to a point having Coordinates of X = 1,955,533.52 and Y = 244,144.71 and West 600.00 feet to the point of beginning, containing approximately **28.97 acres**, all as more particularly outlined on a plat on file in the Office of Mineral Resources, Department of Natural Resources. All bearings, distances and coordinates are based on Louisiana Coordinate System of 1927, (North or South Zone).

NOTE: The above description of the Tract nominated for lease has been provided and corrected, where required, exclusively by the nomination party. Any mineral lease selected from this Tract and awarded by the Louisiana State Mineral Board shall be without warranty of any kind, either express, implied, or statutory, including, but not limited to, the implied warranties of merchantability and fitness for a particular purpose. Should the mineral lease awarded by the Louisiana State Mineral Board be subsequently modified, cancelled or abrogated due to the existence of conflicting leases, operating agreements, private claims or other future obligations or conditions which may affect all or any portion of the leased Tract, it shall not relieve the Lessee of the obligation to pay any bonus due thereon to the Louisiana State Mineral Board, nor shall the Louisiana State Mineral Board be obligated to refund any consideration paid by the Lessor prior to such modification, cancellation, or abrogation, including, but not limited to, bonuses, rentals and royalties.

NOTE: The above described tract may be in the vicinity of existing shell reefs where drilling and dredging operations must be conducted in strict conformity with the regulations adopted by the Louisiana Department of Wildlife and Fisheries and/or the U.S. Corps of Engineers, U.S. Army.

NOTE: The State of Louisiana does hereby reserve, and this lease shall be subject to, the imprescriptible right of surface use in the nature of a



servitude in favor of the Department of Natural Resources, including its Offices and Commissions, for the sole purpose of implementing, constructing, servicing and maintaining approved coastal zone management and/or restoration projects. Utilization of any and all rights derived under this lease by the mineral lessee, its agents, successors or assigns, shall not interfere with nor hinder the reasonable surface use by the Department of Natural Resources, its Offices or Commissions, as herein above reserved.

NOTE: The Department of Wildlife and Fisheries has designated certain areas in the coastal waters of the State of Louisiana as Oyster Seed Bed Areas. The exact location of those Seed Bed Areas must be obtained from the Department of Wildlife and Fisheries and any work done under a mineral lease from the State of Louisiana may necessarily be conducted in conformity with the rules and regulations promulgated by the said Department of Wildlife and Fisheries for Oyster Seed Bed Areas.

Applicant: PATRICK L. DONOHUE PETROLEUM PROPERTIES, INC.

Bidder	Cash Payment	Price/Acre	Rental	Oil	Gas	Other

Legend

-  06050072
-  Blocks
-  Active_Leases
-  Counties

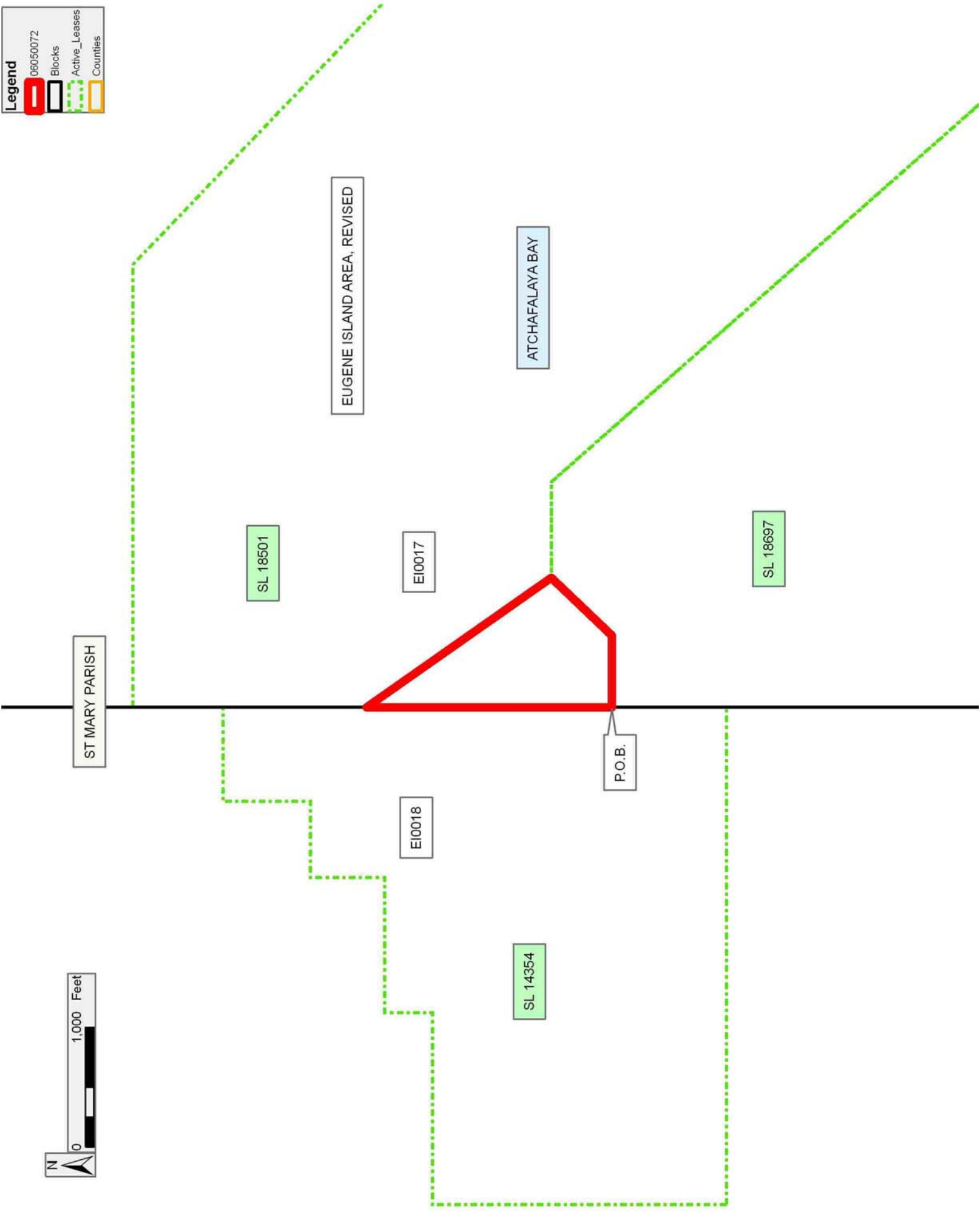

TRACT 38274 - Portion of Blocks 34, and 35, Eugene Island Area, Revised, St. Mary Parish, Louisiana

The beds and bottoms of all water bodies belonging to the State of Louisiana located in Blocks 34, and 35, Eugene Island Area, Revised, together with any present lands formed by accretion to the shoreline or islands formed therein, located in St. Mary Parish, Louisiana, owned by and not presently under mineral lease and cross hatched as of May 10, 2006, from the State of Louisiana, the geographical area of which is more fully described as follows: Beginning at a point on the North line of Block 34, Eugene Island Area, Revised, having Coordinates of X = 1,968,750.44 and Y = 240,895.42; thence East 1,205.24 feet along the North line of said Block 34 to its Northeast corner, also being the Northwest corner of Block 35, Eugene Island Area, Revised, having Coordinates of X = 1,969,955.68 and Y = 240,895.42; thence East 5,000.00 feet along the North line of said Block 35 to a point having Coordinates of X = 1,974,955.68 and Y = 240,895.42; thence South 12,986.80 feet to a point having Coordinates of X = 1,974,955.68 and Y = 227,908.62; thence along an arc to the right having a radius of 18,240.60 feet and a center at X = 1,987,371 and Y = 241,272 to a point having Coordinates of X = 1,972,054 and Y = 231,367; thence Northwesterly on a straight line to a point on the West line of said Block 35, also being the East line of said Block 34 having Coordinates of X = 1,969,955.68 and Y = 232,284.83; thence Northwesterly on a straight line to a point having Coordinates of X = 1,968,750.44 and Y = 232,812.02; thence North 8,083.40 feet to the point of beginning, containing approximately **1,427.44 acres, LESS AND EXCEPT** that portion thereof, if any, lying seaward of the line three nautical miles from the coast line of Louisiana, as said three mile line has been decreed by the Supreme Court of the United States, as determined by a Special Master appointed therein, in litigation styled **United States v. State of Louisiana et al No. 9 Original**, in 1975, all as more particularly outlined on a plat in the Office of Mineral Resources, Department of Natural Resources. All bearings, distances and coordinates are based on the Louisiana Coordinate System of 1927, (South Zone).

NOTE: The above description of the Tract nominated for lease has been provided and corrected, where required, exclusively by the nomination party. Any mineral lease selected from this Tract and awarded by the Louisiana State Mineral Board shall be without warranty of any kind, either express, implied, or statutory, including, but not limited to, the implied warranties of merchantability and fitness for a particular purpose. Should the mineral lease awarded by the Louisiana State Mineral Board be subsequently modified, cancelled or abrogated due to the existence of conflicting leases, operating agreements, private claims or other future obligations or conditions which may affect all or any portion of the leased Tract, it shall not relieve the Lessee of the obligation to pay any bonus due thereon to the Louisiana State Mineral Board, nor shall the Louisiana State Mineral Board be obligated to refund any consideration paid by the Lessor prior to such modification, cancellation, or abrogation, including, but not limited to, bonuses, rentals and royalties.

NOTE: The above described tract may be in the vicinity of existing shell reefs where drilling and dredging operations must be conducted in strict conformity with the regulations adopted by the Louisiana Department of Wildlife and Fisheries and/or the U.S. Corps of Engineers, U.S. Army.

NOTE: The State of Louisiana does hereby reserve, and this lease shall be subject to, the imprescriptible right of surface use in the nature of a servitude in favor of the Department of Natural Resources, including its Offices and Commissions, for the sole purpose of implementing, constructing, servicing and maintaining approved coastal zone management and/or restoration projects. Utilization of any and all rights derived under this lease by the mineral lessee, its agents, successors or assigns, shall not interfere with nor hinder the reasonable surface use by the Department of Natural Resources, its Offices or Commissions, as herein above reserved.

NOTE: It appears, according to our records, that a portion of this Tract is located within the restrictive safety fairway area as set out by the Corps of Engineers, U.S. Army and/or the restrictive anchorage area as set out by the U.S. Coast Guard.

NOTE: The Department of Wildlife and Fisheries has designated certain areas in the coastal waters of the State of Louisiana as Oyster Seed Bed Areas. The exact location of those Seed Bed Areas must be obtained from the Department of Wildlife and Fisheries and any work done under a mineral lease from the State of Louisiana may necessarily be conducted in conformity with the rules and regulations promulgated by the said Department of Wildlife and Fisheries for Oyster Seed Bed Areas.

Applicant: PATRICK L. DONOHUE PETROLEUM PROPERTIES, INC.

Bidder	Cash Payment	Price/Acre	Rental	Oil	Gas	Other

Legend

- 06050073 Active_Leases
- Blocks
- Counties

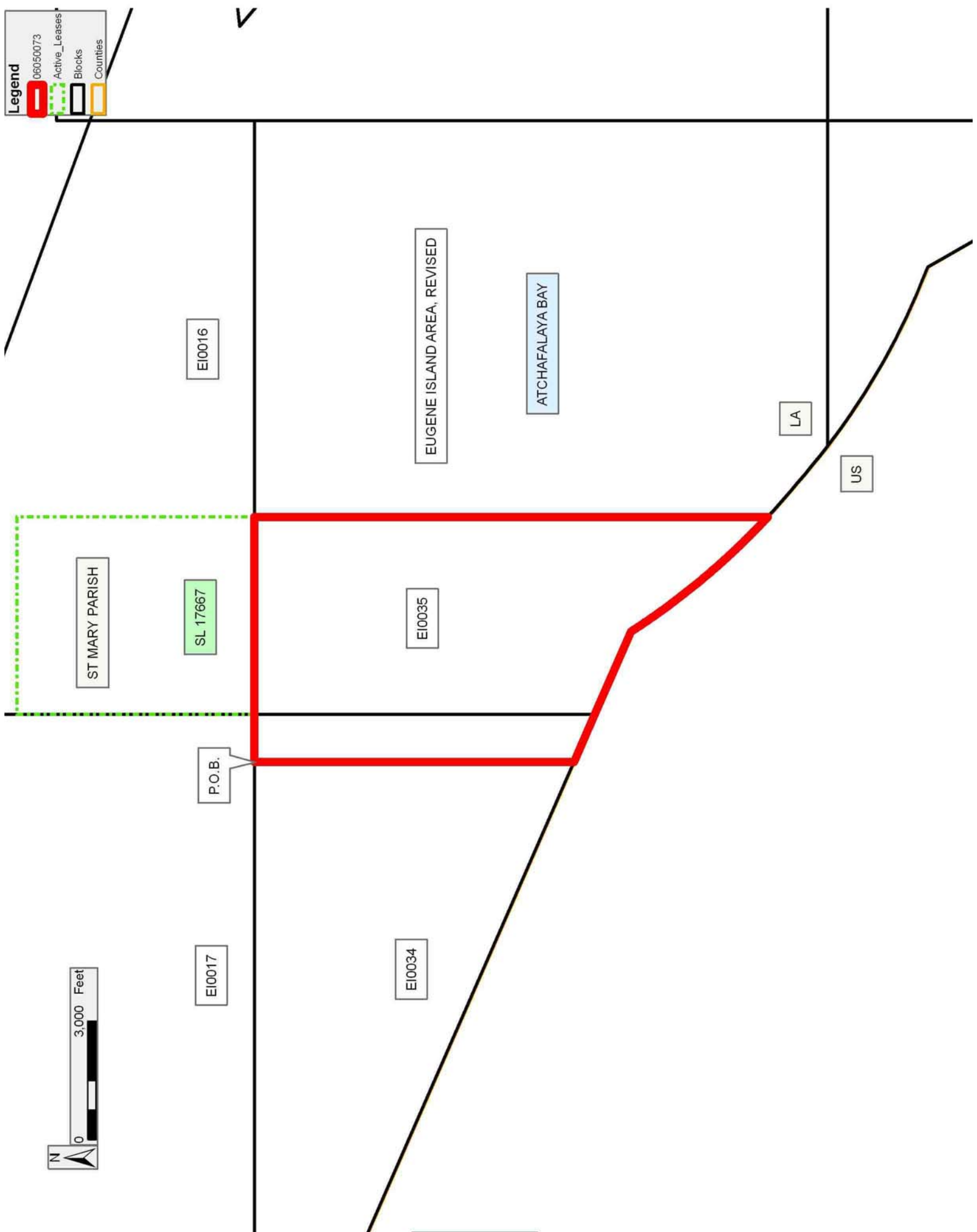

TRACT 38275 - Portion of Blocks 33, and 34, Eugene Island Area, Revised, St. Mary Parish, Louisiana

The beds and bottoms of all water bodies belonging to the State of Louisiana located in Blocks 33, and 34, Eugene Island Area, Revised, together with any present lands formed by accretion to the shoreline or islands formed therein, located in St. Mary Parish, Louisiana, owned by and not presently under mineral lease and cross hatched as of May 10, 2006, from the State of Louisiana, the geographical area of which is more fully described as follows: Beginning at a point on the North line of Block 34, Eugene Island Area, Revised, having Coordinates of X = 1,968,750.44 and Y = 240,895.42; thence South 8,083.40 feet to a point having Coordinates of X = 1,968,750.44 and Y = 232,812.02; thence Northwesterly on a straight line to a point on the West line of said Block 34, also being the East line of Block 33, Eugene Island Area, Revised, having Coordinates of X = 1,954,933.52 and Y = 238,855.73; thence Northwesterly on a straight line to a point on the North line of said Block 33 having Coordinates of X = 1,950,270.44 and Y = 240,895.42; thence East 4,663.08 feet along the North line of said Block 33 to its Northeast corner, also being the Northwest corner of said Block 34 having Coordinates of X = 1,954,933.52 and Y = 240,895.42; thence East 13,816.92 feet to the point of beginning, containing approximately **1,714.66 acres, LESS AND EXCEPT** that portion thereof, if any, lying seaward of the line three nautical miles from the coast line of Louisiana, as said three mile line has been decreed by the Supreme Court of the United States, as determined by a Special Master appointed therein, in litigation styled **United States v. State of Louisiana et al No. 9 Original**, in 1975, all as more particularly outlined on a plat in the Office of Mineral Resources, Department of Natural Resources. All bearings, distances and coordinates are based on the Louisiana Coordinate System of 1927, (South Zone).

NOTE: The above description of the Tract nominated for lease has been provided and corrected, where required, exclusively by the nomination party. Any mineral lease selected from this Tract and awarded by the Louisiana State Mineral Board shall be without warranty of any kind, either express, implied, or statutory, including, but not limited to, the implied warranties of merchantability and fitness for a particular purpose. Should the mineral lease awarded by the Louisiana State Mineral Board be subsequently modified, cancelled or abrogated due to the existence of conflicting leases, operating agreements, private claims or other future obligations or conditions which may affect all or any portion of the leased Tract, it shall not relieve the Lessee of the obligation to pay any bonus due thereon to the Louisiana State Mineral Board, nor shall the Louisiana State Mineral Board be obligated to refund any consideration paid by the Lessor prior to such modification, cancellation, or abrogation, including, but not limited to, bonuses, rentals and royalties.

NOTE: The above described tract may be in the vicinity of existing shell reefs where drilling and dredging operations must be conducted in strict

conformity with the regulations adopted by the Louisiana Department of Wildlife and Fisheries and/or the U.S. Corps of Engineers, U.S. Army.

NOTE: The State of Louisiana does hereby reserve, and this lease shall be subject to, the imprescriptible right of surface use in the nature of a servitude in favor of the Department of Natural Resources, including its Offices and Commissions, for the sole purpose of implementing, constructing, servicing and maintaining approved coastal zone management and/or restoration projects. Utilization of any and all rights derived under this lease by the mineral lessee, its agents, successors or assigns, shall not interfere with nor hinder the reasonable surface use by the Department of Natural Resources, its Offices or Commissions, as herein above reserved.

NOTE: It appears, according to our records, that a portion of this Tract is located within the restrictive safety fairway area as set out by the Corps of Engineers, U.S. Army and/or the restrictive anchorage area as set out by the U.S. Coast Guard.

NOTE: The Department of Wildlife and Fisheries has designated certain areas in the coastal waters of the State of Louisiana as Oyster Seed Bed Areas. The exact location of those Seed Bed Areas must be obtained from the Department of Wildlife and Fisheries and any work done under a mineral lease from the State of Louisiana may necessarily be conducted in conformity with the rules and regulations promulgated by the said Department of Wildlife and Fisheries for Oyster Seed Bed Areas.

Applicant: PATRICK L. DONOHUE PETROLEUM PROPERTIES, INC.

Bidder	Cash Payment	Price/Acre	Rental	Oil	Gas	Other

