

**TRACT 37367 - Portion of Block 50, Breton Sound Area, Plaquemines Parish, Louisiana**

All of the lands now or formerly constituting the beds and bottoms of all water bodies of every nature and description the title of which vests in the State of Louisiana, together with all islands arising therein and other lands formed by accretion or by reliction, where allowed by law, excepting tax adjudicated lands, and not presently under mineral lease on May 11, 2005, situated in Plaquemines Parish, Louisiana, and more particularly described as follows: Beginning at a point on the East line of Block 50, Breton Sound Area, having Coordinates of X = 2,664,850.00 and Y = 285,455.00; thence South 7,375.00 feet along the East line of said Block 50 to its Southeast corner having Coordinates of X = 2,664,850.00 and Y = 278,080.00; thence West 10,500.00 feet along the South line of said Block 50 to the Southeast corner of State Lease No. 16393, having Coordinates of X = 2,654,350.00 and Y = 278,080.00; thence along the boundary of said State Lease No. 16393 the following courses: North 2,000.00 feet to its Northeast corner having Coordinates of X = 2,654,350.00 and Y = 280,080.00; West 3,800.00 feet to its Northwest corner having Coordinates of X = 2,650,550.00 and Y = 280,080.00; and South 2,000.00 feet to its Southwest corner, said corner also being a point on the South line of said Block 50, having Coordinates of X = 2,650,550.00 and Y = 278,080.00; thence West 450.00 feet along said South line of said Block 50 to its Southwest corner having Coordinates of X = 2,650,100.00 and Y = 278,080.00; thence North 7,375.00 feet along the West line of said Block 50 to a point having Coordinates of X = 2,650,100.00 and Y = 285,455.00; thence East 14,750.00 feet to the point of beginning, containing approximately **2,322.80 acres**, all as more particularly outlined on a plat on file in the Office of Mineral Resources, Department of Natural Resources. All bearings, distances and coordinates are based on Louisiana Coordinate System of 1927, (North or South Zone), where applicable.

NOTE: The above description of the Tract nominated for lease has been provided and corrected, where required, exclusively by the nomination party. Any mineral lease selected from this Tract and awarded by the Louisiana State Mineral Board shall be without warranty of any kind, either express, implied, or statutory, including, but not limited to, the implied warranties of merchantability and fitness for a particular purpose. Should the mineral lease awarded by the Louisiana State Mineral Board be subsequently modified, cancelled or abrogated due to the existence of conflicting leases, operating agreements, private claims or other future obligations or conditions which may affect all or any portion of the leased Tract, it shall not relieve the Lessee of the obligation to pay any bonus due thereon to the Louisiana State Mineral Board, nor shall the Louisiana State Mineral Board be obligated to refund any consideration paid by the Lessor prior to such modification, cancellation, or abrogation, including, but not limited to, bonuses, rentals and royalties.

NOTE: The State of Louisiana does hereby reserve, and this lease shall be subject to, the imprescriptible right of surface use in the nature of a servitude in favor of the Department of Natural Resources, including its Offices and Commissions, for the sole purpose of implementing, constructing, servicing and maintaining approved coastal zone management and/or restoration projects. Utilization of any and all rights derived under this lease by the mineral lessee, its agents, successors or assigns, shall not interfere with nor hinder the reasonable surface use by the Department of Natural Resources, its Offices or Commissions, as herein above reserved.

Applicant: Fleetwood Resources, Inc.

Bidder	Cash Payment	Price/Acre	Rental	Oil	Gas	Other



P.O.B.  
X=2,664,850.00  
Y=285,455.00

BLOCK  
BS0051

BLOCK  
MP0046

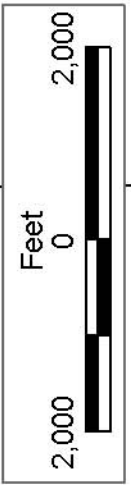

SL 17487

PLAQUEMINES PARISH

BRETON SOUND AREA

BLOCK BS0050

MAIN PASS AREA, REVISED

BLOCK MP0047

SL 16393

SL 16392

BLOCK  
BS0049

**TRACT 37368 - Portion of Blocks 51, and 52, Breton Sound Area, Plaquemines Parish, Louisiana**

All of the lands now or formerly constituting the beds and bottoms of all water bodies of every nature and description the title of which vests in the State of Louisiana, together with all islands arising therein and other lands formed by accretion or by reliction, where allowed by law, excepting tax adjudicated lands, and not presently under mineral lease on May 11, 2005, situated in Plaquemines Parish, Louisiana, and more particularly described as follows: Beginning at a point on the West line of Block 51, Breton Sound Area, having Coordinates of X = 2,664,850.00 and Y = 285,455.00; thence East 4,136.01 feet to the most Northerly Northwest corner of State Lease No. 17245, having Coordinates of X = 2,668,986.01 and Y = 285,455.00; thence along the boundary of said State Lease No. 17245 the following courses: South 2,250.00 feet to a point having Coordinates of X = 2,668,986.01 and Y = 283,205.00; West 1,169.00 feet to a point having Coordinates of X = 2,667,817.01 and Y = 283,205.00; South 1,903.00 feet to a point having Coordinates of X = 2,667,817.01 and Y = 281,302.00; East 3,425.00 feet to a point having Coordinates of X = 2,671,242.01 and Y = 281,302.00; North 1,876.00 feet to a point having Coordinates of X = 2,671,242.01 and Y = 283,178.00; and East 2,175.00 feet to a point having Coordinates of X = 2,673,417.01 and Y = 283,178.00; and thence North 39 degrees 23 minutes 04 seconds East 2,946.92 feet along the East lines of said State Lease No. 17245 and State Lease No. 17243 to a point on the East line of State Lease No. 17243, having Coordinates of X = 2,675,286.89 and Y = 285,455.69; thence East 3,667.65 feet to a point having Coordinates of X = 2,678,954.54 and Y = 285,455.69; thence Southeasterly on a straight line to a point within Block 52, located on the South line having Coordinates of X = 2,679,742.80 and Y = 278,080.00; thence West 142.80 feet along the South line of said Block 52 to its Southeast corner and the Southeast corner of State Lease No. 17244 having Coordinates of X = 2,679,600.00 and Y = 278,080.00; thence along the boundary of said State Lease No. 17244 the following courses: North 33 degrees 05 minutes 49 seconds West 1,607.89 feet to its Northeast corner having Coordinates of X = 2,678,722.00 and Y = 279,427.00; West 2,053.00 feet to its Northwest corner having Coordinates of X = 2,676,669.00 and Y = 279,427.00; and South 1,347.00 feet to its Southwest corner, having Coordinates of X = 2,676,669.00 and Y = 278,080.00; thence West 11,819.00 feet along the South line of said Block 51, to its Southwest corner having Coordinates of X = 2,664,850.00 and Y = 278,080.00; thence North 7375.00 feet along the West line of said Block 51 to the point of beginning, containing approximately **1,949.02 acres**, all as more particularly outlined on a plat on file in the Office of Mineral Resources, Department of Natural Resources. All bearings, distances and coordinates are based on Louisiana Coordinate System of 1927, (North or South Zone), where applicable.

NOTE: The above description of the Tract nominated for lease has been provided and corrected, where required, exclusively by the nomination party. Any mineral lease selected from this Tract and awarded by the

Louisiana State Mineral Board shall be without warranty of any kind, either express, implied, or statutory, including, but not limited to, the implied warranties of merchantability and fitness for a particular purpose. Should the mineral lease awarded by the Louisiana State Mineral Board be subsequently modified, cancelled or abrogated due to the existence of conflicting leases, operating agreements, private claims or other future obligations or conditions which may affect all or any portion of the leased Tract, it shall not relieve the Lessee of the obligation to pay any bonus due thereon to the Louisiana State Mineral Board, nor shall the Louisiana State Mineral Board be obligated to refund any consideration paid by the Lessor prior to such modification, cancellation, or abrogation, including, but not limited to, bonuses, rentals and royalties.

NOTE: The State of Louisiana does hereby reserve, and this lease shall be subject to, the imprescriptible right of surface use in the nature of a servitude in favor of the Department of Natural Resources, including its Offices and Commissions, for the sole purpose of implementing, constructing, servicing and maintaining approved coastal zone management and/or restoration projects. Utilization of any and all rights derived under this lease by the mineral lessee, its agents, successors or assigns, shall not interfere with nor hinder the reasonable surface use by the Department of Natural Resources, its Offices or Commissions, as herein above reserved.

Applicant: Fleetwood Resources, Inc.

Bidder	Cash Payment	Price/Acre	Rental	Oil	Gas	Other



BLOCK BS0052

BLOCK MP0045

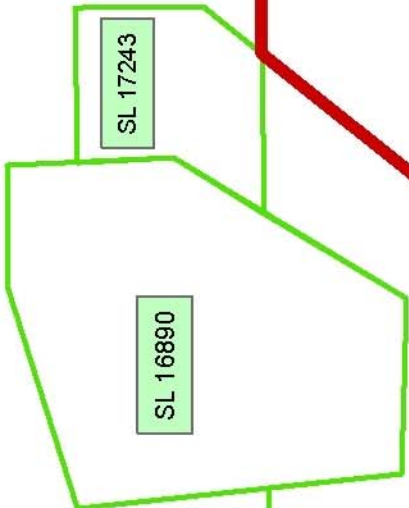
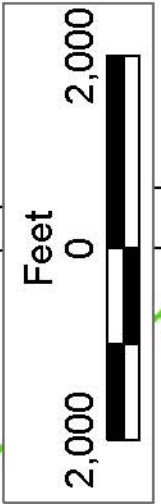

SL 17243

SL 16890

PLAQUEMINES PARISH

BRETON SOUND AREA

BLOCK BS0051

SL 17244

SL 17052

SL 2726

BLOCK MP0046

SL 17245

MAIN PASS AREA, REVISED

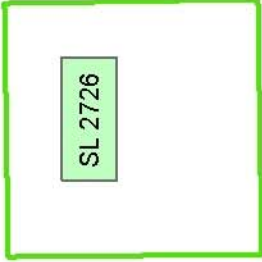

SL 2726

P.O.B.  
X=2,664,850.00  
Y=285,455.00

BLOCK BS0050

BLOCK MP0047

**TRACT 37369 - Portion of Block 47, Main Pass Area, Revised, Plaquemines Parish, Louisiana**

All of the lands now or formerly constituting the beds and bottoms of all water bodies of every nature and description the title of which vests in the State of Louisiana, together with all islands arising therein and other lands formed by accretion or by reliction, where allowed by law, excepting tax adjudicated lands, and not presently under mineral lease on May 11, 2005, situated in Plaquemines Parish, Louisiana, and more particularly described as follows: Beginning at the Northeast corner of Block 47, Main Pass Area, Revised, having Coordinates of X = 2,664,850.00 and Y = 278,080.00; thence South 6,600.00 feet along the East line of said Block 47 to a point having Coordinates of X = 2,664,850.00 and Y = 271,480.00; thence West 1,305.60 feet to the Northeast corner of State Lease No. 15906, having Coordinates of X = 2,663,544.40 and Y = 271,480.00; thence West 3,194.40 feet along the North line of said State Lease No. 15906 to its Northwest corner, said corner also being the Northeast corner of State Lease No. 1268, having Coordinates of X = 2,660,350.00 and Y = 271,480.00; thence West 10,250.00 feet along the North line of said State Lease No. 1268 to a point having Coordinates of X = 2,650,100.00 and Y = 271,480.00; thence North 6,600.00 feet to a point on the North line of said Block 47 having Coordinates of X = 2,650,100.00 and Y = 278,080.00; thence East 450.00 feet along the North line of said Block 47 to the Northwest corner of State Lease No. 16392, having Coordinates of X = 2,650,550.00 and Y = 278,080.00; thence South 2,599.99 feet along the West line of said State Lease No. 16392 to its Southwest corner, said corner also being the Northwest corner of State Lease No. 16570, having Coordinates of X = 2,650,550.00 and Y = 275,480.01; thence along said State Lease No. 16570 the following courses: South 258.57 feet to a point having Coordinates of X = 2,650,550.00 and Y = 275,221.44, South 59 degrees 15 minutes 06 seconds East 4,168.83 feet to a point having Coordinates of X = 2,654,132.78 and Y = 273,090.05, East 1,177.47 feet to a point having Coordinates of X = 2,655,310.25 and Y = 273,090.05 and North 24 degrees 40 minutes 37 seconds West 2,300.00 feet to its Northeast corner, said corner also being the most Easterly Southeast corner of said State Lease No. 16392, having Coordinates of X = 2,654,350.00 and Y = 275,180.00; thence North 2,900.00 feet along the East line of said State Lease No. 16392 to its Northeast corner, said corner also being a point on the North line of said Block 47, having Coordinates of X = 2,654,350.00 and Y = 278,080.00; thence East 10,500.00 feet along the North line of said Block 47 to the point of beginning, containing approximately **1,864.16 acres**, all as more particularly outlined on a plat on file in the Office of Mineral Resources, Department of Natural Resources. All bearings, distances and coordinates are based on Louisiana Coordinate System of 1927, (North or South Zone), where applicable.

NOTE: The above description of the Tract nominated for lease has been provided and corrected, where required, exclusively by the nomination party. Any mineral lease selected from this Tract and awarded by the Louisiana State Mineral Board shall be without warranty of any kind,

either express, implied, or statutory, including, but not limited to, the implied warranties of merchantability and fitness for a particular purpose. Should the mineral lease awarded by the Louisiana State Mineral Board be subsequently modified, cancelled or abrogated due to the existence of conflicting leases, operating agreements, private claims or other future obligations or conditions which may affect all or any portion of the leased Tract, it shall not relieve the Lessee of the obligation to pay any bonus due thereon to the Louisiana State Mineral Board, nor shall the Louisiana State Mineral Board be obligated to refund any consideration paid by the Lessor prior to such modification, cancellation, or abrogation, including, but not limited to, bonuses, rentals and royalties.

NOTE: The State of Louisiana does hereby reserve, and this lease shall be subject to, the imprescriptible right of surface use in the nature of a servitude in favor of the Department of Natural Resources, including its Offices and Commissions, for the sole purpose of implementing, constructing, servicing and maintaining approved coastal zone management and/or restoration projects. Utilization of any and all rights derived under this lease by the mineral lessee, its agents, successors or assigns, shall not interfere with nor hinder the reasonable surface use by the Department of Natural Resources, its Offices or Commissions, as herein above reserved.

Applicant: Fleetwood Resources, Inc.

Bidder	Cash Payment	Price/Acre	Rental	Oil	Gas	Other





P.O.B.  
X=2,664,850.00  
Y=278,080.00

BLOCK  
BS0051

BLOCK  
MP0046

SL 16847

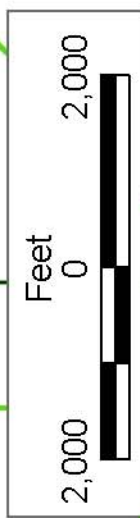

PLAQUEMINES PARISH

BRETON SOUND AREA

BLOCK BS0050

BLOCK MP0047

MAIN PASS AREA, REVISED

BLOCK MP0047

SL 16393

SL 16392

SL 16570

SL 1268

BLOCK  
BS0049

BLOCK  
MP0047

**TRACT 37370 - Portion of Blocks 45, and 46, Main Pass Area, Revised, Plaquemines Parish, Louisiana**

All of the lands now or formerly constituting the beds and bottoms of all water bodies of every nature and description the title of which vests in the State of Louisiana, together with all islands arising therein and other lands formed by accretion or by reliction, where allowed by law, excepting tax adjudicated lands, and not presently under mineral lease on May 11, 2005, situated in Plaquemines Parish, Louisiana, and more particularly described as follows: Beginning at the Northwest corner of Block 46, Main Pass Area, Revised, having Coordinates of X = 2,664,850.00 and Y = 278,080.00; thence East 7,375.13 feet along the North line of said Block 46 to the Northwest corner of the Northeast portion of State Lease No. 2726, as amended, having Coordinates of X = 2,672,225.13 and Y = 278,080.00; thence along the boundary of said Northeast portion of said State Lease No. 2726 the following courses: South 4,399.93 feet to a point having Coordinates of X = 2,672,225.13 and Y = 273,680.07, South 80 degrees 00 minutes 00 seconds East 1,500.00 feet to a point having Coordinates of X = 2,673,702.34 and Y = 273,419.60, South 85 degrees 30 minutes 00 seconds East 2,000.00 feet to a point having Coordinates of X = 2,675,696.17 and Y = 273,262.68, South 88 degrees 30 minutes 00 seconds East 1,500.00 feet to a point having Coordinates of X = 2,677,195.66 and Y = 273,223.42, North 87 degrees 30 minutes 00 seconds East 600.00 feet to a point having Coordinates of X = 2,677,795.09 and Y = 273,249.59, North 76 degrees 21 minutes 00 seconds East 1,188.60 feet to a point having Coordinates of X = 2,678,950.12 and Y = 273,530.09, North 38 degrees 27 minutes 00 seconds West 1,627.30 feet to a point having Coordinates of X = 2,677,938.21 and Y = 274,804.51, North 42 degrees 00 minutes 00 seconds West 1,500.00 feet to a point having Coordinates of X = 2,676,934.51 and Y = 275,919.22, North 52 degrees 00 minutes 00 seconds West 1,000.00 feet to a point having Coordinates of X = 2,676,146.50 and Y = 276,534.89 and North 59 degrees 00 minutes 00 seconds West 3,000.00 feet to its Northeast corner, said corner also being a point on said North line of said Block 46, having Coordinates of X = 2,673,575.00 and Y = 278,080.00; thence East 2,975.00 feet along said North line of said Block 46 to the Northwest corner of State Lease No. 17052, as amended, having Coordinates of X = 2,676,550.00 and Y = 278,080.00; thence along the boundary of said State Lease No. 17052 the following courses: South 1,400.00 feet to a point having Coordinates of X = 2,676,550.00 and Y = 276,680.00, South 42 degrees 13 minutes 15 seconds East 1,277.41 feet to a point having Coordinates of X = 2,677,408.41 and Y = 275,734.00 and East 2,191.59 feet to its Southeast corner, said corner also being a point on the East line of said Block 46 and the Southwest corner of State Lease No. 17053, as amended, having Coordinates of X = 2,679,600.00 and Y = 275,734.00; thence East 393.53 feet along the South line of said State Lease No. 17053 to a point having Coordinates of X = 2,679,993.53 and Y = 275,734.00; thence Southeasterly on a straight line to a point having Coordinates of X = 2,680,448.17 and Y = 271,480.00; thence West 848.17 feet to a point on the East line of said Block 46, having Coordinates of X = 2,679,600.00 and Y = 271,480.00; thence West approximately 2,936 feet to a point on the Northern boundary

of the Southeast portion of State Lease No. 2726, as amended, having a Coordinate of Y = 271,480.00; thence Northwesterly and Southwesterly along the boundary of said State Lease No. 2726 to a point having a Coordinate of Y = 271,480.00; thence West approximately 1,989 feet to a point on the East line of State Lease No. 16847, having Coordinates of X = 2,672,225.00 and Y = 271,480.00; thence along the boundary of said State Lease No. 16847 the following courses: North 1,400.00 feet to a point having Coordinates of X = 2,672,225.00 and Y = 272,880.00; and West 7,375.00 feet to its Northwest corner, also being a point on the West line of said Block 46, having Coordinates of X = 2,664,850.00 and Y = 272,880.00; thence North 5,200.00 feet along the West line of said Block 46 to the point of beginning, **LESS AND EXCEPT** all of the Northwest portion of State Lease No. 2726, as amended, described as follows: Beginning at a point having Coordinates of X = 2,668,650.00 and Y = 276,520.00, East 2,640.00 feet to a point having Coordinates of X = 2,671,290.00 and Y = 276,520.00, South 2,640.00 feet to a point having Coordinates of X = 2,671,290.00 and Y = 273,880.00, West 2,640.00 feet to a point having Coordinates of X = 2,668,650.00 and Y = 273,880.00, and North 2,640.00 feet to the point of beginning, and **LESS AND EXCEPT** all that portion, if any, of the Southeastern portion of State Lease No. 2726, as amended, that may lie within the above described tract, containing approximately **1,216 acres**, all as more particularly outlined on a plat on file in the Office of Mineral Resources, Department of Natural Resources. All bearings, distances and coordinates are based on Louisiana Coordinate System of 1927, (North or South Zone), where applicable.

NOTE: The above description of the Tract nominated for lease has been provided and corrected, where required, exclusively by the nomination party. Any mineral lease selected from this Tract and awarded by the Louisiana State Mineral Board shall be without warranty of any kind, either express, implied, or statutory, including, but not limited to, the implied warranties of merchantability and fitness for a particular purpose. Should the mineral lease awarded by the Louisiana State Mineral Board be subsequently modified, cancelled or abrogated due to the existence of conflicting leases, operating agreements, private claims or other future obligations or conditions which may affect all or any portion of the leased Tract, it shall not relieve the Lessee of the obligation to pay any bonus due thereon to the Louisiana State Mineral Board, nor shall the Louisiana State Mineral Board be obligated to refund any consideration paid by the Lessor prior to such modification, cancellation, or abrogation, including, but not limited to, bonuses, rentals and royalties.

NOTE: The State of Louisiana does hereby reserve, and this lease shall be subject to, the imprescriptible right of surface use in the nature of a servitude in favor of the Department of Natural Resources, including its Offices and Commissions, for the sole purpose of implementing, constructing, servicing and maintaining approved coastal zone management and/or restoration projects. Utilization of any and all rights derived under this lease by the mineral lessee, its agents, successors or assigns,

shall not interfere with nor hinder the reasonable surface use by the Department of Natural Resources, its Offices or Commissions, as herein above reserved.

Applicant: Fleetwood Resources, Inc.

Bidder	Cash Payment	Price/Acre	Rental	Oil	Gas	Other



BLOCK BS0052

BLOCK MP0045

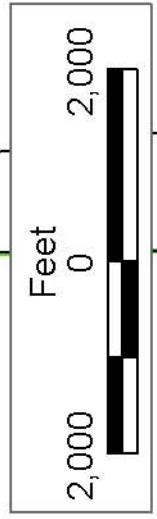

PLAQUEMINES PARISH

BRETON SOUND AREA

SL 2726

MAIN PASS AREA, REVISED

SL 17245

BLOCK BS0051

SL 2726

SL 2726

BLOCK MP0046

SL 16847

P.O.B.  
X=2,664,850.00  
Y=2,78,080.00

BLOCK BS0050

BLOCK MP0047

SL 17053

SL 17244

SL 17052

**TRACT 37371 - Portion of Blocks 48, and 52, Main Pass Area, Revised, Plaquemines Parish, Louisiana**

All of the lands now or formerly constituting the beds and bottoms of all water bodies of every nature and description the title of which vests in the State of Louisiana, together with all islands arising therein and other lands formed by accretion or by reliction, where allowed by law, excepting tax adjudicated lands, and not presently under mineral lease on May 11, 2005, situated in Plaquemines Parish, Louisiana, and more particularly described as follows: Beginning at a point within Block 48, Main Pass Area, Revised, having Coordinates of X = 2,639,550.00 and Y = 266,080.00; thence East 7,800.00 feet to the Northwest corner of Block 52, Main Pass Area, Revised, having Coordinates of X = 2,647,350.00 and Y = 266,080.00; thence East 5,400.00 feet along the North line of said Block 52 to the Northwest corner of State Lease No. 16664 having Coordinates of X = 2,652,750.00 and Y = 266,080.00; thence along the boundary of said State Lease No. 16664 the following courses: South 1,223.84 feet to a point having Coordinates of X = 2,652,750.00 and Y = 264,856.16, North 87 degrees 38 minutes 44 seconds East 3,961.34 feet to a point having Coordinates of X = 2,656,708.00 and Y = 265,018.90 and South 02 degrees 59 minutes 38 seconds East 3,752.82 feet to its most Southerly Southwest corner having Coordinates of X = 2,656,904.00 and Y = 261,271.20; thence South 877.13 feet to a point having Coordinates of X = 2,656,904.00 and Y = 260,394.07; thence Westerly approximately 3,913 feet to a corner on the common boundary line between said Block 52 and State Lease No. 195, as amended; thence Westerly approximately 5,642 feet along the common boundary line between said Block 52 and said State Lease No. 195, to the most Westerly Southwest corner of said Block 52, said corner also being the Southeast corner of said Block 48; thence Westerly approximately 3,492 feet along the common boundary line between said Block 48 and said State Lease No. 195, to a point of intersection with a line that bears South 15 degrees 30 minutes 00 seconds East extended from a point having Coordinates of X = 2,643,531.15 and Y = 261,415.67; thence North 15 degrees 30 minutes 00 seconds West approximately 1,224 feet along said line to said point having Coordinates of X = 2,643,531.15 and Y = 261,415.67; thence North 41 degrees 40 minutes 00 seconds West 5,988.53 feet to a point having Coordinates of X = 2,639,550.00 and Y = 265,889.25; thence North 190.75 feet to the point of beginning, **LESS AND EXCEPT** that portion, if any, of State Lease No. 195, as amended, that may fall within the above described tract, containing approximately **1,686 acres**, all as more particularly outlined on a plat on file in the Office of Mineral Resources, Department of Natural Resources. All bearings, distances and coordinates are based on Louisiana Coordinate System of 1927, (North or South Zone), where applicable.

NOTE: The above description of the Tract nominated for lease has been provided and corrected, where required, exclusively by the nomination party. Any mineral lease selected from this Tract and awarded by the Louisiana State Mineral Board shall be without warranty of any kind, either express, implied, or statutory, including, but not limited to, the

implied warranties of merchantability and fitness for a particular purpose. Should the mineral lease awarded by the Louisiana State Mineral Board be subsequently modified, cancelled or abrogated due to the existence of conflicting leases, operating agreements, private claims or other future obligations or conditions which may affect all or any portion of the leased Tract, it shall not relieve the Lessee of the obligation to pay any bonus due thereon to the Louisiana State Mineral Board, nor shall the Louisiana State Mineral Board be obligated to refund any consideration paid by the Lessor prior to such modification, cancellation, or abrogation, including, but not limited to, bonuses, rentals and royalties.

NOTE: The State of Louisiana does hereby reserve, and this lease shall be subject to, the imprescriptible right of surface use in the nature of a servitude in favor of the Department of Natural Resources, including its Offices and Commissions, for the sole purpose of implementing, constructing, servicing and maintaining approved coastal zone management and/or restoration projects. Utilization of any and all rights derived under this lease by the mineral lessee, its agents, successors or assigns, shall not interfere with nor hinder the reasonable surface use by the Department of Natural Resources, its Offices or Commissions, as herein above reserved.

NOTE: The Department of Wildlife and Fisheries has designated certain areas in the coastal waters of the State of Louisiana as Oyster Seed Bed Areas. The exact location of those Seed Bed Areas must be obtained from the Department of Wildlife and Fisheries and any work done under a mineral lease from the State of Louisiana may necessarily be conducted in conformity with the rules and regulations promulgated by the said Department of Wildlife and Fisheries for Oyster Seed Bed Areas.

Applicant: Leslie M. Cooper

Bidder	Cash Payment	Price/Acre	Rental	Oil	Gas	Other

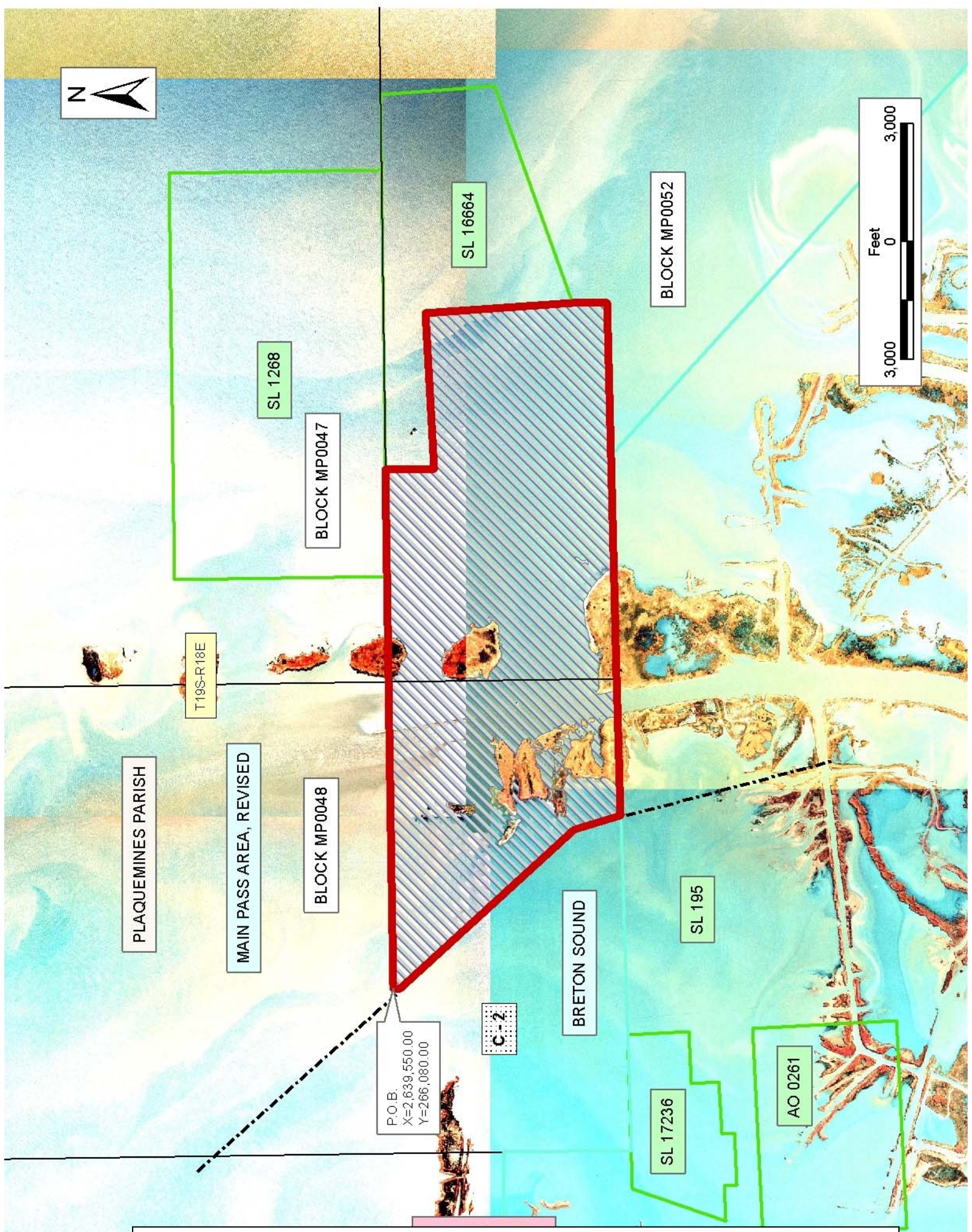

SL 1268

BLOCK MP0047

SL 16664

BLOCK MP0052

T19S-R18E

PLAQUEMINES PARISH

MAIN PASS AREA, REVISED

BLOCK MP0048

BRETON SOUND

SL 195

P.O.B.  
X=2,639,550.00  
Y=266,080.00

C-2

SL 17236

AO 0261



**TRACT 37372 - Portion of Block 48, Main Pass Area, Revised, Plaquemines Parish, Louisiana**

All of the lands now or formerly constituting the beds and bottoms of all water bodies of every nature and description the title of which vests in the State of Louisiana, together with all islands arising therein and other lands formed by accretion or by reliction, where allowed by law, excepting tax adjudicated lands, and not presently under mineral lease on May 11, 2005, situated in Plaquemines Parish, Louisiana, and more particularly described as follows: Beginning at a point within Block 48, Main Pass Area, Revised, having Coordinates of X = 2,639,550.00 and Y = 265,889.25; thence South 41 degrees 40 minutes 00 seconds East 5,988.53 feet to a point having Coordinates of X = 2,643,531.15 and Y = 261,415.67; thence South 15 degrees 30 minutes 00 seconds East approximately 1,224 feet to a point on the South line of said Block 48 and on the Northern boundary of State Lease No. 195, as amended; thence Westerly approximately 4,309 feet along the South line of said Block 48 and along the Northern boundary of said State Lease No. 195, as amended, to a point having a Coordinate of X = 2,639,550.00; thence North approximately 5,728 feet to the point of beginning, **LESS AND EXCEPT** that portion, if any, of State Lease No. 195, as amended, that may fall within the above described tract, containing approximately 320 Gross acres and **192 Net acres**, all as more particularly outlined on a plat on file in the Office of Mineral Resources, Department of Natural Resources. All bearings, distances and coordinates are based on Louisiana Coordinate System of 1927, (North or South Zone), where applicable.

NOTE: The above description of the Tract nominated for lease has been provided and corrected, where required, exclusively by the nomination party. Any mineral lease selected from this Tract and awarded by the Louisiana State Mineral Board shall be without warranty of any kind, either express, implied, or statutory, including, but not limited to, the implied warranties of merchantability and fitness for a particular purpose. Should the mineral lease awarded by the Louisiana State Mineral Board be subsequently modified, cancelled or abrogated due to the existence of conflicting leases, operating agreements, private claims or other future obligations or conditions which may affect all or any portion of the leased Tract, it shall not relieve the Lessee of the obligation to pay any bonus due thereon to the Louisiana State Mineral Board, nor shall the Louisiana State Mineral Board be obligated to refund any consideration paid by the Lessor prior to such modification, cancellation, or abrogation, including, but not limited to, bonuses, rentals and royalties.

NOTE: The State of Louisiana does hereby reserve, and this lease shall be subject to, the imprescriptible right of surface use in the nature of a servitude in favor of the Department of Natural Resources, including its Offices and Commissions, for the sole purpose of implementing, constructing, servicing and maintaining approved coastal zone management and/or restoration projects. Utilization of any and all rights derived under this lease by the mineral lessee, its agents, successors or assigns,

shall not interfere with nor hinder the reasonable surface use by the Department of Natural Resources, its Offices or Commissions, as herein above reserved.

NOTE: The Department of Wildlife and Fisheries has designated certain areas in the coastal waters of the State of Louisiana as Oyster Seed Bed Areas. The exact location of those Seed Bed Areas must be obtained from the Department of Wildlife and Fisheries and any work done under a mineral lease from the State of Louisiana may necessarily be conducted in conformity with the rules and regulations promulgated by the said Department of Wildlife and Fisheries for Oyster Seed Bed Areas.

Applicant: Leslie M. Cooper

Bidder	Cash Payment	Price/Acre	Rental	Oil	Gas	Other

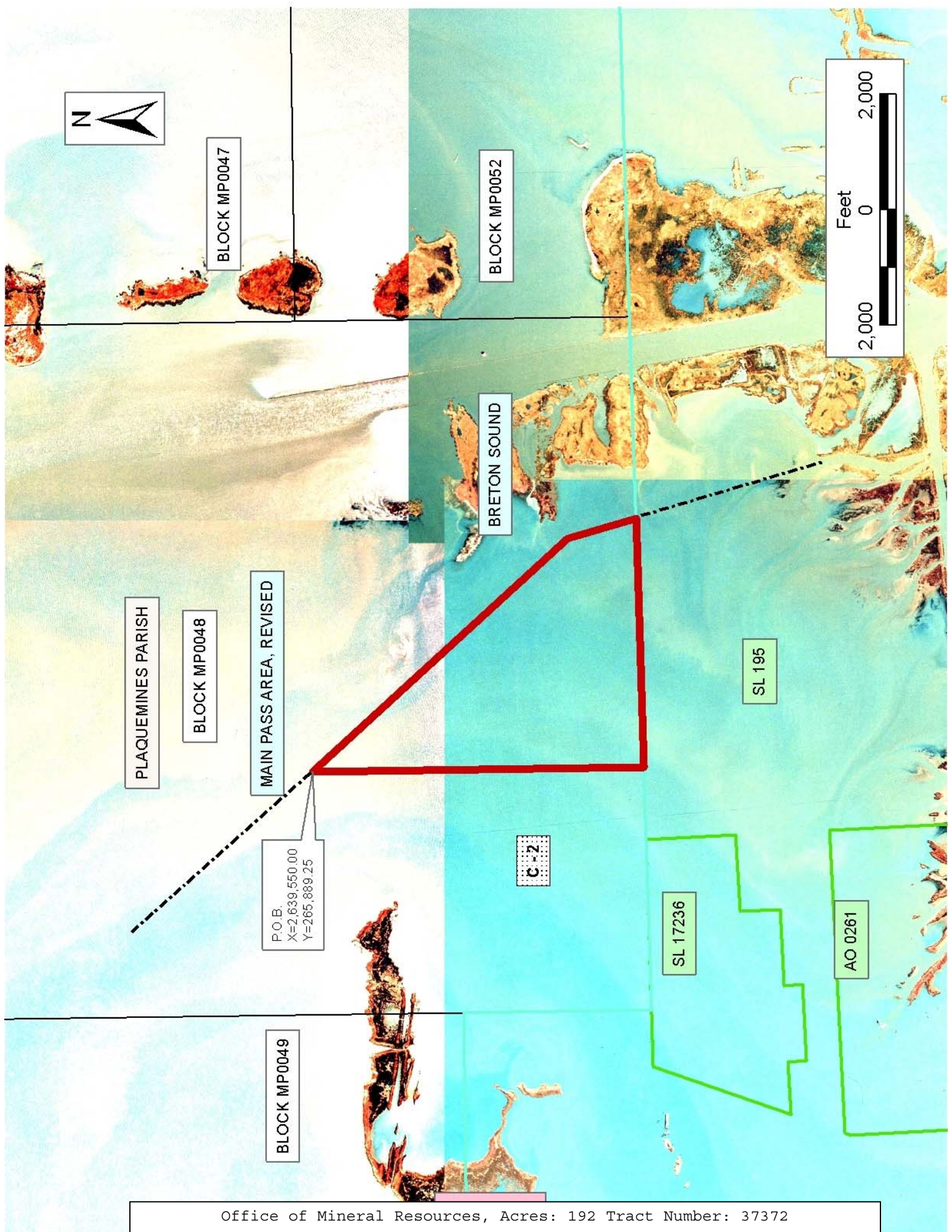

BLOCK MP0047

BLOCK MP0052



PLAQUEMINES PARISH

BLOCK MP0048

MAIN PASS AREA, REVISED

BRETTON SOUND

SL 195

P.O.B.  
X=2,639,550.00  
Y=2,665,889.25

C-2

SL 17236

AO 0261

BLOCK MP0049

**TRACT 37373 - Plaquemines Parish, Louisiana**

All of the lands now or formerly constituting the beds and bottoms of all water bodies of every nature and description the title of which vests in the State of Louisiana, together with all islands arising therein and other lands formed by accretion or by reliction, where allowed by law, excepting tax adjudicated lands, and not presently under mineral lease on May 11, 2005, situated in Plaquemines Parish, Louisiana, and more particularly described as follows: Beginning at a Southeast corner of State Lease No. 17236 having Coordinates of X = 2,637,060.59 and Y = 257,831.45; thence along the Southern boundary of said State Lease No. 17236 the following courses: North 02 degrees 08 minutes 27 seconds West 700.00 feet to a point having Coordinates of X = 2,637,034.44 and Y = 258,530.97 and North 87 degrees 51 minutes 33 seconds East 1,320.00 feet to its most Easterly Southeast corner having Coordinates of X = 2,638,353.53 and Y = 258,580.28; thence South 02 degrees 08 minutes 27 seconds East 1,623.08 feet to the Northeast corner of Operating Agreement No. 261 having Coordinates of X = 2,638,414.15 and Y = 256,958.33; thence South 87 degrees 51 minutes 33 seconds West 2,639.98 feet along the North line of said Operating Agreement No. 261 to a point having Coordinates of X = 2,635,776.01 and Y = 256,859.70; thence North 02 degrees 08 minutes 27 seconds West 303.08 feet to a point having Coordinates of X = 2,635,764.69 and Y = 257,162.57; thence North 87 degrees 51 minutes 33 seconds East 1,320.00 feet to a point having Coordinates of X = 2,637,083.77 and Y = 257,211.88; thence North 02 degrees 08 minutes 37 seconds West 620.00 feet to the point of beginning, **LESS AND EXCEPT** those portions, if any, of State Lease No. 195, as amended, that may lie within the above described tract, containing approximately **58.37 acres**, all as more particularly outlined on a plat on file in the Office of Mineral Resources, Department of Natural Resources. All bearings, distances and coordinates are based on Louisiana Coordinate System of 1927, (North or South Zone), where applicable.

NOTE: The above description of the Tract nominated for lease has been provided and corrected, where required, exclusively by the nomination party. Any mineral lease selected from this Tract and awarded by the Louisiana State Mineral Board shall be without warranty of any kind, either express, implied, or statutory, including, but not limited to, the implied warranties of merchantability and fitness for a particular purpose. Should the mineral lease awarded by the Louisiana State Mineral Board be subsequently modified, cancelled or abrogated due to the existence of conflicting leases, operating agreements, private claims or other future obligations or conditions which may affect all or any portion of the leased Tract, it shall not relieve the Lessee of the obligation to pay any bonus due thereon to the Louisiana State Mineral Board, nor shall the Louisiana State Mineral Board be obligated to refund any consideration paid by the Lessor prior to such modification, cancellation, or abrogation, including, but not limited to, bonuses, rentals and royalties.

NOTE: The State of Louisiana does hereby reserve, and this lease shall be subject to, the imprescriptible right of surface use in the nature of a servitude in favor of the Department of Natural Resources, including its Offices and Commissions, for the sole purpose of implementing, constructing, servicing and maintaining approved coastal zone management and/or restoration projects. Utilization of any and all rights derived under this lease by the mineral lessee, its agents, successors or assigns, shall not interfere with nor hinder the reasonable surface use by the Department of Natural Resources, its Offices or Commissions, as herein above reserved.

NOTE: The Department of Wildlife and Fisheries has designated certain areas in the coastal waters of the State of Louisiana as Oyster Seed Bed Areas. The exact location of those Seed Bed Areas must be obtained from the Department of Wildlife and Fisheries and any work done under a mineral lease from the State of Louisiana may necessarily be conducted in conformity with the rules and regulations promulgated by the said Department of Wildlife and Fisheries for Oyster Seed Bed Areas.

Applicant: Leslie M. Cooper

Bidder	Cash Payment	Price/Acre	Rental	Oil	Gas	Other

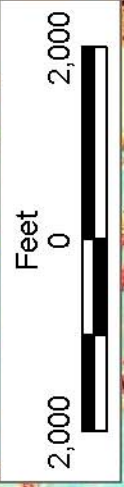
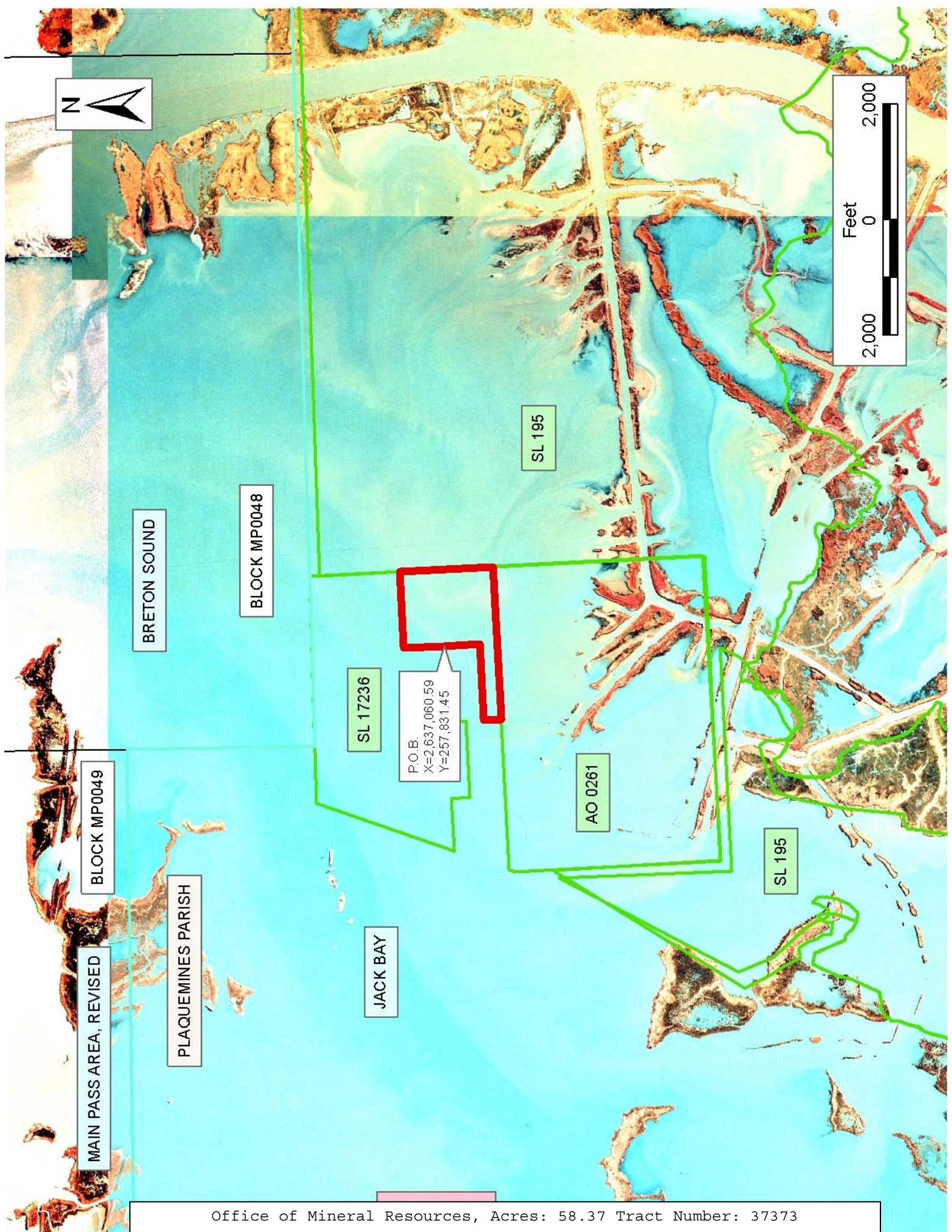

BRETTON SOUND

BLOCK MP0048

SL 195

SL 17236

P.O.B.  
X=2,637,060.59  
Y=257,831.45

AO 0261

SL 195

BLOCK MP0049

PLAQUEMINES PARISH

JACK BAY

MAIN PASS AREA, REVISED

**TRACT 37374 - Terrebonne Parish, Louisiana**

All of the lands now or formerly constituting the beds and bottoms of all water bodies of every nature and description the title of which vests in the State of Louisiana, together with all islands arising therein and other lands formed by accretion or by reliction, where allowed by law, excepting tax adjudicated lands, and not presently under mineral lease on May 11, 2005, situated in Terrebonne Parish, Louisiana, and more particularly described as follows: Beginning at a point having Coordinates of X = 2,203,351.52 and Y = 256,403.96; thence North 3,663.15 feet to a point having Coordinates of X = 2,203,351.52 and Y = 260,067.11; thence East 14,962.48 feet to a point having Coordinates of X = 2,218,314.00 and Y = 260,067.11; thence South 3,663.15 feet to a point having Coordinates of X = 2,218,314.00 and Y = 256,403.96; thence West 14,962.48 feet to the point of beginning, containing approximately **529 acres**, all as more particularly outlined on a plat on file in the Office of Mineral Resources, Department of Natural Resources. All bearings, distances and coordinates are based on Louisiana Coordinate System of 1927, (North or South Zone), where applicable.

NOTE: The above description of the Tract nominated for lease has been provided and corrected, where required, exclusively by the nomination party. Any mineral lease selected from this Tract and awarded by the Louisiana State Mineral Board shall be without warranty of any kind, either express, implied, or statutory, including, but not limited to, the implied warranties of merchantability and fitness for a particular purpose. Should the mineral lease awarded by the Louisiana State Mineral Board be subsequently modified, cancelled or abrogated due to the existence of conflicting leases, operating agreements, private claims or other future obligations or conditions which may affect all or any portion of the leased Tract, it shall not relieve the Lessee of the obligation to pay any bonus due thereon to the Louisiana State Mineral Board, nor shall the Louisiana State Mineral Board be obligated to refund any consideration paid by the Lessor prior to such modification, cancellation, or abrogation, including, but not limited to, bonuses, rentals and royalties.

NOTE: The State of Louisiana does hereby reserve, and this lease shall be subject to, the imprescriptible right of surface use in the nature of a servitude in favor of the Department of Natural Resources, including its Offices and Commissions, for the sole purpose of implementing, constructing, servicing and maintaining approved coastal zone management and/or restoration projects. Utilization of any and all rights derived under this lease by the mineral lessee, its agents, successors or assigns, shall not interfere with nor hinder the reasonable surface use by the Department of Natural Resources, its Offices or Commissions, as herein above reserved.

NOTE: The Department of Wildlife and Fisheries has designated certain areas in the coastal waters of the State of Louisiana as Oyster Seed Bed Areas. The exact location of those Seed Bed Areas must be obtained from

the Department of Wildlife and Fisheries and any work done under a mineral lease from the State of Louisiana may necessarily be conducted in conformity with the rules and regulations promulgated by the said Department of Wildlife and Fisheries for Oyster Seed Bed Areas.

Applicant: Gray Fox Resources

Bidder	Cash Payment	Price/Acre	Rental	Oil	Gas	Other



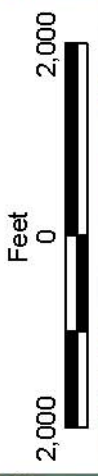

TERREBONNE PARISH

LAKE GERO

T19S - R18E

LAKE QUITMAN

T19S - R17E

BAYOU DULAC

T20S - R17E



P.O.B.  
X=2,203,351.52  
Y=256,403.96

**TRACT 37375 - Terrebonne Parish, Louisiana**

All of the lands now or formerly constituting the beds and bottoms of all water bodies of every nature and description the title of which vests in the State of Louisiana, together with all islands arising therein and other lands formed by accretion or by reliction, where allowed by law, excepting tax adjudicated lands, and not presently under mineral lease on May 11, 2005, situated in Terrebonne Parish, Louisiana, and more particularly described as follows: Beginning at a point having Coordinates of X = 2,203,351.52 and Y = 256,403.96; thence East 3,663.00 feet to a point having Coordinates of X = 2,207,014.52 and Y = 256,403.96; thence South 7,918.21 feet to a point on the boundary of State Lease No. 18268 having Coordinates of X = 2,207,014.52 and Y = 248,485.75; thence West 3,663.00 feet to a point having Coordinates of X = 2,203,351.52 and Y = 248,485.75; thence North 7,918.21 feet to the point of beginning, containing approximately **110 acres**, all as more particularly outlined on a plat on file in the Office of Mineral Resources, Department of Natural Resources. All bearings, distances and coordinates are based on Louisiana Coordinate System of 1927, (North or South Zone), where applicable.

NOTE: The above description of the Tract nominated for lease has been provided and corrected, where required, exclusively by the nomination party. Any mineral lease selected from this Tract and awarded by the Louisiana State Mineral Board shall be without warranty of any kind, either express, implied, or statutory, including, but not limited to, the implied warranties of merchantability and fitness for a particular purpose. Should the mineral lease awarded by the Louisiana State Mineral Board be subsequently modified, cancelled or abrogated due to the existence of conflicting leases, operating agreements, private claims or other future obligations or conditions which may affect all or any portion of the leased Tract, it shall not relieve the Lessee of the obligation to pay any bonus due thereon to the Louisiana State Mineral Board, nor shall the Louisiana State Mineral Board be obligated to refund any consideration paid by the Lessor prior to such modification, cancellation, or abrogation, including, but not limited to, bonuses, rentals and royalties.

NOTE: The State of Louisiana does hereby reserve, and this lease shall be subject to, the imprescriptible right of surface use in the nature of a servitude in favor of the Department of Natural Resources, including its Offices and Commissions, for the sole purpose of implementing, constructing, servicing and maintaining approved coastal zone management and/or restoration projects. Utilization of any and all rights derived under this lease by the mineral lessee, its agents, successors or assigns, shall not interfere with nor hinder the reasonable surface use by the Department of Natural Resources, its Offices or Commissions, as herein above reserved.

NOTE: The Department of Wildlife and Fisheries has designated certain areas in the coastal waters of the State of Louisiana as Oyster Seed Bed Areas. The exact location of those Seed Bed Areas must be obtained from

the Department of Wildlife and Fisheries and any work done under a mineral lease from the State of Louisiana may necessarily be conducted in conformity with the rules and regulations promulgated by the said Department of Wildlife and Fisheries for Oyster Seed Bed Areas.

Applicant: Gray Fox Resources

Bidder	Cash Payment	Price/Acre	Rental	Oil	Gas	Other



T19S - R18E

LAKE QUITMAN

SL 17895



TERREBONNE PARISH

T19S - R17E

SL 18268



P.O.B.  
X=2,203,351.52  
Y=256,403.96

BAYOU  
DULAC

T20S - R17E

**TRACT 37376 - Terrebonne Parish, Louisiana**

All of the lands now or formerly constituting the beds and bottoms of all water bodies of every nature and description the title of which vests in the State of Louisiana, together with all islands arising therein and other lands formed by accretion or by reliction, where allowed by law, excepting tax adjudicated lands, and not presently under mineral lease on May 11, 2005, situated in Terrebonne Parish, Louisiana, and more particularly described as follows: Beginning at a point having Coordinates of X = 2,218,314.00 and Y = 252,740.81; thence West 11,299.48 feet to a point having Coordinates of X = 2,207,014.52 and Y = 252,740.81; thence North 3,663.15 feet to a point having Coordinates of X = 2,207,014.52 and Y = 256,403.96; thence East 11,299.48 feet to a point having Coordinates of X = 2,218,314.00 and Y = 256,403.96; thence South 3,663.15 feet to the point of beginning, containing approximately **638 acres**, all as more particularly outlined on a plat on file in the Office of Mineral Resources, Department of Natural Resources. All bearings, distances and coordinates are based on Louisiana Coordinate System of 1927, (North or South Zone), where applicable.

NOTE: The above description of the Tract nominated for lease has been provided and corrected, where required, exclusively by the nomination party. Any mineral lease selected from this Tract and awarded by the Louisiana State Mineral Board shall be without warranty of any kind, either express, implied, or statutory, including, but not limited to, the implied warranties of merchantability and fitness for a particular purpose. Should the mineral lease awarded by the Louisiana State Mineral Board be subsequently modified, cancelled or abrogated due to the existence of conflicting leases, operating agreements, private claims or other future obligations or conditions which may affect all or any portion of the leased Tract, it shall not relieve the Lessee of the obligation to pay any bonus due thereon to the Louisiana State Mineral Board, nor shall the Louisiana State Mineral Board be obligated to refund any consideration paid by the Lessor prior to such modification, cancellation, or abrogation, including, but not limited to, bonuses, rentals and royalties.

NOTE: The State of Louisiana does hereby reserve, and this lease shall be subject to, the imprescriptible right of surface use in the nature of a servitude in favor of the Department of Natural Resources, including its Offices and Commissions, for the sole purpose of implementing, constructing, servicing and maintaining approved coastal zone management and/or restoration projects. Utilization of any and all rights derived under this lease by the mineral lessee, its agents, successors or assigns, shall not interfere with nor hinder the reasonable surface use by the Department of Natural Resources, its Offices or Commissions, as herein above reserved.

NOTE: The Department of Wildlife and Fisheries has designated certain areas in the coastal waters of the State of Louisiana as Oyster Seed Bed Areas. The exact location of those Seed Bed Areas must be obtained from

the Department of Wildlife and Fisheries and any work done under a mineral lease from the State of Louisiana may necessarily be conducted in conformity with the rules and regulations promulgated by the said Department of Wildlife and Fisheries for Oyster Seed Bed Areas.

Applicant: Gray Fox Resources

Bidder	Cash Payment	Price/Acre	Rental	Oil	Gas	Other

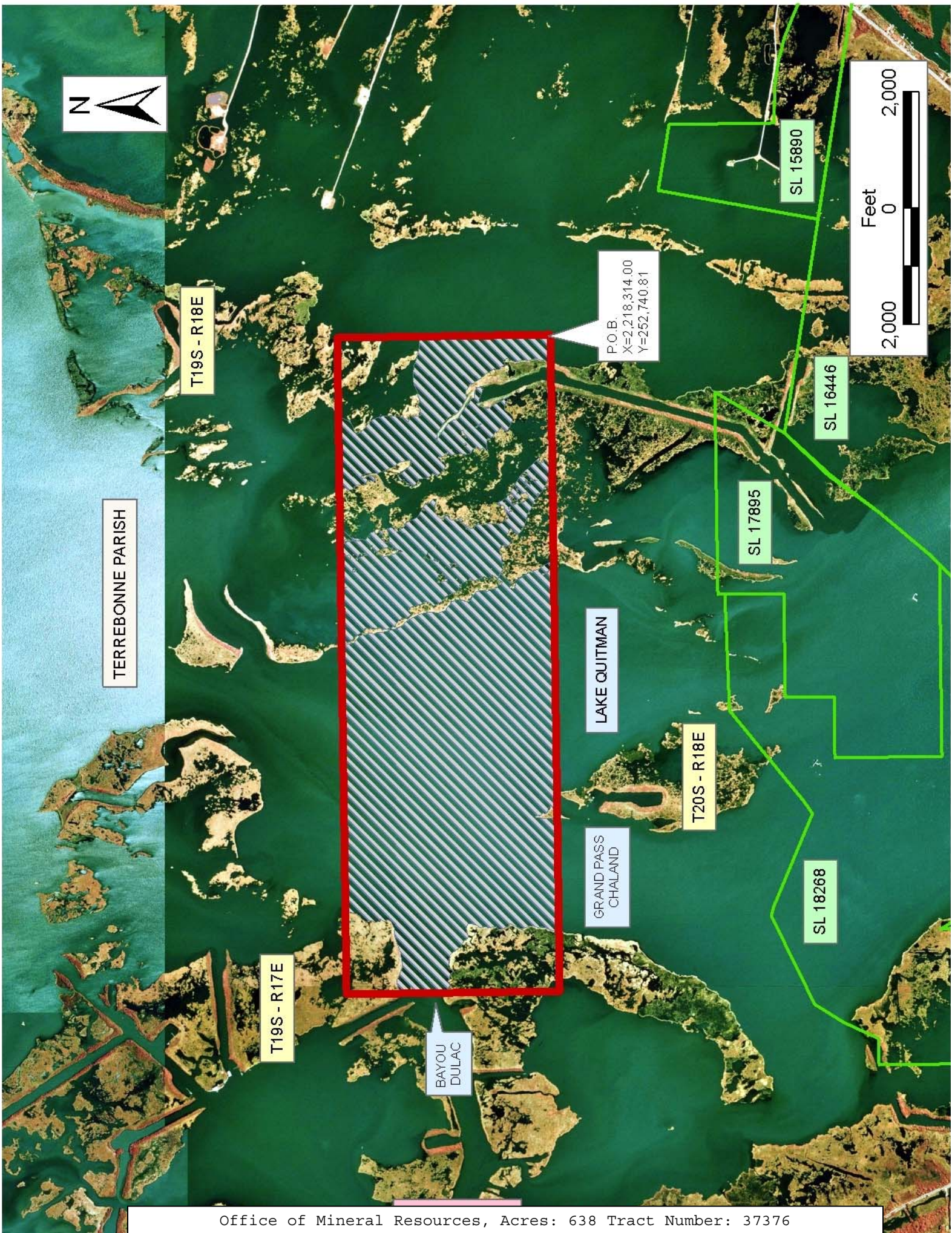

TERREBONNE PARISH

T19S - R18E

T19S - R17E

BAYOU  
DULAC

LAKE QUITMAN

T20S - R18E

GRAND PASS  
CHALAND

SL 15890

SL 16446

SL 17895

SL 18268

P.O.B.  
X=2,218,314.00  
Y=252,740.81

