

**TRACT 35403 - Concordia Parish, Louisiana**

All of the lands now or formerly constituting the beds and bottoms of all water bodies of every nature and description, and all islands and other lands formed by accretion, where allowed by law, or by reliction, and excepting tax adjudicated lands, belonging to the State of Louisiana and not presently under mineral lease on May 14, 2003, situated in Concordia Parish, Louisiana, and more particularly described as follows: Beginning at a point having Coordinates of X = 2,242,818.47 and Y = 255,247.66; thence East 3,897.53 feet to a point having Coordinates of X = 2,246,716.00 and Y = 255,247.66; thence South 5,415.81 feet to a point having Coordinates of X = 2,246,716.00 and Y = 249,831.85 thence West 3,897.53 to a point having Coordinates of X = 2,242,818.47 and Y = 249,831.85; thence North 5,415.81 feet to the point of beginning containing approximately **55.00 acres**, all as more particularly outlined on a plat on file in the Office of Mineral Resources, Department of Natural Resources. All bearings, distances and coordinates are based on Louisiana Coordinate System of 1927, (North or South Zone), where applicable.

NOTE: The above description of the Tract nominated for lease has been provided and corrected, where required, exclusively by the nomination party. Any mineral lease selected from this Tract and awarded by the Louisiana State Mineral Board shall be without warranty of any kind, either express, implied, or statutory, including, but not limited to, the implied warranties of merchantability and fitness for a particular purpose. Should the mineral lease awarded by the Louisiana State Mineral Board be subsequently modified, cancelled or abrogated due to the existence of conflicting leases, operating agreements, private claims or other future obligations or conditions which may affect all or any portion of the leased Tract, it shall not relieve the Lessee of the obligation to pay any bonus due thereon to the Louisiana State Mineral Board, nor shall the Louisiana State Mineral Board be obligated to refund any consideration paid by the Lessor prior to such modification, cancellation, or abrogation, including, but not limited to, bonuses, rentals and royalties.

Applicant: Leslie L. Moore

Bidder	Cash Payment	Price / Acre	Rental	Oil	Gas	Other





T5N - R7E

T4N - R7E

P.O.B.  
X=2,242,818.47  
Y=2,552,247.66



TR 35403  
55.00 +/- ACRES  
MAY, 2003

CONCORDIA PARISH

T5N - R8E

T4N - R8E

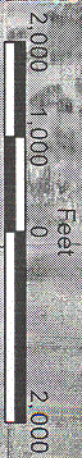



#### **TRACT 35404 - Concordia Parish, Louisiana**

All of the lands now or formerly constituting the beds and bottoms of all water bodies of every nature and description, and all islands and other lands formed by accretion, where allowed by law, or by reliction, and excepting tax adjudicated lands, belonging to the State of Louisiana and not presently under mineral lease on May 14, 2003, situated in Concordia Parish, Louisiana, and more particularly described as follows: Beginning at a point having Coordinates of X = 2,243,495.30 and Y = 204,582.23; thence South 89 degrees 33 minutes 30 seconds West 10,287.05 feet to a point on the boundary of Red River Wildlife Management Area having Coordinates of X = 2,233,208.56 and Y = 204,502.93; thence North 00 degrees 28 minutes 16 seconds West 4,495.39 feet along the said boundary of Red River Wildlife Management Area to a point having Coordinates of X = 2,233,171.59 and Y = 208,998.17; thence North 00 degrees 29 minutes 25 seconds West 2,819.32 feet along the said boundary of Red River Wildlife Management Area to a point having Coordinates of X = 2,233,147.47 and Y = 211,817.39; thence North 00 degrees 26 minutes 30 seconds West 8,668.15 feet to a point having Coordinates of X = 2,233,080.65 and Y = 220,485.28; thence North 89 degrees 15 minutes 02 seconds East 10,209.08 feet to a point having Coordinates of X = 2,243,288.86 and Y = 220,618.81; thence South 00 degrees 44 minutes 15 seconds East 16,037.91 feet to the point of beginning, **LESS AND EXCEPT** any portion of the above described tract lying outside the boundaries of the Red River Wildlife Management Area, containing approximately **13 acres**, all as more particularly outlined on a plat on file in the Office of Mineral Resources, Department of Natural Resources. All bearings, distances and coordinates are based on Louisiana Coordinate System of 1927, (North or South Zone), where applicable.

NOTE: The above description of the Tract nominated for lease has been provided and corrected, where required, exclusively by the nomination party. Any mineral lease selected from this Tract and awarded by the Louisiana State Mineral Board shall be without warranty of any kind, either express, implied, or statutory, including, but not limited to, the implied warranties of merchantability and fitness for a particular purpose. Should the mineral lease awarded by the Louisiana State Mineral Board be subsequently modified, cancelled or abrogated due to the existence of conflicting leases, operating agreements, private claims or other future obligations or conditions which may affect all or any portion of the leased Tract, it shall not relieve the Lessee of the obligation to pay any bonus due thereon to the Louisiana State Mineral Board, nor shall the Louisiana State Mineral Board be obligated to refund any consideration paid by the Lessor prior to such modification, cancellation, or abrogation, including, but not limited to, bonuses, rentals and royalties.

NOTE: The mineral lease is located in the Red River Wildlife Management Area under the jurisdiction of the Louisiana Department of Wildlife and Fisheries which has promulgated rules and regulations for the protection of game and wildlife on the aforesaid Tract and, therefore, shall be subject to said rules and regulations, a copy of which shall be attached to the mineral lease. In addition to the specific rules and regulations

applicable, the following shall apply regarding operations under this mineral lease:

1. No activities will be allowed without written authorization from the Louisiana Department of Wildlife and Fisheries.
2. Projects will be evaluated on a case by case basis. Modifications to projects may be required including, but not limited to, access routes, spoil placement, well sites, flow lines and other appurtenant structures.
3. Mitigation will be required to offset avoidable wetland impacts.
4. Removal of all structures, facilities and equipment will be required within 120 days of abandonment unless otherwise agreed to by the Louisiana Department of Wildlife and Fisheries.
5. Prior to submitting applications for wetland permits to Federal and State permitting agencies the lease holder shall coordinate project details with the Louisiana Department of Wildlife and Fisheries, Fur and Refuge Division. Contact person for the Department will be Mike Windham at (504) 568-5886.

Applicant: Stephen M. Jenkins, Inc.

Bidder	Cash Payment	Price / Acre	Rental	Oil	Gas	Other





T3N R7E

CONCORDIA PARISH

A.O. 0255

TR 35404  
13.00 +/- ACRES  
MAY, 2003

P.O.B.  
X=2,243,495.30  
Y=204,562.23

Feet  
0 1,500 3,000



#### **TRACT 35405 - Concordia Parish, Louisiana**

All of the lands now or formerly constituting the beds and bottoms of all water bodies of every nature and description, and all islands and other lands formed by accretion, where allowed by law, or by reliction, and excepting tax adjudicated lands, belonging to the State of Louisiana and not presently under mineral lease on May 14, 2003, situated in Concordia Parish, Louisiana, and more particularly described as follows: Beginning at a point having Coordinates of X = 2,243,495.30 and Y = 204,582.23; thence South 00 degrees 44 minutes 15 seconds East 9,656.98 feet to a point on the boundary of Red River Wildlife Management Area having Coordinates of X = 2,243,619.60 and Y = 194,926.05; thence in a Northwesterly direction along the Southern boundary of the said Red River Wildlife Management Area to a point having Coordinates of X = 2,233,226.11 and Y = 201,616.29; thence North 00 degrees 15 minutes 04 seconds East 346.64 feet to a point having Coordinates of X = 2,233,227.63 and Y = 201,962.93; thence South 41 degrees 04 minutes 11 seconds East 2.79 feet to a point having Coordinates of X = 2,233,229.46 and Y = 201,960.83; thence North 00 degrees 28 minutes 13 seconds West 146.19 feet to a point having Coordinates of X = 2,233,228.26 and Y = 202,107.02; thence North 00 degrees 28 minutes 16 seconds West 2,395.99 feet to a point having Coordinates of X = 2,233,208.56 and Y = 204,502.93; thence North 89 degrees 33 minutes 30 seconds East 10,287.05 feet to the point of beginning, **LESS AND EXCEPT**, if any, that portion of State Lease No. 12938, as amended, that may lie within the above described tract, and **LESS AND EXCEPT** all that portion of the above described tract lying outside the boundaries of the Red River Wildlife Management Area, containing approximately **183 acres**, all as more particularly outlined on a plat on file in the Office of Mineral Resources, Department of Natural Resources. All bearings, distances and coordinates are based on Louisiana Coordinate System of 1927, (North or South Zone), where applicable.

NOTE: The above description of the Tract nominated for lease has been provided and corrected, where required, exclusively by the nomination party. Any mineral lease selected from this Tract and awarded by the Louisiana State Mineral Board shall be without warranty of any kind, either express, implied, or statutory, including, but not limited to, the implied warranties of merchantability and fitness for a particular purpose. Should the mineral lease awarded by the Louisiana State Mineral Board be subsequently modified, cancelled or abrogated due to the existence of conflicting leases, operating agreements, private claims or other future obligations or conditions which may affect all or any portion of the leased Tract, it shall not relieve the Lessee of the obligation to pay any bonus due thereon to the Louisiana State Mineral Board, nor shall the Louisiana State Mineral Board be obligated to refund any consideration paid by the Lessor prior to such modification, cancellation, or abrogation, including, but not limited to, bonuses, rentals and royalties.

NOTE: The mineral lease is located in the Red River Wildlife Management Area under the jurisdiction of the Louisiana Department of Wildlife and Fisheries which has promulgated rules and regulations for the protection



of game and wildlife on the aforesaid Tract and, therefore, shall be subject to said rules and regulations, a copy of which shall be attached to the mineral lease. In addition to the specific rules and regulations applicable, the following shall apply regarding operations under this mineral lease:

1. No activities will be allowed without written authorization from the Louisiana Department of Wildlife and Fisheries.
2. Projects will be evaluated on a case by case basis. Modifications to projects may be required including, but not limited to, access routes, spoil placement, well sites, flow lines and other appurtenant structures.
3. Mitigation will be required to offset avoidable wetland impacts.
4. Removal of all structures, facilities and equipment will be required within 120 days of abandonment unless otherwise agreed to by the Louisiana Department of Wildlife and Fisheries.
5. Prior to submitting applications for wetland permits to Federal and State permitting agencies the lease holder shall coordinate project details with the Louisiana Department of Wildlife and Fisheries, Fur and Refuge Division. Contact person for the Department will be Mike Windham at (504) 568-5886.

Applicant: Stephen M. Jenkins, Inc.

Bidder	Cash Payment	Price / Acre	Rental	Oil	Gas	Other





RED RIVER

AVOUELLES PARISH

CONCORDIA PARISH

RED RIVER WMA

T3N - R7E

T3N - R7E

S.L. 12938

TR 35405  
183.00 +/- ACRES  
MAY, 2003

P.O.B  
X=2,243,495.30  
Y=204,582.23

Feet  
2,000 1,000 0 2,000



**TRACT 35406 - Avoyelles Parish, Louisiana**

All of the lands now or formerly constituting the beds and bottoms of all water bodies of every nature and description, and all islands and other lands formed by accretion, where allowed by law, or by reliction, and excepting tax adjudicated lands, belonging to the State of Louisiana and not presently under mineral lease on May 14, 2003, situated in Avoyelles Parish, Louisiana, and more particularly described as follows: Beginning at a point on the Northern boundary of Grassy Lake Wildlife Management Area having Coordinates of X = 2,243,760.45 and Y = 183,985.18; thence South 88 degrees 25 minutes 06 seconds West 5,007.86 feet along the said Northern boundary of Grassy Lake Wildlife Management Area to a point having Coordinates of X = 2,238,754.50 and Y = 183,846.96; thence North 00 degrees 53 minutes 21 seconds West 5,203.77 feet along the said Northern boundary of Grassy Lake Wildlife Management Area to a point having Coordinates of X = 2,238,673.74 and Y = 189,050.10; thence North 00 degrees 53 minutes 21 seconds West 5,213.25 feet to a point having Coordinates of X = 2,238,592.83 and Y = 194,262.72; thence North 89 degrees 57 minutes 23 seconds West 5,310.07 feet to a point having Coordinates of X = 2,233,282.76 and Y = 194,266.75; thence North 00 degrees 26 minutes 30 seconds West 7,349.76 feet to a point on the Southern boundary of Red River Wildlife Management Area having Coordinates of X = 2,233,226.11 and Y = 201,616.29; thence in a Southeasterly direction along the Southern boundary of said Red River Wildlife Management Area to a point having Coordinates of X = 2,243,619.60 and Y = 194,926.05; thence South 00 degrees 44 minutes 15 seconds East 10,941.78 feet to the point of beginning, **LESS AND EXCEPT** all that portion of State Lease No. 12938, as amended, that lies within the above described tract, and **LESS AND EXCEPT** all those portions of Red River Wildlife Management Area and Grassy Lake Wildlife Management Area that may lie within the above described tract, containing approximately **150 acres**, all as more particularly outlined on a plat on file in the Office of Mineral Resources, Department of Natural Resources. All bearings, distances and coordinates are based on Louisiana Coordinate System of 1927, (North or South Zone), where applicable.

NOTE: The above description of the Tract nominated for lease has been provided and corrected, where required, exclusively by the nomination party. Any mineral lease selected from this Tract and awarded by the Louisiana State Mineral Board shall be without warranty of any kind, either express, implied, or statutory, including, but not limited to, the implied warranties of merchantability and fitness for a particular purpose. Should the mineral lease awarded by the Louisiana State Mineral Board be subsequently modified, cancelled or abrogated due to the existence of conflicting leases, operating agreements, private claims or other future obligations or conditions which may affect all or any portion of the leased Tract, it shall not relieve the Lessee of the obligation to pay any bonus due thereon to the Louisiana State Mineral Board, nor shall the Louisiana State Mineral Board be obligated to refund any consideration paid by the Lessor prior to such modification, cancellation, or abrogation, including, but not limited to, bonuses, rentals and royalties.



Applicant: Stephen M. Jenkins, Inc.

Bidder	Cash Payment	Price / Acre	Rental	Oil	Gas	Other



A.O. 0255

T3N - R7E

AVOUELLES PARISH

GRASSY LAKE WMA

TR 35406  
150.00 +/- ACRES  
MAY, 2003

T2N - R7E

S.L. 12938

RED RIVER

S.L. 12894

P.O.B.  
X=2,243,760.45  
Y=183,985.18





#### **TRACT 35407 - Concordia Parish, Louisiana**

All of the lands now or formerly constituting the beds and bottoms of all water bodies of every nature and description, and all islands and other lands formed by accretion, where allowed by law, or by reliction, and excepting tax adjudicated lands, belonging to the State of Louisiana and not presently under mineral lease on May 14, 2003, situated in Concordia Parish, Louisiana, and more particularly described as follows: Beginning at a point having Coordinates of X = 2,243,495.30 and Y = 204,582.23; thence North 00 degrees 44 minutes 15 seconds West 16,037.91 feet to a point having Coordinates of X = 2,243,288.86 and Y = 220,618.81; thence North 89 degrees 16 minutes 30 seconds East 9,606.14 feet to a point having Coordinates of X = 2,252,894.23 and Y = 220,740.34; thence South 00 degrees 44 minutes 15 seconds East 16,108.84 feet to a point on the boundary of said Red River Wildlife Management Area having Coordinates of X = 2,253,101.59 and Y = 204,632.83; thence North 88 degrees 57 minutes 34 seconds West 906.32 feet along the said boundary of Red River Wildlife Management Area to a point having Coordinates of X = 2,252,195.42 and Y = 204,649.29; thence South 89 degrees 33 minutes 30 seconds West 8,700.38 feet to the point of beginning, containing approximately **5 acres**, all as more particularly outlined on a plat on file in the Office of Mineral Resources, Department of Natural Resources. All bearings, distances and coordinates are based on Louisiana Coordinate System of 1927, (North or South Zone), where applicable.

NOTE: The above description of the Tract nominated for lease has been provided and corrected, where required, exclusively by the nomination party. Any mineral lease selected from this Tract and awarded by the Louisiana State Mineral Board shall be without warranty of any kind, either express, implied, or statutory, including, but not limited to, the implied warranties of merchantability and fitness for a particular purpose. Should the mineral lease awarded by the Louisiana State Mineral Board be subsequently modified, cancelled or abrogated due to the existence of conflicting leases, operating agreements, private claims or other future obligations or conditions which may affect all or any portion of the leased Tract, it shall not relieve the Lessee of the obligation to pay any bonus due thereon to the Louisiana State Mineral Board, nor shall the Louisiana State Mineral Board be obligated to refund any consideration paid by the Lessor prior to such modification, cancellation, or abrogation, including, but not limited to, bonuses, rentals and royalties.

NOTE: The mineral lease is located in the Red River Wildlife Management Area under the jurisdiction of the Louisiana Department of Wildlife and Fisheries which has promulgated rules and regulations for the protection of game and wildlife on the aforesaid Tract and, therefore, shall be subject to said rules and regulations, a copy of which shall be attached to the mineral lease. In addition to the specific rules and regulations applicable, the following shall apply regarding operations under this mineral lease:

1. No activities will be allowed without written authorization from the Louisiana Department of Wildlife and Fisheries.

2. Projects will be evaluated on a case by case basis. Modifications to projects may be required including, but not limited to, access routes, spoil placement, well sites, flow lines and other appurtenant structures.
3. Mitigation will be required to offset avoidable wetland impacts.
4. Removal of all structures, facilities and equipment will be required within 120 days of abandonment unless otherwise agreed to by the Louisiana Department of Wildlife and Fisheries.
5. Prior to submitting applications for wetland permits to Federal and State permitting agencies the lease holder shall coordinate project details with the Louisiana Department of Wildlife and Fisheries, Fur and Refuge Division. Contact person for the Department will be Mike Windham at (504) 568-5886.

Applicant: Stephen M. Jenkins, Inc.

Bidder	Cash Payment	Price / Acre	Rental	Oil	Gas	Other



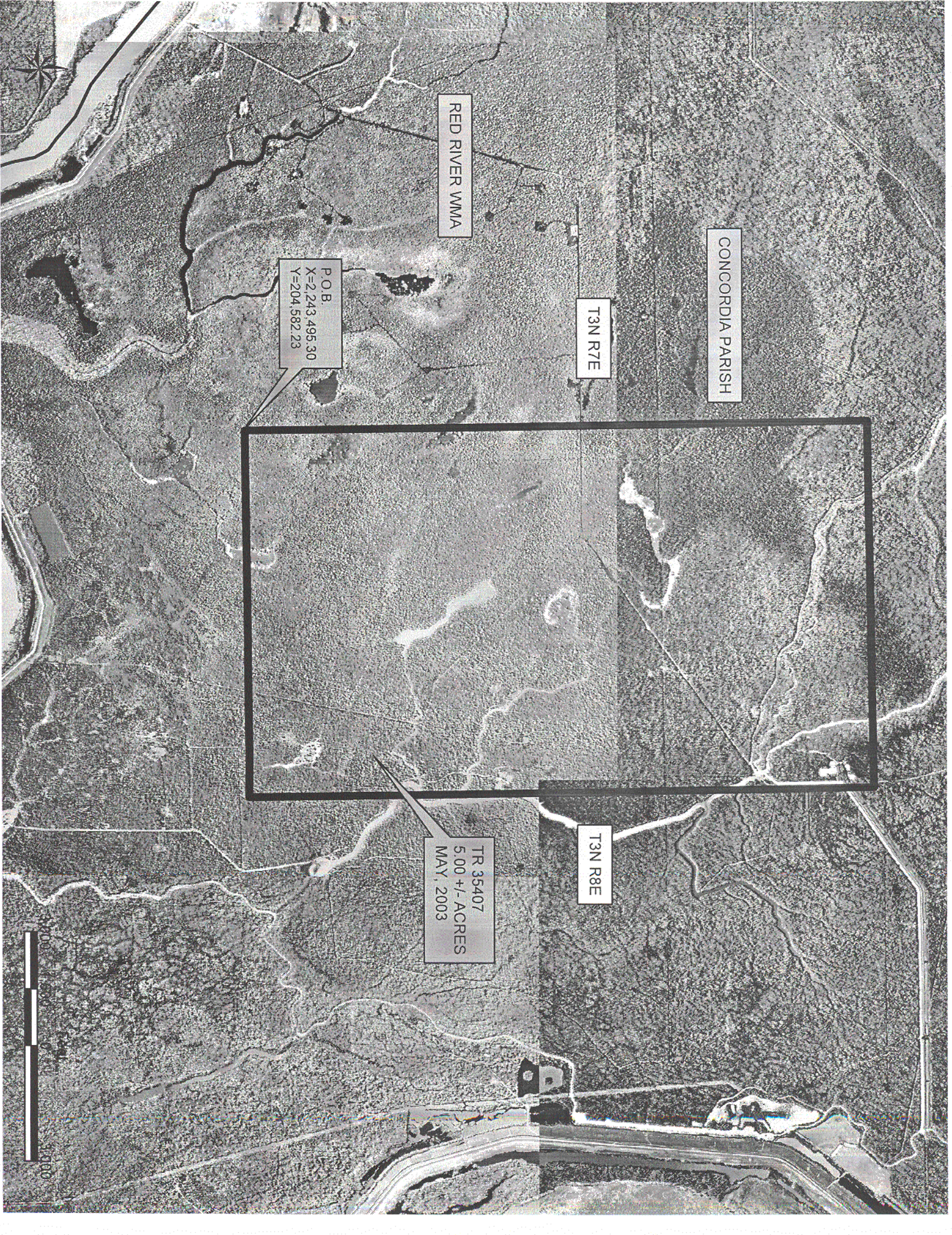

RED RIVER WMA

CONCORDIA PARISH

T3N R7E

T3N R8E

P.O.B.  
X=2,243,495.30  
Y=204,582.23

TR 35407  
5.00 +/- ACRES  
MAY, 2003

0 100 200 300 400 500 600 700 800 900 1000



#### **TRACT 35408 - Concordia Parish, Louisiana**

All of the lands now or formerly constituting the beds and bottoms of all water bodies of every nature and description, and all islands and other lands formed by accretion, where allowed by law, or by reliction, and excepting tax adjudicated lands, belonging to the State of Louisiana and not presently under mineral lease on May 14, 2003, situated in Concordia Parish, Louisiana, and more particularly described as follows: Beginning at a point having Coordinates of X = 2,243,495.30 and Y = 204,582.23; thence North 89 degrees 33 minutes 30 seconds East 8,700.38 feet to a point on the boundary of said Red River Wildlife Management Area having Coordinates of X = 2,252,195.42 and Y = 204,649.29; thence along the said boundary of Red River Wildlife Management Areas the following courses: South 02 degrees 15 minutes 55 seconds East 1,188.57 feet to a point having Coordinates of X = 2,252,242.40 and Y = 203,461.65, South 83 degrees 40 minutes 58 seconds East 802.40 feet to a point having Coordinates of X = 2,253,039.93 and Y = 203,373.36; South 83 degrees 13 minutes 18 seconds East 78.54 feet to a point on the boundary of said Red River Wildlife Management Area having Coordinates of X = 2,253,117.92 and Y = 203,364.09; thence South 00 degrees 44 minutes 15 seconds East 7,924.60 feet to a point having Coordinates of X = 2,253,219.93 and Y = 195,440.15, thence in a Northwesterly direction, then in a Westerly direction, and then in a Southwesterly direction along the Southern boundary of said Red River Wildlife Management Area to a point having Coordinates of X = 2,243,619.60 and Y = 194,926.05; thence North 00 degrees 44 minutes 15 seconds West 9,656.98 feet to the point of beginning, **LESS AND EXCEPT**, if any, that portion of State Lease No. 12938, as amended, and State Lease No. 12894, as amended, that may lie within the above described tract, containing approximately **80 acres**, all as more particularly outlined on a plat on file in the Office of Mineral Resources, Department of Natural Resources. All bearings, distances and coordinates are based on Louisiana Coordinate System of 1927, (North or South Zone), where applicable.

NOTE: The above description of the Tract nominated for lease has been provided and corrected, where required, exclusively by the nomination party. Any mineral lease selected from this Tract and awarded by the Louisiana State Mineral Board shall be without warranty of any kind, either express, implied, or statutory, including, but not limited to, the implied warranties of merchantability and fitness for a particular purpose. Should the mineral lease awarded by the Louisiana State Mineral Board be subsequently modified, cancelled or abrogated due to the existence of conflicting leases, operating agreements, private claims or other future obligations or conditions which may affect all or any portion of the leased Tract, it shall not relieve the Lessee of the obligation to pay any bonus due thereon to the Louisiana State Mineral Board, nor shall the Louisiana State Mineral Board be obligated to refund any consideration paid by the Lessor prior to such modification, cancellation, or abrogation, including, but not limited to, bonuses, rentals and royalties.



NOTE: The mineral lease is located in the Red River Wildlife Management Area under the jurisdiction of the Louisiana Department of Wildlife and Fisheries which has promulgated rules and regulations for the protection of game and wildlife on the aforesaid Tract and, therefore, shall be subject to said rules and regulations, a copy of which shall be attached to the mineral lease. In addition to the specific rules and regulations applicable, the following shall apply regarding operations under this mineral lease:

1. No activities will be allowed without written authorization from the Louisiana Department of Wildlife and Fisheries.
2. Projects will be evaluated on a case by case basis. Modifications to projects may be required including, but not limited to, access routes, spoil placement, well sites, flow lines and other appurtenant structures.
3. Mitigation will be required to offset avoidable wetland impacts.
4. Removal of all structures, facilities and equipment will be required within 120 days of abandonment unless otherwise agreed to by the Louisiana Department of Wildlife and Fisheries.
5. Prior to submitting applications for wetland permits to Federal and State permitting agencies the lease holder shall coordinate project details with the Louisiana Department of Wildlife and Fisheries, Fur and Refuge Division. Contact person for the Department will be Mike Windham at (504) 568-5886.

Applicant: Stephen M. Jenkins, Inc.

Bidder	Cash Payment	Price / Acre	Rental	Oil	Gas	Other



CONCORDIA PARISH

P.O.B  
X=2,243,495.30  
Y=204,582.23

TR 35408  
80.00 +/- ACRES  
MAY, 2003

T3N - R7E

S.L. 12938

RED RIVER

AVOYELLES PARISH

S.L. 12894

S.L. 13398

T3N R8E

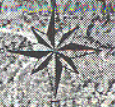



**TRACT 35409 - Avoyelles Parish, Louisiana**

All of the lands now or formerly constituting the beds and bottoms of all water bodies of every nature and description, and all islands and other lands formed by accretion, where allowed by law, or by reliction, and excepting tax adjudicated lands, belonging to the State of Louisiana and not presently under mineral lease on May 14, 2003, situated in Avoyelles Parish, Louisiana, and more particularly described as follows: Beginning at a point on the Northern boundary of Grassy Lake Wildlife Management Area having Coordinates of X = 2,243,760.45 and Y = 183,985.18; thence North 00 degrees 44 minutes 15 seconds West 10,941.78 feet to a point on the Southern boundary of Red River Wildlife Management Area having Coordinates of X = 2,243,619.60 and Y = 194,926.05; thence in a Northeasterly direction, then in an Easterly direction, and then in a Southeasterly direction along the Southern boundary of said Red River Wildlife Management Area to a point having Coordinates of X = 2,253,219.93 and Y = 195,440.15; thence South 00 degrees 44 minutes 15 seconds East 5,956.14 feet to a point on the Northern boundary of Grassy Lake Wildlife Management Area having Coordinates of X = 2,253,296.59 and Y = 189,484.50; thence along the said Northern boundary of Grassy Lake Wildlife Management Areas the following courses: South 89 degrees 44 minutes 50 seconds West 4,246.15 feet to a point having Coordinates of X = 2,249,050.48 and Y = 189,465.77; South 02 degrees 13 minutes 31 seconds East 5,387.33 feet to a point having Coordinates of X = 2,249,259.65 and Y = 184,082.50; South 89 degrees 35 minutes 35 seconds West 2,600.18 feet to a point having Coordinates of X = 2,246,659.54 and Y = 184,064.03; South 89 degrees 35 minutes 46 seconds West 58.16 feet to a point having Coordinates of X = 2,246,601.38 and Y = 184,063.62; South 88 degrees 25 minutes 06 seconds West 2,842.01 feet to the point of beginning, **LESS AND EXCEPT**, if any, that portion of State Lease No. 12938, as amended, and State Lease No. 12894, as amended, and **LESS AND EXCEPT** all that portion of the above described tract lying within the boundaries of Red River Wildlife Management Area and Grassy Lake Wildlife Management Area, containing approximately **75 acres**, all as more particularly outlined on a plat on file in the Office of Mineral Resources, Department of Natural Resources. All bearings, distances and coordinates are based on Louisiana Coordinate System of 1927, (North or South Zone), where applicable.

NOTE: The above description of the Tract nominated for lease has been provided and corrected, where required, exclusively by the nomination party. Any mineral lease selected from this Tract and awarded by the Louisiana State Mineral Board shall be without warranty of any kind, either express, implied, or statutory, including, but not limited to, the implied warranties of merchantability and fitness for a particular purpose. Should the mineral lease awarded by the Louisiana State Mineral Board be subsequently modified, cancelled or abrogated due to the existence of conflicting leases, operating agreements, private claims or other future obligations or conditions which may affect all or any portion of the leased Tract, it shall not relieve the Lessee of the obligation to pay any bonus due thereon to the Louisiana State Mineral Board, nor shall the Louisiana State Mineral Board be obligated to refund any consideration



paid by the Lessor prior to such modification, cancellation, or abrogation, including, but not limited to, bonuses, rentals and royalties.

NOTE: The mineral lease is located in the Red River Wildlife Management Area under the jurisdiction of the Louisiana Department of Wildlife and Fisheries which has promulgated rules and regulations for the protection of game and wildlife on the aforesaid Tract and, therefore, shall be subject to said rules and regulations, a copy of which shall be attached to the mineral lease. In addition to the specific rules and regulations applicable, the following shall apply regarding operations under this mineral lease:

- 1. No activities will be allowed without written authorization from the Louisiana Department of Wildlife and Fisheries.
- 2. Projects will be evaluated on a case by case basis. Modifications to projects may be required including, but not limited to, access routes, spoil placement, well sites, flow lines and other appurtenant structures.
- 3. Mitigation will be required to offset avoidable wetland impacts.
- 4. Removal of all structures, facilities and equipment will be required within 120 days of abandonment unless otherwise agreed to by the Louisiana Department of Wildlife and Fisheries.
- 5. Prior to submitting applications for wetland permits to Federal and State permitting agencies the lease holder shall coordinate project details with the Louisiana Department of Wildlife and Fisheries, Fur and Refuge Division. Contact person for the Department will be Mike Windham at (504) 568-5886.

Applicant: Stephen M. Jenkins, Inc.

Bidder	Cash Payment	Price / Acre	Rental	Oil	Gas	Other



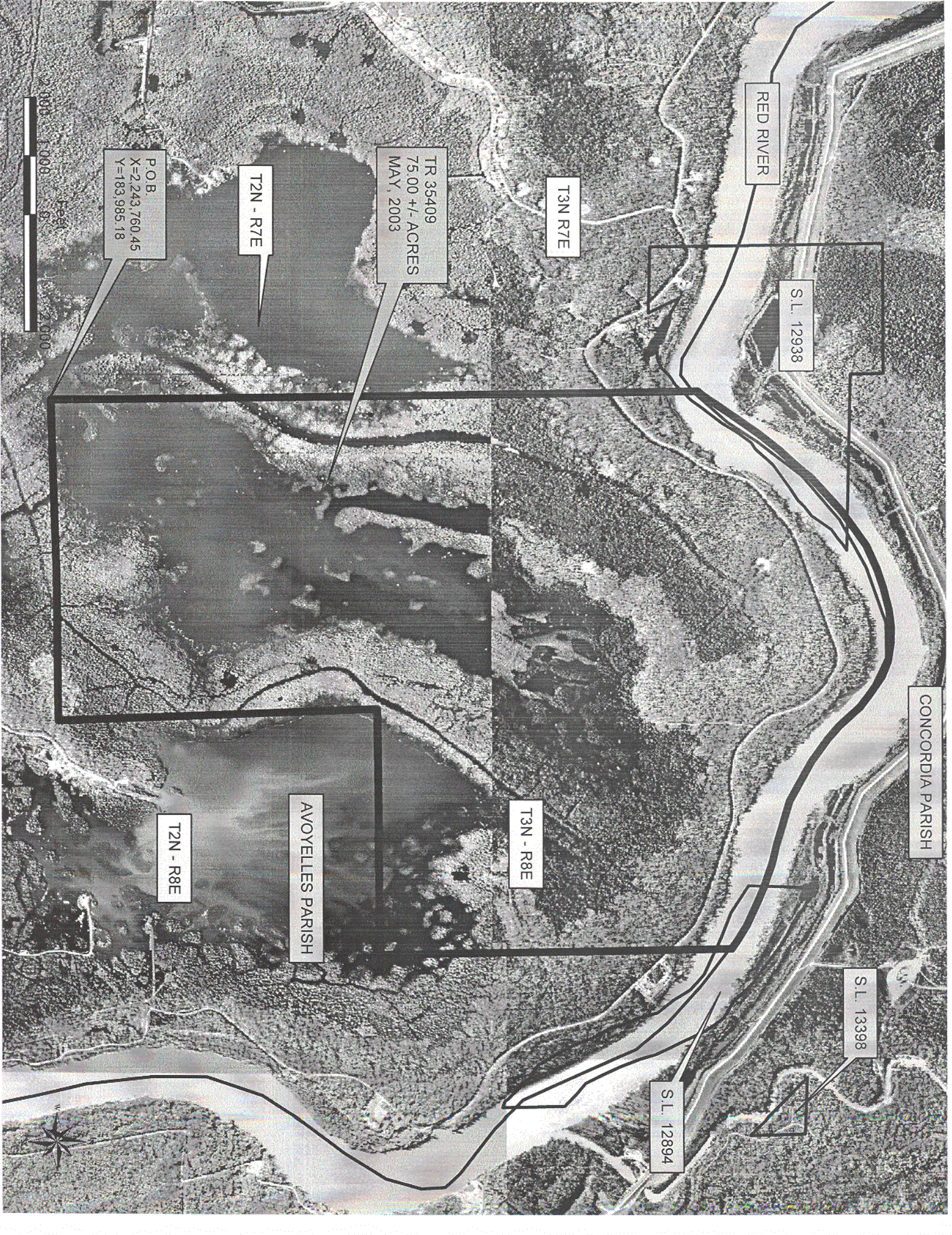

RED RIVER

S.L. 12938

CONCORDIA PARISH

S.L. 13398

S.L. 12894

T3N R7E

T3N - R8E

TR 35409  
75.00 +/- ACRES  
MAY, 2003

T2N - R7E

AVOUELLES PARISH

T2N - R8E

P.O.B.  
X=2,243,760.45  
Y=183,985.18





**TRACT 35410 - Concordia Parish, Louisiana**

All of the lands now or formerly constituting the beds and bottoms of all water bodies of every nature and description, and all islands and other lands formed by accretion, where allowed by law, or by reliction, and excepting tax adjudicated lands, belonging to the State of Louisiana and not presently under mineral lease on May 14, 2003, situated in Concordia Parish, Louisiana, and more particularly described as follows: Beginning at a point having Coordinates of X = 2,252,894.23 and Y = 220,740.34; thence North 89 degrees 15 minutes 45 seconds East 1,817.77 feet to a point on the boundary of said Red River Wildlife Management Area having Coordinates of X = 2,254,711.85 and Y = 220,763.74; thence along the said boundary of Red River Wildlife Management Area the following courses: South 00 degrees 05 minutes 05 seconds West 5,272.89 feet to a point having Coordinates of X = 2,254,704.06 and Y = 215,490.86, North 89 degrees 37 minutes 30 seconds East 5,311.83 feet to a point having Coordinates of X = 2,260,015.78 and Y = 215,525.62, South 02 degrees 34 minutes 40 seconds East 1,022.07 feet to a point having Coordinates of X = 2,260,061.75 and Y = 214,504.58; thence South 03 degrees 32 minutes 41 seconds East 1,495.58 feet to a point having Coordinates of X = 2,260,154.22 and Y = 213,011.86; thence in a Southwesterly direction and then in a Southerly direction along the boundary of said Red River Wildlife Management Area to a point having Coordinates of X = 2,259,355.68 and Y = 210,193.47; thence along the said boundary of Red River Wildlife Management Area the following courses: South 88 degrees 44 minutes 09 seconds West 4,659.92 feet to a point having Coordinates of X = 2,254,696.89 and Y = 210,090.66, South 01 degrees 09 minutes 42 seconds West 2,743.38 feet to a point having Coordinates of X = 2,254,641.27 and Y = 207,347.84, South 89 degrees 49 minutes 15 seconds East 3,659.40 feet to a point having Coordinates of X = 2,258,300.65 and Y = 207,336.40; thence in a Southeasterly direction, then in a Southerly direction and then in a Southwesterly direction along the boundary of said Red River Wildlife Management Area to a point having Coordinates of X = 2,255,663.85 and Y = 204,574.13; thence along the said boundary of Red River Wildlife Management Area the following courses: North 89 degrees 45 minutes 06 seconds West 92.32 feet to a point having Coordinates of X = 2,255,571.53 and Y = 204,574.53, North 04 degrees 38 minutes 08 seconds East 1.86 feet to a point having Coordinates of X = 2,255,571.68 and Y = 204,576.38, North 88 degrees 17 minutes 01 seconds West 991.19 feet to a point having Coordinates of X = 2,254,580.93 and Y = 204,606.07, South 0.11 feet to a point having Coordinates of X = 2,254,580.93 and Y = 204,605.96, North 88 degrees 57 minutes 34 seconds West 1,479.58 feet to a point having Coordinates of X = 2,253,101.59 and Y = 204,632.83; thence North 00 degrees 44 minutes 15 seconds West 16,108.84 feet to the point of beginning, containing approximately **45 acres**, all as more particularly outlined on a plat on file in the Office of Mineral Resources, Department of Natural Resources. All bearings, distances and coordinates are based on Louisiana Coordinate System of 1927, (North or South Zone), where applicable.



NOTE: The above description of the Tract nominated for lease has been provided and corrected, where required, exclusively by the nomination party. Any mineral lease selected from this Tract and awarded by the Louisiana State Mineral Board shall be without warranty of any kind, either express, implied, or statutory, including, but not limited to, the implied warranties of merchantability and fitness for a particular purpose. Should the mineral lease awarded by the Louisiana State Mineral Board be subsequently modified, cancelled or abrogated due to the existence of conflicting leases, operating agreements, private claims or other future obligations or conditions which may affect all or any portion of the leased Tract, it shall not relieve the Lessee of the obligation to pay any bonus due thereon to the Louisiana State Mineral Board, nor shall the Louisiana State Mineral Board be obligated to refund any consideration paid by the Lessor prior to such modification, cancellation, or abrogation, including, but not limited to, bonuses, rentals and royalties.

NOTE: The mineral lease is located in the Red River Wildlife Management Area under the jurisdiction of the Louisiana Department of Wildlife and Fisheries which has promulgated rules and regulations for the protection of game and wildlife on the aforesaid Tract and, therefore, shall be subject to said rules and regulations, a copy of which shall be attached to the mineral lease. In addition to the specific rules and regulations applicable, the following shall apply regarding operations under this mineral lease:

1. No activities will be allowed without written authorization from the Louisiana Department of Wildlife and Fisheries.
2. Projects will be evaluated on a case by case basis. Modifications to projects may be required including, but not limited to, access routes, spoil placement, well sites, flow lines and other appurtenant structures.
3. Mitigation will be required to offset avoidable wetland impacts.
4. Removal of all structures, facilities and equipment will be required within 120 days of abandonment unless otherwise agreed to by the Louisiana Department of Wildlife and Fisheries.
5. Prior to submitting applications for wetland permits to Federal and State permitting agencies the lease holder shall coordinate project details with the Louisiana Department of Wildlife and Fisheries, Fur and Refuge Division. Contact person for the Department will be Mike Windham at (504) 568-5886.

Applicant: Stephen M. Jenkins, Inc.



Bidder	Cash Payment	Price / Acre	Rental	Oil	Gas	Other



P.O.B.  
X=2,252,894.23  
Y=220,740.34

TR 35410  
45.00 +/- ACRES  
MAY, 2003

MISSISSIPPI RIVER

ADAMS COUNTY,  
MISSISSIPPI

T3N R8E

T3N R7E

RED RIVER WMA

CONCORDIA PARISH

0 1,000 2,000 Feet





**TRACT 35411 - Concordia Parish, Louisiana**

The following described property consisting of School Indemnity Lands, excluding the beds and bottoms of all navigable waters, located in Concordia Parish, Louisiana, not presently under mineral lease on May 14, 2003, and described as follows: All of the North Half of Section 51, Township 3 North, Range 8 East, Concordia Parish, Louisiana, containing approximately **321.54 acres**, all as more particularly outlined on a plat on file in the Office of Mineral Resources, Department of Natural Resources.

NOTE: The State Mineral Board is acting pursuant to La. R.S. 30:121-136 and pursuant to all other applicable statutes, and the proceeds derived from any lease that is awarded shall be paid to the Office of Mineral Resources and by it remitted to the State Treasurer for disposition in accordance with requirements of law relating to oil, gas and mineral leases of School Indemnity Lands.

NOTE: The above description of the Tract nominated for lease has been provided and corrected, where required, exclusively by the nomination party. Any mineral lease selected from this Tract and awarded by the Louisiana State Mineral Board shall be without warranty of any kind, either express, implied, or statutory, including, but not limited to, the implied warranties of merchantability and fitness for a particular purpose. Should the mineral lease awarded by the Louisiana State Mineral Board be subsequently modified, cancelled or abrogated due to the existence of conflicting leases, operating agreements, private claims or other future obligations or conditions which may affect all or any portion of the leased Tract, it shall not relieve the Lessee of the obligation to pay any bonus due thereon to the Louisiana State Mineral Board, nor shall the Louisiana State Mineral Board be obligated to refund any consideration paid by the Lessor prior to such modification, cancellation, or abrogation, including, but not limited to, bonuses, rentals and royalties.

Applicant: Stephen M. Jenkins, Inc.

Bidder	Cash Payment	Price / Acre	Rental	Oil	Gas	Other



CONCORDIA PARISH

SEC 51

T3N - R8E

TR 35411  
321.54 +/- ACRES  
MAY, 2003

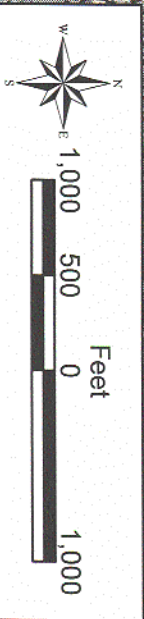



### **TRACT 35412 - Concordia Parish, Louisiana**

All of the lands now or formerly constituting the beds and bottoms of all water bodies of every nature and description, and all islands and other lands formed by accretion, where allowed by law, or by reliction, and excepting tax adjudicated lands, belonging to the State of Louisiana and not presently under mineral lease on May 14, 2003, situated in Concordia Parish, Louisiana, and more particularly described as follows: Beginning at a point having Coordinates of X = 2,260,154.22 and Y = 204,608.75; thence South 89 degrees 33 minutes 30 seconds West 4,490.50 feet to a point on the boundary of said Red River Wildlife Management Area having Coordinates of X = 2,255,663.85 and Y = 204,574.13; thence in a Northeasterly direction, then in a Northerly direction and then in a Northwesterly direction along the boundary of said Red River Wildlife Management Area, to a point having Coordinates of X = 2,258,300.65 and Y = 207,336.40; thence along the said boundary of Red River Wildlife Management Area the following courses: North 89 degrees 49 minutes 15 seconds West 3,659.40 feet to a point having Coordinates of X = 2,254,641.27 and Y = 207,347.84, North 01 degrees 09 minutes 42 seconds East 2,743.38 feet to a point having Coordinates of X = 2,254,696.89 and Y = 210,090.66, North 88 degrees 44 minutes 09 seconds East 4,659.92 feet to a point having Coordinates of X = 2,259,355.68 and Y = 210,193.47; thence in a Northerly direction and then in a Northeasterly direction along the boundary of said Red River Wildlife Management Area to a point having Coordinates of X = 2,260,154.22 and Y = 213,011.86; thence South 8,403.11 feet to the point of beginning, **LESS AND EXCEPT** all that portion of Red River Wildlife Management Area that may lie within the above described tract, containing approximately **13 acres**, all as more particularly outlined on a plat on file in the Office of Mineral Resources, Department of Natural Resources. All bearings, distances and coordinates are based on Louisiana Coordinate System of 1927, (North or South Zone), where applicable.

NOTE: The above description of the Tract nominated for lease has been provided and corrected, where required, exclusively by the nomination party. Any mineral lease selected from this Tract and awarded by the Louisiana State Mineral Board shall be without warranty of any kind, either express, implied, or statutory, including, but not limited to, the implied warranties of merchantability and fitness for a particular purpose. Should the mineral lease awarded by the Louisiana State Mineral Board be subsequently modified, cancelled or abrogated due to the existence of conflicting leases, operating agreements, private claims or other future obligations or conditions which may affect all or any portion of the leased Tract, it shall not relieve the Lessee of the obligation to pay any bonus due thereon to the Louisiana State Mineral Board, nor shall the Louisiana State Mineral Board be obligated to refund any consideration paid by the Lessor prior to such modification, cancellation, or abrogation, including, but not limited to, bonuses, rentals and royalties.

NOTE: The mineral lease is located in the Red River Wildlife Management Area under the jurisdiction of the Louisiana Department of Wildlife and



Fisheries which has promulgated rules and regulations for the protection of game and wildlife on the aforesaid Tract and, therefore, shall be subject to said rules and regulations, a copy of which shall be attached to the mineral lease. In addition to the specific rules and regulations applicable, the following shall apply regarding operations under this mineral lease:

1. No activities will be allowed without written authorization from the Louisiana Department of Wildlife and Fisheries.
2. Projects will be evaluated on a case by case basis. Modifications to projects may be required including, but not limited to, access routes, spoil placement, well sites, flow lines and other appurtenant structures.
3. Mitigation will be required to offset avoidable wetland impacts.
4. Removal of all structures, facilities and equipment will be required within 120 days of abandonment unless otherwise agreed to by the Louisiana Department of Wildlife and Fisheries.
5. Prior to submitting applications for wetland permits to Federal and State permitting agencies the lease holder shall coordinate project details with the Louisiana Department of Wildlife and Fisheries, Fur and Refuge Division. Contact person for the Department will be Mike Windham at (504) 568-5886.

Applicant: Stephen M. Jenkins, Inc.

Bidder	Cash Payment	Price / Acre	Rental	Oil	Gas	Other





CONCORDIA PARISH

TR 35412  
13.00 +/- ACRES  
MAY, 2003

T3N R8E

RED RIVER WMA

P.O.B  
X=2,260,154.22  
Y=204,608.75

MISSISSIPPI RIVER

ADAMS COUNTY,  
MISSISSIPPI

MS  
LA

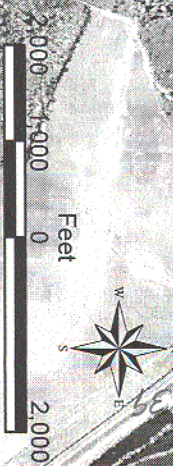



**TRACT 35413 - Concordia Parish, Louisiana**

All of the lands now or formerly constituting the beds and bottoms of all water bodies of every nature and description, and all islands and other lands formed by accretion, where allowed by law, or by reliction, and excepting tax adjudicated lands, belonging to the State of Louisiana and not presently under mineral lease on May 14, 2003, situated in Concordia Parish, Louisiana, and more particularly described as follows: Beginning at a point on the boundary of Grassy Lake Wildlife Management Area having Coordinates of X = 2,253,296.59 and Y = 189,484.50; thence North 00 degrees 44 minutes 15 seconds West 5,956.14 feet to a point on the boundary of Red River Wildlife Management Area, having Coordinates of X = 2,253,219.93 and Y = 195,440.15; thence in a Southeasterly direction along the boundary of said Red River Wildlife Management Area to a point having Coordinates of X = 2,256,274.48 and Y = 191,950.76; thence in a Northeasterly direction along the boundary of said Red River Wildlife Management Area to a point having Coordinates of X = 2,256,993.71 and Y = 193,842.49; thence along the said boundary of Red River Wildlife Management Area the following courses: South 00 degrees 06 minutes 58 seconds East 1,456.97 feet to a point having Coordinates of X = 2,256,996.66 and Y = 192,385.52, South 00 degrees 00 minutes 11 seconds West 189.79 feet to a point having Coordinates of X = 2,256,996.65 and Y = 192,195.73, North 58 degrees 28 minutes 32 seconds East 352.54 feet to a point having Coordinates of X = 2,257,297.16 and Y = 192,380.06, North 58 degrees 56 minutes 14 seconds East 284.06 feet to a point having Coordinates of X = 2,257,540.49 and Y = 192,526.63, North 58 degrees 34 minutes 30 seconds East 374.89 feet to a point having Coordinates of X = 2,257,860.39 and Y = 192,722.09, North 58 degrees 47 minutes 58 seconds East 204.91 feet to a point having Coordinates of X = 2,258,035.66 and Y = 192,828.24, North 00 degrees 11 minutes 55 seconds West 981.31 feet to a point having Coordinates of X = 2,258,032.26 and Y = 193,809.54; thence in a Southeasterly direction, then in an Easterly direction, and then in a Northeasterly direction along the boundary of said Red River Wildlife Management Area to a point having Coordinates of X = 2,263,770.39 and Y = 193,242.35; thence along the boundary of said Red River Wildlife Management Area South 08 degrees 46 minutes 23 seconds East 3,443.76 feet to a point, said point also being a point on the boundary of the Three Rivers Wildlife Management Area having Coordinates of X = 2,264,295.64 and Y = 189,838.88; thence along the said boundary of Three Rivers Wildlife Management Area the following courses: North 81 degrees 54 minutes 39 seconds West 613.23 feet to a point having Coordinates of X = 2,263,688.51 and Y = 189,925.17, North 81 degrees 54 minutes 37 seconds West 168.91 feet to a point having Coordinates of X = 2,263,521.28 and Y = 189,948.94, North 81 degrees 27 minutes 15 seconds West 61.57 feet to a point having Coordinates of X = 2,263,460.39 and Y = 189,958.09, North 81 degrees 27 minutes 46 seconds West 302.65 feet to a point having Coordinates of X = 2,263,161.09 and Y = 190,003.02, North 81 degrees 27 minutes 42 seconds West 138.34 feet to a point having Coordinates of X = 2,263,024.28 and Y = 190,023.56, North 79 degrees 48 minutes 14 seconds West 58.92 feet to a point having Coordinates of X = 2,262,966.29 and Y = 190,033.99, North 79 degrees 48 minutes 22 seconds West 217.71 feet to a point having



Coordinates of X = 2,262,752.02 and Y = 190,072.52, North 79 degrees 48 minutes 15 seconds West 141.80 feet to a point having Coordinates of X = 2,262,612.46 and Y = 190,097.62, North 79 degrees 48 minutes 20 seconds West 96.50 feet to a point having Coordinates of X = 2,262,517.48 and Y = 190,114.70, North 85 degrees 42 minutes 06 seconds West 176.12 feet to a point having Coordinates of X = 2,262,341.86 and Y = 190,127.90, North 88 degrees 40 minutes 12 seconds West 291.27 feet to a point having Coordinates of X = 2,262,050.67 and Y = 190,134.66, North 86 degrees 28 minutes 47 seconds West 288.93 feet to a point having Coordinates of X = 2,261,762.29 and Y = 190,152.40, North 87 degrees 01 minutes 27 seconds West 404.31 feet to a point having Coordinates of X = 2,261,358.53 and Y = 190,173.39, North 87 degrees 02 minutes 46 seconds West 349.29 feet to a point having Coordinates of X = 2,261,009.70 and Y = 190,191.39, North 89 degrees 14 minutes 18 seconds West 307.71 feet to a point having Coordinates of X = 2,260,702.02 and Y = 190,195.48, South 83 degrees 54 minutes 47 seconds West 124.39 feet to a point having Coordinates of X = 2,260,578.33 and Y = 190,182.29, South 74 degrees 18 minutes 20 seconds West 100.00 feet to a point having Coordinates of X = 2,260,482.06 and Y = 190,155.24, South 74 degrees 49 minutes 41 seconds West 247.94 feet to a point having Coordinates of X = 2,260,242.76 and Y = 190,090.35, South 74 degrees 08 minutes 11 seconds West 257.36 feet to a point having Coordinates of X = 2,259,995.20 and Y = 190,020.00, South 74 degrees 18 minutes 23 seconds West 160.00 feet to a point having Coordinates of X = 2,259,841.16 and Y = 189,976.72, South 83 degrees 32 minutes 27 seconds West 94.05 feet to a point having Coordinates of X = 2,259,747.71 and Y = 189,966.14, North 87 degrees 54 minutes 06 seconds West 85.21 feet to a point having Coordinates of X = 2,259,662.56 and Y = 189,969.26, North 77 degrees 29 minutes 15 seconds West 64.67 feet to a point having Coordinates of X = 2,259,599.43 and Y = 189,983.27, North 65 degrees 18 minutes 40 seconds West 66.39 feet to a point having Coordinates of X = 2,259,539.11 and Y = 190,011.00, North 56 degrees 03 minutes 50 seconds West 59.43 feet to a point having Coordinates of X = 2,259,489.80 and Y = 190,044.18, North 42 degrees 01 minutes 22 seconds West 81.68 feet to a point having Coordinates of X = 2,259,435.12 and Y = 190,104.86, North 31 degrees 21 minutes 18 seconds West 83.87 feet to a point having Coordinates of X = 2,259,391.48 and Y = 190,176.48, North 23 degrees 05 minutes 12 seconds West 152.58 feet to a point having Coordinates of X = 2,259,331.65 and Y = 190,316.84, North 21 degrees 19 minutes 23 seconds West 127.03 feet to a point having Coordinates of X = 2,259,285.46 and Y = 190,435.17, North 27 degrees 16 minutes 31 seconds West 300.17 feet to a point having Coordinates of X = 2,259,147.90 and Y = 190,701.97, North 89 degrees 35 minutes 55 seconds West 912.06 feet to a point having Coordinates of X = 2,258,235.86 and Y = 190,708.36, South 02 degrees 05 minutes 04 seconds West 1,116.26 feet to a point having Coordinates of X = 2,258,195.26 and Y = 189,592.84, South 30 degrees 57 minutes 12 seconds West 1,178.04 feet to a point having Coordinates of X = 2,257,589.35 and Y = 188,582.57, South 89 degrees 33 minutes 41 seconds West 1,189.68 feet to a point having Coordinates of X = 2,256,399.70 and Y = 188,573.46; thence in a Southwesterly direction and then in a Southerly direction along the boundary of said Three Rivers Wildlife Management Area to a point having



Coordinates of X = 2,255,531.80 and Y = 184,224.10; thence South 88 degrees 36 minutes 16 seconds West 742.82 feet to a point on the boundary of said Grassy Lake Wildlife Management Area having Coordinates of X = 2,254,789.20 and Y = 184,206.01; thence along the said boundary of Grassy Lake Wildlife Management Areas the following courses: North 07 degrees 31 minutes 36 seconds West 68.48 feet to a point having Coordinates of X = 2,254,780.23 and Y = 184,273.90, North 24 degrees 00 minutes 55 seconds West 468.94 feet to a point having Coordinates of X = 2,254,589.38 and Y = 184,702.25, North 09 degrees 02 minutes 11 seconds West 326.18 feet to a point having Coordinates of X = 2,254,538.15 and Y = 185,024.38, North 06 degrees 13 minutes 35 seconds West 330.18 feet to a point having Coordinates of X = 2,254,502.34 and Y = 185,352.61, North 84 degrees 09 minutes 47 seconds East 300.01 feet to a point having Coordinates of X = 2,254,800.79 and Y = 185,383.12, North 06 degrees 42 minutes 34 seconds West 200.89 feet to a point having Coordinates of X = 2,254,777.32 and Y = 185,582.63, South 85 degrees 59 minutes 53 seconds West 296.59 feet to a point having Coordinates of X = 2,254,481.45 and Y = 185,561.93, North 06 degrees 09 minutes 52 seconds East 1,278.62 feet to a point having Coordinates of X = 2,254,618.75 and Y = 186,833.16, North 16 degrees 51 minutes 44 seconds East 1,289.34 feet to a point having Coordinates of X = 2,254,992.75 and Y = 188,067.06, North 48 degrees 46 minutes 44 seconds East 287.22 feet to a point having Coordinates of X = 2,255,208.79 and Y = 188,256.33, North 72 degrees 07 minutes 43 seconds East 120.89 feet to a point having Coordinates of X = 2,255,323.85 and Y = 188,293.43, North 39 degrees 56 minutes 03 seconds East 229.35 feet to a point having Coordinates of X = 2,255,471.07 and Y = 188,469.29, North 54 degrees 27 minutes 11 seconds East 235.72 feet to a point having Coordinates of X = 2,255,662.86 and Y = 188,606.33, North 46 degrees 33 minutes 05 seconds East 319.92 feet to a point having Coordinates of X = 2,255,895.12 and Y = 188,826.34, North 40 degrees 44 minutes 48 seconds East 278.68 feet to a point having Coordinates of X = 2,256,077.02 and Y = 189,037.47, North 57 degrees 00 minutes 12 seconds West 586.59 feet to a point having Coordinates of X = 2,255,585.05 and Y = 189,356.92, North 39 degrees 48 minutes 45 seconds East 161.81 feet to a point having Coordinates of X = 2,255,688.65 and Y = 189,481.21, North 89 degrees 43 minutes 37 seconds West 1,508.31 feet to a point having Coordinates of X = 2,254,180.36 and Y = 189,488.40, South 89 degrees 44 minutes 50 seconds West 883.78 feet to the point of beginning, **LESS AND EXCEPT**, if any, that portion of State Lease No. 12894 that may lie within the above described tract, containing approximately **170 acres**, all as more particularly outlined on a plat on file in the Office of Mineral Resources, Department of Natural Resources. All bearings, distances and coordinates are based on Louisiana Coordinate System of 1927, (North or South Zone), where applicable.

NOTE: The above description of the Tract nominated for lease has been provided and corrected, where required, exclusively by the nomination party. Any mineral lease selected from this Tract and awarded by the Louisiana State Mineral Board shall be without warranty of any kind, either express, implied, or statutory, including, but not limited to, the implied warranties of merchantability and fitness for a particular



purpose. Should the mineral lease awarded by the Louisiana State Mineral Board be subsequently modified, cancelled or abrogated due to the existence of conflicting leases, operating agreements, private claims or other future obligations or conditions which may affect all or any portion of the leased Tract, it shall not relieve the Lessee of the obligation to pay any bonus due thereon to the Louisiana State Mineral Board, nor shall the Louisiana State Mineral Board be obligated to refund any consideration paid by the Lessor prior to such modification, cancellation, or abrogation, including, but not limited to, bonuses, rentals and royalties.

NOTE: The mineral lease is located in the Red River Wildlife Management Area under the jurisdiction of the Louisiana Department of Wildlife and Fisheries which has promulgated rules and regulations for the protection of game and wildlife on the aforesaid Tract and, therefore, shall be subject to said rules and regulations, a copy of which shall be attached to the mineral lease. In addition to the specific rules and regulations applicable, the following shall apply regarding operations under this mineral lease:

1. No activities will be allowed without written authorization from the Louisiana Department of Wildlife and Fisheries.
2. Projects will be evaluated on a case by case basis. Modifications to projects may be required including, but not limited to, access routes, spoil placement, well sites, flow lines and other appurtenant structures.
3. Mitigation will be required to offset avoidable wetland impacts.
4. Removal of all structures, facilities and equipment will be required within 120 days of abandonment unless otherwise agreed to by the Louisiana Department of Wildlife and Fisheries.
5. Prior to submitting applications for wetland permits to Federal and State permitting agencies the lease holder shall coordinate project details with the Louisiana Department of Wildlife and Fisheries, Fur and Refuge Division. Contact person for the Department will be Mike Windham at (504) 568-5886.

Applicant: Stephen M. Jenkins, Inc.

Bidder	Cash Payment	Price / Acre	Rental	Oil	Gas	Other



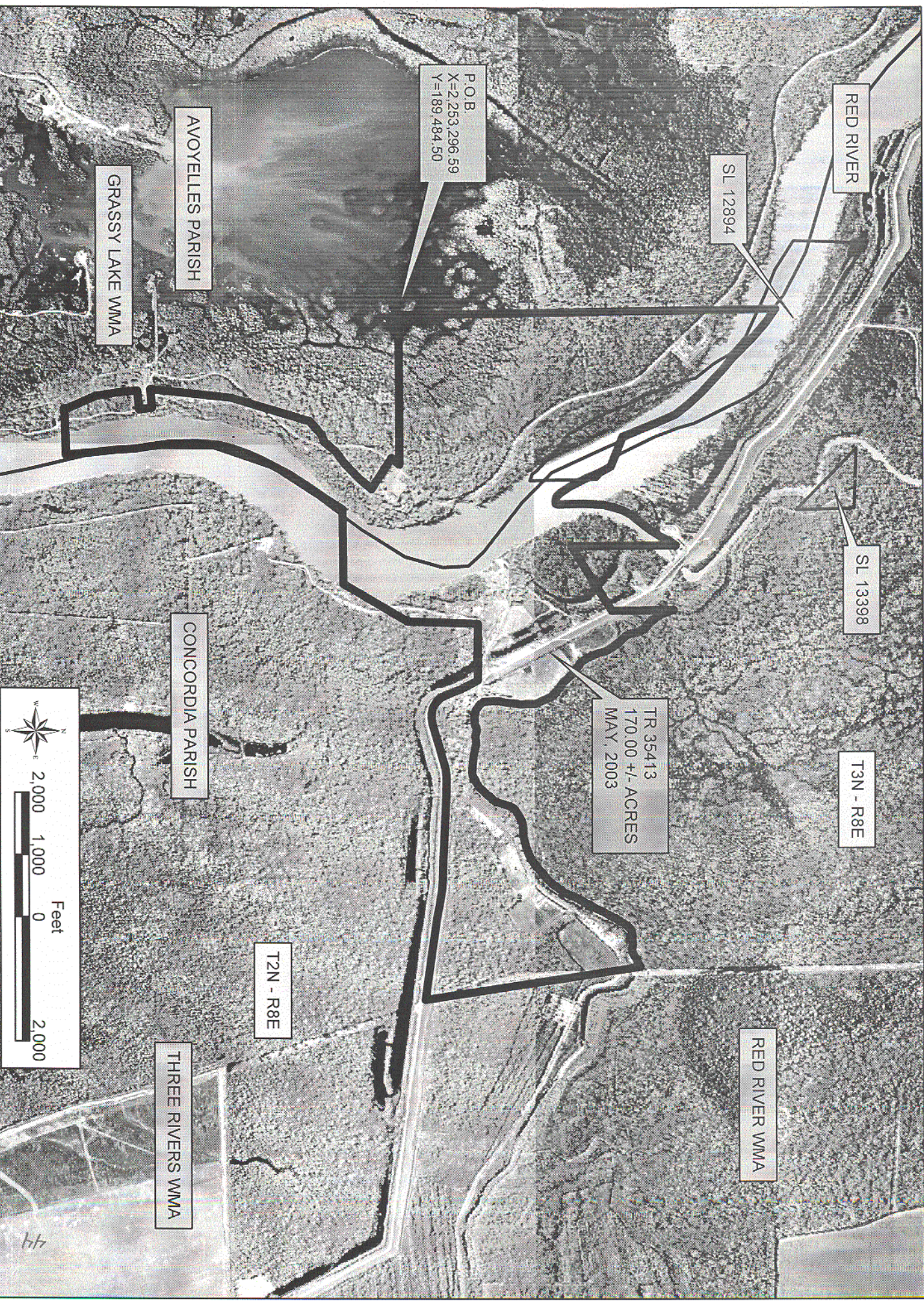

RED RIVER

SL 12894

SL 13398

T3N - R8E

TR 35413  
170.00 +/- ACRES  
MAY, 2003

POB  
X=2,253,296.59  
Y=189,484.50

AVOUELLES PARISH

GRASSY LAKE WMA

CONCORDIA PARISH

T2N - R8E

THREE RIVERS WMA

RED RIVER WMA

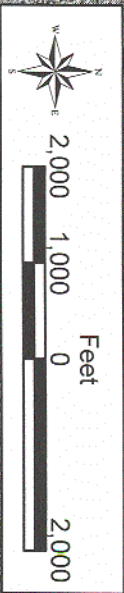



**TRACT 35414 - Concordia Parish, Louisiana**

All of the lands now or formerly constituting the beds and bottoms of all water bodies of every nature and description, and all islands and other lands formed by accretion, where allowed by law, or by reliction, and excepting tax adjudicated lands, belonging to the State of Louisiana and not presently under mineral lease on May 14, 2003, situated in Concordia Parish, Louisiana, and more particularly described as follows: Beginning at a point having Coordinates of X = 2,260,154.22 and Y = 204,608.75; thence South 4,839.10 feet to a point on the boundary of said Red River Wildlife Management Area having Coordinates of X = 2,260,154.22 and Y = 199,769.65; thence along the said boundary of Red River Wildlife Management Areas the following courses: North 89 degrees 16 minutes 36 seconds West 265.34 feet to a point having Coordinates of X = 2,259,888.90 and Y = 199,773.00, North 85 degrees 41 minutes 30 seconds West 268.23 feet to a point having Coordinates of X = 2,259,621.43 and Y = 199,793.15, South 89 degrees 00 minutes 30 seconds West 600.93 feet to a point having Coordinates of X = 2,259,020.59 and Y = 199,782.75, North 89 degrees 30 minutes 05 seconds West 1,025.92 feet to a point having Coordinates of X = 2,257,994.71 and Y = 199,791.68, North 89 degrees 11 minutes 19 seconds West 1,021.02 feet to a point having Coordinates of X = 2,256,973.79 and Y = 199,806.14, South 00 degrees 10 minutes 35 seconds East 5,200.29 feet to a point having Coordinates of X = 2,256,989.81 and Y = 194,605.87; thence in a Northwesterly direction along the boundary of said Red River Wildlife Management Area, to a point having Coordinates of X = 2,255,468.92 and Y = 199,805.45; thence along the said boundary of Red River Wildlife Management Area the following courses: North 89 degrees 44 minutes 57 seconds West 479.85 feet to a point having Coordinates of X = 2,254,989.07 and Y = 199,807.55, North 0.38 feet to a point having Coordinates of X = 2,254,989.07 and Y = 199,807.93, North 89 degrees 45 minutes 18 seconds West 958.94 feet to a point having Coordinates of X = 2,254,030.14 and Y = 199,812.03, North 01 degrees 08 minutes 26 seconds West 3,452.48 feet to a point having Coordinates of X = 2,253,961.41 and Y = 203,263.83, North 83 degrees 13 minutes 17 seconds West 849.43 feet to a point having Coordinates of X = 2,253,117.92 and Y = 203,364.09, North 83 degrees 13 minutes 18 seconds West 78.54 feet to a point having Coordinates of X = 2,253,039.93 and Y = 203,373.36, North 83 degrees 40 minutes 58 seconds West 802.40 feet to a point having Coordinates of X = 2,252,242.40 and Y = 203,461.65, North 02 degrees 15 minutes 55 seconds West 1,188.57 feet to a point having Coordinates of X = 2,252,195.42 and Y = 204,649.29, South 88 degrees 57 minutes 34 seconds East 906.32 feet to a point having Coordinates of X = 2,253,101.59 and Y = 204,632.83, South 88 degrees 57 minutes 34 seconds East 1,479.58 feet to a point having Coordinates of X = 2,254,580.93 and Y = 204,605.96, North 0.11 feet to a point having Coordinates of X = 2,254,580.93 and Y = 204,606.07, South 88 degrees 17 minutes 01 seconds East 991.19 feet to a point having Coordinates of X = 2,255,571.68 and Y = 204,576.38, South 04 degrees 38 minutes 08 seconds West 1.86 feet to a point having Coordinates of X = 2,255,571.53 and Y = 204,574.53, South 89 degrees 45 minutes 06 seconds East 92.32 feet to a point having Coordinates of X = 2,255,663.85 and Y = 204,574.13; thence North 89 degrees 33 minutes 30 seconds East 4,490.50 feet, **LESS AND**



**EXCEPT**, if any, that portion of State Lease No. 13398, as amended, that may lie within the above described tract, to the point of beginning, containing approximately **32 acres**, all as more particularly outlined on a plat on file in the Office of Mineral Resources, Department of Natural Resources. All bearings, distances and coordinates are based on Louisiana Coordinate System of 1927, (North or South Zone), where applicable.

NOTE: The above description of the Tract nominated for lease has been provided and corrected, where required, exclusively by the nomination party. Any mineral lease selected from this Tract and awarded by the Louisiana State Mineral Board shall be without warranty of any kind, either express, implied, or statutory, including, but not limited to, the implied warranties of merchantability and fitness for a particular purpose. Should the mineral lease awarded by the Louisiana State Mineral Board be subsequently modified, cancelled or abrogated due to the existence of conflicting leases, operating agreements, private claims or other future obligations or conditions which may affect all or any portion of the leased Tract, it shall not relieve the Lessee of the obligation to pay any bonus due thereon to the Louisiana State Mineral Board, nor shall the Louisiana State Mineral Board be obligated to refund any consideration paid by the Lessor prior to such modification, cancellation, or abrogation, including, but not limited to, bonuses, rentals and royalties.

NOTE: The mineral lease is located in the Red River Wildlife Management Area under the jurisdiction of the Louisiana Department of Wildlife and Fisheries which has promulgated rules and regulations for the protection of game and wildlife on the aforesaid Tract and, therefore, shall be subject to said rules and regulations, a copy of which shall be attached to the mineral lease. In addition to the specific rules and regulations applicable, the following shall apply regarding operations under this mineral lease:

1. No activities will be allowed without written authorization from the Louisiana Department of Wildlife and Fisheries.
2. Projects will be evaluated on a case by case basis. Modifications to projects may be required including, but not limited to, access routes, spoil placement, well sites, flow lines and other appurtenant structures.
3. Mitigation will be required to offset avoidable wetland impacts.
4. Removal of all structures, facilities and equipment will be required within 120 days of abandonment unless otherwise agreed to by the Louisiana Department of Wildlife and Fisheries.
5. Prior to submitting applications for wetland permits to Federal and State permitting agencies the lease holder shall coordinate project details with the Louisiana Department of Wildlife and Fisheries, Fur and Refuge Division. Contact person for the Department will be Mike Windham at (504) 568-5886.

Applicant: Stephen M. Jenkins, Inc.



Bidder	Cash Payment	Price / Acre	Rental	Oil	Gas	Other



CONCORDIA PARISH

RED RIVER WMA

AVOYELLES PARISH

RED RIVER

T3N R8E

S.L. 12894

S.L. 13398

P.O.B.  
X=2,260,154.22  
Y=204,608.75

TR 35414  
32.00 +/- ACRES  
MAY, 2003

