

T19S - R16E
PLAQUEMINES PARISH



S. L. 15498

X=2,565,700.00
Y= 260,200.00

TR 32497
270 +/- ACS.
MAY, 2000

OFFICIAL COPY
OFFICE OF MINERAL RESOURCES
DEPT. OF NATURAL RESOURCES
DO NOT REMOVE

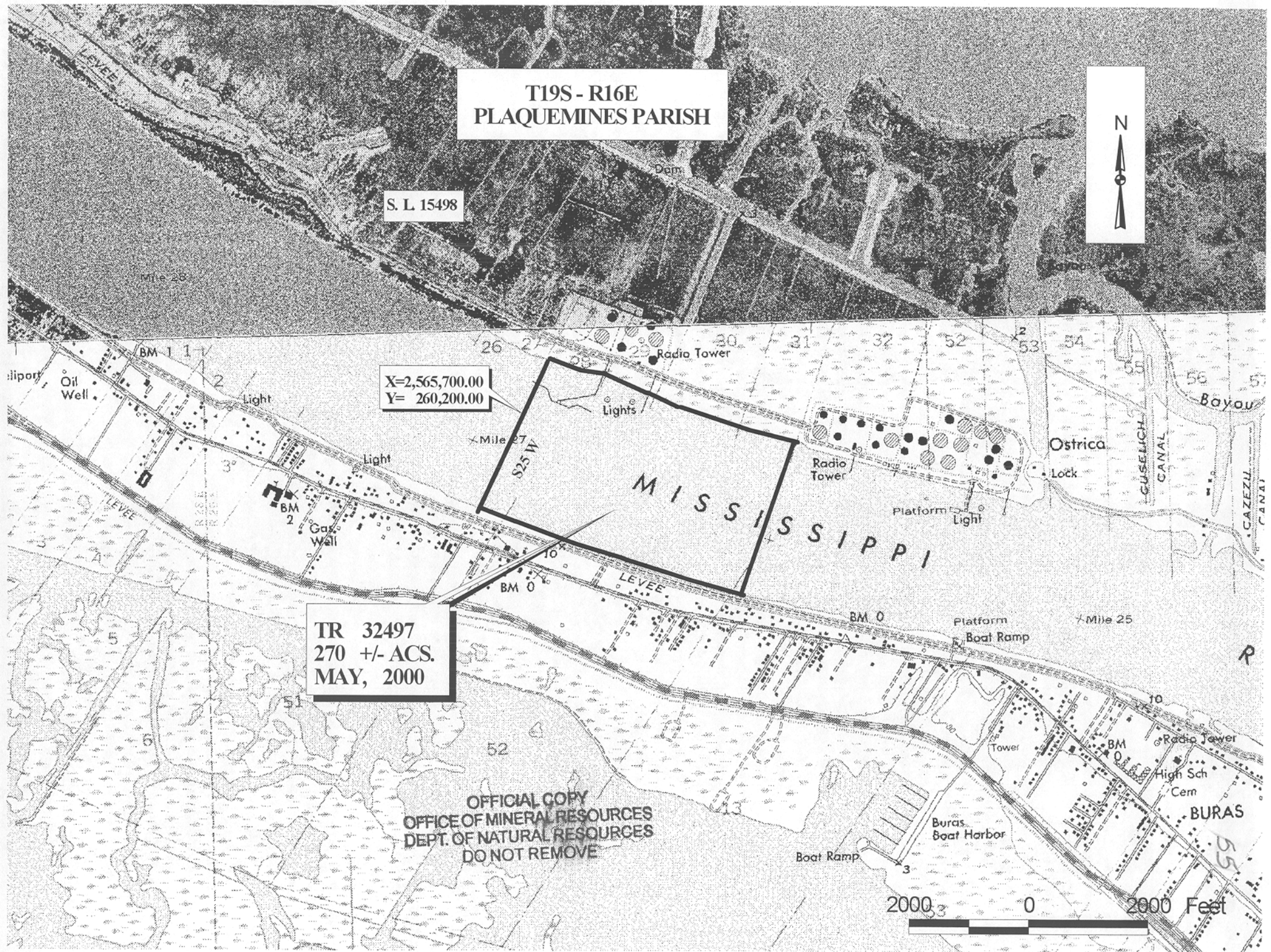
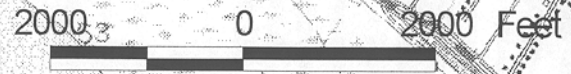

NOT TO BE USED WITH A PORTION BID
FOR INFORMATIONAL PURPOSES ONLY!

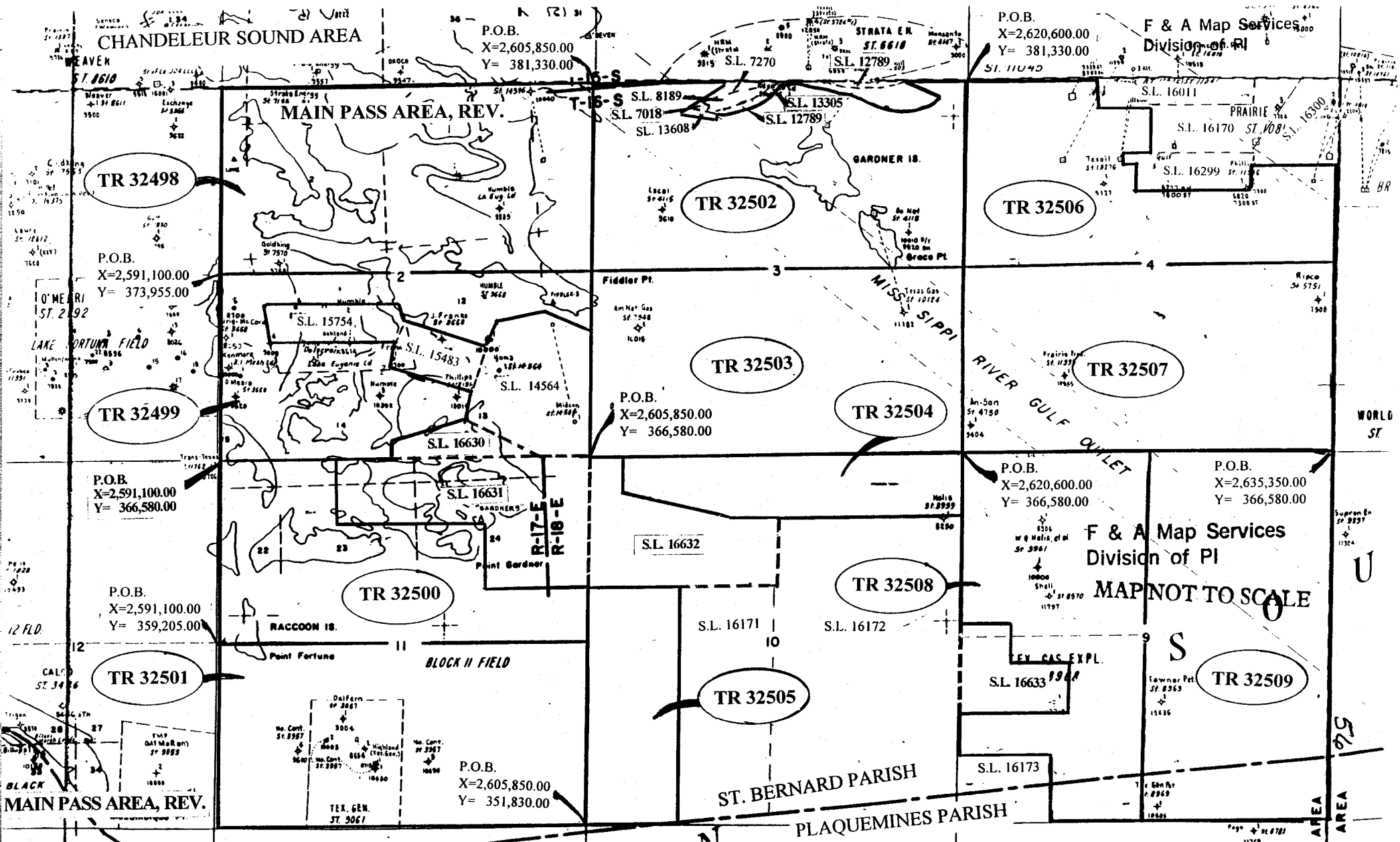

TRACT 32498 - PORTION OF BLOCK 2, MAIN PASS AREA, REVISED, St. Bernard Parish, Louisiana

All of the lands now or formerly constituting the beds and bottoms of all water bodies of every nature and description and all islands and other lands formed by accretion or reliction, except tax lands, belonging to the State of Louisiana and not under mineral lease on May 10, 2000, situated in St. Bernard Parish, Louisiana, and more particularly described as follows: Beginning at a point on the West line of Block 2, Main Pass Area, Revised, having Coordinates of X = 2,591,100.00 and Y = 373,955.00; thence North 7,375.00 feet on the West line of said Block 2 to its Northwest corner having Coordinates of X = 2,591,100.00 and Y = 381,330.00; thence East 14,750.00 feet on the North line of said Block 2 to its Northeast corner having Coordinates of X = 2,605,850.00 and Y = 381,330.00; thence South 7,375.00 feet on the East line of said Block 2 to a point having Coordinates of X = 2,605,850.00 and Y = 373,955.00; thence West 14,750.00 feet to the point of beginning, containing approximately 1,164 acres, as shown outlined in red on a plat on file in the Office of Mineral Resources, Department of Natural Resources. All bearings, distances and coordinates are based on Louisiana Coordinate System of 1927 (South Zone).

NOTE: The above tract is located in or near an oyster restricted area and all operations in such area must be conducted in strict conformity with the stipulations and/or regulations of the Louisiana Department of Wildlife and Fisheries.

NOTE: The State of Louisiana does hereby reserve, and this lease shall be subject to, the imprescriptible right of surface use in the nature of a servitude in favor of the Department of Natural Resources, including its Offices and Commissions, for the sole purpose of implementing, constructing, servicing and maintaining approved coastal zone management and/or restoration projects. Utilization of any and all rights derived under this lease by the mineral lessee, its agents, successors or assigns, shall not interfere with nor hinder the reasonable surface use by the Department of Natural Resources, its Offices or Commissions, as hereinabove reserved.

Applicant: Robert A. Schroeder, Inc.

| Bidder | Cash Payment | Price / Acre | Rental | Oil | Gas | Other |
|--------|--------------|--------------|--------|-----|-----|-------|
| | | | | | | |
| | | | | | | |
| | | | | | | |
| | | | | | | |

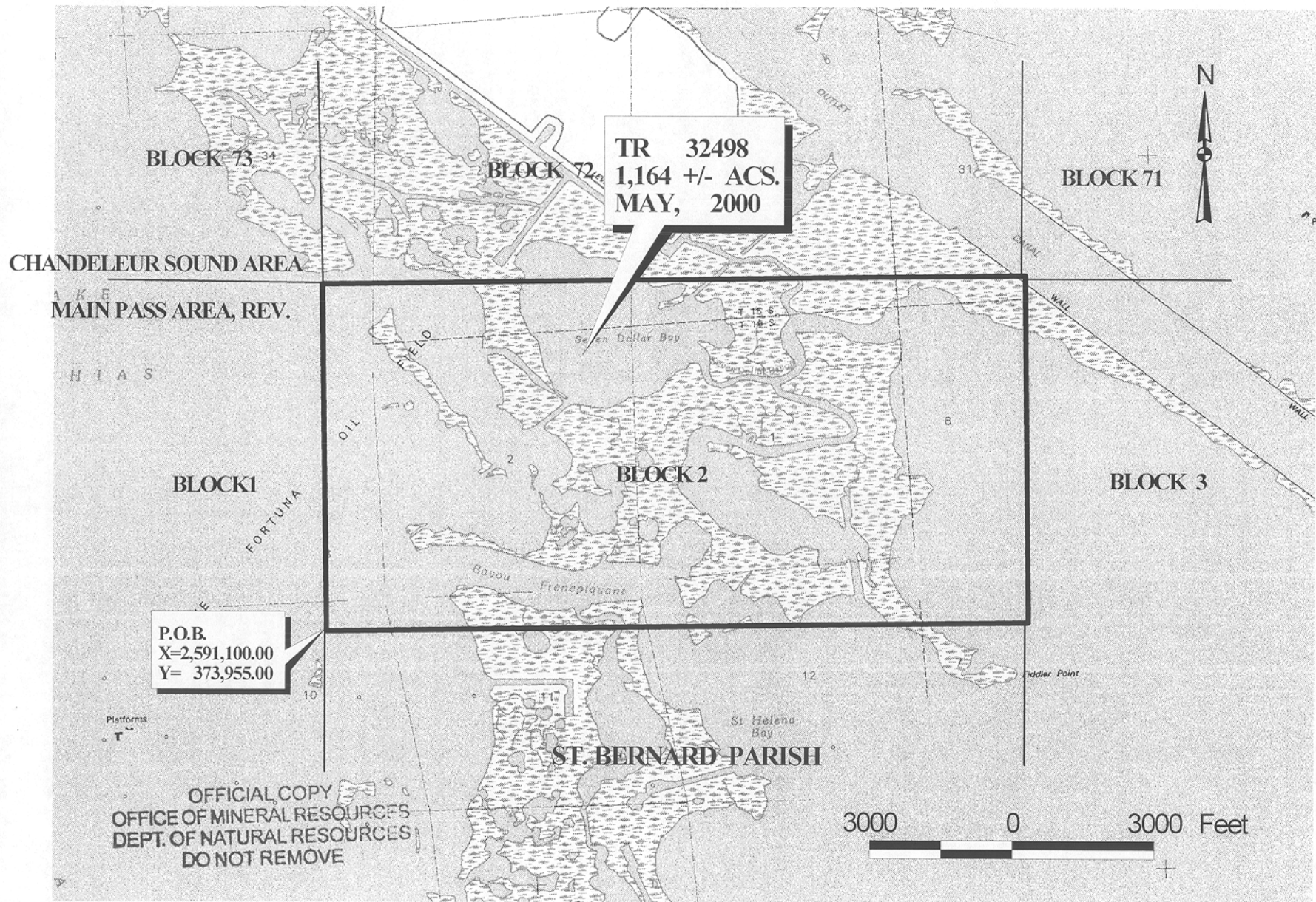

TRACT 32499 - PORTION OF BLOCK 2, MAIN PASS AREA, REVISED, St. Bernard Parish, Louisiana

All of the lands now or formerly constituting the beds and bottoms of all water bodies of every nature and description and all islands and other lands formed by accretion or reliction, except tax lands, belonging to the State of Louisiana and not under mineral lease on May 10, 2000, situated in St. Bernard Parish, Louisiana, and more particularly described as follows: Beginning at a point on the West line of Block 2, Main Pass Area, Revised, having Coordinates of X = 2,591,100.00 and Y = 373,955.00; thence East 14,750.00 feet to a point on the East line of said Block 2 having Coordinates of X = 2,605,850.00 and Y = 373,955.00; thence South 2,425.00 feet on the East line of said Block 2 to a point on the North line of State Lease No. 14564 having Coordinates of X = 2,605,850.00 and Y = 371,530.00; thence with the boundaries of said State Lease No. 14564 the following courses: North 66 degrees 59 minutes 59 seconds West 2,100.00 feet, South 77 degrees 59 minutes 59 seconds West 2,000.01 feet and South 18 degrees 00 minutes 08 seconds West 1,099.51 feet to the Northeast corner of State Lease No. 15483; thence North 71 degrees 59 minutes 52 seconds West 3,500.00 feet along the North line of said State Lease No. 15483 to its Northwest corner which lies on the East boundary of State Lease No. 15754 having Coordinates of X = 2,598,292.17 and Y = 371,970.71; thence along the boundaries of said State Lease No. 15754 the following courses: North 13 degrees 00 minutes 37 seconds West 716.88 feet, West 5,433.26 feet, South 11 degrees 38 minutes 01 seconds East 1,500.00 feet, East 5,041.72 feet to a point on the West line of said State Lease No. 15483; thence along the boundaries of said State Lease No. 15483 the following courses: South 18 degrees 00 minutes 08 seconds West 989.62 feet and South 71 degrees 59 minutes 52 seconds East 3,500.00 feet to a point on the West line of said State Lease No. 14564 having Coordinates of X = 2,601,064.53 and Y = 369,177.14; thence South 18 degrees 00 minutes 08 seconds West 1,100.00 feet on the West line of said State Lease No. 14564 to the most Northern point of State Lease No. 16630 having Coordinates of X = 2,600,724.57 and Y = 368,130.99; thence on the boundaries of said State Lease No. 16630 the following courses: South 71 degrees 50 minutes 57 seconds West 2,972.48 feet and South 625.00 feet to a point on the South line of said Block 2 having Coordinates of X = 2,597,900.00 and Y = 366,580.00; thence West 6,800.00 feet to a point on the West line of said Block 2 having Coordinates of X = 2,591,100.00 and Y = 366,580.00; thence North 7,375.00 feet on the West line of said Block 2 to the point of beginning, containing approximately **807 acres**, as shown outlined in red on a plat on file in the Office of Mineral Resources, Department of Natural Resources. All bearings, distances and coordinates are based on Louisiana Coordinate System of 1927 (South Zone).

NOTE: The above tract is located in or near an oyster restricted area and all operations in such area must be conducted in strict conformity with the stipulations and/or regulations of the Louisiana Department of Wildlife and Fisheries.

NOTE: The State of Louisiana does hereby reserve, and this lease shall be subject to, the imprescriptible right of surface use in the nature of a servitude in favor of the Department of Natural Resources, including its Offices and Commissions, for the sole purpose of implementing, constructing, servicing and maintaining approved coastal zone management and/or restoration projects. Utilization of any and all rights derived under this lease by the mineral lessee, its agents, successors or assigns, shall not interfere with nor

hinder the reasonable surface use by the Department of Natural Resources, its Offices or Commissions, as hereinabove reserved.

Applicant: Robert A. Schroeder, Inc.

| Bidder | Cash Payment | Price / Acre | Rental | Oil | Gas | Other |
|--------|--------------|--------------|--------|-----|-----|-------|
| | | | | | | |
| | | | | | | |
| | | | | | | |
| | | | | | | |