

OFFICIAL COPY
OFFICE OF MINERAL RESOURCES
DEPT. OF NATURAL RESOURCES
DO NOT REMOVE

TRACT 32487 - Cameron Parish, Louisiana

All of the lands now or formerly constituting the beds and bottoms of all water bodies of every nature and description and all islands and other lands formed by accretion or reliction, except tax lands, owned by and not under mineral lease from the State of Louisiana on May 10, 2000, situated in Cameron Parish, Louisiana, within the following described boundaries: Beginning at a corner of State Lease No. 15993 having Coordinates of X = 1,519,459.28 and Y = 429,847.11; thence South 88 degrees 33 minutes 21 seconds East 170.82 feet along a Southern boundary of said State Lease No. 15993 to a point having Coordinates of X = 1,519,630.04 and Y = 429,842.80; thence South 61 degrees 52 minutes 50 seconds West 196.38 feet to a point on the Eastern boundary of said State Lease No. 15993 having Coordinates of X = 1,519,456.84 and Y = 429,750.24; thence North 01 degrees 26 minutes 39 seconds East 96.89 feet along the Eastern boundary of said State Lease No. 15993 to the point of beginning, containing approximately 0.19 acres, as shown outlined in red on a plat on file in the Office of Mineral Resources, Department of Natural Resources. All bearings, distances and coordinates are based on Louisiana Coordinate System of 1927 (South Zone).

NOTE: The State of Louisiana does hereby reserve, and this lease shall be subject to, the imprescriptible right of surface use in the nature of a servitude in favor of the Department of Natural Resources, including its Offices and Commissions, for the sole purpose of implementing, constructing, servicing and maintaining approved coastal zone management and/or restoration projects. Utilization of any and all rights derived under this lease by the mineral lessee, its agents, successors or assigns, shall not interfere with nor hinder the reasonable surface use by the Department of Natural Resources, its Offices or Commissions, as hereinabove reserved.

Applicant: Rebel Minerals, Inc.

Bidder	Cash Payment	Price / Acre	Rental	Oil	Gas	Other

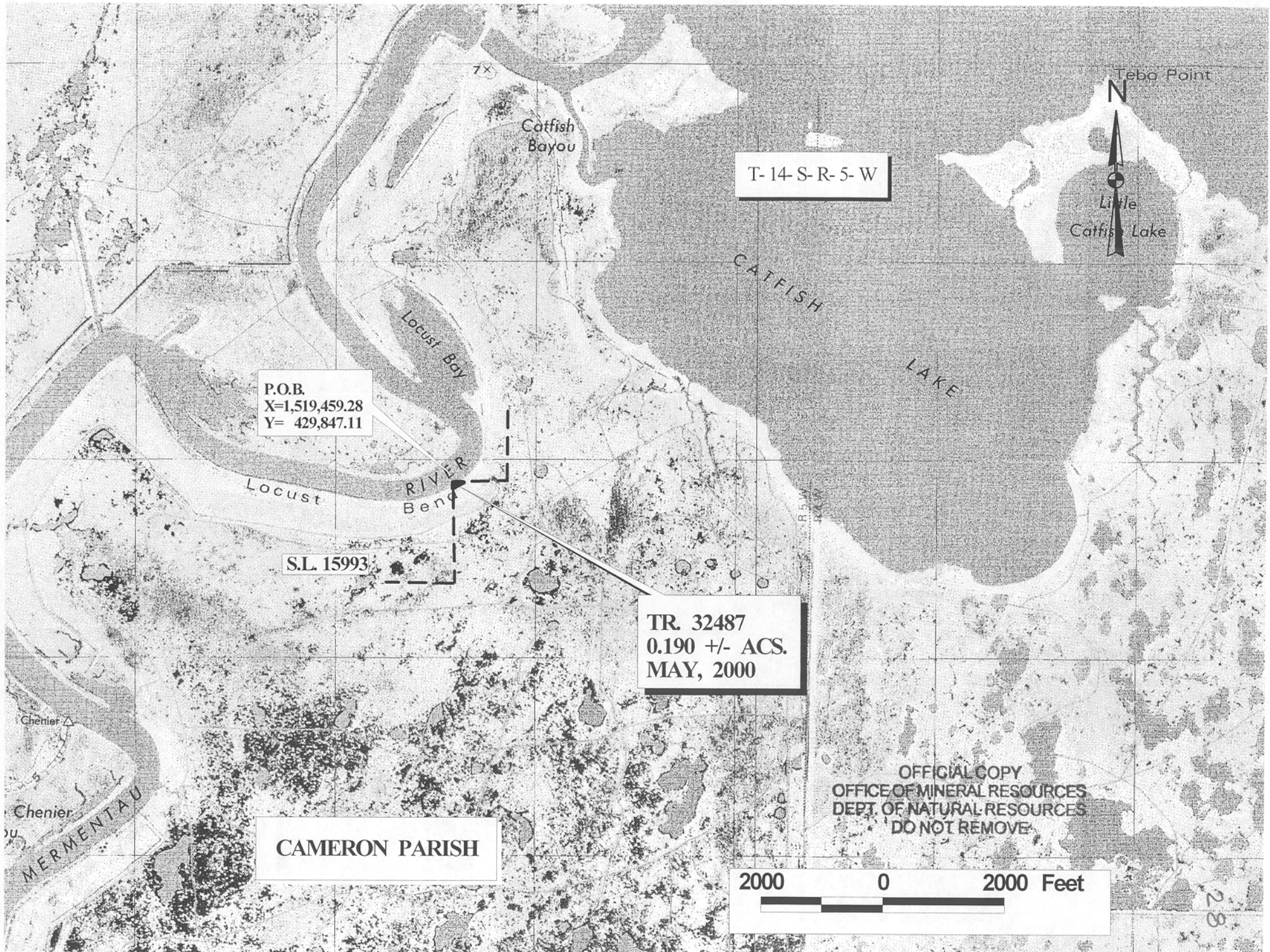

T-14 S-R-5-W

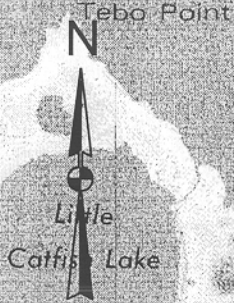

P.O.B.
X=1,519,459.28
Y= 429,847.11

S.L. 15993

TR. 32487
0.190 +/- ACS.
MAY, 2000

OFFICIAL COPY
OFFICE OF MINERAL RESOURCES
DEPT. OF NATURAL RESOURCES
DO NOT REMOVE

CAMERON PARISH

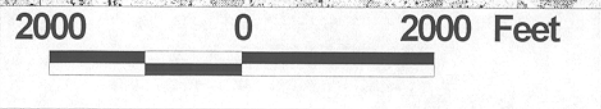

TRACT 32488 - Lafayette Parish, Louisiana

All of the right, title and interest of the State of Louisiana in the mineral rights in and to the following described property, which is not under mineral lease from the State of Louisiana on May 10, 2000, situated in Lafayette Parish, Louisiana, and being more fully described as follows: A certain tract of land situated in the Northeast Quarter of Section 29, Township 9 South, Range 3 East, Lafayette Parish, Louisiana, situated within the corporate limits of the Town of Duson, Lafayette Parish, Louisiana, and being known and designated as Lot 1, Block 1 of the Plan of the Village of Duson on file in the Clerk's Office, Parish of Lafayette. Said lot having the dimensions of forty (40) feet by one hundred twenty (120) feet, being the same property adjudicated to the State of Louisiana for unpaid taxes for the year 1906 assessed in the name of R.E. Adams per act recorded under Entry No. 35679 and further identified in that certain sheriff's deed of sale dated September 4, 1946, from the State of Louisiana to Richard Lagneaux recorded under Entry No. 194124 of the Records of Lafayette Parish, Louisiana, containing approximately **0.110 acres**, as shown outlined in red on a plat on file in the Office of Mineral Resources, Department of Natural Resources.

Applicant: Louisiana Oil and Gas, Inc.

Bidder	Cash Payment	Price / Acre	Rental	Oil	Gas	Other